

UNITED STATES
DEPARTMENT OF THE INTERIOR
BUREAU OF LAND MANAGEMENT

NMOCD

SUNDRY NOTICES AND REPORTS ON WELLS
Do not use this form for proposals to drill or to re-enter an abandoned well. Use form 3160-3 (APD) for such proposals.

Artesia

FORM APPROVED
OMB NO. 1004-0135
Expires: July 31, 20105. Lease Serial No.
NMNM89156

6. If Indian, Allottee or Tribe Name

7. If Unit or CA/Agreement, Name and/or No.

8. Well Name and No.
HAWK 8 N FEDERAL 509. API Well No.
30-015-43277-00-X110. Field and Pool, or Exploratory
RED LAKE11. County or Parish, and State
EDDY COUNTY, NM**SUBMIT IN TRIPLICATE - Other instructions on reverse side.**

1. Type of Well

☒ Oil Well ☐ Gas Well ☐ Other

2. Name of Operator

LIME ROCK RESOURCES II A LP

Contact: MIKE PIPPIN

E-Mail: MIKE@PIPPINLLC.COM

3a. Address

1111 BAGBY STREET SUITE 4600
HOUSTON, TX 77002

3b. Phone No. (include area code)

Ph: 505-327-4573

4. Location of Well (Footage, Sec., T., R., M., or Survey Description)

Sec 8 T18S R27E SESW 455FSL 1980FWL

12. CHECK APPROPRIATE BOX(ES) TO INDICATE NATURE OF NOTICE, REPORT, OR OTHER DATA

TYPE OF SUBMISSION	TYPE OF ACTION			
<input type="checkbox"/> Notice of Intent	<input type="checkbox"/> Acidize	<input type="checkbox"/> Deepen	<input type="checkbox"/> Production (Start/Resume)	<input type="checkbox"/> Water Shut-Off
<input checked="" type="checkbox"/> Subsequent Report	<input type="checkbox"/> Alter Casing	<input type="checkbox"/> Fracture Treat	<input type="checkbox"/> Reclamation	<input type="checkbox"/> Well Integrity
<input type="checkbox"/> Final Abandonment Notice	<input type="checkbox"/> Casing Repair	<input type="checkbox"/> New Construction	<input type="checkbox"/> Recomplete	<input checked="" type="checkbox"/> Other
	<input type="checkbox"/> Change Plans	<input type="checkbox"/> Plug and Abandon	<input type="checkbox"/> Temporarily Abandon	Well Spud
	<input type="checkbox"/> Convert to Injection	<input type="checkbox"/> Plug Back	<input type="checkbox"/> Water Disposal	

13. Describe Proposed or Completed Operation (clearly state all pertinent details, including estimated starting date of any proposed work and approximate duration thereof. If the proposal is to deepen directionally or recomple horizontally, give subsurface locations and measured and true vertical depths of all pertinent markers and zones. Attach the Bond under which the work will be performed or provide the Bond No. on file with BLM/BIA. Required subsequent reports shall be filed within 30 days following completion of the involved operations. If the operation results in a multiple completion or recompletion in a new interval, a Form 3160-4 shall be filed once testing has been completed. Final Abandonment Notices shall be filed only after all requirements, including reclamation, have been completed, and the operator has determined that the site is ready for final inspection.)

THIS IS THE SPUD & CASING REPORT FOR THIS NEW OIL WELL:

Spudded well on 8/13/16. Drilled 11" hole to 353'. Set 8-5/8" 24# J-55 csg @ 353'. Cmted lead w/98 sx (151 cf) cl "C" cmt w/2% Cacl2 & 10% gypsum. Tailed w/241 sx (325 cf) cl "C" cmt w/2% Cacl2 & 1/4#/sx cello flake. Did not circ cmt. Ran 1" tbg & found TOC @ 93'. Pumped 225 sx cmt w/2% Cacl2 down 1" & circ 138 sx cmt to pit. The 1" tbg procedure was approved by a BLM Engineer. On 8/14/16, pressure tested 8-5/8" csg to 1500 psi for 30 min-OK.

Drilled 7-7/8" hole to TD4894' on 8/23/16. Ran open hole logs. On 8/25/16, set 5-1/2" 17# J-55 production csg @ 4878'. Cmted lead w/130 sx (380 cf) cl "C" 35/65 poz w/10% gel, 5% salt, 0.6% SMS, 0.25#/sx cello flake, & 5#/sx kol-Seal. Tailed w/745 sx (969 cf) cl "C" cmt w/2% gel, 0.2% OTX 20, & 5% salt. Circ 52 sx cmt to pit. Released drilling rig on 8/25/16. Plan to pressure test 5-1/2"

NM OIL CONSERVATION
ARTESIA DISTRICT

SEP 06 2016

RECEIVED

14. I hereby certify that the foregoing is true and correct.

Electronic Submission #349179 verified by the BLM Well Information System
For LIME ROCK RESOURCES II A LP, sent to the Carlsbad
Committed to AFMSS for processing by JENNIFER SANCHEZ on 08/29/2016 (16JAS1723SE)

Name (Printed/Typed) MIKE PIPPIN

Title. PETROLEUM ENGINEER

Signature (Electronic Submission)

Date 08/26/2016

THIS SPACE FOR FEDERAL OR STATE OFFICE USE

AUG 29 2016

Approved By

Title

Conditions of approval, if any, are attached. Approval of this notice does not warrant or certify that the applicant holds legal or equitable title to those rights in the subject lease which would entitle the applicant to conduct operations thereon.

Office

Title 18 U.S.C. Section 1001 and Title 43 U.S.C. Section 1212, make it a crime for any person knowingly and willfully to make to any department or agency of the United States any false, fictitious or fraudulent statements or representations as to any matter within its jurisdiction.

**** BLM REVISED ** BLM REVISED ** BLM REVISED ** BLM REVISED ** BLM REVISED ****

Additional data for EC transaction #349179 that would not fit on the form

32. Additional remarks, continued
csg during completion operations.

District I
1625 N. French Dr., Hobbs, NM 88240
District II
1301 W. Grand Avenue, Artesia, NM 88210
District III
1000 Rio Brazos Rd., Aztec, NM 87410
District IV
1220 S. St. Francis Dr., Santa Fe, NM 87505

State of New Mexico
Energy, Minerals & Natural Resources Department
OIL CONSERVATION DIVISION
1220 South St. Francis Dr.
Santa Fe, NM 87505

Form C-102
Revised October 12, 2005
Submit to Appropriate District Office
State Lease - 4 Copies
Fee Lease - 3 Copies

AS DRILLED

☐ AMENDED REPORT

WELL LOCATION AND ACREAGE DEDICATION PLAT

* API Number 30-015-43277		51120		* Pool Name Red Lake, Glorieta-Yeso	
* Property Code 309003		* Property Name HAWK 8 N FEDERAL			* Well Number 50
* OGRID No. 277558		* Operator Name LIME ROCK RESOURCES II-A, L.P.			* Elevation 3433' GL

¹⁰ Surface Location

UL or lot no.	Section	Township	Range	Lot Idn	Feet from the	North/South line	Feet from the	East/West line	County
N	8	18-S	27-E		455	SOUTH	1980	WEST	EDDY

¹¹ Bottom Hole Location If Different From Surface

UL or lot no.	Section	Township	Range	Lot Idn	Feet from the	North/South line	Feet from the	East/West line	County
N	8	18-S	27-E		957	SOUTH	1683	WEST	EDDY

¹² Dedicated Acres 40	¹³ Joint or Infill	¹⁴ Consolidation Code	¹⁵ Order No.
-------------------------------------	-------------------------------	----------------------------------	-------------------------

¹⁷ OPERATOR CERTIFICATION

I hereby certify that the information contained herein is true and complete to the best of my knowledge and belief, and that this organization either owns a working interest or unleased mineral interest in the land including the proposed bottom hole location or has a right to drill this well at this location pursuant to a contract with an owner of such a mineral or working interest, or to a voluntary pooling agreement or a compulsory pooling order heretofore entered by the division.

8/26/16

Signature

Date

Mike Pippin

Printed Name

¹⁸ SURVEYOR CERTIFICATION

I hereby certify that the well location shown on this plat was plotted from field notes of actual surveys made by me or under my supervision, and that the same is true and correct to the best of my belief.

7/28/14

Date of Survey

Signature and Seal of Professional Surveyor:

Filmon F. Jaramillo

12797 Certificat Number

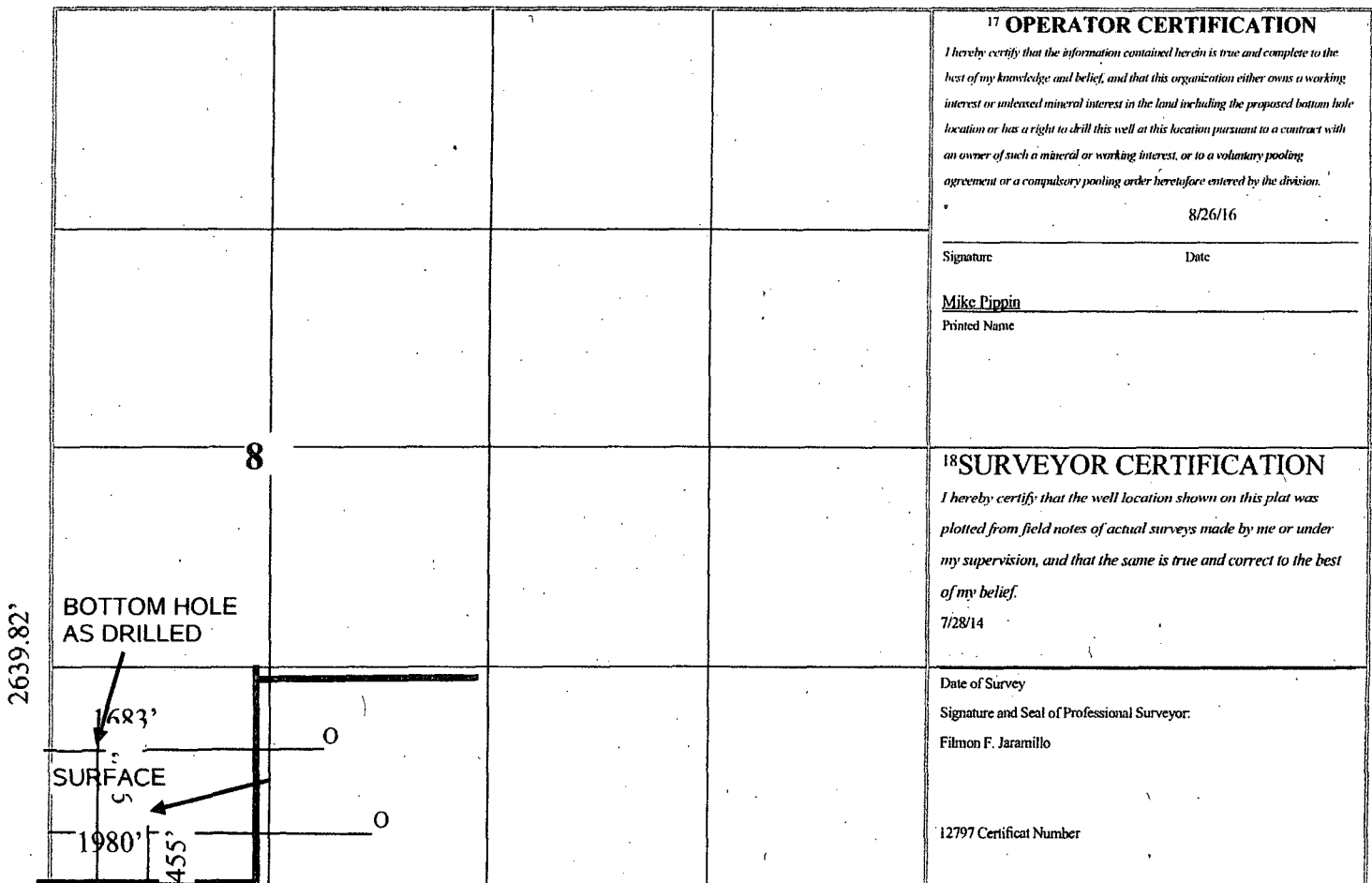

2628.29'