

UNITED STATES
DEPARTMENT OF THE INTERIOR
BUREAU OF LAND MANAGEMENTCarlsbad Field Office
OCD ArtesiaFORM APPROVED
OMB NO. 1004-0137
Expires: January 31, 2018**SUNDRY NOTICES AND REPORTS ON WELLS**
Do not use this form for proposals to drill or to re-enter an abandoned well. Use form 3160-3 (APD) for such proposals.5. Lease Serial No.
NMNM81622

6. If Indian, Allottee or Tribe Name

7. If Unit or CA/Agreement, Name and/or No.

8. Well Name and No.
ICE DANCER 30 FEDERAL 2H9. API Well No.
30-015-3947310. Field and Pool or Exploratory Area
FORTY NINER RIDGE, BS11. County or Parish, State
EDDY COUNTY, NM**SUBMIT IN TRIPLICATE - Other instructions on page 2**

1. Type of Well

☒ Oil Well ☐ Gas Well ☐ Other2. Name of Operator
COG OPERATING LLCContact: AMANDA L AVERY
E-Mail: aavery@concho.com3a. Address
2208 W MAIN STREET
ARTESIA, NM 882103b. Phone No. (include area code)
Ph: 575-748-69404. Location of Well (Footage, Sec., T., R., M., or Survey Description)
Sec 30 T23S R30E SWSE 475FSL 1980FEL**12. CHECK THE APPROPRIATE BOX(ES) TO INDICATE NATURE OF NOTICE, REPORT, OR OTHER DATA**

TYPE OF SUBMISSION

TYPE OF ACTION

☐ Notice of Intent☒ Subsequent Report☐ Final Abandonment Notice☐ Acidize☐ Alter Casing☐ Casing Repair☐ Change Plans☐ Convert to Injection☐ Deepen☐ Hydraulic Fracturing☐ New Construction☐ Plug and Abandon☐ Plug Back☐ Production (Start/Resume)☐ Reclamation☐ Recomplete☐ Temporarily Abandon☐ Water Disposal☐ Water Shut-Off☐ Well Integrity☒ Other
Off-Lease Measurement

13. Describe Proposed or Completed Operation: Clearly state all pertinent details, including estimated starting date of any proposed work and approximate duration thereof. If the proposal is to deepen directionally or recomple horizontally, give subsurface locations and measured and true vertical depths of all pertinent markers and zones. Attach the Bond under which the work will be performed or provide the Bond No. on file with BLM/BIA. Required subsequent reports must be filed within 30 days following completion of the involved operations. If the operation results in a multiple completion or recomple in a new interval, a Form 3160-4 must be filed once testing has been completed. Final Abandonment Notices must be filed only after all requirements, including reclamation, have been completed and the operator has determined that the site is ready for final inspection.

COG Operating LLC respectfully requests permission for Off Lease Measurement for oil and gas for the Ice Dancer 30 Federal #2H.

All Interest owners have been notified of this proposal.

No Federal or Indian Royalties will be reduced by the approval of this application.

The off lease measurement meter is located at the Gold Rush 31 Federal #1. 660' FNL & 330' FEL of Sec 31-T23S R30E. The gas sales meter is located at Sec 23-T23S-R29E Latitude 32.272885 and Longitude -103.948023.

The following documents are attached:

NM OIL CONSERVATION
ARTESIA DISTRICT

FEB 24 2017

RECEIVED

14. I hereby certify that the foregoing is true and correct.

Electronic Submission #339592 verified by the BLM Well Information System
For COG OPERATING LLC, sent to the Carlsbad
Committed to AFMSS for processing by PRISCILLA PEREZ on 05/24/2016 ()

Name (Printed/Typed) AMANDA L AVERY

Title REGULATORY TECH

Signature (Electronic Submission)

Date 05/18/2016

THIS SPACE FOR FEDERAL OR STATE OFFICE USE

Approved By

Title TLDET

Date 2/21/17

Conditions of approval, if any, are attached. Approval of this notice does not warrant or certify that the applicant holds legal or equitable title to those rights in the subject lease which would entitle the applicant to conduct operations thereon.

Office CFO

Title 18 U.S.C. Section 1001 and Title 43 U.S.C. Section 1212, make it a crime for any person knowingly and willfully to make to any department or agency of the United States any false, fictitious or fraudulent statements or representations as to any matter within its jurisdiction.

(Instructions on page 2)

**** OPERATOR-SUBMITTED ** OPERATOR-SUBMITTED ** OPERATOR-SUBMITTED ****

Accepted for record - NMOCD

RFP 3-6-17

Additional data for EC transaction #339592 that would not fit on the form

32. Additional remarks, continued

- 1) Map showing lease numbers and locations of leases and wells that will contribute production to the off lease measurement.
- 2) Facility Diagrams
- 3) Plat of the location
- 4) Interest owners notification letters.

DATE IN	BY	ENGINEER	DATE	TITLE	OFFICE
---------	----	----------	------	-------	--------

ABOVE THIS LINE FOR DIVISION USE ONLY

NEW MEXICO OIL CONSERVATION DIVISION

- Engineering Bureau -

1220 South St. Francis Drive, Santa Fe, NM 87505



ADMINISTRATIVE APPLICATION CHECKLIST

THIS CHECKLIST IS MANDATORY FOR ALL ADMINISTRATIVE APPLICATIONS FOR EXCEPTIONS TO DIVISION RULES AND REGULATIONS WHICH REQUIRE PROCESSING AT THE DIVISION LEVEL IN SANTA FE

Application Acronyms:

[NSL-Non-Standard Location] [NSP-Non-Standard Proration Unit] [SD-Simultaneous Dedication]
 [DHC-Downhole Commingling] [CTB-Lease Commingling] [PLC-Pool/Lease Commingling]
 [PC-Pool Commingling] [OLS - Off-Lease Storage] [OLM-Off-Lease Measurement]
 [WFX-Waterflood Expansion] [PMX-Pressure Maintenance Expansion]
 [SWD-Salt Water Disposal] [IPI-Injection Pressure Increase]
 [EOR-Qualified Enhanced Oil Recovery Certification] [PPR-Positive Production Response]

[1] TYPE OF APPLICATION - Check Those Which Apply for [A]

- [A] Location - Spacing Unit - Simultaneous Dedication
☐ NSL ☐ NSP ☐ SD

Check One Only for [B] or [C]

- [B] Commingling - Storage - Measurement
☐ DHC ☐ CTB ☐ PLC ☐ PC ☐ OLS ☒ OLM

- [C] Injection - Disposal - Pressure Increase - Enhanced Oil Recovery
☐ WFX ☐ PMX ☐ SWD ☐ IPI ☐ EOR ☐ PPR

- [D] Other: Specify _____

[2] NOTIFICATION REQUIRED TO: - Check Those Which Apply, or Does Not Apply

- [A] ☒ Working, Royalty or Overriding Royalty Interest Owners
 [B] ☐ Offset Operators, Leaseholders or Surface Owner
 [C] ☐ Application is One Which Requires Published Legal Notice
 [D] ☐ Notification and/or Concurrent Approval by BLM or SLO
U.S. Bureau of Land Management Commissioner of Public Lands, State Land Office
 [E] ☒ For all of the above, Proof of Notification or Publication is Attached, and/or,
 [F] ☐ Waivers are Attached

[3] SUBMIT ACCURATE AND COMPLETE INFORMATION REQUIRED TO PROCESS THE TYPE OF APPLICATION INDICATED ABOVE.

[4] **CERTIFICATION:** I hereby certify that the information submitted with this application for administrative approval is accurate and complete to the best of my knowledge. I also understand that no action will be taken on this application until the required information and notifications are submitted to the Division.

Note: Statement must be completed by an individual with managerial and/or supervisory capacity.

Amanda Avery
 Print or Type Name

Amanda Avery
 Signature

Regulatory Tech
 Title

5/17/16
 Date

aavery@concho.com
 e-mail Address



May 17, 2016

New Mexico Oil Conservation Division
1220 S St. Francis Drive
Santa Fe, NM 87505

Dear Mr. McMillan,

COG Operating LLC respectfully requests approval for Off-Lease Measurement of oil and gas on the following well:

Ice Dancer 30 Federal Com #2H
Eddy County
API# 30-015-39473
SHL 475' FSL & 1980' FEL of Sec 30-T23S- R30E
BHL 342' FNL & 2256' FEL of Sec 30- T23S- R30E
Forty Niner Ridge, BS

The Off-Lease Measurement meter will be located at the Gold Rush 31 Federal #1, 660' FNL & 330' FEL of Sec 31-T23S- R30E. The gas sales meter is located at Sec 23- T23S -R29E. Latitude 32.272885 and Longitude -103.948023.

COG Operating LLC will keep all production separate.

I have attached proof of notice to our working interest owners, a diagram of our battery facility and a map with lease boundaries showing all well and facility locations.

Sincerely,

Amanda Avery
Regulatory Technician



May 17, 2016

Dear Interest Owner

This letter will serve as notice, under Rule 19.15.N.1207.A, that COG Operating LLC has requested administrative approval from the Oil and Gas Division in Santa Fe, NM for Off-Lease Measurement of only for the following well:

Ice Dancer 30 Federal Com #2H
Eddy County, NM
API# 30-015-39473
SHL: 475' FSL & 1980' FEL of Sec 30- T23S R30E
BHL: 342' FNL & 2256' FEL of Sec 30- T23S R30E
Forty Niner Ridge; BS

The Off-Lease Measurement facility will be located at the Gold Rush 31 Federal #1.
660 'FNL & 330' FEL of Sec 31-T23S R30E. The gas sales meter is located at
SESE Sec 23 T23S R29E. Latitude 32.272885 and Longitude -103.948023.

Should you or your company have an objection, it must be filed in writing within twenty (20) days from the date of this notice. The Division Director may approve the Off-Lease Measurement Facility if no objection has been made within the twenty (20) days after the application has been received.

Sincerely,

Amanda Avery
Regulatory Tech

Date Sent	Initial	Document Type	Well Name	Sent Certified Return Receipt to:	Receipt No.
5/17/2016	AA	Off Lease Measurement	Ice Dancer 30 Federal Com #2H	The Allar Company PO Box 1567, Graham TX 76450-7567	70133020000087500000
5/17/2016	AA	Off Lease Measurement	Ice Dancer 30 Federal Com #2H	Curtis A And Edna Anderson 9314 Cherry Brook Ln, Frisco, TX 75033	70133020000087500217
5/17/2016	AA	Off Lease Measurement	Ice Dancer 30 Federal Com #2H	BAGAM LTD PO Box 900 Graham, TX 76450	70133020000087500231
5/17/2016	AA	Off Lease Measurement	Ice Dancer 30 Federal Com #2H	Bob Herrell Operating LP 3600 Meadowside Midland, TX 79707	70133020000087500248
5/17/2016	AA	Off Lease Measurement	Ice Dancer 30 Federal Com #2H	Bill Burton 301 Commerce St STE 2900 Fort Worth, TX 76102	70133020000087500255
5/17/2016	AA	Off Lease Measurement	Ice Dancer 30 Federal Com #2H	Ben J Fortson Jr 301 Commerce St Ste 2900 Fort Worth TX 76102	70133020000087500262
5/17/2016	AA	Off Lease Measurement	Ice Dancer 30 Federal Com #2H	Chase Oil Corporation PO Box 1757 Artesia, NM 88210	70133020000087500279
5/17/2016	AA	Off Lease Measurement	Ice Dancer 30 Federal Com #2H	Conoco Phillips Company 22295 Network Place Chicago IL 60673-1222	70133020000087500286
5/17/2016	AA	Off Lease Measurement	Ice Dancer 30 Federal Com #2H	Collins and Ware 508 W Wall Ave Ste 1200 Midland, TX 79701	70133020000087500293
5/17/2016	AA	Off Lease Measurement	Ice Dancer 30 Federal Com #2H	Ben J Fortson Jr 301 Commerce St Ste 2900 Fort Worth TX 76102	70133020000087500309
5/17/2016	AA	Off Lease Measurement	Ice Dancer 30 Federal Com #2H	FFF Inc PO Box 8874 Denver, CO 80201	70133020000087500316
5/17/2016	AA	Off Lease Measurement	Ice Dancer 30 Federal Com #2H	Ben J Fortson III Children Trust PO Box 29 Fort Worth, TX 76101	70133020000087500323
5/17/2016	AA	Off Lease Measurement	Ice Dancer 30 Federal Com #2H	Robert C Grable 201 Main St Ste 2500 Fort Worth, TX 76102	70133020000087500330
5/17/2016	AA	Off Lease Measurement	Ice Dancer 30 Federal Com #2H	Alan R Hannifin PO Box 8874 Denver, CO 80201	70133020000087500347
5/17/2016	AA	Off Lease Measurement	Ice Dancer 30 Federal Com #2H	Shawn and Frances Hannifin, 730 17th St Ste 325 Denver CO 80202	70133020000087500354
5/17/2016	AA	Off Lease Measurement	Ice Dancer 30 Federal Com #2H	Ben J Fortson Jr 301 Commerce St Ste 2900 Fort Worth TX 76102	70133020000087500415
5/17/2016	AA	Off Lease Measurement	Ice Dancer 30 Federal Com #2H	MW Oil Investment Co Inc 740 17th St Ste 325 Denver CO 80202	70133020000087500422
5/17/2016	AA	Off Lease Measurement	Ice Dancer 30 Federal Com #2H	LE Opperman 1505 Neerly Ave Midland, TX 79705	70133020000087501894
5/17/2016	AA	Off Lease Measurement	Ice Dancer 30 Federal Com #2H	RBM Company 2201 N Palm St Little Rock AR 72207	70133020000087501900
5/17/2016	AA	Off Lease Measurement	Ice Dancer 30 Federal Com #2H	Ricks Exploration II LP 3000 Oklahoma Tower 210 Parks Ave OKC OK 73102	70133020000087501917
5/17/2016	AA	Off Lease Measurement	Ice Dancer 30 Federal Com #2H	The Roach Foundation Ft Worth Club Tower Pen II-J 777 Taylor ST Ft Worth TX 76102	70133020000087501924
5/17/2016	AA	Off Lease Measurement	Ice Dancer 30 Federal Com #2H	S.B. Street and Co Box 206 Graham, TX 76450	70133020000087501931
5/17/2016	AA	Off Lease Measurement	Ice Dancer 30 Federal Com #2H	Thomas R Smith 5705 Pinehurst Farmington, NM 87402	70133020000087501948
5/17/2016	AA	Off Lease Measurement	Ice Dancer 30 Federal Com #2H	Sundance Minerals PO Box 1744 Fort Worth, TX 76102	70133020000087501955
5/17/2016	AA	Off Lease Measurement	Ice Dancer 30 Federal Com #2H	Moon Royalty PO Box 720070 OKC OK 73172	70133020000087500408
5/17/2016	AA	Off Lease Measurement	Ice Dancer 30 Federal Com #2H	Steven Massey 3825 Bee Caves Rd Austin, TX 78746	70133020000087500392
5/17/2016	AA	Off Lease Measurement	Ice Dancer 30 Federal Com #2H	Kimbell Art Foundation 301 Commerce St Ste 2900 Fort Worth TX 76102	70133020000087500385
5/17/2016	AA	Off Lease Measurement	Ice Dancer 30 Federal Com #2H	KCM Company Drawer 10646 Midland, TX 79702-7646	70133020000087500378
5/17/2016	AA	Off Lease Measurement	Ice Dancer 30 Federal Com #2H	H M Bettis Inc PO Box 1240 Graham, TX 76046	70133020000087500361
5/17/2016	AA	Off Lease Measurement	Ice Dancer 30 Federal Com #2H	Annette O Wambaugh 6203 Alden Bridge Rd The Woodlands, TX 77382	70133020000087501962
5/17/2016	AA	Off Lease Measurement	Ice Dancer 30 Federal Com #2H	WT Boyle and Co Box 57 Graham, TX 76450	70133020000087501979
5/17/2016	AA	Off Lease Measurement	Ice Dancer 30 Federal Com #2H	Map 98 PO Box 268988 OKC OK 73126	70133020000087501986
5/17/2016	AA	Off Lease Measurement	Ice Dancer 30 Federal Com #2H	Map 98 B PO Box 268984 OKC OK 73126	70133020000087501993
5/17/2016	AA	Off Lease Measurement	Ice Dancer 30 Federal Com #2H	Sonic Minerals LP PO Box 1240 Graham, TX 76450	70133020000087502006
5/17/2016	AA	Off Lease Measurement	Ice Dancer 30 Federal Com #2H	Map OO Net C/O Mineral Acquisition Partnership PO Box 268946 OKC OK 73126	70133020000087502020
5/17/2016	AA	Off Lease Measurement	Ice Dancer 30 Federal Com #2H	Stovall Energy LTD PO Box 10 Graham, TX 76450	70133020000087502013
5/17/2016	AA	Off Lease Measurement	Ice Dancer 30 Federal Com #2H	S & E Royalty LLC 8470 W 4th Ave Lakewood, CO 80226	70133020000087502037
5/17/2016	AA	Off Lease Measurement	Ice Dancer 30 Federal Com #2H	Khody Land and Minerals Company One Williams Center Tulsa, OK 74172	70133020000087502044
5/17/2016	AA	Off Lease Measurement	Ice Dancer 30 Federal Com #2H	Gunn Family Properties PO Box 1298 Graham TX 76450	70133020000087502051
5/17/2016	AA	Off Lease Measurement	Ice Dancer 30 Federal Com #2H	Exxon Mobile Corporation PO Box 731917 Dallas, TX 75373	70133020000087502068
5/17/2016	AA	Off Lease Measurement	Ice Dancer 30 Federal Com #2H	Michelle Sandoval 1359 Ravenn Ct Encinitas, CA 92024	70133020000087502075

ICE DANCER 30 FEDERAL COM 2H WELL
SWSE SECTION 30, T23S, R30E, UNIT 0
EDDY COUNTY, NM

WELLS:
ICE DANCER 30 FEDERAL COM #002H: 30-015-39473

Production Phase - Oil Tank #1
- Valve 1 open
- Valves 2, 3, and 4 closed
- Valves 5, 6, 7, and 8 open
- Valves 9, 10, 11, and 12 closed
- Valve 13 open
- Valves 14, 15, and 16 closed

Sales Phase - Oil Tank #1
- Valve 1 closed
- Valves 2, 3, or 4 open
- Valve 5 closed
- Valves 6, 7, and 8 open
- Valve 9 open
- Valves 10, 11, and 12 closed
- Valve 13 closed
- Valves 14, 15, or 16 open

ICE DANCER 30
FED COM 2H WELL

OVERFLOW TANK

COMP 1431P

COMP 2151P

BC

GL

GAS METER
Gas Up Meter
#45522742

PROD SEP 21P

TO DCP GAS SALES LINE
METER #74512-00 LOCATED:
FEDERAL LEASE # MNM - 081622
NENE SECTION 30, T23S, R30E, UNIT 1

COG Operating LLC
Site Security Plans Located At:
One Concho Center
600 W. Illinois Ave.
Midland, TX 79701

FROM ICE DANCER 30 FED COM
17H BATTERY LOCATED:
FED LEASE # MNM - 092180
NENE SEC 31, T23S, R30E, UNIT A

TO ICE DANCER 30 FED COM
17H BATTERY LOCATED:
FED LEASE # MNM - 092180
NENE SEC 31, T23S, R30E, UNIT A



ICE DANCER 30
FED COM 2H WELL

Ledger for Site Diagram
Produced Fluid: _____
Produced Oil: _____
Produced Gas: _____
Produced Water: _____

NOTES:

Type of Lease: Federal
Federal Lease #: MNM - 081622 (Well Location)
Property Code: 38857 (Well Location) / 301072 (Bty Location)
OGRID #: 229137

CONCHO OPERATING LLC
803 WEST LUMBER AVENUE
MIDLAND, TEXAS 79701

CONCHO OPERATING LLC
803 WEST LUMBER AVENUE
MIDLAND, TEXAS 79701

CONCHO OPERATING LLC
803 WEST LUMBER AVENUE
MIDLAND, TEXAS 79701

CONCHO OPERATING LLC
803 WEST LUMBER AVENUE
MIDLAND, TEXAS 79701

CONCHO OPERATING LLC
803 WEST LUMBER AVENUE
MIDLAND, TEXAS 79701

CONCHO OPERATING LLC
803 WEST LUMBER AVENUE
MIDLAND, TEXAS 79701

CONCHO OPERATING LLC
803 WEST LUMBER AVENUE
MIDLAND, TEXAS 79701

ICE DANCER 30 FEDERAL COM 2H BATTERY
LOCATED: GOLD RUSH 31 FED #1 WELL PAD
NENE SECTION 31, T23S, R30E, UNIT A
EDDY COUNTY, NM

WELLS:
ICE DANCER 30 FEDERAL COM #002H: 30-015-39473

Production Phase - Oil Tank #1

- Valve 1 open
- Valves 2, 3, and 4 closed
- Valves 5, 6, 7, and 8 open
- Valves 9, 10, 11, and 12 closed
- Valve 13 open
- Valves 14, 15, and 16 closed

Sales Phase - Oil Tank #1

- Valve 1 closed
- Valves 2, 3, or 4 open
- Valve 5 closed
- Valves 6, 7, and 8 open
- Valve 9 open
- Valves 10, 11, and 12 closed
- Valve 13 closed
- Valves 14, 15, or 16 open

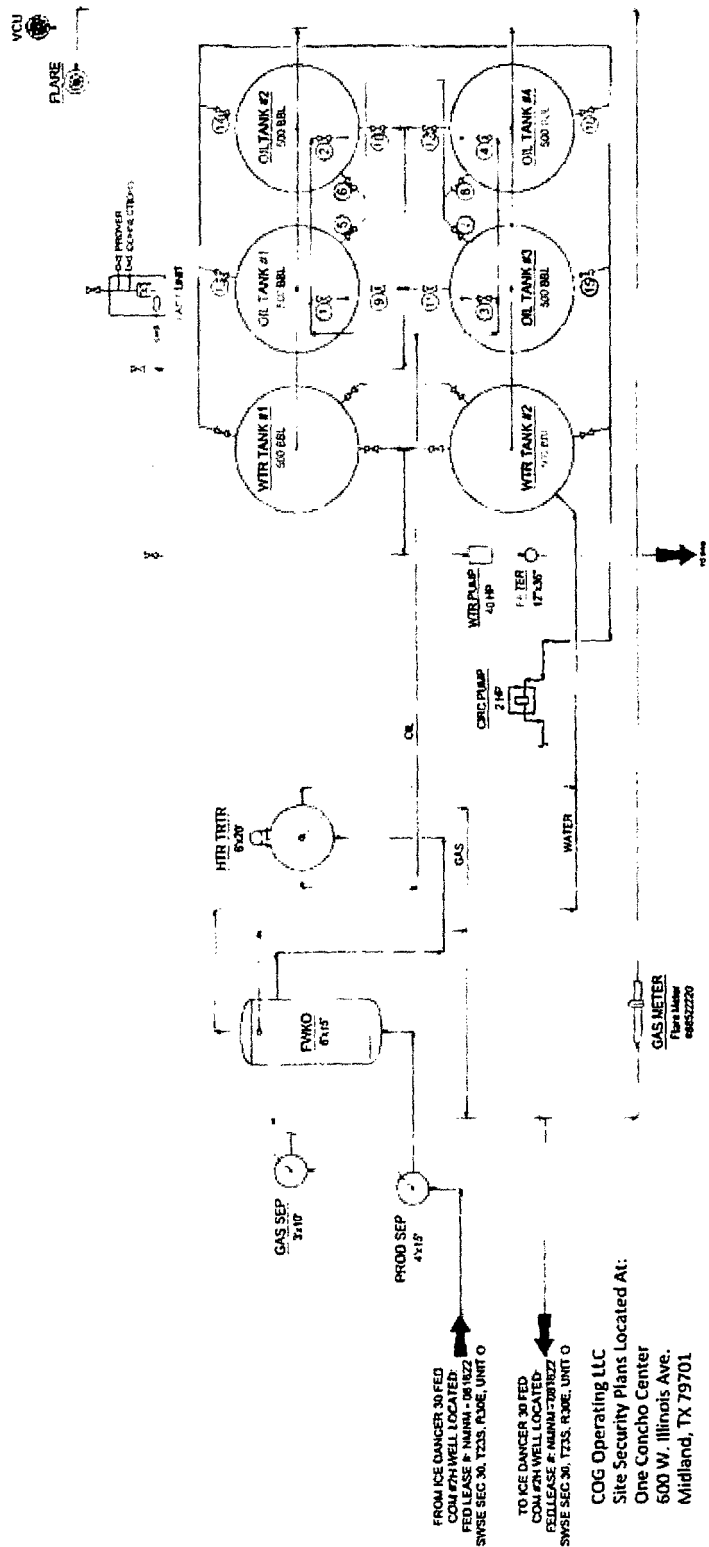

Ledger for Site Diagram

Produced Fluid:	_____
Produced Oil:	_____
Produced Gas:	_____
Produced Water:	_____

[illegible]

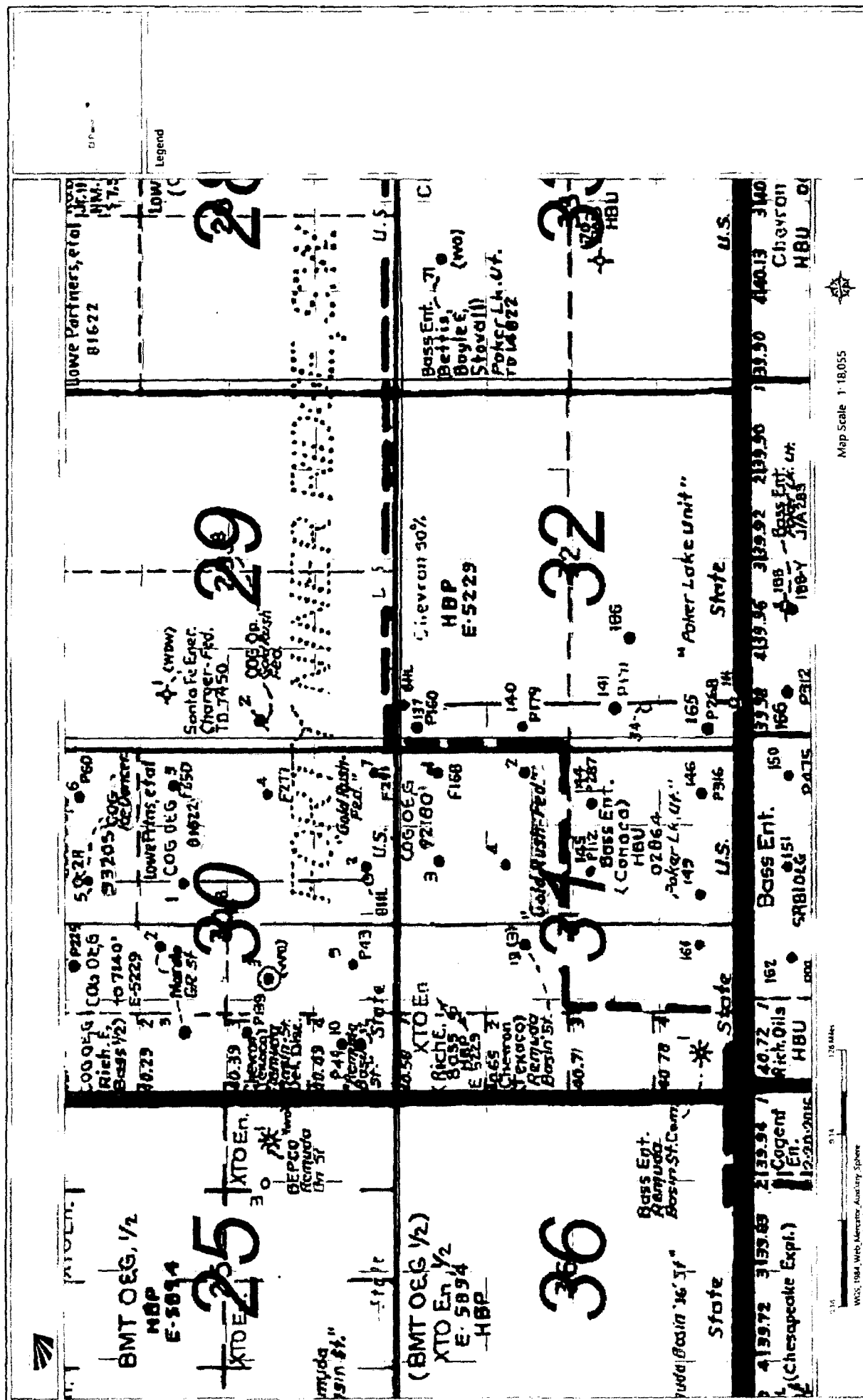

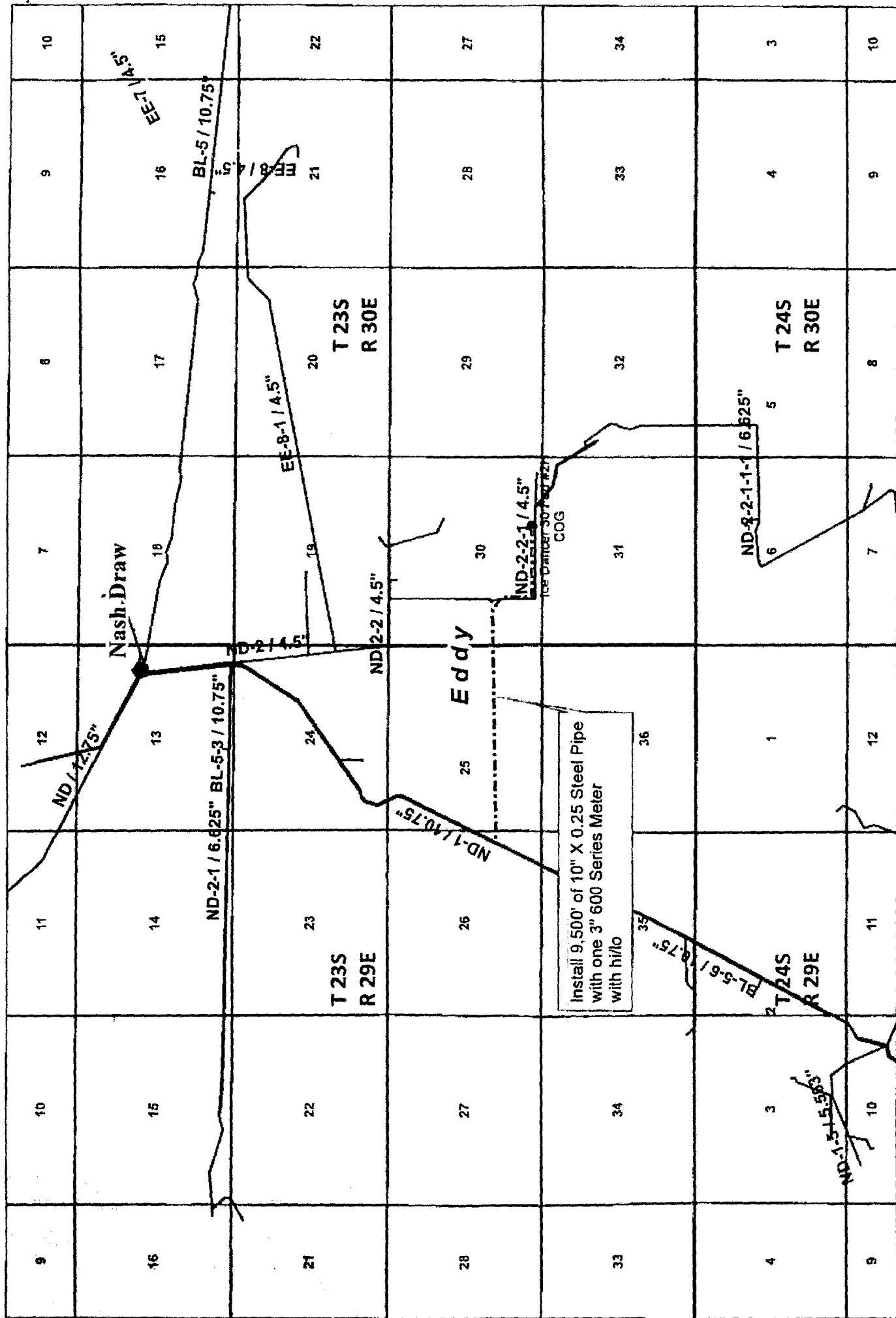

COG - Ice Dancer 30 Fed #2H
 475' FSL & 1980' FEL
 Sec 30 - T23S - R30E, Eddy Co., NM
 Date: 6/2/15

1 in = 4,167 ft

**Bureau of Land Management
Carlsbad Field Office
620 East Greene Street
Carlsbad, New Mexico 88220
575-234-5972**

**Off-Lease Measurement and Sales
Conditions of Approval**

**COG Operating LLC
Ice Dancer 30 Federal 2H
3001539473, Lease-NM81622**

Approval of off-lease measurement is subject to the following conditions of approval:

1. This agency shall be notified of any change in sales method or location of the Sales point.
2. This agency shall be notified of any spill or discharge as required by NTL-3A. No gas may be vented/flared without proper measurement and prior approval. Any gas vented must be flared.
3. This agency reserves the right to modify or rescind approval whenever it determines continued use of the approved method may adversely affect the surface or subsurface environments and/or product accountability.
4. This approval is subject to like approval by the New Mexico Oil Conservation Division.
5. Additional wells and/or leases require additional approvals.
6. This approval does not constitute right-of-way approval for any off-lease activities. Within 30 days, an application for right-of-way approval must be submitted to the Realty Section if not already done.
7. Approval for off-lease from various sources is a privilege which is granted to lessees/operators for the purpose of aiding conservation and extending the economic life of leases. Applicants should be cognizant that failure to operate in accordance with the provisions outlined in the Authorized Officer's conditions of approval and/or subsequent stipulations or modifications will subject such approval to revocation.