

MAR 01 2017 State of New Mexico
Energy, Minerals & Natural Resources Department
OIL CONSERVATION DIVISION
RECEIVED 1220 South St. Francis Dr.
Santa Fe, NM 87505

☒ **AMENDED REPORT**

District I
1625 N. French Dr., Hobbs, NM 88240
Phone: (575) 393-6161 Fax: (575) 393-0720

District II
811 S. First St., Artesia, NM 88210
Phone: (575) 748-1283 Fax: (575) 748-9720

District III
1000 Rio Brazos Road, Aztec, NM 87410
Phone: (505) 334-6178 Fax: (505) 334-6170

District IV
1220 S. St. Francis Dr., Santa Fe, NM 87505
Phone: (505) 476-3460 Fax: (505) 476-3462

API Number 30-015-43844		Pool Code 98220	Pool Name Purple Sage Wolfcamp
Property Code 39668	Property Name CEDAR CANYON "16" STATE		Well Number 33H
OGRID No. 16696	Operator Name OXY USA INC.		Elevation 2927.3'

UL or lot no.	Section	Township	Range	Lot Idn	Feet from the	North/South line	Feet from the	East/West line	County
A	16	24 SOUTH	29 EAST, N.M.P.M.		402'	NORTH	1123'	EAST	EDDY

UL or lot no.	Section	Township	Range	Lot Idn	Feet from the	North/South line	Feet from the	East/West line	County
0	16	24 SOUTH	29 EAST, N.M.P.M.		180' 178'	SOUTH	1700' 1665'	EAST	EDDY
Dedicated Acres	Joint or Infill	Consolidation Code	Order No.	Bottom Reef - 354 FSL 1670 FEL Top Reef - 498 FNL 1679 FEL					
160	N								

Y=445651.80 US FT 50' Y=445659.50 US FT
X=606482.72 US FT X=607805.43 US FT

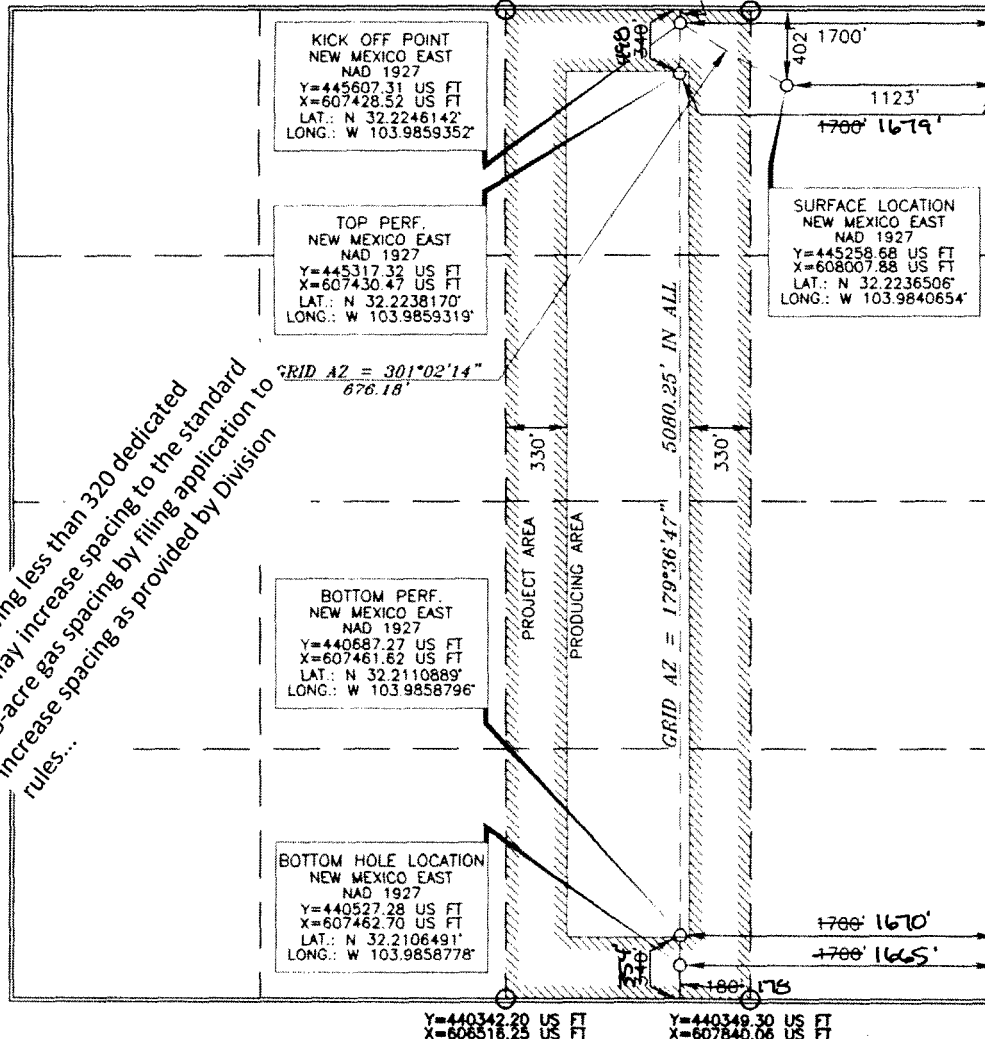

I hereby certify that the information contained herein is true and complete to the best of my knowledge and belief, and that this organization either owns a working interest or unleased mineral interest in the land including the proposed bottom hole location or has a right to drill this well at this location pursuant to a contract with an owner of such a mineral or working interest, or is a voluntary pooling agreement or a compulsory pooling order heretofore ~~passed~~ by the division.

Signature David Stewart Date 2/27/17
Printed Name David Stewart SR. Reg. Adm.
E-mail Address david_stewart@oxp.com

I hereby certify that the well location shown on this plat was plotted from field notes of actual surveys made by me or under my supervision, and that the same is true and correct to the best of my belief.

15079
APRIL 19, 2016
Date of Survey

Signature and Seal of Professional Surveyor

Terry J. Paul 5/23/2016
Certificate Number 15079

WO# 160419WL-a-XY (KA)