

UNITED STATES
DEPARTMENT OF THE INTERIOR
BUREAU OF LAND MANAGEMENT**Carlsbad Field Office**
OCD ArtesiaFORM APPROVED
OMB NO. 1004-0137
Expires: January 31, 2018**SUNDRY NOTICES AND REPORTS ON WELLS**
*Do not use this form for proposals to drill or to re-enter an abandoned well. Use form 3160-3 (APD) for such proposals.*5. Lease Serial No.
NMNM89052

6. If Indian, Allottee or Tribe Name

7. If Unit or CA/Agreement, Name and/or No.

8. Well Name and No.
APACHE 25 FED 69. API Well No.
30-015-2989410. Field and Pool or Exploratory Area
QUAHADA RDIGE, DELAWARE, SE11. County or Parish, State
EDDY COUNTY, NM**SUBMIT IN TRIPLICATE - Other instructions on page 2**

1. Type of Well

☒ Oil Well ☐ Gas Well ☐ Other

2. Name of Operator

DEVON ENERGY PRODUCTION CO. LP

Contact: ERIN WORKMAN

E-Mail: Erin.workman@devn.com

3a. Address

33E WEST SHERIDAN AVE
OKC, OK 73102

3b. Phone No. (include area code)

Ph: 405-552-7970

4. Location of Well (Footage, Sec., T., R., M., or Survey Description)

Sec 25 T22S R30E Mer NMP SESE 330FSL 330FEL

12. CHECK THE APPROPRIATE BOX(ES) TO INDICATE NATURE OF NOTICE, REPORT, OR OTHER DATA

TYPE OF SUBMISSION	TYPE OF ACTION			
<input checked="" type="checkbox"/> Notice of Intent	<input type="checkbox"/> Acidize	<input type="checkbox"/> Deepen	<input type="checkbox"/> Production (Start/Resume)	<input type="checkbox"/> Water Shut-Off
<input type="checkbox"/> Subsequent Report	<input type="checkbox"/> Alter Casing	<input type="checkbox"/> Hydraulic Fracturing	<input type="checkbox"/> Reclamation	<input type="checkbox"/> Well Integrity
<input type="checkbox"/> Final Abandonment Notice	<input type="checkbox"/> Casing Repair	<input type="checkbox"/> New Construction	<input type="checkbox"/> Recomplete	<input checked="" type="checkbox"/> Other
	<input type="checkbox"/> Change Plans	<input type="checkbox"/> Plug and Abandon	<input type="checkbox"/> Temporarily Abandon	
	<input type="checkbox"/> Convert to Injection	<input type="checkbox"/> Plug Back	<input type="checkbox"/> Water Disposal	

13. Describe Proposed or Completed Operation: Clearly state all pertinent details, including estimated starting date of any proposed work and approximate duration thereof. If the proposal is to deepen directionally or recompleat horizontally, give subsurface locations and measured and true vertical depths of all pertinent markers and zones. Attach the Bond under which the work will be performed or provide the Bond No. on file with BLM/BIA. Required subsequent reports must be filed within 30 days following completion of the involved operations. If the operation results in a multiple completion or recompleat in a new interval, a Form 3160-4 must be filed once testing has been completed. Final Abandonment Notices must be filed only after all requirements, including reclamation, have been completed and the operator has determined that the site is ready for final inspection.

Devon Energy Production Company, LP is requesting to amend the PLC-311 approved on 07/30/2008. We need to add the Apache 25 Fed 17H to this PLC. It includes the following wells:

Apache 25 Fed 2
SESE, Sec. 25, T22S, R30E
30-015-27478
Quahada Ridge; Delaware, SE
NMNM 89052 (12.5%)

Apache 25 Fed 5
NESE, Sec. 25, T22S, R30E

WILM OIL CONSERVATION
ARTESIA DISTRICT

APR 27 2017

RECEIVED

14. I hereby certify that the foregoing is true and correct.

Electronic Submission #372707 verified by the BLM Well Information System
For DEVON ENERGY PRODUCTION CO., LP, sent to the Carlsbad
Committed to AFMSS for processing by DEBORAH MCKINNEY on 04/12/2017 ()

Name (Printed/Typed) ERIN WORKMAN

Title REGULATORY COMPLIANCE PROF.

Signature (Electronic Submission)

Date 04/12/2017

THIS SPACE FOR FEDERAL OR STATE OFFICE USE

Approved By

J. D. W. Rutledge

Title

TL PET

Date

4/13/17

Conditions of approval, if any, are attached. Approval of this notice does not warrant or certify that the applicant holds legal or equitable title to those rights in the subject lease which would entitle the applicant to conduct operations thereon.

Office

CFO

Title 18 U.S.C. Section 1001 and Title 43 U.S.C. Section 1212, make it a crime for any person knowingly and willfully to make to any department or agency of the United States any false, fictitious or fraudulent statements or representations as to any matter within its jurisdiction.

(Instructions on page 2)

**** OPERATOR-SUBMITTED ** OPERATOR-SUBMITTED ** OPERATOR-SUBMITTED ****

Additional data for EC transaction #372707 that would not fit on the form

32. Additional remarks, continued

30-015-32720
Quahada Ridge; Delaware, SE
NMNM 91509 (12.5%)

Apache 25 Fed 6
SESE, Sec. 25, T22S, R30E
30-015-29894
Quahada Ridge; Delaware, SE
NMNM 89052 (12.5%)

Apache 25 Fed 9
NWSE, Sec. 25, T22S, R30E
30-015-32797
Los Medanos; Bone Spring & Los Medanos; Wolfcamp, (S)
NMNM 91509 (12.5%)

Apache 25 Fed 10H
SESE, Sec. 25, T22S, R30E
30-015-35597
Quahada Ridge; Delaware, SE
NMNM 89052 (12.5%)

Apache 25 Fed 17H
NESE, Sec. 25, T22S, R30E
30-015-41116
Los Medanos; Bone Spring
NMNM ~~91509~~ (12.5%)

NM89052
The central tank battery is located at the Apache 25 Fed 6 in Sec. 25, T22S, R30E, on lease NMNM89052 in Eddy County, New Mexico. The production from the Apache 25 Fed 2, 5, 6, 9, 10H, & 17H will come into a common production header with isolation lines to route each wells production. From this point one well will be on test and its production routed through the testing equipment.

The Apache 25 Fed 6 battery will have four oil tanks that all six wells. Total oil production will be truck hauled from this location. Two common gas sales meters, Duke Energy #74086-00 and what gas DCP is not able to take, is routed to the Devon's Point of Royalty Measurement Meter #390-33-227 on location in the southwest corner of the battery. Oil, gas, and water volumes from each well producing to this battery will be determined by utilizing a test separator/heater treater at the proposed facility so that one of the wells is always producing through the testing equipment. Daily production will be allocated on a daily basis based on the most recent individual well test of oil, gas, and water. Well test for each well will be conducted at least once per month for a minimum of 24 hours.

Devon is the record title owner of the leases to be commingled and the owner of 100% WI in the commingled wells. The ownership of all interest is uniform in both leases and all of the wells involved in this application. Therefore, no additional notification should be necessary.

Attachment: Deliverables

APPLICATION FOR POOL\LEASE COMMINGLING

Proposal for the Apache 25 Fed 2, 5, 6, 9, 10H, & 17H

Devon Energy Production Company, LP is requesting to amend the PLC-311 approved on 07/30/2008. We need to add the Apache 25 Fed 17H to this PLC.

Federal Lease NMNM 89052 (12.5%)

Well Name	Location	API #	Pool	BOPD	OG	MCFPD	BTU
Apache 25 Fed 2	SESE, Sec. 25, T22S, R30E	30-015-27478	40295 Quahada Ridge; Delaware, Southeast	5	44	29	1231.8
Apache 25 Fed 6	SESE, Sec. 25, T22S, R30E	30-015-29894	50443 Quahada Ridge; Delaware, Southeast	25	46	65	1260.1
Apache 25 Fed 10H	SESE, Sec. 25, T22S, R30E	30-015-35597	50443 Quahada Ridge; Delaware, Southeast	16	45	56	1219.0
Apache 25 Fed 17H	NESE, Sec. 25, T22S, R30E	30-015-41116	40295 Los Medanos; Bone Spring	46	43	220	1319.9

Federal Lease NMNM 91509 (12.5%)

Well Name	Location	API #	Pool	BOPD	OG	MCFPD	BTU
Apache 25 Fed 5	NESE, Sec. 25, T22S, R30E	30-015-32720	50443 Quahada Ridge; Delaware, Southeast	4	42	15	1297.9

Federal Lease NMNM90990 (12.5%)

Well Name	Location	API #	Pool	BOPD	OG	MCFPD	BTU
Apache 25 Fed 9	NWSE, Sec. 25, T22S, R30E	30-015-32797	40295 Los Medanos; Bone Spring 96336 Los Medanos; Wolfcamp, (S)	11	41	29	1299.7

(Apache 25 Fed 9 Bone Spring and Wolfcamp already approved to downhole commingle, allocated 60% to Wolfcamp and 40% To Bone Spring. CA includes Federal Leases NMNM91509 & NMNM89052, which are both 12.5% Royalty Rate. Allocation to each lease is, 75% to NMNM89052 and 25% to NMNM91509.)

Attached is a map that displays the federal leases and well locations in Section 25-T23S-R31E. Although there are two leases listed above the ownership for all the wells are identical.

The BLM's interest in all five wells is 12.5%.

Oil & Gas metering:

The central tank battery is located at the Apache 25 Fed 6 in Sec. 25, T22S, R30E, on lease NMNM89052 in Eddy County, New Mexico. The production from the Apache 25 Fed 2, 5, 6, 9, 10H, & 17H will come into a common production header with isolation lines to route each wells production. From this point one well will be on test and its production routed through the testing equipment.

The Apache 25 Fed 6 battery will have four oil tanks that all six wells. Total oil production will be truck hauled from this location. Two common gas sales meters, Duke Energy #74086-00 and what gas DCP is not able to take, is routed to the Devon's Point of Royalty Measurement Meter #390-33-227 on location in the southwest corner of the battery. Oil, gas, and water volumes from each well producing to this battery will be determined by utilizing a test separator/heater treater at the proposed facility so that one of the wells is always producing through the testing equipment. Daily production will be allocated on a daily basis based on the most recent individual well test of oil, gas, and water. Well test for each well will be conducted at least once per month for a minimum of 24 hours.

The well which is on test production flows to the test separator, where after separation gas is routed to the gas test meter #390-49-037, then into a production line with other wells gas and then to Duke Energy gas sales meter #74086-00, and what gas DCP is not able to take, is routed to Devon's Point of Royalty Measurement Meter #390-33-227. Produced water and oil flow into the heater\treater where after separation, oil is metered by the Micro Motion Coriolis Meter S/N#14492141, then combines with the oil from the production heater/treater and flows to one of the 400 bbl oil tanks. The produced water is measured with a turbine meter downstream of the heater/treater, combines with the water from the production heater/treater & FWKO, then is metered with a turbine meter and flows to one of the 500 bbl water tanks.

Oil production will be allocated on a daily basis based on the Micro Motion Coriolis Test Meter located downstream of the test heater/treater. The Coriolis meter will be proven, as per API, NMOCD, and BLM specifications, when installed, once per month for the first 3 months (to establish a consistent repeatability factor), and then quarterly thereafter, the factor obtained will be used to allocate the production volumes. Gas production for these wells will be allocated on a daily basis based on the subtraction method. The DCP CDP #74086-00 or Devon's Point of Royalty Measurement #390-33-227 minus the VRU Meter #390-00-220 volumes, then subtract the test for each well's production from the gas allocation meter #390-49-037. The gas production from the production equipment, VRU allocation meter, and the test gas meter will commingle and flow through Duke Energy CDP #74086-00 or if DCP unable to take the gas production, it will flow to the Devon's Point of Royalty Measurement #390-33-227. These meters will be calibrated on a regular basis per API, NMOCD and BLM specifications. The BLM and OCD will be notified of any future changes in the facilities.

Process and Flow Descriptions:

The flow of produced fluids is shown in detail on the enclosed facility diagram, along with a description of each vessel and map which shows the lease boundaries, location of wells, facility, and gas sales meter. The proposed commingling is appropriate based on the BLM's guidance in IM 2013-152. The proposed commingling will maximize the ultimate recovery of oil and/or gas from the federal leases and will reduce environmental impacts by minimizing surface disturbance and emissions. The proposed commingling will reduce operating expenses, as well as, not adversely affect federal royalty income, production accountability, or the distribution of royalty.

Devon is the record title owner of the leases to be commingled and the owner of 100% WI in the commingled wells. The ownership of all interest is uniform in both leases and all of the wells involved in this application. Therefore, no additional notification should be necessary.

Signed:  _____

Printed Name: Erin Workman

Title: Regulatory Compliance Professional

Date: 04/11/2017

Apache 25 Fed 6 Battery Sec. 25-T22S-R30E 330 FSL & 330 FEL Eddy, NM API 30-015-29894	Open
Production System:	Open
Oil sales by tank gauge to tank truck.	
Seal requirements:	
Production Phase: On all Tanks.	
1) All valves 5 sealed closed.	
Sales Phase: On Tank being hauled.	
1) Valve 1 sealed closed.	1
2) Valve 3 sealed closed.	2
3) Valve 4 sealed closed.	3
4) Valve 5 sealed closed.	4
(5) Misc. Valves: Plugged or otherwise inaccessible.	
NOTE: Valve 2 is either a test or roll line if there is a valve 2 it will be sealed closed.	
Ladder for Site Diagram	
Valve #1: Production Line	1
Valve #2: Test or Roll Line	2
Valve #3: Equalizer Line	3
Valve #4: Circ./Drain Line	4
Valve #5: Sales Line	5
Valve #6: BS&W Load Line	6
Gas Line:	
Firewall:	
Wellhead:	Stak-pak
Stak-pak:	
Production line:	
Water line:	
Gas Meter	
Oil Line	

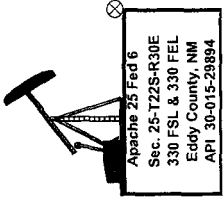
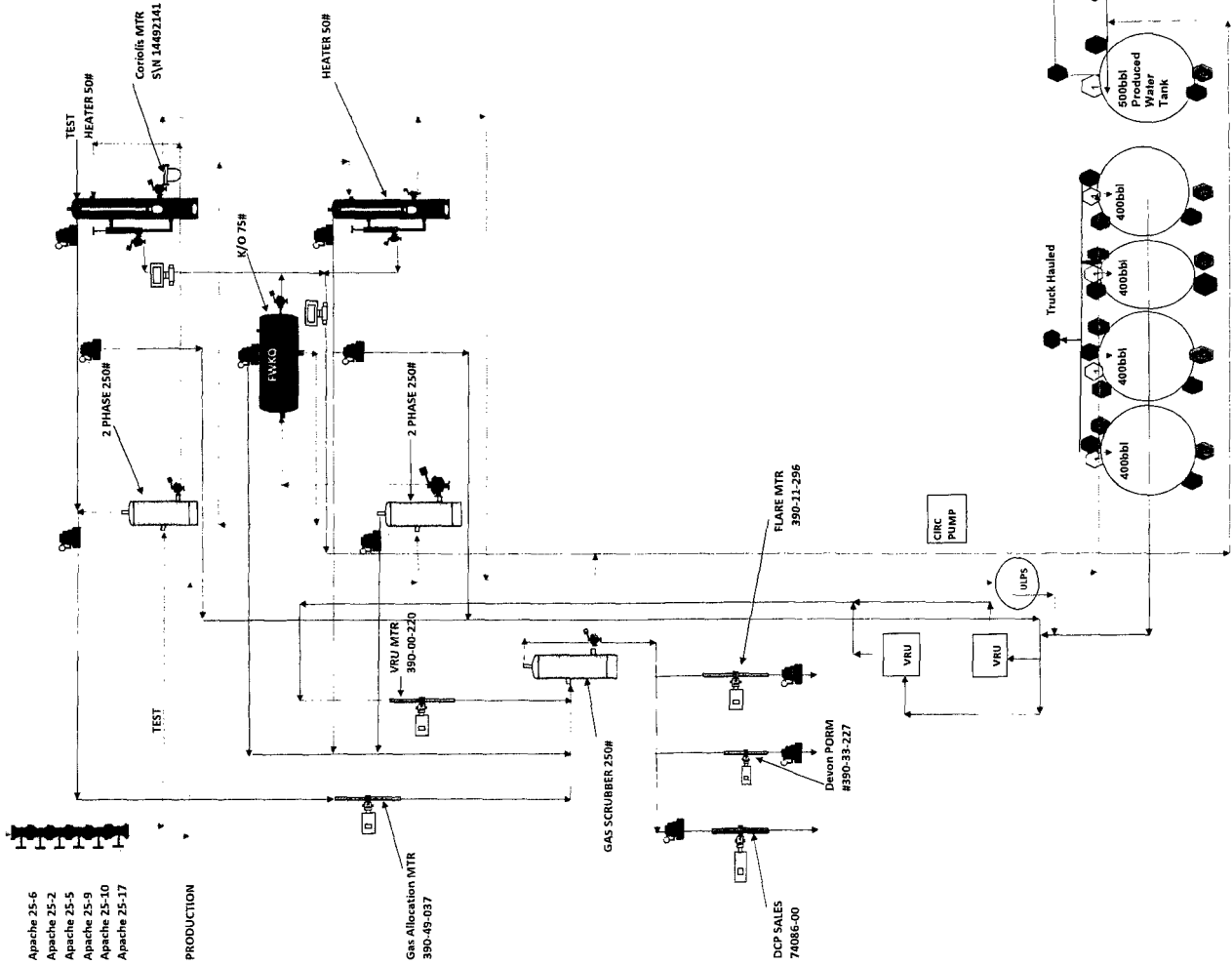

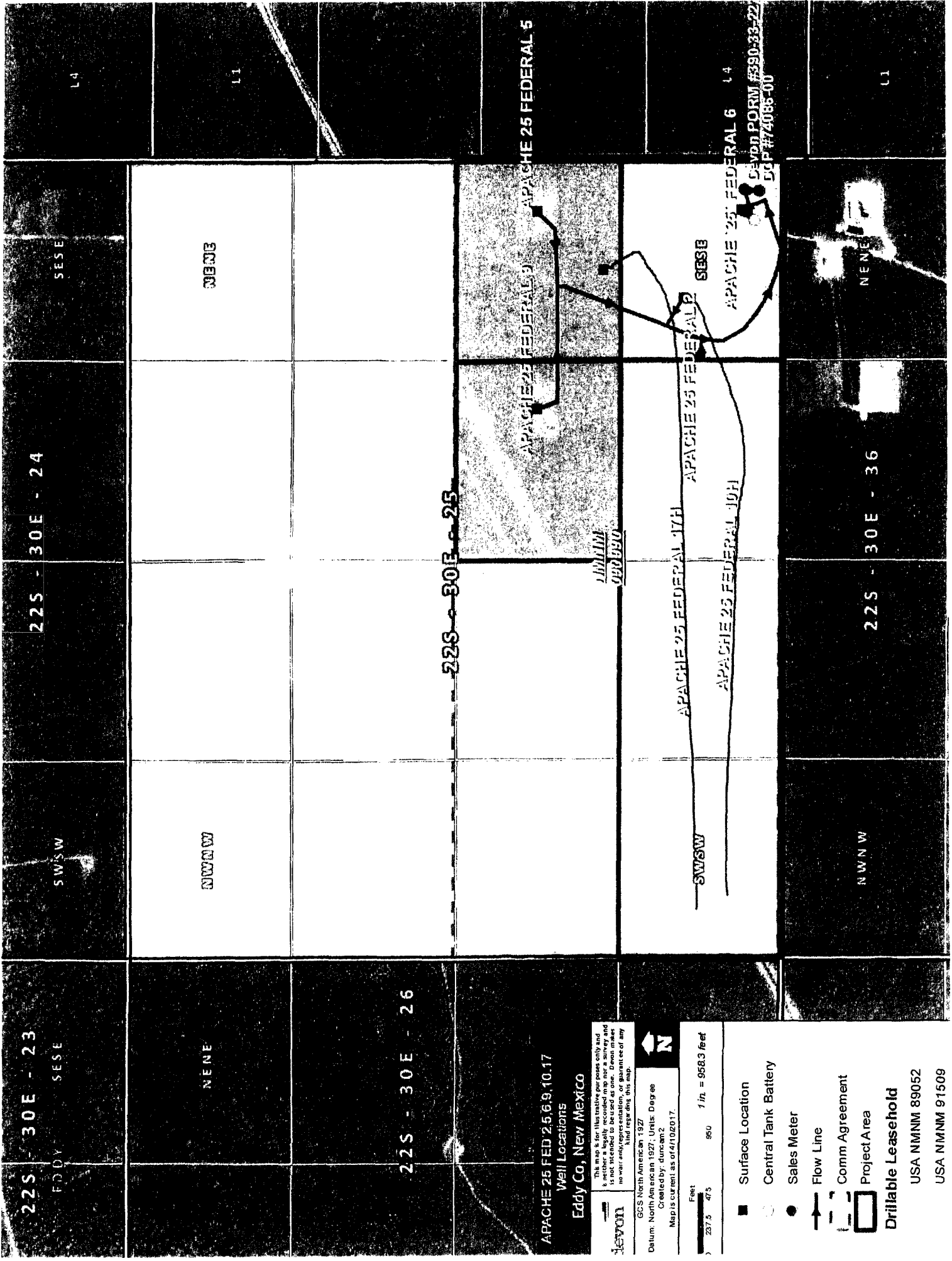

APACHE 25 FED 2,5,6,9,10,17
Well Locations
Eddy Co, New Mexico

This map is for informational purposes only and is neither a legally recorded map nor a warranty. It is not intended to be used as one. Deacon makes no warranty, representation, or guarantee of any kind regarding this map.

GCS North American 1927
Datum: North American 1927; Units: Degrees
Created by: duncam2
Map is current as of 4/10/2017.

Feet
1 in. = 958.3 feet
237.5 475 950

- Surface Location
 - Central Tank Battery
 - Sales Meter
 - Flow Line
 - Comm Agreement
 - Project Area
 - Drillable Leasehold
- USA NMNM 89052
USA NMNM 91509

**DEPARTMENT OF THE INTERIOR
BUREAU OF LAND MANAGEMENT
CASE RECORDATION
(MASS) Serial Register Page**

Run Time: 01:44 PM

Page 1 of 2

Run Date: 05/21/2014

01 12-22-1987;101STAT1330;30USC181 ET SE

Total Acres

Serial Number

Case Type 312021: O&G LSE COMP PD -1987

560.000

NMNM-- - 089052

Commodity 459: OIL & GAS L

Case Disposition: AUTHORIZED

Serial Number: NMNM-- - 089052

Name & Address	Int Rel	% Interest
DEVON ENERGY PROD CO LP 333 W SHERIDAN AVE OKLAHOMA CITY OK 731025010	LESSEE	100.000000000

Serial Number: NMNM-- - 089052

Mer Twp	Rng	Sec	STyp	SNr Suff	Subdivision	District/Field Office	County	Mgmt Agency
23	0220S	0300E	025	ALIQ	N2,SW,S2SE;	CARLSBAD FIELD OFFICE	EDDY	BUREAU OF LAND MGMT

Serial Number: NMNM-- - 089052

Act Date	Code	Action	Action Remark	Pending Office
08/27/1982	909	BOND ACCEPTED	EFF 07/16/82;CO0042	
04/21/1992	387	CASE ESTABLISHED	9204082	
04/22/1992	191	SALE HELD		
04/22/1992	267	BID RECEIVED	\$355600.00;	
04/22/1992	392	MONIES RECEIVED	\$1120.00;	
04/30/1992	392	MONIES RECEIVED	\$354480.00;	
05/27/1992	237	LEASE ISSUED		
05/27/1992	974	AUTOMATED RECORD VERIF	AR/LR	
06/01/1992	496	FUND CODE	05;145003	
06/01/1992	530	RLTY RATE - 12 1/2%		
06/01/1992	868	EFFECTIVE DATE		
07/07/1992	600	RECORDS NOTED		
12/03/1992	575	APD FILED	MITCHELL ENERGY; BM	
12/18/1992	575	APD FILED	MITCHELL ENERGY;	
04/05/1993	111	RENTAL RECEIVED	\$840.00;21/40320	
04/06/1993	575	APD FILED	APACHE 25 FED #1; BM	
06/11/1993	576	APD APPROVED	#2 APACHE 25 FED;	
09/22/1993	246	LEASE COMMITTED TO CA	NMNM90990;	
10/27/1993	575	APD FILED	MITCHELL ENERGY CORP	
12/02/1993	575	APD FILED	MITCHELL ENERGY CORP	
12/16/1993	575	APD FILED	MITCHELL ENERGY CORP	
12/20/1993	650	HELD BY PROD - ACTUAL	NMNM90990;	
12/20/1993	974	AUTOMATED RECORD VERIF	MV/MV	
01/19/1994	576	APD APPROVED	3 APACHE 25 FED	
01/19/1994	576	APD APPROVED	4 APACHE 25 FED	
01/19/1994	576	APD APPROVED	6 APACHE 25 FED	
03/10/1994	576	APD APPROVED	10 APACHE 25 FED	
03/11/1994	576	APD APPROVED	8 APACHE 25 FED	
03/15/1994	576	APD APPROVED	7 APACHE 25 FED	
09/15/1997	575	APD FILED		
10/15/1997	576	APD APPROVED	#6 APACHE "25" FED	
05/16/2002	940	NAME CHANGE RECOGNIZED	MITCHELL/DEVON ENE	
01/27/2003	140	ASGN FILED	DEVON/DEVON ENE PROD	
02/26/2003	139	ASGN APPROVED	EFF 02/26/03;	
02/26/2003	974	AUTOMATED RECORD VERIF	ANN	

**DEPARTMENT OF THE INTERIOR
BUREAU OF LAND MANAGEMENT
CASE RECORDATION
(MASS) Serial Register Page**

Run Time: 01:53 PM

Page 1 of 1

Run Date: 05/21/2014

01 12-22-1987;101STAT1330;30USC181 ET SE

Total Acres
80.000

Serial Number
NMNM-- - 091509

Case Type 312021: O&G LSE COMP PD -1987

Commodity 459: OIL & GAS L

Case Disposition: AUTHORIZED

Serial Number: NMNM-- - 091509

Name & Address	Int Rel	% Interest
DEVON ENERGY PROD CO LP 333 W SHERIDAN AVE OKLAHOMA CITY OK 731025010	LESSEE	100.000000000

Serial Number: NMNM-- - 091509

Mer Twp	Rng	Sec	STyp	SNr Suff	Subdivision	District/Field Office	County	Mgmt Agency
23	0220S	0300E	025	ALIQ	N2SE;	CARLSBAD FIELD OFFICE	EDDY	BUREAU OF LAND MGMT

Serial Number: NMNM-- - 091509

Act Date	Code	Action	Action Remark	Pending Office
07/20/1993	387	CASE ESTABLISHED	9307093	
07/21/1993	191	SALE HELD		
07/21/1993	267	BID RECEIVED	\$128000.00;	
07/21/1993	392	MONIES RECEIVED	\$160.00;	
07/29/1993	392	MONIES RECEIVED	\$127840.00;	
08/25/1993	237	LEASE ISSUED		
08/25/1993	974	AUTOMATED RECORD VERIF	AR/LBO	
09/01/1993	496	FUND CODE	05;145003	
09/01/1993	530	RLTY RATE - 12 1/2%		
09/01/1993	868	EFFECTIVE DATE		
09/03/1993	600	RECORDS NOTED		
09/22/1993	246	LEASE COMMITTED TO CA	NMNM90990;	
09/30/1993	963	CASE MICROFILMED	CNUM 570,010 PR	
10/25/1993	111	RENTAL RECEIVED	\$120.00;11/MULTIPLE	
10/27/1993	575	APD FILED	MITCHELL ENERGY CORP	
10/27/1993	651	HELD BY PROD - ALLOCATED	NMNM90990;	
10/27/1993	660	MEMO OF 1ST PROD-ALLOC	/1/NMNM90990;	
12/16/1993	575	APD FILED	MITCHELL ENERGY CORP	
12/20/1993	974	AUTOMATED RECORD VERIF	MV/MV	
01/19/1994	576	APD APPROVED	5 APACHE 25 FED	
03/11/1994	576	APD APPROVED	9 APACHE 25 FED	
05/16/2002	940	NAME CHANGE RECOGNIZED	MITCHELL/DEVON ENE	
01/27/2003	140	ASGN FILED	DEVON/DEVON	
02/27/2003	139	ASGN APPROVED	EFF 02/01/03;	
02/27/2003	974	AUTOMATED RECORD VERIF	MV	
04/09/2014	974	AUTOMATED RECORD VERIF	ANN	

Serial Number: NMNM-- - 091509

Line Nr	Remarks
---------	---------

**BUREAU OF LAND MANAGEMENT
CASE RECORDATION
(LIVE) SERIAL REGISTER PAGE**

Run Date/Time: 04/04/17 03:06 PM

Page 1 of 1

01 02-25-1920;041STAT0437;30USC181

Total Acres

Serial Number

Case Type 318310: O&G COMMUNITIZATION AGRMT

320.000

NMNM-- - 090990

Commodity 410: NATURAL GAS

Case Disposition: AUTHORIZED Case File Juris:

Serial Number: NMNM-- - 090990

Name & Address			Int Rel	%Interest
BLM ROSWELL FO	2909 W 2ND ST	ROSWELL NM 88201	OFFICE OF RECORD	0.000000000
DEVON ENERGY PROD CO LP	333 W SHERIDAN AVE	OKLAHOMA CITY OK 731025010	OPERATOR	100.000000000

Mer Twp	Rng	Sec	SType	Nr Suff	Subdivision	District/Resource Area	County	Mgmt Agency
23	0220S	0300E	025	ALIQ	S2;	CARLSBAD FIELD OFFICE	EDDY	BUREAU OF LAND MGMT

09/22/1993	387	CASE ESTABLISHED	
09/22/1993	516	FORMATION	ATOK;ATOKA
09/22/1993	516	FORMATION	MRRW06;MORROW
09/22/1993	516	FORMATION	WCAP;WOLFCAMP
09/22/1993	526	ACRES-FED INT 100%	320.00;100.00%
09/22/1993	868	EFFECTIVE DATE	/A/
09/28/1993	580	PROPOSAL RECEIVED	CA RECD
10/06/1993	334	AGRMT APPROVED	
10/12/1993	974	AUTOMATED RECORD VERIF	MO/MO
10/27/1993	654	AGRMT PRODUCING	NMNM89052,2 APACHE 25
11/08/1993	963	CASE MICROFILMED/SCANNED	CNUM 536,781
12/16/1993	600	RECORDS NOTED	
08/01/2001	940	NAME CHANGE RECOGNIZED	MITCHELL ENE CORP/LP
05/16/2002	940	NAME CHANGE RECOGNIZED	MITCHELL ENE/DEVONENE
11/17/2004	817	MERGER RECOGNIZED	DEVON OP/DEVON PROD
10/09/2007	516	FORMATION	/B/STRN06;STRAWN

Line Nr	Remarks	Serial Number: NMNM-- - 090990
0002	/A/ RECAPITULATION EFFECTIVE 09/22/1993	
0003	TR# LEASE SERIAL NO AC COMMITTED % INTEREST	
0004	1 NMNM 89052 240.00 75.0000	
0005	2 NMNM 91509 80.00 25.0000	
0006	TOTAL 320.00 100.0000	
0007	/B/AGREEMENT AMENDED TO INCLUDE THE STRAWN FORMATION	

Samuel Walker
Landman

Devon Energy Corporation
333 West Sheridan Ave.
Oklahoma City, Oklahoma 73102-8260
Office: (405) 228-4342
Fax: (405) 234-2634

June 05, 2015

New Mexico Oil Conservation Division
1220 South St. Francis Drive
Santa Fe, NM 87505

Re: Well Commingle
Section 6-T25S-R32E
Lea County, NM

Gentlemen:

Devon Energy Production Company, L.P. ("Devon") recently reviewed its files covering the ownership of the following wells and has determined that the ownership of the working interest, royalty interest and overriding royalty interest in the following wells are uniform with respect to Devon's application for Well Comingling:

Apache 25 Fed 2	API: 30-015-27478
Apache 25 Fed 5	API: 30-015-32720
Apache 25 Fed 6	API: 30-015-29894
Apache 25 Fed 9	API: 30-015-32797
Apache 25 Fed 10H	API: 30-015-35597
Apache 25 Fed 17H	API: 30-015-41116

If there are any questions, or if any additional information is required, feel free to call me at (405) 228-4342.

Sincerely,

DEVON ENERGY PRODUCTION COMPANY, L.P.



Samuel Walker
Landman

**Bureau of Land Management
Carlsbad Field Office
620 East Greene Street
Carlsbad, New Mexico 88220
575-234-5972**

**Apache 25 Federal 2, 5, 6, 9, 10H, & 17H
3001527478, 3001532720, 3001529894, 3001532797, 3001535597, & 3001541116
Leases NMNM89052, NMNM91509 and CA- NMNM90990**

Devon Energy Production Company

April 13, 2017

Condition of Approval

Surface commingling, off lease storage measurement and sales.

1. This approval is subject to like approval by the New Mexico Oil Conservation Division.
2. This agency shall be notified of any spill or discharge as required by NTL-3A.
3. This agency reserves the right to modify or rescind approval whenever it determines continued use of the approved method may adversely affect the surface or subsurface environments or product accountability.
4. This approval does not constitute right-of-way approval for any off-lease activities. Within 30 days, an application for right-of-way approval must be submitted to the Realty Section if not already done.
5. Approval for combining production from various sources is a privilege which is granted to lessees for the purpose of aiding conservation and extending the economic life of leases. Applicants should be cognizant that failure to operate in accordance with the provisions outlined in the Authorized Officer's conditions of approval and/or subsequent stipulations or modifications will subject such approval to revocation.
6. Gas measurement for allocation must be measured as per Federal Regulations, AGA and API requirements for sales meters.
7. All gas and oil subject to royalty shall be measured as per federal regulations and shall be reported to ONRR as required. All gas which is vented, flared or used on lease shall be reported as per NTL-4A to ONRR. All gas which is vented or flared shall be subject to royalty, unless prior approval was given by the authorized officer.
8. This agency shall be notified of any change in sales method or location of sales point.
9. Additional wells and/or leases require additional commingling approvals.
10. Notify this office 24 Hrs. prior to any meter proving to allow time for an inspector to witness.