

District I  
1625 N. French Dr., Hobbs, NM 88240  
Phone: (575) 393-6161 Fax: (575) 393-0720  
District II  
811 S. First St., Artesia, NM 88210  
Phone: (575) 748-1283 Fax: (575) 748-9720  
District III  
1000 Rio Brazos Road, Aztec, NM 87410  
Phone: (505) 334-6178 Fax: (505) 334-6170  
District IV  
1220 S. St. Francis Dr., Santa Fe, NM 87505  
Phone: (505) 476-3460 Fax: (505) 476-3462

State of New Mexico  
Energy, Minerals & Natural Resources Department  
OIL CONSERVATION DIVISION  
1220 South St. Francis Dr.  
Santa Fe, NM 87505

Form C-102  
Revised August 1, 2011  
Submit a copy to appropriate District Office  
JAN 16 2018  
☐ AMENDED REPORT

RECEIVED  
WELL LOCATION AND ACREAGE DEDICATION PLAT

<sup>1</sup> API Number <b>30-015-44627</b>	<sup>2</sup> Pool Code <b>98220</b>	<sup>3</sup> Pool Name <b>PURPLE SAGE; WOLFCAMP</b>
<sup>4</sup> Property Code <b>320615</b>	<sup>5</sup> Property Name <b>GRAVEL GRINDER FEE 23-28-18 WXY</b>	<sup>6</sup> Well Number <b>3H</b>
<sup>7</sup> OGRID No. <b>372098</b>	<sup>8</sup> Operator Name <b>MARATHON OIL PERMIAN LLC</b>	<sup>9</sup> Elevation <b>3080'</b>

<sup>10</sup> Surface Location

UL or lot no.	Section	Township	Range	Lot Idn	Feet from the	North/South line	Feet from the	East/West line	County
M (LOT 4)	18	T23S	R28E		353	SOUTH	1265	WEST	EDDY

<sup>11</sup> Bottom Hole Location If Different From Surface

UL or lot no.	Section	Township	Range	Lot Idn	Feet from the	North/South line	Feet from the	East/West line	County
D (LOT 1)	18	T23S	R28E		330	NORTH	330	WEST	EDDY

<sup>12</sup> Dedicated Acres	<sup>13</sup> Joint or Infill	<sup>14</sup> Consolidation Code	<sup>15</sup> Order No.
317.40			

No allowable will be assigned to this completion until all interests have been consolidated or a non-standard unit has been approved by the division.

<p><sup>16</sup></p> <p>SECTION 12 SECTION 13 SECTION 18 SECTION 19 SECTION 24 SECTION 27 SECTION 28 SECTION 7 SECTION 8 SECTION 17 SECTION 18 SECTION 19 SECTION 20</p> <p>LAST TAKE POINT/BOTTOM HOLE LOCATION 330' FSL 330' FWL, SECTION 18 NAD 83, SPCS NM EAST X:602924.26' / Y:477195.60' LAT:32.31172612N / LDNM04.13398147W NAD 27, SPCS NM EAST X:561741.88' / Y:477136.45' LAT:32.31160622N / LDNM04.13348392W</p> <p>FIRST TAKE LOCATION 330' FSL 330' FWL, SECTION 18 NAD 83, SPCS NM EAST X:602875.67' / Y:472529.52' LAT:32.29889999N / LDNM04.13416682W NAD 27, SPCS NM EAST X:561693.18' / Y:472470.49' LAT:32.29878001N / LDNM04.13366968W</p> <p>SURFACE HOLE LOCATION 353' FSL 1265' FWL, SECTION 18 NAD 83, SPCS NM EAST X:603810.69' / Y:472556.63' LAT:32.29896970N / LDNM04.13114049W NAD 27, SPCS NM EAST X:562628.19' / Y:472497.59' LAT:32.29884967N / LDNM04.13064347W</p> <p>CORNER COORDINATES NAD 83, SPCS NM EAST A - Y: 477528.37' / X: 602595.57' B - Y: 477508.83' / X: 605148.50' C - Y: 472208.49' / X: 605187.51' D - Y: 472198.23' / X: 602542.35'</p> <p>CORNER COORDINATES NAD 27, SPCS NM EAST A - Y: 477469.22' / X: 561413.20' B - Y: 477449.65' / X: 563966.09' C - Y: 472149.44' / X: 564004.98' D - Y: 472139.21' / X: 561359.86'</p>			<p><sup>17</sup> OPERATOR CERTIFICATION</p> <p>I hereby certify that the information contained herein is true and complete to the best of my knowledge and belief, and that this organization either owns a working interest or unleased mineral interest in the land including the proposed bottom hole location or has a right to drill this well at this location pursuant to a contract with an owner of such a mineral or working interest, or to a voluntary pooling agreement or a compulsory pooling order heretofore entered by the division.</p> <p><i>Melissa Szudera</i> 01/12/2018 Signature Date</p> <p>Melissa Szudera Printed Name</p> <p>mszudera@marathonoil.com E-mail Address</p> <p><sup>18</sup> SURVEYOR CERTIFICATION</p> <p>I hereby certify that the well location shown on this plat was plotted from field notes of actual surveys made by me or under my supervision, and that the same is true and correct to the best of my belief.</p> <p>JANUARY 11, 2018 Date of Survey</p> <p><i>Lloyd P. Short</i> Signature and Seal of Professional Surveyor</p> <p>Certificate Number LLOYD P. SHORT 21653</p>		
---	--	--	---	--	--

# LOCATION VERIFICATION MAP

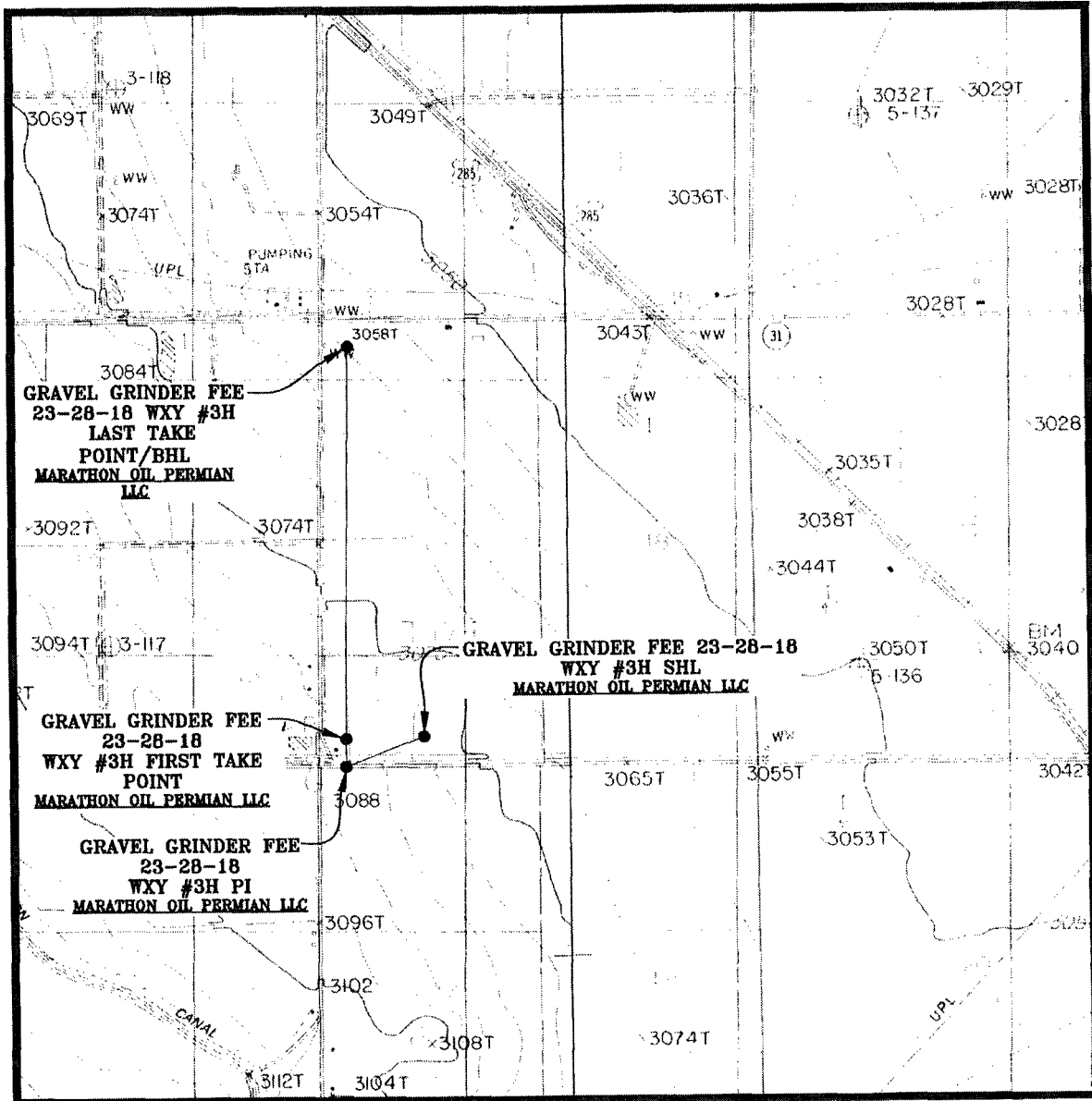

SEC. 18 TWP. 23-S RGE. 28-E  
 SURVEY: N.M.P.M.  
 COUNTY: EDDY  
 DESCRIPTION: 353' FSL & 1265' FWL  
 ELEVATION: 3080'  
 OPERATOR: MARATHON OIL PERMIAN LLC  
 LEASE: GRAVEL GRINDER FEE 23-28-18  
 U.S.G.S. TOPOGRAPHIC MAP: OTIS, N.M.

SCALE: 1" = 2000'  
 CONTOUR INTERVAL = 5'

PREPARED BY:  
 R-SQUARED GLOBAL, LLC  
 1309 LOUISVILLE AVENUE, MONROE, LA 71201  
 318-323-6900 OFFICE  
 JOB No. R3813\_001

# VICINITY MAP

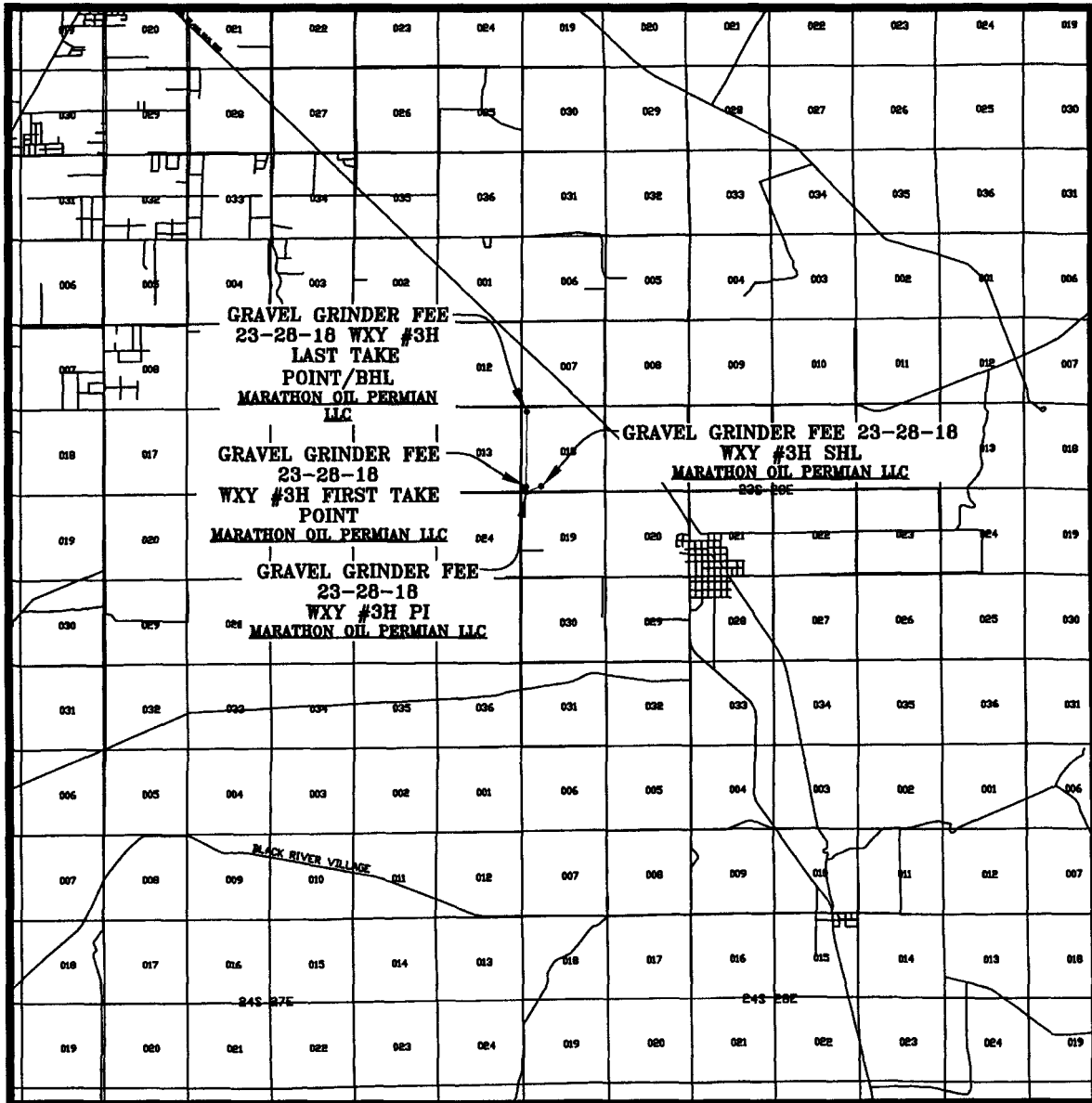

SEC. 18 TWP. 23-S RGE. 28-E

SURVEY: N.M.P.M.

COUNTY: EDDY

DESCRIPTION: 353' FSL & 1265' FWL

ELEVATION: 3080'

OPERATOR: MARATHON OIL PERMIAN LLC

LEASE: GRAVEL GRINDER FEE 23-28-18

U.S.G.S. TOPOGRAPHIC MAP: OTIS, N.M.

SCALE: 1" = 2 MILES

PREPARED BY:  
R-SQUARED GLOBAL, LLC  
1309 LOUISVILLE AVENUE, MONROE, LA 71201  
318-323-8900 OFFICE  
JOB No. R3813\_001