

NSP Required R/P 7.2-18

RECEIVED

RECEIVED



SCALE: 1" = 2000'
CONTOUR INTERVAL = 10'

PREPARED BY:
R-SQUARED GLOBAL, LLC
1309 LOUISVILLE AVENUE, MONROE, LA 71201
318-323-6900 OFFICE
JOB No. R3815_003

VICINITY MAP

NM OIL CONSERVATION
ARTESIA DISTRICT

FEB 02 2018

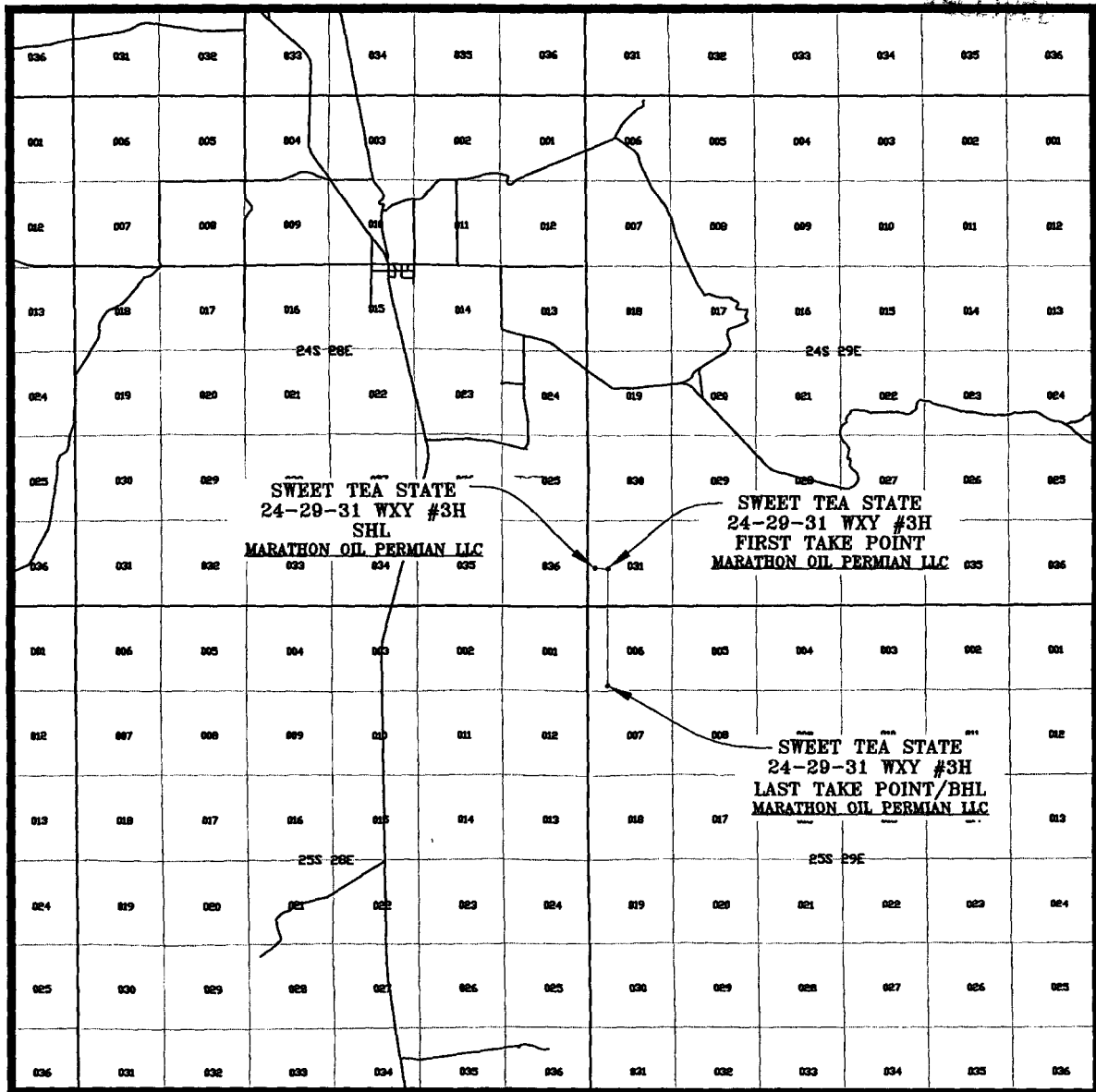

SEC. 31 TWP. 24-S RGE. 29-E
SURVEY: N.M.P.M.
COUNTY: EDDY
DESCRIPTION: 2,406' FSL & 456' FWL
ELEVATION: 2921'
OPERATOR: MARATHON OIL PERMIAN, LLC
LEASE: SWEET TEA STATE 24-29-31
U.S.G.S. TOPOGRAPHIC MAP: MALAGA, N.M.

SCALE: 1" = 2 MILES

PREPARED BY:
R-SQUARED GLOBAL, LLC
1309 LOUISVILLE AVENUE, MONROE, LA 71201
318-323-6900 OFFICE
JOB No. R3815_003