

District I  
1625 N. French Dr., Hobbs, NM 88240  
Phone: (575) 393-6161 Fax: (575) 393-0720  
District II  
811 S. First St., Artesia, NM 88210  
Phone: (575) 748-1283 Fax: (575) 748-9720  
District III  
1000 Rio Brazos Road, Aztec, NM 87410  
Phone: (505) 334-6178 Fax: (505) 334-6170  
District IV  
1220 S. St. Francis Dr., Santa Fe, NM 87505  
Phone: (505) 476-3460 Fax: (505) 476-3462

State of New Mexico  
Energy, Minerals & Natural Resources Department  
OIL CONSERVATION DIVISION  
1220 South St. Francis Dr.  
Santa Fe, NM 87505

Form C-102  
Revised August 1, 2011  
A copy to appropriate  
District Office

MAR 16 2018 ☐ AMENDED REPORT

WELL LOCATION AND ACREAGE DEDICATION

RECEIVED

<sup>1</sup> API Number <b>30-015-44815</b>	<sup>2</sup> Pool Code <b>96415 -</b>	<sup>3</sup> Pool Name <b>WILLOW LAKE (WEST); BONE SPRING -</b>
<sup>4</sup> Property Code <b>319-795</b>	<sup>5</sup> Property Name <b>BLACK RIVER 374 STATE 24-27-15 TB</b>	<sup>6</sup> Well Number <b>6H</b>
<sup>7</sup> GRID No. <b>372098</b>	<sup>8</sup> Operator Name <b>MARATHON OIL PERMIAN LLC</b>	<sup>9</sup> Elevation <b>3222'</b>

<sup>10</sup> Surface Location

UL or lot no.	Section	Township	Range	Lot Idn	Feet from the	North/South line	Feet from the	East/West line	County
M	15	24S	27E		321	SOUTH	797	WEST	EDDY

<sup>11</sup> Bottom Hole Location If Different From Surface

UL or lot no.	Section	Township	Range	Lot Idn	Feet from the	North/South line	Feet from the	East/West line	County
D	15	24S	27E		330	NORTH	495	WEST	EDDY

<sup>12</sup> Dedicated Acres <b>160.00</b>	<sup>13</sup> Joint or Infill	<sup>14</sup> Consolidation Code	<sup>15</sup> Order No.
--	-------------------------------	----------------------------------	-------------------------

No allowable will be assigned to this completion until all interests have been consolidated or a non-standard unit has been approved by the division.

<p><b>SECTION 9 A</b></p> <p><b>SECTION 16</b></p> <p><b>SECTION 21 D</b></p> <p><b>SECTION 10</b></p> <p><b>SECTION 15</b></p> <p><b>SECTION 11</b></p> <p><b>SECTION 14</b></p> <p><b>SECTION 15</b></p> <p><b>SECTION 22</b></p> <p><b>SECTION 14</b></p> <p><b>SECTION 23</b></p>		<p><b>CORNER COORDINATES</b> NAD 83, SPCS NM EAST A - X: 586546.74' / Y: 445455.95' B - X: 587872.72' / Y: 445439.80' C - X: 587832.62' / Y: 440162.05' D - X: 586532.61' / Y: 440164.88'</p> <p><b>CORNER COORDINATES</b> NAD 27, SPCS NM EAST A - X: 545363.97' / Y: 445397.76' B - X: 546689.92' / Y: 445381.60' C - X: 546649.73' / Y: 440103.95' D - X: 545349.75' / Y: 440106.79'</p> <p><b>LAST TAKE POINT</b> 330' FSL 495' FWL SECTION 15 NAD 83, SPCS NM EAST X: 587040.74' / Y: 445119.91' LAT: 32.22362465N / LON: 104.18553807W NAD 27, SPCS NM EAST X: 545857.96' / Y: 440061.73' LAT: 32.22350478N / LON: 104.18504114W</p> <p><b>FIRST TAKE POINT</b> 330' FSL 495' FWL SECTION 15 NAD 83, SPCS NM EAST X: 587028.39' / Y: 440493.80' LAT: 32.21080799N / LON: 104.18559857W NAD 27, SPCS NM EAST X: 545845.53' / Y: 440435.70' LAT: 32.21078795N / LON: 104.18510197W</p> <p><b>SURFACE HOLE LOCATION</b> 321' FSL 797' FWL SECTION 15 NAD 83, SPCS NM EAST X: 587330.70' / Y: 440483.80' LAT: 32.21087934N / LON: 104.18462117W NAD 27, SPCS NM EAST X: 546147.82' / Y: 440425.70' LAT: 32.21075929N / LON: 104.18412461W</p>	<p><b><sup>17</sup> OPERATOR CERTIFICATION</b></p> <p>I hereby certify that the information contained herein is true and complete to the best of my knowledge and belief, and that this organization either owns a working interest or unleased mineral interest in the land including the proposed bottom hole location or has a right to drill this well at this location pursuant to a contract with an owner of such a mineral or working interest, or to a voluntary pooling agreement or a compulsory pooling order heretofore entered by the division.</p> <p><i>Jennifer Van Curen</i> 2/28/2018 Signature Date</p> <p><b>Jennifer Van Curen</b> Printed Name</p> <p>E-mail Address</p> <p><b><sup>18</sup> SURVEYOR CERTIFICATION</b></p> <p>I hereby certify that the well location shown on this plat was plotted from field notes of actual surveys made by me or under my supervision, and that the same is true and correct to the best of my belief.</p> <p>FEBRUARY 22, 2018 Date of Survey</p> <p>Signature and Seal of Professional Surveyor</p> <p><i>Lloyd P. Short</i> Certificate Number LLOYD P. SHORT 21653</p>
---	--	---	---

RWP 3-16-18.

MAR 16 2018

RECEIVED

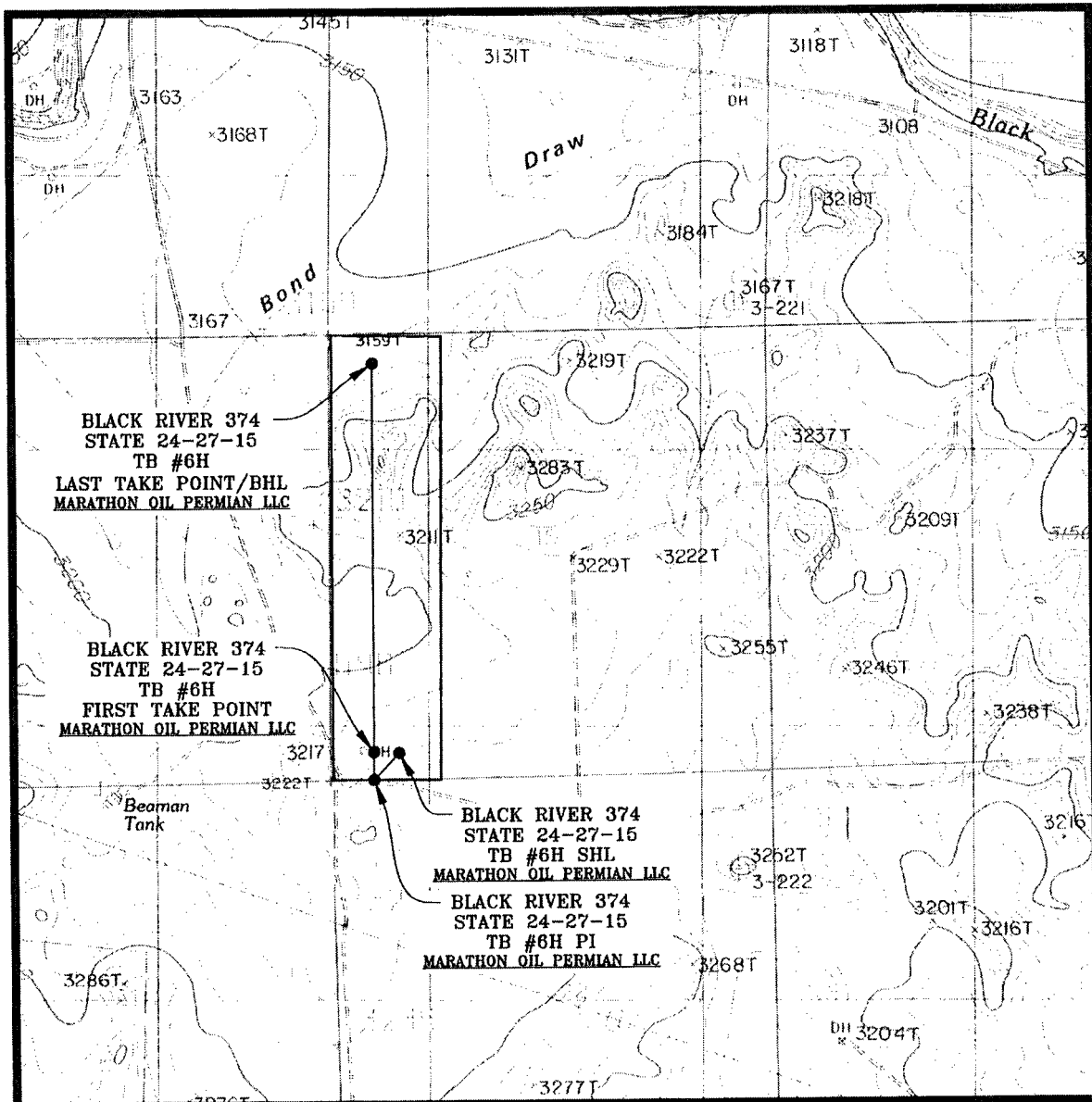

SEC. 15 TWP. 24-S RGE. 27-E  
SURVEY: N.M.P.M.  
COUNTY: EDDY  
DESCRIPTION: 321' FSL & 797' FWL  
ELEVATION: 3,222'  
OPERATOR: MARATHON OIL PERMIAN LLC  
LEASE: BLACK RIVER 374 STATE 24-27-15  
U.S.G.S. TOPOGRAPHIC MAP: BOND DRAW, N.M.

SCALE: 1" = 2000'  
CONTOUR INTERVAL = 10'

PREPARED BY:  
R-SQUARED GLOBAL, LLC  
1309 LOUISVILLE AVENUE, MONROE, LA 71201  
318-323-6900 OFFICE  
JOB No. R3784\_013

# VICINITY MAP

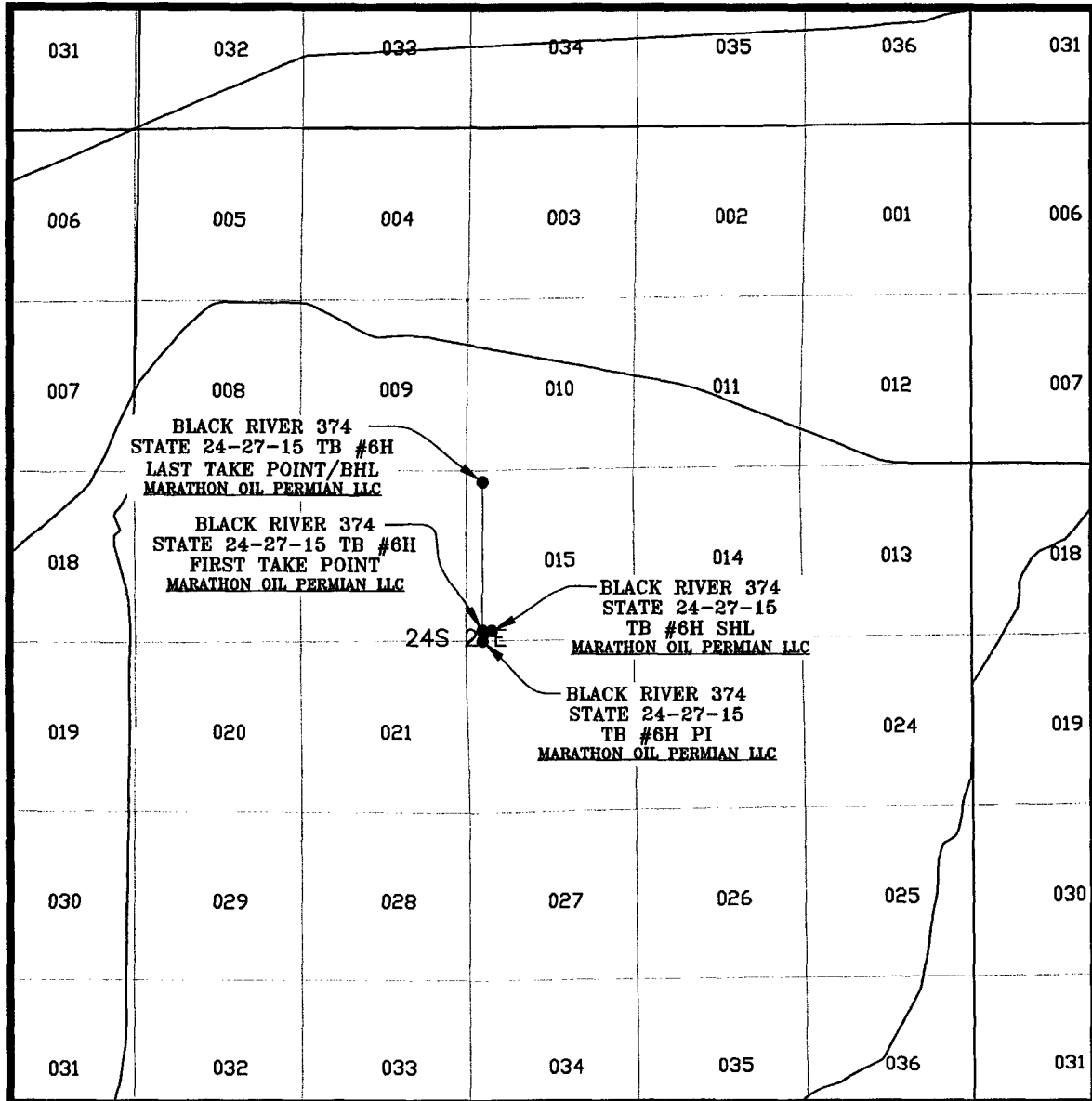

SEC. 15 TWP. 24-S RGE. 27-E  
 SURVEY: N.M.P.M.  
 COUNTY: EDDY  
 DESCRIPTION: 321' FSL & 797' FWL  
 ELEVATION: 3,222'  
 OPERATOR: MARATHON OIL PERMIAN LLC  
 LEASE: BLACK RIVER 374 STATE 24-27-15  
 U.S.G.S. TOPOGRAPHIC MAP: BOND DRAW, N.M.

SCALE: 1" = 1 MILE

PREPARED BY:  
 R-SQUARED GLOBAL, LLC  
 1309 LOUISVILLE AVENUE, MONROE, LA 71201  
 318-323-6900 OFFICE  
 JOB No. R3784\_013