

District I
1625 N. French Dr., Hobbs, NM 88240
District II
811 S. First St., Artesia, NM 88210
District III
1000 Rio Brazos Road, Aztec, NM 87410
District IV
1220 S. St. Francis Dr., Santa Fe, NM 87505

State of New Mexico
Energy, Minerals and Natural Resources Department

Submit Original
to Appropriate
District Office

Oil Conservation Division
1220 South St. Francis Dr.
Santa Fe, NM 87505

**NM OIL CONSERVATION
ARTESIA DISTRICT**

GAS CAPTURE PLAN

APR 26 2018

Date: 03/20/2108

RECEIVED

☒ Original

Operator & OGRID No.: Chisholm Energy Operating, LLC/372137

☐ Amended - Reason for Amendment: _____

This Gas Capture Plan outlines actions to be taken by the Operator to reduce well/production facility flaring/venting for new completion (new drill, recomple to new zone, re-frac) activity.

Note: Form C-129 must be submitted and approved prior to exceeding 60 days allowed by Rule (Subsection A of 19.15.18.12 NMAC).

Well(s)/Production Facility – Name of facility

The well(s) that will be located at the production facility are shown in the table below.

Well Name	API	Well Location (ULSTR)	Footages	Expected MCF/D	Flared or Vented	Comments
Cottonwood 29-32 Fed Com 2BS 8H	015- <i>44918</i>	B-29-26S-26E	200 FNL 1295FEL	1900	FLARED	PIPELINE IN PLACE; FLARE ONLY WHEN NEEDED

Gathering System and Pipeline Notification

Well(s) will be connected to a production facility after flowback operations are complete, if gas transporter system is in place. The gas produced from production facility is dedicated to LUCID and will be connected to LUCID low/high pressure gathering system located in EDDY County, New Mexico. It will require FLOWLINES to connect the facility to low/high pressure gathering system. Chisholm Energy Operating, LLC provides (periodically) to LUCID a drilling, completion and estimated first production date for wells that are scheduled to be drilled in the foreseeable future. In addition, Chisholm Energy Operating, LLC and LUCID have periodic conference calls to discuss changes to drilling and completion schedules. Gas from these wells will be processed at LUCID Processing Plant located in Sec. 13, Twn. 24S, Rng. 33E, EDDY County, New Mexico. The actual flow of the gas will be based on compression operating parameters and gathering system pressures.

Flowback Strategy

After the fracture treatment/completion operations, well(s) will be produced to temporary production tanks and gas will be flared or vented. During flowback, the fluids and sand content will be monitored. When the produced fluids contain minimal sand, the wells will be turned to production facilities. Gas sales should start as soon as the wells start flowing through the production facilities, unless there are operational issues on LUCID system at that time. Based on current information, it is Chisholm Energy Operating, LLC belief the system can take this gas upon completion of the well(s).

Safety requirements during cleanout operations from the use of underbalanced air cleanout systems may necessitate that sand and non-pipeline quality gas be vented and/or flared rather than sold on a temporary basis.

Alternatives to Reduce Flaring

Below are alternatives considered from a conceptual standpoint to reduce the amount of gas flared.

- Power Generation – On lease
 - Only a portion of gas is consumed operating the generator, remainder of gas will be flared
- Compressed Natural Gas – On lease
 - Gas flared would be minimal, but might be uneconomical to operate when gas volume declines
- NGL Removal – On lease
 - Plants are expensive, residue gas is still flared, and uneconomical to operate when gas volume declines

SECTION 29, TOWNSHIP 26 SOUTH, RANGE 26 EAST, N.M.P.M.,
EDDY COUNTY, NEW MEXICO.

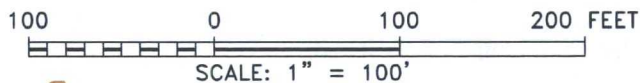
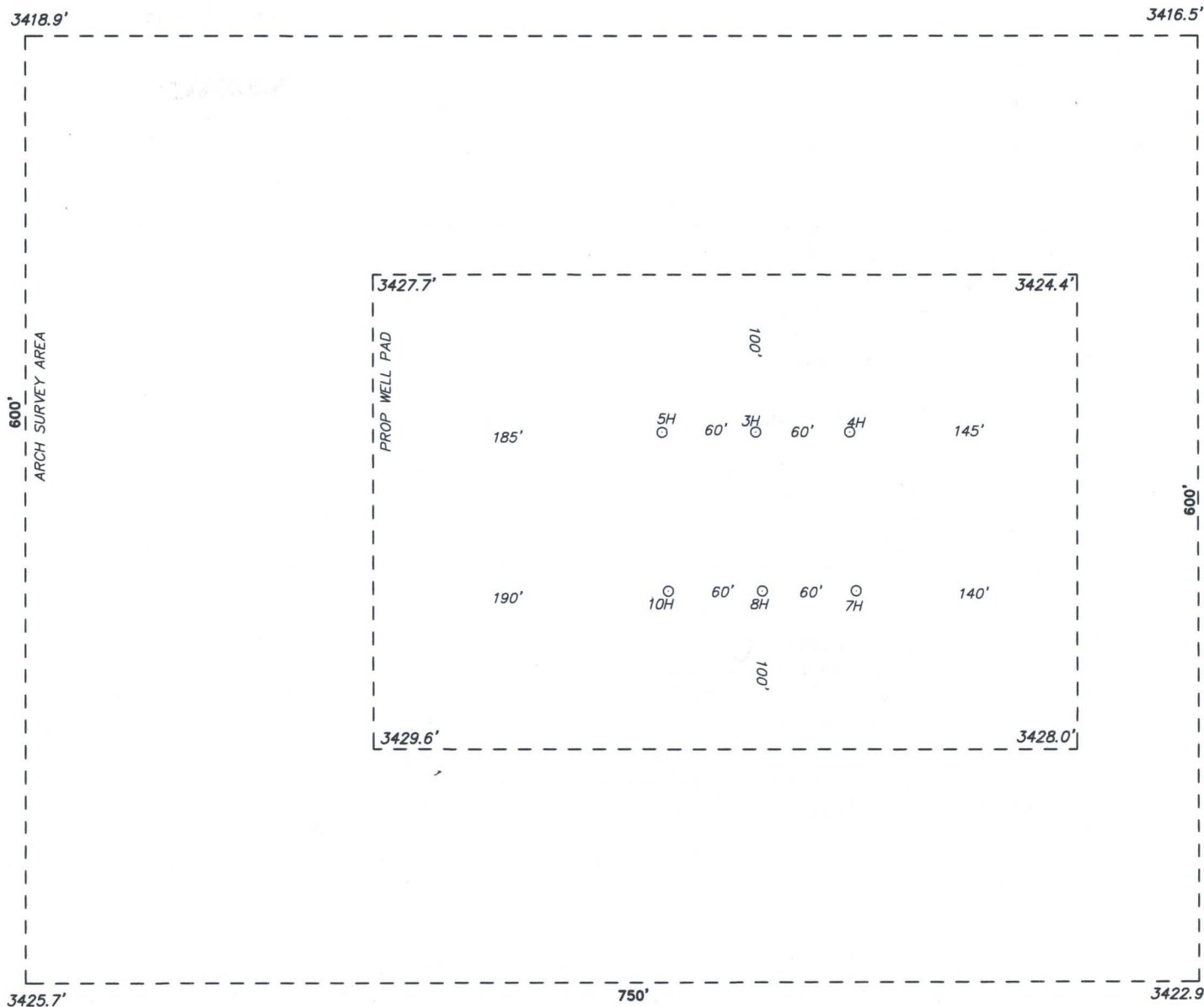

basin
surveys
focused on excellence
in the oilfield

P.O. Box 1786 (575) 393-7316 - Office
1120 N. West County Rd. (575) 392-2206 - Fax
Hobbs, New Mexico 88241 basinsurveys.com

CHISHOLM ENERGY OPERATING, LLC

REF: COTTONWOOD 29-32 FED COM 2BS 8H / WELL PAD TOPO

THE COTTONWOOD 29-32 FED COM 2BS 8H LOCATED 200' FROM

THE NORTH LINE AND 1295' FROM THE EAST LINE OF

SECTION 29, TOWNSHIP 26 SOUTH, RANGE 26 EAST,

N.M.P.M., EDDY COUNTY, NEW MEXICO.

W.O. Number: 33403

Drawn By: K. GOAD

Date: 11-28-2017

Survey Date: 11-14-2017

Sheet 1 of 1 Sheets