

Operator Name: OXY USA Inc.	Property Name: Corral Fly 35-26 Federal Com <i>30-015-44703</i>	Well Number 22H
--------------------------------	---	--------------------

Kick Off Point (KOP)

UL C	Section 2	Township 25S	Range 29E	Lot	Feet 192	From N/S NORTH	Feet 1360	From E/W WEST	County EDDY
Latitude 32.16600613					Longitude -103.95929124			NAD NAD83	

First Take Point (FTP)

UL N	Section 35	Township 24S	Range 29E	Lot	Feet 386	From N/S SOUTH	Feet 1400	From E/W WEST	County EDDY
Latitude 32.167597					Longitude -103.95918			NAD NAD83	

Last Take Point (LTP)

UL C	Section 26	Township 24S	Range 29E	Lot	Feet 353	From N/S NORTH	Feet 1411	From E/W WEST	County EDDY
Latitude 32.19468749					Longitude -103.95921324			NAD NAD83	

Is this well the defining well for the Horizontal Spacing Unit?

Is this well an infill well?

**NM OIL CONSERVATION
ARTESIA DISTRICT**

JUL 13 2018

RECEIVED

If infill is yes please provide API if available, Operator Name and well number for Defining well for Horizontal Spacing Unit.

API #		
Operator Name:	Property Name:	Well Number

KZ 06/27/2018



OXY



Borehole: Original Borehole	Well: Oxy Corral Fly 35-26 Federal Com 22H	Field: NM Eddy County (NAD 83)	Structure: Oxy Corral Fly 35-26 Federal Com 22H
---------------------------------------	--	--	---

Gravity & Magnetic Parameters		Surface Location		Measurements	
Model: HGS8 2010	Ch: 28 824'	Date: 20-01-2018	NAZ83 New Mexico State Plane, Eastern Zone, US Feet	Lat: N 28 0 42 00	Longitude: 107 57 42 00
MagDec: 6.999'	FD: 47961 2mT	Gravity PB: P98 417mgn (3 80521 Base-0)	Lat: W 102 57 34 03	Easting: 634786 77028	Scale Fact: 0.9992641
				Well: Oxy Corral Fly 35-26 Federal Com 22H	Well Ref: P98-015 712044 79 above N.M.J.
				Plan: Oxy Corral Fly 35-26 Federal Com 22H Dynam WGS83 (1) 0-19.410'	

Grid
True ↑
Mag ↑
Grid North
Tot Corr (M->G 6.800°)
Mag Dec (6.999°)
Grid Conv (0.199°)

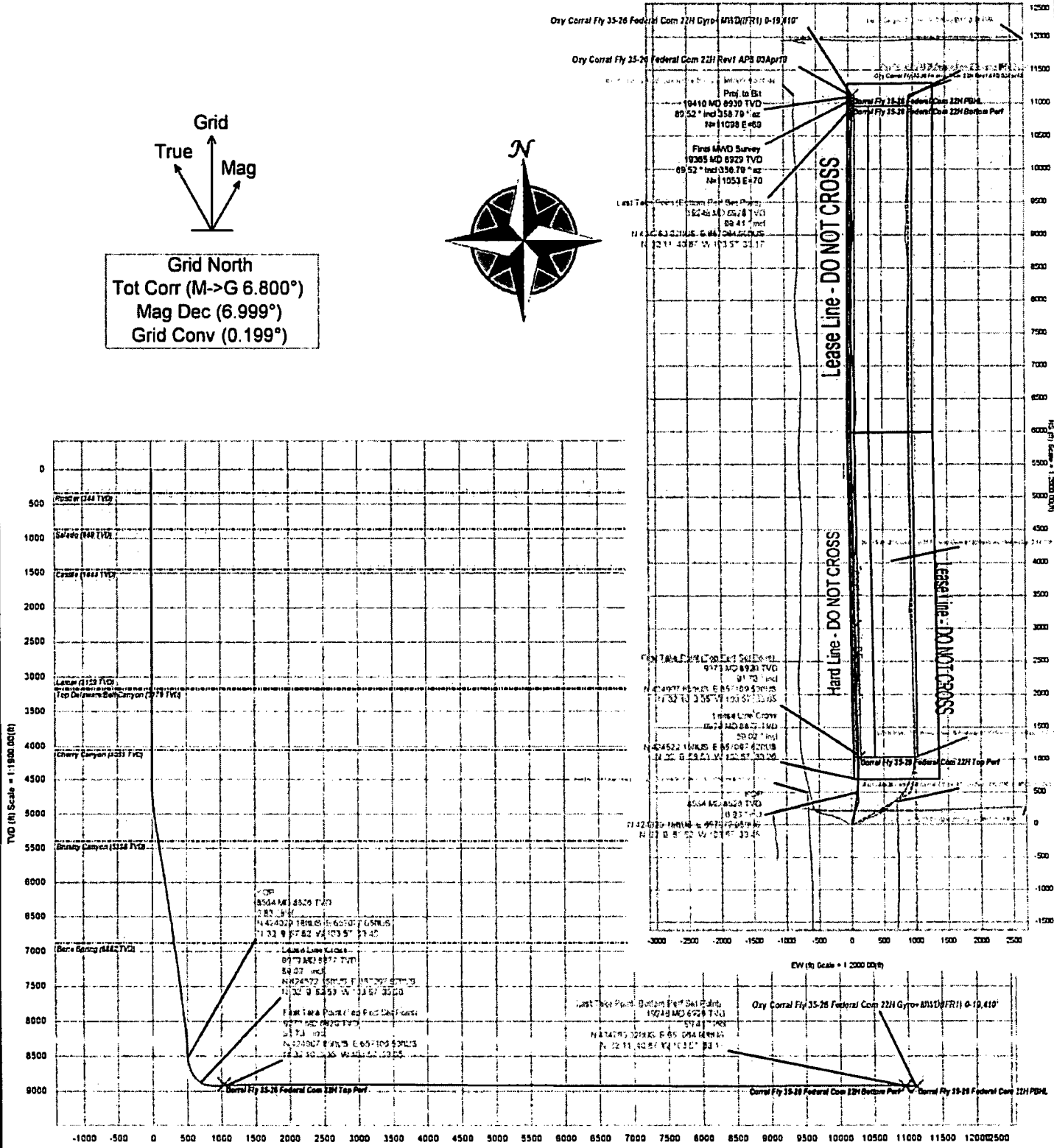

Vertical Section (R) Adm = 0.24° Scale = 1.1900 00(R) Origin = DN-3, GE/W