

District I
1625 N. French Dr., Hobbs, NM 88240
Phone: (575) 393-6161 Fax: (575) 393-0720
District II
811 S. First St., Artesia, NM 88210
Phone: (575) 748-1283 Fax: (575) 748-9720
District III
1000 Rio Brazos Road, Aztec, NM 87410
Phone: (505) 334-6178 Fax: (505) 334-6170
District IV
1220 S. St. Francis Dr., Santa Fe, NM 87505
Phone: (505) 476-3460 Fax: (505) 476-3462

State of New Mexico
Energy, Minerals & Natural Resources Department
OIL CONSERVATION DIVISION
1220 South St. Francis Dr.
Santa Fe, NM 87505

Form C-102
Revised August 1, 2011
Submit one copy to appropriate
District Office

☐ AMENDED REPORT

WELL LOCATION AND ACREAGE DEDICATION PLAT

¹ API Number 30-015-45329	² Pool Code 98220	³ Pool Name PURPLE SAGE WOLFCAMP
⁴ Property Code 322125	⁵ Property Name FULLER 13/24 WIJO FEDERAL COM	
⁷ OGRID NO. 14744	⁸ Operator Name MEWBOURNE OIL COMPANY	⁶ Well Number 2H
		⁹ Elevation 3015'

¹⁰ Surface Location

UL or lot no.	Section	Township	Range	Lot Idn	Feet from the	North/South line	Feet From the	East/West line	County
G	13	26S	29E		2500	NORTH	1910	EAST	EDDY

¹¹ Bottom Hole Location If Different From Surface

UL or lot no.	Section	Township	Range	Lot Idn	Feet from the	North/South line	Feet from the	East/West line	County
0	24	26S	29E		330	SOUTH	2200	EAST	EDDY

¹² Dedicated Acres 640	¹³ Joint or Infill	¹⁴ Consolidation Code	¹⁵ Order No.
---	-------------------------------	----------------------------------	-------------------------

No allowable will be assigned to this completion until all interest have been consolidated or a non-standard unit has been approved by the division.

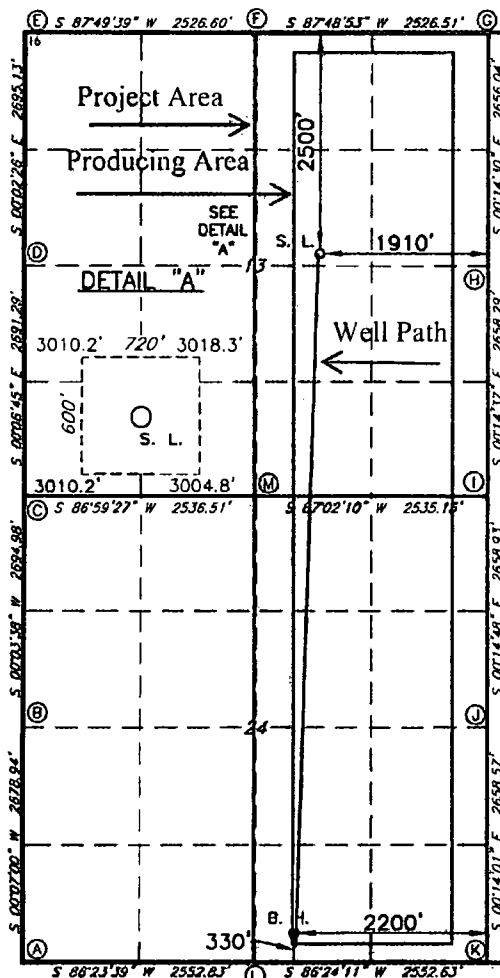

GEODETIC DATA
NAD 83 GRID - NM EAST

SURFACE LOCATION
N: 379502.2 - E: 664640.1

LAT: 32.0427088° N
LONG: 103.9353845° W

BOTTOM HOLE
N: 371636.9 - E: 664386.0

LAT: 32.0210884° N
LONG: 103.9362980° W

CORNER DATA
NAD 83 GRID - NM EAST

A: FOUND BRASS CAP "1940"
N: 371124.3 - E: 661488.2

B: FOUND BRASS CAP "1940"
N: 373802.7 - E: 661493.7

C: FOUND BRASS CAP "1940"
N: 376497.1 - E: 661496.5

D: FOUND BRASS CAP "1940"
N: 379187.8 - E: 661491.3

E: FOUND BRASS CAP "1940"
N: 381882.4 - E: 661489.4

F: FOUND BRASS CAP "1940"
N: 381978.1 - E: 664013.6

G: FOUND BRASS CAP "1940"
N: 382074.4 - E: 666537.7

H: FOUND BRASS CAP "1940"
N: 379419.0 - E: 666548.9

I: FOUND BRASS CAP "1940"
N: 376761.3 - E: 666560.2

J: FOUND BRASS CAP "1940"
N: 374102.9 - E: 666571.7

K: FOUND 5/8" REBAR
N: 371444.9 - E: 666582.5

L: FOUND BRASS CAP "1940"
N: 371284.6 - E: 664035.5

M: FOUND BRASS CAP "1940"
N: 376630.2 - E: 664029.0

¹⁷ OPERATOR CERTIFICATION

I hereby certify that the information contained herein is true and complete to the best of my knowledge and belief, and that this organization either owns a working interest or unleased mineral interest in the land including the proposed bottom hole location or has a right to drill this well at this location pursuant to a contract with an owner of such a mineral or working interest, or to a voluntary pooling agreement or a compulsory pooling

order heretofore entered by the division

Bradley Bishop 1-17-18
Signature Date

Printed Name
BRADLEY BISHOP

E-mail Address
BBISHOP@MEWBOURNE.COM

¹⁸ SURVEYOR CERTIFICATION

I hereby certify that the well location shown on this plat was plotted from field notes of actual surveys made by me or under my supervision, and that the same is true and correct to the best of my belief.

9-22-2017

Date of Survey

Signature and Seal of Professional Surveyor

19680
Certificate Number

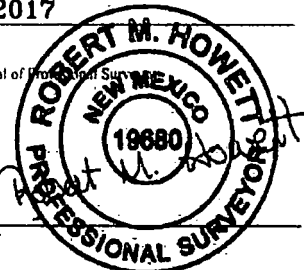

RRC-Job No.: LS1708589

Ref 10-15-18

United States Department of the Interior
Bureau of Land Management
Carlsbad Field Office
620 E Greene Street
Carlsbad, New Mexico 88201-1287

Statement Accepting Responsibility for Operations

Operator Name: Mewbourne Oil Company
Street or Box: P.O. Box 5270
City, State: Hobbs, New Mexico
Zip Code: 88241

The undersigned accepts all applicable terms, conditions, stipulations, and restrictions concerning operations conducted of the leased land or portion thereof, as described below.

Lease Number: NMLC 061497 – G,J,B Sec 13,
NMNM 121953 O,J,G Sec 12
NMNM 57261-B

Legal Description of Land: Section 13, T-26S, R-29E Eddy County, New Mexico.
Location @ 2500' FNL & 1910' FEL

Formation (if applicable): Wolfcamp

Bond Coverage: \$150,000

BLM Bond File: NM1693 nationwide, NMB000919

Authorized Signature: _____



Name: **Bradley Bishop**
Title: **Regulatory Manager**
Date: 1-8-18