

UNITED STATES
DEPARTMENT OF THE INTERIOR
BUREAU OF LAND MANAGEMENT

OCD Artesia

FORM APPROVED
OMB No. 1004-0137
Expires: July 31, 2010

WELL COMPLETION OR RECOMPLETION REPORT AND LOG

5. Lease Serial No.
NMNM02953C1a. Type of Well ☒ Oil Well ☐ Gas Well ☐ Dry ☐ Other
b. Type of Completion ☒ New Well ☐ Work Over ☐ Deepen ☐ Plug Back ☐ Diff. Resvr.
Other _____

6. If Indian, Allottee or Tribe Name

7. Unit or CA Agreement Name and No.
891000558X2. Name of Operator
BOPCO LPContact: TESSA FITZHUGH
E-Mail: tessa_fitzhugh@xtoenergy.com8. Lease Name and Well No.
JAMES RANCH UNIT 146H3. Address 6401 HOLIDAY HILL RD BLDG 5 SUITE 200
MIDLAND, TX 797073a. Phone No. (include area code)
Ph: 432-620-43369. API Well No.
30-015-42756-00-S1

4. Location of Well (Report location clearly and in accordance with Federal requirements)*

Sec 36 T22S R30E Mer NMP
At surface SESE 0800FSL 0405FEL 32.203616 N Lat, 103.493519 W LonSec 31 T22S R31E Mer NMP
At top prod interval reported below SWSW 330FSL 200FELSec 31 T22S R31E Mer NMP
At total depth SESE 0660FSL 0330FEL 32.203277 N Lat, 103.483257 W Lon 351F5L 206FEL10. Field and Pool, or Exploratory
LOS MEDANOS11. Sec., T., R., M., or Block and Survey
or Area Sec 36 T22S R30E Mer NMP12. County or Parish
EDDY13. State
NM14. Date Spudded
08/17/201715. Date T.D. Reached
09/13/201716. Date Completed
☐ D & A ☒ Ready to Prod.
11/27/201717. Elevations (DF, KB, RT, GL)*
3312 GL18. Total Depth: MD 16335
TVD 11226 1122719. Plug Back T.D.: MD 16255
TVD 1122620. Depth Bridge Plug Set: MD
TVD21. Type Electric & Other Mechanical Logs Run (Submit copy of each)
RCBL GR CCL22. Was well cored? ☒ No ☐ Yes (Submit analysis)
Was DST run? ☒ No ☐ Yes (Submit analysis)
Directional Survey? ☐ No ☒ Yes (Submit analysis)

23. Casing and Liner Record (Report all strings set in well)

Hole Size	Size/Grade	Wt. (#/ft.)	Top (MD)	Bottom (MD)	Stage Cementer Depth	No. of Sk. & Type of Cement	Slurry Vol. (BBL)	Cement Top*	Amount Pulled
17.500	13.375 H40	48.0	0	575		638	151	0	
8.750	7.000 HCP110	29.0	27	10884	4290	718	296	0	
12.250	9.625 J55	40.0	37	3940		1566	464	0	
6.125	4.500 HCP110	18.0	10263	16355		707	65	0	

24. Tubing Record

Size	Depth Set (MD)	Packer Depth (MD)	Size	Depth Set (MD)	Packer Depth (MD)	Size	Depth Set (MD)	Packer Depth (MD)
2.875	10216							

25. Producing Intervals

26. Perforation Record

Formation	Top	Bottom	Perforated Interval	Size	No. Holes	Perf. Status
A) WOLFCAMP	11393	16355	11872 TO 16220	0.400		ACTIVE/PRODUCING - Wolfcamp
B)						
C)						
D)						

27. Acid, Fracture, Treatment, Cement Squeeze, Etc.

Depth Interval	Amount and Type of Material
11872 TO 16220	FRAC INTERVAL IN 30 STAGES, USING 30,000 GALS ACID; 10,998,760 LBS PROPANT; 9,474,843 GALS OF FLUID

28. Production - Interval A

Date First Produced	Test Date	Hours Tested	Test Production	Oil BBL	Gas MCF	Water BBL	Oil Gravity Corr. API	Gas Gravity	Production Method
12/03/2017	12/23/2017	24	→	1407.0	3284.0	2242.0	45.9		FLOWS FROM WELL
Choke Size	Tbg. Press. Flwg. SI	Csg. Press.	24 Hr. Rate	Oil BBL	Gas MCF	Water BBL	Gas:Oil Ratio	Well Status	
30/64	2350	225.0	→	1407	3284	242	2334	POW	

28a. Production - Interval B

Date First Produced	Test Date	Hours Tested	Test Production	Oil BBL	Gas MCF	Water BBL	Oil Gravity Corr. API	Gas Gravity	Production Method
			→						
Choke Size	Tbg. Press. Flwg. SI	Csg. Press.	24 Hr. Rate	Oil BBL	Gas MCF	Water BBL	Gas:Oil Ratio	Well Status	
			→						

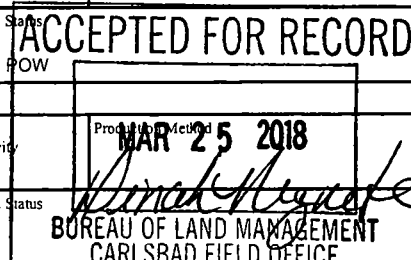

(See Instructions and spaces for additional data on reverse side)

ELECTRONIC SUBMISSION #407945 VERIFIED BY THE BLM WELL INFORMATION SYSTEM

** BLM REVISED ** BLM REVISED ** BLM REVISED ** BLM REVISED ** BLM REVISED **

Reclamation Due: 5/27/2018

28b. Production - Interval C

Date First Produced	Test Date	Hours Tested	Test Production	Oil BBL	Gas MCF	Water BBL	Oil Gravity Corr. API	Gas Gravity	Production Method
			→						
Choke Size	Tbg. Press. Flwg. SI	Csg. Press.	24 Hr. Rate	Oil BBL	Gas MCF	Water BBL	Gas:Oil Ratio	Well Status	
			→						

28c. Production - Interval D

Date First Produced	Test Date	Hours Tested	Test Production	Oil BBL	Gas MCF	Water BBL	Oil Gravity Corr. API	Gas Gravity	Production Method
			→						
Choke Size	Tbg. Press. Flwg. SI	Csg. Press.	24 Hr. Rate	Oil BBL	Gas MCF	Water BBL	Gas:Oil Ratio	Well Status	
			→						

29. Disposition of Gas(Sold, used for fuel, vented, etc.)
SOLD

30. Summary of Porous Zones (Include Aquifers):

Show all important zones of porosity and contents thereof: Cored intervals and all drill-stem tests, including depth interval tested, cushion used, time tool open, flowing and shut-in pressures and recoveries.

31. Formation (Log) Markers

Formation	Top	Bottom	Descriptions, Contents, etc.	Name	Top
					Meas. Depth
BASE OF SALT LAMAR SALADO BELL CANYON WOLFCAMP CHERRY CANYON BRUSHY CANYON BONE SPRING			ANHYDRITE, DOLOMITE LIMESTONE, SHALE SALT, ANHYDRITE SANDSTONE, SHALE, LIMESTONE SANDSTONE, SHALE, LIMESTONE SANDSTONE, SHALE, LIMESTONE SANDSTONE, SHALE, LIMESTONE LIMESTONE, SHALE, SANDSTONE	SALADO BASE OF SALT LAMAR BELL CANYON CHERRY CANYON BRUSHY CANYON BONE SPRING WOLFCAMP	561 2504 3864 3903 4838 6407 7703 11393

32. Additional remarks (include plugging procedure):

33. Circle enclosed attachments:

- | | | | |
|---|--------------------|---------------|-----------------------|
| 1. Electrical/Mechanical Logs (1 full set req'd.) | 2. Geologic Report | 3. DST Report | 4. Directional Survey |
| 5. Sundry Notice for plugging and cement verification | 6. Core Analysis | 7. Other: | |

34. I hereby certify that the foregoing and attached information is complete and correct as determined from all available records (see attached instructions):

Electronic Submission #407945 Verified by the BLM Well Information System.

For BOPCO LP, sent to the Carlsbad

Committed to AFMSS for processing by DUNCAN WHITLOCK on 03/16/2018 (18DW0109SE)

Name (please print) TESSA FITZHUGHTitle REG. ANALYST

Signature _____ (Electronic Submission)

Date 03/15/2018

Title 18 U.S.C. Section 1001 and Title 43 U.S.C. Section 1212, make it a crime for any person knowingly and willfully to make to any department or agency of the United States any false, fictitious or fraudulent statements or representations as to any matter within its jurisdiction.

**** REVISED ** REVISED ** REVISED ** REVISED ** REVISED ** REVISED ** REVISED ** REVISED ****

District I
1625 N. French Dr., Hobbs, NM 88240
Phone: (575) 393-6161 Fax: (575) 393-0720
District II
811 S. First St., Artesia, NM 88210
Phone: (575) 748-1283 Fax: (575) 748-9720
District III
1000 Rio Brazos Road, Aztec, NM 87410
Phone: (505) 334-6178 Fax: (505) 334-6170
District IV
1220 S. St. Francis Dr., Santa Fe, NM 87505
Phone: (505) 476-3460 Fax: (505) 476-3462

State of New Mexico
Energy, Minerals & Natural Resources Department
OIL CONSERVATION DIVISION
1220 South St. Francis Dr.
Santa Fe, NM 87505

Form C-102
Revised August 1, 2011
Submit one copy to appropriate
District Office
☐ AMENDED REPORT

WELL LOCATION AND ACREAGE DEDICATION PLAT AS-DRILLED PLAT

1 API Number 30-016-42756	2 Pool Code 36407	3 Well Name Los Medanos (1 well) South
4 Property Code 96336	5 Property Name JAMES RANCH UNIT	6 Well Number 146H
7 OGRID No. 005380	8 Operator Name XTO ENERGY, INC.	9 Elevation 3312'

10 Surface Location

UL or lot no.	Section	Township	Range	Lot Idn	Feet from the	North/South line	Feet from the	East/West line	County
P	36	22 S	30 E		800	SOUTH	405	EAST	EDDY

11 Bottom Hole Location If Different From Surface

UL or lot no.	Section	Township	Range	Lot Idn	Feet from the	North/South line	Feet from the	East/West line	County
P	31	22 S	31 E		351	SOUTH	206	EAST	EDDY

12 Dedicated Acres	13 Joint or Infill	14 Consolidation Code	15 Order No.
--------------------	--------------------	-----------------------	--------------

No allowable will be assigned to this completion until all interests have been consolidated or a non-standard unit has been approved by the division.
NOTE: AS-DRILLED BOTTOM HOLE PLOTTED FROM
DATA FURNISHED BY XTO ENERGY

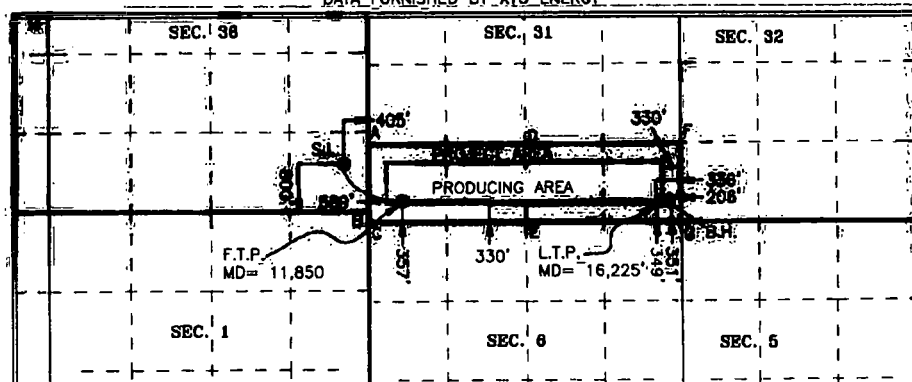

GEODETIC COORDINATES
SURFACE LOCATION
NAD 27 NME
Y= 489,009.5
X= 656,549.0
LAT.= 32.343384°N
LONG.= 103.826433°W

LAST TAKE POINT
NAD 27 NME
Y= 488,382.3
X= 661,918.4
LAT.= 32.341589°N
LONG.= 103.809057°W

GEODETIC COORDINATES
SURFACE LOCATION
NAD 83 NME
Y= 489,069.4
X= 697,731.3
LAT.= 32.343507°N
LONG.= 103.826923°W

LAST TAKE POINT
NAD 83 NME
Y= 488,442.2
X= 703,100.7
LAT.= 32.341712°N
LONG.= 103.809548°W

AS-DRILLED
FIRST TAKE POINT
NAD 27 NME
Y= 488,376.1
X= 657,546.4
LAT.= 32.341630°N
LONG.= 103.823213°W

BOTTOM HOLE LOCATION
NAD 27 NME
Y= 488,384.2
X= 662,048.3
LAT.= 32.341593°N
LONG.= 103.808637°W

AS-DRILLED
FIRST TAKE POINT
NAD 83 NME
Y= 488,436.0
X= 698,728.7
LAT.= 32.341753°N
LONG.= 103.823704°W

BOTTOM HOLE LOCATION
NAD 83 NME
Y= 488,444.1
X= 703,230.6
LAT.= 32.341715°N
LONG.= 103.809127°W

CORNER COORDINATES TABLE
NAD 27 NME

A - Y= 489,336.0 N, X= 656,952.5 E
B - Y= 488,210.5 N, X= 656,957.8 E
C - Y= 488,018.0 N, X= 656,958.7 E
D - Y= 489,344.0 N, X= 659,608.1 E
E - Y= 488,022.8 N, X= 659,616.6 E
F - Y= 489,355.4 N, X= 662,249.2 E
G - Y= 488,034.6 N, X= 662,256.0 E

CORNER COORDINATES TABLE
NAD 83 NME

A - Y= 489,395.9 N, X= 698,134.8 E
B - Y= 488,270.4 N, X= 698,140.1 E
C - Y= 488,077.9 N, X= 698,141.0 E
D - Y= 489,403.9 N, X= 700,790.4 E
E - Y= 488,082.7 N, X= 700,798.9 E
F - Y= 489,415.3 N, X= 703,431.5 E
G - Y= 488,094.5 N, X= 703,438.4 E

17 OPERATOR CERTIFICATION

I hereby certify that the information contained herein is true and complete to the best of my knowledge and belief, and that this organization either owns a working interest or unleased mineral interest in the land including the proposed bottom hole location or has a right to drill this well at this location pursuant to a contract with an owner of such a mineral or working interest, or to a voluntary pooling agreement or a compulsory pooling

Signature: [Signature] Date: 3-14-2018

Printed Name

E-mail Address

18 SURVEYOR CERTIFICATION

I hereby certify that the well location shown on this plat was plotted from field notes of actual surveys made by me or under my supervision, and that the same is true and correct to the best of my belief.

9-28-2017

Date of Survey

Signature and Seal of Professional Surveyor:

MARK DILLON HARP 23786
Certificate Number



RR 2017050724