

OCT 29 2018

DISTRICT I
1025 N. FRANCIS DR., MORGAN, NM 88240
Phone: (505) 233-4181 Fax: (505) 233-9780

DISTRICT II
511 E. FIRST ST., ARTESIA, NM 88210
Phone: (505) 749-1423 Fax: (505) 749-9722

DISTRICT III
1000 RIO BRAZOS RD., AZTEC, NM 87410
Phone: (505) 334-8178 Fax: (505) 334-8170

DISTRICT IV
1220 S. ST. FRANCIS DR., SANTA FE, NM 87505
Phone: (505) 678-3480 Fax: (505) 478-3483

State of New Mexico
Energy, Minerals & Natural Resources Department
OIL CONSERVATION DIVISION
1220 SOUTH ST. FRANCIS DR.
Santa Fe, New Mexico 87505

RECEIVED

Form C-102
Revised August 1, 2011
Submit one copy to appropriate
District Office

☐ AMENDED REPORT

WELL LOCATION AND ACREAGE DEDICATION PLAT

API Number 30-015-45376	Pool Code 98220	Pool Name Purple Sage; Wolfcamp
Property Code 38521	Property Name MYOX 21 STATE COM	Well Number 37H
OGRID No. 229137	Operator Name COG OPERATING, LLC	Elevation 2976.9'

Surface Location

UL or lot No.	Section	Township	Range	Lot Idn	Feet from the	North/South line	Feet from the	East/West line	County
N	21	25-S	28-E		200	SOUTH	1709	WEST	EDDY

Bottom Hole Location If Different From Surface

UL or lot No.	Section	Township	Range	Lot Idn	Feet from the	North/South line	Feet from the	East/West line	County
C	16	25-S	28-E		200	NORTH	2310	WEST	EDDY

Dedicated Acres 640	Joint or Infill	Consolidation Code	Order No.
-------------------------------	-----------------	--------------------	-----------

NO ALLOWABLE WILL BE ASSIGNED TO THIS COMPLETION UNTIL ALL INTERESTS HAVE BEEN CONSOLIDATED
OR A NON-STANDARD UNIT HAS BEEN APPROVED BY THE DIVISION

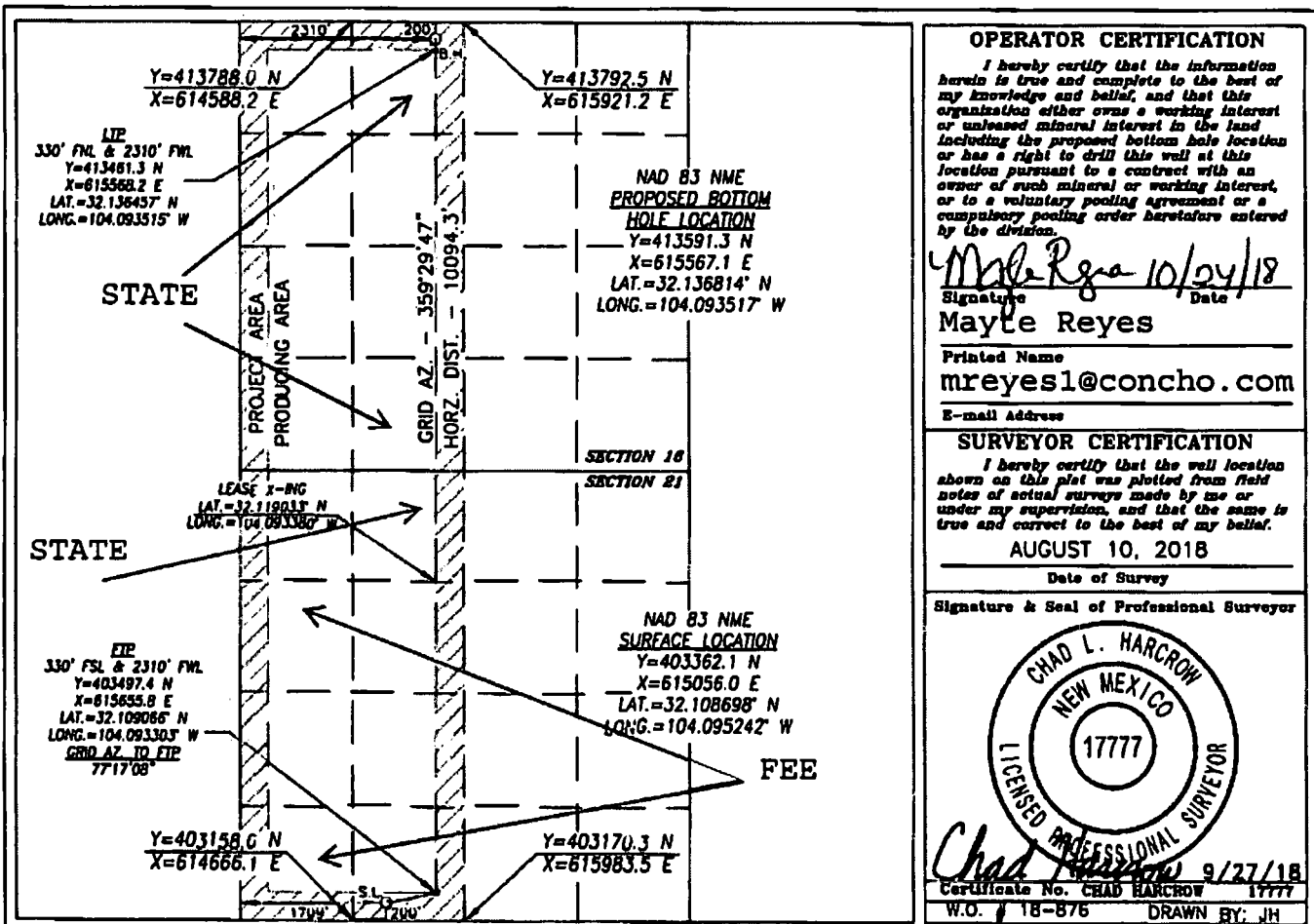

Rev 10-30-18

Myox 21 State Com 37H

Casing and Cement

<u>String</u>	<u>Hole Size</u>	<u>Csg OD</u>	<u>PPF</u>	<u>Depth</u>	<u>Sx Cement</u>	<u>TOC</u>
Surface	17 1/2"	13 3/8"	54.5#	625'	500	0'
Intermediate	12-1/4"	9-5/8"	40#	8925'	1500	0'
Production	8-3/4"	5-1/2"	20#	19713'	3000	8425'

Well Plan

Drill 17-1/2" hole to ~625' w/ fresh water. Run 13-3/8" 54.5# J-55 BTC casing to TD and cement to surface in one stage.

Drill 12-1/4" hole to ~8,925' with cut brine emulsion. Run 9-5/8 40# L-80 BTC to TD and cement to surface in two stages.

Drill 8-3/4" vertical hole, curve & lateral to 19713' with OBM. Run 5-1/2" 20# P110 BTC casing from TD to surface and cement to 8425' in one stage.

Well Control

<u>Type</u>	<u>Working Pressure</u>	<u>Test Pressure</u>	<u>Manufacture</u>
Double Ram	5000 psi	5000 psi	Cameron