

UNITED STATES  
DEPARTMENT OF THE INTERIOR  
BUREAU OF LAND MANAGEMENTFORM APPROVED  
OMB NO. 1004-0137  
Expires: January 31, 2018

## SUNDRY NOTICES AND REPORTS ON WELLS

Do not use this form for proposals to drill or to re-enter an abandoned well. Use form 3160-3 (APD) for such proposals.

5. Lease Serial No.  
NMNM104730

6. If Indian, Allottee or Tribe Name

7. If Unit or CA/Agreement, Name and/or No.

8. Well Name and No.  
SUNDANCE FEDERAL 49. API Well No.  
30-015-27390-00-S110. Field and Pool or Exploratory Area  
SAND DUNES11. County or Parish, State  
EDDY COUNTY, NM

SUBMIT IN TRIPLICATE - Other instructions on page 2

1. Type of Well

☒ Oil Well ☐ Gas Well ☐ Other2. Name of Operator  
OXY USA INCORPORATEDContact: RYAN NEWPORT  
E-Mail: ryan\_newport@oxy.com3a. Address  
5 GREENWAY PLAZA SUITE 110  
HOUSTON, TX 77046-05213b. Phone No. (include area code)  
Ph: 713-366-51544. Location of Well (Footage, Sec., T., R., M., or Survey Description)  
Sec 5 T24S R31E NWNE 660FNL 1980FEL

## 12. CHECK THE APPROPRIATE BOX(ES) TO INDICATE NATURE OF NOTICE, REPORT, OR OTHER DATA

| TYPE OF SUBMISSION                                   | TYPE OF ACTION                                |   |  |  |
|--|---|---|--|--|
| <input checked="" type="checkbox"/> Notice of Intent | <input type="checkbox"/> Acidize              | <input type="checkbox"/> Deepen               | <input type="checkbox"/> Production (Start/Resume) | <input type="checkbox"/> Water Shut-Off                |
| <input type="checkbox"/> Subsequent Report           | <input type="checkbox"/> Alter Casing         | <input type="checkbox"/> Hydraulic Fracturing | <input type="checkbox"/> Reclamation               | <input type="checkbox"/> Well Integrity                |
| <input type="checkbox"/> Final Abandonment Notice    | <input type="checkbox"/> Casing Repair        | <input type="checkbox"/> New Construction     | <input type="checkbox"/> Recomplete                | <input checked="" type="checkbox"/> Other Right of Way |
|  | <input type="checkbox"/> Change Plans         | <input type="checkbox"/> Plug and Abandon     | <input type="checkbox"/> Temporarily Abandon       |  |
|  | <input type="checkbox"/> Convert to Injection | <input type="checkbox"/> Plug Back            | <input type="checkbox"/> Water Disposal            |  |

13. Describe Proposed or Completed Operation: Clearly state all pertinent details, including estimated starting date of any proposed work and approximate duration. If the proposal is to deepen directionally or recomple horizontally, give subsurface locations and measured and true vertical depths of all pertinent markers and zones. Attach the Bond under which the work will be performed or provide the Bond No. on file with BLM/BIA. Required subsequent reports must be filed within 30 days following completion of the involved operations. If the operation results in a multiple completion or recompletion in a new interval, a Form 3160-4 must be filed testing has been completed. Final Abandonment Notices must be filed only after all requirements, including reclamation, have been completed and the operator has determined that the site is ready for final inspection.

We need a right of entry in order to do geotechnical boring so we can get soil samples for a potential treated water pond in our sand dunes area.

The geotechnical boring will consist of drilling a total of five boreholes that will be 4" in diameter to a depth no greater than 75' based on preliminary design and water level. This will be done using a rubber tired truck mounted air rotary unit to drill these survey holes. They will be backfilling the holes with cuttings from the drilling of each hole and no holes will be open overnight. There will be no blading of terrain or mulching of brush. The only surface disturbance will be from the truck & the backfilled boreholes. This operation will take between 4-6 hours.

This operation will be done in the SWSW of Section 4, T24S-R31E, Eddy County, NM. The attached survey plat shows the location of each of these 5 proposed boreholes labeled with

RECEIVED

JAN 10 2019

Accepted For Record  
NMOCD

14. I hereby certify that the foregoing is true and correct.

Electronic Submission #447420 verified by the BLM Well Information System  
For OXY USA INCORPORATED, sent to the Carlsbad  
Committed to AFMSS for processing by PRISCILLA PEREZ on 12/12/2018 (19PP0598SE)

Name (Printed/Typed) RYAN NEWPORT

Title LANDMAN

Signature (Electronic Submission)

Date 12/12/2018

## THIS SPACE FOR FEDERAL OR STATE OFFICE USE

Approved By

Title

Date

Conditions of approval, if any, are attached. Approval of this notice does not warrant or certify that the applicant holds legal or equitable title to those rights in the subject lease which would entitle the applicant to conduct operations thereon.

Office

Title 18 U.S.C. Section 1001 and Title 43 U.S.C. Section 1212, make it a crime for any person knowingly and willfully to make to any department or agency of the United States any false, fictitious or fraudulent statements or representations as to any matter within its jurisdiction.

(Instructions on page 2)

\*\* BLM REVISED \*\* BLM REVISED \*\* BLM REVISED \*\* BLM REVISED \*\* BLM REVISED \*\*

## **Additional data for EC transaction #447420 that would not fit on the form**

### **32. Additional remarks, continued**

latitude/longitude. The footage calls for each of the boreholes are listed below. You can also see the location with the attached google earth images. One shows Section 4 & the surrounding sections in said township with the proposed operation area outlined in red. The other image shows the proposed boreholes marked with 5 black dots.

Center borehole: 1,326' from south line of section 4 and 1,045' from the west line of section 4.

NE borehole: 1,775' from south line of section 4 and 1,505' from the west line of section 4.

SE borehole: 905' from south line of section 4 and 1,505' from the west line of section 4.

SW borehole: 905' from south line of section 4 and 596' from the west line of section 4.

NW borehole: 1,505' from south line of section 4 and 596' from the west line of section 4.

There will be an arch monitor on site during this operation.

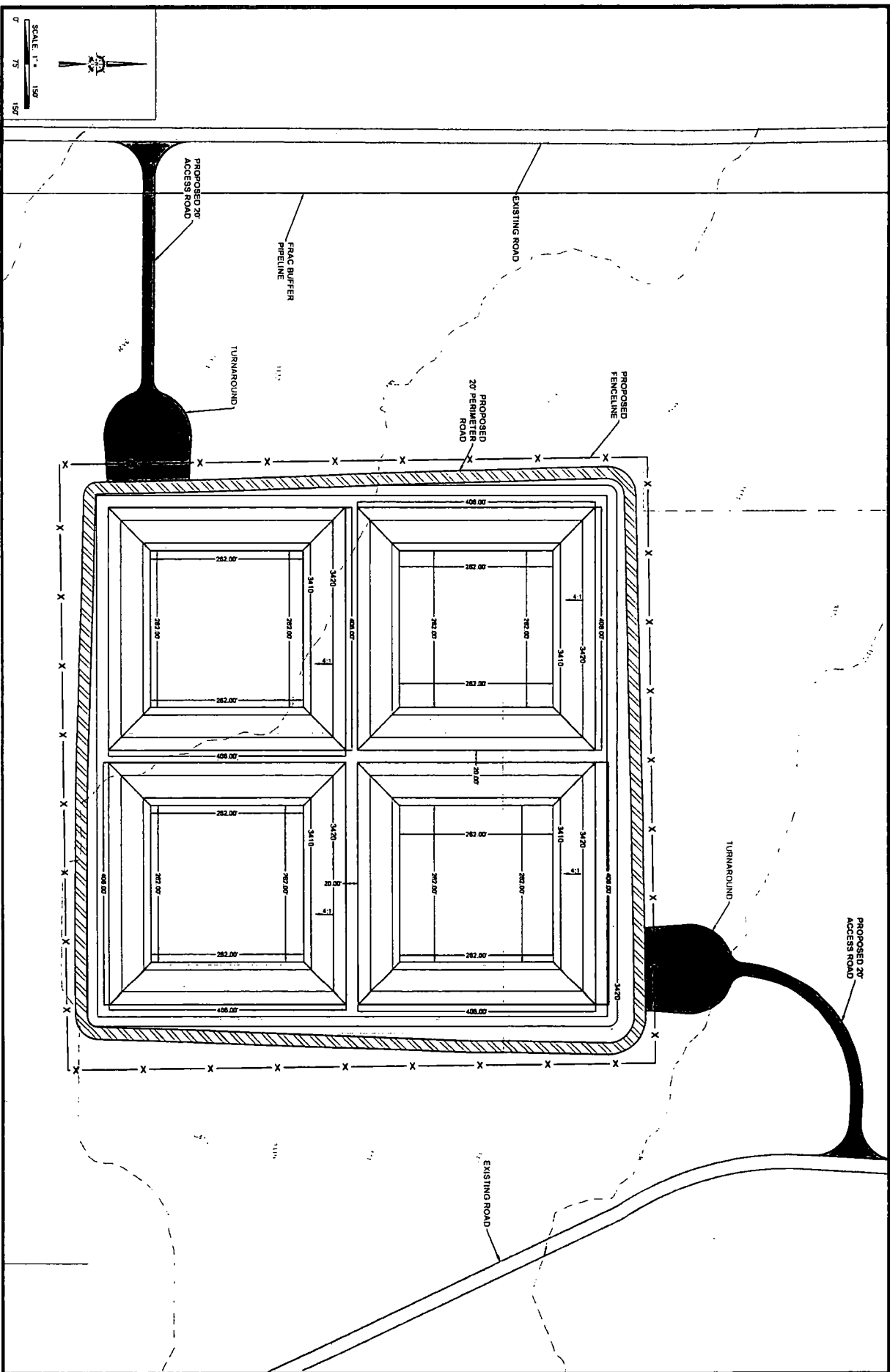

|   |   |   |   |
|---|---|---|---|
| DATE: 04/25/18<br>FILE: SAND_DUNES_POND<br>DRAWN BY: ARG<br>REVIEWED BY: CCC<br>SCALE: 1" = 150'<br>SHEET: 1 OF 2 | REVISION:<br>XXX XX/XX/XXXX<br><br><br><br><br><br> | <h2 style="text-align: center;">POND LAYOUT</h2> <h3 style="text-align: center;">SAND DUNES RECYCLING FACILITY</h3> <h4 style="text-align: center;">FOR</h4> <h3 style="text-align: center;">OXY ENVIRONMENTAL</h3> |  <b>TOPOGRAPHIC</b><br>LOYALTY INNOVATION LEGACY<br><small>1400 EVERMAN PARKWAY, Ste. 148 - FT. WORTH, TEXAS 76140<br/>         TELEPHONE: (817) 744-7512 FAX: (817) 744-7548<br/>         WWW.TOPOGRAPHIC.COM</small> |
|---|---|---|---|

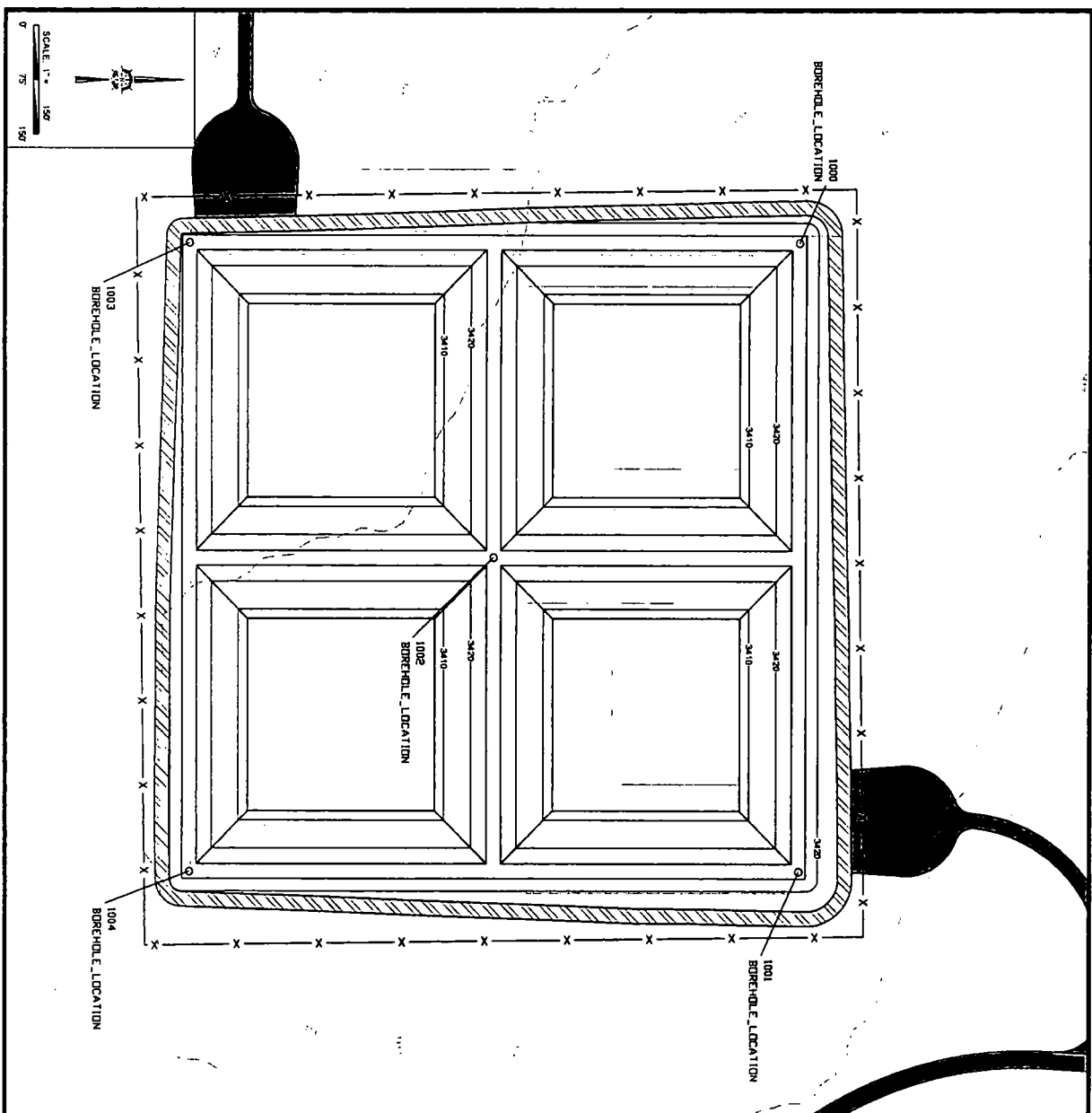

| POINT NUMBER | NORTHING  | EASTING   | LATITUDE     | LONGITUDE     |
|--------------|-----------|-----------|--------------|---------------|
| 1000         | 452843.36 | 706571.35 | 32°14'37.57" | 103°47'21.05" |
| 1001         | 452843.36 | 710423.35 | 32°14'37.53" | 103°47'11.13" |
| 1002         | 452416.89 | 706996.61 | 32°14'33.33" | 103°47'16.13" |
| 1003         | 451981.36 | 706571.35 | 32°14'28.14" | 103°47'21.10" |
| 1004         | 452891.36 | 710423.35 | 32°14'28.10" | 103°47'11.18" |

|              |                 |
|--------------|-----------------|
| DATE:        | 04/25/18        |
| FILE:        | SAND_DUNES_POND |
| DRAWN BY:    | ARG             |
| REVIEWED BY: | CCC             |
| SCALE:       | 1" = 150'       |
| SHEET:       | 2 OF 2          |

# BORE HOLE LOCATIONS SAND DUNES RECYCLING FACILITY FOR OXY ENVIRONMENTAL

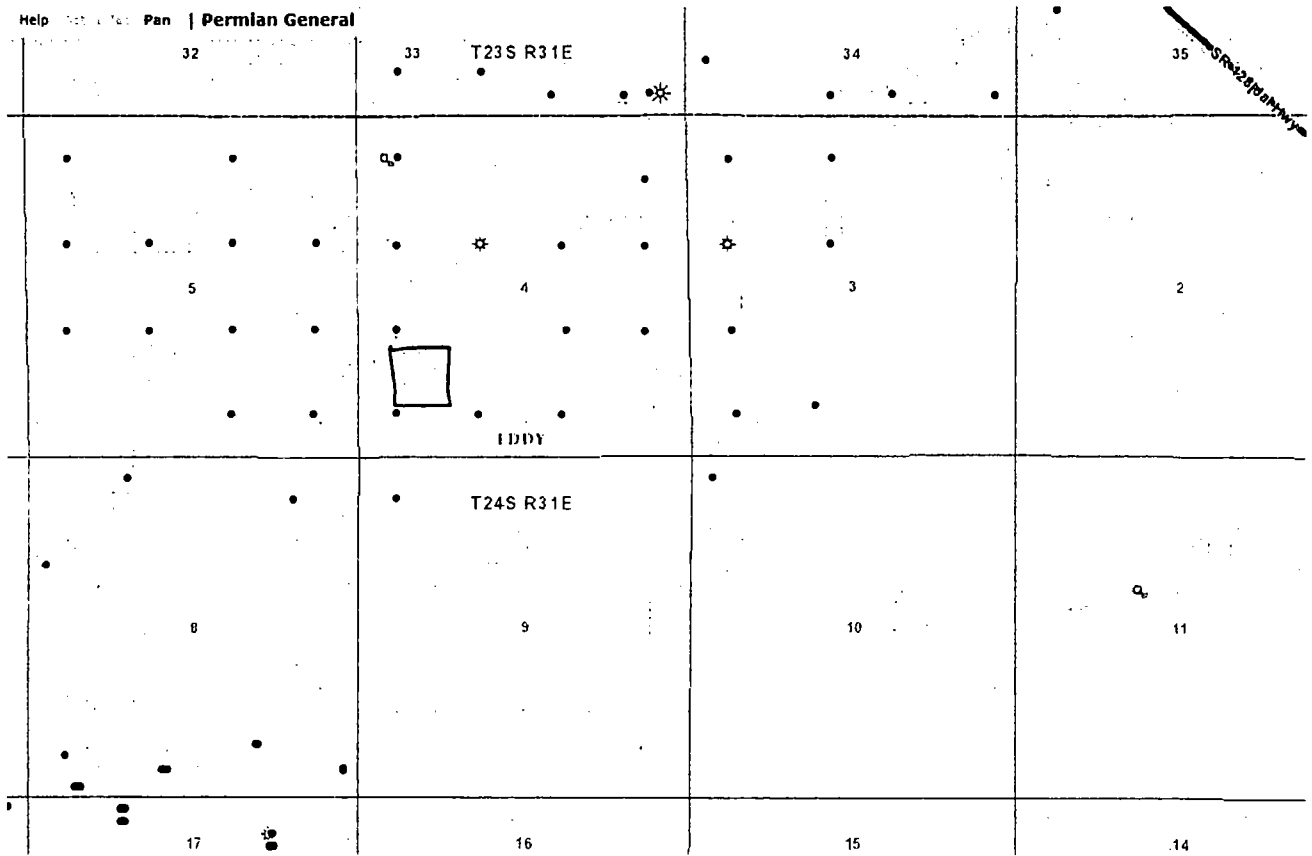

**NEPA COMPLIANCE RECORD FOR CATEGORICAL EXCLUSION (CX)**  
**Bureau of Land Management (BLM) Office: Carlsbad Field Office (CFO)**  
**IT4RM-P020-2019-0225-CX**  
**Sundance Federal 4**  
**Serial Number: NMNM104730**

**Proposed Action:**

The proposed action is located in Eddy County, New Mexico.

T. 024S R. 031E Section .004

**Authority of this action is Mineral Leasing Act of February 25, 1920, (30 U.S.C. 185), as amended**

**Part I: PLAN CONFORMANCE REVIEW.**

This proposed action is subject to the Carlsbad Resource Area Resource Management Plan/Final Environmental Impact Statement (RMP/FEIS, BLM February 1986) and the Carlsbad Resource Area Resource Management Plan Amendment/Final Environmental Impact Statement (RMPA/FEIS, BLM January 1997), which were approved as the Final RMP and RMPA for the BLM-CFO by the Record of Decisions (ROD) signed September 30, 1988 and October 10, 1997, respectively. The proposed action has been reviewed and determined to be consistent with these plans (43 CFR 1610.5).

The Carlsbad Field Office utilizes a resource conflict map that was prepared by an interdisciplinary team showing areas of concern. These areas of concern include special management areas (SMA), threatened & endangered (T&E) habitat, known locations of T&E species, areas with other special status species, wildlife habitat projects, riparian/wetland areas, 100-year floodplains, etc. The conflict map is reviewed and the author of the EA signs off the projects outside the areas of concern. The projects that occur in the areas of concern depicted on the map are reviewed and signed off only by the resource specialist with the expertise for that area.

Reviewed by: Jesse Bassett

Date: 12-12-2012

**PART II: CATEGORICAL EXCLUSION REVIEW**

This proposed action qualifies as a categorical exclusion under 516 DM 11, Energy Act.

**The proposed action has been reviewed against the following exceptions to individual categorical exclusions (516 DM 2, Appendix 2).**

| Yes | No | Exception |
|-----|----|-----------|
|-----|----|-----------|

|  |   |  |
|--|---|--|
|  | x | Have significant adverse effects on public health and safety.  |
|  | x | Have adverse effects on such unique geographic characteristics as historic or cultural resources, park, recreation, or refuge lands, wilderness areas, wild or scenic rivers, sole or principle drinking water aquifers, prime farmlands, wetlands, floodplains, or ecologically significant or critical areas, including those listed on the Department's National Register of Natural Landmarks. |
|  | x | Have highly controversial environmental effects.   |
|  | x | Have highly uncertain and potentially significant environmental effects or involve unique or unknown environmental risks.  |
|  | x | Establish a precedent for future actions or represent a decision in principle about future actions with potentially significant environmental effects.   |
|  | x | Be directly related to other actions with individually insignificant but cumulatively significant environmental effects.   |
|  | x | Have adverse effects on properties listed or eligible for listing on the National Register of Historic Places.   |
|  | x | Have adverse effects on species listed or proposed to be listed on the List of Endangered or Threatened Species, or have adverse effects on designated critical habitat for these species.   |
|  | x | Require compliance with Executive Order 11988 (Floodplain Management), Executive Order 11990 (Protection of Wetlands), or the Fish and Wildlife Coordination Act.  |
|  | x | Threaten to violate a Federal, State, Local Government or Tribal law or requirement imposed for the protection of the environment.   |
|  | x | Limit access to and ceremonial use of Indian sacred sites on Federal lands by Indian religious practitioners or significantly adversely affect the physical integrity of such sacred sites (Executive Order 13007).  |
|  | x | Contribute to the introduction, continued existence, or spread of noxious weeds, or non-native invasive species known to occur in the area or actions that may promote the introduction, growth, or expansion of the range of such species (Federal Noxious Weed Control Act and Executive Order 13112).   |

Remarks:

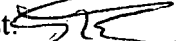
Archaeologist: 

Date: 12/12/18

Reviewed by Jesse Bassett

Date: 12-12-18

### PART III. DECISION

Based on the review documented above, I conclude that this proposal conforms to the applicable land use planning document(s) and that this NEPA documentation fully covers the proposed action and constitutes BLM's compliance with the requirements of NEPA and that no further environmental analysis is required. It is my decision to implement the proposed action, as described, with the following stipulations/mitigation measures to be applied.

Authority of this action is Mineral Leasing Act of February 25, 1920, (30 U.S.C. 185), as amended.

Stipulations/Mitigations:

Authorized Official:

  
\_\_\_\_\_

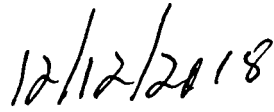
  
\_\_\_\_\_  
Date

 Carlsbad Field Office Manager



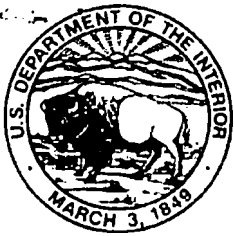

**Bureau of Land Management, Carlsbad Field Office**  
620 E. Greene Street Carlsbad, NM 88220

Cultural and Archaeological Resources

IT4RM NEPA Log  
2019-0225-CX

**NOTICE OF STIPULATIONS**

**Historic properties in the vicinity of this project are protected by federal law. In order to ensure that they are not damaged or destroyed by construction activities, the project proponent and construction supervisors shall ensure that the following stipulations are implemented.**

|  |   |
|--|---|
| <b>Project Name:</b>                   | Sundance Federal 4, Oxy USA Inc.  |
|  | <b><u>1). A 3-day preconstruction call-in notification.</u></b> Contact BLM Inspection and Enforcement at   |
| <b>Required</b>                        | <b><u>2. Professional archaeological monitoring.</u></b> Contact your BLM project archaeologist at (575) 234-6231 for assistance.   |
| A. <input checked="" type="checkbox"/> | These stipulations must be given to your monitor at least <b>5 days</b> prior to the start of construction.   |
| B. <input checked="" type="checkbox"/> | No construction, including vegetation removal or other site prep may begin prior to the arrival of the monitor.   |
|  | <b><u>3. Cultural site barrier fencing.</u></b> (Your monitor will assist you).   |
| A. <input type="checkbox"/>            | <b><u>A temporary site protection barrier(s)</u></b> shall be erected prior to all ground-disturbing activities. The minimum barrier(s) shall consist of upright wooden survey lath spaced no more than ten (10) feet apart and marked with blue ribbon flagging or blue paint. There shall be no construction activities or vehicular traffic past the barrier(s) at any time. |
| B. <input type="checkbox"/>            | <b><u>A permanent, 4-strand barbed wire fence</u></b> strung on standard "T-posts" shall be erected prior to all ground-disturbing activities. No construction activities or vehicle traffic are allowed past the fence.  |
| <b>Required</b>                        | <b><u>4. The archaeological monitor shall:</u></b>  |
| A. <input type="checkbox"/>            |   |
| B. <input checked="" type="checkbox"/> | Observe all ground-disturbing activities.   |
| C. <input type="checkbox"/>            | Ensure that the proposed  |
| D. <input type="checkbox"/>            | Ensure the proposed reroute for the .   |
| E. <input checked="" type="checkbox"/> | Submit a brief monitoring report within 30 days of completion of monitoring.  |
|  | If any skeletal remains that might be human or funerary objects, or other significant subsurface cultural resources are encountered during the monitoring, all activities shall cease and a BLM-CFO archaeologist shall be notified immediately.  |
| <b>Other:</b>                          | <b>IF THE CONTRACT ARCHAEOLOGIST DOES NOT KNOW WHERE THE SITE(S) ARE LOCATED AT PLEASE COME BY THE CARLSBAD BLM AND MAPS AND OTHER DATA WILL BE PROVIDED UPON REQUEST TO THE CONTRACT ARCHAEOLOGIST</b>   |

**Site Protection and Employee Education:** It is the responsibility of the project proponent and his construction supervisor to inform all employees and subcontractors that cultural and archaeological sites are to be avoided by all personnel, vehicles, and equipment; and that it is illegal to collect, damage, or disturb cultural resources on Public Lands.

For assistance contact: Bruce Boeke (575) 234-5917

Elia Perez (575) 234-6231  
Aaron Whaley (575) 234-5986  
Garrett Leitermann (575) 234-2239