

FEB 12 2019

District I
1625 N. French Dr., Hobbs, NM 88240
District II
811 S. First St., Artesia, NM 88210
District III
1000 Rio Brazos Road, Aztec, NM 87410
District IV
1220 S. St. Francis Dr., Santa Fe, NM 87505

State of New Mexico
Energy, Minerals and Natural Resources Department

Oil Conservation Division
1220 South St. Francis Dr.
Santa Fe, NM 87505

DISTRICT II-ARTESIA O.C.B.

Submit Original
to Appropriate
District Office

GAS CAPTURE PLAN

Date: 07-30-2018☒ OriginalOperator & OGRID No.: OXY USA INC. - 16696☐ Amended - Reason for Amendment: _____

This Gas Capture Plan outlines actions to be taken by the Operator to reduce well/production facility flaring/venting for new completion (new drill, recomple to new zone, re-frac) activity.

Note: Form C-129 must be submitted and approved prior to exceeding 60 days allowed by Rule (Subsection A of 19.15.18.12 NMAC).

Well(s)/Production Facility – Name of facility

The well(s) that will be located at the production facility are shown in the table below.

| Well Name | API | Well Location (ULSTR) | Footages | Expected MCF/D | Flared or Vent | Comments |
|--|---------|-----------------------|---------------------|----------------|----------------|----------|
| Pure Gold MDP1 29-17 Fd Com 1H | Pending | M-29-23S-31E | 690 FSL 920 FWL | 3900 | | |
| Pure Gold MDP1 29-17 Fd Com 2H | Pending | M-29-23S-31E | 690 FSL 1025 FWL | 3900 | | |
| Pure Gold MDP1 29-17 Fd Com 171H 30-015-45716 | Pending | M-29-23S-31E | 690 FSL 955 FWL | 3100 | | |
| Pure Gold MDP1 29-17 Fd Com 172H | Pending | M-29-23S-31E | 690 FSL 990 FWL | 3100 | | |

Gathering System and Pipeline Notification

Well(s) will be connected to a production facility after flowback operations are complete, where a gas transporter system is in place. The gas produced from production facility is dedicated to Enterprise Field Services, LLC ("Enterprise") and is connected to Enterprise low/high pressure gathering system located in Eddy County, New Mexico. OXY USA INC. ("OXY") provides (periodically) to Enterprise a drilling, completion and estimated first production date for wells that are scheduled to be drilled in the foreseeable future. In addition, OXY and Enterprise have periodic conference calls to discuss changes to drilling and completion schedules. Gas from these wells will be processed at Enterprise's Processing Plant located in Sec. 36, Twn. 24S, Rng. 30E, Eddy County, New Mexico. The actual flow of the gas will be based on compression operating parameters and gathering system pressures.

Flowback Strategy

After the fracture treatment/completion operations, well(s) will be produced to temporary production tanks and gas will be flared or vented. During flowback, the fluids and sand content will be monitored. When the produced fluids contain minimal sand, the wells will be turned to production facilities. Gas sales should start as soon as the wells start flowing through the production facilities, unless there are operational issues on Enterprise system at that time. Based on current information, it is OXY's belief the system can take this gas upon completion of the well(s).

Safety requirements during cleanout operations from the use of underbalanced air cleanout systems may necessitate that sand and non-pipeline quality gas be vented and/or flared rather than sold on a temporary basis.

Alternatives to Reduce Flaring

Below are alternatives considered from a conceptual standpoint to reduce the amount of gas flared.

- Power Generation – On lease
 - Only a portion of gas is consumed operating the generator, remainder of gas will be flared
- Compressed Natural Gas – On lease
 - Gas flared would be minimal, but might be uneconomical to operate when gas volume declines
- NGL Removal – On lease
 - Plants are expensive, residue gas is still flared, and uneconomical to operate when gas volume declines

SECTIONS 29, 20 & 17, TOWNSHIP 23 SOUTH, RANGE 31 EAST, N.M.P.M.,
EDDY COUNTY
NEW MEXICO

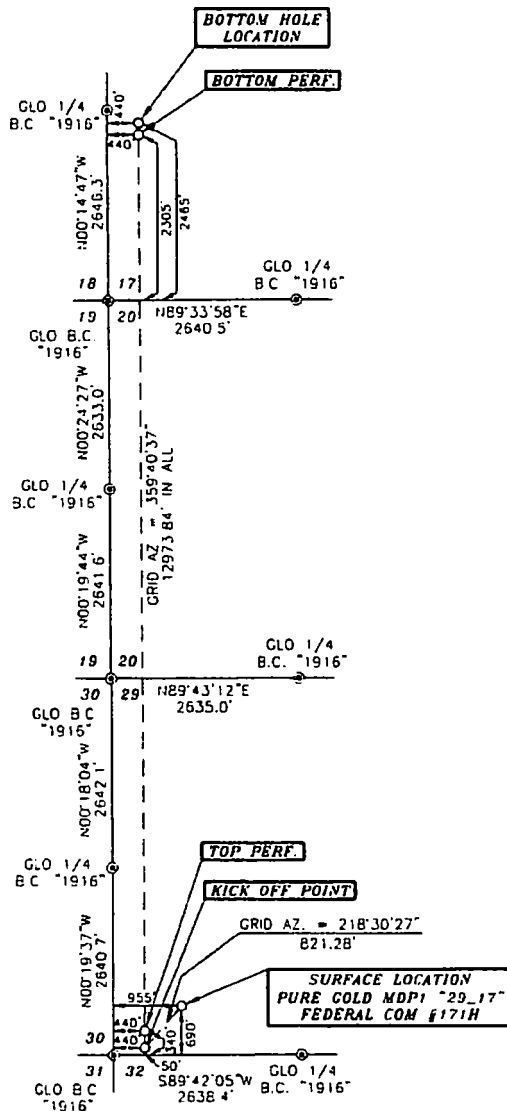

DRIVING DIRECTIONS:
 BEGINNING AT THE INTERSECTION OF
 N.M. STATE HWY. #128 AND EDDY
 COUNTY ROAD #787 (TWIN WELLS
 ROAD), GO SOUTHEAST ON N.M. STATE
 HWY. #128 FOR 1.1 MILES, TURN RIGHT
 ON CALICHE ROAD AND GO SOUTH FOR
 1.4 MILES, TURN RIGHT AND GO WEST
 FOR 0.8 MILES, TURN RIGHT ON
 PROPOSED ROAD AND GO NORTH FOR
 280.0 FEET TO LOCATION.

Bears of Bearings - GPS Geodetic Measurements
 NAD 83 Zone 10B North American Datum of 1983



SURVEYORS CERTIFICATE

I, TERRY J. ASEL, NEW MEXICO PROFESSIONAL SURVEYOR
 NO. 15079, DO HEREBY CERTIFY THAT I CONDUCTED AND AM
 RESPONSIBLE FOR THIS SURVEY, THAT THIS SURVEY IS
 TRUE AND CORRECT TO THE BEST OF MY KNOWLEDGE AND
 BELIEF, AND MEETS THE "MINIMUM STANDARDS FOR
 SURVEYING IN NEW MEXICO" AS ADOPTED BY THE NEW
 MEXICO STATE BOARD OF REGISTRATION FOR
 PROFESSIONAL ENGINEERS AND SURVEYORS

Terry J. Asel 4/10/2018
 Terry J. Asel, N.M. R.P.L.S. No. 15079

Asel Surveying

P.O. BOX 303 - 310 W TAYLOR
 HOBBS, NEW MEXICO - 575-393-9146



LEGEND

• DENOTES FOUND MONUMENT AS NOTED

2000' 0' 2000' 4000' FEET
 SCALE: 1"=2000'

OXY USA INC.

PURE GOLD MDP1 "29_17" FEDERAL COM #171H
 LOCATED AT 690' FSL & 955' FWL IN SECTION
 29, TOWNSHIP 23 SOUTH, RANGE 31 EAST,
 N.M.P.M., EDDY COUNTY, NEW MEXICO

| | |
|-------------------------|----------------------------|
| Survey Date: 04/10/18 | Sheet 1 of 1 Sheets |
| W.O. Number: 180410WL-d | Drawn By: KA Rev: |
| Date: 05/30/18 | 180410WL-d Scale: 1"=2000' |