

District I  
1625 N. French Dr., Hobbs, NM 88240  
District II  
811 S. First St., Artesia, NM 88210  
District III  
1000 Rio Brazos Road, Aztec, NM 87410  
District IV  
1220 S. St. Francis Dr., Santa Fe, NM 87505

State of New Mexico  
Energy, Minerals and Natural Resources Department

Oil Conservation Division  
1220 South St. Francis Dr.  
Santa Fe, NM 87505

RECEIVED

FEB 12 2019

Submit Original  
to Appropriate  
District Office

DISTRICT II-ARTESIA O.C.D.

## GAS CAPTURE PLAN

Date: 07-30-2018

☒ Original

Operator & OGRID No.: OXY USA INC. - 16696

☐ Amended - Reason for Amendment: \_\_\_\_\_

This Gas Capture Plan outlines actions to be taken by the Operator to reduce well/production facility flaring/venting for new completion (new drill, recomple to new zone, re-frac) activity.

*Note: Form C-129 must be submitted and approved prior to exceeding 60 days allowed by Rule (Subsection A of 19.15.18.12 NMAC).*

### Well(s)/Production Facility – Name of facility

The well(s) that will be located at the production facility are shown in the table below.

Well Name	API	Well Location (ULSTR)	Footages	Expected MCF/D	Flared or Vent	Comments
Pure Gold MDP1 29-17 Fd Com 1H	Pending	M-29-23S-31E	690 FSL 920 FWL	3900		
Pure Gold MDP1 29-17 Fd Com 2H	Pending	M-29-23S-31E	690 FSL 1025 FWL	3900		
Pure Gold MDP1 29-17 Fd Com 171H	Pending	M-29-23S-31E	690 FSL 955 FWL	3100		
Pure Gold MDP1 29-17 Fd Com 172H	Pending	M-29-23S-31E	690 FSL 990 FWL	3100		

### Gathering System and Pipeline Notification

Well(s) will be connected to a production facility after flowback operations are complete, where a gas transporter system is in place. The gas produced from production facility is dedicated to Enterprise Field Services, LLC ("Enterprise") and is connected to Enterprise low/high pressure gathering system located in Eddy County, New Mexico. OXY USA INC. ("OXY") provides (periodically) to Enterprise a drilling, completion and estimated first production date for wells that are scheduled to be drilled in the foreseeable future. In addition, OXY and Enterprise have periodic conference calls to discuss changes to drilling and completion schedules. Gas from these wells will be processed at Enterprise's Processing Plant located in Sec. 36, Twn. 24S, Rng. 30E, Eddy County, New Mexico. The actual flow of the gas will be based on compression operating parameters and gathering system pressures.

### Flowback Strategy

After the fracture treatment/completion operations, well(s) will be produced to temporary production tanks and gas will be flared or vented. During flowback, the fluids and sand content will be monitored. When the produced fluids contain minimal sand, the wells will be turned to production facilities. Gas sales should start as soon as the wells start flowing through the production facilities, unless there are operational issues on Enterprise system at that time. Based on current information, it is OXY's belief the system can take this gas upon completion of the well(s).

Safety requirements during cleanout operations from the use of underbalanced air cleanout systems may necessitate that sand and non-pipeline quality gas be vented and/or flared rather than sold on a temporary basis.

### Alternatives to Reduce Flaring

Below are alternatives considered from a conceptual standpoint to reduce the amount of gas flared.

- Power Generation – On lease
  - Only a portion of gas is consumed operating the generator, remainder of gas will be flared
- Compressed Natural Gas – On lease
  - Gas flared would be minimal, but might be uneconomical to operate when gas volume declines
- NGL Removal – On lease
  - Plants are expensive, residue gas is still flared, and uneconomical to operate when gas volume declines

SECTIONS 29, 20 & 17, TOWNSHIP 23 SOUTH, RANGE 31 EAST, N.M.P.M.,  
EDDY COUNTY NEW MEXICO

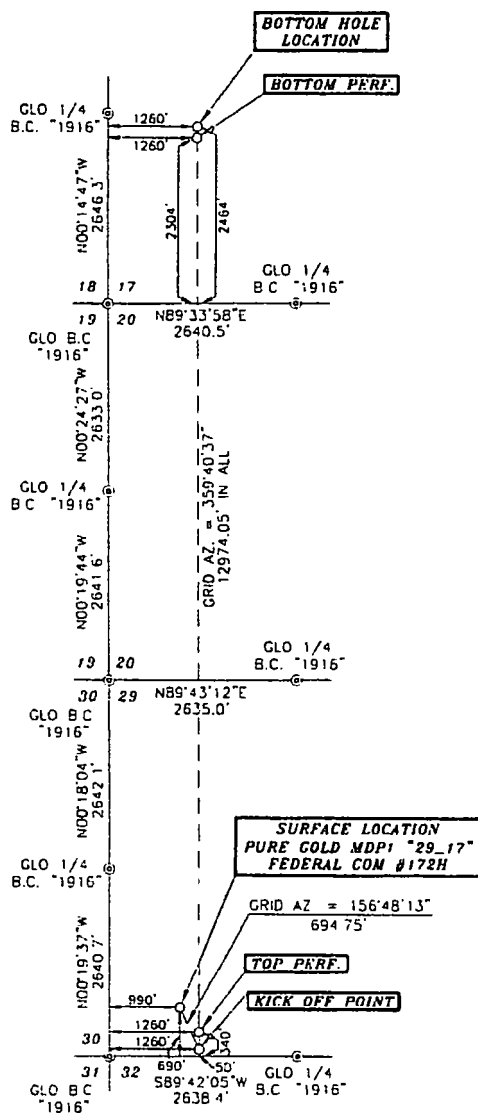

DRIVING DIRECTIONS:  
BEGINNING AT THE INTERSECTION OF  
N.M. STATE HWY. #128 AND EDDY  
COUNTY ROAD #787 (TWIN WELLS  
ROAD), GO SOUTHEAST ON N.M. STATE  
HWY #128 FOR 1.1 MILES, TURN RIGHT  
ON CALICHE ROAD AND GO SOUTH FOR  
1.4 MILES, TURN RIGHT AND GO WEST  
FOR 0.8 MILES, TURN RIGHT ON  
PROPOSED ROAD AND GO NORTH FOR  
280.0 FEET TO LOCATION



**SURVEYORS CERTIFICATE**

I, TERRY J. ASEL, NEW MEXICO PROFESSIONAL SURVEYOR  
NO. 15079, DO HEREBY CERTIFY THAT I CONDUCTED AND AM  
RESPONSIBLE FOR THIS SURVEY. THAT THIS SURVEY IS  
TRUE AND CORRECT TO THE BEST OF MY KNOWLEDGE AND  
BELIEF, AND MEETS THE "MINIMUM STANDARDS FOR  
SURVEYING IN NEW MEXICO" AS ADOPTED BY THE NEW  
MEXICO STATE BOARD OF REGISTRATION FOR  
PROFESSIONAL ENGINEERS AND SURVEYORS

*Terry J. Asel*  
Terry J. Asel, N.M. P.E.S. No. 15079

Asel Surveying

P.O. BOX 393 - 310 W. TAYLOR  
HOBBS, NEW MEXICO - 575-393-9146



**LEGEND**

• - DENOTES FOUND MONUMENT AS NOTED

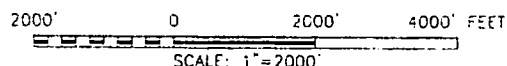

**OXY USA INC.**

PURE GOLD MDP1 "29\_17" FEDERAL COM #172H  
LOCATED AT 690' FSL & 990' FWL IN SECTION  
29, TOWNSHIP 23 SOUTH, RANGE 31 EAST,  
N.M.P.M., EDDY COUNTY, NEW MEXICO

Survey Date: 04/10/18	Sheet 1 of 1 Sheets
W.O. Number: 180410WL-e	Drawn By: KA Rev:
Date: 05/30/18	180410WL-e Scale: 1"=2000'