

# NM OIL CONSERVATION

ARTESIA DISTRICT

State of New Mexico

Energy, Minerals & Natural Resources Department

OIL CONSERVATION DIVISION

RECEIVED 1220 South St. Francis SEP 25 2017  
Santa Fe, New Mexico 87505

Form C-102

Revised August 1, 2011

Submit one copy to appropriate  
District Office

AMENDED REPORT

DISTRICT I  
1625 N. French Dr., Hobbs, NM 88240  
Phone: (575) 393-6161 Fax: (575) 393-0720  
DISTRICT II  
811 S. First St., Artesia, NM 88210  
Phone: (575) 748-1283 Fax: (575) 748-9720  
DISTRICT III  
1000 Rio Brazos Road, Aztec, NM 87410  
Phone: (505) 334-6178 Fax: (505) 334-6170  
DISTRICT IV  
1220 S. St. Francis Dr., Santa Fe, NM 87505  
Phone: (505) 476-3460 Fax: (505) 476-3462

## WELL LOCATION AND ACREAGE DEDICATION PLAT

|                                   |   |   |
|-----------------------------------|---|---|
| API Number<br><b>30-015-43555</b> | Pool Code<br><b>98220</b>                       | Pool Name<br><b>Purple Sage; Wolfcamp</b> |
| Property Code<br><b>314249</b>    | Property Name<br><b>FOREHAND RANCH 22 STATE</b> | Well Number<br><b>8H</b>                  |
| OGRID No.<br><b>249099</b>        | Operator Name<br><b>CAZA OPERATING, LLC</b>     | Elevation<br><b>3149'</b>                 |

### Surface Location

| UL or lot No. | Section   | Township    | Range       | Lot Idn | Feet from the | North/South line | Feet from the | East/West line | County      |
|---------------|-----------|-------------|-------------|---------|---------------|------------------|---------------|----------------|-------------|
| <b>K</b>      | <b>22</b> | <b>23-S</b> | <b>27-E</b> |         | <b>2310</b>   | <b>SOUTH</b>     | <b>2080</b>   | <b>WEST</b>    | <b>EDDY</b> |

### Bottom Hole Location If Different From Surface

| UL or lot No. | Section   | Township    | Range       | Lot Idn | Feet from the | North/South line | Feet from the | East/West line | County      |
|---------------|-----------|-------------|-------------|---------|---------------|------------------|---------------|----------------|-------------|
| <b>N</b>      | <b>27</b> | <b>23-S</b> | <b>27-E</b> |         | <b>304</b>    | <b>SOUTH</b>     | <b>781</b>    | <b>WEST</b>    | <b>EDDY</b> |

| Dedicated Acres | Joint or Infill | Consolidation Code | Order No. |
|-----------------|-----------------|--------------------|-----------|
| <b>480</b>      |                 |                    |           |

NO ALLOWABLE WILL BE ASSIGNED TO THIS COMPLETION UNTIL ALL INTERESTS HAVE BEEN CONSOLIDATED OR A NON-STANDARD UNIT HAS BEEN APPROVED BY THE DIVISION

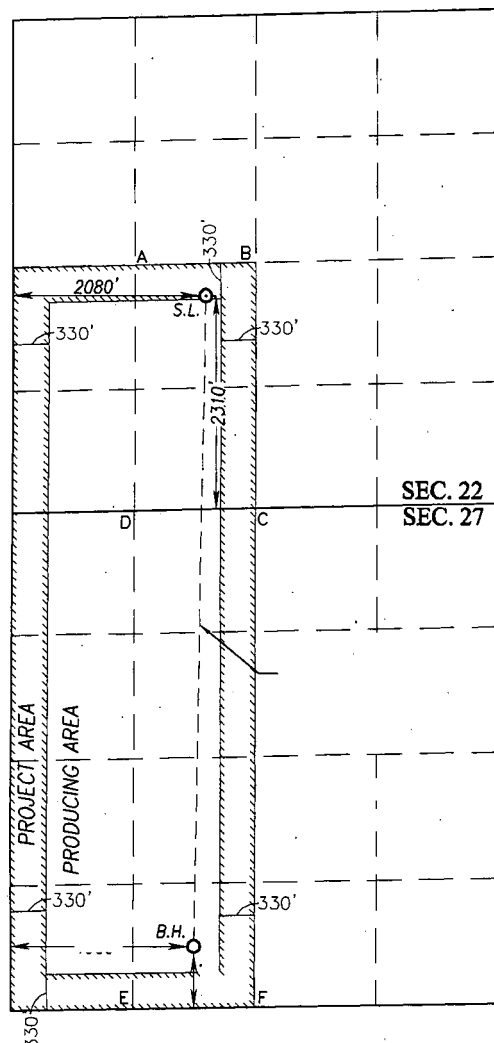

SCALE: 1"=2000'

GEODETIC COORDINATES  
NAD 83 NME  
SURFACE LOCATION  
Y= 469113.5 N  
X= 588792.9 E  
LAT.=32.289573° N  
LONG.=104.179761° W

GEODETIC COORDINATES  
NAD 27 NME  
SURFACE LOCATION  
Y= 469054.7 N  
X= 547610.6 E  
LAT.=32.289454° N  
LONG.=104.179262° W

### OPERATOR CERTIFICATION

I hereby certify that the information herein is true and complete to the best of my knowledge and belief, and that this organization either owns a working interest or unleased mineral interest in the land including the proposed bottom hole location or has a right to drill this well at this location pursuant to a contract with an owner of such mineral or working interest, or to a voluntary pooling agreement or a compulsory pooling order heretofore entered by the division.

Signature: *Steve Morris* Date: **09/22/2017**

Printed Name: **Steve Morris**

E-mail Address: **steve.morris@mojoenergy.com**

### SURVEYOR CERTIFICATION

I hereby certify that the well location shown on this plat was plotted from field notes of actual surveys made by me or under my supervision, and that the same is true and correct to the best of my belief.

REVISED MARCH 14, 2017  
NOVEMBER 5, 2015

Date of Survey: **04/27/2017**  
Signature & Seal of Professional Surveyor:

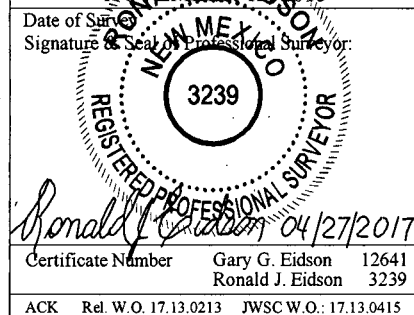

Certificate Number: **12641**  
Ronald J. Eidson: **3239**

ACK Rel. W.O. 17.13.0213 JWSC W.O.: 17.13.0415

BOTTOM HOLE LOCATION  
NAD 83 NME  
Y=461799.52  
X=588775.45  
Lat=32.269468°N  
Long=104.179851°W