

District I
1625 N. French Dr., Hobbs, NM 88240
District II
1301 W. Grand Avenue, Artesia, NM 88210
District III
1000 Rio Brazos Road, Aztec, NM 87410
District IV
1220 S. St. Francis Dr., Santa Fe, NM 87505

State of New Mexico
Energy Minerals and Natural Resources

Form C-101
May 27, 2004

Oil Conservation Division
1220 South St. Francis Dr.
Santa Fe, NM 87505

RECEIVED

Submit to appropriate District Office

APR 26 2006

☐ AMENDED REPORT

APPLICATION FOR PERMIT TO DRILL, RE-ENTER, DEEPEN, PLUGBACK, OR ADD A ZONE

¹ Operator Name and Address Samson Resources Company 200 N. Loraine Street, Ste 1010 Midland, TX 79701		² OGRID Number 20165
		³ API Number 30-015-23729
⁴ Property Code 9912	⁵ Property Name Loving 1 State	⁶ Well No. 1
⁹ Proposed Pool 1 Black River East (Wolfcamp)		¹⁰ Proposed Pool 2

⁷ Surface Location

UL or lot no.	Section	Township	Range	Lot Idn	Feet from the	North/South line	Feet from the	East/West line	County
B	1	24S	27E		990	North	1980	East	Eddy

⁸ Proposed Bottom Hole Location If Different From Surface

UL or lot no.	Section	Township	Range	Lot Idn	Feet from the	North/South line	Feet from the	East/West line	County

Additional Well Information

¹¹ Work Type Code P	¹² Well Type Code G	¹³ Cable/Rotary	¹⁴ Lease Type Code S	¹⁵ Ground Level Elevation 3114
¹⁶ Multiple No	¹⁷ Proposed Depth 12158	¹⁸ Formation Morrow	¹⁹ Contractor	²⁰ Spud Date 4/17/1981
Depth to Groundwater		Distance from nearest fresh water well		Distance from nearest surface water
Pit: Liner: Synthetic <input type="checkbox"/> _____ mils thick Clay <input type="checkbox"/> Pit Volume: _____ bbls Drilling Method: _____				
Closed-Loop System <input type="checkbox"/> Fresh Water <input type="checkbox"/> Brine <input type="checkbox"/> Diesel/Oil-based <input type="checkbox"/> Gas/Air <input type="checkbox"/>				

²¹ Proposed Casing and Cement Program

Hole Size	Casing Size	Casing weight/foot	Setting Depth	Sacks of Cement	Estimated TOC

²² Describe the proposed program. If this application is to DEEPEN or PLUG BACK, give the data on the present productive zone and proposed new productive zone. Describe the blowout prevention program, if any. Use additional sheets if necessary.

ND tree, NU BOP
POH
Dump 35' cmt on CIBP @ 11490'
Set CIBP @ 11170' and dump 35' cmt.
Perforate Wolfcamp (10381-88', 10397-416', 10422-24', 10432-35' - - 62 holes).
GIH w/pkr
Acdz Wolfcamp (10381-435') w/5000 gal 15% NEFE.
If warranted frac Wolfcamp (10381-435') w/apprx 100,000 gal XL 2% KCl and 150,000 M#
Set RBP @ 10290'
Perforate Wolfcamp (9850-10261'). Proposed perfs: 9850, 57, 64; 10123, 33, 58, 87; 10245, 48, 59, 61
GIH w/pkr
Acdz Wolfcamp (9850-10261) w/5000 gal 15% NEFE. (Recompletion Procedure Continued on Attached)

²³ I hereby certify that the information given above is true and complete to the best of my knowledge and belief. I further certify that the drilling pit will be constructed according to NMOCD guidelines ☐, a general permit ☐, or an (attached) alternative OCD-approved plan ☐.

Printed name: Ken Krawietz
Title: District Engineer
E-mail Address: kkrawietz@samson.com

Date: 4/25/2006

Phone: (432) 683-7063

OIL CONSERVATION DIVISION

Approved by:

BRYAN G. ARRANT
DISTRICT II GEOLOGIST

Title:

Approval Date: APR 27 2006

Expiration Date: APR 27 2007

Conditions of Approval Attached ☐

LOVING 1 STATE #1

Workover Procedure

Recomplete to Wolfcamp

(Continue Form C-101, Item 22)

Release pkr, retrieve RBP and reset @ 9700'.

Perf Wolfcamp 9255 - 9649

9255, 57, 64, 66, 83, 94

9300, 35, 41, 46, 54, 71, 81, 98

9408, 35, 45, 56, 77, 80

9506, 28, 60, 73

9645, 49

Acidize Wolfcamp 9255 - 9649 w/ 5000 gal 15% NEFE.

Release pkr, retrieve RBP and POH.

GIH w/ pkr and set @ 9150.

ND BOP. NU tree.

Kick well off. Flow test.

No H₂S Present

5/3/06 Filed to correct
Operator

MEXICO OIL CONSERVATION COMMISSION
WELL LOCATION AND ACREAGE DEDICATION PLAT

Form C-102
Supersedes C-120
Effective 1-1-81

All distances must be from the outer boundaries of the Section

Operator Samson Resources Co.			Lease Lovina 1 State		Well No. 1
Unit Letter B	Section 1	Township 24 South	Range 27 East	County Eddy	
Actual Footage Location of Well: 990 feet from the North line and 1980 feet from the East line					
Ground Level Elev. 3114.3	Producing Formation Morrow		Pool	Leak-off Area (ac) 320	

- Outline the acreage dedicated to the subject well by colored pencil or hatchure marks on the plat below.
- If more than one lease is dedicated to the well, outline each and identify the ownership thereof (both as to working interest and royalty).
- If more than one lease of different ownership is dedicated to the well, have the interests of all owners been consolidated by communitization, unitization, force-pooling, etc?

☐ Yes ☐ No If answer is "yes," type of consolidation _____

If answer is "no," list the owners and tract descriptions which have actually been consolidated. (Use reverse side of this form if necessary.) _____

No allowable will be assigned to the well until all interests have been consolidated (by communitization, unitization, forced-pooling, or otherwise) or until a non-standard unit, eliminating such interests, has been approved by the Commission.

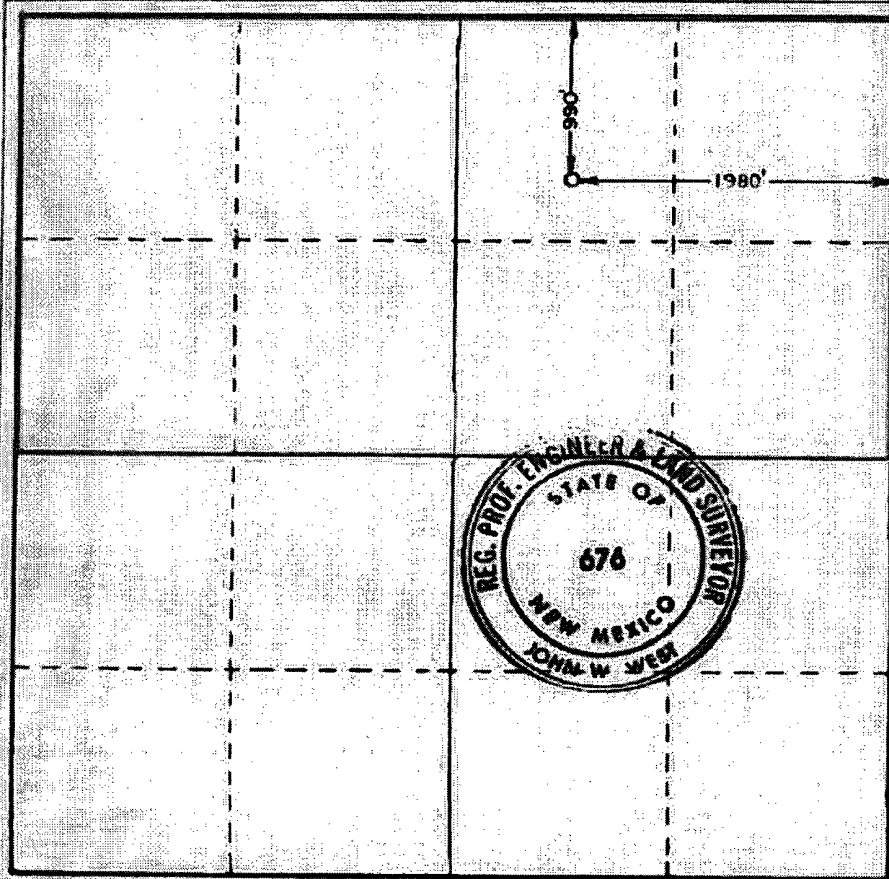

CERTIFICATION

I hereby certify that the information contained herein is true and complete to the best of my knowledge and belief.

John W. Webb

Name
Sp. Landman

Position
Samson Resources

Company
3-27-06

Date

I hereby certify that the well location shown on this plat was plotted from field notes of actual surveys made by me or under my supervision, and that the same is true and correct to the best of my knowledge and belief.

Date Surveyed

3-21-81

Registered Professional Engineer and/or Land Surveyor

John W. Webb

Certificate No. **JOHN W. WEBB 676**
PATRICK A. ROMERO 6688
Donald J. Eldred 3222

**NEW MEXICO OIL CONSERVATION COMMISSION
WELL LOCATION AND ACREAGE DEDICATION PLAT**

Form C-102
Supersedes C-128
Effective 1-1-65

All distances must be from the outer boundaries of the Section.

Operator Samson Resources			Lease Loving 1 State		Well No. 1
Unit Letter B	Section 1	Township 24 South	Range 27 East	County Eddy	
Actual Footage Location of Well:					
990 feet from the North line and		1980 feet from the East line			
Ground Level Elev. 3114.3	Producing Formation Wolfcamp		Pool	Dedicated Acreage: 320 Acres	

1. Outline the acreage dedicated to the subject well by colored pencil or hachure marks on the plat below.
2. If more than one lease is dedicated to the well, outline each and identify the ownership thereof (both as to working interest and royalty).
3. If more than one lease of different ownership is dedicated to the well, have the interests of all owners been consolidated by communitization, unitization, force-pooling, etc?

☐ Yes ☐ No If answer is "yes," type of consolidation _____

If answer is "no," list the owners and tract descriptions which have actually been consolidated. (Use reverse side of this form if necessary.) _____

No allowable will be assigned to the well until all interests have been consolidated (by communitization, unitization, forced-pooling, or otherwise) or until a non-standard unit, eliminating such interests, has been approved by the Commission.

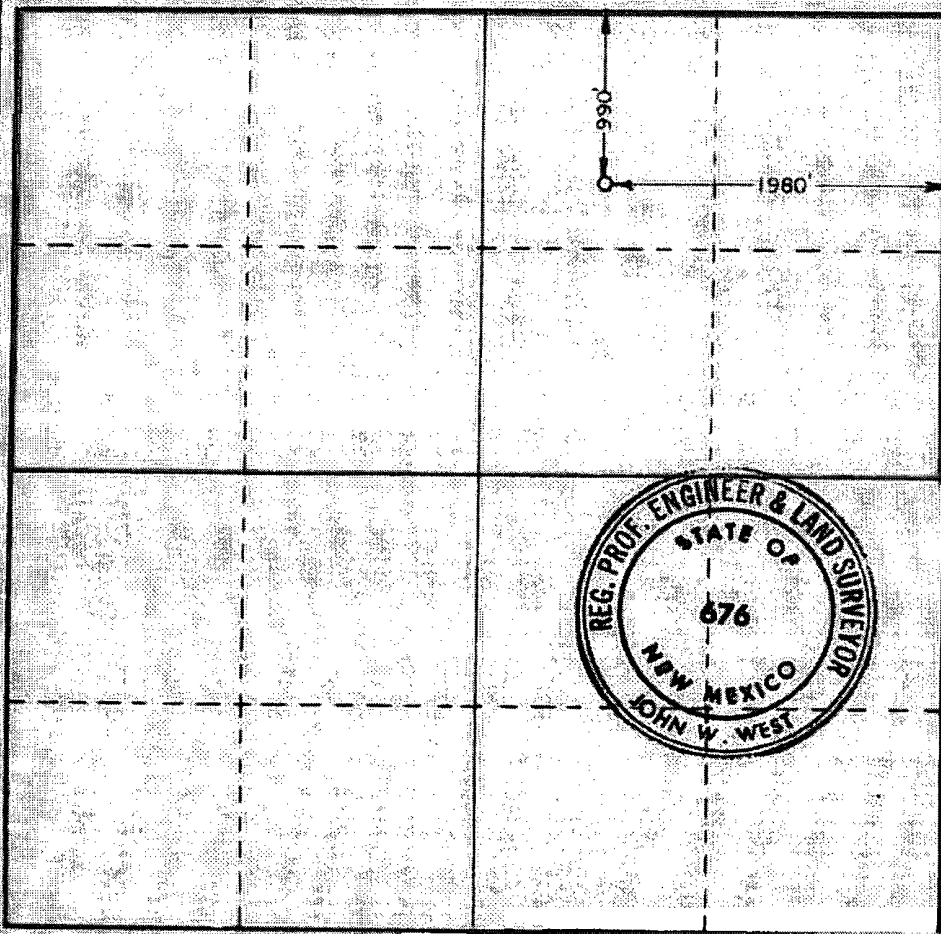

CERTIFICATION

I hereby certify that the information contained herein is true and complete to the best of my knowledge and belief.

Joe Dault

Name

Rose Burditt

Position

Engineer Technician

Company

Samson Resources

Date

May 2, 2006

I hereby certify that the well location shown on this plat was plotted from field notes of actual surveys made by me or under my supervision, and that the same is true and correct to the best of my knowledge and belief.

Date Surveyed

3-21-81

Registered Professional Engineer and/or Land Surveyor

John W. West

Certificate No. **JOHN W. WEST 676**
PATRICK A. ROMERO 6888
Ronald J. Eldon 3239



WELL: Loving State 1	SPUD DATE: 4/17/1981	FIELD:
COUNTY: Eddy	RR DATE:	LOCATION: 1-24S-27E
STATE: NM	COMP DATE: 6/10/1981	FORMATION:
API #: 30-015-23729	BLM #:	LSE #: 022553
TD: 12,900'	Proposed PBDT: 12,158'	ELEVATION: 3114 GR
	PBDT: 12,565'	

13.375"SET@535'

CASING RECORD											
SURFACE CASING											
O.D.	WT./FT.	GRADE	THD	TOP	BTM	NO. JTS.	BIT SZ.	SX CMT.	TOP CMT.	MUD WT.	TEST
13.375"	48#	H40	STC	Surf	535'		17.500"	725	Surf	9.8#	600#

9.625"set @2400'

O.D.	WT./FT.	GRADE	THD	TOP	BTM	NO. JTS.	BIT SZ.	SX CMT.	TOP CMT.	MUD WT.	TEST
9.625"	36#	K55	STC	Surf	2,400'	58	12.250"	1800	Surf	10.0#	1000#
7.000"	23#	N80/S95	LTC		10,512'		8.500"	1900		13#	1500#
4.500"	13.5#	N80/S95	LTC		12,890'		6.125"	350		9.9#	1500#

Csg leak 5832-96' sqz w/ 200 sx

Csg leak 7067-98' sqz w/ 200 sx

TUBING							
O.D.	WT./FT.	GRADE	THD	TOP	BTM	NO. JTS.	BIT SZ.
2.375"	4.7#	L80	EUE	Surf			

TOL=10320'

PERFORATION RECORD					
DATE	TOP	BOTTOM	SPF	ZONE	STATUS
6/81	12,643'	12,649'		Morrow	Abandoned
6/81	12,496'	12,499'		Morrow	Abandoned
6/81	12,371'	12,377'		Morrow	Abandoned
6/81	12,321'	12,327'		Morrow	Open
6/81	12,213'	12,219'		Morrow	Open

Proposed pkr set @ 11100'

Proposed Strawn Perfs:
11202'-11382'

On/off tool w/ 181" F nipple

WL entry guide

Proposed Atoka Perfs:
11526'-11828'

CIBP @ 12193' w/35' cmt cap

Morrow 12213-12219'

Morrow 12321-12327'

RBP @ 12360' w/1sk sand

Morrow 12371-12377'

Morrow 12496-12499'

TTBP @ 12585' CapW/20' cmt

Morrow 12643-12649'

TD: 12,900' BHP=5371# @12431'

WELL HISTORY	
04/17/81	Spud well. Ran 13.375" csg, 48#, H40, STC. 9.8# MW. Cmt w/ lead: 525 sx. Cmt w/ tail: 200 sx. Cmt rtns. Test csg to 600#.
04/23/81	Ran 9.625" csg, 36#, K55, STC. 10# MW. Cmt w/ lead: 1400 sx; cement w/ tail: 400 sx. Cmt rtns. Test csg to 1000#.
DATE	Ran 7.00" csg, 23#, N80 S95, LTC. 13#MW, 850 sx lead + 750 sx tail, Ow/ 9.9, spot 323 bbl 14#S 660 bbl 16#. Test csg to 1500#.
12/01	Downsqz 7x9 5/8" w/ 300 sx cl 'C'.
12/01	Csg leak 5832-96' sqz w/ 200 sx
12/01	Csg leak 7067-98' sqz w/ 200 sx
12/01	Mill scale 12311-90' & 12640' co fill to 12717'
05/18/03	TTBP (Thru Tbg Bridge Plug) Set @ 12585' capped w/20' cement.
08/05/05	POOH & LD 374 jts 2 3/8" tbg and Arrow 1X. NUWH w/1 - 2 3/8"x6' sub. Shut in well.

MISCELLANEOUS

SRC Wt%:	##	BHT:
ZONE PENALTY:		BHP:
COMPETITIVE:		EST SITP:
FERC CLASS:		EST WHSIP:
FORCE POOL:		COMPRESSOR DETAIL:
SRC OFFSET/ZONE:		
LOGS:		PUMPING UNIT DETAIL:

CAPACITIES

Tubular Cap.	(bbl/ft)	(cf/ft)
Casing		
Casing		
Liner		
Tubing		
Annular Cap.	(bbl/ft)	(cf/ft)
Tubing x Casing		
Tubing x Casing		
Casing x Casing		
Casing x Hole		

TUBULAR GOODS PERFORMANCE

Material	ID (in)	Drift (in)	Collapse (psi)	Burst (psi)	Tensile (lbs)
** Safety factor not included.					

Engineer: _
Office#: 918-591-
Fax#: 918-591-

pared By: Jody Boyd
Date:
Updated: 5/20/04 LH 12/30/05 RMB