

UNITED STATES
DEPARTMENT OF THE INTERIOR
BUREAU OF LAND MANAGEMENTFORM APPROVED
OMB NO. 1004-0137
Expires: January 31, 2018**SUNDRY NOTICES AND REPORTS ON WELLS**
*Do not use this form for proposals to drill or to re-enter an abandoned well. Use form 3160-3 (APD) for such proposals.*5. Lease Serial No.
NMNM100549

6. If Indian, Allottee or Tribe Name

7. If Unit or CA/Agreement, Name and/or No.

8. Well Name and No.
HH SO 8 5 FED 004 1H9. API Well No.
30-015-45987-00-X110. Field and Pool or Exploratory Area
PURPLE SAGE-WOLFCAMP (GAS)11. County or Parish, State
EDDY COUNTY, NM**SUBMIT IN TRIPLICATE - Other instructions on page 2**

1. Type of Well

☐ Oil Well ☒ Gas Well ☐ Other2. Name of Operator
CHEVRON USA INCORPORATEDContact: LAURA BECERRA
E-Mail: LBECERRA@CHEVRON.COM3a. Address
6301 DEAUVILLE BLVD
MIDLAND, TX 797063b. Phone No. (include area code)
Ph: 432-687-7655

4. Location of Well (Footage, Sec., T., R., M., or Survey Description)

Sec 17 T26S R27E NWNE 783FNL 1584FEL
32.047600 N Lat, 104.208832 W Lon**12. CHECK THE APPROPRIATE BOX(ES) TO INDICATE NATURE OF NOTICE, REPORT, OR OTHER DATA**

TYPE OF SUBMISSION	TYPE OF ACTION
<input checked="" type="checkbox"/> Notice of Intent	<input type="checkbox"/> Acidize <input type="checkbox"/> Deepen <input type="checkbox"/> Production (Start/Resume) <input type="checkbox"/> Water Shut-Off
<input type="checkbox"/> Subsequent Report	<input type="checkbox"/> Alter Casing <input type="checkbox"/> Hydraulic Fracturing <input type="checkbox"/> Reclamation <input type="checkbox"/> Well Integrity
<input type="checkbox"/> Final Abandonment Notice	<input type="checkbox"/> Casing Repair <input type="checkbox"/> New Construction <input type="checkbox"/> Recomplete <input checked="" type="checkbox"/> Other
	<input type="checkbox"/> Change Plans <input type="checkbox"/> Plug and Abandon <input type="checkbox"/> Temporarily Abandon Surface Disturbance
	<input type="checkbox"/> Convert to Injection <input type="checkbox"/> Plug Back <input type="checkbox"/> Water Disposal

13. Describe Proposed or Completed Operation: Clearly state all pertinent details, including estimated starting date of any proposed work and approximate duration thereof. If the proposal is to deepen directionally or recomple horizontally, give subsurface locations and measured and true vertical depths of all pertinent markers and zones. Attach the Bond under which the work will be performed or provide the Bond No. on file with BLM/BIA. Required subsequent reports must be filed within 30 days following completion of the involved operations. If the operation results in a multiple completion or recomple in a new interval, a Form 3160-4 must be filed once testing has been completed. Final Abandonment Notices must be filed only after all requirements, including reclamation, have been completed and the operator has determined that the site is ready for final inspection.

Chevron USA respectfully requests authorization to extend the existing service road from 24'x212' to 24'x619' and to add a temporary 24'x909' access road to the HH SO 8 5 FED 004 well pad.

The secondary access is needed to safely enter and exit the pad during the fracking operations of each well. The secondary access road is temporary and will be reclaimed after the fracking operations are complete.

Certified IR plat is attached. This request applies to the approved APDs for the following wells:

HH SO 8 5 FED 004 1H - 30-015-45987
HH SO 8 5 FED 004 2H - 30-015-45988
HH SO 8 5 FED 004 3H - 30-015-45989

NM OIL CONSERVATION
ARTESIA DISTRICT

OCT 21 2019

RECEIVED

GC 11/6/19
Accepted for record - NMOCD

14. I hereby certify that the foregoing is true and correct.

Electronic Submission #480235 verified by the BLM Well Information System
For CHEVRON USA INCORPORATED, sent to the Carlsbad
Committed to AFMSS for processing by JUANA MEDRANO on 08/23/2019 (19JM0093SE)

Name (Printed/Typed) LAURA BECERRA

Title REGULATORY SPECIALIST

Signature (Electronic Submission)

Date 08/23/2019

THIS SPACE FOR FEDERAL OR STATE OFFICE USEApproved By CODY LAYTON

Title ASSIST FIELD MANAGER LANDS MINERALS Date 10/04/201

Conditions of approval, if any, are attached. Approval of this notice does not warrant or certify that the applicant holds legal or equitable title to those rights in the subject lease which would entitle the applicant to conduct operations thereon.

Office Carlsbad

Title 18 U.S.C. Section 1001 and Title 43 U.S.C. Section 1212, make it a crime for any person knowingly and willfully to make to any department or agency of the United States any false, fictitious or fraudulent statements or representations as to any matter within its jurisdiction.

(Instructions on page 2)

**** BLM REVISED ** BLM REVISED ** BLM REVISED ** BLM REVISED ** BLM REVISED ****

Additional data for EC transaction #480235 that would not fit on the form

32. Additional remarks, continued

HH SO 8 5 FED 004 4H - 30-015-45990
HH SO 8 5 FED 004 5H - 30-015-45991
HH SO 8 5 FED 004 6H - 30-015-45992

Revisions to Operator-Submitted EC Data for Sundry Notice #480235

	Operator Submitted	BLM Revised (AFMSS)
Sundry Type:	DISTURB NOI	DISTURB NOI
Lease:	NMNM118108	NMNM100549
Agreement:		
Operator:	CHEVRON USA INC 6301 DEAUVILLE BLVD MIDLAND, TX 79706 Ph: 432-687-7665	CHEVRON USA INCORPORATED 6301 DEAUVILLE BLVD MIDLAND, TX 79706 Ph: 432 687 7100
Admin Contact:	LAURA BECERRA REGULATORY SPECIALIST E-Mail: LBECERRA@CHEVRON.COM Ph: 432-687-7665	LAURA BECERRA REGULATORY SPECIALIST E-Mail: LBECERRA@CHEVRON.COM Ph: 432-687-7655
Tech Contact:	LAURA BECERRA REGULATORY SPECIALIST E-Mail: LBECERRA@CHEVRON.COM Ph: 432-687-7665	LAURA BECERRA REGULATORY SPECIALIST E-Mail: LBECERRA@CHEVRON.COM Ph: 432-687-7655
Location:		
State:	NM	NM
County:	EDDY	EDDY
Field/Pool:	PURPLE SAGE;WOLFCAMP (GAS)	PURPLE SAGE-WOLFCAMP (GAS)
Well/Facility:	HH SO 8 5 FED 004 1H Sec 17 T26S R27E Mer NMP NWNE 783FNL 1584FEL	HH SO 8 5 FED 004 1H Sec 17 T26S R27E NWNE 783FNL 1584FEL 32.047600 N Lat, 104.208832 W Lon

R 27 E

Point of Commencement/
Fnd. 2" Iron Pipe @ NE
Corner of Section 17
(NAD 27)
X= 540,303.95
Y= 381,799.23

T
26
S

Sec. 17
Bureau of Land Management

Edge of As-Staked 80' ROW
As-Staked Lease Road
Edge of As-Staked 80' ROW

CENTERLINE
PROPOSED MAIN
ACCESS ROAD
24' x ±618.77'
±37.50 Rods
±0.30 Acres

CENTERLINE
PROPOSED
SECONDARY
ACCESS ROAD
24' x ±908.21'
±55.04 Rods
±0.41 Acres

HH SO 8 5 FED 004
No. 1H Well
HH SO 8 5 FED 004
No. 2H Well
HH SO 8 5 FED 004
No. 3H Well
HH SO 8 5 FED 004
No. 4H Well
HH SO 8 5 FED 004
No. 5H Well
HH SO 8 5 FED 004
No. 6H Well

PROPOSED
TEMPORARY
PAD AREA
±2.45 Acres

PROPOSED
PERMANENT
PAD AREA
±2.30 Acres

HH SO 8 5 FED 004 NO. 1H WELL			
X=	538,727'		
Y=	381,020'		
LAT.	32.047477° N	NAD 27	
LONG.	104.208340° W		
X=	579,911'		
Y=	381,077'		
LAT.	32.047599° N	NAD83/86	
LONG.	104.208833° W		
ELEV.	+3,267'	NAVD88	

NAD 27 NEW MEXICO EAST ZONE

LEGEND	
	As-Staked ROW
	Centerline Access
	Lease Road
	Section Line
	Fnd. Monument
	Archaeological Find

Scale: 1" = 200'

200' 0 100' 200'

FOR THE EXCLUSIVE USE OF
CHEVRON U.S.A. INC.

I, Steve M. Coleman Professional
Surveyor, do hereby state this plat is true
and correct to the best of my knowledge.

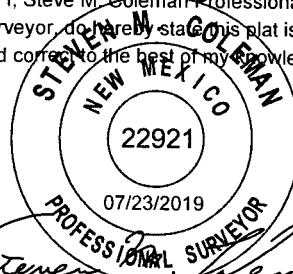

Steve M. Coleman
Registration No. 22921

WELL PLAT

Page 1 of 2

CHEVRON U.S.A. INC.

INTERIM RECLAMATION
HH SO 8 5 FED 004 NO. 1H-6H WELLS
SECTION 17, T26S-R27E
EDDY COUNTY, NEW MEXICO

REVISIONS

DRAWN BY:	#	BY:	DATE:	DESCRIPTION:
PROJ. MGR.: GDG	2	DMB	05/19/2019	Revise Pad and Access
DATE: 08/22/2017	3	GDG	07/23/2019	Remove Arc Site

FILENAME: T:\2017\2176071\DWG\HH SO 8 5 FED 004 INTERIM RECLAMATION PLAT.dwg



C. H. Fenstermaker & Associates, L.L.C.
135 Regency Sq. Lafayette, LA 70508
Ph. 337-237-2200 Fax. 337-232-3299
www.fenstermaker.com

DISCLAIMER: At this time, C. H. Fenstermaker & Associates, L.L.C. has not performed nor was asked to perform any type of engineering, hydrological modeling, flood plain, or "No Rise" certification analyses, including but not limited to determining whether the project will impact flood hazards in connection with federal/FEMA, state, and/or local laws, ordinances and regulations. Accordingly, Fenstermaker makes no warranty or representation of any kind as to the foregoing issues, and persons or entities using this information shall do so at their own risk.

NOTE:

Please be advised, that while reasonable efforts are made to locate and verify pipelines and anomalies using our standard pipeline locating equipment, it is impossible to be 100 % effective. As such, we advise using caution when performing work as there is a possibility that pipelines and other hazards, such as fiber optic cables, PVC pipelines, etc. may exist undetected on site.

NOTE:

Many states maintain information centers that establish links between those who dig (excavators) and those who own and operate underground facilities (operators). It is advisable and in most states, law, for the contractor to contact the center for assistance in locating and marking underground utilities. For guidance: New Mexico One Call - www.nmonecall.org.

NW PAD CORNER		NE PAD CORNER	
X=	538,493'	X=	539,038'
Y=	381,142'	Y=	381,138'
LAT.	32.047812° N	LAT.	32.047800° N
LONG.	104.209095° W	LONG.	104.207336° W
X=	579,677'	X=	580,222'
Y=	381,198'	Y=	381,195'
LAT.	32.047934° N	LAT.	32.047922° N
LONG.	104.209589° W	LONG.	104.207830° W
ELEV.	+3,257' NAVD88	ELEV.	+3,265' NAVD88
SW PAD CORNER		SE PAD CORNER	
X=	538,491'	X=	539,036'
Y=	380,762'	Y=	380,758'
LAT.	32.046768° N	LAT.	32.046755° N
LONG.	104.209105° W	LONG.	104.207346° W
X=	579,674'	X=	580,219'
Y=	380,818'	Y=	380,815'
LAT.	32.046889° N	LAT.	32.046877° N
LONG.	104.209599° W	LONG.	104.207840° W
ELEV.	+3,264' NAVD88	ELEV.	+3,278' NAVD88

FOR THE EXCLUSIVE USE OF:
CHEVRON U.S.A. INC.

I, Steve M. Coleman Professional
Surveyor, do hereby state this plat is true
and correct to the best of my knowledge.

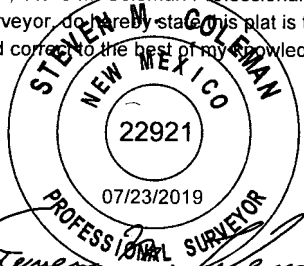

Steve M. Coleman
Registration No. 22921



C. H. Fenstermaker & Associates, L.L.C.
135 Regency Sq. Lafayette, LA 70508
Ph. 337-237-2200 Fax. 337-232-3299
www.fenstermaker.com

WELL PLAT

Page 2 of 2

CHEVRON U.S.A. INC.

INTERIM RECLAMATION
HH SO 8 5 FED 004 NO. 1H-6H WELLS
SECTION 17, T26S-R27E
EDDY COUNTY, NEW MEXICO

REVISIONS

DRAWN BY:	#	BY:	DATE:	DESCRIPTION:
PROJ. MGR.: GDG	2	DMB	05/08/2019	Revised pad and access
DATE: 08/22/2017	3	GDG	07/23/2019	Remove arch site
FILENAME: T:\2017\217607\1DWG\HH SO 8 5 FED 004 INTERIM RECLAMATION PLAT.dwg				