

DISTRICT I
1625 N. FRENCH DR., HOBBS, NM 88240
Phone: (575) 393-6181 Fax: (575) 393-0720

DISTRICT II
811 S. FIRST ST., ARTESIA, NM 88210
Phone: (575) 748-1283 Fax: (575) 748-9720

DISTRICT III
1000 RIO BRAZOS RD., AZTEC, NM 87410
Phone: (505) 334-6178 Fax: (505) 334-6170

DISTRICT IV
1220 S. ST. FRANCIS DR., SANTA FE, NM 87505
Phone: (505) 476-3460 Fax: (505) 476-3462

State of New Mexico
Energy, Minerals & Natural Resources Department
OIL CONSERVATION DIVISION
1220 SOUTH ST. FRANCIS DR.
Santa Fe, New Mexico 87505

NM OIL CONSERVATION

ARTESIA DISTRICT

NOV 25 2019

Form C-102

Revised August 1, 2011

Submit one copy to appropriate

District Office

RECEIVED

☒ AMENDED REPORT

WELL LOCATION AND ACREAGE DEDICATION PLAT

API Number 30-015-45531	Pool Code 16800	Pool Name Delaware River; Bone Spring
Property Code 322993	Property Name SRO 5 STATE COM	Well Number 504H
OGRID No. 229137	Operator Name COG OPERATING, LLC	Elevation 3007.4'

Surface Location

UL or lot No. A	Section 5	Township 26-S	Range 28-E	Lot Idn	Feet from the 314	North/South line NORTH	Feet from the 895	East/West line EAST	County EDDY
--------------------	--------------	------------------	---------------	---------	----------------------	---------------------------	----------------------	------------------------	----------------

Bottom Hole Location If Different From Surface

UL or lot No. P	Section 8	Township 26-S	Range 28-E	Lot Idn	Feet from the 52	North/South line SOUTH	Feet from the 319	East/West line EAST	County EDDY
--------------------	--------------	------------------	---------------	---------	---------------------	---------------------------	----------------------	------------------------	----------------

Dedicated Acres 320	Joint or Infill	Consolidation Code	Order No.
------------------------	-----------------	--------------------	-----------

NO ALLOWABLE WILL BE ASSIGNED TO THIS COMPLETION UNTIL ALL INTERESTS HAVE BEEN CONSOLIDATED
OR A NON-STANDARD UNIT HAS BEEN APPROVED BY THE DIVISION

SEE PAGE 2

PAGE 1 OF 2

W.O. #19-1867

DRAWN BY: WN

Property Code 322993	Property Name SRO 5 STATE COM	Well Number 504H
OGRID No. 229137	Operator Name COG OPERATING, LLC	Elevation 3007.4'

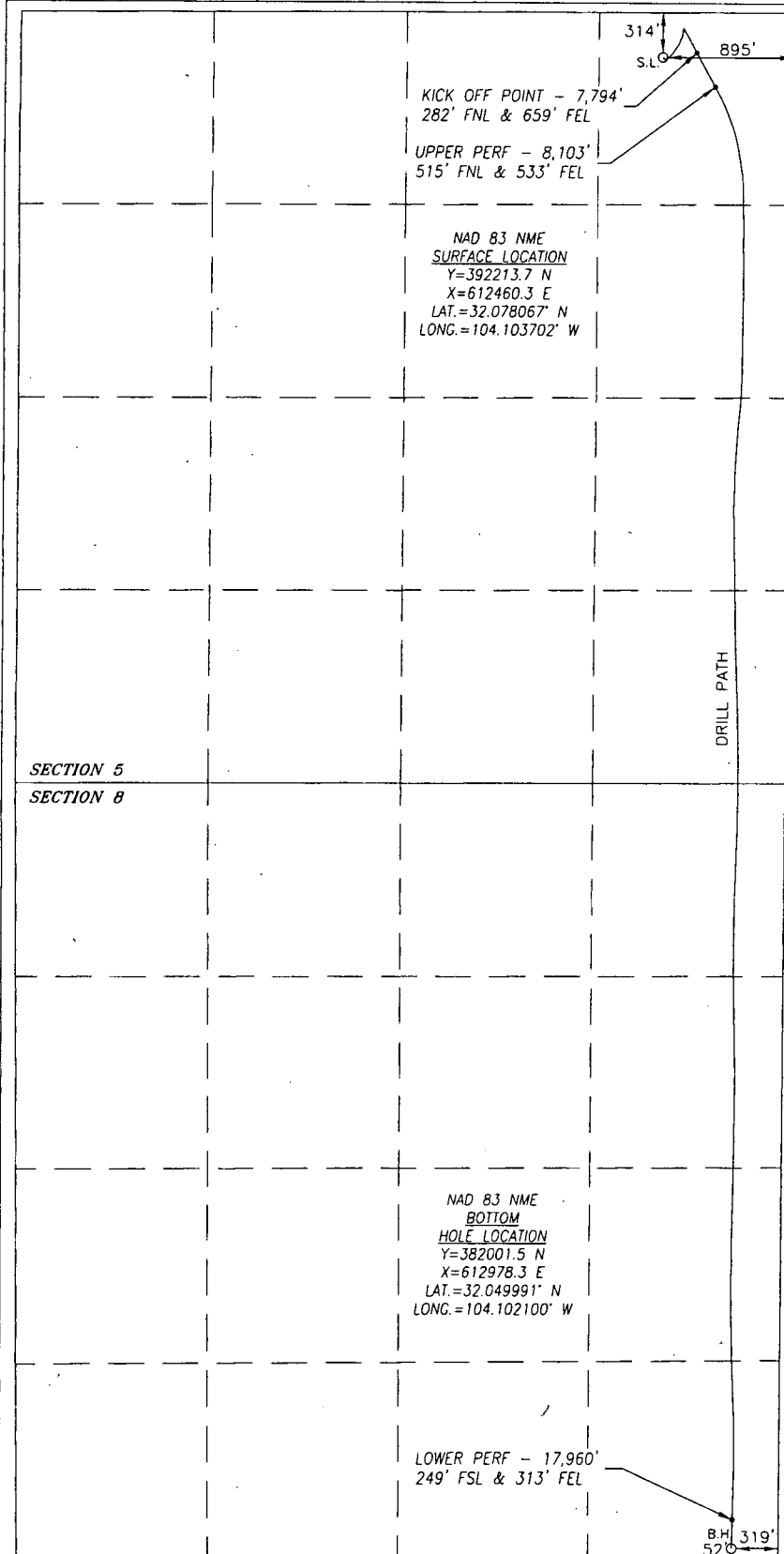

BOREPATH SHOWN HEREON IS BASED ON DIRECTIONAL SURVEY REPORT PROVIDED BY COG OPERATING, LLC FOR THE SRO 5 STATE COM #504H SUPPLIED TO HARCROW SURVEYING, LLC ON SEPTEMBER 25, 2019.

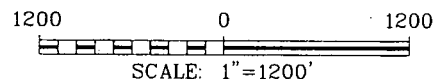

OPERATOR CERTIFICATION

I hereby certify that the information herein is true and complete to the best of my knowledge and belief, and that this organization either owns a working interest or unleased mineral interest in the land including the proposed bottom hole location or has a right to drill this well at this location pursuant to a contract with an owner of such mineral or working interest, or to a voluntary pooling agreement or a compulsory pooling order heretofore entered by the division.

Amanda Avery 10/30/19
Signature Date

Amanda Avery
Printed Name

aavery@concho.com
E-mail Address

SURVEYOR CERTIFICATION

I hereby certify that the well location shown on this plat was plotted from field notes of actual surveys made by me or under my supervision, and that the same is true and correct to the best of my belief.

JAN. 14, 2018/JUNE 19, 2019
Date of Survey/Date of Geographic Survey

Signature & Seal of Professional Surveyor

Chad Harcrow 10/18/19
Certificate No. CHAD HARCROW 17777



Intent ☐ As Drilled ☒

API #
30-015-45531

Operator Name: COG OPERATING, LLC	Property Name: SRO 5 STATE COM	Well Number 504H
--------------------------------------	-----------------------------------	---------------------

Kick Off Point (KOP)

UL A	Section 5	Township 26S	Range 28E	Lot	Feet 282	From N/S NORTH	Feet 659	From E/W EAST	County EDDY
Latitude 32.078155					Longitude -104.102943			NAD 83	

First Take Point (FTP)

UL A	Section 5	Township 26S	Range 28E	Lot	Feet 515	From N/S NORTH	Feet 533	From E/W EAST	County EDDY
Latitude 32.077514					Longitude -104.102527			NAD 83	

Last Take Point (LTP)

UL P	Section 8	Township 26S	Range 28E	Lot	Feet 249	From N/S SOUTH	Feet 313	From E/W EAST	County EDDY
Latitude 32.050532					Longitude -104.102078			NAD 83	

Is this well the defining well for the Horizontal Spacing Unit? ☐ No

Is this well an infill well? ☐ Yes

If infill is yes please provide API if available, Operator Name and well number for Defining well for Horizontal Spacing Unit.

API #
30-015-45534

Operator Name: COG Operating LLC	Property Name: SRO 5 State Com	Well Number 507H
-------------------------------------	-----------------------------------	---------------------

KZ 06/29/2018