

UNITED STATES
DEPARTMENT OF THE INTERIOR
BUREAU OF LAND MANAGEMENT

APPLICATION FOR PERMIT TO DRILL OR REENTER

1a. Type of Work: ☒ DRILL ☐ REENTER

b. Type of Well: ☒ Oil Well ☐ Gas Well ☐ Other ☐ Single Zone ☒

2. Name of Operator

Yates Petroleum Corporation

3A. Address 105 South Fourth Street
Artesia, New Mexico 88210

3b. Phone No. (include area code)

(505) 748-1471

4. Location of Well (Report location clearly and in accordance with any State requirements. *)

At surface 330' FSL and 1650' FWL, SESW, Unit N

At proposed prod. Zone same as above

14. Distance in miles and direction from nearest town or post office*

Approximately fourteen (14) miles southwest of Artesia, New Mexico

15. Distance from proposed* location to nearest property or lease line, ft. (Also to nearest drig. unit line, if any) 350'

16. No. of Acres in lease

2329.37

17. Spacing Unit dedicated to this well

SESW

18. Distance from proposed location* to nearest well, drilling, completed, applied for, on this lease, ft. 990'

19. Proposed Depth

3,100'

20. BLM/BIA Bond No. on file

NM-2811

21. Elevations (Show whether DF, KDB, RT, GL, etc.)

3604' GL

22. Approximate date work will start*

ASAP

23. Estimated duration

30 Days

24. Attachments

The following, completed in accordance with the requirements of Onshore Oil and Gas Order No. 1, shall be attached to this form:

1. Well plat certified by a registered surveyor.
2. A Drilling Plan.
3. A Surface Use Plan (if the location is on National Forest System Lands, the SUPO shall be filed with the appropriate Forest Service Office.

4. Bond to cover the operations unless covered by an existing bond on file (see Item 20 above).
5. Operator certification.
6. Such other site specific information and/or plans as may be required by the authorized office.

25. Signature

Name (Printed/Typed)

Date

Cy Cowan

6/29/2006

Title:

Regulatory Agent/Land Department

Approved by (Signature)

/s/ Don Peterson

Name (Printed/Typed)

/s/ Don Peterson

Date

AUG 02 2006

Title

ACTING FIELD MANAGER

Office

CARLSBAD FIELD OFFICE

Application approval does not warrant or certify that the applicant holds legal or equitable title to those rights in the subject lease which would entitle the applicant to conduct operations thereon.

Conditions of approval, if any, are attached.

APPROVAL FOR 1 YEAR

Title 18 U.S.C. Section 1001 and Title 43 U.S.C. Section 1212, make it a crime for any person knowingly and willfully to make to any department or agency of the United States any false, fictitious or fraudulent statements or representations as to any matter within its jurisdiction.

*(Instructions on reverse)

C144 Attached

Archaeological Survey Attached

If earthen pits are used in association with the drilling of this well, an OCD pit permit must be obtained prior to pit construction.

APPROVAL SUBJECT TO
GENERAL REQUIREMENTS AND
SPECIAL STIPULATIONS
ATTACHED

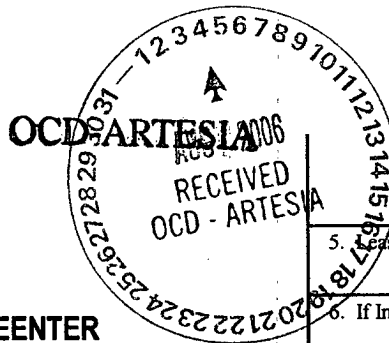

OMB No. 1004-0136
Expires November 30, 2000

5. Lease Serial No.

NM-487738

6. If Indian, Allottee or Tribe Name

Not Applicable

7. If Unit or CA Agreement, Name and No.

Not Applicable

8. Lease Name and Well No.

Federal AB 13

9. API Well No.

30-015-35068

10. Field and Pool, or Exploratory

Penasco Draw, San Andres, Yeso

11. Sec., T., R., M., or Blk. and Survey or Area

Section 32, T18S-R25E

12. County or Parish

Eddy

13. State

NM

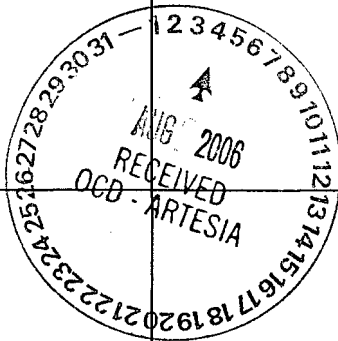
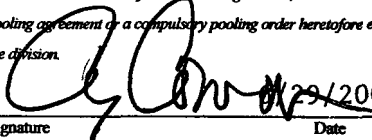
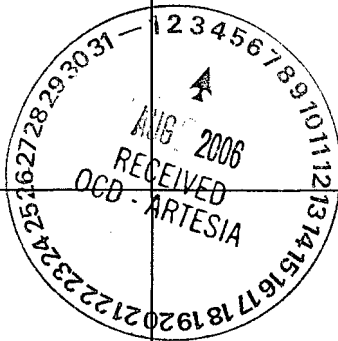
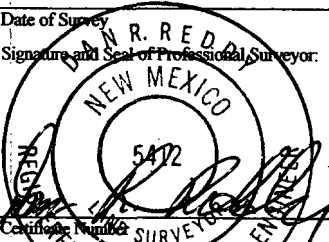
16		<p>17 OPERATOR CERTIFICATION</p> <p><i>I hereby certify that the information contained herein is true and complete to the best of my knowledge and belief, and that this organization either owns a working interest in the land including the proposed bottom hole location or has a right to drill this well at this location pursuant to a contract with an owner of such a working interest, or to a voluntary pooling agreement or a compulsory pooling order heretofore entered by the division.</i></p> <p style="text-align: right;">  Date: 2/29/2006 </p> <p>Signature: _____ Date: _____</p> <p>Printed Name: Cy Cowan</p>
<div style="border: 2px solid black; padding: 5px; margin: 10px auto; width: 150px; text-align: center;"> LAT N32.69858 LON W104.51064 NM-487738 </div> <div style="margin-top: 20px;"> 1650' </div>		<p>18 SURVEYOR CERTIFICATION</p> <p><i>I hereby certify that the well location shown on this plat was plotted from field notes of actual surveys made by me or under my supervision, and that the same is true and correct to the best of my belief.</i></p> <p>MARCH 1, 2006</p> <p>Date of Survey: _____</p> <p>Signature and Seal of Professional Surveyor: _____</p> <div style="text-align: center;">  DAN R. REDDY, NEW MEXICO PROFESSIONAL SURVEYOR </div>

YATES PETROLEUM CORPORATION
Federal AB 13
350' FSL and 1650' FWL, SESW, Unit N
Section 32-T18S-R25E
Eddy County, New Mexico

1. The estimated tops of geologic markers are as follows:

San Andres	612'
Glorieta	1,962'
Upper Yeso	2,162'
TD	3,100'

2. The estimated depths at which anticipated water, oil or gas formations are expected to be encountered:

Water: 150' – 350'
Oil or Gas: All potential zones.

3. Pressure Control Equipment: BOPE will be installed on the 8 5/8" casing and rated for 2000 BOP systems will be consistent with API RP 53. Pressure tests will be conducted before drilling out from under all casing strings which are set and cemented in place. Blowout Preventor controls will be installed prior to drilling the surface plug and will remain in use until the well is completed or abandoned. Preventors will be inspected and operated at least daily to ensure good mechanical working order, and this inspection recorded on the daily drilling report. See Exhibit B.

Auxiliary Equipment:

- A. Auxiliary Equipment: Kelly cock, pit level indicators, flow sensor equipment and a sub with full opening valve to fit the drill pipe and collars will be available on the rig floor in the open position at all times for use when kelly is not in use.
4. THE PROPOSED CASING AND CEMENTING PROGRAM:

A. Casing Program: (All New)

<u>Hole Size</u>	<u>Casing Size</u>	<u>Wt./Ft</u>	<u>Grade</u>	<u>Coupling</u>	<u>Interval</u>	<u>Length</u>
14 3/4	8 5/8"	24#	J-55	ST&C	0-1,000'	1,000'
7 7/8"	5 1/2"	15.5#	J-55	LT&C	0-3,100'	3,100'

SSS 7/26/04

Minimum Casing Design Factors: Burst 1.0, Tensile 1.8, and Collapse 1.125.

Pressure Control Equipment: 2000 psi system nipped up and tested on 8 5/8".

B. CEMENTING PROGRAM:

Surface casing: 475 sx C Lite (YLD 2.0 WT 12.5). Tail in with 200 sx C
(YLD 1.34 WT 14.8)

Production Casing: 600 sx C (YLD 1.34 WT 14.8)

WITNESS

5. MUD PROGRAM AND AUXILIARY EQUIPMENT:

<u>Interval</u>	<u>Type</u>	<u>Weight</u>	<u>Viscosity</u>	<u>Fluid Loss</u>
0-1000' 1125'	Fresh Water	8.4	28	N/C
1000'-TD	Fresh Water	8.4	28	N/C

Sufficient mud material(s) to maintain mud properties, control lost circulation and contain a blow out will be available at the well site during drilling operations. Mud will be checked hourly by rig personnel.

6. EVALUATION PROGRAM:

Samples: 10' samples from 1000' to TD. 1125'
Logging: Platform Express/HALS.
Coring: None Anticipated.
DST's: None Anticipated.
Mudlogging: TBD.

7. ABNORMAL CONDITIONS, BOTTOM HOLE PRESSURE, AND POTENTIAL HAZARDS:

Anticipated BHP:
From: 0 TO: 1000' 1125' Anticipated Max. BHP: 435 PSI
From: 1000' TO: 3100' Anticipated Max. BHP: 1355 PSI
1125'

No abnormal pressures or temperatures are anticipated.

Lost Circulation Zones Anticipated: None

H2S Zones Anticipated: None.

8. ANTICIPATED STARTING DATE:

Plans are to drill this well as soon as possible after receiving approval. It should take approximately 25 days to drill the well with completion taking another 15 days.

**MULTI-POINT SURFACE USE AND OPERATIONS PLAN
YATES PETROLEUM CORPORATION**

Federal AB 13
330' FSL and 1650' FWL, SESW, Unit N
Section 32 T18S-R25E
Eddy County, New Mexico

This plan is submitted with Form 3160-3, Application for Permit to Drill, covering the above described well. The purpose of this plan is to describe the location of the proposed well, the proposed construction activities and operations plan, the magnitude of the surface disturbance involved and the procedures to be followed in rehabilitating the surface after completion of the operations, so that a complete appraisal can be made of the environmental effect associated with the operations.

1. EXISTING ROADS:

Exhibit A is a portion of the BLM map showing the well and roads in the vicinity of the proposed location. The proposed wellsite is located approximately 14 miles southwest of Artesia, New Mexico and the access route to the location is indicated in red and green on Exhibit A.

DIRECTIONS:

Go South of Artesia on Highway 285 to CR-38 Kincaid Ranch Road. Turn Right and go to 3.3 miles to end of pavement and a cattle guard. Cross cattleguard and continue on CR 38 for 1 mile. Turn west and cross cattleguard and go 1.2 miles to another Cattleguard. Cross Cattleguard and road forks here. Take right fork and get on the double road. Go approx. 2 miles. Turn right and go through the cattleguard. Follow lease road north for .5 of a mile to the Federal AB #8 well location. From the southeast corner of the #8 location follow two track road for .1 of a mile to the southwest corner of the proposed federal AB 13 well location.

2. PLANNED ACCESS ROAD:

- A. The proposed new access will be approximately 300' going east to the southwest corner of the drilling pad. The road will lie in an east/west direction.
- B. The new road will be 14 feet in width (driving surface) and will be adequately drained to control runoff and soil erosion.
- C. The new road will be bladed with drainage on one side. Traffic turnouts will be built.
- D. The route of the road is visible.
- E. Existing roads will be maintained in the same or better condition.

3. LOCATION OF EXISTING WELL:

- A. There is drilling activity within a one-mile radius of the wellsite.
- B. Exhibit D shows existing wells within a one-mile radius of the proposed wellsite.

4. LOCATION OF EXISTING AND/OR PROPOSED FACILITIES:

- A. There are production facilities on this lease at the present time.
- B. In the event that the well is productive, the necessary production facilities will be installed on the drilling pad. If the well is productive oil, a gas or diesel self-contained unit will be used to provide the necessary power. No power will be required if the well is productive of gas.

5. LOCATION AND TYPE OF WATER SUPPLY:

- A. It is planned to drill the proposed well with a fresh water system. The water will be obtained from commercial sources and will be hauled to the location by truck over the existing and proposed roads shown in Exhibit A.

6. SOURCE OF CONSTRUCTION MATERIALS:

Dirt contractor will locate nearest pit and obtain any permits and materials needed for construction.

7. METHODS OF HANDLING WASTE DISPOSAL:

- A. Drill cuttings will be disposed of in the reserve pits.
- B. Drilling fluids will be allowed to evaporate in the reserve pits until the pits are dry.
- C. Water produced during operations will be collected in tanks until hauled to an approved disposal system, or separate disposal application will be submitted.
- D. Oil produced during operations will be stored in tanks until sold.
- E. Current laws and regulations pertaining to the disposal of human waste will be complied with.
- F. All trash, junk, and other waste materials will be contained in trash cages or bins to prevent scattering and will be removed and deposited in an approved sanitary land fill. Burial on site is not approved.

8. ANCILLARY FACILITIES:

None

9. WELLSITE LAYOUT:

- A. Exhibit C shows the relative location and dimensions of the well pad, the reserve pits, the location of the drilling equipment, rig orientation and access road approach.
- B. The reserve pits will be plastic lined. Yates Petroleum Corporation is in full compliance with the OCD General Plan for Drilling Pits approved on April 15, 2004.
- C. A 600' x 600' area has been staked and flagged.

10. PLANS FOR RESTORATION:

- A. After finishing drilling and/or completion operations, all equipment and other material not needed for further operations will be removed. The location will be cleaned of all trash and junk to leave the wellsite in as aesthetically pleasing a condition as possible.
- B. Unguarded pits, if any, containing fluids will be fenced until they have dried and been leveled.
- C. If the proposed well is non-productive, all rehabilitation and/or vegetation requirements of the Bureau of Land Management will be complied with and will be accomplished as expeditiously as possible. All pits will be filled level after they have evaporated and dried.

11. SURFACE OWNERSHIP: FEE – Four Dinkus Ranch

Darrell Brown
PO Box 1281
Artesia, NM 88210

An agreement has been reached concerning surface use in the drilling of this well.

Federal Minerals, Administered by Bureau of Land
Management, Carlsbad, New Mexico.

12. OTHER INFORMATION:

- A. Topography: Refer to the existing archaeological report for a description of the topography, flora, fauna, soil characteristics, dwellings, historical and cultural sites.
- B. The primary surface use is for grazing.

13. OPERATOR'S REPRESENTATIVE:

A. Through A.P.D. Approval:

Cy Cowan, Regulatory Agent
Yates Petroleum Corporation
105 South Fourth Street
Artesia, New Mexico 88210
Phone (505) 748-1471

B. Through Drilling Operations,
Completions and Production:
Pinson McWhorter,
Operations Manager
Yates Petroleum Corporation
105 South Fourth Street
Artesia, New Mexico 88210
Phone (505) 748-1471

14. CERTIFICATION:

I hereby certify that I, or persons under my direct supervision, have inspected the proposed drill site and access route, that I am familiar with the conditions which presently exist; that the statements made in this plan are to the best of my knowledge, true and correct; and , that the work associated with the operations proposed herein will be performed by Yates Petroleum Corporation and its contractors and subcontractors in conformity with this plan and the terms and conditions under which it is approved. This statement is subject to the provisions of 18 U.S.C. 1001 for the filing of a false statement.

06/29/2006



Regulatory Agent

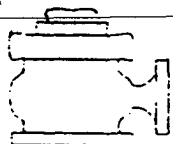

Yates Petroleum Corporation

BOP-2

Typical 2,000 psi Pressure System Schematic Double Ram Preventer Stack

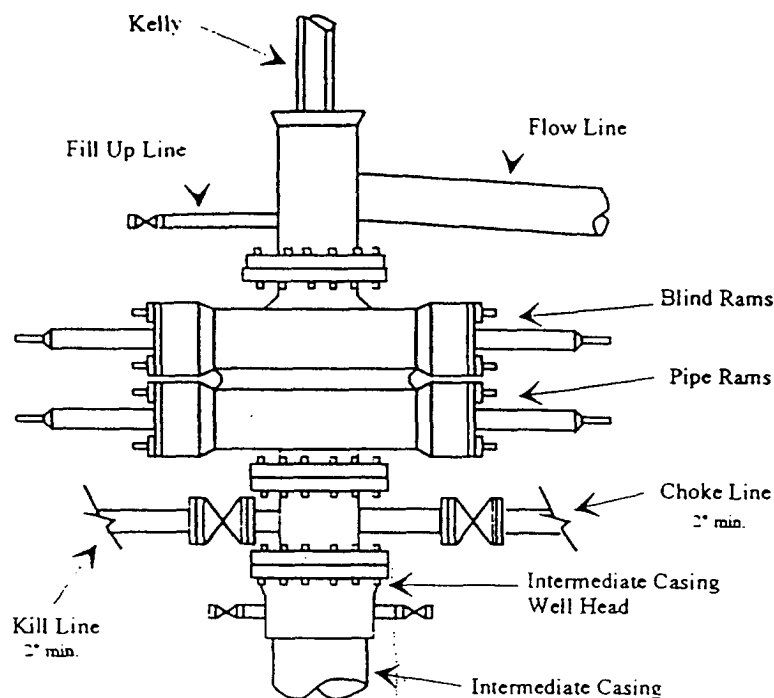

Typical 2,000 psi choke manifold assembly with at least these minimum features

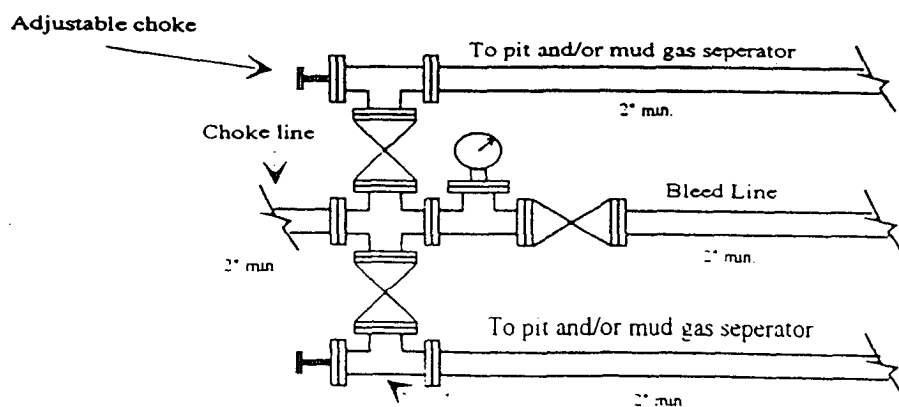

Adjustable choke

Yates Petroleum Corporation

Federal AB #13

330' FSL and 1650' FWL, SESW, Unit N

Section 32, T18S-R25E

Eddy County, New Mexico

Exhibit "B"

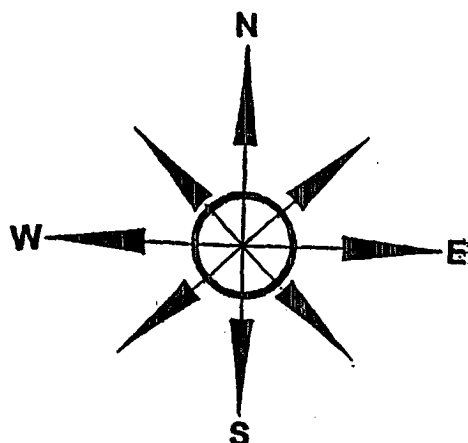

Yates Petroleum Corporation

Location Layout for Permian Basin
Up to 12,000'

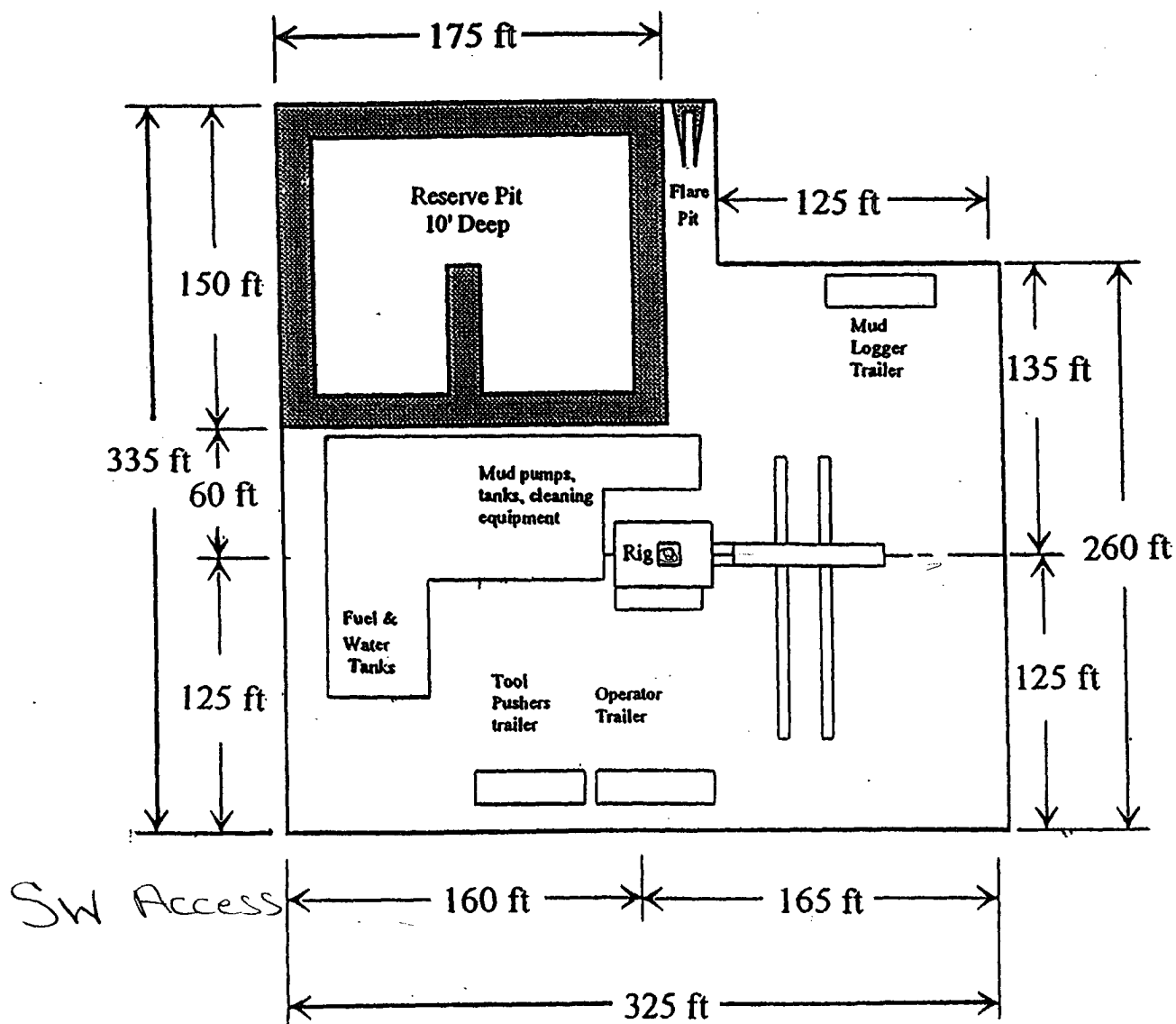

Yates Petroleum Corporation

Federal AB #13

Distance from Well
Head to Reserve Pit
will vary between rigs

330' FSL and 1650' FWL, SESW, Unit N

Section 32, T18S-R25E

Eddy County, New Mexico

Exhibit "C"

The above dimension
should be a minimum

CONDITIONS OF APPROVAL - DRILLING

Operator's Name: Yates Petroleum Corporation

Well Name & No: Federal AB 13

Location: Surface 350' FSL & 1650' FWL, Sec.32, T. 14 S., R. 25 E.

Lease: NMNM 0487738

Eddy County, New Mexico

.....

I. DRILLING OPERATIONS REQUIREMENTS:

1. The Bureau of Land Management (BLM) is to be notified at the Roswell Field Office, 2909 West Second St., Roswell, NM 88201, (505) 627-0272 for wells in Chaves and Roosevelt Counties; the Carlsbad Field Office, 620 East Greene St., Carlsbad, NM 88220, (505) 361-2822 for wells in Eddy County; and the Hobbs Field Station, 414 West Taylor, Hobbs NM 88240, (505) 393-3612 for wells in Lea County, in sufficient time for a representative to witness:

A. Spudding

B. Cementing casing: 8 5/8 inch; 5 1/2 inch;

C. BOP Tests

2. A Hydrogen Sulfide (H₂S) Drilling Plan is not required for this well bore.

3. Unless the production casing has been run and cemented or the well has been properly plugged, the drilling rig shall not be removed from over the hole without prior approval.

4. Submit a Sundry Notice (Form 3160-5, one original and five copies) for each casing string, describing the casing and cementing operations. Include pertinent information such as; spud date, hole size, casing (size, weight, grade and thread type), cement (type, quantity and top), water zones and problems or hazards encountered. The Sundry shall be submitted within 15 days of completion of each casing string. The reports may be combined into the same Sundry if they fall within the same 15 day time frame.

5. The API No. assigned to the well by NMOCD shall be included on the subsequent report of setting the first casing string.

II. CASING:

1. The 8 5/8 inch shall be set at 1125 Feet with cement circulated to the surface. If cement does not circulate to the surface the appropriate BLM office shall be notified and a temperature survey or cement bond log shall be run to verify the top of the cement. Remedial cementing shall be completed prior to drilling out that string.

2. The minimum required fill of cement behind the 5 1/2 inch Production casing is to circulate to surface.

III. PRESSURE CONTROL:

1. All BOP systems and related equipment shall comply with well control requirements as described in Onshore Oil and Gas Order No. 2. The BOP and related equipment shall be installed and operational before drilling below the 8 5/8 inch casing shoe and shall be tested as described in Onshore Order No. 2. Any equipment failing to test satisfactorily shall be repaired or replaced.

2. Minimum working pressure of the blowout preventer and related equipment (BOPE) shall be 2 M psi.

(III Cont):

3. The appropriate BLM office shall be notified in sufficient time for a representative to witness the test.

- The test shall be done by an independent service company
- The results of the test shall be reported to the appropriate BLM office.
- Testing fluid must be water or an appropriate clear liquid suitable for sub-freezing temperatures.
- Use of drilling mud for testing is not permitted since it can mask small leaks.
- Testing must be done in safe workman-like manner. Hard line connections shall be required.
- Both low pressure and high pressure testing of BOPE is required.

G. Gourley RFO 07/28/06