

B. Yates shall be allowed to drill oil wells in Section 34 and Pogo shall be allowed to drill oil wells in Section 35 at locations in their discretion so long as the wellbores are not within the corridor described in paragraph A above, and in Exhibits A and B, and Yates and Pogo agree not to file applications for permit to drill oil wells at locations within the corridor;

C. MPI hereby waives objection to any oil wells located in Sections 34 and 35 on oil and gas leases now owned by Yates or Pogo which comply with paragraph B above. For purposes of this Agreement, "oil well" shall mean a well drilled to a depth no deeper than 200 feet below the base of the Delaware formation. This waiver of objection by MPI shall satisfy any requirements set forth in Order No. R-111-P, and well operators shall not be required to obtain further waivers of objection from MPI with respect to oil wells in Sections 34 and 35, so long as the well locations comply with paragraph B above. In the event that the OCD requires a separate waiver for any specific location that complies with paragraph B above, MPI shall execute any such waiver consistent with the terms of this Agreement;

D. The prohibition of well locations described in paragraphs A and B above does not apply to well pads, surface facilities, gathering lines, pipelines and other facilities and equipment (except the well) that are on or near the surface;

E. Upon execution of this Agreement by all parties, Pogo shall dismiss OCD Case No. 12406;

F. This Agreement is executed by the duly authorized representatives of MPI, Pogo, and Yates, and is binding on their respective successors and assigns.

G. This Agreement is being executed in three multiple counterparts so each party may retain an original executed Agreement. Each counterpart shall be deemed an original for all purposes. The signatures of the authorized representative of each party may appear on separate signature pages and the signature pages may be reassembled to form a complete original counterpart.

Pogo Producing Company

Jerry A. Cooper

Name: Jerry A. Cooper

Title: Senior Vice President

Mississippi Potash, Inc.

Timothy A. Dawson

Name: Timothy A. Dawson

Title: Vice President & Treasurer

Yates Petroleum Corporation

Randy G. Patterson

Name: Randy G. Patterson

Title: Attorney-in-Fact

STATE OF TEXAS

§
§
§

COUNTY OF MIDLAND

This instrument was acknowledged before me on this 28 day of June, 2000, by Jerry A. Cooper, Senior Vice President of Pogo Producing Company, a Delaware corporation, on behalf of said corporation.

My Commission Expires:

5-27-2001



Janey J. Lasley
NOTARY PUBLIC IN AND FOR THE
STATE OF TEXAS

STATE OF NEW MEXICO

§
§
§

COUNTY OF EDDY

This instrument was acknowledged before me on this 3 day of July, 2000, by Randy G. Patterson, Attorney-in-Fact of Yates Petroleum Corporation, a New Mexico corporation.

My Commission Expires:

3/1/02

Theresa S. Morrow
NOTARY PUBLIC IN AND FOR THE
STATE OF NEW MEXICO

STATE OF MISSISSIPPI §
 §
COUNTY OF YAZOO §

This instrument was acknowledged before me on this 25th day of
July, 2000, by Timothy A. Dawson,
Vice President & Treasurer of Mississippi Potash, Inc.,
a Mississippi corporation.

My Commission Expires:

My Commission Expires
July 14, 2001



NOTARY PUBLIC IN AND FOR THE
STATE OF Mississippi

EXHIBIT "A"

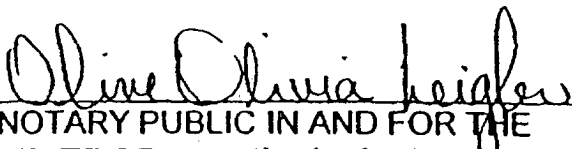
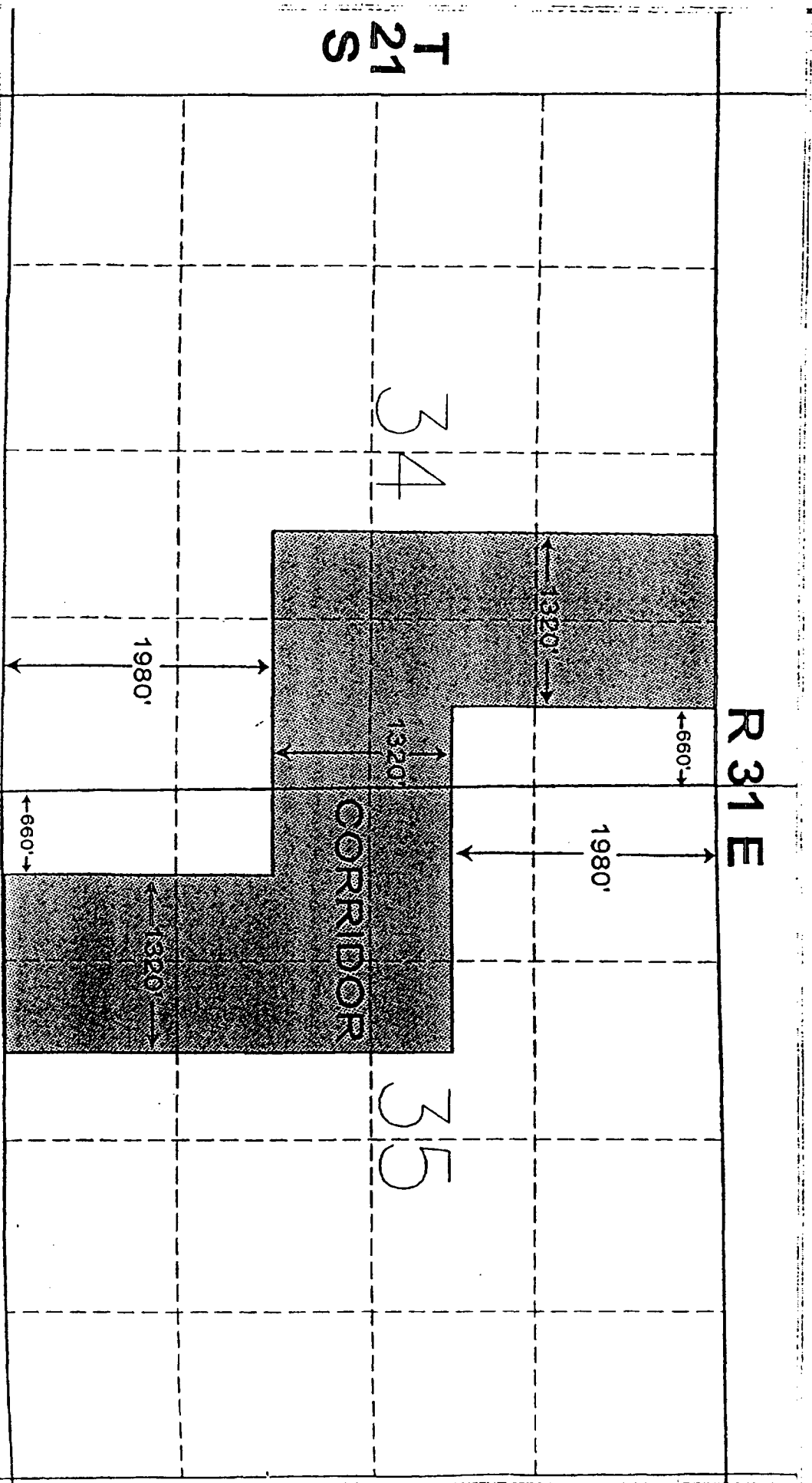

EXHIBIT B

Legal Description of Corridor

The following described lands located in Eddy County, New Mexico:

Township 21 South, Range 31 East, N.M.P.M.

Section 34: $W\frac{1}{2}NE\frac{1}{4}NE\frac{1}{4}$
 $E\frac{1}{2}NW\frac{1}{4}NE\frac{1}{4}$
 $W\frac{1}{2}SE\frac{1}{4}NE\frac{1}{4}$
 $E\frac{1}{2}SW\frac{1}{4}NE\frac{1}{4}$
 $SE\frac{1}{4}SE\frac{1}{4}NE\frac{1}{4}$
 $NE\frac{1}{4}NW\frac{1}{4}SE\frac{1}{4}$
 $N\frac{1}{2}NE\frac{1}{4}SE\frac{1}{4}$

Section 35: $S\frac{1}{2}SW\frac{1}{4}NW\frac{1}{4}$
 $SW\frac{1}{4}SE\frac{1}{4}NW\frac{1}{4}$
 $N\frac{1}{2}NW\frac{1}{4}SW\frac{1}{4}$
 $SE\frac{1}{4}NW\frac{1}{4}SW\frac{1}{4}$
 $W\frac{1}{2}NE\frac{1}{4}SW\frac{1}{4}$
 $E\frac{1}{2}SW\frac{1}{4}SW\frac{1}{4}$
 $W\frac{1}{2}SE\frac{1}{4}SW\frac{1}{4}$

For all depths from the surface down to the base of the Salado formation which is located at a subsurface depth of 2461 feet in the CNLD log (compensated neutron litho density log) of the Mary "AIV" State Well No. 5, located 660 feet FNL and 330 feet FEL of Section 36, T21S, R31E, N.M.P.M.