

District I  
1625 N. French Dr., Hobbs, NM 88240  
District II  
1301 W. Grand Avenue, Artesia, NM 88210  
District III  
1000 Rio Brazos Road, Aztec, NM 87410  
District IV  
1220 S. St. Francis Dr., Santa Fe, NM 87505

State of New Mexico  
Energy Minerals and Natural Resources

Form C-144  
June 1, 2004

Oil Conservation Division  
1220 South St. Francis Dr.  
Santa Fe, NM 87505

For drilling and production facilities, submit to appropriate NMOCD District Office.  
For downstream facilities, submit to Santa Fe office

**Pit or Below-Grade Tank Registration or Closure**

Is pit or below-grade tank covered by a "general plan"? Yes ☒ No ☐  
Type of action: Registration of a pit or below-grade tank ☐ Closure of a pit or below-grade tank ☒

Operator: Yates Petroleum Corporation Telephone: 505-748-4500 e-mail address: mikes@ypcnm.com  
Address: 105 South 4<sup>th</sup> Street, Artesia, NM 88210  
Facility or well name: Stonewall DS Federal Com #2 API #: 30-015-21640 U/L or Qtr/Qtr J Sec 29 T 20S R 28E  
County: Eddy Latitude 32.54273 Longitude 104.19740 NAD: 1927 ☒ 1983 ☐  
Surface Owner: Federal ☒ State ☐ Private ☐ Indian ☐

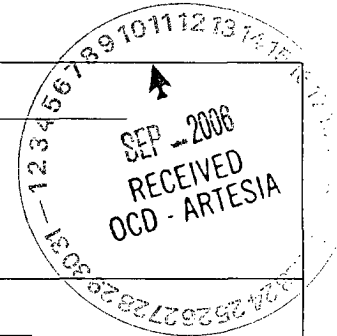

<b>Pit</b>	<b>Below-grade tank</b>	
Type: Drilling <input checked="" type="checkbox"/> Production <input type="checkbox"/> Disposal <input type="checkbox"/> Work over <input type="checkbox"/> Emergency <input type="checkbox"/> Lined <input checked="" type="checkbox"/> Unlined <input type="checkbox"/> Liner type: Synthetic <input checked="" type="checkbox"/> Thickness <u>12</u> mil Clay <input type="checkbox"/> Pit Volume _____ bbl	Volume: _____ bbl Type of fluid: _____ Construction material: _____ Double-walled, with leak detection? Yes <input type="checkbox"/> If not, explain why not. _____	
Depth to ground water (vertical distance from bottom of pit to seasonal high water elevation of ground water.)	Less than 50 feet	(20 points) XXXX
	50 feet or more, but less than 100 feet	(10 points)
	100 feet or more	( 0 points) )
Wellhead protection area: (Less than 200 feet from a private domestic water source, or less than 1000 feet from all other water sources.)	Yes	(20 points)
	No	( 0 points) XXXX
Distance to surface water: (horizontal distance to all wetlands, playas, irrigation canals, ditches, and perennial and ephemeral watercourses.)	Less than 200 feet	(20 points)
	200 feet or more, but less than 1000 feet	(10 points)
	1000 feet or more	( 0 points) XXXX
<b>Ranking Score (Total Points)</b>		<b>20 Points</b>

**If this is a pit closure:** (1) Attach a diagram of the facility showing the pit's relationship to other equipment and tanks. (2) Indicate disposal location: (check the onsite box if you are burying in place) onsite ☐ offsite ☒ If offsite, name of facility: N/A (3) Attach a general description of remedial action taken including remediation start date and end date. (4)

Groundwater encountered: No ☐ Yes ☐ If yes, show depth below ground surface \_\_\_\_\_ ft. and attach sample results.

(5) Attach soil sample results and a diagram of sample locations and excavations.

Additional Comments: Work plan for reopening & closure of drilling pit. The drilling pit contents will be excavated and hauled to an OCD approved soil waste facility.  
The excavated area will be backfilled to grade using a minimum of 3' of clean soil and like material. A one call and a 48 hour notice will be provided to the Oil Conservation Division.  
Pit Closure start date: N/A Final closure date: N/A

I hereby certify that the information above is true and complete to the best of my knowledge and belief. I further certify that the above-described pit or below-grade tank has been/will be constructed or closed according to NMOCD guidelines ☐, a general permit ☒, or an (attached) alternative OCD-approved plan ☐.

Date: 09/07/2006

Printed Name/Title Mike Stubblefield / Regulatory Agent

Signature Mike Stubblefield

Your certification and NMOCD approval of this application/closure does not relieve the operator of liability should the contents of the pit or tank contaminate ground water or otherwise endanger public health or the environment. Nor does it relieve the operator of its responsibility for compliance with any other federal, state, or local laws and/or regulations.

Approval:

Printed Name/Title Jim W. Green

Date: 9/21/06

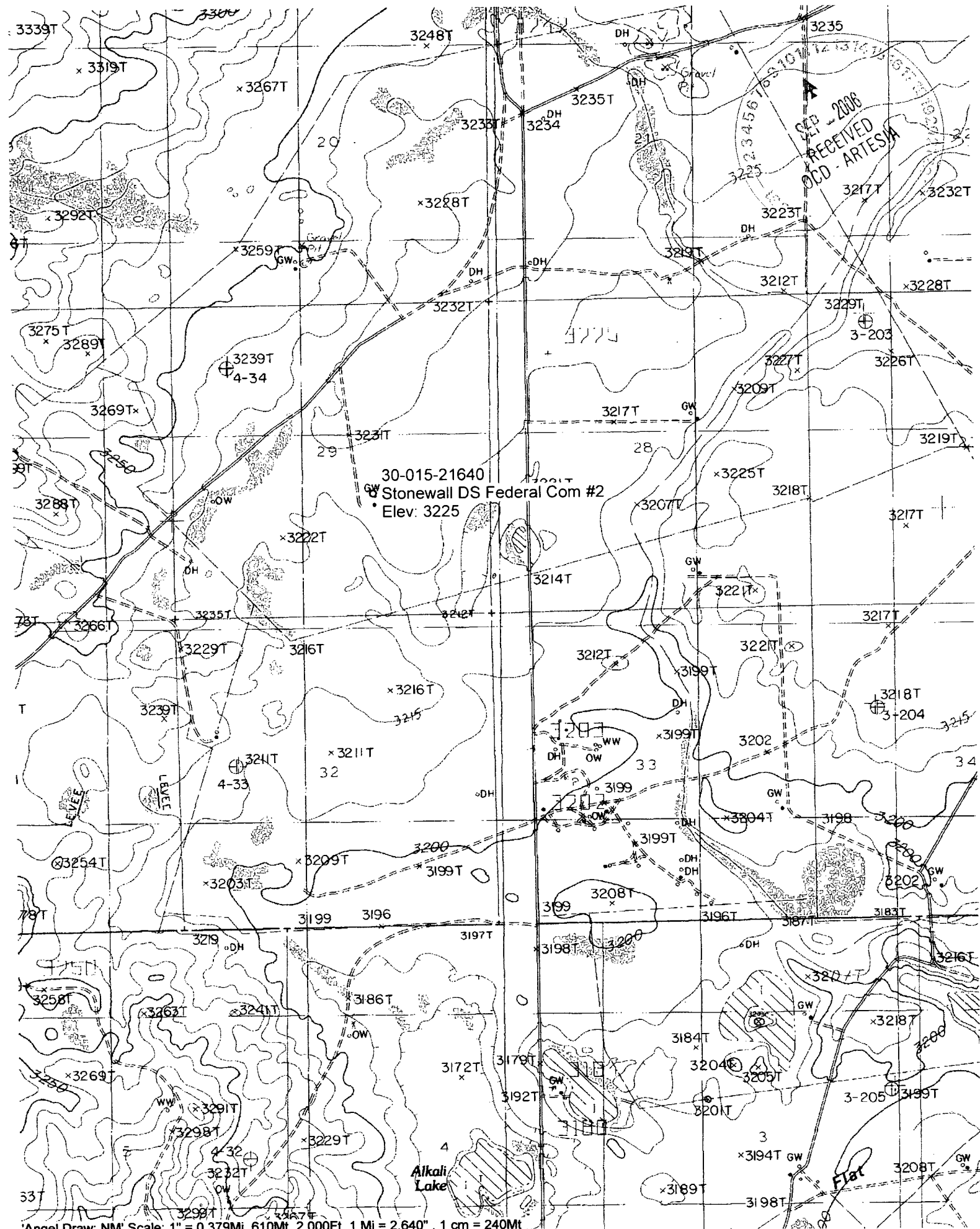

'Angel Draw, NM' Scale: 1" = 0.379Mi 610Mt 2,000Ft, 1 Mi = 2.640", 1 cm = 240Mt

**New Mexico Office of the State Engineer  
POD Reports and Downloads**

STONEWALL DS  
FEDERAL COM #2

Township: 20S Range: 28E Sections:

NAD27 X: Y: Zone: Search Radius:

County: Basin: Number: Suffix:

Owner Name: (First)

(Last)

☐ Non-Domestic

☐ Domestic

☒ All

POD / Surface Data Report

Avg Depth to Water Report

Water Column Report

Clear Form

iWATERS Menu

Help

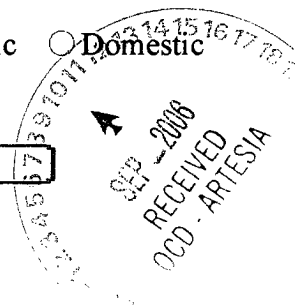

**AVERAGE DEPTH OF WATER REPORT 08/31/2006**

(Depth Water in Feet)

Bsn	Tws	Rng	Sec	Zone	X	Y	Wells	Min	Max	Avg
CP	20S	28E	31				1	115	115	115
CP	20S	28E	33				4	27	30	29

Record Count: 5

**I & E CFO**

**UNITED STATES  
DEPARTMENT OF THE INTERIOR  
BUREAU OF LAND MANAGEMENT**

**NOTICE OF WRITTEN ORDER**

☒ Certified Mail - Return  
Receipt Requested  
70051820000110416002

IDENTIFICATION	
IID	AF 16 17 18 19 20 21 22
Lease	NMNM17100
CA	NMNM94457
Unit	
PA	

Bureau of Land Management Office <b>CARLSBAD FIELD OFFICE</b>	Operator <b>YATES PETROLEUM CORPORATION</b>
Address <b>620 E GREENE STREET CARLSBAD NM 88220</b>	Address <b>105 S 4TH STREET ARTESIA NM 88210</b>
Telephone <b>505-234-5965</b>	Attention
Inspector <b>BHUNT</b>	Attn Addr

Site Name	Well or Facility	1/4 1/4 Section	Township	Range	Meridian	County	State
STONEWALL DS	2	NWSE 29	20S	28E	NMP	EDDY	NM
Site Name	Well or Facility	1/4 1/4 Section	Township	Range	Meridian	County	State
Site Name	Well or Facility	1/4 1/4 Section	Township	Range	Meridian	County	State

The following condition(s) were found by Bureau of Land Management Inspectors on the date and at the site(s) listed above.

Date	Time (24-hour clock)	Corrective Action to be Completed by	Date Corrected	Authority Reference
08/01/2006	11:00	11/22/2006		43 CFR 3162.3-4(c), 43 CFR 3162.1(a), 43 CFR 3162.5-1(b)

**Remarks:**

The following actions must be completed prior to abandonment approval.  
The surface location is to be cleaned and leveled per BLM requirements.

32.54223 104.1974

**1. General cleanup:**

- Remove any equipment parts, household trash, thread protectors, or other plastic/metal debris from location, access road, and surrounding pastures; haul all trash to an authorized landfill facility.
  - Install lease number on dry hole marker.
  - Remove pump jack and concrete foundation.
- (Remarks continued on following page(s).)

When the Written Order is complied with, sign this notice and return to above address.

Company Representative Title	Signature	Date
Company Comments		

**Warning**

The Authorized Officer has authority to issue a Written Order in accordance with 43 CFR 3161.2. Written Order correction and reporting time frames begin upon receipt of this Notice or 7 business days after the date it is mailed, whichever is earlier. Each stipulation must be corrected within the prescribed time from receipt of this Notice and reported to the Bureau of Land Management Office at the address shown above. If you do not comply as noted above under "Corrective Action to be Completed By", you shall be issued an Incident of Noncompliance (INC) in accordance with 43 CFR 3163.1(a). Failure to comply with the INC may result in assessments as outlined in 43 CFR 3163.1 and may also incur civil penalties (43 CFR 3163.2). All self-certified corrections must be postmarked no later than the next business day after the prescribed time frame for correction.

Section 109(d)(1) of the Federal Oil and Gas Royalty Management Act of 1982, as implemented by the applicable provisions of the operating regulations at Title 43 CFR 3163.2(f)(1), provides that any person who "knowingly or willfully" prepares, maintains, or submits false, inaccurate, or misleading reports, notices, affidavits, records, data, or other written information required by this part shall be liable for a civil penalty of up to \$25,000 per violation for each day such violation continues, not to exceed a maximum of 20 days.

**Review and Appeal Rights**

A person contesting a decision shall request a State Director review of the Written Order. This request must be filed within 20 working days of receipt of the Notice with the appropriate State Director (see 43 CFR 3165.3). The State Director review decision may be appealed to the Interior Board of Land Appeals, 801 North Quincy Street, Suite 300, Arlington, VA 22203 (see 43 CFR 3165.4). Contact the above listed Bureau of Land Management office for further information.

Signature of Bureau of Land Management Authorized Officer	Date 08/14/06	Time 09:00
FOR OFFICE USE ONLY		
Number 3	Date	Type of Inspection ES



PHONE (505) 393-2326 • 101 E. MARLAND • HOBBS, NM 88240

SEP - 2008  
RECEIVED  
OCD - ARTESIA

Analysis Date: 09/06/06  
Sampling Date: 08/30/06  
Sample Type: SOIL  
Sample Condition: COOL & INTACT  
Sample Received By: NF  
Analyzed By: HM

[illegible]

**NOTE:** Analysis performed on a 1:4 w:v aqueous extract.

09-06-06  
Date

PLEASE NOTE: **Liability and Damages.** Cardinal's liability and client's exclusive remedy for any claim arising, whether based in contract or tort, shall be limited to the amount paid by client for analyses. All claims, including those for negligence and any other cause whatsoever shall be deemed waived unless made in writing and received by Cardinal within thirty (30) days after completion of the applicable service. In no event shall Cardinal be liable for incidental or consequential damages, including, without limitation, business interruptions, loss of use, or loss of profit incurred by client, its subsidiaries, affiliates or successors arising out of or related to the performance of services hereunder by Cardinal, regardless of whether such claim is based upon any of the above-stated reasons or otherwise.