

District I

1625 N. French Dr., Hobbs, NM 88240

District II

1301 E. Grand Avenue, Artesia, NM 88210

District III

1000 Rio Brazos Road, Aztec, NM 87410

District IV

1220 S. St. Francis Dr., Santa Fe, NM 87505

State of New Mexico
Energy Minerals and Natural ResourcesForm C-101
May 27, 2004Oil Conservation Division
1220 South St. Francis Dr.
Santa Fe, NM 87505

Submit to appropriate District Office

☐ AMENDED REPORT

APPLICATION FOR PERMIT TO DRILL, RE-ENTER, DEEPEN, PLUGBACK, OR ADD A ZONE

¹ Operator Name and Address Yates Petroleum Corporation 105 South Fourth Street Artesia, New Mexico 88210		² OGRID Number 025575
³ Property Code 26974		⁴ Property Name Junior AWW State Com
⁵ Proposed Pool 1 Crow Flats Morrow		⁶ Well No. 1
⁷ Surface Location		⁸ Proposed Pool 2

UL or lot no.	Section	Township	Range	Lot Idn	Feet from the	North/South line	Feet from the	East/West line	County
K	17	16S	28E		1980'	South	1980'	West	Eddy

⁸ Proposed Bottom Hole Location If Different From Surface

UL or lot no.	Section	Township	Range	Lot Idn	Feet from the	North/South line	Feet from the	East/West line	County

Additional Well Information

¹¹ Work Type Code N	¹² Well Type Code G	¹³ Cable/Rotary R	¹⁴ Lease Type Code P	¹⁵ Ground Level Elevation 3550'
¹⁶ Multiple N	¹⁷ Proposed Depth 9600'	¹⁸ Formation Morrow	¹⁹ Contractor Not Determined	²⁰ Spud Date ASAP
Depth to Groundwater >100'		Distance from nearest fresh water well >1000'		Distance from nearest surface water >200'
Pit: Liner: Synthetic XX 12_mils thick Clay <input type="checkbox"/> Pit Volume: _____ bbls Drilling Method: Closed-Loop System <input type="checkbox"/> Fresh Water <input type="checkbox"/> Brine <input checked="" type="checkbox"/> Diesel/Oil-based <input type="checkbox"/> Gas/Air <input type="checkbox"/>				

²¹ Proposed Casing and Cement Program

Hole Size	Casing Size	Casing weight/foot	Setting Depth	Sacks of Cement	Estimated TOC
12 1/4"	8 5/8"	24#	1900'	650 sx	Surface
7 7/8"	4 1/2"	11.6#	9700'	600 sx	TOC 5500'
Cement to cover	all oil, gas and water	bearing zones.			
Water protection	string to be set	@ 250'-350'.			

²² Describe the proposed program. If this application is to DEEPEN or PLUG BACK, give the data on the present productive zone and proposed new productive zone. Describe the blowout prevention program, if any. Use additional sheets if necessary.

Yates Petroleum Corporation proposes to drill and test the Morrow and intermediate formations. Approximately 1900' of surface casing will be set and cement circulated to shut off gravel and cavings. If commercial, production casing will be run and cemented, will perforate and stimulate as needed for production.

MUD PROGRAM: 0-1900' FW; 1900'-8500' Cut Brine; 8500'-TD Salt Gel/Starch.

BOPE PROGRAM: A 3000# BOPE will be installed on the 8 5/8" casing and tested daily.

No H2S is anticipated.

²³ I hereby certify that the information given above is true and complete to the best of my knowledge and belief. I further certify that the drilling pit will be constructed according to NMOC guidelines ☐, a general permit ☒, or an (attached) alternative OGD-approved plan ☐.

Signature:

Printed name: Cy Cowan

Title: Regulatory Agent

E-mail Address:

Date: 10/25/06

Phone: (505) 748-4372

OIL CONSERVATION DIVISION

Approved by:

BRYAN G. ARRANT

DISTRICT II GEOLOGIST

Title:

Approval Date: OCT 30 2006

Expiration Date: OCT 30 2007

Conditions of Approval Attached ☐

PREVIOUSLY APPROVED

1625 1/2 French Dr., Hobbs, NM 88240
District II
814 South First, Artesia, NM 88210
District III
1000 Rio Brazos Rd., Aztec, NM 87410
District IV
1220 S. St. Francis Dr., Santa Fe, NM 87505

State of New Mexico
Energy, Minerals & Natural Resources Department

Form C-102
Revised August 15, 2000

OIL CONSERVATION DIVISION
1220 South St. Francis Dr.
Santa Fe, NM 87505

Submit to Appropriate District Office
State Lease - 4 Copies
Fee Lease - 3 Copies

☐ AMENDED REPORT

WELL LOCATION AND ACREAGE DEDICATION PLAT

¹ API Number 30-015-31484	² Pool Code 7572c	³ Pool Name Crow Flats Wildcat Morrow
⁴ Property Code 26974	⁵ Property Name Junior AWW State Com.	⁶ Well Number 1
⁷ OGRID No. 025575	⁸ Operator Name Yates Petroleum Corporation	⁹ Elevation 3550'

¹⁰ Surface Location

UL or lot no. K	Section 17	Township 16S	Range 28E	Lot Idn	Feet from the 1980	North/South line South	Feet from the 1980	East/West line West	County Eddy
---------------------------	----------------------	------------------------	---------------------	---------	------------------------------	----------------------------------	------------------------------	-------------------------------	-----------------------

¹¹ Bottom Hole Location If Different From Surface

UL or lot no.	Section	Township	Range	Lot Idn	Feet from the	North/South line	Feet from the	East/West line	County
---------------	---------	----------	-------	---------	---------------	------------------	---------------	----------------	--------

¹² Dedicated Acres 320	¹³ Joint or Infill	¹⁴ Consolidation Code	¹⁵ Order No.
---	-------------------------------	----------------------------------	-------------------------

NO ALLOWABLE WILL BE ASSIGNED TO THIS COMPLETION UNTIL ALL INTERESTS HAVE BEEN CONSOLIDATED OR A NON-STANDARD UNIT HAS BEEN APPROVED BY THE DIVISION

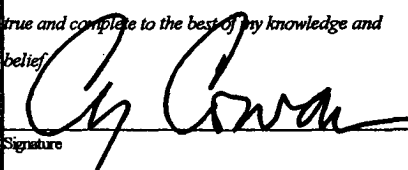
¹⁶				¹⁷ OPERATOR CERTIFICATION I hereby certify that the information contained herein is true and complete to the best of my knowledge and belief.  Signature Cy Cowan Printed Name Regulatory Agent Title November 11, 2003 Date
				¹⁸ SURVEYOR CERTIFICATION I hereby certify that the well location shown on this plat was plotted from field notes of actual surveys made by me or under my supervision, and that the same is true and correct to the best of my belief. Date of Survey Signature and Seal of Professional Surveyor: REFER TO ORIGINAL PLAT Certificate Number

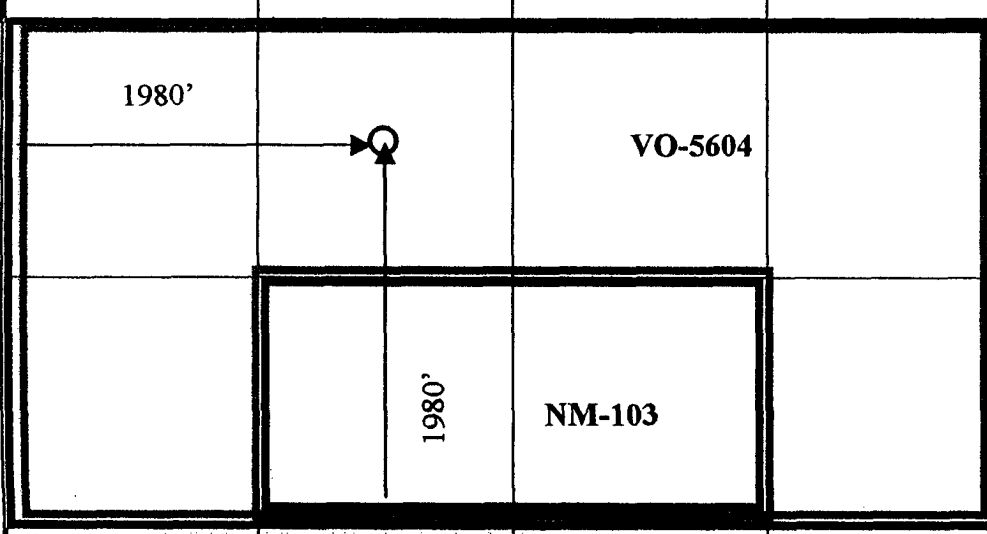

District IV
2040 South Pacheco, Santa Fe, NM 87505

OIL CONSERVATION DIVISION
2040 South Pacheco
Santa Fe, NM 87505

Form C-102
Revised March 17, 1999

Submit to Appropriate District Office
State Lease - 4 Copies
Fee Lease - 3 Copies

☐ AMENDED REPORT

1 API Number		2 Pool Code		3 Pool Name Wildcat Morrow	
4 Property Code		5 Property Name JUNIOR "AWW" STATE COM			6 Well Number 1
7 OGRID No. 025575		8 Operator Name YATES PETROLEUM CORPORATION			9 Elevation 3550.

UL or lot no.	Section	Township	Range	Lot Idn	Feet from the	North/South line	Feet from the	East/West line	County
K	17	16-S	28-E		1980	SOUTH	1980	WEST	EDDY

UL or lot no.	Section	Township	Range	Lot Idn	Feet from the	North/South line	Feet from the	East/West line	County
---------------	---------	----------	-------	---------	---------------	------------------	---------------	----------------	--------

11 Dedicated Acres	12 Joint or Infill	13 Consolidation Code	14 Order No.
320			

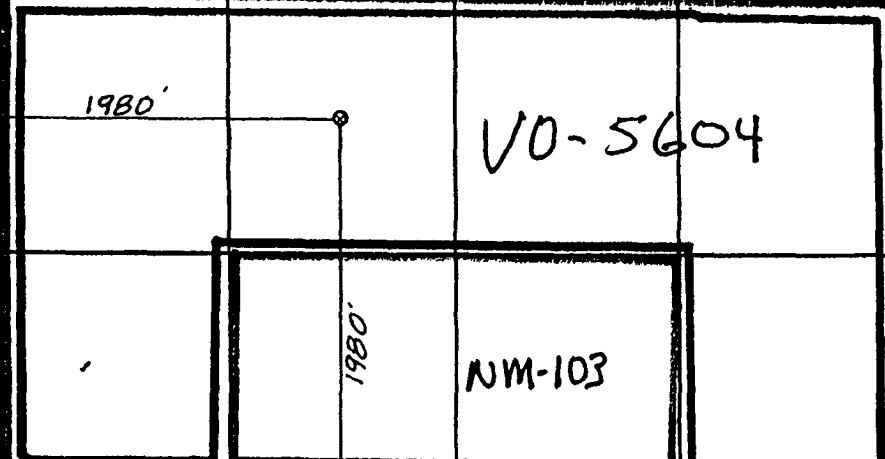
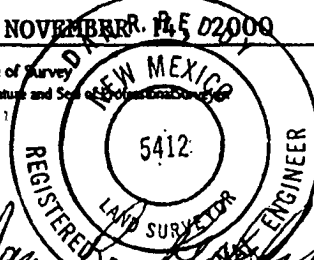
16				17 OPERATOR CERTIFICATION	
				I hereby certify that the information contained herein is true and complete to the best of my knowledge and belief	
					
				Signature	Cy Cowan
				Printed Name	Regulatory Agent
				Title	November 29, 2000
				Date	
				18 SURVEYOR CERTIFICATION	
				I hereby certify that the well location shown on this plat was plotted from field notes of actual surveys made by me or under my supervision, and that the same is true and correct to the best of my belief.	
				NOVEMBER 25 2000	
				Date of Survey	
				Signature and Seal of Professional Engineer	
					



Yates Petroleum Corporation

Typical 3,000 psi Pressure System Schematic Annular with Double Ram Preventer Stack

BOP-3

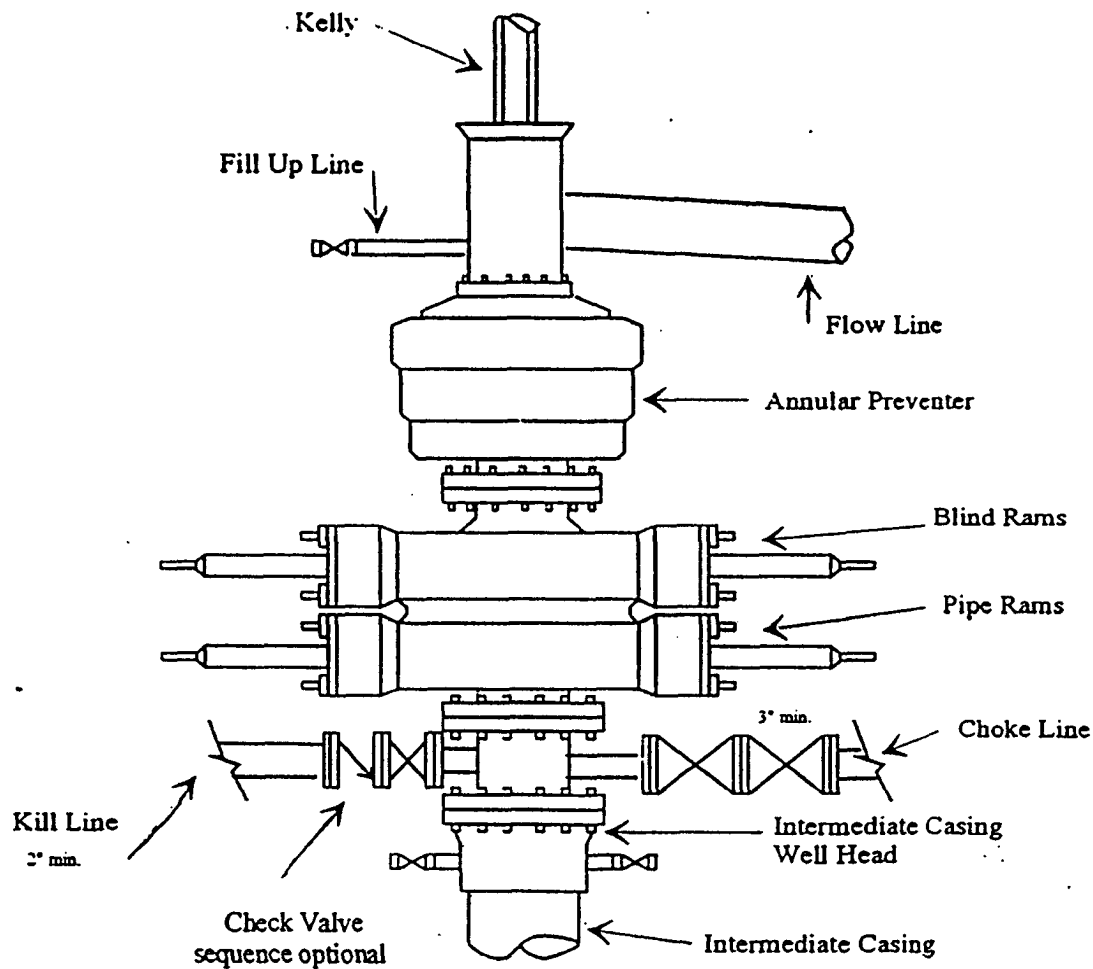

Typical 3,000 psi choke manifold assembly with at least these minimum features

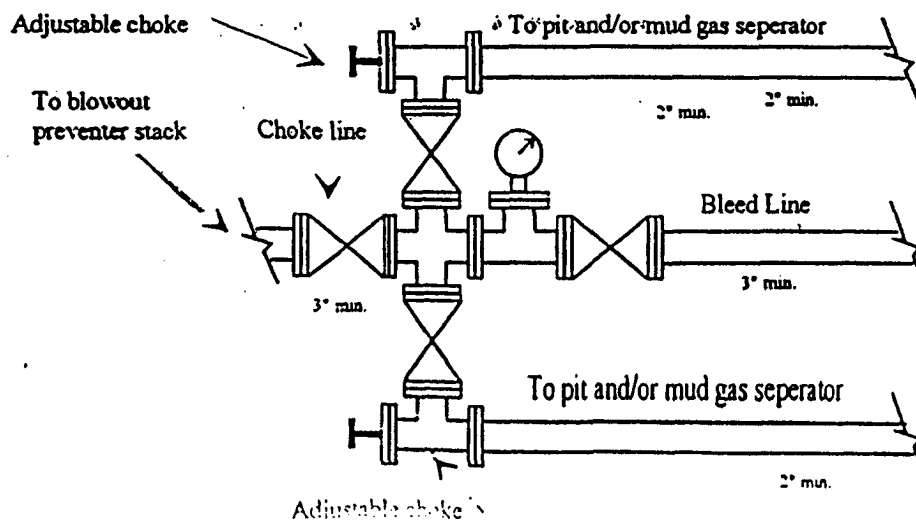

Submit 3 Copies
to Appropriate
District Office

State of New Mexico
Energy, Minerals and Natural Resources Department

Form C-103
Revised 1-1-89

DISTRICT I
P.O. Box 1980, Hobbs, NM 88240

DISTRICT II
P.O. Drawer DD, Artesia, NM 88210

DISTRICT III
1000 Rio Brazos Rd., Aztec, NM 87410

OIL CONSERVATION DIVISION
P.O. Box 2088
Santa Fe, New Mexico 87504-2088

WELL API NO.
30-015-31484

5. Indicate Type of Lease
STATE ☒ FEE ☐

6. State Oil & Gas Lease No.
VO-5604

7. Lease Name or Unit Agreement Name
Junior AWW State Com

8. Well No.
1

9. Pool name or Wildcat
Wildcat Morrow

10. Elevation (Show whether DF, RKB, RT, GR, etc.)
3550' GR

SUNDRY NOTICES AND REPORTS ON WELLS
(DO NOT USE THIS FORM FOR PROPOSALS TO DRILL OR TO DEEPEN OR PLUG BACK TO A
DIFFERENT RESERVOIR. USE "APPLICATION FOR PERMIT"
(FORM C-101) FOR SUCH PROPOSALS.)

1. Type of Well:
OIL WELL ☐ GAS WELL ☒ OTHER

2. Name of Operator
YATES PETROLEUM CORPORATION

3. Address of Operator
105 South 4th St., Artesia, NM 88210

4. Well Location
Unit Letter K : 1980 Feet From The South Line and 1980 Feet From The West Line
Section 17 Township 16S Range 28E NMFM Eddy County

11. Check Appropriate Box to Indicate Nature of Notice, Report, or Other Data

NOTICE OF INTENTION TO:		SUBSEQUENT REPORT OF:	
PERFORM REMEDIAL WORK <input type="checkbox"/>	PLUG AND ABANDON <input type="checkbox"/>	REMEDIAL WORK <input type="checkbox"/>	ALTERING CASING <input type="checkbox"/>
TEMPORARILY ABANDON <input type="checkbox"/>	CHANGE PLANS <input checked="" type="checkbox"/>	COMMENCE DRILLING OPNS. <input type="checkbox"/>	PLUG AND ABANDONMENT <input type="checkbox"/>
PULL OR ALTER CASING <input type="checkbox"/>		CASING TEST AND CEMENT JOB <input type="checkbox"/>	
OTHER: <input type="checkbox"/>		OTHER: <input type="checkbox"/>	

12. Describe Proposed or Completed Operations (Clearly state all pertinent details, and give pertinent dates, including estimated date of starting any proposed work) SEE RULE 1103.

Surface casing will be added as follows:

14-3/4" hole with 11-3/4" 42# casing set at 300' with 200 sacks of cement, circulated

The intermediate hole size will change from 12-1/4" to 11" with remainder of proposed casing program noted on the Application for Permit to Drill to remain the same.

I hereby certify that the information above is true and complete to the best of my knowledge and belief.

SIGNATURE Rusty Klein TITLE Operations Technician DATE Dec. 1, 2000
TYPE OR PRINT NAME Rusty Klein TELEPHONE NO. 505/748-1471

(This space for State Use)

ORIGINAL SIGNED BY TIM W. GUM
DISTRICT II SUPERVISOR *B6*

DEC 11 2000

APPROVED BY _____ TITLE _____ DATE _____

CONDITIONS OF APPROVAL, IF ANY:

MARTIN YATES, III
1912 - 1985
FRANK W. YATES
1936 - 1986



105 SOUTH FOURTH STREET
ARTESIA, NEW MEXICO 88210-2118
TELEPHONE (505) 748-1471

S. P. YATES
CHAIRMAN OF THE BOARD
JOHN A. YATES
PRESIDENT
PEYTON YATES
EXECUTIVE VICE PRESIDENT
RANDY G. PATTERSON
SECRETARY
DENNIS G. KINSEY
TREASURER

November 11, 2003

Mr. Bryan Arrant
Oil Conservation Division, District II Office
1301 W. Grand Ave.
Artesia, NM 88210

Re: Junior AWW State Com. #1
1980' FSL and 1980' FWL
Section 17, T16S-R28E
Eddy County, New Mexico
H2S Contingency Plan

Sources at Yates Petroleum Corporation have relayed information to me that they believe there will not be enough H2S anticipated from the surface to the Morrow Formation to even meet the OCD's minimum requirements for the submission of a contingency plan per Rule 118.

Thank you,

YATES PETROLEUM CORPORATION

Debbie L. Caffall
Regulatory Technician

Submit 3 Copies To Appropriate District Office
District I
1625 N. French Dr., Hobbs, NM 88240
District II
1301 W. Grand Ave., Artesia, NM 88210
District III
1000 Rio Brazos Rd., Aztec, NM 87410
District IV
1220 S. St. Francis Dr., Santa Fe, NM 87505

State of New Mexico
Energy, Minerals and Natural Resources

OIL CONSERVATION DIVISION
1220 South St. Francis Dr.
Santa Fe, NM 87505

Form C-103
March 4, 2004

WELL API NO.
30-015-31484

5. Indicate Type of Lease
STATE ☐

FEE ☒

6. State Oil & Gas Lease No.
VO-5604

7. Lease Name or Unit Agreement Name
Junior AWW State Com.

8. Well Number
1

9. OGRID Number
025575

10. Pool name or Wildcat
Crow Flats Morrow

RECEIVED

OCT 14 2004

OCD-ARTESIA

SUNDRY NOTICES AND REPORTS ON WELLS
(DO NOT USE THIS FORM FOR PROPOSALS TO DRILL OR TO DEEPEN OR PLUG BACK TO A DIFFERENT RESERVOIR. USE "APPLICATION FOR PERMIT" (FORM C-101) FOR SUCH PROPOSALS.)

1. Type of Well:
Oil Well ☐ Gas Well ☒ Other

2. Name of Operator
Yates Petroleum Corporation

3. Address of Operator
105 South 4th Street, Artesia, New Mexico, 88210

4. Well Location

Unit Letter: K : 1980 feet from the South line and 1980 feet from the West line

Section 17 Township 16S Range 28E NMPM County Eddy

11. Elevation (Show whether DR, RKB, RT, GR, etc.)
3550' GR

Pit or Below-grade Tank Application (For pit or below-grade tank closures, a form C-144 must be attached)

Pit Location: UL K Sect 17 Twp 16S Rng 28E Pit type Drilling Depth to Groundwater N/A Distance from nearest fresh water well N/A

Distance from nearest surface water N/A Below-grade Tank Location UL Sect Twp Rng ;
feet from the line and feet from the line

12. Check Appropriate Box to Indicate Nature of Notice, Report or Other Data

NOTICE OF INTENTION TO:		SUBSEQUENT REPORT OF:	
PERFORM REMEDIAL WORK <input type="checkbox"/>	PLUG AND ABANDON <input type="checkbox"/>	REMEDIAL WORK <input type="checkbox"/>	ALTERING CASING <input type="checkbox"/>
TEMPORARILY ABANDON <input type="checkbox"/>	CHANGE PLANS <input type="checkbox"/>	COMMENCE DRILLING OPNS. <input type="checkbox"/>	PLUG AND ABANDONMENT <input type="checkbox"/>
PULL OR ALTER CASING <input type="checkbox"/>	MULTIPLE COMPLETION <input type="checkbox"/>	CASING TEST AND CEMENT JOB <input type="checkbox"/>	
OTHER: <input type="checkbox"/>		OTHER: <input checked="" type="checkbox"/> Extend APD	

13. Describe proposed or completed operations. (Clearly state all pertinent details, and give pertinent dates, including estimated date of starting any proposed work). SEE RULE 1103. For Multiple Completions: Attach wellbore diagram of proposed completion or recompletion.

Yates Petroleum Corporation request to extend the captioned well's APD expiration date for one (1) year to November 13, 2005. A drilling pit will be constructed at this wellsite under Yates Petroleum Corporation general plan that was approved by OCD on April 15, 2004. Sources at Yates Petroleum Corporation have relayed information to me that they believe there will be enough H2S anticipated from the surface to the Morrow Formation to meet the OCD's minimum requirements for the submission of a contingency plan per rule 118. The State Engineers Web Site has been accessed for the captioned well. There were no records found of ground water depth, water well, or any indication of any surface water in the area surrounding this well location.
Thank you,

I hereby certify that the information above is true and complete to the best of my knowledge and belief. I further certify that any pit or below-grade tank has been/will be constructed or closed according to NMOCD guidelines ☐, a general permit ☒ or an (attached) alternative OCD-approved plan ☐.

SIGNATURE Debbie L. Caffall TITLE Regulatory Technician/Land Department DATE October 11, 2004

Type or print name: Debbie L. Caffall E-mail address: debbiec@ypcnm.com Telephone No. (505) 748-1471
(This space for State use)

APPROVED BY TIM W. GUM DISTRICT II SUPERVISOR DATE OCT 21 2004
Conditions of approval, if any:

French Dr., Hobbs, NM 88240
District II
1301 W. Grand Avenue, Artesia, NM 88210
District III
1000 Rio Brazos Road, Aztec, NM 87410
District IV
1220 S. St. Francis Dr., Santa Fe, NM 87505

State of New Mexico
Energy Minerals and Natural Resources

Oil Conservation Division
1220 South St. Francis Dr.
Santa Fe, NM 87505

Form C-144
March 12, 2004

For drilling and production facilities, submit to appropriate NMOCD District Office.
For downstream facilities, submit to Santa Fe office

Pit or Below-Grade Tank Registration or Closure

Is pit or below-grade tank covered by a "general plan"? Yes ☒ No ☐

Type of action: Registration of a pit or below-grade tank ☒ Closure of a pit or below-grade tank ☐

Operator: <u>Yates Petroleum Corporation</u> Telephone: <u>(505) 748-4372</u> e-mail address: <u>debbiec@ypcnm.com</u>		
Address: <u>105 South 4th Street, Artesia, NM 88210</u> <u>(30-015-31484)</u>		
Facility or well name: <u>Junior AWW State Com #1</u> API #: _____ U/L or Qtr/Qtr <u>K</u> Sec <u>17</u> T <u>16S</u> R <u>28E</u>		
County: <u>Eddy</u> Latitude _____ Longitude _____ NAD: 1927 <input type="checkbox"/> 1983 <input type="checkbox"/> Surface Owner: Federal <input type="checkbox"/> State <input checked="" type="checkbox"/> Private <input type="checkbox"/> Indian <input type="checkbox"/>		
Pit Type: Drilling <input checked="" type="checkbox"/> Production <input type="checkbox"/> Disposal <input type="checkbox"/> Workover <input type="checkbox"/> Emergency <input type="checkbox"/> Lined <input checked="" type="checkbox"/> Unlined <input type="checkbox"/> Liner type: Synthetic <input checked="" type="checkbox"/> Thickness <u>12 mil</u> Clay <input type="checkbox"/> Volume _____ bbl	Below-grade tank Volume: _____ bbl Type of fluid: _____ Construction material: _____ Double-walled, with leak detection? Yes <input type="checkbox"/> If not, explain why not. _____	RECEIVED OCT 12 2005 OCD-ARTESIA
Depth to ground water (vertical distance from bottom of pit to seasonal high water elevation of ground water.)	Less than 50 feet 50 feet or more, but less than 100 feet 100 feet or more	(20 points) (10 points) 10 (0 points)
Wellhead protection area: (Less than 200 feet from a private domestic water source, or less than 1000 feet from all other water sources.)	Yes No	(20 points) 20 (0 points)
Distance to surface water: (horizontal distance to all wetlands, playas, irrigation canals, ditches, and perennial and ephemeral watercourses.)	Less than 200 feet 200 feet or more, but less than 1000 feet 1000 feet or more	(20 points) (10 points) 20 (0 points)
Ranking Score (Total Points)		Points 50

If this is a pit closure: (1) attach a diagram of the facility showing the pit's relationship to other equipment and tanks. (2) Indicate disposal location:

onsite ☐ offsite ☐ If offsite, name of facility _____ (3) Attach a general description of remedial action taken including remediation start date and end date. (4) Groundwater encountered: No ☐ Yes ☐ If yes, show depth below ground surface _____ ft. and attach sample results. (5) Attach soil sample results and a diagram of sample locations and excavations.

I hereby certify that the information above is true and complete to the best of my knowledge and belief. I further certify that the above-described pit or below-grade tank has been/will be constructed or closed according to NMOCD guidelines ☐, a general permit ☒, or an (attached) alternative OCD-approved plan ☐.

Date: October 13, 2005

Printed Name/Title Debbie L. Caffall/Regulatory Technician Signature Debbie L. Caffall

Your certification and NMOCD approval of this application/closure does not relieve the operator of liability should the contents of the pit or tank contaminate ground water or otherwise endanger public health or the environment. Nor does it relieve the operator of its responsibility for compliance with any other federal, state, or local laws and/or regulations.

Approval: **OCT 14 2005**

Date: _____

Printed Name/Title Field Supervisor Signature [Signature]

As a condition of approval, if during pit construction water is encountered or if water seeps in pits after construction the **OCD MUST BE CONTACTED IMMEDIATELY!**

As a condition of approval, a closure plan must be submitted and approved prior to the commencement of closure procedures.