

District I  
1625 N. French Dr., Hobbs, NM 88240  
District II  
1301 W. Grand Avenue, Artesia, NM 88210  
District III  
1000 Rio Brazos Road, Aztec, NM 87410  
District IV  
1220 S. St. Francis Dr., Santa Fe, NM 87505

State of New Mexico  
Energy Minerals and Natural Resources

Form C-101  
May 27, 2004

Oil Conservation Division  
1220 South St. Francis Dr.  
Santa Fe, NM 87505

Submit to appropriate District Office

☐ AMENDED REPORT

APPLICATION FOR PERMIT TO DRILL, RE-ENTER, DEEPEN, PLUGBACK, OR ADD A ZONE

<sup>1</sup> Operator Name and Address Yates Petroleum Corporation 105 S. 4 <sup>th</sup> Street Artesia, NM 88210		<sup>2</sup> OGRID Number 025575
<sup>3</sup> Property Code 15141		<sup>4</sup> API Number 30-015-23433
<sup>5</sup> Property Name Gardner Draw Unit		<sup>6</sup> Well No. 5
<sup>9</sup> Proposed Pool 1 Crocket Canyon - Atoka - Morrow		<sup>10</sup> Proposed Pool 2 Wildcat Strawn

<sup>7</sup> Surface Location

UL or lot no. E	Section 32	Township 19S	Range 21E	Lot Idn	Feet from the 2015	North/South line North	Feet from the 660	East/West line West	County Eddy
--------------------	---------------	-----------------	--------------	---------	-----------------------	---------------------------	----------------------	------------------------	----------------

<sup>8</sup> Proposed Bottom Hole Location If Different From Surface

UL or lot no.	Section	Township	Range	Lot Idn	Feet from the	North/South line	Feet from the	East/West line	County
---------------	---------	----------	-------	---------	---------------	------------------	---------------	----------------	--------

Additional Well Information

<sup>11</sup> Work Type Code A	<sup>12</sup> Well Type Code G	<sup>13</sup> Cable/Rotary N/A	<sup>14</sup> Lease Type Code S	<sup>15</sup> Ground Level Elevation 4541' GR
<sup>16</sup> Multiple Y	<sup>17</sup> Proposed Depth N/A	<sup>18</sup> Formation Morrow	<sup>19</sup> Contractor N/A	<sup>20</sup> Spud Date ASAP
Depth to Groundwater		Distance from nearest fresh water well		Distance from nearest surface water
Pit: Liner: Synthetic <input type="checkbox"/> _____ mils thick Clay <input type="checkbox"/> Pit Volume: _____ bbls Drilling Method: _____				
Closed-Loop System <input checked="" type="checkbox"/> Fresh Water <input type="checkbox"/> Brine <input type="checkbox"/> Diesel/Oil-based <input type="checkbox"/> Gas/Air <input type="checkbox"/>				

<sup>21</sup> Proposed Casing and Cement Program

Hole Size	Casing Size	Casing weight/foot	Setting Depth	Sacks of Cement	Estimated TOC
		IN PLACE			

<sup>22</sup> Describe the proposed program. If this application is to DEEPEN or PLUG BACK, give the data on the present productive zone and proposed new productive zone. Describe the blowout prevention program, if any. Use additional sheets if necessary.

Yates Petroleum Corporation plans to workover and possibly recompleate this well as follows: Perforate additional Morrow 7326'-7330' (24). Stimulate as needed. Set a composite flow through plug (flapper style) at 7215'. Perforate Atoka 7126'-7132' (36) and 7154'-7166' (72). Stimulate as needed. Set a composite flow through plug (flapper style) at 6958'. Perforate Strawn 6902'-6908' (36). Stimulate as needed.

NSL - 5490

<sup>23</sup> I hereby certify that the information given above is true and complete to the best of my knowledge and belief. I further certify that the drilling pit will be constructed according to NMOCD guidelines <input type="checkbox"/> , a general permit <input type="checkbox"/> , or an (attached) alternative OCD-approved plan <input type="checkbox"/> .		OIL CONSERVATION DIVISION	
Signature: 		Approved by:	
Printed name: Tina Huerta		BRYAN G. ARANT DISTRICT II GEOLOGIST	
Title: Regulatory Compliance Supervisor		Title:	
E-mail Address: tina@ypcnm.com		Approval Date: JAN 04 2007 Expiration Date: JAN 04 2008	
Date: October 4, 2006	Phone: 505-748-4168	Conditions of Approval Attached <input type="checkbox"/>	

District I  
1625 N. French Dr., Hobbs, NM 88240  
District II  
1301 W. Grand Avenue, Artesia, NM 88210  
District III  
1000 Rio Brazos Rd., Aztec, NM 87410  
District IV  
1220 S. St. Francis Dr., Santa Fe, NM 87505

State of New Mexico  
Energy, Minerals & Natural Resources Department  
OIL CONSERVATION DIVISION  
1220 South St. Francis Dr.  
Santa Fe, NM 87505

Form C-102  
Revised October 12, 2005  
Submit to Appropriate District Office  
State Lease - 4 Copies  
Fee Lease - 3 Copies

☐ AMENDED REPORT

WELL LOCATION AND ACREAGE DEDICATION PLAT

<sup>1</sup> API Number 30-015-23433	<sup>2</sup> Pool Code 97158	<sup>3</sup> Pool Name Crooked Canyon; Atolia - Morrow
<sup>4</sup> Property Code 15141	<sup>5</sup> Property Name Gardner Draw Unit	<sup>6</sup> Well Number 5
<sup>7</sup> OGRID No. 025575	<sup>8</sup> Operator Name Yates Petroleum Corporation	<sup>9</sup> Elevation 4541'GR

<sup>10</sup> Surface Location

UL or lot no. E	Section 32	Township 19S	Range 21E	Lot Idn	Feet from the 2015	North/South line North	Feet from the 660	East/West line West	County Eddy
--------------------	---------------	-----------------	--------------	---------	-----------------------	---------------------------	----------------------	------------------------	----------------

<sup>11</sup> Bottom Hole Location If Different From Surface

UL or lot no.	Section	Township	Range	Lot Idn	Feet from the	North/South line	Feet from the	East/West line	County
---------------	---------	----------	-------	---------	---------------	------------------	---------------	----------------	--------

<sup>12</sup> Dedicated Acres 320	<sup>13</sup> Joint or Infill	<sup>14</sup> Consolidation Code	<sup>15</sup> Order No.
--------------------------------------	-------------------------------	----------------------------------	-------------------------

No allowable will be assigned to this completion until all interests have been consolidated or a non-standard unit has been approved by the division.

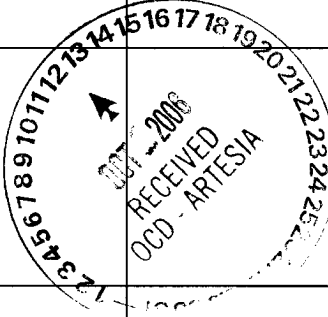
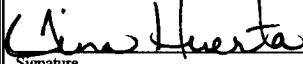
<sup>16</sup> 2015.14 660'W					<sup>17</sup> OPERATOR CERTIFICATION I hereby certify that the information contained herein is true and complete to the best of my knowledge and belief, and that this organization either owns a working interest or unleased mineral interest in the land including the proposed bottom hole location or has a right to drill this well at this location pursuant to a contract with an owner of such a mineral or working interest, or to a voluntary pooling agreement or a compulsory pooling order heretofore entered by the division.  Signature October 4, 2006 Date
					Tina Huerta Printed Name
					<sup>18</sup> SURVEYOR CERTIFICATION I hereby certify that the well location shown on this plat was plotted from field notes of actual surveys made by me or under my supervision, and that the same is true and correct to the best of my belief.  Date of Survey Signature and Seal of Professional Surveyor:  Certificate Number

District I  
1625 N. French Dr., Hobbs, NM 88240  
District II  
1301 W. Grand Avenue, Artesia, NM 88210  
District III  
1000 Rio Brazos Rd., Aztec, NM 87410  
District IV  
1220 S. St. Francis Dr., Santa Fe, NM 87505

State of New Mexico  
Energy, Minerals & Natural Resources Department  
OIL CONSERVATION DIVISION  
1220 South St. Francis Dr.  
Santa Fe, NM 87505

Form C-102  
Revised October 12, 2005  
Submit to Appropriate District Office  
State Lease - 4 Copies  
Fee Lease - 3 Copies

☐ AMENDED REPORT

WELL LOCATION AND ACREAGE DEDICATION PLAT

<sup>1</sup> API Number 30-015-23433	<sup>2</sup> Pool Code	<sup>3</sup> Pool Name Wildcat Strawn
<sup>4</sup> Property Code 15141	<sup>5</sup> Property Name Gardner Draw Unit	<sup>6</sup> Well Number 5
<sup>7</sup> OGRID No. 025575	<sup>8</sup> Operator Name Yates Petroleum Corporation	<sup>9</sup> Elevation 4541'GR

<sup>10</sup> Surface Location

UL or lot no. E	Section 32	Township 19S	Range 21E	Lot Idn	Feet from the 2015	North/South line North	Feet from the 660	East/West line West	County Eddy
--------------------	---------------	-----------------	--------------	---------	-----------------------	---------------------------	----------------------	------------------------	----------------

<sup>11</sup> Bottom Hole Location If Different From Surface

UL or lot no.	Section	Township	Range	Lot Idn	Feet from the	North/South line	Feet from the	East/West line	County
---------------	---------	----------	-------	---------	---------------	------------------	---------------	----------------	--------

<sup>12</sup> Dedicated Acres 320	<sup>13</sup> Joint or Infill	<sup>14</sup> Consolidation Code	<sup>15</sup> Order No.
--------------------------------------	-------------------------------	----------------------------------	-------------------------

No allowable will be assigned to this completion until all interests have been consolidated or a non-standard unit has been approved by the division.

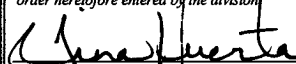
<sup>16</sup> 2015 N 660 W						<sup>17</sup> OPERATOR CERTIFICATION <i>I hereby certify that the information contained herein is true and complete to the best of my knowledge and belief, and that this organization either owns a working interest or unleased mineral interest in the land including the proposed bottom hole location or has a right to drill this well at this location pursuant to a contract with an owner of such a mineral or working interest, or to a voluntary pooling agreement or a compulsory pooling order heretofore entered by the division.</i>  Signature October 4, 2006 Date
						Tina Huerta Printed Name
						<sup>18</sup> SURVEYOR CERTIFICATION <i>I hereby certify that the well location shown on this plat was plotted from field notes of actual surveys made by me or under my supervision, and that the same is true and correct to the best of my belief.</i>  Date of Survey Signature and Seal of Professional Surveyor:  Certificate Number

# Yates Petroleum Corporation

## Typical 3,000 psi Pressure System Schematic

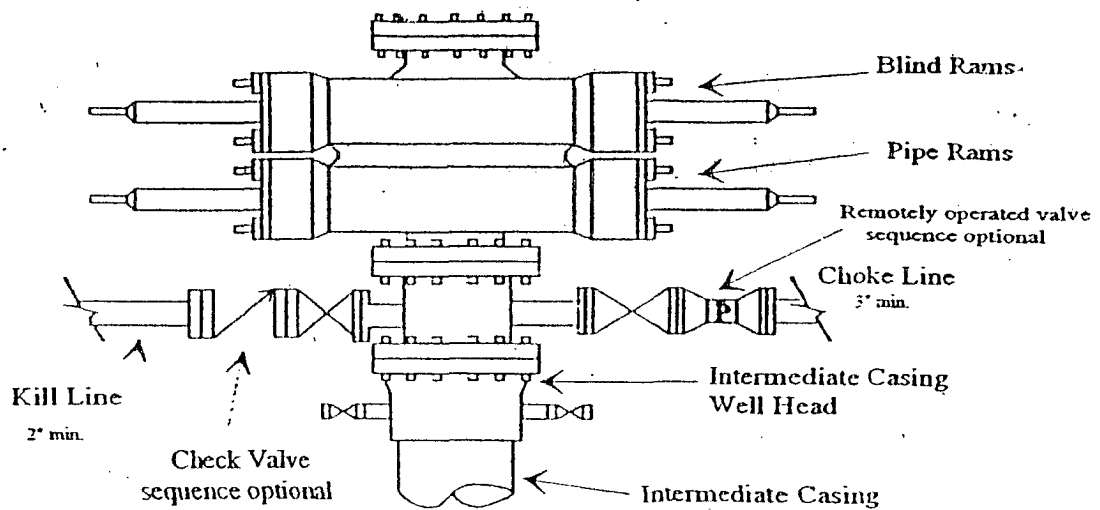

Typical 3,000 psi choke manifold assembly with at least these minimum features

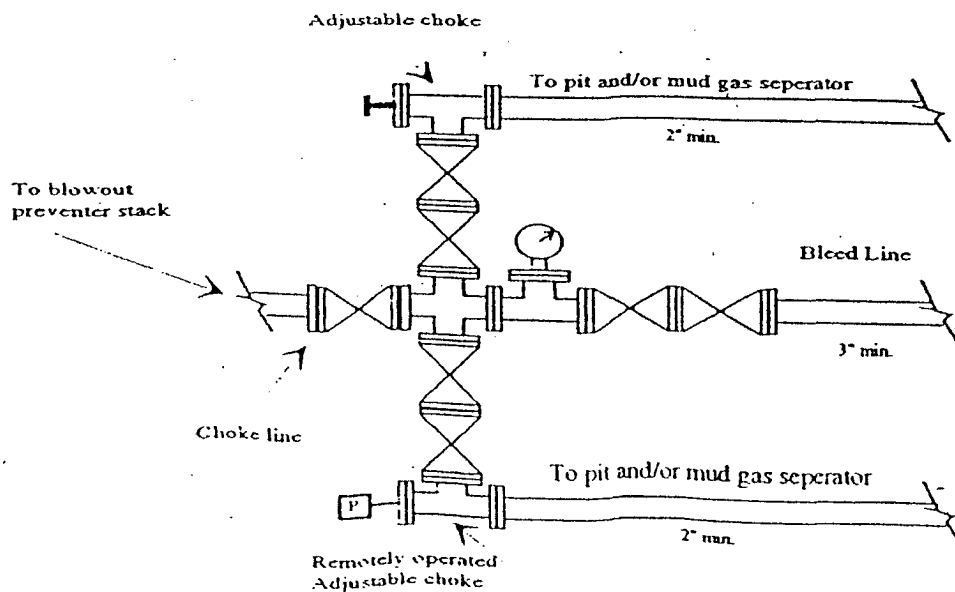

MARTIN YATES, III  
1912 - 1985  
FRANK W. YATES  
1936 - 1986



105 SOUTH FOURTH STREET  
ARTESIA, NEW MEXICO 88210-2118  
TELEPHONE (505) 748-1471

S. P. YATES  
CHAIRMAN OF THE BOARD  
JOHN A. YATES  
PRESIDENT  
PEYTON YATES  
EXECUTIVE VICE PRESIDENT  
RANDY G. PATTERSON  
SECRETARY  
DENNIS G. KINSEY  
TREASURER

October 4, 2006

Mr. Bryan Arrant  
Oil Conservation Division, District II Office  
1301 W. Grand Ave.  
Artesia, NM 88210



Re: Gardner Draw Unit #5  
Section 32-T19S-R21E  
Eddy County, New Mexico  
H2S Contingency Plan

Sources at Yates Petroleum Corporation have relayed information to me that they believe there will not be enough H2S anticipated from the surface to the Atoka formation to even meet the OCD's minimum requirements for the submission of a contingency plan per Rule 118.

Thank you,

YATES PETROLEUM CORPORATION

Tina Huerta  
Regulatory Compliance Supervisor