

District I
1625 N. French Dr., Hobbs, NM 88240
District II
1301 W. Grand Avenue, Artesia, NM 88210
District III
1000 Rio Brazos Rd., Aztec, NM 87410
District IV
1220 S. St. Francis Dr., Santa Fe, NM 87505

State of New Mexico
Energy, Minerals & Natural Resources

S

Oil Conservation Division
1220 S. St. Francis Dr.
Santa Fe, NM 87505

Form C-101
May 27, 2004

Month - Year
FEB 26 2007
OCD - ARTESIA, NM

Submit to appropriate District Office

☐ AMENDED REPORT

APPLICATION FOR PERMIT TO DRILL, RE-ENTER, DEEPEN, PLUGBACK, OR ADD A ZONE

¹ Operator Name and Address Nearburg Producing Company 3300 N A St., Bldg 2, Ste 120, Midland, TX 79705		² OGRID Number 015742
⁴ Property Code 36351	⁵ Property Name Halo 2 State	³ API Number 30- 015- 35452
⁹ Proposed Pool 1 Artesia; Queen-Grayburg-San Andres		¹⁰ Proposed Pool 2 3230

⁷ Surface Location

UL or lot no. P	Section 2	Township 19S	Range 27E	Lot. Idn	Feet from the 990	North/South Line South	Feet from the 660	East/West line East	County Eddy
---------------------------	---------------------	------------------------	---------------------	----------	-----------------------------	----------------------------------	-----------------------------	-------------------------------	-----------------------

⁸ Proposed Bottom Hole Location If Different From Surface

UL or lot no.	Section	Township	Range	Lot. Idn	Feet from the	North/South Line	Feet from the	East/West line	County
---------------	---------	----------	-------	----------	---------------	------------------	---------------	----------------	--------

Additional Well Location

¹¹ Work Type Code N	¹² Well Type Code O	¹³ Cable/Rotary R	¹⁴ Lease Type Code S	¹⁵ Ground Level Elevation 3515
¹⁶ Multiple No	¹⁷ Proposed Depth 2800'	¹⁸ Formation San Andres	¹⁹ Contractor	²⁰ Spud Date 3/15/07
Depth to ground water		Distance from nearest fresh water well		Distance from nearest surface water
Pit: Liner: Synthetic <input type="checkbox"/> _____ mils thick Clay <input type="checkbox"/> Pit Volume _____ bbls Drilling Method:				
Closed-Loop System <input type="checkbox"/> Fresh Water <input type="checkbox"/> Brine <input type="checkbox"/> Diesel/Oil-based <input type="checkbox"/> Gas/Air <input type="checkbox"/>				

²¹ Proposed Casing and Cement Program

Hole Size	Casing Size	Casing weight/foot	Setting Depth	Sacks of Cement	Estimated TOC
11	8-5/8	24	300	300	Surface
7-7/8	5-1/2	17	2800	300	Surface

²² Describe the proposed program. If this application is to DEEPEN or PLUG BACK, give the data on the present productive zone and proposed new productive zone. Describe the blowout prevention program, if any. Use additional sheets if necessary.

NPC proposes to drill well to sufficient depth to evaluate the San Andres formation. Perf, test and stimulate as necessary to establish production.

Acreeage dedication is 40 acres

²³ I hereby certify that the information given above is true and complete to the best of my knowledge and belief. I further certify that the drilling pit will be constructed according to NMOCD guidelines ☒ a general permit ☐, or an (attached) alternative OCD-approved plan ☐.

Signature: *Sarah Jordan*
Printed name: **Sarah Jordan**

Title: **Production/ Analyst**

E-mail Address: **sjordan@nearburg.com**

Date: **2/23/07**

Phone: **432/686-8235 x 203**

OIL CONSERVATION DIVISION

Approved by: **BRYAN G. ARRANT**
DISTRICT II GEOLOGIST

Title:

Approval Date: **MAR 03 2007**

Expiration Date: **MAR 03 2008**

Conditions of Approval:

Attached ☐

DISTRICT I
1625 N. FRENCH DR., HOHES, NM 88240

DISTRICT II
1301 W. GRAND AVENUE, ARTESIA, NM 88210

DISTRICT III
1000 Rio Brazos Rd., Aztec, NM 87410

DISTRICT IV
1220 S. ST. FRANCIS DR., SANTA FE, NM 87505

State of New Mexico
Energy, Minerals and Natural Resources Department

S

OIL CONSERVATION DIVISION
1220 SOUTH ST. FRANCIS DR.
Santa Fe, New Mexico 87505

Form C-102
Revised October 12, 2005
Submit to Appropriate District Office
State Lease - 4 Copies
Fee Lease - 3 Copies

Month-Year
FEB 26 2007
OCD - ARTESIA, NM

WELL LOCATION AND ACREAGE DEDICATION PLAT

☐ AMENDED REPORT

API Number	Pool Code 4949 3239	Property Name Artesia; Queen Grayburg San Andres
Property Code	Property Name HALO 2 STATE	Well Number 1
OGRID No. 015742	Operator Name NEARBURG PRODUCING COMPANY	Elevation 3515'

Surface Location

UL or lot No.	Section	Township	Range	Lot Idn	Feet from the	North/South line	Feet from the	East/West line	County
P	2	19-S	27-E		990	SOUTH	660	EAST	EDDY

Bottom Hole Location If Different From Surface

UL or lot No.	Section	Township	Range	Lot Idn	Feet from the	North/South line	Feet from the	East/West line	County

Dedicated Acres 40	Joint or Infill	Consolidation Code	Order No.
-----------------------	-----------------	--------------------	-----------

NO ALLOWABLE WILL BE ASSIGNED TO THIS COMPLETION UNTIL ALL INTERESTS HAVE BEEN CONSOLIDATED
OR A NON-STANDARD UNIT HAS BEEN APPROVED BY THE DIVISION

LOT 4	LOT 3	LOT 2	LOT 1
<p>GEODETIC COORDINATES NAD 27 NME Y=612884.4 N X=527947.7 E LAT.=32.684886° N LONG.=104.242496° W</p>			
<p>Diagram showing well location with dimensions: 660' and 990'.</p>			
<p>OPERATOR CERTIFICATION I hereby certify that the information herein is true and complete to the best of my knowledge and belief, and that this organization either owns a working interest or unleased mineral interest in the land including the proposed bottom hole location or has a right to drill this well at this location pursuant to a contract with an owner of such mineral or working interest, or to a voluntary pooling agreement or a compulsory pooling order heretofore entered by the division. Signature: [Signature] Date: [Date] Printed Name: [Name]</p>			
<p>SURVEYOR CERTIFICATION I hereby certify that the well location shown on this plat was plotted from field notes of actual surveys made by me or under my supervision, and that the same is true and correct to the best of my belief. FEBRUARY 1, 2007 Date Surveyed: [Date] AR Signature & Seal of Professional Surveyor: [Signature] Certificate No. GARY EIDSON 12841</p>			

SECTION 2, TOWNSHIP 19 SOUTH, RANGE 27 EAST, N.M.P.M.,
 EDDY COUNTY, NEW MEXICO

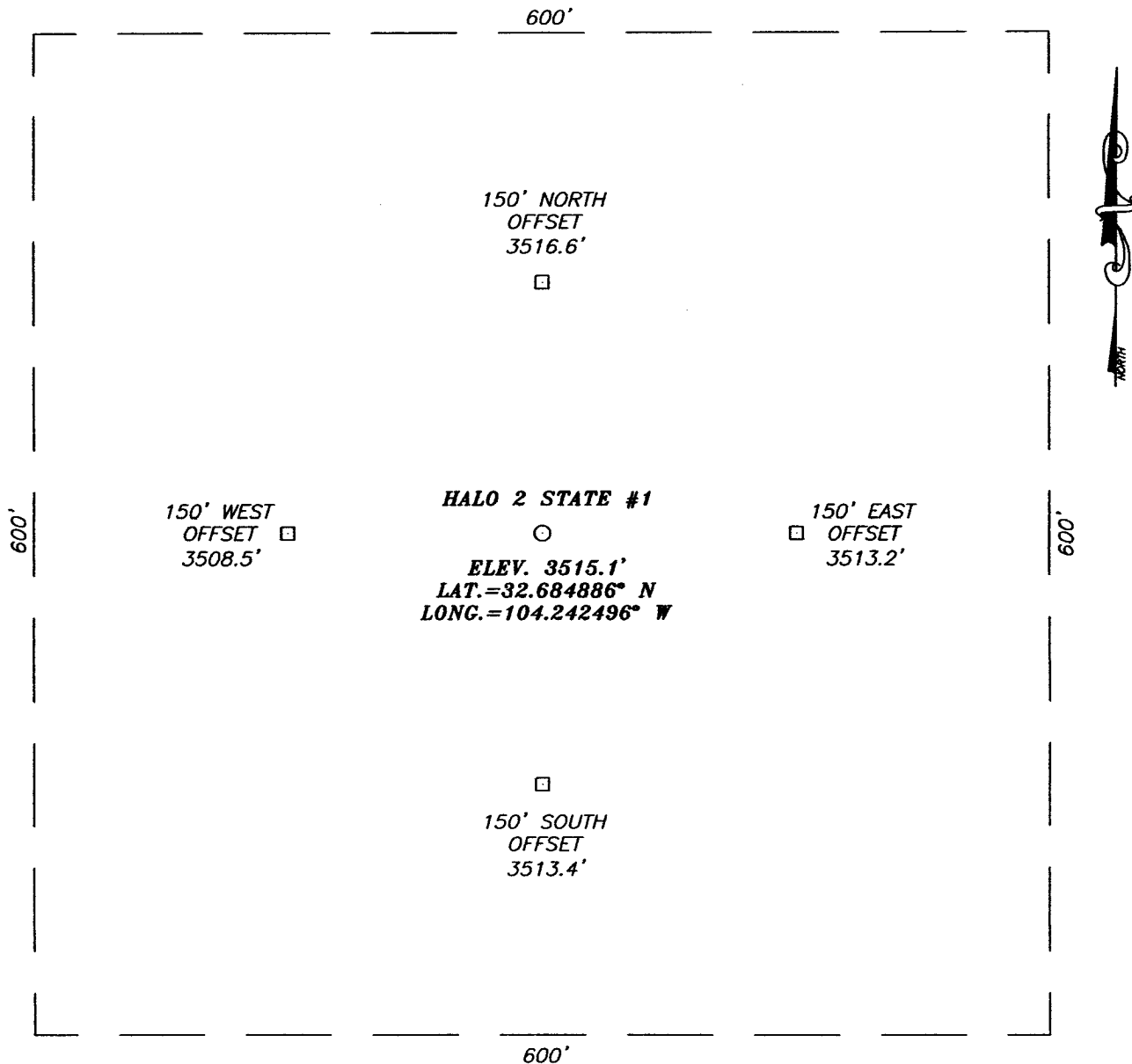

DIRECTIONS TO LOCATION

FROM THE INTERSECTION OF ILLINOIS CAMP RD. (#206) AND NETHERLIN RD. (#236), GO WEST ON NETHERLIN RD. APPROX. 1.2 MILES. TURN RIGHT AND GO NORTHWEST APPROX. 1.1 MILE. VEER RIGHT AND GO NORTHEAST APPROX. 0.5 MILES. TURN RIGHT AND GO EAST APPROX. 0.2 MILES TO THE MARBOB EAGLE CLAW ST. #1 WELL. THIS LOCATION IS APPROX. 654 FEET EAST IN PASTURE.

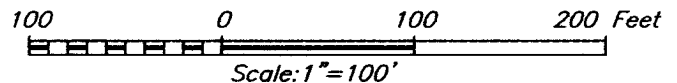

NEARBURG PRODUCING COMPANY

HALO 2 STATE #1 WELL
 LOCATED 990 FEET FROM THE SOUTH LINE
 AND 660 FEET FROM THE EAST LINE OF SECTION 2,
 TOWNSHIP 19 SOUTH, RANGE 27 EAST, N.M.P.M.,
 EDDY COUNTY, NEW MEXICO.

Survey Date: 02/01/07		Sheet 1 of 1 Sheets	
W.O. Number: 07.11.0146		Dr By: AR	Rev 1:N/A
Date: 02/06/07	Disk: CD#5	07110146	Scale: 1"=100'

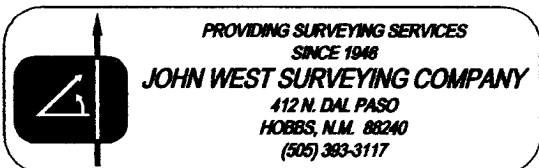

VICINITY MAP

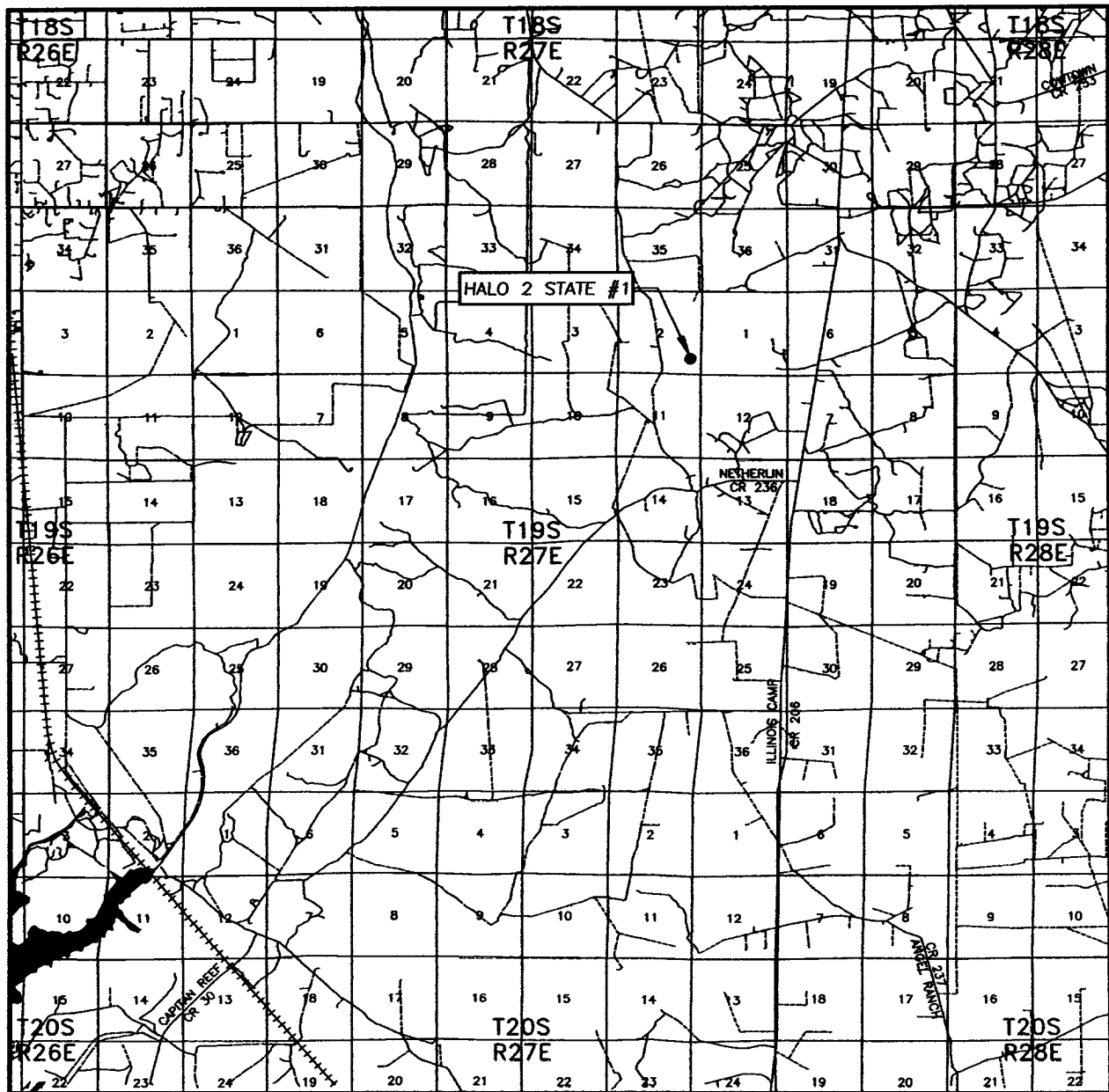

SCALE: 1" = 2 MILES

SEC. 2 TWP. 19-S RGE. 27-E
 SURVEY N.M.P.M.
 COUNTY EDDY STATE NEW MEXICO
 DESCRIPTION 990' FSL & 660' FEL
 ELEVATION 3515'
 OPERATOR NEARBURG PRODUCING COMPANY
 LEASE HALO 2 STATE

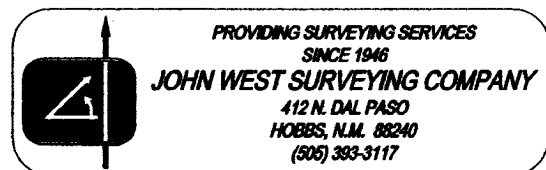

LOCATION VERIFICATION MAP

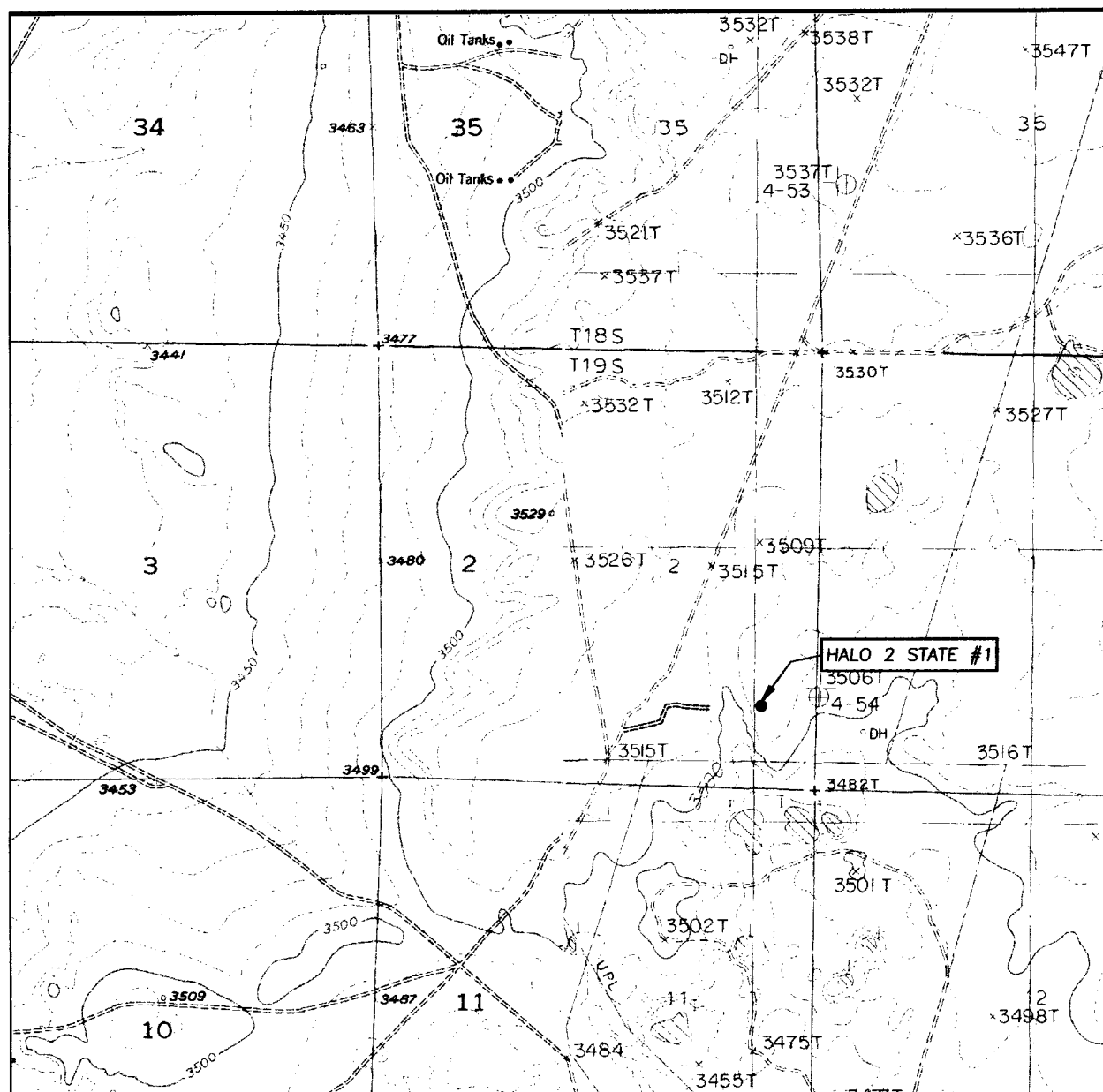

SCALE: 1" = 2000'

CONTOUR INTERVAL:
ILLINOIS CAMP, N.M. - 10'
SUPPLEMENTAL - 5'

SEC. 2 TWP. 19-S RGE. 27-E

SURVEY N.M.P.M.

COUNTY EDDY STATE NEW MEXICO

DESCRIPTION 990' FSL & 660' FEL

ELEVATION 3515'

OPERATOR NEARBURG
PRODUCING COMPANY

LEASE HALO 2 STATE

U.S.G.S. TOPOGRAPHIC MAP
ILLINOIS CAMP, N.M.

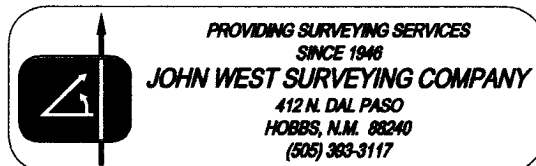

BOPE SCHEMATIC

Rotating Head (Optional)
Drilling Nipple option
must include a fill-up
line. Do not use kill line
for fill up.

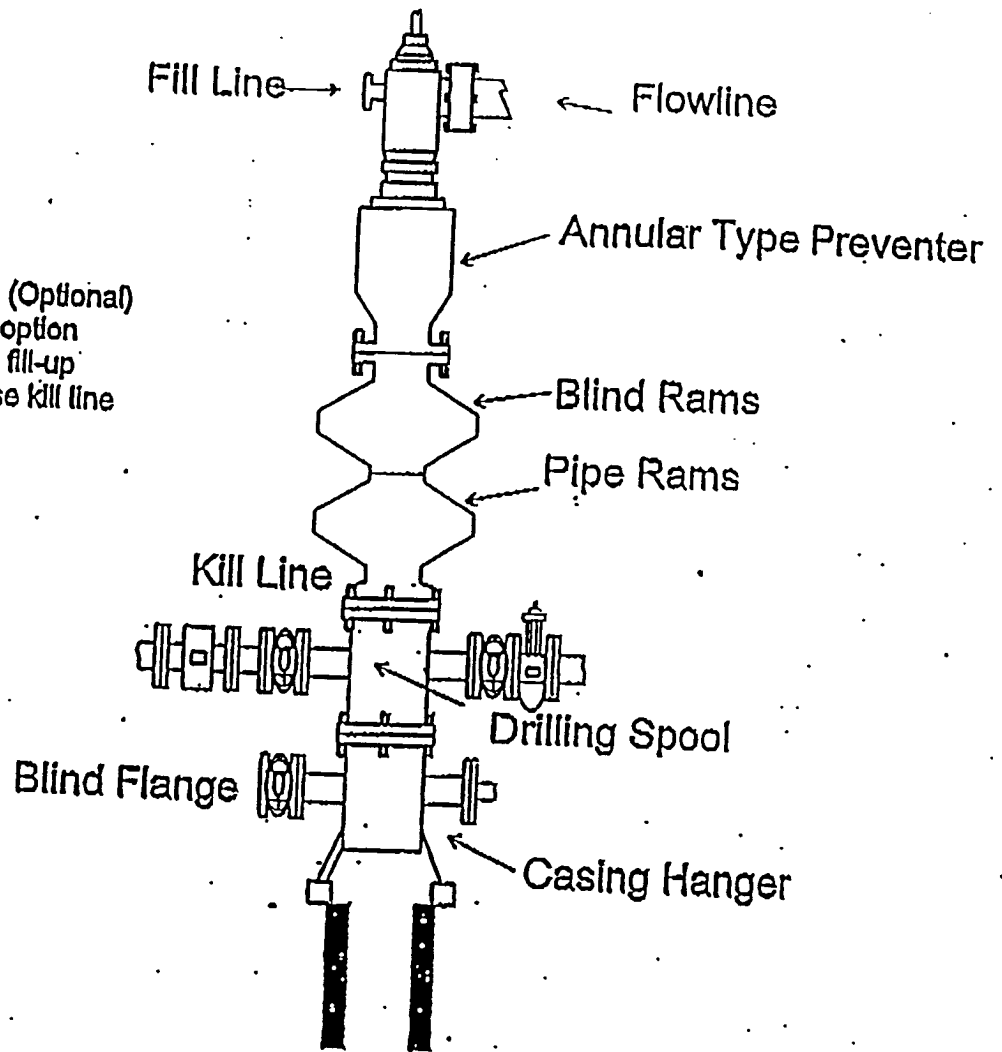

1500 Series

NEARBURG PRODUCING CO.
CHOKE MANIFOLD
5M SERVICE

