

District IV
1220 S. St. Francis Dr., Santa Fe, NM 87505



Oil Conservation Division
1220 South St. Francis Dr. IIII
Santa Fe, NM 87505

Form C-101
May 27, 2004

Submit to appropriate District Office

☐ AMENDED REPORT

OCD-ARTESIA

APPLICATION FOR PERMIT TO DRILL, RE-ENTER, DEEPEN, PLUGBACK, OR ADD A ZONE

¹ Operator Name and Address Yates Petroleum Corporation 105 S. 4 th Street Artesia, NM 88210		² OGRID Number 025575
		³ API Number 30-015-33733
⁴ Property Code 34426	⁵ Property Name Clayton BFO State Com	⁶ Well No. 1
⁹ Proposed Pool 1 Wildcat Atoka		¹⁰ Proposed Pool 2

⁷ Surface Location

UL or lot no. 1	Section 16	Township 19S	Range 26E	Lot Idn	Feet from the 1980	North/South line South	Feet from the 660	East/West line East	County Eddy
--------------------	---------------	-----------------	--------------	---------	-----------------------	---------------------------	----------------------	------------------------	----------------

⁸ Proposed Bottom Hole Location If Different From Surface

UL or lot no.	Section	Township	Range	Lot Idn	Feet from the	North/South line	Feet from the	East/West line	County
---------------	---------	----------	-------	---------	---------------	------------------	---------------	----------------	--------

Additional Well Information

¹¹ Work Type Code A	¹² Well Type Code G	¹³ Cable/Rotary N/A	¹⁴ Lease Type Code S	¹⁵ Ground Level Elevation 3354'GR
¹⁶ Multiple Y	¹⁷ Proposed Depth N/A	¹⁸ Formation Chester	¹⁹ Contractor N/A	²⁰ Spud Date ASAP
Depth to Groundwater		Distance from nearest fresh water well		Distance from nearest surface water
<u>Pit:</u> Liner. Synthetic <input type="checkbox"/> ____mils thick Clay <input type="checkbox"/> Pit Volume:____ bbls Drilling Method: Closed-Loop System <input checked="" type="checkbox"/> Fresh Water <input type="checkbox"/> Brine <input type="checkbox"/> Diesel/Oil-based <input type="checkbox"/> Gas/Air <input type="checkbox"/>				

²¹ Proposed Casing and Cement Program

Hole Size	Casing Size	Casing weight/foot	Setting Depth	Sacks of Cement	Estimated TOC
		IN PLACE			

²² Describe the proposed program. If this application is to DEEPEN or PLUG BACK, give the data on the present productive zone and proposed new productive zone. Describe the blowout prevention program, if any. Use additional sheets if necessary.

Yates Petroleum Corporation plans to recomplete this well as follows: Set a composite flow through BP at 9644'. Perforate Atoka 9142'-9152' (61), 9160'-9164' (25) and 9254'-9292' (153). Stimulate as needed.

²³ I hereby certify that the information given above is true and complete to the best of my knowledge and belief. **I further certify that the drilling pit will be constructed according to NMOC guidelines ☒, a general permit ☐, or an (attached) alternative OCD-approved plan ☐.**

Signature: Lina Huerta

Printed name: Tina Huerta

Title: Regulatory Compliance Supervisor

E-mail Address: tinah@ypcnm.com

Date: July 27, 2007

Phone: 505-748-4168

OIL CONSERVATION DIVISION

Approved by:

~~BRYAN G. ARRAANT~~

Title: **THE DISTRICT II GEOLOGIST**

Approval Date: **AUG 03 2001** Expiration Date: **AUG 05 2008**

Conditions of Approval Attached ☐

District I
1625 N. French Dr., Hobbs, NM 88240
District II
1301 W. Grand Avenue, Artesia, NM 88210
District III
1000 Rio Brazos Rd., Aztec, NM 87410
District IV
1220 S. St. Francis Dr., Santa Fe, NM 87505

State of New Mexico
Energy, Minerals & Natural Resources Department
OIL CONSERVATION DIVISION
1220 South St. Francis Dr.
Santa Fe, NM 87505

Form C-102
Revised October 12, 2005
Submit to Appropriate District Office
State Lease - 4 Copies
Fee Lease - 3 Copies
JUL 31 2007
OCD-ARTESIA
☐ AMENDED REPORT

WELL LOCATION AND ACREAGE DEDICATION PLAT

¹ API Number 30-015-33733	² Pool Code 96794	³ Pool Name Wildcat Atoka
⁴ Property Code 34426	⁵ Property Name Clayton BFO State Com	⁶ Well Number 1
⁷ OGRID No. 025575	⁸ Operator Name Yates Petroleum Corporation	⁹ Elevation 3354'GR

¹⁰ Surface Location

UL or lot no.	Section	Township	Range	Lot Idn	Feet from the	North/South line	Feet from the	East/West line	County
I	16	19S	26E		1980	South	660	East	Eddy

¹¹ Bottom Hole Location If Different From Surface

UL or lot no.	Section	Township	Range	Lot Idn	Feet from the	North/South line	Feet from the	East/West line	County
¹² Dedicated Acres 320	¹³ Joint or Infill	¹⁴ Consolidation Code	¹⁵ Order No.						

No allowable will be assigned to this completion until all interests have been consolidated or a non-standard unit has been approved by the division.

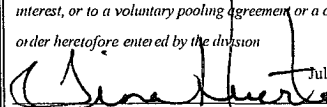
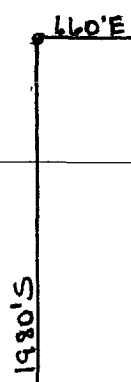
¹⁶						¹⁷ OPERATOR CERTIFICATION I hereby certify that the information contained herein is true and complete to the best of my knowledge and belief, and that this organization either owns a working interest or unleased mineral interest in the land including the proposed bottom hole location or has a right to drill this well at this location pursuant to a contract with an owner of such a mineral or working interest, or to a voluntary pooling agreement or a compulsory pooling order heretofore entered by the division  Signature Date July 27, 2007 Tina Huerta Printed Name
						¹⁸ SURVEYOR CERTIFICATION I hereby certify that the well location shown on this plat was plotted from field notes of actual surveys made by me or under my supervision, and that the same is true and correct to the best of my belief. Date of Survey Signature and Seal of Professional Surveyor.  Certificate Number

Yates Petroleum Corporation

Typical 3,000 psi Pressure System Schematic

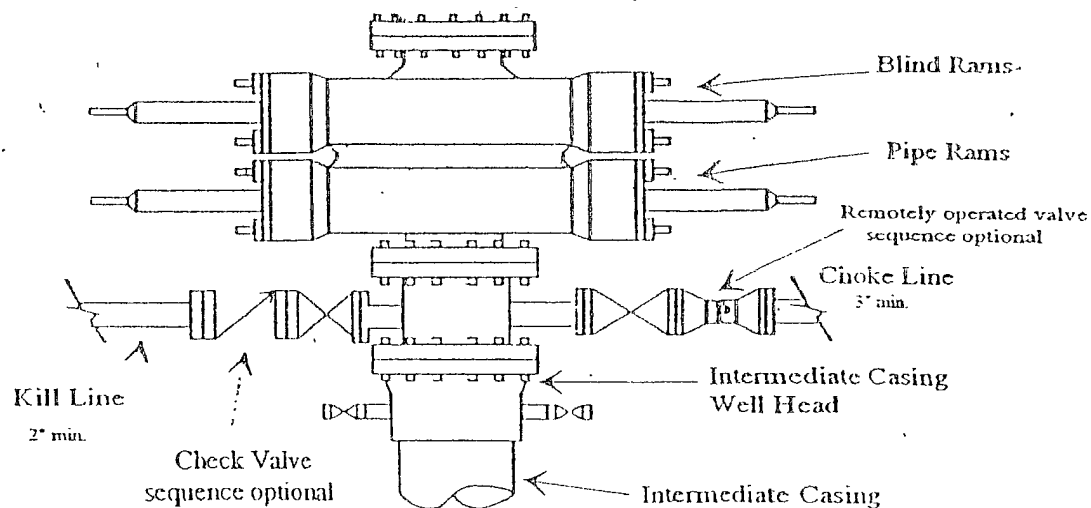

Typical 3,000 psi choke manifold assembly with at least these minimum features

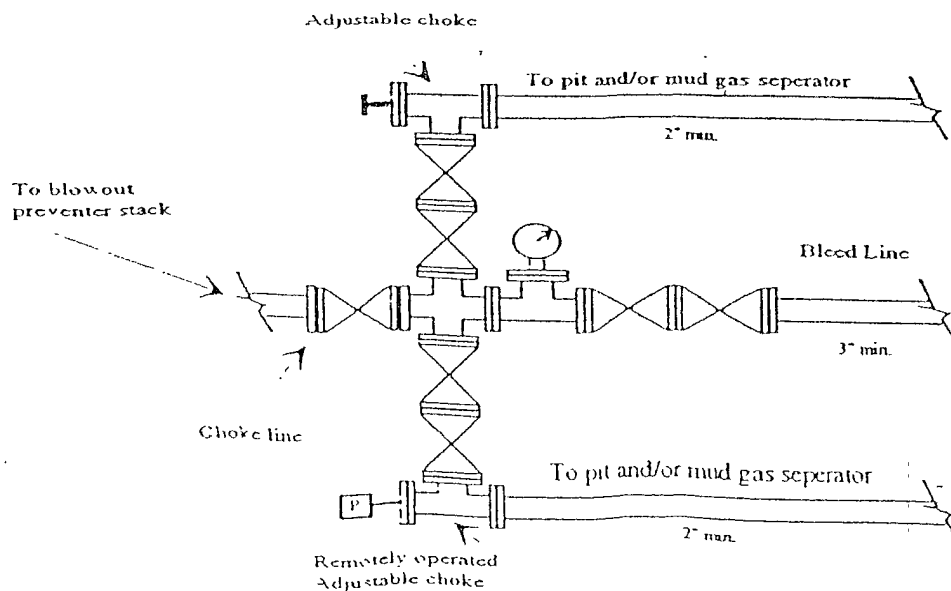

WELL NAME: Clayton BFO State Com #1

FIELD: Four Mile Draw

LOCATION: 1980' FSL & 660' FEL Sec 16-19S-26E Eddy County, NM

GL: ZERO: KB: 3510'

SPUD DATE: 7/14/05 COMPLETION DATE: 8/28/05

COMMENTS: API #30-015-33733

CASING PROGRAM

13-3/8" 48#	900
5-1/2" 17# P110 LT&C 1781'	
5-1/2" 17# J55 LT&C 1700'	
5-1/2" 15.5# J55 LT&C 5300'	
5-1/2" 17# J-55 LT&C 1100'	9900'

17-1/2" Hole

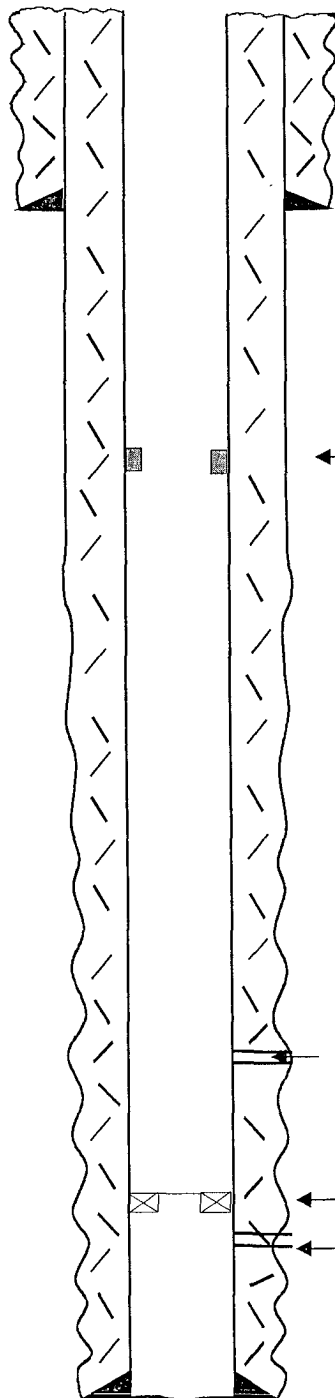

8-3/4" Hole

13-3/8" set at 900' with 810 sx
cement
1"ed to surface with 150 sx

DV Tool @ 4022'

Atoka Perfs: 9,142-9,152' (61); 9, 160-9,164 (25);
9,254-9,292' (153)

Composite Frac Plug @ 9,644'

Morrow Perfs: 9,694-9,702' (49)

TD 9900'

After

Not to Scale
1/29/07
DC/M.Hill

MARTIN YATES, III
1912-1985

FRANK W. YATES
1936-1986



105 SOUTH FOURTH STREET
ARTESIA, NEW MEXICO 88210-2118
TELEPHONE (505) 748-1471

S.P. YATES
CHAIRMAN EMERITUS

JOHN A. YATES
CHAIRMAN OF THE BOARD

PEYTON YATES
PRESIDENT

FRANK YATES, JR.
EXECUTIVE VICE PRESIDENT

JOHN A. YATES, JR.
SENIOR VICE PRESIDENT

July 27, 2007

JUL 31 2007
OCD-ARTESIA

Mr. Bryan Arrant
Oil Conservation Division, District II Office
1301 W. Grand Ave.
Artesia, NM 88210

Re: Clayton BFO State Com #1
Section 16-T19S-R26E
Eddy County, New Mexico
H2S Contingency Plan

Sources at Yates Petroleum Corporation have relayed information to me that they believe there will not be enough H2S anticipated from the surface to the Atoka formation to even meet the OCD's minimum requirements for the submission of a contingency plan per Rule 118.

Thank you,

YATES PETROLEUM CORPORATION

Tina Huerta
Regulatory Compliance Supervisor