

N.M. Oil Cons. DIV-Dist. 2
1301 W. Grand Avenue
Artesia, NM 88210

Form 3160-3
(August 1999)

UNITED STATES
DEPARTMENT OF THE INTERIOR
BUREAU OF LAND MANAGEMENT

0
OMB No. 1004-0136
Expires November 30, 2000

APPLICATION FOR PERMIT TO DRILL OR REENTER

1a. Type of Work: <input checked="" type="checkbox"/> DRILL <input type="checkbox"/> REENTER		5. Lease Serial No. NM-82904
b. Type of Well: <input checked="" type="checkbox"/> Oil Well <input type="checkbox"/> Gas Well <input type="checkbox"/> Other <input type="checkbox"/> Single Zone <input type="checkbox"/> Multiple Zone		6. If Indian, Allottee or Tribe Name
2. Name of Operator Yates Petroleum Corporation		7. If Unit or CA Agreement, Name and No.
3A. Address 105 South Fourth Street Artesia, New Mexico 88210		8. Lease Name and Well No. Adeline ALN Federal #12
3b. Phone No. (include area code) (505) 748-1471		9. API Well No. 30-015-32014
4. Location of Well (Report location clearly and in accordance with any State requirements. *) At surface 1800' FSL & 330' FWL At proposed prod. Zone Same		10. Field and Pool, or Exploratory Wildcat Delaware
14. Distance in miles and direction from nearest town or post office* Approximately 24 miles northeast of Loving, New Mexico.		11. Sec., T., R., M., or Blk. and Survey or Area Section 6, T24S-R31E
15. Distance from proposed* location to nearest property or lease line, ft. (Also to nearest drig. unit line, if any) 330'	16. No. of Acres in lease 640	12. County or Parish Eddy County
18. Distance from proposed location* to nearest well, drilling, completed, applied for, on this lease, ft. 1200'	17. Spacing Unit dedicated to this well 41.86 acres	13. State NM
19. Proposed Depth 8200'	20. BLM/BIA Bond No. on file NM-2811	
21. Elevations (Show whether DF, KDB, RT, GL, etc.) 3439'	22. Approximate date work will start* ASAP	23. Estimated duration 35 days

24. Attachments **CARLSBAD CONTROLLED WATER BASIN**

The following, completed in accordance with the requirements of Onshore Oil and Gas Order No. 1, shall be attached to this form:

- | | |
|---|---|
| 1. Well plat certified by a registered surveyor. | 4. Bond to cover the operations unless covered by an existing bond on file (see Item 20 above). |
| 2. A Drilling Plan. | 5. Operator certification. |
| 3. A Surface Use Plan (if the location is on National Forest System Lands, the SUPO shall be filed with the appropriate Forest Service Office). | 6. Such other site specific information and/or plans as may be required by the authorized office. |

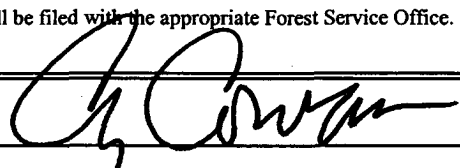
25. Signature 	Name (Printed/Typed) Cy Cowan	Date 8/19/03
---	---	------------------------

Title:
Regulatory Agent

Approved by (Signature) 15/ Carsten F. Goff	Name (Printed/Typed) Carsten F. Goff	Date 10/1/03
---	--	------------------------

Title FOR STATE DIRECTOR	Office NM STATE OFFICE
------------------------------------	----------------------------------

Application approval does not warrant or certify that the applicant holds legal or equitable title to those rights in the subject lease which would entitle the applicant to conduct operations thereon.

Conditions of approval, if any, are attached.

APPROVAL FOR 1 YEAR

Title 18 U.S.C. Section 1001 and Title 43 U.S.C. Section 1212, make it a crime for any person knowingly and willfully to make to any department or agency of the United States any false, fictitious or fraudulent statements or representations as to any matter within its jurisdiction.

*(Instructions on reverse)

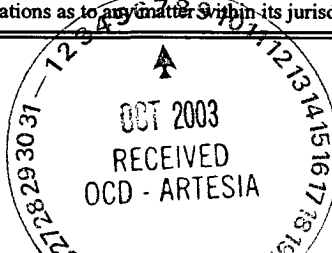

APPROVAL SUBJECT TO
GENERAL REQUIREMENTS
AND SPECIAL STIPULATIONS
ATTACHED

District I
1625 N. French Dr., Hobbs, NM 88240

District II
811 South First, Artesia, NM 88210

District III
1000 Rio Brazos Rd., Aztec, NM 87410

District IV
1220 S. St. Francis Dr., Santa Fe, NM 87505

State of New Mexico
Energy, Minerals & Natural Resources Department

OIL CONSERVATION DIVISION
1220 South St. Francis Dr.
Santa Fe, NM 87505

Form C-102
Revised August 15, 2000

Submit to Appropriate District Office
State Lease - 4 Copies
Fee Lease - 3 Copies

☐ AMENDED REPORT

WELL LOCATION AND ACREAGE DEDICATION PLAT

¹ API Number	² Pool Code	³ Pool Name Wildcat Delaware
⁴ Property Code	⁵ Property Name ADELINE ALN FEDERAL	⁶ Well Number 12
⁷ OGRID No. 025575	⁸ Operator Name Yates Petroleum Corporation	⁹ Elevation 3439'

¹⁰ Surface Location

UL or lot no. L	Section 6	Township 24S	Range 31E	Lot Idn	Feet from the 1800	North/South line South	Feet from the 330	East/West line West	County Eddy
---------------------------	---------------------	------------------------	---------------------	---------	------------------------------	----------------------------------	-----------------------------	-------------------------------	-----------------------

¹¹ Bottom Hole Location If Different From Surface

UL or lot no.	Section	Township	Range	Lot Idn	Feet from the	North/South line	Feet from the	East/West line	County
¹² Dedicated Acres 40	¹³ Joint or Infill	¹⁴ Consolidation Code	¹⁵ Order No.						

NO ALLOWABLE WILL BE ASSIGNED TO THIS COMPLETION UNTIL ALL INTERESTS HAVE BEEN CONSOLIDATED OR A
NON-STANDARD UNIT HAS BEEN APPROVED BY THE DIVISION

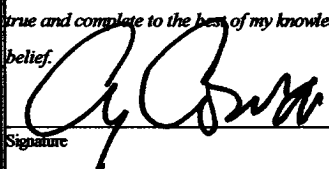
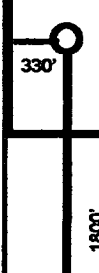
¹⁶				¹⁷ OPERATOR CERTIFICATION I hereby certify that the information contained herein is true and complete to the best of my knowledge and belief.  Signature Cy Cowan Printed Name Regulatory Agent Title 8/18/2003 Date
NM-82904				¹⁸ SURVEYOR CERTIFICATION I hereby certify that the well location shown on this plat was plotted from field notes of actual surveys made by me or under my supervision, and that the same is true and correct to the best of my belief. REFER TO ORIGINAL PLAT Date of Survey Signature and Seal of Professional Surveyor: Certificate Number
				

DISTRICT I
1826 E. French St., Hobbs, NM 88240

DISTRICT II
811 South First, Artesia, NM 88210

DISTRICT III
1000 Rio Grande Rd., Aztec, NM 87410

DISTRICT IV
2040 South Pacheco, Santa Fe, NM 87506

State of New Mexico
Energy, Minerals and Natural Resources Report

Form C-102
Revised March 17, 1999
Instruction on back
Submit to Appropriate District Office
State Lease - 4 Copies
Fee Lease - 3 Copies

OIL CONSERVATION DIVISION
P.O. Box 2088
Santa Fe, New Mexico 87504-2088

☐ AMENDED REPORT

WELL LOCATION AND ACREAGE DEDICATION PLAT

API Number	Pool Code	Pool Name Wildcat Delaware
Property Code	Property Name ADELINE "ALN" FEDERAL	Well Number 12
OGED No. 025575	Operator Name YATES PETROLEUM CORPORATION	Elevation 3439

Surface Location

UL or lot No. L	Section 6	Township 24S	Range 31E	Lot 1/4	Feet from the 1800	North/South Line SOUTH	Feet from the 330	East/West Line WEST	County EDDY
--------------------	--------------	-----------------	--------------	---------	-----------------------	---------------------------	----------------------	------------------------	----------------

Bottom Hole Location If Different From Surface

UL or lot No.	Section	Township	Range	Lot 1/4	Feet from the	North/South Line	Feet from the	East/West Line	County
---------------	---------	----------	-------	---------	---------------	------------------	---------------	----------------	--------

Dedicated Acres 40	Joint or Infill	Consolidation Code	Order No.
-----------------------	-----------------	--------------------	-----------

NO ALLOWABLE WILL BE ASSIGNED TO THIS COMPLETION UNTIL ALL INTERESTS HAVE BEEN CONSOLIDATED
OR A NON-STANDARD UNIT HAS BEEN APPROVED BY THE DIVISION

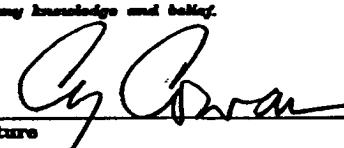
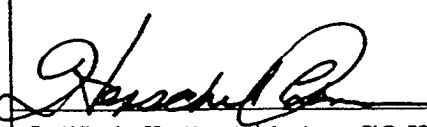
				<p>OPERATOR CERTIFICATION</p> <p>I hereby certify the the information contained herein is true and complete to the best of my knowledge and belief.</p> <p> Signature Cy Cowan</p> <p>Printed Name Regulatory Agent</p> <p>Title July 30, 2001</p> <p>Date</p> <p>SURVEYOR CERTIFICATION</p> <p>I hereby certify that the well location shown on this plat was plotted from field notes of actual surveys made by me or under my supervision, and that the same is true and correct to the best of my belief.</p> <p>7/11/2001</p> <p>Date Surveyed</p> <p> Signature & Seal of Professional Surveyor</p> <p>Certificate No. Herschel L. Jones RLS 3640 ADELINE 12 GENERAL SURVEYING COMPANY</p>	

YATES PETROLEUM CORPORATION
Adeline ALN Federal #12
 1800' FSL & 330' FWL
 Sec. 6-T24S-R31E
 Eddy County, New Mexico

1. The estimated tops of geologic markers are as follows:

Rustler	477'
Top of Salt	863'
Base of Salt	3950'
Bell Canyon	4150'
Cherry Canyon	5129'
Brushy Canyon	6810'
Bone Spring Lime	8010'
TD	8200'

2. The estimated depths at which anticipated water, oil or gas formations are expected to be encountered: -

Water: Approx 150'
 Oil or Gas: Canyon 5129' and Bone Spring 8010'

3. Pressure Control Equipment: BOPE will be installed on the 13 3/8" casing and rated for 3000 BOP systems will be consistent with API RP 53. Pressure tests will be conducted before drilling out from under all casing strings which are set and cemented in place. Blowout Preventor controls will be installed prior to drilling the surface plug and will remain in use until the well is completed or abandoned. Preventors will be inspected and operated at least daily to ensure good mechanical working order, and this inspection recorded on the daily drilling report. See Exhibit B.

Auxiliary Equipment:

- A. Auxiliary Equipment: Kelly cock, pit level indicators, flow sensor equipment and a sub with full opening valve to fit the drill pipe and collars will be available on the rig floor in the open position at all times for use when kelly is not in use.

4. THE PROPOSED CASING AND CEMENTING PROGRAM:

- A. Casing Program: (All New)

<u>Hole Size</u>	<u>Casing Size</u>	<u>Wt./Ft</u>	<u>Grade</u>	<u>Coupling</u>	<u>Interval</u>	<u>Length</u>
17 1/2"	13 3/8"	48#	H-40	ST&C	0-750'	750'
11"	8 5/8"	32#	J-55	ST&C	0-4100'	4100'
7 7/8"	5 1/2"	17#	J-55	LT&C	0-100'	100'
7 7/8"	5 1/2"	15.5#	L-80	LT&C	100'-6900'	6800'
7 7/8"	5 1/2"	17#	J-55	LT&C	6900'-8200'	1300'

Minimum Casing Design Factors: Collapse 1.125, Burst 1.0, Joint Strength 1.8

B. CEMENTING PROGRAM:

WITNESS Surface casing: 250 sx Lite (YLD 1.96 WT.12.5) Tail in w/ 200 sx Class "C" + 2% CaCl₂ (YLD 1.34 WT 14.8).

WITNESS Intermediate Casing: 750 sx Lite (YLD 2.5 WT 11.9); Tail in w/ 250 sx "C" w/ 2% CaCl₂ (YLD 1.34 WT. 14.8)

Production Casing: (TOC=3700') Lead w/400 sx Lite (YLD 2.0 WT 12.0) Tail in w/300 sx Super "H" (Yld 1.67 Wt 13.4).

5. Mud Program and Auxiliary Equipment:

<u>Interval</u>	<u>Type</u>	<u>Weight</u>	<u>Viscosity</u>	<u>Fluid Loss</u>
0-750'	FW/Native Mud	8.6-9.2	28-36	N/C
750'-4100'	Brine	10.0-10.2	28	N/C
4100'-6500'	Cut Brine	8.6-9.1	28	N/C
6500'-8200'	Cut Brine/Starch	8.6-9.1	28-32	<15cc

Sufficient mud material(s) to maintain mud properties, control lost circulation and contain a blow out will be available at the well site during drilling operations. Mud will be checked hourly by rig personnel.

6. EVALUATION PROGRAM:

Samples: 10 samples out from under surface casing.

Logging: CNL/LDT TD to casing; GR w/CNL to Surface; DLL x/RXO TD to casing.

Coring: None Anticipated.

DST's: As warranted.

7. Abnormal Conditions, Bottom hole pressure and potential hazards:

Anticipated BHP:

From: 0	TO: 750'	Anticipated Max.	BHP: 400	PSI
From: 750'	TO: 4100'	Anticipated Max.	BHP: 1790	PSI
From: 4100'	TO: 8200'	Anticipated Max.	BHP: 4100	PSI

No abnormal pressures or temperatures are anticipated.

Lost Circulation Zones Anticipated: None.

H₂S Zones Anticipated: None

Maximum Bottom Hole Temperature: 198 F

8. ANTICIPATED STARTING DATE:

Plans are to drill this well as soon as possible after receiving approval. It should take approximately 20 days to drill the well with completion taking another 15 days.

MULTI-POINT SURFACE USE AND OPERATIONS PLAN
Yates Petroleum Corporation
Adeline ALN Federal #12
1800' FSL & 330' FWL
Sec. 6-T24S-R31E
Eddy County, New Mexico

This plan is submitted with Form 3160-3, Application for Permit to Drill, covering the above described well. The purpose of this plan is to describe the location of the proposed well, the proposed construction activities and operations plan, the magnitude of the surface disturbance involved and the procedures to be followed in rehabilitating the surface after completion of the operations, so that a complete appraisal can be made of the environmental effect associated with the operations.

1. EXISTING ROADS:

Exhibit A is a portion of the BLM map showing the well and roads in the vicinity of the proposed location. The proposed wellsite is located approximately 23 miles northwest of Loving, New Mexico and the access route to the location is indicated in red and green on Exhibit A.

DIRECTIONS:

Go east of Carlsbad on Highway 285 to Highway 31. Go east on Highway 31 to Highway 128 (Jal Highway). Go approximately 12 miles to County Road 787 (Twin Wells Road). Turn South and go approximately 3.5 miles and turn west. Follow lease road to the Adeline ALN Federal #1 location. Continue west to the Adeline ALN Federal #6 location. The new road will start here going south.

2. PLANNED ACCESS ROAD.

- A. The proposed new access will be approximately 1200' in length to the northwest corner of the drilling pad. The road will lie in a north to south direction.
- B. The new road will be 14 feet in width (driving surface) and will be adequately drained to control runoff and soil erosion.
- C. The new road will be bladed with drainage on one side. Traffic turnouts may be built.
- D. The route of the road is visible.
- E. Existing roads will be maintained in the same or better condition.

3. LOCATION OF EXISTING WELL

- A. There is drilling activity within a one-mile radius of the wellsite.
- B. Exhibit D shows existing wells within a one-mile radius of the proposed wellsite.

4. LOCATION OF EXISTING AND/OR PROPOSED FACILITIES

- A. There are production facilities on this lease at the present time.
- B. In the event that the well is productive, the necessary production facilities will be installed on the drilling pad. If the well is productive oil, a gas or diesel self-contained unit will be used to provide the necessary power. No power will be required if the well is productive of gas.

5. LOCATION AND TYPE OF WATER SUPPLY:

- A. It is planned to drill the proposed well with a fresh water system. The fresh water will be obtained from commercial sources and will be hauled to the location by truck over the existing and proposed roads shown in Exhibit A.

6. SOURCE OF CONSTRUCTION MATERIALS:

Dirt contractor will locate closest pit and obtain any permits and materials needed for construction.

7. METHODS OF HANDLING WASTE DISPOSAL:

- A. Drill cuttings will be disposed of in the reserve pits.
- B. Drilling fluids will be allowed to evaporate in the reserve pits until the pits are dry.
- C. Water produced during operations will be collected in tanks until hauled to an approved disposal system, or separate disposal application will be submitted.
- D. Oil produced during operations will be stored in tanks until sold.
- E. Current laws and regulations pertaining to the disposal of human waste will be complied with.
- F. All trash, junk, and other waste materials will be contained in trash cages or bins to prevent scattering and will be removed and deposited in an approved sanitary land fill. Burial on site is not approved.

8. ANCILLARY FACILITIES: Amend the surface use plan to include the following, one 3" SDR Poly surface flowline and one (1) three phase 640 volt raptor proof powerline from this well to the Adeline ALN Federal Com. #1. See attached plat.

9. WELLSITE LAYOUT:

- A. Exhibit C shows the relative location and dimensions of the well pad, the reserve pits, the location of the drilling equipment, rig orientation and access road approach.
- B. The reserve pits will be plastic lined and will face to the north.
- C. A 400' x 400' area has been staked and flagged.

10. PLANS FOR RESTORATION

- A. After finishing drilling and/or completion operations, all equipment and other material not needed for further operations will be removed. The location will be cleaned of all trash and junk to leave the wellsite in as aesthetically pleasing a condition as possible.
- B. Unguarded pits, if any, containing fluids will be fenced until they have dried and been leveled.
- C. If the proposed well is non-productive, all rehabilitation and/or vegetation requirements of the Bureau of Land Management will be complied with and will be accomplished as expeditiously as possible. All pits will be filled level after they have evaporated and dried.

11. SURFACE OWNERSHIP: Federal surface, Administered by the Bureau of Land Management, Carlsbad, New Mexico.

12. OTHER INFORMATION:

- A. Topography: Refer to the existing archaeological report for a description of the topography, flora, fauna, soil characteristics, dwellings, historical and cultural sites.
- B. The primary surface use is for grazing.

13. OPERATOR'S REPRESENTATIVE

- A. Through A.P.D. Approval:

Cy Cowan, Regulatory Agent
Yates Petroleum Corporation
105 South Fourth Street
Artesia, New Mexico 88210
Phone (505) 748-1471

- B. Through Drilling Operations,
Completions and Production:

Pinson McWhorter, Operations Manager
Yates Petroleum Corporation
105 South Fourth Street
Artesia, New Mexico 88210
Phone (505) 748-1471

14. CERTIFICATION:

I hereby certify that I, or persons under my direct supervision, have inspected the proposed drill site and access route, that I am familiar with the conditions which presently exist; that the statements made in this plan are to the best of my knowledge, true and correct; and, that the work associated with the operations proposed herein will be performed by Yates Petroleum Corporation and its contractors and subcontractors in conformity with this plan and the terms and conditions under which it is approved. This statement is subject to the provisions of 18 U.S.C. 1001 for the filing of a false statement.

8/18/2003



Regulatory Agent



IMC Potash Carlsbad Inc.
P. O. Box 71
1361 Potash Mines Road
Carlsbad, New Mexico 88221-0071
505.887.2871
505.887.0589 Fax

August 1, 2001

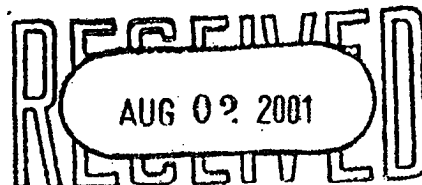
Mr. Cy Cowan
Yates Petroleum Corporation
105 South Fourth Street.
Artesia, New Mexico 88210-2188



RE: Proposed Wells Adeline ALN Federal #5, #6, #12
Section 6, T24S-R31E, N.M.P.M.
#5: 330' FNL & 990' FWL
#6: 2310' FNL & 330' FWL
#12: 1800' FSL & 330' FWL
Eddy County, New Mexico

Dear Mr. Cowan:

IMC Kalium Carlsbad Potash Company has received your notices that Yates Petroleum Corporation intends to drill the above referenced wells. IMC Kalium has no objections to Yates drilling wells Adeline ALN Federal #5, #6, #12 to depths no deeper than 100' below the base of the Delaware formation at the stated locations. Based on the best available information, the locations of the fore mentioned wells would not interfere with the development of our potash resources.

The above consideration is based on the best available information at this time; as more information becomes available our estimates of the extent of the potash resources in the area may change. Therefore, please consider the "objections offered" and "no objection offered" to the well locations to be valid for one year only. If you are still considering a well location that a potash operator has or has not objected to, more than one year prior, notify us again at that time so we can make the decision based on current information.

IMC Kalium submits this letter in lieu of the forms requested.

Sincerely,

John Purcell
Chief Mine Engineer

cc: Don Purvis Charlie High Leslie Theiss Lori Wroteneery
Dan Morehouse Tim O'Brien Craig Cranston

MARTIN YATES, III
1912 - 1985
FRANK W. YATES
1936 - 1986



S. P. YATES
CHAIRMAN OF THE BOARD
JOHN A. YATES
PRESIDENT
PEYTON YATES
EXECUTIVE VICE PRESIDENT

105 SOUTH FOURTH ST
ARTESIA, NEW MEXICO 8
TELEPHONE (505) 748-

July 30, 2001

Attention: Mr. John Purcell, Chief Mining Engineer
IMC Carlsbad Potash Company
P.O. Box 71
Carlsbad, New Mexico 88221-0071

RE: Adeline ALN Federal #12
Township 24 South, Range 31 East
Section 6: 1800' FSL & 330' FWL
Eddy County, New Mexico

U.S. Postal Service
CERTIFIED MAIL RECEIPT
(Domestic Mail Only; No Insurance Coverage Provided)

Postage	\$	Postmark here
Certified Fee		
Return Receipt Fee (Endorsement Required)		
Restricted Delivery Fee (Endorsement Required)		
Total Postage & Fees	\$	

Sent To: John Purcell, Chief Mining Engineer - IMC
Street, Apt. No.: P.O. Box 71
or PO Box No.
City, State, ZIP+4: Carlsbad, NM 88221-0071

PS Form 3800, January 2001 See Reverse for Ins

Dear Mr. Purcell:

Yates Petroleum Corporation wishes to place the captioned well on our list for future drilling operations. We are planning to drill this well to a total depth of 8,200' or 100' below the base of the Delaware Formation. We have been advised that your company is the owner of certain potash leases in this area. Therefore, we respectfully request that you waive any objections you may have to this proposed well location and so indicate by signing and returning one copy of this letter in the enclosed envelope.

Your favorable consideration of this request will be greatly appreciated. Thank you.

Very truly yours,

YATES PETROLEUM CORPORATION

Cy Cowan
Regulatory Agent

☐ NO OBJECTION OFFERED
IMC Potash Company

By: _____

Title: _____

☐ OBJECTION OFFERED
IMC Potash Company

By: _____

Title: _____

Yates Petroleum Corporation,
Adeline ALN Federal #12
1800' FSL and 330' FWL
Section 6-T24S-R31E
Eddy County, New Mexico
Exhibit "A"

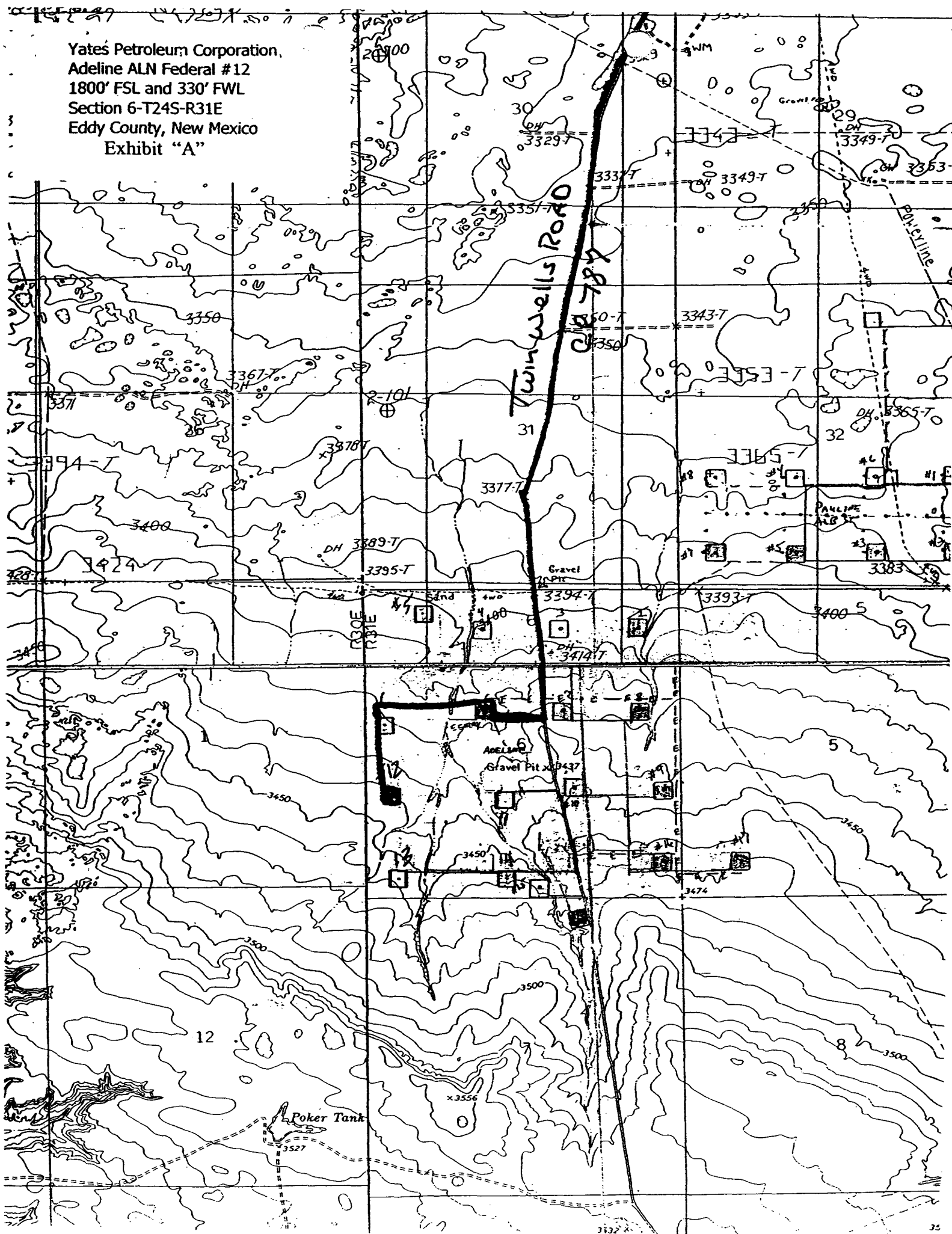

Yates Petroleum Corporation

Location Layout for Permian Basin

Up to 12,000'

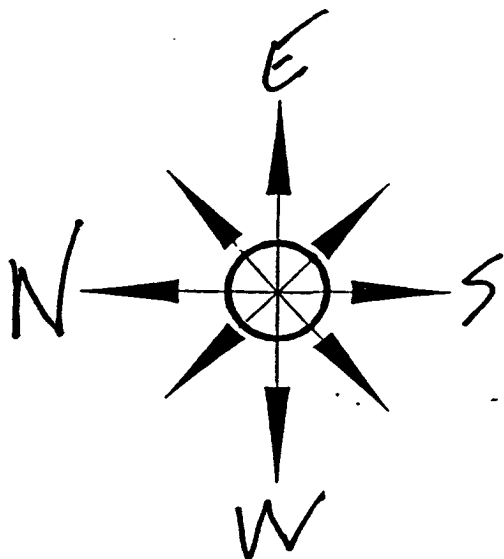

Yates Petroleum Corporation
Adeline ALN Federal #12
1800' FSL and 330' FWL
Section 6-T24S-R31E
Eddy County, New Mexico
Exhibit "B"

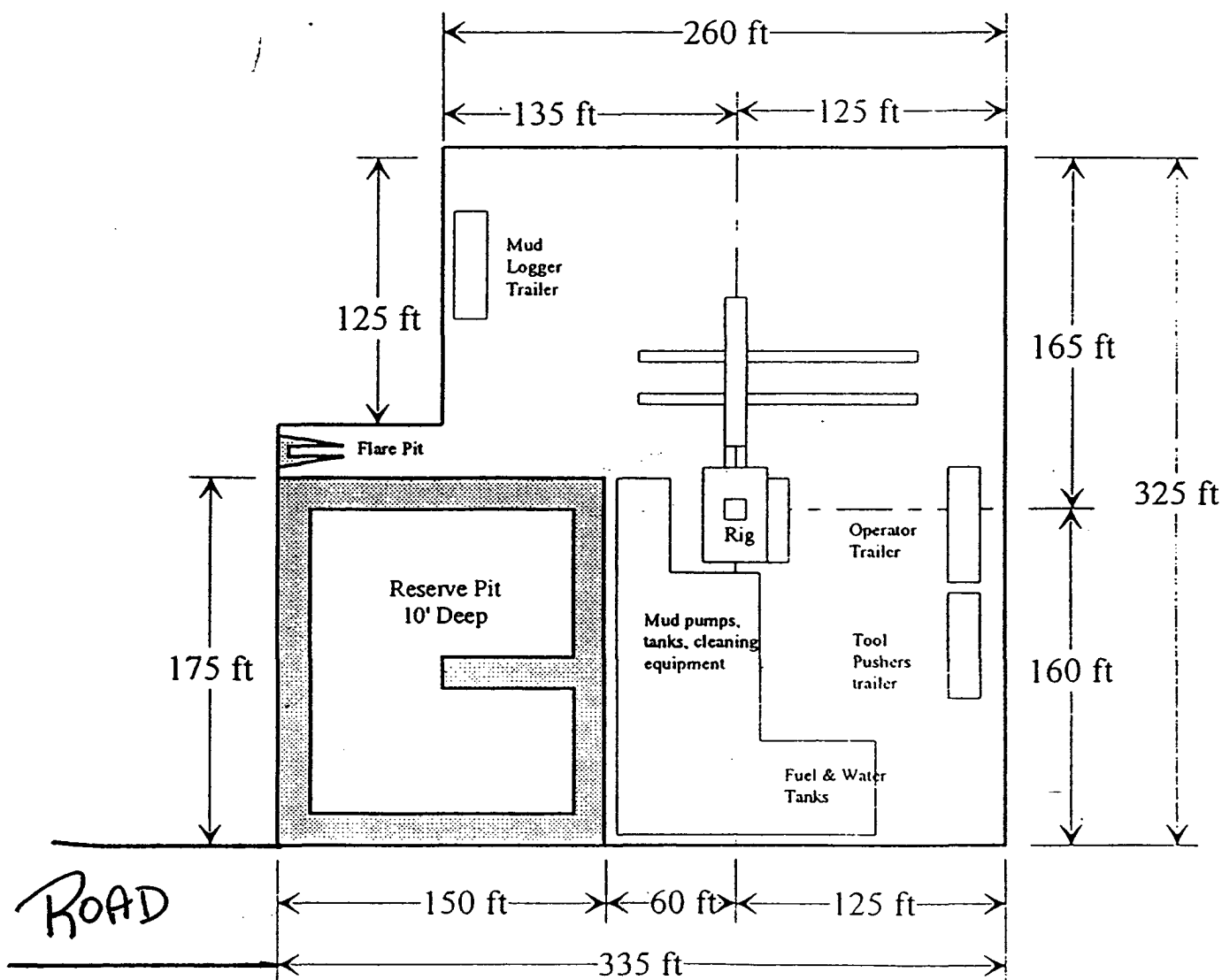

Distance from Well
Head to Reserve Pit
will vary between rigs

The above dimension
should be a maximum

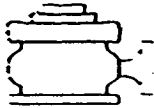

Yates Petroleum Corporation

BOP-3

Typical 3,000 psi Pressure System Schematic Annular with Double Ram Preventer Stack

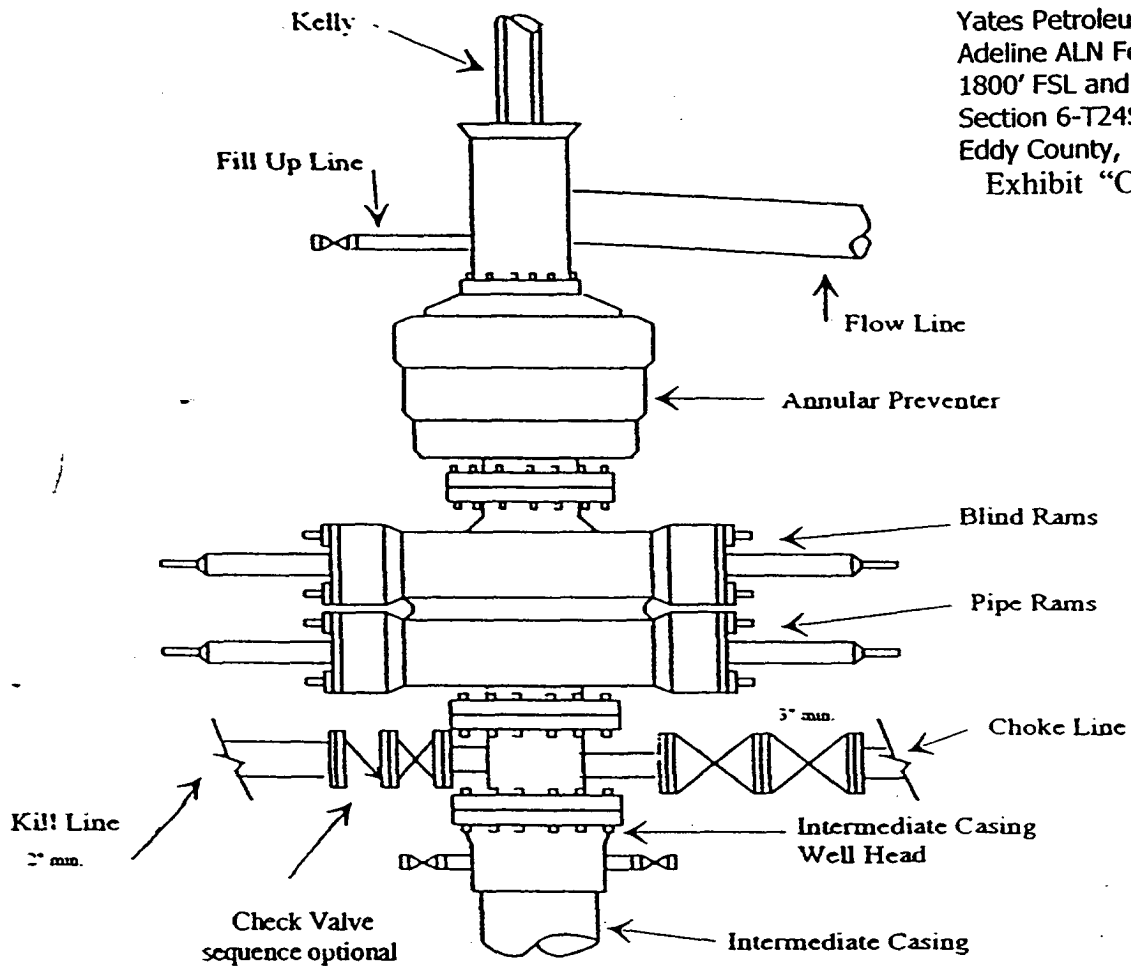

Yates Petroleum Corporation
Adeline ALN Federal #12
1800' FSL and 330' FWL
Section 6-T24S-R31E
Eddy County, New Mexico
Exhibit "C"

Typical 3,000 psi choke manifold assembly with at least these minimum features

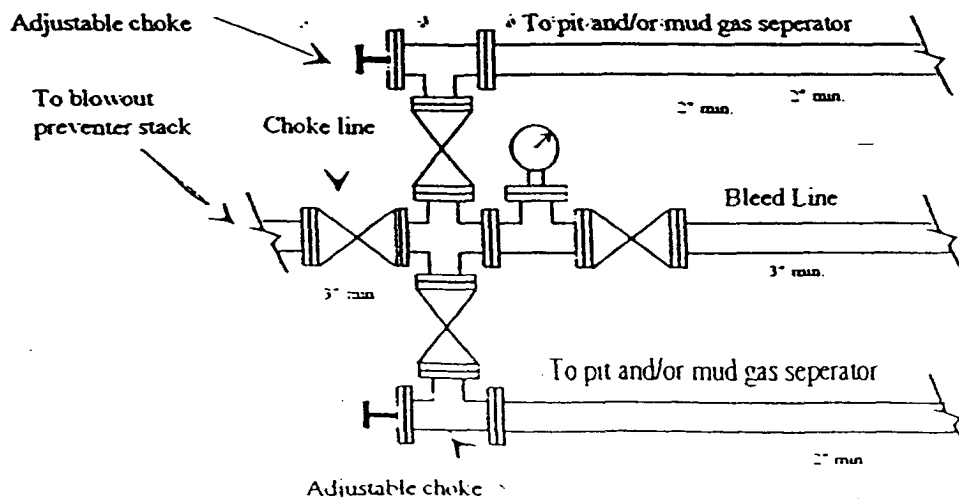

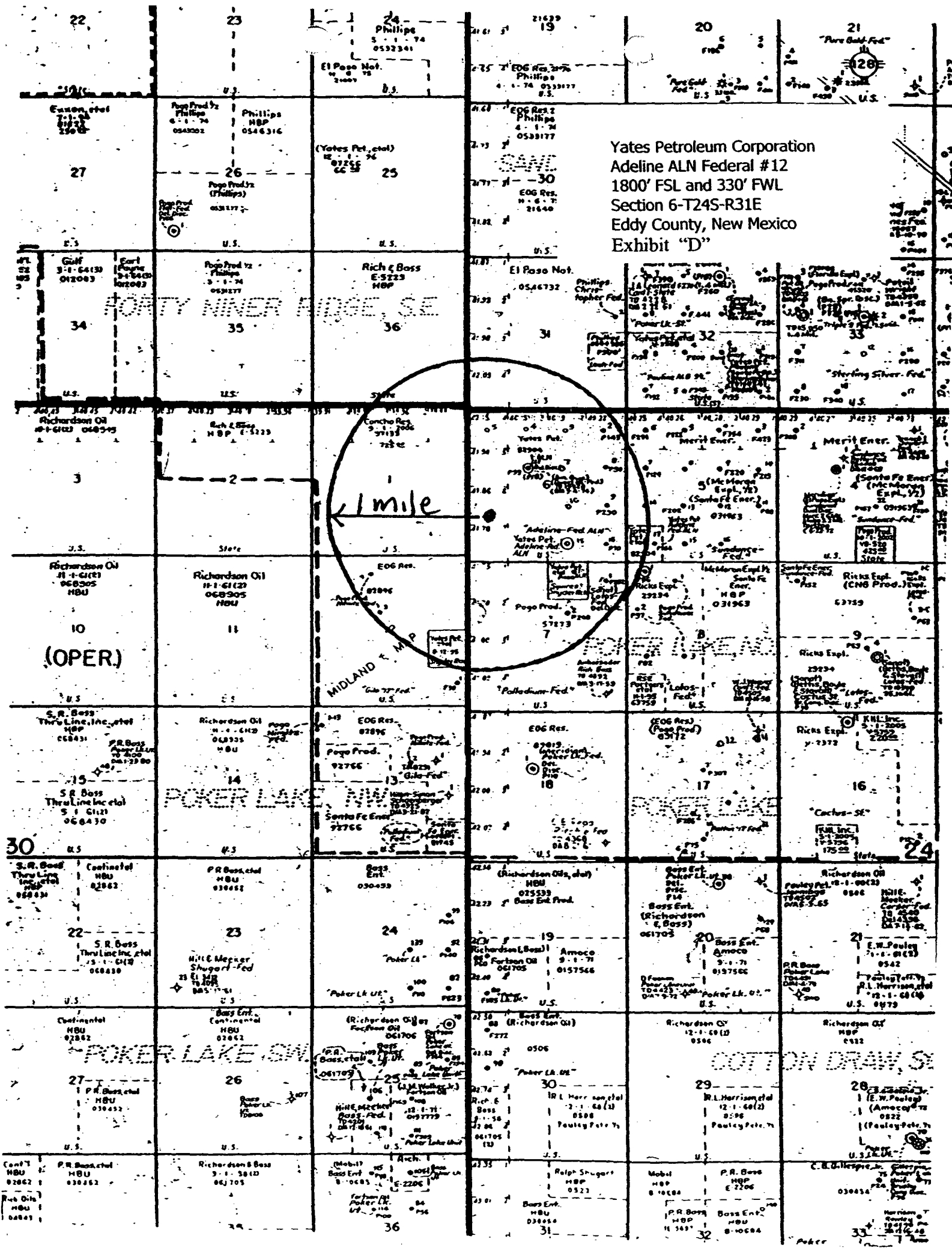

CONDITIONS OF APPROVAL - DRILLING

Operator's Name: YATES PETROLEUM CORPORATION
Well Name & No. 12 - ADELIN ALN FEDERAL
Location: 1800' FSL & 330' FWL - SEC 6 - T24S - R31E - EDDY COUNTY
Lease: NM-82904

I. DRILLING OPERATIONS REQUIREMENTS:

1. The Bureau of Land Management (BLM) is to be notified at the Roswell Field Office, 2909 West Second St., Roswell NM 88201, (505) 627-0272 for wells in Chaves and Roosevelt Counties; the Carlsbad Field Office, 620 East Greene St., Carlsbad, NM 88220, (505) 234-5909 or (505) 361-2822 (After hours) - for wells in Eddy County; and the Hobbs Field Station, 414 West Taylor, Hobbs NM 88240, (505) 393-3612 for wells in Lea County, in sufficient time for a representative to witness:

A. Spudding

B. Cementing casing: 13-3/8 inch 8-5/8 inch 5-1/2 inch

C. BOP tests

2. Unless the production casing has been run and cemented or the well has been properly plugged, the drilling rig shall not be removed from over the hole without prior approval.

3. Submit a Sundry Notice (Form 3160-5, one original and five copies) for each casing string, describing the casing and cementing operations. Include pertinent information such as; spud date, hole size, casing (size, weight, grade and thread type), cement (type, quantity and top), water zones and problems or hazards encountered. The Sundry shall be submitted within 15 days of completion of each casing string. The reports may be combined into the same Sundry if they fall within the same 15 day time frame.

4. The API No. assigned to the well by NMOCD shall be included on the subsequent report of setting the first casing string.

5. Gamma-Ray/Neutron logs shall be run from the base of the Salado Formation to the surface; cable speed not to exceed 30 feet per minute.

II. CASING:

1. The 13-3/8 inch surface casing shall be set between 890 and 1000 feet below usable water and cement circulated to the surface. If cement does not circulate to the surface the appropriate BLM office shall be notified and a temperature survey or cement bond log shall be run to verify the top of the cement. Remedial cementing shall be completed prior to drilling out that string.

2. The minimum required fill of cement behind the 8-5/8 inch salt protection casing is circulate cement to the surface.

3. The minimum required fill of cement behind the 5-1/2 inch production casing is circulate cement to the surface.

5. Whenever a casing string is cemented in the R-111-P Potash Area, cement shall be allowed to stand a minimum of twelve (12) hours under pressure and a total of twenty-four (24) hours before drilling the plug or initiating tests.

(ORIG. SGD.) LES BABYAK