

Submit to Appropriate District Office
State Lease - 6 copies
Fee Lease - 5 copies
District I
1625 N French, Hobbs, NM 88240
District II
1301 W. Grand Avenue, Artesia, NM 88210
District III
1000 Rio Brazos Rd., Aztec, NM 87410
District IV
1220 S. St Francis Dr., Santa Fe, NM 87505

State of New Mexico
Energy, Minerals and Natural Resources

Form C-105
Revised June 10, 2003

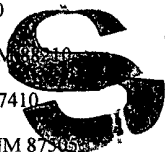

OIL CONSERVATION DIVISION
1220 South St. Francis Dr.
Santa Fe, NM 87505

WELL API NO. 30-015-35561
5. Indicate Type Of Lease STATE <input checked="" type="checkbox"/> FEE <input type="checkbox"/>
6. State Oil & Gas Lease No.

WELL COMPLETION OR RECOMPLETION REPORT AND LOG

1a. Type of Well: OIL WELL <input type="checkbox"/> GAS WELL <input checked="" type="checkbox"/> DRY <input type="checkbox"/> OTHER _____	7. Lease Name or Unit Agreement Name HOPE UNIT 1821-16 STATE
b. Type of Completion: NEW WELL <input checked="" type="checkbox"/> WORK OVER <input type="checkbox"/> DEEPEN <input type="checkbox"/> PLUG BACK <input type="checkbox"/> DIFF. RESVR. <input type="checkbox"/> OTHER _____	
2. Name of Operator PARALLEL PETROLEUM CORPORATION	8. Well No. 1Y
3. Address of Operator 1004 N BIG SPRING, SUITE 400, MIDLAND, TX 79701	9. Pool name or Wildcat WOLFCAMP

4. Well Location
Unit Letter **P** : **760** Feet From The **SOUTH** Line and **200** Feet From The **EAST** Line
Section **16** Township **18S** Range **21E** NMPM **EDDY** County

10. Date Spudded 04-28-2007	11. Date T.D. Reached 06-10-2007	12. Date Compl. (Ready to Prod.) 08-07-2007	13. Elevations (DF & RKB, RT, GR, etc.) GR: 4223	14. Elev. Casinghead
15. Total Depth MD: 7560; TVD 4061	16. Plug Back T.D. MD: 7455; TVD 4063	17. If Multiple Compl. How Many Zones?	18. Intervals Drilled By X	Rotary Tools X
19. Producing Interval(s), of this completion - Top, Bottom, Name MD: 4440-7412; TVD: 4162-4066 WOLFCAMP			20. Was Directional Survey Made YES	
21. Type Electric and Other Logs Run THREE DETECTOR LITHO-DENSITY/CN/HNGS--MAILED 06-28-2007; SURVEYS ATTACHED			22. Was Well Cored NO	

23. CASING RECORD (Report all strings set in well)

CASING SIZE	WEIGHT LB./FT.	DEPTH SET	HOLE SIZE	CEMENTING RECORD	AMOUNT PULLED
CONDUCTOR: 16		50			
8-5/8	24	1518	11	560 SX + 50 SX	
5.5	17	7490	7.875	1300 SX	

24. LINER RECORD				25. TUBING RECORD			
SIZE	TOP	BOTTOM	SACKS CEMENT	SCREEN	SIZE	DEPTH SET	PACKER SET
					2-7/8	SN @ 4100	

26. Perforation record (interval, size, and number) MD: 4440-4873; 5170-5673; 5870-6433; 6570-7412 TVD: 4162-4150; 5150-4124; 4117-4098; 4093-4066 144 HOLES, 0.42" DIAMETER	27. ACID, SHOT, FRACTURE, CEMENT, SQUEEZE, ETC. DEPTH INTERVAL MD: 4440-7412 TVD: 4162-4066 AMOUNT AND KIND MATERIAL USED FRAC W/15% NEEF ACID, FRESH WATER, CO2, 30/70 & 20/40 BRADY SAND + ADDITIVES
--	--

28. PRODUCTION

Date First Production 08-16-2007	Production Method (Flowing, gas lift, pumping - Size and type pump) FLOWING	Well Status (Prod. or Shut-in) PROD					
Date of Test 08-16-2007	Hours Tested 24	Choke Size 3/4	Prod'n For Test Period	Oil - Bbl.	Gas - MCF 404	Water - Bbl. 77	Gas - Oil Ratio
Flow Tubing Press. 350	Casing Pressure 375	Calculated 24-Hour Rate	Oil - Bbl.	Gas - MCF 404	Water - Bbl. 77	Oil Gravity - API -(Corr.)	

29. Disposition of Gas (Sold, used for fuel, vented, etc.) SOLD	Test Witnessed By
---	-------------------

30. List Attachments

31. I hereby certify that the information shown on both sides of this form is true and complete to the best of my knowledge and belief

Signature Printed Name **KAYE MC CORMICK** Title **SR REG & PROD TECH** Date **08-24-2007**

[illegible]

INDICATE FORMATION TOPS IN CONFORMANCE WITH GEOGRAPHICAL SECTION OF STATE

Southeastern New Mexico		Northeastern New Mexico	
T. Anhy	T. Canyon	T. Ojo Alamo	T. Penn. "B"
T. Salt	T. Strawn	T. Kirtland-Fruitland	T. Penn. "C"
B. Salt	T. Atoka	T. Pictured Cliffs	T. Penn. "D"
T. Yates	T. Miss	T. Cliff House	T. Leadville
T. 7 Rivers	T. Devonian	T. Menefee	T. Madison
T. Queen	T. Silurian	T. Point Lookout	T. Elbert
T. Grayburg	T. Montoya	T. Mancos	T. McCracken
T. San Andres	T. Simpson	T. Gallup	T. Ignacio Otzte
T. Glorieta 1788	T. McKee	Base Greenhorn	T. Granite
T. Paddock	T. Ellenburger	T. Dakota	T.
T. Blinebry	T. Gr. Wash	T. Morrison	T.
T. Tubb 2692	T. Delaware Sand	T. Todilto	T.
T. Drinkard	T. Bone Springs	T. Entrada	T.
T. Abo 3316	T.	T. Wingate	T.
T. Wolfcamp 4226		T. Chinle	T.
T. Penn	T.	T. Permain	T.
T. Cisco (Bough C)	T.	T. Penn "A"	T.

OIL OR GAS SANDS OR ZONES

No. 1, from	to
No. 2, from	to

No. 3, from _____ to _____
No. 4, from _____ to _____

IMPORTANT WATER SANDS

Include data on rate of water inflow and elevation to which water rose in hole.

No. 1, from _____ to _____ feet _____

No. 2, from _____ to _____ feet _____

No. 3, from _____ to _____ feet _____

LITHOLOGY RECORD (Attach additional sheet if necessary)

From	To	Thickness in Feet	Lithology

From	To	Thickness in Feet	Lithology

District I
1625 N. French Dr., Hobbs, NM 88240
District II
1301 W. Grand Avenue, Artesia, NM 88210
District III
1000 Rio Brazos Rd., Aztec, NM 87410
District IV
1220 S. St. Francis Dr., Santa Fe, NM 87505

State of New Mexico
Energy, Minerals & Natural Resources Department
OIL CONSERVATION DIVISION
1220 South St. Francis Dr.
Santa Fe, NM 87505

Form C-102
Revised October 12, 2005
Submit to Appropriate District Office
State Lease - 4 Copies
Fee Lease - 3 Copies

☐ AMENDED REPORT

WELL LOCATION AND ACREAGE DEDICATION PLAT

API Number 30-015-35561		Pool Code 97489	Pool Name WILDCAT, WOLFCAMP
Property Code 36279	Property Name HOPE UNIT 1821-16-STATE		Well Number 1Y
OGRID No. 230387	Operator Name PARALLEL PETROLEUM CORPORATION		Elevation GR: 4223

¹⁰ Surface Location

UL or lot no. P	Section 16	Township 18S	Range 21E	Lot Idn	Feet from the 760	North/South line SOUTH	Feet from the 200	East/West line EAST	County EDDY
---------------------------	----------------------	------------------------	---------------------	---------	-----------------------------	----------------------------------	-----------------------------	-------------------------------	-----------------------

¹¹ Bottom Hole Location If Different From Surface

UL or lot no. M	Section 16	Township 18S	Range 21E	Lot Idn	Feet from the 815	North/South line SOUTH	Feet from the 1494	East/West line WEST	County EDDY
Dedicated Acres 320		Joint or Infill		Consolidation Code		Order No.			

No allowable will be assigned to this completion until all interests have been consolidated or a non-standard unit has been approved by the division.

<p>16</p> <p>PARTIAL PLAT - HOPE UNIT</p> <p>SEC 10</p>						<p>¹⁷ OPERATOR CERTIFICATION</p> <p><i>I hereby certify that the information contained herein is true and complete to the best of my knowledge and belief, and that this organization either owns a working interest or unleased mineral interest in the land including the proposed bottom hole location or has a right to drill this well at this location pursuant to a contract with an owner of such a mineral or working interest, or to a voluntary pooling agreement or a compulsory pooling order heretofore entered by the Division.</i></p> <p>Signature: <i>Kaye Mc Cormick</i> Date: 24-2007</p> <p>KAYE MC CORMICK</p> <p>Printed Name</p>	
<p>SEC 16</p> <p>SEC 15</p> <p>1494</p> <p>815</p> <p>#1</p> <p>#2</p> <p>#3</p> <p>#4</p>						<p>¹⁸ SURVEYOR CERTIFICATION</p> <p><i>I hereby certify that the well location shown on this plat was plotted from field notes of actual surveys made by me or under my supervision, and that the same is true and correct to the best of my belief.</i></p> <p>Date of Survey</p> <p>Signature and Seal of Professional Surveyor:</p> <p>Certificate Number</p>	
<p>1 SL: 760 FSL & 200 FEL, SEC 16 2 PP: 835 FSL & 646** FEL, SEC 16 3BHL: 815 FSL & 1494 FWL, SEC 16 **THIS IS A UNIT, 646 IS FROM SEC LINE, TO UNIT LINE IS 5926 4 PERPEDICULAR CLOSEST LEASE LINE IS 1056 FSEL HOPE UNIT PLAT ATTACHED</p>							

HOPE UNIT

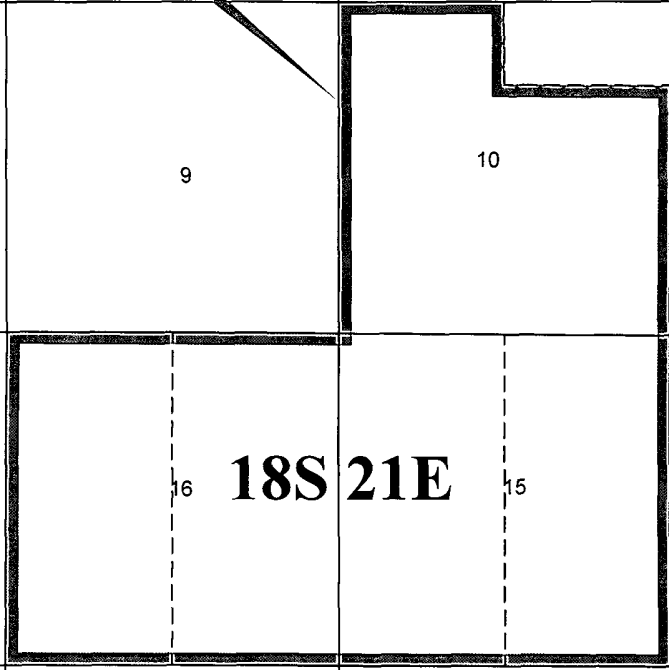
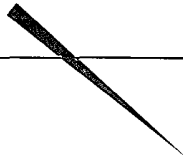

18S 21E

6

5

4

3

2

1

7

8

9

10

11

12

18

17

16

15

14

13

19

20

21

22

23

24