

Submit 3 Copies To Appropriate District
Office
District I
1625 N. French Dr., Hobbs, NM 88240
District II
1301 W. Grand Ave., Artesia, NM 88210
District III
1000 Rio Brazos Rd., Aztec, NM 87410
District IV
1220 S. St. Francis Dr., Santa Fe, NM
87505

State of New Mexico
Energy, Minerals and Natural Resources

Form C-103
May 27, 2004

OIL CONSERVATION DIVISION
1220 South St. Francis Dr.
Santa Fe, NM 87505

WELL API NO. 30-015-35184
5. Indicate Type of Lease STATE <input type="checkbox"/> FEE <input checked="" type="checkbox"/>
6. State Oil & Gas Lease No.
7. Lease Name or Unit Agreement Name Perfecto 2 State
8. Well Number 2
9. OGRID Number 6137
10. Pool name or Wildcat Happy Valley; Morrow (Gas)

SUNDRY NOTICES AND REPORTS ON WELLS (DO NOT USE THIS FORM FOR PROPOSALS TO DRILL OR TO DEEPEN OR PLUG BACK TO A DIFFERENT RESERVOIR. USE "APPLICATION FOR PERMIT" (FORM C-101) FOR SUCH PROPOSALS.) 1. Type of Well: Oil Well <input type="checkbox"/> Gas Well <input checked="" type="checkbox"/> Other <input type="checkbox"/>	
2. Name of Operator Devon Energy Production Company, LP	AUG 15 2007 OCD-ARTESIA
3. Address of Operator 20 North Broadway Oklahoma City, Oklahoma 73102-8260	(405) 552-7802
4. Well Location Unit Letter <u>H</u> : <u>2100</u> feet from the <u>North</u> line and <u>150</u> feet from the <u>East</u> line Section <u>3</u> Township <u>22S</u> Range <u>26E</u> NMPM Eddy County, NM	
11. Elevation (Show whether DR, RKB, RT, GR, etc.) 3224'	
Pit or Below-grade Tank Application <input type="checkbox"/> or Closure <input type="checkbox"/>	
Pit type _____ Depth to Groundwater _____ Distance from nearest fresh water well _____ Distance from nearest surface water _____	
Pit Liner Thickness: _____ mil Below-Grade Tank: Volume _____ bbls; Construction Material _____	

12. Check Appropriate Box to Indicate Nature of Notice, Report or Other Data

NOTICE OF INTENTION TO:

PERFORM REMEDIAL WORK ☐ PLUG AND ABANDON ☐
TEMPORARILY ABANDON ☐ CHANGE PLANS ☒
PULL OR ALTER CASING ☐ MULTIPLE COMPL ☐

SUBSEQUENT REPORT OF:

REMEDIAL WORK ☐ ALTERING CASING ☐
COMMENCE DRILLING OPNS. ☐ P AND A ☐
CASING/CEMENT JOB ☐

OTHER: ☐

OTHER: ☐

13. Describe proposed or completed operations. (Clearly state all pertinent details, and give pertinent dates, including estimated date of starting any proposed work). SEE RULE 1103. For Multiple Completions: Attach wellbore diagram of proposed completion or recompletion.

Devon Energy Production Co., LP respectfully advises the W/2 unit is correctly reflected on the C-102 per the Com Agreement.

(See Attached)

I hereby certify that the information above is true and complete to the best of my knowledge and belief. I further certify that any pit or below-grade tank has been/will be constructed or closed according to NMOCD guidelines ☐, a general permit ☐ or an (attached) alternative OCD-approved plan ☐.

SIGNATURE [Signature] TITLE Sr. Staff Engineering Technician DATE 08/14/07

Type or print name Stephanie A. Ysasaga E-mail address: Stephanie.Ysasaga@dvn.com Telephone No. (405) 552-7802

For State Use Only
BRYAN G. ARANT
DISTRICT II GEOLOGIST

APPROVED BY: _____ TITLE _____ DATE AUG 20 2007

Conditions of Approval (if any):

DISTRICT I
1625 N. French Dr., Hobbs, NM 88240

DISTRICT II
1301 W. Grand Avenue, Artesia, NM 88210

DISTRICT III
1000 Rio Brazos Rd., Aztec, NM 87410

DISTRICT IV
1220 S. St. Francis Dr., Santa Fe, NM 87505

State of New Mexico
Energy, Minerals and Natural Resources Department

OIL CONSERVATION DIVISION
1220 South St. Francis Dr.
Santa Fe, New Mexico 87505

Revised October 12, 2005

Submit to Appropriate District Office
State Land Office
Fee Letter

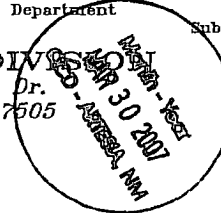

AMENDED REPORT

WELL LOCATION AND ACREAGE DEDICATION PLAT

API Number 30-015-35184	Pool Code	Pool Name HAPPY VALLEY; MORROW (GAS)
Property Code	Property Name PERFECTO "2" STATE	Well Number 2
OGRID No. 6137	Operator Name DEVON ENERGY PRODUCTION COMPANY LP	Elevation 3224'

Surface Location

UL or lot No.	Section	Township	Range	Lot Idn	Feet from the	North/South line	Feet from the	East/West line	County
H	3	22 S	26 E		2100	NORTH	150	EAST	EDDY

Bottom Hole Location If Different From Surface

UL or lot No.	Section	Township	Range	Lot Idn	Feet from the	North/South line	Feet from the	East/West line	County
L	2	22 S	26 E		1650	SOUTH	660	WEST	EDDY

Dedicated Acres	Joint or Infill	Consolidation Code	Order No.
320			

NO ALLOWABLE WILL BE ASSIGNED TO THIS COMPLETION UNTIL ALL INTERESTS HAVE BEEN CONSOLIDATED
OR A NON-STANDARD UNIT HAS BEEN APPROVED BY THE DIVISION

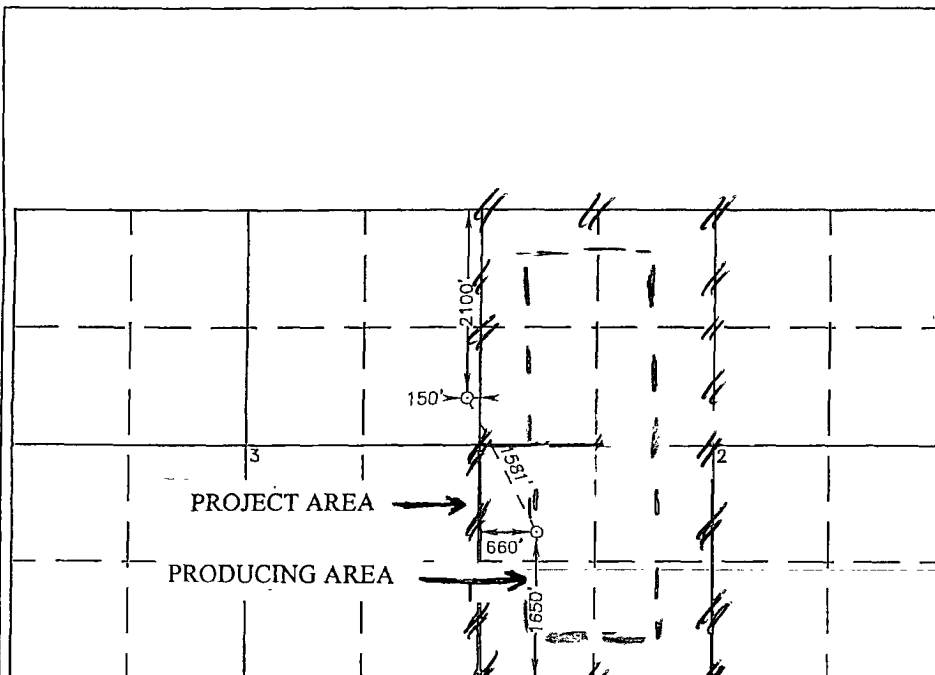

SURFACE LOCATION
LAT - N32°25'22.6"
LONG - W103°16'21.2"
(NAD-83)

BOTTOM HOLE LOCATION
LAT - N32°25'08.9"
LONG - W103°16'12.0"
(NAD-83)

OPERATOR CERTIFICATION

I hereby certify that the information contained herein is true and complete to the best of my knowledge and belief, and that this organization either owns a working interest or unleased mineral interest in the land including the proposed bottom hole location pursuant to a contract with an owner of such a mineral or working interest, or to a voluntary pooling agreement or a compulsory pooling order heretofore entered by the division.

Signature: [Signature] Date: 02/28/07
Printed Name: STEPHANIE A. YSASAGA

SURVEYOR CERTIFICATION

I hereby certify that the well location shown on this plat was plotted from field notes of actual surveys made by me or under my supervision, and that the same is true and correct to the best of my belief.

NOVEMBER 16, 2006

Date Surveyed: [Signature] L. Jones
Signature: [Signature] L. Jones
Professional Surveyor

Certificate No. Gary L. Jones 7977

BASIN SURVEYS

DISTRICT I
1625 N. French Dr., Hobbs, NM 88240

DISTRICT II
1301 W. Grand Avenue, Artesia, NM 88210

DISTRICT III
1000 Rio Brazos Rd., Aztec, NM 87410

DISTRICT IV
1220 S. St. Francis Dr., Santa Fe, NM 87505

State of New Mexico
Energy, Minerals and Natural Resources Department

OIL CONSERVATION DIVISION
1220 South St. Francis Dr.
Santa Fe, New Mexico 87505

Revised October 12, 2005

Submit to Appropriate District Office
State License - 4
Fee License - 4

AMENDED REPORT

WELL LOCATION AND ACREAGE DEDICATION PLAT

API Number 30-015-35184	Pool Code	Pool Name HAPPY VALLEY, MORROW (GAS)
Property Code	Property Name PERFECTO "2" STATE	Well Number 2
OGRID No. 6137	Operator Name DEVON ENERGY PRODUCTION COMPANY LP	Elevation 3224'

Surface Location

UL or lot No.	Section	Township	Range	Lot Idn	Feet from the	North/South line	Feet from the	East/West line	County
H	3	22 S	26 E		2100	NORTH	150	EAST	EDDY

Bottom Hole Location If Different From Surface

UL or lot No.	Section	Township	Range	Lot Idn	Feet from the	North/South line	Feet from the	East/West line	County
L	2	22 S	26 E		1650	SOUTH	660	WEST	EDDY

Dedicated Acres	Joint or Infill	Consolidation Code	Order No.
320			

NO ALLOWABLE WILL BE ASSIGNED TO THIS COMPLETION UNTIL ALL INTERESTS HAVE BEEN CONSOLIDATED
OR A NON-STANDARD UNIT HAS BEEN APPROVED BY THE DIVISION

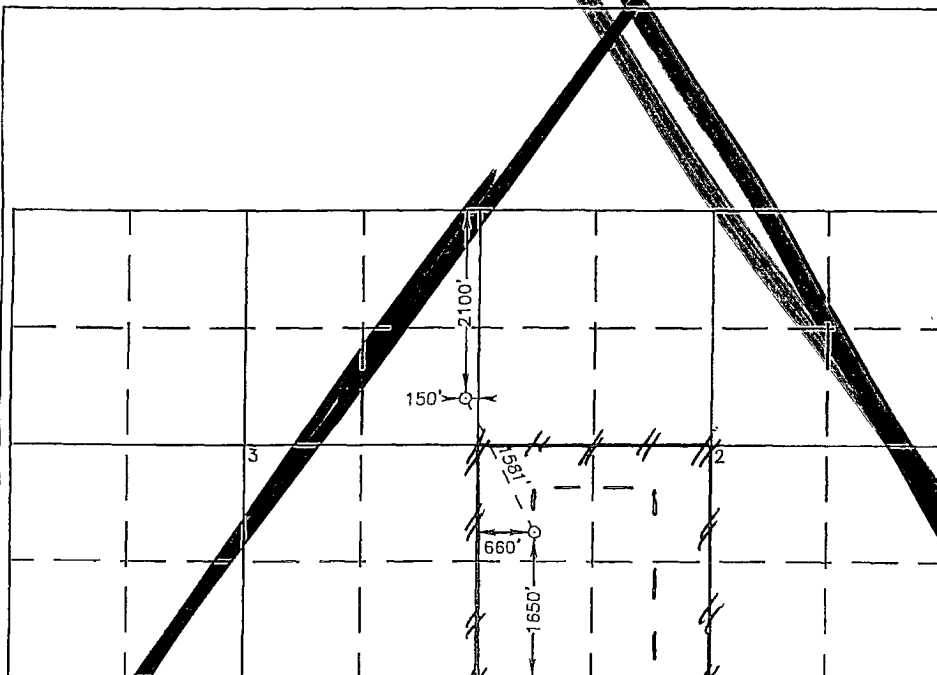

SURFACE LOCATION
LAT - N32°25'22.6"
LONG - W103°16'21.2"
(NAD-83)

BOTTOM HOLE LOCATION
LAT - N32°25'08.9"
LONG - W103°16'12.3"
(NAD-83)

PROJECT AREA

PRODUCING AREA

SCALE - 1" = 2000'

OPERATOR CERTIFICATION

I hereby certify that the information contained herein is true and complete to the best of my knowledge and belief, and that this organization either owns a working interest or unleased mineral interest in the land including the proposed bottom hole location pursuant to a contract with an owner of such a mineral or working interest, or to a voluntary pooling agreement or a compulsory pooling order heretofore entered by the division.

Signature: [Signature] Date: 02/28/07
Printed Name: STEPHANIE A. YSASAGA

SURVEYOR CERTIFICATION

I hereby certify that the well location shown on this plat was plotted from field notes of actual surveys made by me or under my supervision, and that the same is true and correct to the best of my belief.

NOVEMBER 16, 2006

Date Surveyed: [Signature] L. Jones
Signature: [Signature]
Professional Surveyor

Certificate No. Gary L. Jones 7977

BASIN SURVEYS