

Submit 3 Copies To Appropriate District Office
District I
1625 N French Dr , Hobbs, NM 88240
District II
1301 W. Grand Ave , Artesia, NM 88210
District III
1000 Rio Brazos Rd., Aztec, NM 87410
District IV
1220 S. St. Francis Dr., Santa Fe, NM 87505

State of New Mexico
Energy, Minerals and Natural Resources

Form C-103
March 4, 2004

OIL CONSERVATION DIVISION
1220 South St. Francis Dr.
Santa Fe, NM 87505



WELL API NO. 30-015-32518
5. Indicate Type of Lease STATE <input checked="" type="checkbox"/> FEE <input type="checkbox"/>
6. State Oil & Gas Lease No. VO-5824
7. Lease Name or Unit Agreement Name Samuel Smith Unit (36104)
8. Well Number 2
9. OGRID Number 025575
10. Pool name or Wildcat Crooked Creek, Morrow (Gas)

SUNDRY NOTICES AND REPORTS ON WELLS
(DO NOT USE THIS FORM FOR PROPOSALS TO DRILL OR TO DEEPEN OR PLUG BACK TO A DIFFERENT RESERVOIR. USE "APPLICATION FOR PERMIT" (FORM C-101) FOR SUCH PROPOSALS.)

1. Type of Well:
Oil Well ☐ Gas Well ☒ Other ☐

OCT 05 2007

2. Name of Operator
Yates Petroleum Corporation

OCD-ARTESIA

3. Address of Operator
105 South Fourth Street, Artesia, New Mexico, 88210

4. Well Location
Unit Letter: : I 1420 feet from the South line and 1190 feet from the East line

Section 32 Township 23S Range 24E County Eddy

11. Elevation (Show whether DR, RKB, RT, GR, etc.)
4242' GR

Pit or Below-grade Tank Application (For pit or below-grade tank closures, a form C-144 must be attached)

Pit Location: L Sect 32 Twp 23S Rng 24E Pit type Drilling Depth to Groundwater 170 Distance from nearest fresh water

well 3300' Distance from nearest surface water 2000' Below-grade Tank Location UL Sect Twp Rng ; feet from the line and feet from the East line

12. Check Appropriate Box to Indicate Nature of Notice, Report or Other Data

NOTICE OF INTENTION TO:
PERFORM REMEDIAL WORK ☐ PLUG AND ABANDON ☐

TEMPORARILY ABANDON ☐ CHANGE PLANS ☐

PULL OR ALTER CASING ☐ MULTIPLE COMPLETION ☐

OTHER: ☐

SUBSEQUENT REPORT OF:
REMEDIAL WORK ☐ ALTERING CASING ☐

COMMENCE DRILLING OPNS. ☐ PLUG AND ABANDONMENT ☐

CASING TEST AND CEMENT JOB ☐

OTHER: ☒ Extend APD

13. Describe proposed or completed operations. (Clearly state all pertinent details, and give pertinent dates, including estimated date of starting any proposed work). SEE RULE 1103. For Multiple Completions: Attach wellbore diagram of proposed completion or recompletion.

Yates Petroleum Corporation wishes to extend the captioned well's APD expiration date for one (1) year to October 18, 2008.

Sources at Yates Petroleum Corporation have relayed information to me that they believe there will not be enough H2S found from the surface to the Morrow formation to meet the OCD's minimum requirements for the submission of a contingency plan per rule 118.

C-144 attached C-102 attached
Thank you

I hereby certify that the information above is true and complete to the best of my knowledge and belief. I further certify that any pit or below-grade tank has been/will be constructed or closed according to NMOCD guidelines ☐, a general permit ☒ or an (attached) alternative OCD-approved plan ☐.

SIGNATURE TITLE Regulatory Agent/Land Department DATE October 4, 2007

Type or print name: Cy Cowan E-mail address: cy@ypcnm.com Telephone No. (505) 748-4372

(This space for State use)

APPROVED BY BRYAN G. ARRANT TITLE DISTRICT II GEOLOGIST DATE OCT 10 2007
Conditions of approval, if any:

District I
1625 N. French Dr., Hobbs, NM 88240

District II
1301 W. Grand Avenue, Artesia, NM 88210

District III
1000 Rio Brazos Rd., Aztec, NM 87410

District IV
1220 S. St. Francis Dr., Santa Fe, NM 87505

State of New Mexico
Energy, Minerals & Natural Resources Department
OIL CONSERVATION DIVISION
1220 South St. Francis Dr.
Santa Fe, NM 87505

Form C-102
Revised October 12, 2005
Submit to Appropriate District Office
State Lease - 4 Copies
Fee Lease - 3 Copies

☐ AMENDED REPORT

WELL LOCATION AND ACREAGE DEDICATION PLAT

¹ API Number		² Pool Code 75400		³ Pool Name Crooked Creek; Morrow (Gas)	
⁴ Property Code 36104		⁵ Property Name Samuel Smith Unit			⁶ Well Number 2
⁷ OGRID No. 025575		⁸ Operator Name Yates Petroleum Corporation			⁹ Elevation 4242

¹⁰ Surface Location

UL or lot no.	Section	Township	Range	Lot Idn	Feet from the	North/South line	Feet from the	East/West line	County
I	32	23 S	24 E		1420	South	1190	East	Eddy

¹¹ Bottom Hole Location If Different From Surface

UL or lot no.	Section	Township	Range	Lot Idn	Feet from the	North/South line	Feet from the	East/West line	County

¹² Dedicated Acres 320.2- S/2	¹³ Joint or Infill	¹⁴ Consolidation Code	¹⁵ Order No.
---	-------------------------------	----------------------------------	-------------------------

No allowable will be assigned to this completion until all interests have been consolidated or a non-standard unit has been approved by the division.

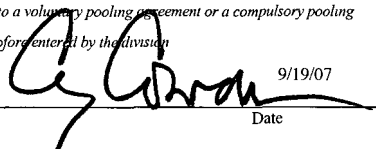
16				¹⁷ OPERATOR CERTIFICATION I hereby certify that the information contained herein is true and complete to the best of my knowledge and belief, and that this organization either owns a working interest or unleased mineral interest in the land including the proposed bottom hole location or has a right to drill this well at this location pursuant to a contract with an owner of such a mineral or working interest, or to a voluntary pooling agreement or a compulsory pooling order heretofore entered by the division.  Signature _____ Date 9/19/07 Cy Cowan, Regulatory Agent Printed Name _____
				¹⁸ SURVEYOR CERTIFICATION I hereby certify that the well location shown on this plat was plotted from field notes of actual surveys made by me or under my supervision, and that the same is true and correct to the best of my belief. Date of Survey _____ Signature and Seal of Professional Surveyor _____ REFER TO ORIGINAL PLAT Certificate Number _____
			VO-5824 1190' 1420'	

District I

1625 N. French Dr., Hobbs, NM 88240

District II

1301 W. Grand Ave., Artesia, NM 88210

District III

1000 Rio Brazos Rd., Aztec, NM 87410

District IV

1220 S. St Francis Dr., Santa Fe, NM 87505

State of New Mexico
Energy, Minerals and Natural Resources

Form C-102

Oil Conservation Division

1220 S. St Francis Dr.

Santa Fe, NM 87505

WELL LOCATION AND ACREAGE DEDICATION PLAT

API Number 30-15-32518	Pool Name CROOKED CREEK;MORROW (GAS)	Pool Code 75400
Property Code 30761	Property Name Samuel Smith Unit	Well No. 002
OGRID No. 25575	Operator Name Yates Petroleum Corporation	Elevation 4242

Surface And Bottom Hole Location

UL or Lot I	Section 32	Township 23S	Range 24E	Lot Idn	Feet From 1420	N/S Line S	Feet From 1190	E/W Line E	County Eddy
Dedicated Acres 320		Joint or Infill		Consolidation Code		Order No.			

OPERATOR CERTIFICATION

I hereby certify that the information contained herein is true and complete to the best of my knowledge and belief.

Electronically Signed By: Robert Asher

Title: Manager

Date: 11/7/2002

SURVEYOR CERTIFICATION

I hereby certify that the well location shown on this plat was plotted from field notes of actual surveys made by me or under my supervision, and that the same is true and correct to the best of my belief.

Electronically Signed By: Dan R. Reddy

Date of Survey: 9/23/2002

Certificate Number: 5412

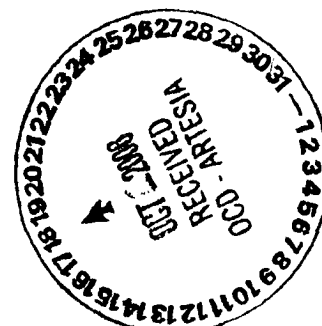

District I
1625 N. French Dr Hobbs, NM 88240

District II
811 South First, Artesia, NM 88210

District III
1000 Rio Brazos Rd., Aztec NM 87410

District IV
2040 South Pacheco, Santa Fe, NM 87505

State of New Mexico
Energy, Minerals & Natural Resources

OIL CONSERVATION DIVISION

2040 South Pacheco
Santa Fe, N M 87505

Form C-102

Revised March 17, 1999
Submit to Appropriate District Office
State Lease - 4 Copies
Fee Lease - 3 Copies

☐ AMENDED REPORT

WELL LOCATION AND ACREAGE DEDICATION PLAT

API Number		Pool Code		Pool Name	
Property Code		Property Name SAMUEL SMITH "BAS" STATE			Well Number 1
OGRID No.		Operation Name YATES PETROLEUM CORPORATION			Elevation 4242

Surface Location

UL or Lot No.	Section	Township	Range	Lot Idn.	Feet from the	North/South line	Feet from the	East/West line	County
I	32	23-S	24-E		1420	SOUTH	1190	EAST	EDDY

Bottom Hole Location If Different From Surface

UL or Lot No.	Section	Township	Range	Lot Idn.	Feet from the	North/South line	Feet from the	East/West line	County

Dedicated Acres	Joint or Infill	Consolidation Code	Order No.

NO ALLOWABLE WILL BE ASSIGNED TO THIS COMPLETION UNTIL ALL INTEREST HAVE BEEN CONSOLIDATED OR A NON-STANDARD UNIT HAS BEEN APPROVED BY THE DIVISION

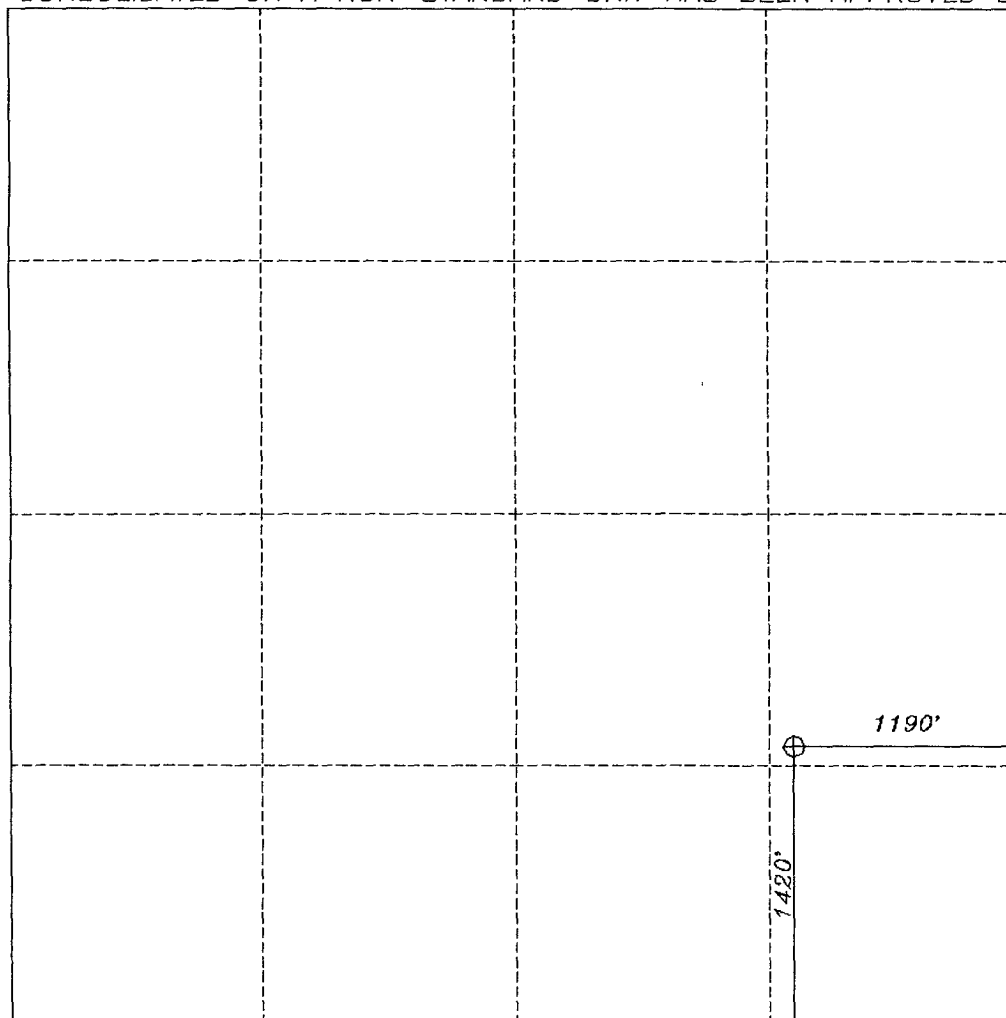
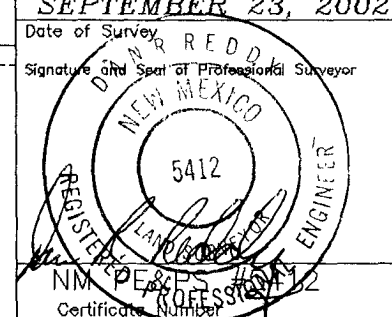
	OPERATOR CERTIFICATION I HEREBY CERTIFY THAT THE INFORMATION HEREIN IS TRUE AND CORRECT TO THE BEST OF MY KNOWLEDGE AND BELIEF.
	Signature
	Printed Name
	Title
	Date
	SURVEYOR CERTIFICATION I HEREBY CERTIFY THAT THE WELL LOCATION SHOWN ON THIS PLAT WAS PLOTTED FROM FIELD NOTES OF ACTUAL SURVEYS MADE BY ME OR UNDER MY SUPERVISION, AND THAT THE SAME IS TRUE AND CORRECT TO THE BEST OF MY KNOWLEDGE AND BELIEF.
	SEPTEMBER 23, 2002 Date of Survey
	Signature and Seal of Professional Surveyor
	

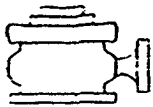

Yates Petroleum Corporation

Typical 5,000 psi Pressure System

Schematic

Annular with Double Ram Preventer Stack

BOP-4

Samuel Smith Unit 2

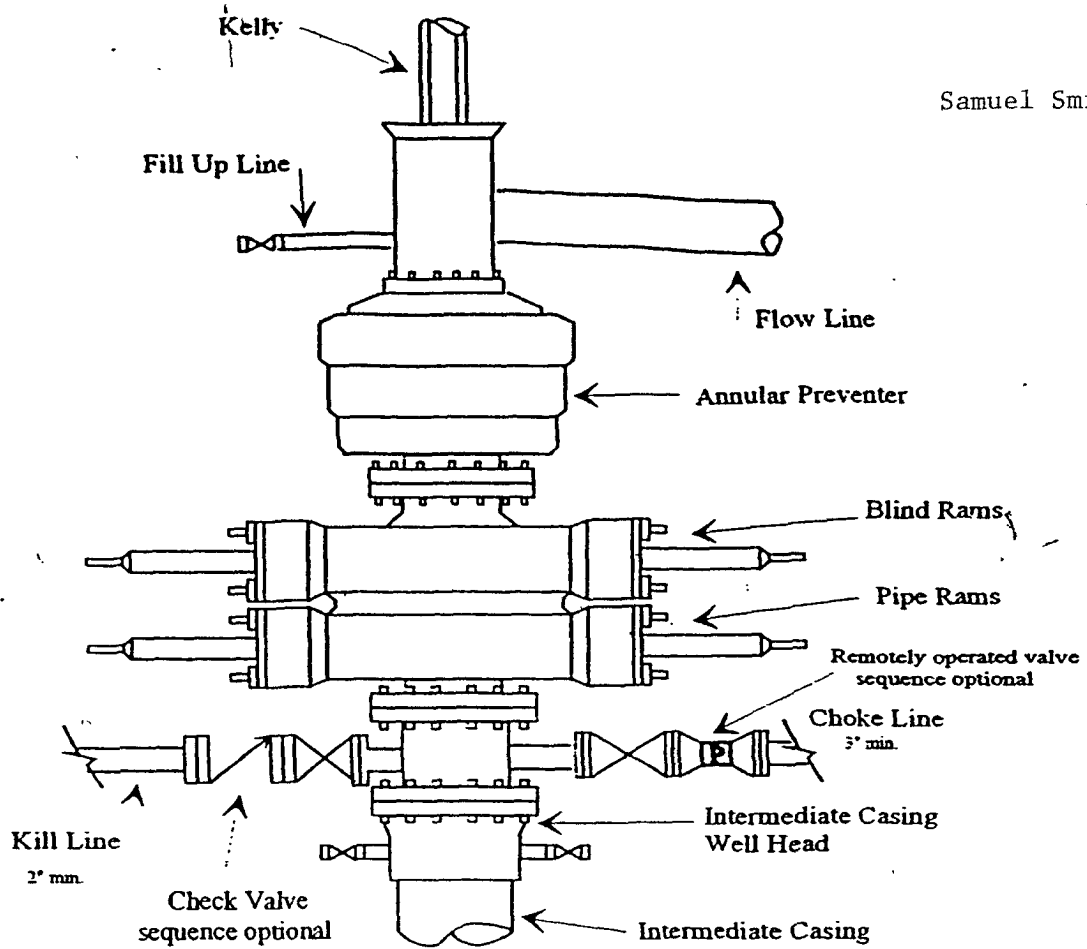

Typical 5,000 psi choke manifold assembly with at least these minimum features

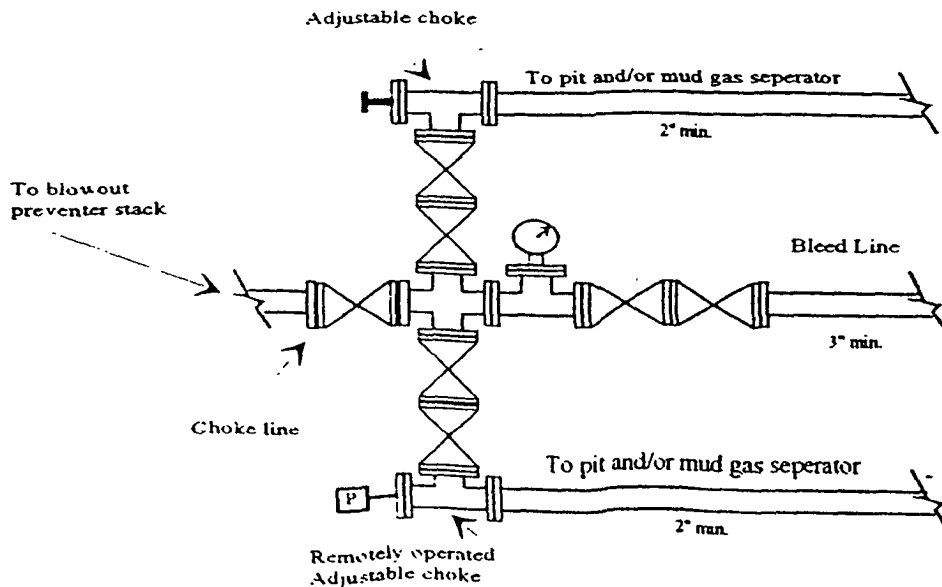

District I
1625 N. French Dr., Hobbs, NM 88240
District II
1301 W. Grand Avenue, Artesia, NM 88210
District III
1000 Rio Brazos Road, Aztec, NM 87410
District IV
1220 S. St. Francis Dr., Santa Fe, NM 87505

State of New Mexico
Energy Minerals and Natural Resources

Oil Conservation Division
1220 South St. Francis Dr.
Santa Fe, NM 87505

Form C-144
March 12, 2004

For drilling and production facilities, submit to appropriate NMOCD District Office.
For downstream facilities, submit to Santa Fe office

Pit or Below-Grade Tank Registration or Closure

Is pit or below-grade tank covered by a "general plan"? Yes ☒ No ☐

Type of action: Registration of a pit or below-grade tank ☒ Closure of a pit or below-grade tank ☐

Operator: <u>Yates Petroleum Corporation</u>		Telephone: <u>(505) 748-4372</u>		e-mail address: <u>debbiec@ypennm.com</u>	
Address: <u>105 South 4th Street, Artesia, NM 88210</u>					
Facility or well name: <u>Samuel Smith Unit #2 API # 30-015-32518</u>					
U/L or Qtr/Qtr <u>1</u> Sec <u>32</u> T <u>23S</u> R <u>24E</u>					
County: <u>Eddy</u> Latitude _____ Longitude _____ NAD: 1927 <input type="checkbox"/> 1983 <input type="checkbox"/> Surface Owner: Federal <input type="checkbox"/> State <input checked="" type="checkbox"/> Private <input type="checkbox"/> Indian <input type="checkbox"/>					
Pit Type: Drilling <input checked="" type="checkbox"/> Production <input type="checkbox"/> Disposal <input type="checkbox"/>		Below-grade tank			
Workover <input type="checkbox"/> Emergency <input type="checkbox"/>		Volume: _____ bbl Type of fluid: _____			
Lined <input checked="" type="checkbox"/> Unlined <input type="checkbox"/>		Construction material: _____			
Liner type: Synthetic <input checked="" type="checkbox"/> Thickness <u>12 mil</u>		Double-walled, with leak detection? Yes <input type="checkbox"/> If not, explain why not. _____			
Clay <input type="checkbox"/> Volume <u>20,000</u> bbl					
Depth to ground water (vertical distance from bottom of pit to seasonal high water elevation of ground water.)		Less than 50 feet (20 points)			
		50 feet or more, but less than 100 feet (10 points)		<input type="checkbox"/>	
		100 feet or more (0 points)		<input type="checkbox"/>	
Wellhead protection area. (Less than 200 feet from a private domestic water source, or less than 1000 feet from all other water sources.)		Yes (20 points)		<input type="checkbox"/>	
		No (0 points)		<input type="checkbox"/>	
Distance to surface water: (horizontal distance to all wetlands, playas, irrigation canals, ditches, and perennial and ephemeral watercourses.)		Less than 200 feet (20 points)			
		200 feet or more, but less than 1000 feet (10 points)			
		1000 feet or more (0 points)		<input type="checkbox"/>	
Ranking Score (Total Points)				Points <u>0</u>	

RECEIVED

OCT 06 2005

OCU-ARTESIA

If this is a pit closure: (1) attach a diagram of the facility showing the pit's relationship to other equipment and tanks. (2) Indicate disposal location:

onsite ☐ offsite ☐ If offsite, name of facility _____ (3) Attach a general description of remedial action taken including remediation start date and end date. (4) Groundwater encountered: No ☐ Yes ☐ If yes, show depth below ground surface _____ ft. and attach sample results. (5) Attach soil sample results and a diagram of sample locations and excavations.

I hereby certify that the information above is true and complete to the best of my knowledge and belief. I further certify that the above-described pit or below-grade tank has been/will be constructed or closed according to NMOCD guidelines ☐, a general permit ☒, or an (attached) alternative OCD-approved plan ☐.

Date: October 7, 2005

Printed Name/Title Debbie L. Caffall/Regulatory Technician Signature Debbie L. Caffall

Your certification and NMOCD approval of this application/closure does not relieve the operator of liability should the contents of the pit or tank contaminate ground water or otherwise endanger public health or the environment. Nor does it relieve the operator of its responsibility for compliance with any other federal, state, or local laws and/or regulations.

Approval:

Date: OCT 6 2005

Printed Name/Title Supervisor Signature [Signature]