

District I  
1625 N. French Dr., Hobbs, NM 88240  
District II  
1301 W. Grand Avenue, Artesia, NM 88210  
District III  
1000 Rio Brazos Road, Aztec, NM 87410  
District IV  
1220 S. St. Francis Dr., Santa Fe, NM 87505

State of New Mexico  
Energy Minerals and Natural Resources

Form C-144  
June 1, 2004

Oil Conservation Division  
1220 South St. Francis Dr.  
Santa Fe, NM 87505

For drilling and production facilities, submit to appropriate NMOCD District Office.  
For downstream facilities, submit to Santa Fe office

**Pit or Below-Grade Tank Registration or Closure**

Is pit or below-grade tank covered by a "general plan"? Yes ☒ No ☐  
Type of action: Registration of a pit or below-grade tank ☐ Closure of a pit or below-grade tank ☒

JAN 16 2008

OCD-ARTESIA

Operator: Myco Industries, Inc. Telephone: 575-748-1471 e-mail address: anmuncy@myco.com	
Address: P.O. Box 840 Artesia, NM 88211-0840	
Facility or well name: Alfalfa 32 Fee #1H	API #: 30-005-63850
County: Eddy	Latitude 32.965999 N Longitude 104.470832 W NAD: 1927 <input type="checkbox"/> 1983 <input checked="" type="checkbox"/>
Surface Owner: Federal <input type="checkbox"/> State <input type="checkbox"/> Private <input type="checkbox"/> Indian <input checked="" type="checkbox"/>	
<b>Pit</b> Type: Drilling <input checked="" type="checkbox"/> Production <input type="checkbox"/> Disposal <input type="checkbox"/> Workover <input type="checkbox"/> Emergency <input type="checkbox"/> Lined <input checked="" type="checkbox"/> Unlined <input type="checkbox"/> Liner type: Synthetic <input checked="" type="checkbox"/> Thickness 20 mil Clay <input type="checkbox"/> Pit Volume 12000 bbl	<b>Below-grade tank</b> Volume: _____ bbl Type of fluid: _____ Construction material: _____ Double-walled, with leak detection? Yes <input type="checkbox"/> If not, explain why not. _____
Depth to ground water (vertical distance from bottom of pit to seasonal high water elevation of ground water.)	Less than 50 feet (20 points) 50 feet or more, but less than 100 feet (10 points) 100 feet or more ( 0 points) 0
Wellhead protection area: (Less than 200 feet from a private domestic water source, or less than 1000 feet from all other water sources.)	Yes (20 points) 20 No ( 0 points)
Distance to surface water: (horizontal distance to all wetlands, playas, irrigation canals, ditches, and perennial and ephemeral watercourses.)	Less than 200 feet (20 points) 200 feet or more, but less than 1000 feet (10 points) 1000 feet or more ( 0 points) 0
Ranking Score (Total Points) 20	

If this is a pit closure: (1) Attach a diagram of the facility showing the pit's relationship to other equipment and tanks. (2) Indicate disposal location: (check the onsite box if you are burying in place) onsite ☐ offsite ☒ If offsite, name of facility \_\_\_\_\_. (3) Attach a general description of remedial action taken including remediation start date and end date. (4) Groundwater encountered: No ☒ Yes ☐ If yes, show depth below ground surface \_\_\_\_\_ ft. and attach sample results. (5) Attach soil sample results and a diagram of sample locations and excavations.

Additional Comments:
Pit contents hauled to authorized disposal site (CRI) and excavated until soil sample analysis indicates proper levels of chlorides and TPH in soil are below OCD guidelines.
See Attached pit diagram and Cardinal Laboratories soil analysis reports.

I hereby certify that the information above is true and complete to the best of my knowledge and belief. I further certify that the above-described pit or below-grade tank has been/will be constructed or closed according to NMOCD guidelines ☒, a general permit ☐, or an (attached) alternative OCD-approved plan ☐.

Date: Jan 8, 2008

Printed Name/Title Gene Lee, Agent, 575-626-4292

Signature

Your certification and NMOCD approval of this application/closure does not relieve the operator of liability should the contents of the pit or tank contaminate ground water or otherwise endanger public health or the environment. Nor does it relieve the operator of its responsibility for compliance with any other federal, state, or local laws and/or regulations.

Approval:

Accepted for record  
NMOCD

Printed Name/Title

Signature

JAN 17 2008

JAN 16 2008  
OCD-ARTESIA

LCI  
P.O. Box 8280  
Roswell, NM 88202-8280  
575-622-7355  
575-624-2911 Fax

January 8, 2008

Mr. Mike Bratcher  
NMOCD Artesia, NM  
1301 W. Grand Ave.  
Artesia, NM 88210

RE: Alfalfa 32 Fee #1H      API # 30-005-63850  
Milo 33 Fee #1H      API # 30-005-03849  
Final C144 Pit Closure With Documentation

Dear Mr. Bratcher,

Pursuant to our conversation in your office on December 18, 2007 giving me permission to close the above drilling pits, I am submitting the Final C-144 form to your office with the Cardinal Laboratories soil analysis run on samples shown in the attached diagram.

The pit contents were hauled to an authorized disposal site (CRI) and then excavation was performed and soil analysis was done on samples taken from the drilling pit area. This is shown on the attached diagram indicating the location and depth of the samples. I am enclosing copies of the soil sample analysis which were performed to check for Chlorides and TPH.

I am sure you are aware, but both the above described wells utilized the same drilling pit while the wells were drilled because the surface locations and wellheads are only 20' apart on the same drilling pad. This C-144 should be used as the final drilling pit closure for BOTH wells.

Final pit closure and pit area reclamation has been finalized and is satisfactory with the private land owner. If you have any questions, please contact me at the above telephone numbers. Thank you for your assistance in this matter.

Sincerely,

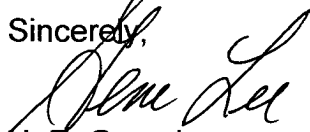

H. E. Gene Lee  
575-626-4292 Cell  
[leeconinc@aol.com](mailto:leeconinc@aol.com)

LCI  
P.O. Box 8280  
Roswell, NM 88202-8280  
505-622-7355  
505-624-2911 Fax  
505-626-4292 Cellular

December 16, 2007

Mr. Mike Bratcher  
NMOCD- Artesia, NM  
1301 W. Grand Ave  
Artesia, NM 88210

RE: Alfalfa / Milo Reserve Pit  
API Number: 30-015-63850  
Sec 32-T15S-R25  
Chaves County, New Mexico

Dear Mr. Bratcher,

Please find attached the latest soil analysis from Cardinal Laboratories on the above described project. The Alfalfa #1 well was drilled and completed by MYCO Industries and utilized a plastic lined reserve pit. This pit was constructed according to the NMOCD guidelines at the time and a C-144 was attached to the APD.

I am also attaching a copy of the daily report that showing the 16" conductor pipe was set at 120'. It was observed after drilling the 20" hole, that no water was encountered to the depth of 120' utilizing the auger of Butch's Rathole Service. This conductor pipe was then cemented to surface.

Sweatt Construction has previously been in contact with your office and has removed a substantial amount of soil below the original liner and contents. These samples are attached and were analyzed by Highlander Environmental Corp. Samples were taken from depths down to 15' and showed chloride content of 240 ppm in the NE corner, SW Corner and 200 ppm in the center area of the pit.

An additional excavation occurred and additional soil was excavated and taken to CRI for disposal. At this time I had a track backhoe excavate deeper in the corners and center area of the pit. Samples were taken at deeper depths

than was previously submitted by Highlander Environmental at the previous sites that had chlorides of >200 ppm.

Please note that these samples were taken on December 12, 2007 from depths down to 23' in the SW corner of the old reserve pit. Other samples were also taken as shown on the attached diagram. The samples were secured, placed in sample bottles, sealed, labeled and then taken to Cardinal Laboratories in Hobbs, NM. Two sets of samples were submitted to test chlorides as well as TPH. The samples were taken at early morning on 12/12/2007, then placed on ice while transported to Cardinal Laboratories.

It appears all samples analyzed by Cardinal Laboratories have acceptable levels of Chlorides and TPH. Based on this report from Cardinal, MYCO Industries would like to close this pit while the equipment is currently available and scheduled. This will also necessary to comply with the closure and restoration of the pit area for the surface owner to be able to resume farming of this property.

Please contact me at the 575-626-4292 if you have any questions and can contact me by email also at [leeconinc@aol.com](mailto:leeconinc@aol.com). Your response and approval will be anticipated in the near future. Please let me know if you have any other questions.

Thank you for your assistance in this matter.

Sincerely,

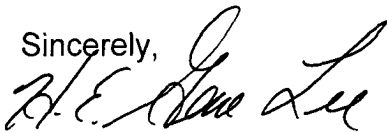
A handwritten signature in black ink, appearing to read "H. E. Gene Lee". The signature is fluid and cursive, with the first name "H. E." and last name "Lee" clearly distinguishable.

H. E. Gene LEE  
LCI

cc: Myco

PIT DIAGRAM AND SOIL SAMPLE LOCATOR

MYCO INDUSTRIES, INC  
Sec. 32-T155-R25E  
Chaves Co, N.M.

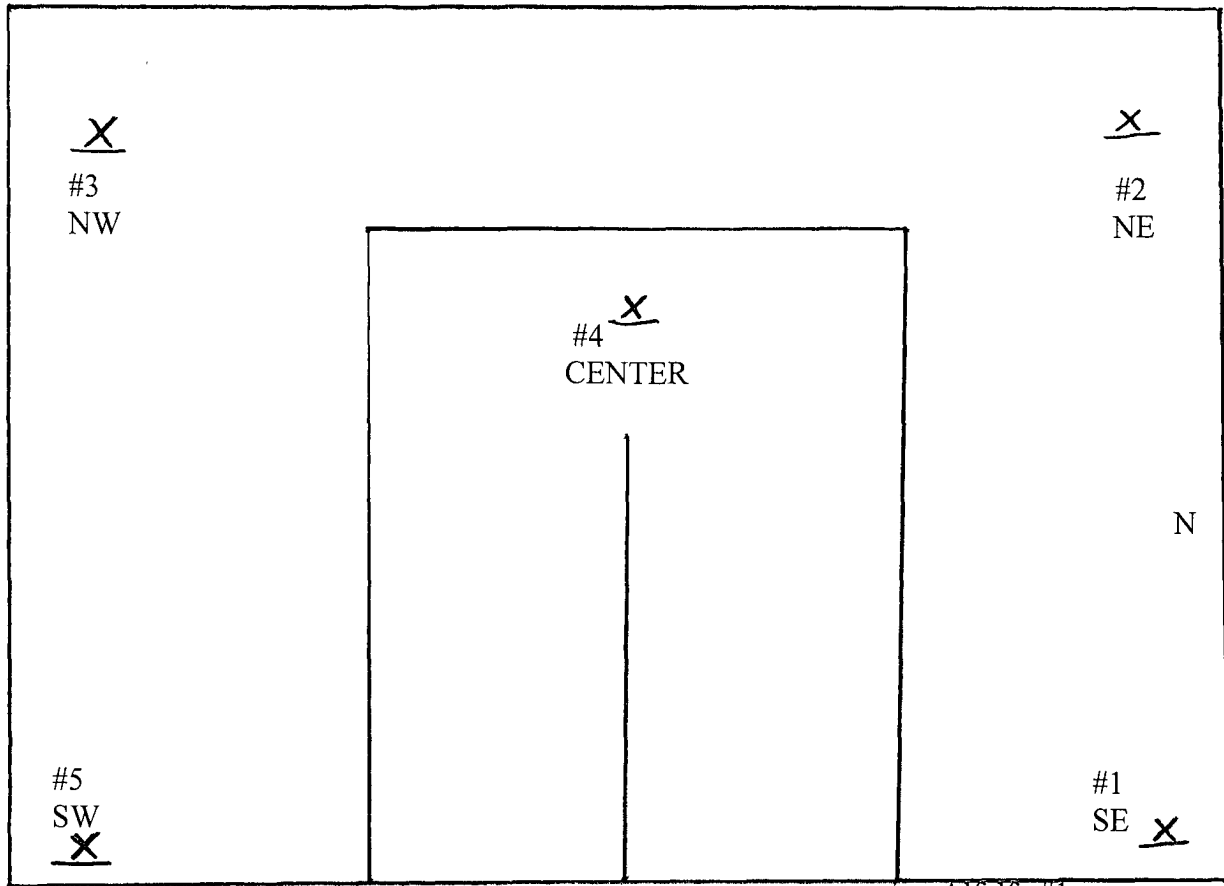

Alfalfa #1  
Wellbore ●

Alfalfa #1: API 30-015-63850

Sample #1: 0700 hrs, 12/12/2007, Depth: 18' Temp 38 Deg F.

SE Corner N32-57.984  
W104-27.412

Sample #2: 0700 hrs, 12/12/2007, Depth: 22', Temp 38 Deg F.

NE Corner N32-58.004  
W104-27.415

Sample #3: 0702 hrs, 12/12/2007, Depth: 19', Temp 38 Deg F.

NW Corner N32-57.982  
W104-27.142

Sample #4: 0704 hrs, 12/12/2007, Depth: 21', Temp 38 Deg F.

Center N32-58.025  
W104-27.432

Sample #5: 0706 hrs, 12/12/2007, Depth: 23', Temp 39 Deg F.

SW Corner N32-58.012  
W104-27.148



## CHAIN-OF-CUSTODY AND ANALYSIS REQUEST

<b>BILL TO</b>		<b>ANALYSIS REQUEST</b>	
<b>Company Name:</b> Lee Consulting, Inc.	<b>P.O. #:</b>		
<b>Project Manager:</b> Gene Lee	<b>Company:</b>		
<b>Address:</b> P.O. Box 8280	<b>Attn:</b>		
<b>City:</b> Roswell <b>State:</b> NM <b>Zip:</b> 88202	<b>Address:</b>		
<b>Phone #:</b> 575-622-7355 <b>Fax #:</b> 575-624-2911	<b>City:</b>		
<b>Project #:</b> <b>Project Owner:</b> Myco Industries	<b>State:</b> <b>Zip:</b>		
<b>Project Name:</b> Alfalfa/milo #1 Reserve Plot	<b>Phone #:</b>		
<b>Project Location:</b>	<b>Fax #:</b>		
<b>Sampler Name:</b> Gene Lee			

FOR LAB USE ONLY		MATRIX	PRESERV	SAMPLING		Chloride TPH 2015
Lab I.D.	Sample I.D.	GROUNDWATER WASTEWATER SOIL OIL SLUDGE OTHER: ACID/BASE: ICE / COOL OTHER :		DATE	TIME	
#13901-		(G)RAB OR (C)OMP. # CONTAINERS:				
1	#1-A					
2	#2-A					
3	#3-A					
4	#4-A					
5	#5-A					
6	#1					
7	#2					
8	#3					
9	#4					
10	#5					

PLEASE NOTE: Liability and Damages. Cardinal's liability and client's exclusive remedy for any claim arising whenever based in contract or tort, shall be limited to the amount paid by the client for the analyses. All claims, including those for negligence and any other cause whatsoever shall be deemed waived unless made in writing and received by Cardinal within 30 days after completion of the applicable service, in no event shall Cardinal be liable for incidental or consequential damages, including without limitation, business interruptions, loss of use or loss of profits incurred by client, its subsidiaries, affiliates or successors arising out of or related to the performance of services hereunder by Cardinal, regardless of whether such claim is based upon any of the above stated reasons or otherwise.

<b>Relinquished By:</b> [Signature]	Date: _____	<b>Received By:</b> _____	<b>Phone Result:</b> <input type="checkbox"/> Yes <input checked="" type="checkbox"/> No Add'l Phone #: _____
<b>Time:</b> _____			<b>Fax Result:</b> <input type="checkbox"/> Yes <input checked="" type="checkbox"/> No Add'l Fax #: _____
<b>REMARKS:</b>			
<b>Delivered By:</b> (Circle One) Sampler - UPS • Bus • Other: _____  Sample Condition: <input checked="" type="checkbox"/> Cool <input checked="" type="checkbox"/> Intact <input type="checkbox"/> Yes <input checked="" type="checkbox"/> No <input type="checkbox"/> No <input type="checkbox"/> Yes			<b>CHECKED BY:</b> (Initials) [Signature]

*LeeConInc@aol.com* ✓ K5  
12/13/07 CC

† Cardinal cannot accept verbal changes. Please fax written changes to 505-393-2476



PHONE (575) 393-2326 • 101 E. MARLAND • HOBBS, NM 88240

ANALYTICAL RESULTS FOR  
LEE CONSULTING, INC.  
ATTN: GENE LEE  
P.O. BOX 8280  
ROSWELL, NM 88202  
FAX TO: (575) 624-2911

Receiving Date: 12/12/07  
Reporting Date: 12/13/07  
Project Owner: MYCO INDUSTRIES  
Project Name: ALFALFA/MILO #1 RESERVE PIT  
Project Location: NOT GIVEN

Analysis Date: 12/13/07  
Sampling Date: 12/12/07  
Sample Type: SOIL  
Sample Condition: COOL & INTACT  
Sample Received By: CK  
Analyzed By: KS

LAB NUMBER	SAMPLE ID	Cl <sup>-</sup> (mg/kg)
H13901-1	#1 - A	< 16
H13901-2	#2 - A	< 16
H13901-3	#3 - A	< 16
H13901-4	#4 - A	16
H13901-5	#5 - A	< 16
Quality Control		500
True Value QC		500
% Recovery		100
Relative Percent Difference		< 0.1

METHOD: Standard Methods 4500-Cl<sup>-</sup>B

Note: Analyses performed on 1:4 w.v aqueous extracts.

Brian S. Sposito  
Chemist

12/13/07  
Date

H13901 LEE

PLEASE NOTE: Liability and Damages. Cardinal's liability and client's exclusive remedy for any claim arising, whether based in contract or tort, shall be limited to the amount paid by client for analyses. All claims, including those for negligence and any other cause whatsoever shall be deemed waived unless made in writing and received by Cardinal within thirty (30) days after completion of the applicable service. In no event shall Cardinal be liable for incidental or consequential damages, including, without limitation, business interruptions, loss of use, or loss of profits incurred by client, its subsidiaries, affiliates or successors arising out of or related to the performance of services hereunder by Cardinal, regardless of whether such claim is based upon any of the above-stated reasons or otherwise.



PHONE (575) 393-2326 • 101 E. MARLAND • HOBBS, NM 88240

ANALYTICAL RESULTS FOR  
LEE CONSULTING, INC.  
ATTN: GENE LEE  
P.O. BOX 8280  
ROSWELL, NM 88202  
FAX TO: (575) 624-2911

Receiving Date: 12/12/07  
Reporting Date: 12/14/07  
Project Owner: MYCO INDUSTRIES  
Project Name: ALFALFA/MILO #1 RESERVE PIT  
Project Location: NOT GIVEN

Sampling Date: 12/12/07  
Sample Type: SOIL  
Sample Condition: COOL & INTACT  
Sample Received By: CK  
Analyzed By: CK

LAB NUMBER	SAMPLE ID	GRO (C <sub>6</sub> -C <sub>12</sub> ) (mg/kg)	DRO (>C <sub>12</sub> -C <sub>28</sub> ) (mg/kg)
------------	-----------	--	--

ANALYSIS DATE	12/13/07	12/13/07
H13901-6 #1	<10.0	<10.0
H13901-7 #2	<10.0	<10.0
H13901-8 #3	<10.0	<10.0
H13901-9 #4	<10.0	<10.0
H13901-10 #5	<10.0	<10.0
Quality Control	506	448
True Value QC	500	500
% Recovery	101	89.6
Relative Percent Difference	3.8	1.5

METHODS: TPH GRO & DRO: EPA SW-846 8015 M

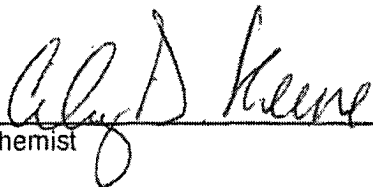
  
Chemist

  
Date

H13901T LEE

PLEASE NOTE: Liability and Damages. Cardinal's liability and client's exclusive remedy for any claim arising, whether based in contract or tort, shall be limited to the amount paid by client for analyses. All claims, including those for negligence and any other cause whatsoever shall be deemed waived unless made in writing and received by Cardinal within thirty (30) days after completion of the applicable service. In no event shall Cardinal be liable for incidental or consequential damages, including, without limitation, business interruptions, loss of use, or loss of profits incurred by client, its subsidiaries, affiliates or successors arising out of or related to the performance of services hereunder by Cardinal, regardless of whether such claim is based upon any of the above-stated reasons or otherwise.



**MYCO INDUSTRIES, INC.**  
**Daily Report**

**ALFALFA 32 FEE #1H**

**Surface Location: Sec 32-T15S-R25E, (Unit P)**

**Bottom Hole Loc: Sec 32-T15S-R25E, (Unit M)**

**Proposed TD: 9050' Wolfcamp**

**Landman: Shari Hodges**

**Geol: Jim Schlueter**

**Chaves County, New Mexico**

**API Number: 30-015-63850**

**710' FSL & 206' FEL**

**710' FSL & 660' FWL**

**Elevation: 3459' GL, 3475' KB**

**Eng: Nelson Muncy**

**Rig: Patriot Rig #1**

=====

**Note:** This well is on the same drill pad as the Myco Milo 33 Fee 1H which is 20' to the East of the Alfalfa 32 Fee 1H surface location. After drilling the Alfalfa 32 Fee 1H, the rig will skid and drill the Myco Milo 33 Fee #1H. The reserve pits were constructed to be utilized for the drilling of both wells.

APD & C-144 are approved through the NMOCD

**12-28-2006**

Location for both wells is complete.---Allstate Construction.

**1-20-2007**

MIRU Butch's Rathole Service. Drill 20" hole to 120'. Run 120', 16" conductor pipe. NOTE: No water encountered while drilling and setting conductor pipe. Cement Conductor w/ 250 sx Class "C" + 2% CaCl<sub>2</sub>. Plug down @1415 hrs, 1-19-2007. Circ 10 sx.

**1-21-2007 thru 1-29-2007**

Waiting on rig.

**1-30-2007**

Move in and rig up Patriot Drilling Company Rig #1. All rig and equipment on location. Rig Up and raise derrick at 5:30 PM, 1-29-2007. Shut down for night. Prepare to repair bearing on rotary drive (per agreement with rig contractor). Delivered 29 jts, 8 5/8", 24#, J55, ST&C surface casing from Myco Inventory via Toolpusher Supply trucks. Total pipe delivered was 1167.75' threads off.

**1-31-2007**

Remove guards and chains on drawworks off side and rig up Bridges Equipment. Remove and replace old bearings on rotary drive of main shaft. Replace with new bearings. Re-assemble bearings, shafts, hubs and guards. Replace and repair oiler lines. Finish rigging up floor. Fill pits with water. Weld on conductor and flow line. Pick up Kelly and make up BHA and bit. Mix spud mud. Install shaker line to pit. Pressure test all pump lines and lower Kelly cock valve. Pressure test all pressure lines on pits. Prep to spud.

**MYCO INDUSTRIES, INC.**  
**Daily Report**

**MILO 33 FEE #1H**

**Surface Location: Sec 32-T15S-R25E, (Unit P)**

**Bottom Hole Loc: Sec 33-T15S-R25E, (Unit P)**

**Proposed TD: 9450' Wolfcamp**

**Landman: Shari Hodges**

**Geol: Jim Schlueter**

**Chaves County, New Mexico**

**API #: 30-005-03849**

**710' FSL & 186' FEL**

**710' FSL & 660' FEL**

**Elevation: 3459' GL, 3475' KB**

**Eng: Nelson Muncy**

**Rig: Patriot Rig #1**

=====

**Note:** This well is on the same drill pad as the Myco Alfalfa 32 Fee 1H which is 20' to the West of the Milo 33 Fee 1H surface location. The rig was skidded 20' from the Alfalfa 32 Fee 1H surface location. The reserve pits were constructed to be utilized for the drilling of both wells. APD & C-144 are approved through the NMOCD

**12-28-2006**

Location for both wells is complete.---Allstate Construction.

**1-20-2007**

MIRU Butch's Rathole Service. Drill 20" hole to 120'. Run 120', 16" conductor pipe. Cement Conductor w/ 250 sx Class "C" + 2% CaCl<sub>2</sub>. Plug down @1300 hrs, 1-19-2007. Circ 22 sx.

NOTE: No water encountered while drilling 20" hole for conductor down to 120' or observed.

**2-1-2007 thru 2-22-2007**

Rig up, spud and drill Alfalfa 32 Fee #1H. Rig down Patriot Rig #1 to move to Milo 33 Fee #1H

**2-23-2007**

Move in Wilbanks Trucking and set off derrick from floor. Skid substructure over conductor of Milo 33 Fee #1H. Pin derrick and A frame. Raise derrick @ 1130 hrs, 2-23-07. Make new lower mouse hole shuck and install. Skid pits and pumps down 20' to the East. Rig up rotary tools. Install head on 16" Conductor pipe for contingency plan of water flow from Artesian water zone that was encountered on the Alfalfa 32 Fee #1H. Start filling steel pits and premix with fresh water. Move all tanks, generators, and rig equipment 20' East to the Milo 33 Fee #1H. Finish rigging up Patriot Rig #1. Unload Kelly and drive bushings that had been sent in for repairs. Pick up and install Kelly / Kelly shuck.

Finish inspection of 4.5" S135 rental drill pipe from Weatherford. Hobbs Rental Corp pipe inspection found 20 joints of 4.5" 16.60 Grade E pipe in string. Cull out the 20 joints of mixed pipe. 2 joints of 4.5" DP were too cemented up to rattle and would not clean up with Hydro blast tool. Hydro Blast all drill pipe, heavy weight drill pipe and drill collars. Cleaned out 4 drill collars with cement in ID that were not run in last well. Drill pipe was not able to be electronically inspected due to thin cement coating on OD of pipe that prevented accurate inspection of tube. Reface total of 32 box ends on DP and 27 pin ends of DP. There are a total of 5 box ends and 2 pin ends damaged that need to be sent to machine shop for re-cuts.

Inspect all XO's, lift subs, eyes, bit subs, upper & lower Kelly cock valves and mandrel of swivel. Repair threads and reface shoulder of swivel mandrel. Found 4 cracked & damaged subs and Kelly cock valves. Inspect all heavy weight drill pipe and hydro blast ID. No bad joints of heavy weight DP.

String level substructure in both directions and center it over conductor pipe. Deliver and unload 18.5' piece of 13 3/8" cutoff to replace lower mouse hole shuck. Deliver and unload total of 30 jts 8 5/8" 32# J55 ST&C 8rd thread of Myco Inventory from Toolpusher supply via Crockett Trucks. **Total of 1244.52' Threads On Tally.**



**Highlander Environmental Corp.**  
**Pit Sample Location Plot**

Pit wall in feet \_\_\_\_\_

    \* NW                      NE \*    

    \* Center                      \*    

    \* SW                      SE \*    

**Wellhead**

**Well Pad**

**Legend:**

\* Indicates Sample Location  
(Name by quarter i.e. NW, NE etc)

 Draw In North Arrow

Depth of pit in feet \_\_\_\_\_

Pit wall in feet \_\_\_\_\_

Client: Myco Industries (Sweatt)

Well: Al Salza 32 FCC #1

Map: 30-015-63850

[illegible]

## DISTRICT I

1920 N. FRANCIS DR., ROSA, NM 88240

## DISTRICT II

1201 W. GRAND AVENUE, ARTESIA, NM 88210

## DISTRICT III

1000 Rio Bravos Rd., Aztec, NM 87410

## DISTRICT IV

1220 S. ST. FRANCIS DR., SANTA FE, NM 87505

State of New Mexico  
Energy, Minerals and Natural Resources DepartmentOIL CONSERVATION DIVISION  
1220 SOUTH ST. FRANCIS  
Santa Fe, New Mexico 87505Form C-102  
Revised October 12, 2005  
Submit to Appropriate District Office  
State Lease - 4 Copies  
Fee Lease - 3 Copies

## WELL LOCATION AND ACREAGE DEDICATION PLAT

☐ AMENDED REPORT

API Number	Pool Code 96086	Well Name Wildcat, Wolfcamp
Property Code	Property Name ALFALFA 32 FEE	Well Number 1
OCRID No.	Operator Name MYCO INDUSTRIES, INC.	Elevation 3460'

## Surface Location

UL or lot No.	Section	Township	Range	Lot Idn	Feet from the	North/South line	Feet from the	East/West line	County
P	32	15-S	25-E		660	SOUTH	660	EAST	CHAVES

## Bottom Hole Location If Different From Surface

UL or lot No.	Section	Township	Range	Lot Idn	Feet from the	North/South line	Feet from the	East/West line	County
M	32	15-S	25-E		660	SOUTH	660	WEST	CHAVES

Dedicated Acres	Joint or Infill	Consolidation Code	Order No.
320			

NO ALLOWABLE WILL BE ASSIGNED TO THIS COMPLETION UNTIL ALL INTERESTS HAVE BEEN CONSOLIDATED  
OR A NON-STANDARD UNIT HAS BEEN APPROVED BY THE DIVISION

<p><b>BOTTOM HOLE LOCATION</b> Y=715170.5 N X=457829.2 E LAT.=32.965999° N LONG.=104.470832° W</p>	<p><b>GEODETTIC COORDINATES NAD 27 NME</b> <b>SURFACE HOLE LOCATION</b> Y=715176.0 N X=461786.6 E LAT.=32.966028° N LONG.=104.457928° W</p>	<p><b>OPERATOR CERTIFICATION</b></p> <p>I hereby certify that the information herein is true and complete to the best of my knowledge and belief, and that this organization either owns a working interest or a leased mineral interest in the land including the proposed bottom hole location or has a right to drill this well at this location pursuant to a contract with an owner of such mineral or working interest, or a voluntary pooling agreement or a compulsory pooling order heretofore entered by the division.</p> <p><u>ALLIANCE, PELS</u> 8-6-06 Signature Date <u>L.N. MUNCY</u> Printed Name</p>
		<p><b>SURVEYOR CERTIFICATION</b></p> <p>I hereby certify that the well location shown on this plat was plotted from field notes of actual surveys made by me or under my supervision, and that the same is true and correct to the best of my belief.</p> <p>AUGUST 24, 2006 Date Surveyed LA REV: 9/6/06 Signature &amp; Seal of Professional Surveyor <u>GARY EIDSON</u> 9/6/06 06.LI.1366 Certificate No. GARY EIDSON 12841</p>

**SECTION 32, TOWNSHIP 15 SOUTH, RANGE 25 EAST, N.M.P.M.,**  
**CHAVES COUNTY, NEW MEXICO**

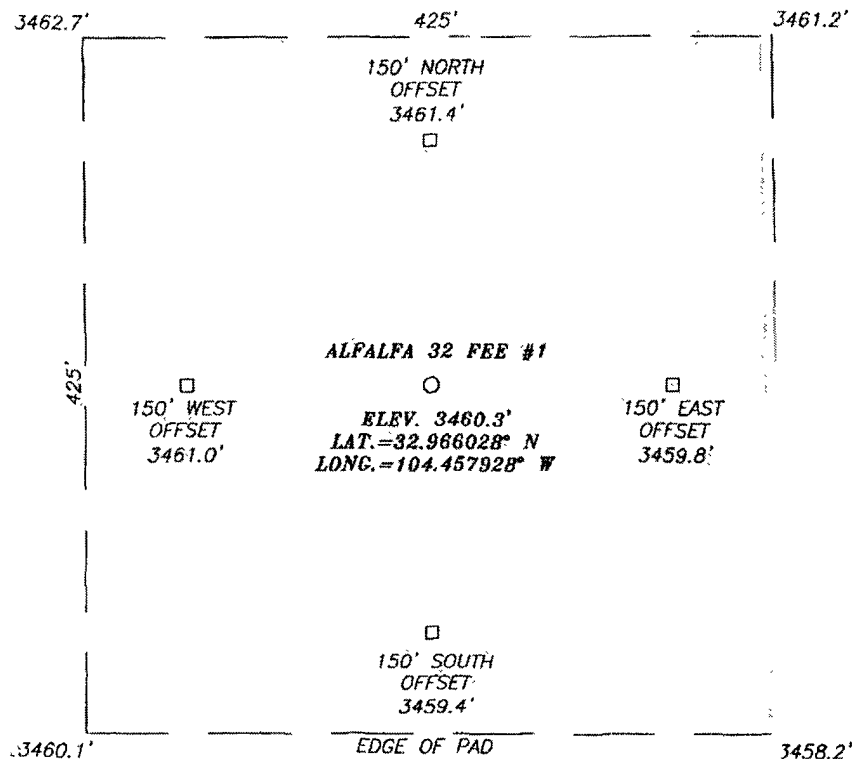

**DIRECTIONS TO LOCATION**

FROM THE INTERSECTION OF U.S. HWY. #285 AND PEARSON ROAD (COUNTY LINE). GO WEST ON PEARSON ROAD FOR APPROX. 1.1 MILES. THIS LOCATION IS APPROX. 600 FEET NORTH.

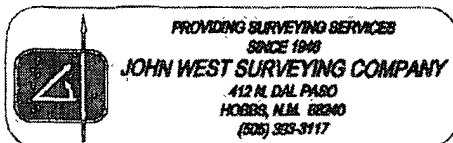
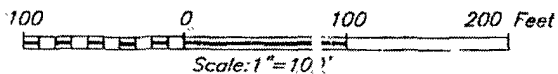

**MYCO INDUSTRIES, INC.**

ALFALFA 32 FEE #1 WELL  
 LOCATED 660 FEET FROM THE SOUTH LINE  
 AND 660 FEET FROM THE EAST LINE OF SECTION 32,  
 TOWNSHIP 15 SOUTH, RANGE 25 EAST, N.M.P.M.,  
 CHAVES COUNTY, NEW MEXICO.

Survey Date: 8/24/06	Sheet: 1 of 1 Sheets
W.O. Number: 06.11.1366	Dr By: A Rev 1: N/A
Date: 8/28/06	Disk: CD#5 6111366 Scale: 1"=100'