

District I
1025 N French Dr, Hobbs, NM 88240
District II
1301 W Grand Avenue, Artesia, NM 88210
District III
1000 Rio Brazos Road, Aztec, NM 87410
District IV
1220 S St Francis Dr, Santa Fe, NM 87505

State of New Mexico
Energy Minerals and Natural Resources

Form C-144
June 1, 2004

Oil Conservation Division
1220 South St. Francis Dr.
Santa Fe, NM 87505

For drilling and production facilities, submit to appropriate NMOCD District Office.
For downstream facilities, submit to Santa Fe office



Pit or Below-Grade Tank Registration or Closure

Is pit or below-grade tank covered by a "general plan"? Yes ☒ No ☐

Type of action Registration of a pit or below-grade tank ☐ Closure of a pit or below-grade tank ☒

Operator Yates Petroleum Corporation Telephone 505-748-4500 e-mail address mikes@ypcnm.com
Address 105 South 4th Street, Artesia, NM 88210
Facility or well name Loving AIB State #15 API # 30-015-35437 U/L or Qtr/Qtr K Sec 16 T 23S R 28E
County Eddy Latitude 32 30236 Longitude 104 09308 NAD 1927 ☒ 1983 ☐
Surface Owner Federal ☐ State ☐ Private ☒ Indian ☐

JAN 31 2008
OCD-ARTESIA

Pit Type Drilling <input checked="" type="checkbox"/> Production <input type="checkbox"/> Disposal <input type="checkbox"/> Work over <input type="checkbox"/> Emergency <input type="checkbox"/> Lined <input checked="" type="checkbox"/> Unlined <input type="checkbox"/> Liner type Synthetic <input checked="" type="checkbox"/> Thickness <u>12</u> mil Clay <input type="checkbox"/> Pit Volume <u>20000</u> bbl	Below-grade tank Volume _____ bbl Type of fluid _____ Construction material _____ Double-walled, with leak detection? Yes <input type="checkbox"/> If not, explain why not _____
Depth to ground water (vertical distance from bottom of pit to seasonal high water elevation of ground water)	Less than 50 feet (20 points) XXXX 50 feet or more, but less than 100 feet (10 points) 100 feet or more (0 points)
Wellhead protection area (Less than 200 feet from a private domestic water source, or less than 1000 feet from all other water sources)	Yes (20 points) No (0 points) XXXX
Distance to surface water (horizontal distance to all wetlands, playas, irrigation canals, ditches, and perennial and ephemeral watercourses)	Less than 200 feet (20 points) 200 feet or more, but less than 1000 feet (10 points) 1000 feet or more (0 points) XXXX
Ranking Score (Total Points) 20 Points	

If this is a pit closure: (1) Attach a diagram of the facility showing the pit's relationship to other equipment and tanks (2) Indicate disposal location (check the onsite box if you are burying in place) onsite ☐ offsite ☒ If offsite, name of facility N/A (3) Attach a general description of remedial action taken including remediation start date and end date (4) Groundwater encountered No ☐ Yes ☐ If yes, show depth below ground surface _____ ft and attach sample results

(5) Attach soil sample results and a diagram of sample locations and excavations

Additional Comments Closure work plan for drilling pit The drilling pit contents will be excavated and hauled to an OCD approved soil waste facility
The excavated area will be backfilled to grade using a minimum of 3' of clean soil and like material A one call and a 48 hour notice will be provided to the Oil Conservation Division
Pit Closure start date N/A Final closure date N/A

I hereby certify that the information above is true and complete to the best of my knowledge and belief I further certify that the above-described pit or below-grade tank has been/will be constructed or closed according to NMOCD guidelines ☐, a general permit ☒, or an (attached) alternative OCD-approved plan ☐.

Date 01/29/2008

Printed Name/Title Mike Stubblefield / Environmental Regulatory Agent

Signature Mike Stubblefield

Your certification and NMOCD approval of this application/closure does not relieve the operator of liability should the contents of the pit or tank contaminate ground water or otherwise endanger public health or the environment Nor does it relieve the operator of its responsibility for compliance with any other federal, state, or local laws and/or regulations

Approval

Printed Name/Title

Signed By Mike Stubblefield

Date

FEB 02 2008

NOTIFY OCD 24 HOURS PRIOR to beginning closure and 24 HOURS PRIOR to obtaining samples. Samples are to be obtained from pit area and analyses submitted to OCD prior to back-filling.

New Mexico Office of the State Engineer
POD Reports and Downloads

LOVING AIR STATE #15
 30-015-35437

Township: Range: Sections:

NAD27 X: Y: Zone: Search Radius:

County: Basin: Number: Suffix:

Owner Name: (First) (Last) ☐ Non-Domestic ☐ Domestic ☒ All

POD / Surface Data Report

Avg Depth to Water Report

Water Column Report

Clear Form

iWATERS Menu

Help

AVERAGE DEPTH OF WATER REPORT 01/29/2008

Bsn	Tws	Rng	Sec	Zone	X	Y	Wells	(Depth Water in Feet)		
								Min	Max	Avg
C	23S	28E	05				1	33	33	33
C	23S	28E	06				11	20	85	45
C	23S	28E	07				2	40	50	45
C	23S	28E	08				3	16	50	35
C	23S	28E	09				1	30	30	30
C	23S	28E	10				2	19	25	22
C	23S	28E	11				2	15	16	16
C	23S	28E	12				1	20	20	20
C	23S	28E	13				4	15	50	33
C	23S	28E	14				2	29	30	30
C	23S	28E	15				5	12	54	37
C	23S	28E	16				3	33	55	40✓
C	23S	28E	17				2	50	75	63
C	23S	28E	18				3	42	217	113
C	23S	28E	19				2	10	45	28
C	23S	28E	20				3	34	70	55
C	23S	28E	21				7	6	69	23
C	23S	28E	22				10	30	160	54
C	23S	28E	23				7	12	75	46
C	23S	28E	24				1	36	36	36
C	23S	28E	25				7	27	60	44
C	23S	28E	27				2	18	40	29
C	23S	28E	28				2	3	10	7
C	23S	28E	29				1	15	15	15
C	23S	28E	30				1	8	8	8
C	23S	28E	33				1	190	190	190
C	23S	28E	34				1	25	25	25
C	23S	28E	35				1	30	30	30

Record Count: 88

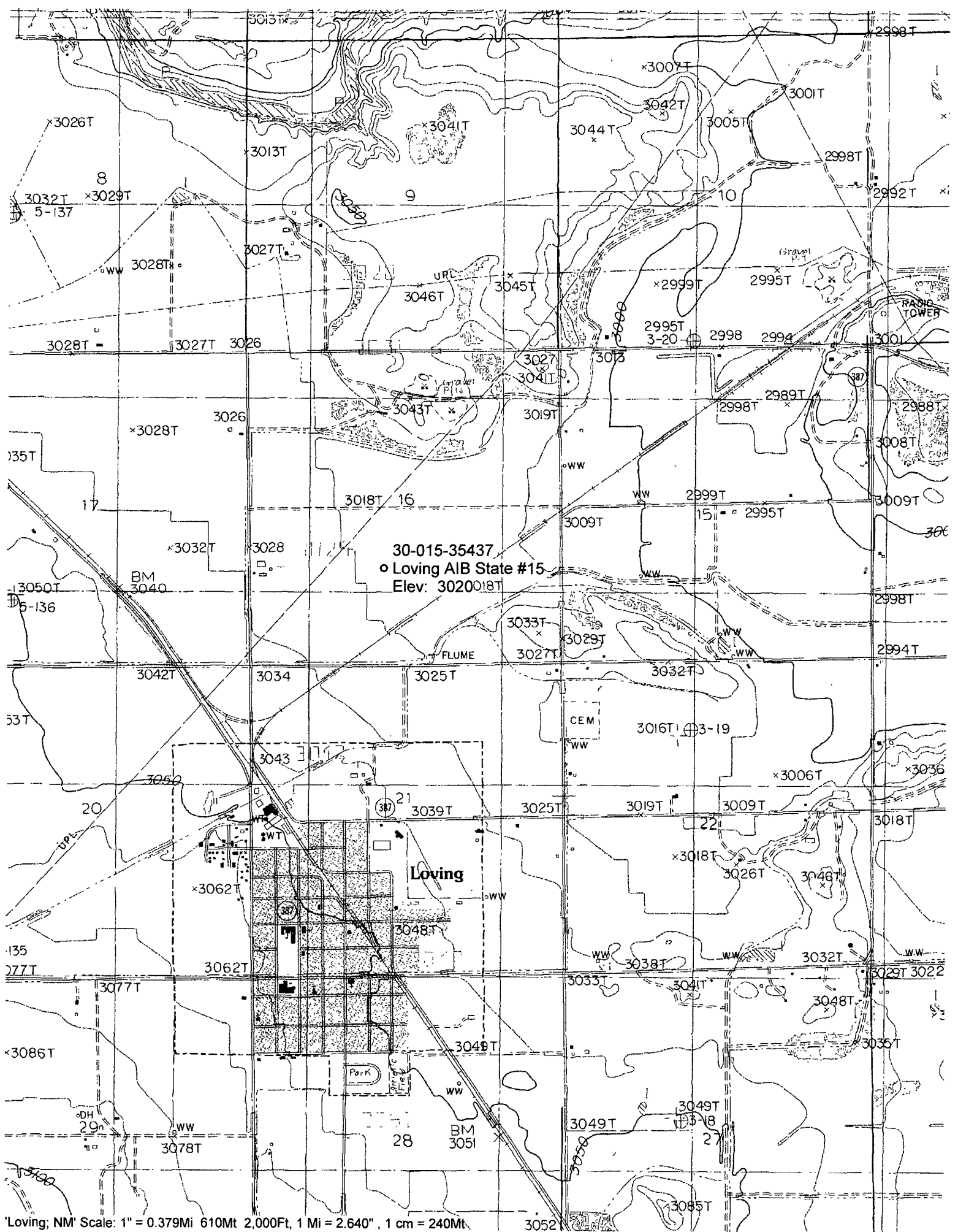

'Loving; NM' Scale: 1" = 0.379Mi 610Mt 2,000Ft, 1 Mi = 2.640", 1 cm = 240Mt.