

District I

625 N French Dr., Hobbs, NM 88240

District II

1301 W. Grand Avenue, Artesia, NM 88210

District III

1000 Rio Brazos Road, Aztec, NM 87410

District IV

1220 S St Francis Dr., Santa Fe, NM 87505

State of New Mexico
Energy Minerals and Natural ResourcesForm C-101
May 27, 2004Oil Conservation Division
1220 South St. Francis Dr.
Santa Fe, NM 87505

Submit to appropriate District Office

☐ AMENDED REPORT

APPLICATION FOR PERMIT TO DRILL, RE-ENTER, DEEPEN, PLUGBACK, OR ADD A ZONE

¹ Operator Name and Address Devon Energy Production Co., L P 20 North Broadway OKC, OK 73102-8260		² OGRID Number 6137
³ Property Code	⁴ Property Name Springs 2 Federal	⁵ API Number 30-015-31236
⁶ Well No. 1		
⁷ Proposed Pool 1 Springs; Upper Penn.		⁸ Proposed Pool 2

⁷ Surface Location

UL or lot no	Section	Township	Range	Lot Idn	Feet from the	North/South line	Feet from the	East/West line	County
10	2	21S	25E		2375	North	2300	East	Eddy

⁸ Proposed Bottom Hole Location If Different From Surface

UL or lot no	Section	Township	Range	Lot Idn	Feet from the	North/South line	Feet from the	East/West line	County
10	2	21S	25E		3200	North	1900	East	Eddy

Additional Well Information

¹¹ Work Type Code P	¹² Well Type Code G	¹³ Cable/Rotary R	¹⁴ Lease Type Code S	¹⁵ Ground Level Elevation 3225' GL
¹⁶ Multiple No	¹⁷ Proposed Depth 10,850'	¹⁸ Formation Catclaw Draw, Morrow	¹⁹ Contractor	²⁰ Spud Date
Depth to Groundwater		Distance from nearest fresh water well		Distance from nearest surface water
Pit Liner: Synthetic <input type="checkbox"/> _____ mils thick Clay <input type="checkbox"/> Pit Volume: _____ bbls Drilling Method: _____ Closed-Loop System <input checked="" type="checkbox"/> Fresh Water <input type="checkbox"/> Brine <input type="checkbox"/> Diesel/Oil-based <input type="checkbox"/> Gas/Air <input type="checkbox"/>				

²¹ Proposed Casing and Cement Program

Hole Size	Casing Size	Casing weight/foot	Setting Depth	Sacks of Cement	Estimated TOC
17 1/4"	13 3/8" H-40	48#	453'	500 sx C I C	surface
12 1/4"	8 5/8" K-55	32#	2170'	910 sx C I C	surface
7 7/8"	5 1/2" I-55	17#	10850'	1200 sx C I H	TOC @ 1190'

²² Describe the proposed program. If this application is to DEEPEN or PLUG BACK, give the data on the present productive zone and proposed new productive zone. Describe the blowout prevention program, if any. Use additional sheets if necessary.

Devon Energy Production Company, LP requests approval to plugback to the Cisco Canyon from the existing Catclaw Draw; Morrow:
See attached procedures

Note: No H2S is expected to be encountered BOP to be used

Completion papers to be filed if successful plugback

JAN 30 2008
OCD-ARTESIA

²³ I hereby certify that the information given above is true and complete to the best of my knowledge and belief. I further certify that the drilling pit will be constructed according to NMOCD guidelines <input checked="" type="checkbox"/> a general permit <input type="checkbox"/> , or an (attached) alternative OCD-approved plan <input type="checkbox"/> .		OIL CONSERVATION DIVISION	
Printed name: Stephanie A. Ysasaga		Approved by BRYAN G. ARRANT	
Title: Sr Staff Engineering Technician		Title: DISTRICT II GEOLOGIST	
E-mail Address: Stephanie.Ysasaga@devn.com		Approval Date: JAN 30 2008 Expiration Date: 2010	
Date: 01/24/2008	Phone: (405)-552-7802	Conditions of Approval Attached <input type="checkbox"/>	

DISTRICT II

P.O. Drawer DD, Artesia, NM 88211-0718

DISTRICT III

1000 Rio Brazos Ed., Artesia, NM 87410

DISTRICT IV

P.O. Box 2068, Santa Fe, N.M. 87504-2068

OIL CONSERVATION DIVISION

P.O. Box 2088
Santa Fe, New Mexico 87504-2088

AMENDED REPORT

WELL LOCATION AND ACREAGE DEDICATION PLAT

API Number	Pool Code 74320	Pool Name CATCLAW DRAW - MORROW
Property Code	Property Name SPRINGS 2 FEDERAL	Well Number 1
OGRID No. 166111	Operator Name CONCHO RESOURCES INC.	Elevation 3225

Surface Location

UL or lot No.	Section	Township	Range	Lot Idn	Feet from the	North/South line	Feet from the	East/West line	County
LOT 10	2	21 S	25 E		2375	NORTH	2300	EAST	EDDY

Bottom Hole Location If Different From Surface

UL or lot No.	Section	Township	Range	Lot Idn	Feet from the	North/South line	Feet from the	East/West line	County
LOT 10	2	21 S	25 E		3200	NORTH	1900	EAST	EDDY

Dedicated Acres	Joint or Infill	Consolidation Code	Order No.
592			

NO ALLOWABLE WILL BE ASSIGNED TO THIS COMPLETION UNTIL ALL INTERESTS HAVE BEEN CONSOLIDATED
OR A NON-STANDARD UNIT HAS BEEN APPROVED BY THE DIVISION

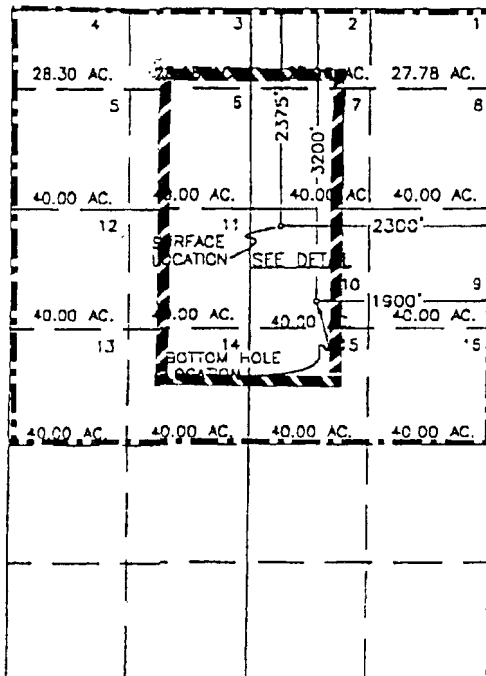

3241.2' 3237.2'
| O |
3235.7' 3229.5'
DETAIL

6-29-00
Do not see a well log

OPERATOR CERTIFICATION

I hereby certify that the information
contained herein is true and complete to the
best of my knowledge and belief.

Joe T. Janica
Signature

Joe T. Janica

Printed Name

Agent

Title

03/16/00

Date

SURVEYOR CERTIFICATION

I hereby certify that the well location shown
on this plat was plotted from field notes of
actual surveys made by me or under my
supervision and that the same is true and
correct to the best of my belief.

FEBRUARY 18, 2000

Date Surveyed DC

Signature & Seal of
Professional Surveyor

Ronald E. Edson
60-110228

Certificate No. RONALD E. EDSON 3239
GARY EDSON 12641
RONALD E. EDSON 12185

EXHIBIT "A"

District I

1625 N. French Dr., Hobbs, NM 88240

District II

1301 W. Grand Avenue, Artesia, NM 88210

District III

1000 Rio Brazos Rd., Aztec, NM 87410

District IV

1220 S. St. Francis Dr., Santa Fe, NM 87505

State of New Mexico

Energy, Minerals & Natural Resources Department

OIL CONSERVATION DIVISION

1220 South St. Francis Dr.

Santa Fe, NM 87505

Form C-102

Revised October 12, 2005

Submit to Appropriate District Office

State Lease - 4 Copies

Fee Lease - 3 Copies

☐ AMENDED REPORT

WELL LOCATION AND ACREAGE DEDICATION PLAT

¹ API Number 30-015-31236	² Pool Code 85640	³ Pool Name Springs; Upper Penn.
⁴ Property Code 28707	⁵ Property Name Springs 2 Federal	⁶ Well Number 1
⁷ OGRID No. 6137	⁸ Operator Name Devon Energy Production Co., L.P.	⁹ Elevation 3225'

¹⁰ Surface Location

UL or lot no.	Section	Township	Range	Lot Idn	Feet from the	North/South line	Feet from the	East/West line	County
LOT 10	2	21S	25E		2375	North	2300	East	Eddy

¹¹ Bottom Hole Location If Different From Surface

UL or lot no.	Section	Township	Range	Lot Idn	Feet from the	North/South line	Feet from the	East/West line	County
LOT 10	2	21S	25E		3200	North	1900	East	Eddy

¹² Dedicated Acres 592	¹³ Joint or Infill	¹⁴ Consolidation Code	¹⁵ Order No.
--------------------------------------	-------------------------------	----------------------------------	-------------------------

No allowable will be assigned to this completion until all interests have been consolidated or a non-standard unit has been approved by the division.

	<p>¹⁷ OPERATOR CERTIFICATION I hereby certify that the information contained herein is true and complete to the best of my knowledge and belief, and that this organization either owns a working interest or unleased mineral interest in the land including the proposed bottom hole location or has a right to drill this well at this location pursuant to a contract with an owner of such a mineral or working interest, or to a voluntary pooling agreement or a compulsory pooling order heretofore entered by the division.</p> <p>Signature: <i>[Signature]</i> Date: 1/23/09</p> <p>Printed Name: Stephanie A. Ysaza</p>
	<p>¹⁸ SURVEYOR CERTIFICATION I hereby certify that the well location shown on this plat was plotted from field notes of actual surveys made by me or under my supervision, and that the same is true and correct to the best of my belief.</p> <p>Date of Survey: _____</p> <p>Signature and Seal of Professional Surveyor: _____</p> <p>See Original Plat for Surveyor Certification</p> <p>Certificate Number: _____</p>

Devon Energy Corporation
Springs 2 Fed 1
2375' FNL & 2300' FEL - SEC 2 – T21S – R25E
Eddy County, NM
 AFE #139626 API # 30-015-31236 WI=100%

Objective: **Recomplete well to Cisco-Canyon.**

Well Data:

Surface Casing:	13-3/8" 48# H-40, STC @ 453' (TOC surface)		
Intermed Casing:	8-5/8" 32# K-55 STC @ 2179' (TOC surface)		
Production Casing:	5-1/2" 17# P-110/N-80 LTC @ 10,850' (TOC 1190' and DV tool @ 7787')		
KB elev:	32xx'	GL elev:	3225'
PBTD:	11,750' (float collar) TD: 10,850'		
Tubing:	259 jts - 2-7/8" 6.5#, N-80 EUE 8rd (EOT 8076')		
TAC:	Set at 7766'		
Existing Perfs:	10,347'-53', 10,386'-92' 10,534'-587' (Morrow)		
Proposed Perfs:	8108'-26' and 8266'-82' (Cisco-Canyon)		

Procedure:

1. RUPU. ND wellhead. NU BOP. Release TAC. POOH. LD TAC.
2. RU wireline truck. RU full lubricator and p-test. Set CIBP at 10,325' and cap with 35' cement after perforating. Perforate Cisco-Canyon with a 3 1/8" gun loaded 3 spf with 120° phasing from 8266'-82' (20') Total 60 holes. RD wireline truck.
3. RIH w/ packer on tubing and set at ~8230' (need to pickup ~155' tubing). ND BOP. NU wellhead. RU swab and swab test.
4. If necessary, stimulate interval with acid frac down tubing as per BJ Services procedure. Take 5, 10, and 15 minutes pressures. RD BJ.
5. RU swab and swab test.
6. If this section of Cisco-Canyon tests wet, RU wireline truck. RU full lubricator and p-test. Set CIBP at ~8230' and cap with 35' cement after perforating. Perforate Cisco-Canyon with 3 1/8" gun loaded 3 spf with 120° phasing from 8108'-26' (18') Total 54 holes. RD wireline truck.
7. RIH w/ packer on tubing and set at ~8070'. ND BOP. NU wellhead. RU swab and swab test.
8. If necessary, stimulate interval with acid frac down tubing as per BJ Services procedure. Take 5, 10, and 15 minutes pressures. RD BJ.
9. RU swab. Swab well on production. RDMO.

PLEASE FOLD THIS SHIPPING DOCUMENT IN HALF AND PLACE IT IN A WAYBILL POUCH AFFIXED TO YOUR SHIPMENT SO THAT THE BARCODE PORTION OF THE LABEL CAN BE READ AND SCANNED. ***WARNING: USE ONLY THE PRINTED ORIGINAL LABEL FOR SHIPPING. USING A PHOTOCOPY OF THIS LABEL FOR SHIPPING PURPOSES IS FRAUDULENT AND COULD RESULT IN ADDITIONAL BILLING CHARGES, ALONG WITH THE CANCELLATION OF YOUR FEDEX ACCOUNT NUMBER.

From Origin ID OKCA (405) 552 7802
Stephanie Ysasaga
DEVON ENERGY CORP
20 N BROADWAY AVE
STE 1500
OKLAHOMA CITY, OK 73102



CL8050107/21/23

Ship Date 25JAN08
ActWgt 1 LB
System# 401491/FXRS0771
Account# S 073102634

Delivery Address Bar Code



SHIP TO (505) 748 1283 BILL SENDER
New Mexico OCD_Artesia

Energy Minerals & Natural Res Dept
1301 W Grand Ave
Artesia, NM 88210

Ref # 123-004
Invoice #
PO #
Dept #

PRIORITY OVERNIGHT

MON

TRK# 7362 5432 4115

FORM
0201Deliver By
28JAN08

LBB AM

88210 -NM-US
DSR

XH ROWA

