

N.M. Oil Cons. Div-Dist. 2  
UNITED STATES  
DEPARTMENT OF THE INTERIOR  
BUREAU OF LAND MANAGEMENT  
1301 W. Grand Avenue  
Artesia, NM 88210FORM APPROVED  
OMB No 1004-0135  
Expires November 30, 2000

## SUNDRY NOTICES AND REPORTS ON WELLS

Do not use this form for proposals to drill or reenter an abandoned well. Use Form 3160-3 (APD) for such proposals.

**SUBMIT IN TRIPLICATE - Other instructions on reverse side**1. Type of Well  
☐ Oil Well ☒ Gas Well ☐ Other2. Name of Operator  
Yates Petroleum Corporation 255753a. Address  
105 South Fourth Street, Artesia, NM 882103b. Phone No. (include area code)  
(575) 748-14714. Location of Well (Footage, Sec., T., R., M., or Survey Description)  
NWNE 660' FNL and 1980' FEL, Unit B  
Sec. 24, T6S-R25E, Mer NMP

5. Lease Serial No.

NM-9982

6. If Indian, Allottee or Tribe Name

7. If Unit or CA/Agreement, Name and/o

29678

8. Well Name and No.

Teckla MD Federal Com #11

9. API Well No.

30-005-63888

10. Field and Pool, or Exploratory Area

Wildcat Precambrian

11. County or Parish, State

Chaves County, New Mexico

## 12. CHECK APPROPRIATE BOX(ES) TO INDICATE NATURE OF NOTICE, REPORT, OR OTHER DATA

TYPE OF SUBMISSION	TYPE OF ACTION			
<input type="checkbox"/> Notice of Intent	<input type="checkbox"/> Acidize	<input type="checkbox"/> Deepen	<input type="checkbox"/> Production (Start/Resume)	<input type="checkbox"/> Water Shut-Off
<input type="checkbox"/> Subsequent Report	<input type="checkbox"/> Alter Casing	<input type="checkbox"/> Fracture Treat	<input type="checkbox"/> Reclamation	<input type="checkbox"/> Well Integrity
<input type="checkbox"/> Final Abandonment Notice	<input type="checkbox"/> Casing Repair	<input type="checkbox"/> New Construction	<input type="checkbox"/> Recomplete	<input checked="" type="checkbox"/> Other Extend
	<input type="checkbox"/> Change Plans	<input type="checkbox"/> Plug and Abandon	<input type="checkbox"/> Temporarily Abandon	APD
	<input type="checkbox"/> Convert to Injection	<input type="checkbox"/> Plug Back	<input type="checkbox"/> Water Disposal	

13. Describe Proposed or Completed Operations (clearly state all pertinent details, including estimated starting date of any proposed work and approximate duration thereof. If the proposal is to deepen directionally or recomple horizontally, give subsurface locations and measured and true vertical depths of all pertinent markers and zones. Attach the Bond under which the work will be performed or provide the Bond No. on file with BLM/BIA. Required subsequent reports shall be filed within 30 days following completion of the involved operations. If the operation results in a multiple completion or recompletion in a new interval, a Form 3160-4 shall be filed once Testing has been completed. Final Abandonment Notices shall be filed only after all requirements, including reclamation, have been completed, and the operator has determined that the site is ready for final inspection.)

Yates Petroleum Corporation wishes to extend the captioned well's APD for two (2) years to January 5, 2010. Sources at Yates Petroleum Corporation have relayed information to me that they believe there will not be enough H<sub>2</sub>S found from the surface through the Basement formation to meet the OCD's requirements for the submission of a contingency plan per Rule 118.

Thank you.

14. I hereby certify that the foregoing is true and correct	
Name (Printed/Typed) Debbie L. Caffall	Title Regulatory Agent/Land Department
Signature <i>Debbie L. Caffall</i>	Email debbiec@ypcnm.
Date December 5, 2007	
THIS SPACE FOR FEDERAL OR STATE USE	
Approved by /s/ Angel Mayes	Title Assistant Field Manager
Conditions of approval, if any, are attached. Approval of this notice does not warrant or certify that the applicant holds legal or equitable title to those rights in the subject lease which would entitle the applicant to conduct operations thereon	Date JAN 08 2008
	Office ROSWELL FIELD OFFICE

Title 18 U.S.C. Section 1001, make it a crime for any person knowingly and willfully to make to any department or agency of the United States any false, fictitious or fraudulent statements or representations as to any matter within its jurisdiction.

(Instructions on reverse)

C-102 attached C-144 attached

16	<div style="position: relative; height: 100px;"> <div style="position: absolute; top: 0; left: 0; transform: rotate(-45deg);">6660'</div> <div style="position: absolute; top: 50%; left: 50%; transform: translate(-50%, -50%);">1980'</div> </div>	NM-9982	NM-51829
<div style="text-align: center;"> <b>17 OPERATOR CERTIFICATION</b>  <i>I hereby certify that the information contained herein is true and complete to the best of my knowledge and belief, and that this organization either owns a working interest or unleased mineral interest in the land including the proposed bottom hole location or has a right to drill this well at this location pursuant to a contract with an owner of such a mineral or working interest, or to a voluntary pooling agreement or a compulsory pooling order heretofore entered by the division.</i> </div>			
<div style="border-bottom: 1px solid black; display: inline-block; width: 100%;"> <i>Debbie L. Caffall</i>            Signature         </div>		<div style="border-bottom: 1px solid black; display: inline-block; width: 100%;">           1/19/2007            Date         </div>	
<div style="border-bottom: 1px solid black; display: inline-block; width: 100%;">           Debbie L. Caffall, Regulatory Agent            Printed Name         </div>			
<div style="text-align: center;"> <b>18 SURVEYOR CERTIFICATION</b>  <i>I hereby certify that the well location shown on this plat was plotted from field notes of actual surveys made by me or under my supervision, and that the same is true and correct to the best of my belief.</i> </div>			
<div style="border-bottom: 1px solid black; display: inline-block; width: 100%;">           Date of Survey         </div>			
<div style="border-bottom: 1px solid black; display: inline-block; width: 100%;">           Signature and Seal of Professional Surveyor         </div>			
<div style="border-bottom: 1px solid black; display: inline-block; width: 100%;">           REFER TO ORIGINAL PLAT         </div>			
<div style="border-bottom: 1px solid black; display: inline-block; width: 100%;">           Certificate Number         </div>			

District I  
1627 N. Branch Dr., Hobbs, NM 88240  
District II  
301 W. Grand Avenue, Artesia, NM 88210  
District III  
1000 Rio Grande Road, Aztec, NM 87410  
District IV  
1220 S. St. Francis Dr., Santa Fe, NM 87505

State of New Mexico  
Energy Minerals and Natural Resources  
Oil Conservation Division  
1220 South St. Francis Dr.  
Santa Fe, NM 87505

WF  
Well  
Form C-144  
March 12, 2004  
For drilling and production facilities, submit to appropriate NMOC District Office.  
For downstream facilities, submit to Santa Fe office

105 South Fourth Street, Artesia, NM 88210

**Pit or Below-Grade Tank Registration or Closure**

RECEIVED

OCT 21 2004

OC-D-ARTESIA

Is pit or below-grade tank covered by a "general plan"? Yes ☒ CheckBox

Type of action: Registration of a pit or below-grade tank ☒ Closure of a pit or below-grade tank ☐

Operator: Yates Petroleum Corporation Telephone: 505-748-4378 e-mail address: debbiec@ynpcnm.com  
Address: 104 South 4<sup>th</sup> Street, Artesia, New Mexico 88210 30-005-63888  
Facility or well name: Teckla MD Federal Com. #11 API #: U/L or Qtr/Qtr NWNE Sec 24 T 6S R 25E  
County: Chaves Latitude Longitude NAD: 1927 ☐ 1983 ☐ Surface Owner: Federal ☒ State ☐ Private ☐ Indian ☐

<b>Pit</b> Type: Drilling <input checked="" type="checkbox"/> Production <input type="checkbox"/> Disposal <input type="checkbox"/> Workover <input type="checkbox"/> Emergency <input type="checkbox"/> Lined <input checked="" type="checkbox"/> Unlined <input type="checkbox"/> Liner type: Synthetic <input checked="" type="checkbox"/> Thickness 12 mil Clay <input type="checkbox"/> Volume bbl		<b>Below-grade tank</b> Volume: bbl Type of fluid: Construction material: Double-walled, with leak detection? Yes <input type="checkbox"/> If not, explain why not.	
Depth to ground water (vertical distance from bottom of pit to seasonal high water elevation of ground water.)	Less than 50 feet	(20 points)	
	50 feet or more, but less than 100 feet	(10 points)	
	100 feet or more	( 0 points)	
Wellhead protection area: (Less than 200 feet from a private domestic water source, or less than 1000 feet from all other water sources.)	Yes	(20 points)	
	No	( 0 points)	
Distance to surface water: (horizontal distance to all wetlands, playas, irrigation canals, ditches, and perennial and ephemeral watercourses.)	Less than 200 feet	(20 points)	
	200 feet or more, but less than 1000 feet	(10 points)	
	1000 feet or more	( 0 points)	
Ranking Score (Total Points)		0	

**If this is a pit closure:** (1) attach a diagram of the facility showing the pit's relationship to other equipment and tanks. (2) Indicate disposal location: onsite ☐ offsite ☐ If offsite, name of facility. (3) Attach a general description of remedial action taken including remediation start date and end date. (4) Groundwater encountered: No ☐ Yes ☐ If yes, show depth below ground surface ft. and attach sample results. (5) Attach soil sample results and a diagram of sample locations and excavations.

I hereby certify that the information above is true and complete to the best of my knowledge and belief. I further certify that the above-described pit or below-grade tank has been constructed or closed according to NMOC District guidelines ☐, a general permit ☐, or an (attached) alternative OCD-approved plan ☐.

Date: 10/20/2004  
Printed Name/Title: Robert Asher/Regulatory Agent Signature: [Signature]

My certification and NMOC District approval of this application/closure does not relieve the operator of liability should the contents of the pit or tank contaminate ground water or otherwise endanger public health or the environment. Nor does it relieve the operator of its responsibility for compliance with any other federal, state, or local laws and/or regulations.

Approval: OCT 21 2004 [Signature]  
Date: [Signature]  
Printed Name/Title: [Signature] Signature: [Signature]

# EXHIBIT A

12-12-07

OPERATOR: Yates Petroleum Corporation

BLM LEASE NUMBER: NM-9982

WELL NAME & NO.: Teckla "MD" Federal Com. #11

LOCATION: SECTION 24, T. 6 S., R. 25 E.

QUARTER/QUARTER & FOOTAGE: NW¼NE¼, - 660' FNL & 1980' FEL

COUNTY: Chaves County New Mexico

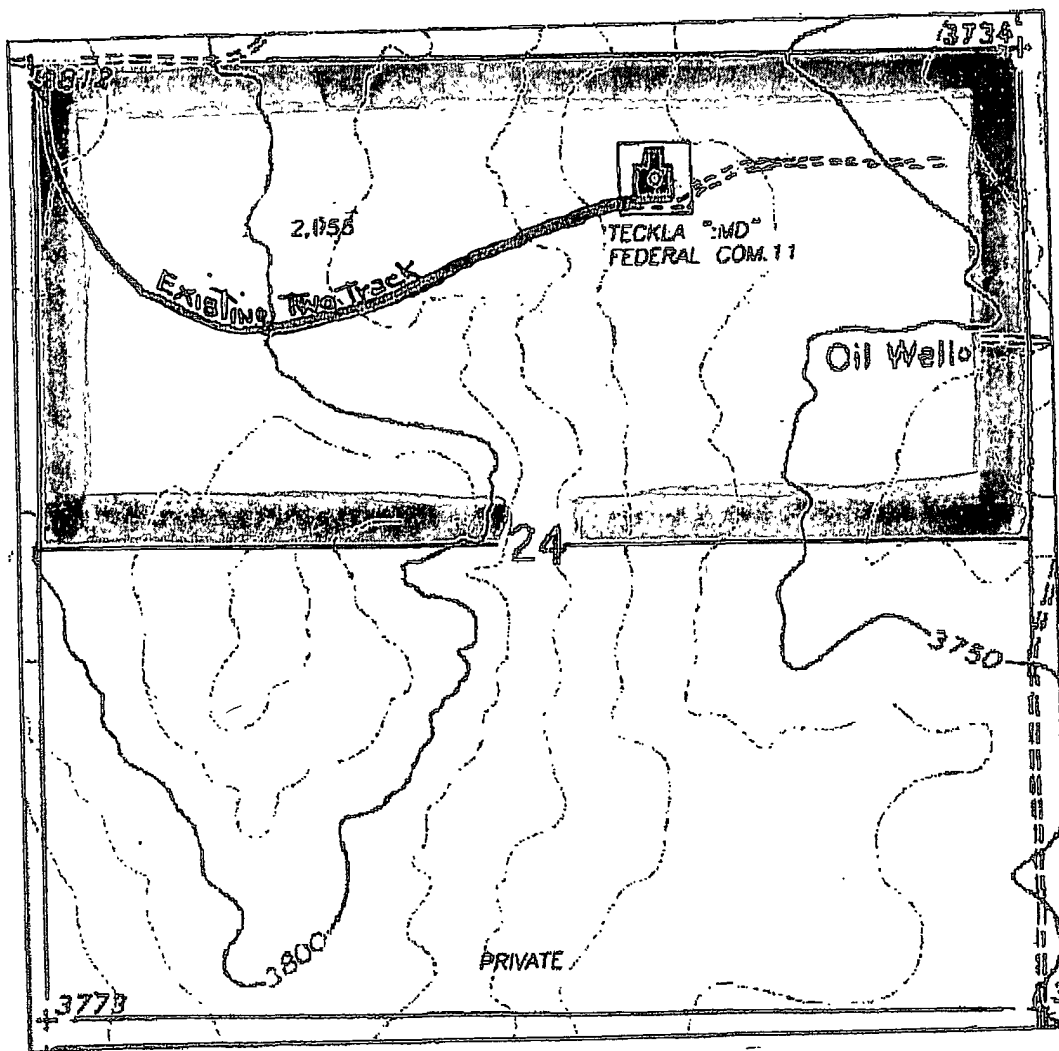

62

# **PECOS DISTRICT - RFO**

## **CONDITIONS OF APPROVAL**

12/12/07

OPERATORS NAME: Yates Petroleum Corporation  
LEASE NO.: NM-9982  
WELL NAME & NO: Teckla "MD" Federal Com. #11  
SURFACE HOLE FOOTAGE: 660' FNL & 1980' FEL  
LOCATION: Section 24, T. 6 S., R. 25 E., NMPM  
COUNTY: Chaves County, New Mexico

### **GENERAL PROVISIONS**

The approval of the Application For Permit To Drill (APD) is in compliance with all applicable laws and regulations: 43 Code of Federal Regulations 3160, the lease terms, Onshore Oil and Gas Orders, Notices To Lessees, New Mexico Oil Conservation Division (NMOCD) Rules, National Historical Preservation Act As Amended, and instructions and orders of the Authorized Officer. Any request for a variance shall be submitted to the Authorized Officer on Form 3160-5, Sundry Notices and Report on Wells.

### **I. PERMIT EXPIRATION**

If the permit terminates prior to drilling and drilling cannot be commenced within 60 days after expiration, an operator is required to submit Form 3160-5, Sundry Notices and Reports on Wells, requesting surface reclamation requirements for any surface disturbance. However, if the operator will be able to initiate drilling within 60 days after the expiration of the permit, the operator must have set the conductor pipe in order to allow for an extension of 60 days beyond the expiration date of the APD (Filing of a Sundry Notice is required for this 60 day extension).

### **II. ARCHAEOLOGICAL, PALEONTOLOGY & HISTORICAL SITES**

Any cultural and/or paleontological resource discovered by the operator or by any person working on the operator's behalf shall immediately report such findings to the Authorized Officer. The operator is fully accountable for the actions of their contractors and subcontractors. The operator shall suspend all operations in the immediate area of such discovery until written authorization to proceed is issued by the Authorized Officer. An evaluation of the discovery shall be made by the Authorized Officer to determine the appropriate actions that shall be required to prevent the loss of significant cultural or scientific values of the discovery. The operator shall be held responsible for the cost of the proper mitigation measures that the Authorized Officer assesses after consultation with the operator on the evaluation and decisions of the discovery. Any unauthorized collection or disturbance of cultural or paleontological resources may result in a shutdown order by the Authorized Officer.

### **III. NOXIOUS WEEDS**

The operator shall be held responsible if noxious weeds become established within the areas of operations (access road and/or well pad). Weed control shall be required on the disturbed land where noxious weeds exist, which includes the roads, pads, associated pipeline corridor, and adjacent land affected by the establishment of weeds due to this action. The operator shall consult with the Authorized Officer for acceptable weed control methods, which include following EPA and BLM requirements and policies.

### **IV. CONSTRUCTION**

#### **A. NOTIFICATION:**

The BLM shall administer compliance and monitor construction of the access road and well pad. Notify the Roswell Field Office at (505) 627-0247 at least 3 working days prior to commencing construction of the access road and/or well pad.

When construction operations are being conducted on this well, the operator shall have the approved Application for Permit to Drill and Conditions of Approval on the well site and they shall be made available upon request by the Authorized Officer.

#### **B. TOPSOIL:**

The operator shall stockpile the topsoil of the well pad. The topsoil to be stripped is approximately 6 inches in depth. The topsoil shall not be used to backfill the reserve pit and will be used for interim and final reclamation. The soil shall be stockpiled in the southeast corner of the well pad.

#### **C. RESERVE PITS:**

The reserve pit shall be constructed and closed in accordance with the NMOCD rules.

The reserve pit shall be constructed 175' X 150' on the NORTH side of the well pad.

The reserve pit shall be constructed, so that upon completion of drilling operations, the dried pit contents shall be buried a minimum depth of three feet below ground level. Should the pit content level not meet the three foot minimum depth requirement, the excess contents shall be removed until the required minimum depth of three feet below ground level has been met. The operator shall properly dispose of the excess contents at an authorized disposal site.

The reserve pit shall be constructed and maintained so that runoff water from outside the location is not allowed to enter the pit. The berms surrounding the entire perimeter of the pit shall extend a minimum of two (2) feet above ground level. At no time will standing fluids in the pit be allowed to rise above ground level.

The reserve pit shall be fenced on three (3) sides during drilling operations. The fourth side shall be fenced immediately upon rig release.

#### **D. FEDERAL MINERAL MATERIALS PIT:**

If the operator elects to surface the access road and/or well pad, mineral materials extracted during construction of the reserve pit may be used for surfacing the well pad and access road and other facilities on the lease.

Payment shall be made to the BLM prior to removal of any additional federal mineral materials from any site other than the reserve pit. Call the Roswell Field Office at (505) 627-0236.

#### **E. WELL PAD SURFACING:**

Surfacing of the well pad is not required.

If the operator elects to surface the well pad, the surfacing material may be required to be removed at the time of reclamation.

The well pad shall be constructed in a manner which creates the smallest possible surface disturbance, consistent with safety and operational need.

#### **F. ON LEASE ACCESS ROADS:**

##### **Road Width**

The access road shall have a driving surface that creates the smallest possible surface disturbance and does not exceed fourteen (14) feet in width. The maximum width of surface disturbance, when constructing the access road, shall not exceed thirty (30) feet.

##### **Surfacing**

Surfacing material is not required on the new access road driving surface. If the operator elects to surface the new access road or pad, the surfacing material may be required to be removed at the time of reclamation.

Where possible, no improvements should be made on the unsurfaced access road other than to remove vegetation as necessary, road irregularities, safety issues, or to fill low areas that may sustain standing water.

The Authorized Officer reserves the right to require surfacing of any portion of the access road at any time deemed necessary. Surfacing may be required in the event the road deteriorates, erodes, road traffic increases, or it is determined to be beneficial for future field development. The surfacing depth and type of material will be determined at the time of notification.

##### **Crowning**

Crowning shall be done on the access road driving surface. The road crown shall have a grade of approximately 2% (i.e., a 1" crown on a 14' wide road). The road shall conform to Figure 1; cross section and plans for typical road construction.

## Turnouts

Vehicle turnouts shall be constructed on the road. Turnouts shall be intervisible with interval spacing distance less than 1000 feet. Turnouts shall be constructed on all blind curves. Turnouts shall conform to the following diagram:

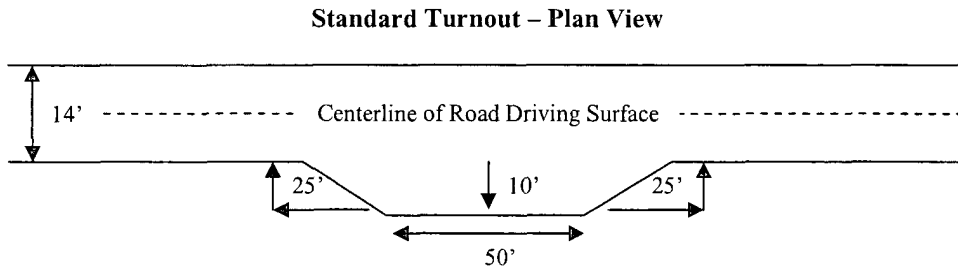

## Drainage

Drainage control systems shall be constructed on the entire length of road (e.g. ditches, sidehill outsloping and insloping, lead-off ditches, culvert installation, and low water crossings).

A typical lead-off ditch has a minimum depth of 1 foot below and a berm of 6 inches above natural ground level. The berm shall be on the down-slope side of the lead-off ditch.

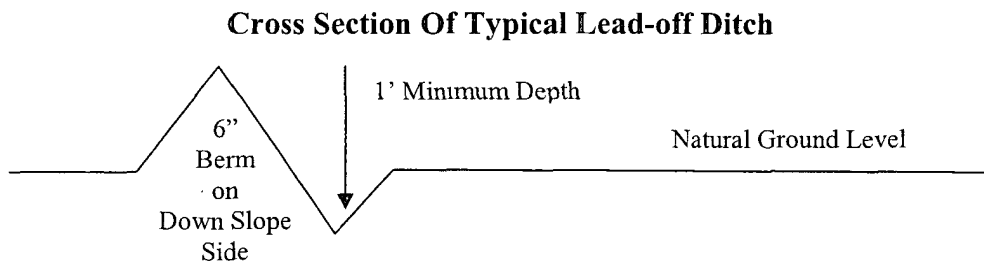

All lead-off ditches shall be graded to drain water with a 1 percent minimum to 3 percent maximum ditch slope. The spacing interval are variable for lead-off ditches and shall be determined according to the formula for spacing intervals of lead-off ditches, but may be amended depending upon existing soil types and centerline road slope (in %);

### Formula For Spacing Interval Of Lead-off Ditches

Example - On a 4% road slope that is 400 feet long, the water flow shall drain water into a lead-off ditch. Spacing interval shall be determined by the following formula:

$$400 \text{ foot road with } 4\% \text{ road slope: } \frac{400'}{4\%} + 100' = 200' \text{ lead-off ditch interval}$$

## Public Access

Public access on this road shall not be restricted by the operator without specific written approval granted by the Authorized Officer.

**Figure 1 – Cross Sections and Plans For Typical Road Sections**

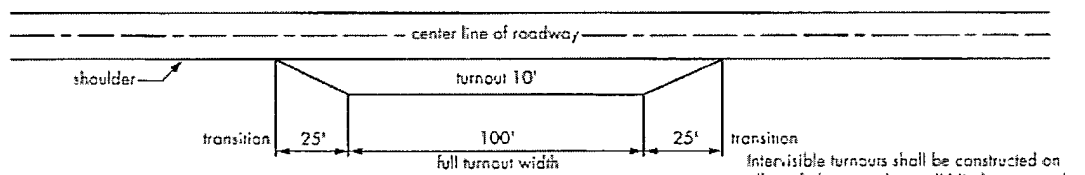

**Typical Turnout Plan**

Intervisible turnouts shall be constructed on all single lane roads on all blind curves with additional turnouts as needed to keep spacing below 1000 feet.

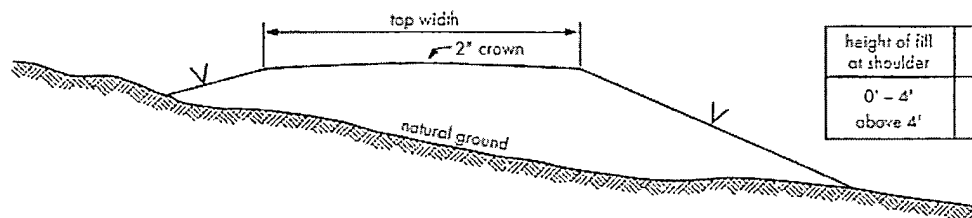

height of fill at shoulder	embankment slope
0' - 4'	3:1
above 4'	2:1

**Embankment Section**

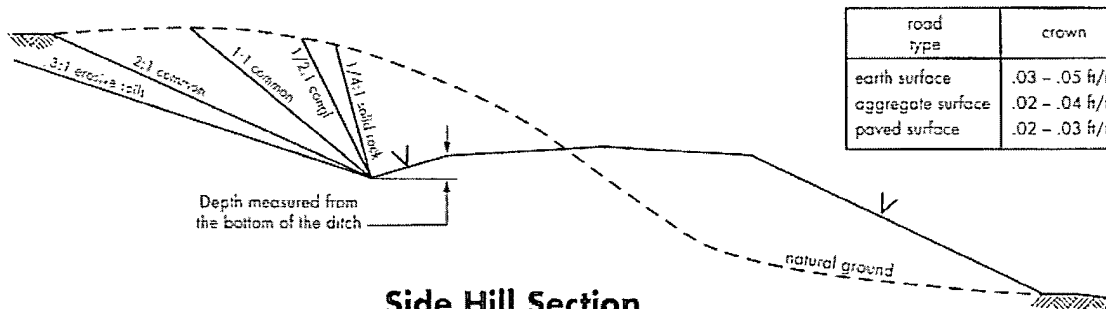

**Side Hill Section**

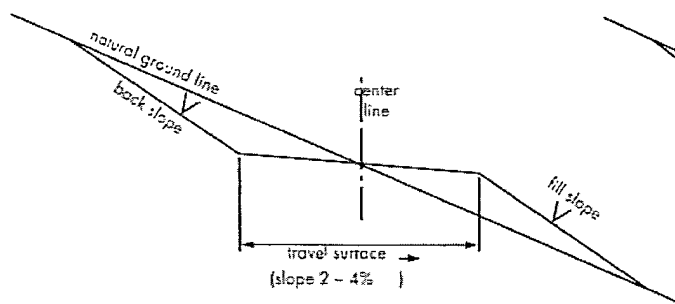

**Typical Outsloped Section**

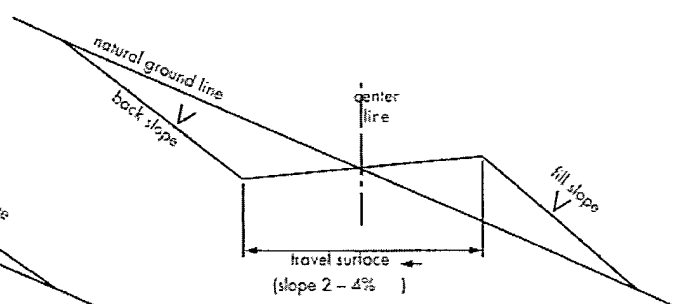

**Typical Insloped Section**

## V. DRILLING

### A. DRILLING OPERATIONS REQUIREMENTS

1. The Bureau of Land Management (BLM) is to be notified at the Roswell Field Office, 2909 West Second St., Roswell NM 88201, 24 hour 505 – 627 - 0205, in sufficient time for a representative to witness:

A. Spudding

B. Cementing casing: 11¾ inch 8⅝ inch 5½ inch

C. BOP tests

2. Unless the production casing has been run and cemented or the well has been properly plugged, the drilling rig shall not be removed from over the hole without prior approval.

3. Submit a Sundry Notice (Form 3160-5, one original and five copies) for each casing string, describing the casing and cementing operations. Include pertinent information such as; spud date, hole size, casing ( size, weight, grade and thread type), cement (type, quantity and top), water zones and problems or hazards encountered. The Sundry shall be submitted within 15 days of completion of each casing string. The reports may be combined into the same Sundry if they fall within the same 15 day time frame.

4. The API No. assigned to the well by NMOCD shall be included on the subsequent report of setting the first casing string.

5. A Communitization Agreement covering the acreage dedicated to this well must be filed for approval with the BLM. The effective date of the agreement shall be prior to any sales.

### B. CASING

1. The 11¾ inch surface casing shall be set at 900 FT and cement circulated to the surface. If cement does not circulate to the surface the appropriate BLM office shall be notified and a temperature survey or cement bond log shall be run to verify the top of the cement. Remedial cementing shall be completed prior to drilling out that string.

2. The minimum required fill of cement behind the 8⅝ inch intermediate casing is to be sufficient to bring top of cement at least 200 feet above shoe.

3. The minimum required fill of cement behind the 5½ inch production casing is cement shall extend upward a minimum of 500 feet above the uppermost perforation.

### C. PRESSURE CONTROL

1. All BOP systems and related equipment shall comply with well control requirements as described in Onshore Oil and Gas Order No. 2. The BOP and related equipment shall be installed and operational before drilling below the 11¾ inch casing shoe and shall be tested as described in Onshore Order No. 2. Any equipment failing to test satisfactorily shall be repaired or replaced.

2. Minimum working pressure of the blowout preventer and related equipment (BOPE) shall be 2000 psi.

3. The appropriate BLM office shall be notified in sufficient time for a representative to witness the tests.

- A. The results of the test shall be reported to the appropriate BLM office.
- B. Testing fluid must be water or an appropriate clear liquid suitable for sub-freezing temperatures. Use of drilling mud for testing is not permitted since it can mask small leaks.
- C. Testing must be done in a safe workman-like manner. Hard line connections shall be required.
- D. BOPE shall be tested prior to drilling into the Wolfcamp Formation.

#### **D. DRILLING MUD**

Mud system monitoring equipment, with derrick floor indicators and visual and audio alarms, shall be operating before drilling into the Wolfcamp formation, and shall be used until production casing is run and cemented. Monitoring equipment shall consist of the following:

- Recording pit level indicator to indicate volume gains and losses.
- Mud measuring device for accurately determining the mud volumes necessary to fill the hole during trips.
- Flow sensor on the flow line to warn of abnormal mud returns from the well.

### **VI. PRODUCTION**

#### **A. WELL STRUCTURES & FACILITIES**

##### **Placement of Production Facilities**

Production facilities should be placed on the well pad to allow for maximum interim recontouring and revegetation of the well location.

##### **Containment Structures**

The containment structure shall be constructed to hold the capacity of the entire contents of the largest tank, plus 24 hour production, unless more stringent protective requirements are deemed necessary by the Authorized Officer.

##### **Painting Requirement**

All above-ground structures including meter housing that are not subject to safety requirements shall be painted a flat non-reflective paint color, Olive Drab, Munsell Soil Color Chart 18-0622 TPX.

## VII. INTERIM RECLAMATION & RESERVE PIT CLOSURE

### A. INTERIM RECLAMATION

If the well is a producer, interim reclamation shall be conducted on the well site in accordance with the orders of the Authorized Officer. The operator shall submit a Sundry Notices and Reports on Wells (Notice of Intent), Form 3160-5, prior to conducting interim reclamation.

During the life of the development, all disturbed areas not needed for active support of production operations should undergo "interim" reclamation in order to minimize the environmental impacts of development on other resources and uses.

During reclamation, the removal of caliche is important to increasing the success of revegetating the site. Removed caliche may be used in road repairs, fire walls or for building other roads and locations. In addition, in order to operate the well or complete workover operations, it may be necessary to drive, park and operate on restored interim vegetation within the previously disturbed area. Disturbing revegetated areas for production or workover operations will be allowed. If there is significant disturbance and loss of vegetation, the area will need to be revegetated. Communicate with the appropriate BLM office for any exceptions/exemptions if needed.

### B. RESERVE PIT CLOSURE

At the time reserve pits are to be reclaimed, operators should work with BLM surface management specialists to devise the best strategies to reduce the size of the location. Any reductions should allow for remedial well operations, as well as safe and efficient removal of oil and gas.

The reserve pit, when dried and closed, shall be recontoured, all trash removed, and reseeded as follows:

Alama silt loam, dry, 0-3% Slope; Hollomex loam, 1-9% slope, dry; Reeves loam, 0-2% slope, dry; Milner loam, 0-2% slope, dry

#### Loamy, SD-3 for CP-2 Loamy Ecological Site

<u>Common Name and Preferred Variety</u>	<u>Scientific Name</u>	<u>Pounds of Pure Live Seed Per Acre</u>
Blue grama, var. Lovington	( <i>Bouteloua gracilis</i> )	4.00 Lbs.
Sideoats grama, var. Vaughn or El Reno	( <i>Bouteloua curtipendula</i> )	1.00 Lb.
Sand dropseed	( <i>Sporobolus cryptandrus</i> )	0.50 Lb.
Vine mesquite	( <i>Panicum obtusum</i> )	1.00 Lb.
Plains bristlegrass	( <i>Setaria macrostachya</i> )	1.00 Lb.
Indian blanketflower	( <i>Gaillardia aristata</i> )	0.50 Lb.
Desert or Scarlet	( <i>Sphaeralcea ambigua</i> )	
Globemallow	or ( <i>S. coccinea</i> )	1.00 Lb.
TOTAL POUNDS PURE LIVE SEED PER ACRE		9.00 Lbs.

If one species is not available, increase ALL others proportionately. Certified Weed Free Seed. A minimum of 4 species is required, including 1 forb species.

## **VIII. FINAL ABANDONMENT & REHABILITATION REQUIREMENTS**

Upon abandonment of the well and/or when the access road is no longer in service the Authorized Officer shall issue instructions and/or orders for surface reclamation and restoration of all disturbed areas.

On private surface/federal mineral estate land the reclamation procedures on the road and well pad shall be accomplished in accordance with the Private Surface Land Owner agreements.