

UNITED STATES
DEPARTMENT OF THE INTERIOR
BUREAU OF LAND MANAGEMENT

S **OCD-ARTESIA**

FORM APPROVED
OMB No 1004-0137
Expires March 31, 2007

SUNDRY NOTICES AND REPORTS ON WELLS
Do not use this form for proposals to drill or to re-enter an abandoned well. Use Form 3160-3 (APD) for such proposals.

5 Lease Serial No
NM 354232
6. If Indian, Allottee or Tribe Name

SUBMIT IN TRIPLICATE – Other instructions on page 2.

1 Type of Well

☐ Oil Well ☒ Gas Well ☐ Other

MAY - 6 2008

2. Name of Operator
Devon Energy Production Co., LP

OCD-ARTESIA

3a. Address
20 North Broadway
OKC, OK 73102

3b. Phone No. (include area code)
(405)-552-7802

7. If Unit of CA/Agreement, Name and/or No

8. Well Name and No.
Pioneer Federal Com 1

9 API Well No.
30-015-24777

10. Field and Pool or Exploratory Area
La Huerta; Atoka/Strawn

4. Location of Well (Footage, Sec, T, R, M, or Survey Description)
1980' FNL & 1740' FEL
Sec 19-T21S-R27E

11. Country or Parish, State
Eddy County, NM

12 CHECK THE APPROPRIATE BOX(ES) TO INDICATE NATURE OF NOTICE, REPORT OR OTHER DATA

TYPE OF SUBMISSION	TYPE OF ACTION			
<input checked="" type="checkbox"/> Notice of Intent	<input type="checkbox"/> Acidize	<input type="checkbox"/> Deepen	<input type="checkbox"/> Production (Start/Resume)	<input type="checkbox"/> Water Shut-Off
<input type="checkbox"/> Subsequent Report	<input type="checkbox"/> Alter Casing	<input type="checkbox"/> Fracture Treat	<input type="checkbox"/> Reclamation	<input type="checkbox"/> Well Integrity
<input type="checkbox"/> Final Abandonment Notice	<input type="checkbox"/> Casing Repair	<input type="checkbox"/> New Construction	<input type="checkbox"/> Recomplete	<input checked="" type="checkbox"/> Other Plugback to Canyon Zone
	<input type="checkbox"/> Change Plans	<input type="checkbox"/> Plug and Abandon	<input type="checkbox"/> Temporarily Abandon	
	<input type="checkbox"/> Convert to Injection	<input checked="" type="checkbox"/> Plug Back	<input type="checkbox"/> Water Disposal	

13 Describe Proposed or Completed Operation: Clearly state all pertinent details, including estimated starting date of any proposed work and approximate duration thereof. If the proposal is to deepen directionally or recompleat horizontally, give subsurface locations and measured and true vertical depths of all pertinent markers and zones. Attach the Bond under which the work will be performed or provide the Bond No. on file with BLM/BIA. Required subsequent reports must be filed within 30 days following completion of the involved operations. If the operation results in a multiple completion or recompleat in a new interval, a Form 3160-4 must be filed once testing has been completed. Final Abandonment Notices must be filed only after all requirements, including reclamation, have been completed and the operator has determined that the site is ready for final inspection.)

Devon Energy Production Company, L.P. respectfully requests approval to recompleat to the Canyon from the Atoka/Strawn:

- * See attached plugback procedure
- * BOP to be used; No H2S is anticipated to be encountered
- * Will submit completion report if well if found productive; or subsequent report if well is found not productive

Notes:

- * CIBP will be set @ 11,550' & 10,230' to isolate Atoka & Morrow perforations.
- * Well has not had production since 05/2007; bringing well back into production will keep well off NMOCID Inactive Well List.

** Return well to production by 7/3/08 or submit plans for abandonment*

14 I hereby certify that the foregoing is true and correct

Name (Printed/Typed)
Stephanie A. Ysasaga

Title Sr. Staff Engineering Technician

Date 04/25/2008

Approved by

THIS SPACE FOR FEDERAL OR STATE OFFICE USE

Title

Office

Date

APPROVED

MAY 3 2008

**JAMES A. AMOS
SUPERVISOR EPS**

Conditions of approval, if any, are attached. Approval of this notice does not warrant or certify that the applicant holds legal or equitable title to those rights in the subject lease which would entitle the applicant to conduct operations thereon

Title 18 U S C Section 1001 and Title 43 U S C Section 1212, make it a crime for any person knowingly and willfully to make to any department or agency of the United States any false, fictitious or fraudulent statements or representations as to any matter within its jurisdiction

(Instructions on page 2)

Accepted for record - NMOCID

Devon Energy Corporation
Pioneer Federal 1
1980' FNL & 1740' FEL - SEC 19 – T21S – R27E
Eddy County, NM
 AFE #141840 API # 30-015-24777 WI= ~70%

Objective: **Recomplete well to Canyon from Strawn/Atoka.**

Well Data:

Surface Casing: 13-3/8" 48# H-40 STC @ 517' (TOC surface)
 Intermed Casing: 8-5/8" 24/32# J-55 LTC @ 2609' (TOC surface)
 Prod Casing: 4 1/2" 11.6/13.5# J-55/N-80 @ 11,500' (Repair at ~2460')
 KB elev: 3209' GL elev: 3181' TD: 11,500' Drilled: 1984
 PBDT: 11,105' (CIBP@11,150' w/45' cmt) 11,458' (Float shoe)
 Tubing: 334 jts - 2-3/8" 4.7#, N-80 EUE 8rd (EOT ~10,250')
 Packer: Model "R" at 10,218' (one jt tubing and sn below pkr)
 Squeezed Perfs: 5410' (950 sxs) tested to 3500 psig.
 8110' (750 sxs) – might be leaking.
 8952'-60' (75 sxs) Wolfcamp perfs.
 Open Perfs: 10,258'-63, 10,266'-71', and 10,273'-77' Strawn
 10,574'-80', and 10,588'-93' Atoka

Proposed Perfs: 9,792'-98' and 9,864'-70' Canyon

Procedure:

1. RUPU. ND Tree. NU BOP. Release packer. POOH w/ tubing and packer.
2. RU wireline truck. RU full lubricator and p-test. Set CIBP at ~11,550' and ~10,230'. Cap each with 35' cement. Perforate Canyon with 3 1/8" guns loaded 3 spf 120° phasing as follows: 9,792'-98' (6') and 9,864'-70' (6'). Total 12' and 36 holes.
 Note: Correlate to Schlumberger Platform Express log dated 5/19/84.
3. RIH w/ 4 1/2" packer on 2 3/8" tubing to ~9,760'. ND BOP. NU tree. RU swab and swab well dry.
4. RU BJ Services. Test lines. Stimulate Canyon as per BJ Services procedure. Take 5, 10, and 15 minute pressures. RD BJ.
5. Swab/flow test well on production.
6. RDMO.

NEW MEXICO OIL CONSERVATION COMMISSION
WELL LOCATION AND ACREAGE DEDICATION AT

Form 2-196
Supersedes 2-122
Effective 1-1-83

All distances must be from the outer boundaries of the Section

DEVON ENERGY PRODUCTION CO., LP - 6137

PIONEER FEDERAL COM

G 19 21S 27E EDDY

1980 NORTH 1740 EAST

3181.5 STRAWN/ATOKA CANYON 320

- Outline the acreage dedicated to the subject well by colored pencil or hatchure marks on the plat below.
- If more than one lease is dedicated to the well, outline each and identify the ownership thereof (both as to working interest and royalty)
- If more than one lease of different ownership is dedicated to the well, have the interests of all owners been consolidated by communitization, unitization, force-pooling, etc?

☐ Yes ☒ No If answer is "yes," type of consolidation TO BE COMMUNITIZED

If answer is "no," list the owners and tract descriptions which have actually been consolidated. (Use reverse side of this form if necessary)

No allowable will be assigned to the well until all interests have been consolidated (by communitization, unitization, force-pooling, or otherwise) or until a non-standard unit, eliminating such interests, has been approved by the Commission.

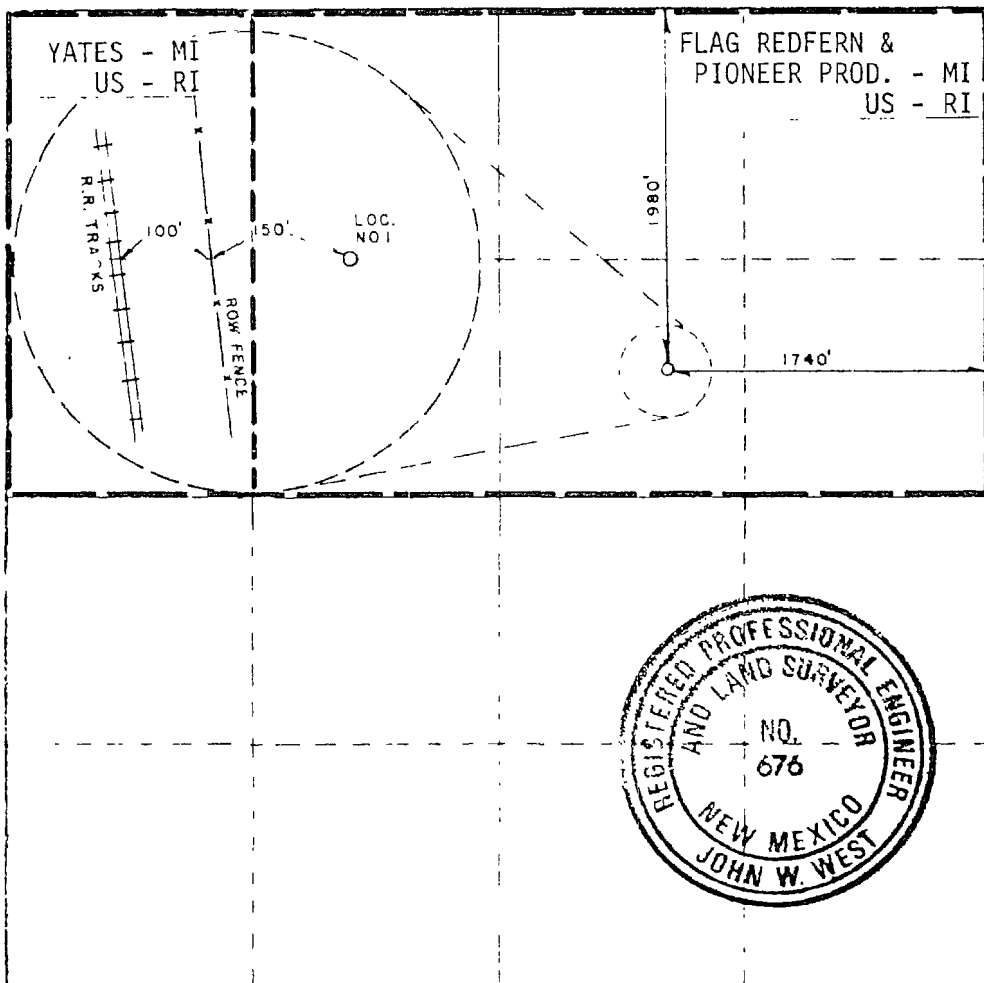

CERTIFICATION

I hereby certify that the information contained herein is true and complete to the best of my knowledge and belief

STEPHANIE A. YSASAGA

SR. STAFF ENG TECH

DEVON ENERGY PRODUCTION CO., LP

04/25/08

I hereby certify that the well location shown on this plat was plotted from field notes of actual surveys made by me or under my supervision and that the same is true and correct to the best of my knowledge and belief

11/29/83

Registered Professional Engineer
Minimum Requirements

Certificate No. JOHN W. WEST, 676
RONALD J. EIDSON, 3239