

## District I

1625 N. French Dr., Hobbs, NM 88240

## District II

1301 W. Grand Avenue, Artesia, NM 88210

## District III

1000 Rio Brazos Road, Aztec, NM 87410

## District IV

1220 S. St. Francis Dr., Santa Fe, NM 87505

State of New Mexico  
Energy Minerals and Natural Resources

Form C-101

May 27, 2004

## Oil Conservation Division

1220 South St. Francis Dr.

Santa Fe, NM 87505

Submit to appropriate District Office

☐ AMENDED REPORT

## APPLICATION FOR PERMIT TO DRILL, RE-ENTER, DEEPEN, PLUGBACK, OR ADD A ZONE

Operator Name and Address RKI EXPLORATION & PRODUCTION, LLC. 3817 NW EXPRESSWAY SUITE 950 OKLAHOMA CITY, OKLAHOMA 73112		OGRID Number 246289
Property Code 303271	Property Name PINNACLE STATE	API Number 30-015-36333
Proposed Pool 1 Culebra Bluff - BONE SPRING S-15011		Well No. 25
Proposed Pool 2		

## Surface Location

UL or lot no. M	Section 36	Township 22 S	Range 28E	Lot Idn	Feet from the 330'	North/South line SOUTH	Feet from the 800'	East/West line WEST	County EDDY
--------------------	---------------	------------------	--------------	---------	-----------------------	---------------------------	-----------------------	------------------------	----------------

## Proposed Bottom Hole Location If Different From Surface

UL or lot no.	Section	Township	Range	Lot Idn	Feet from the	North/South line	Feet from the	East/West line	County
---------------	---------	----------	-------	---------	---------------	------------------	---------------	----------------	--------

## Additional Well Information

Work Type Code N	Well Type Code RO	Cable/Rotary ROTARY	Lease Type Code S	Ground Level Elevation 3066'
Multiple NO	Proposed Depth 7070	Formation BONE SPRING	Contractor PERMIAN DRILLING	Spud Date WHEN APPROVED
Depth to Groundwater 50' ±		Distance from nearest fresh water well UNKNOWN		Distance from nearest surface water APPROXIMATELY 2 miles PECOS R.
Pit: Liner: Synthetic <input type="checkbox"/> _____ mils thick Clay <input type="checkbox"/> Pit Volume: _____ bbls Drilling Method: _____ Closed-Loop System <input checked="" type="checkbox"/> Fresh Water <input checked="" type="checkbox"/> Brine <input checked="" type="checkbox"/> Diesel/Oil-based <input type="checkbox"/> Gas/Air <input type="checkbox"/>				

## Proposed Casing and Cement Program

Hole Size	Casing Size	Casing weight/foot	Setting Depth	Sacks of Cement	Estimated TOC
17 1/2"	14"	Conductor	80'	Redi-mix	Surface
11"	8 5/8"	32#	450'	181 Sx.	Surface
7 7/8"	5 1/2"	17#	7070'	541 Sx	Surface

Describe the proposed program. If this application is to DEEPEN or PLUG BACK, give the data on the present productive zone and proposed new productive zone. Describe the blowout prevention program, if any. Use additional sheets if necessary.

SEE ATTACHED SHEET

**NOTE:** New Pit Rule  
NMAC 19-15-17

I hereby certify that the information given above is true and complete to the best of my knowledge and belief. I further certify that the drilling pit will be constructed according to NMOCD guidelines <input checked="" type="checkbox"/> , a general permit <input type="checkbox"/> , or an (attached) alternative OCD-approved plan <input type="checkbox"/> .		OIL CONSERVATION DIVISION Approved by: <i>Don W. Green</i> District II Supervisor	
Printed name: Joe T. Janica Title: Permit Engineer		Approval Date: 5/21/08 Expiration Date: 5/22/10	
E-mail Address: joejanica@valornet.com		Conditions of Approval Attached <input type="checkbox"/>	
Date: 05/16/08 Phone: 575-391-8503		Date: 5/21/08	

1. Drill 17½" hole to 80'. Set 80' of 14" conductor pipe and cement to surface with Redi-mix.
2. Drill 11" hole to 450'. Run and set 450' of 8 5/8" 32# J-55 ST&C casing. Cement with 181 Sx. of Class "C" cement + 2% CaCl<sub>2</sub> + .125# Flocele/Sx. Yield 1.34, circulate cement to surface.
3. Drill 7 7/8" hole to 7070'. Run and set 7070' of 5½" 17# J-55 LT&C casing. Cement with 341 Sx of 40/60 (CemPlus blend/LITEFIL(24#/CF) + 1% ANTISETTLING AGENT + .3% TIC DISPERSANT + .2% ANTIFOAMER + .125#/Sx. of polyflake/Sx. Yield 2.61, tail in with 40/60/ (CemPlus blend/LITEFIL(24#/CF) + .2% MIDTEMP RETARDER + 1% ANTISETTLING AGENT + .3% TIC DISPERSANT + .2% ANTIFOAMER + .125#/Sx of polyflake/Sx. Yield 2.27, circulate cement to surface.
4. Cement volumes may be altered after open hole logs have been run to check the caliper log it see if changes to volumes will be required.
5. Fresh water will be used to drill the surface hole, and brine will be used to drill the 7 7/8" hole to reduce wash out of the salt section.
6. The Bureau of Land Management does not have any records that indicate the presence of H<sub>2</sub>S in this area. RKI Exploration & Production, LLC. has not encountered and H<sub>2</sub>S during the drilling of other wells on this lease.

DISTRICT I  
1625 N. French Dr., Hobbs, NM 88240  
DISTRICT II  
1301 W. Grand Avenue, Artesia, NM 88210  
DISTRICT III  
1000 Rio Brazos Rd., Aztec, NM 87410  
DISTRICT IV  
1220 S. St. Francis Dr., Santa Fe, NM 87505

State of New Mexico  
Energy, Minerals and Natural Resources Department

Form C-102  
Revised October 12, 2005

Submit to Appropriate District Office  
State Lease - 4 Copies  
Fee Lease - 3 Copies

OIL CONSERVATION DIVISION  
1220 South St. Francis Dr.  
Santa Fe, New Mexico 87505

☐ AMENDED REPORT

WELL LOCATION AND ACREAGE DEDICATION PLAT

API Number	Pool Code 150H	Pool Name Culebra Bluff BONE SPRING, S
Property Code 303271	Property Name PINNACLE STATE	Well Number 25
OGRID No. 246289	Operator Name RKI EXPLORATION & PRODUCTION	Elevation 3066'

Surface Location

UL or lot No.	Section	Township	Range	Lot Idn	Feet from the	North/South line	Feet from the	East/West line	County
M	36	22 S	28 E		330	SOUTH	800	WEST	EDDY

Bottom Hole Location If Different From Surface

UL or lot No.	Section	Township	Range	Lot Idn	Feet from the	North/South line	Feet from the	East/West line	County
Dedicated Acres 80	Joint or Infill	Consolidation Code	Order No.						

NO ALLOWABLE WILL BE ASSIGNED TO THIS COMPLETION UNTIL ALL INTERESTS HAVE BEEN CONSOLIDATED  
OR A NON-STANDARD UNIT HAS BEEN APPROVED BY THE DIVISION

	<p><b>OPERATOR CERTIFICATION</b></p> <p>I hereby certify that the information contained herein is true and complete to the best of my knowledge and belief, and that this organization either owns a working interest or unleased mineral interest in the land including the proposed bottom hole location pursuant to a contract with an owner of such a mineral or working interest, or to a voluntary pooling agreement or a compulsory pooling order heretofore entered by the division.</p> <p>Signature: Joe T. Janica Date: 05/16/08</p> <p>Printed Name: Joe T. Janica</p>	
	<p><b>SURVEYOR CERTIFICATION</b></p> <p>I hereby certify that the well location shown on this plat was plotted from field notes of actual surveys made by me or under my supervision, and that the same is true and correct to the best of my belief.</p> <p>Date Surveyed: MAY 7, 2008</p> <p>Signature &amp; Seal of Professional Surveyor: [Signature] 7977</p> <p>Certificate No.: Gery L. Jones 7977</p> <p>BASIN SURVEYS</p>	

SECTION 36, TOWNSHIP 22 SOUTH, RANGE 28 EAST, N.M.P.M.,  
EDDY COUNTY, NEW MEXICO.

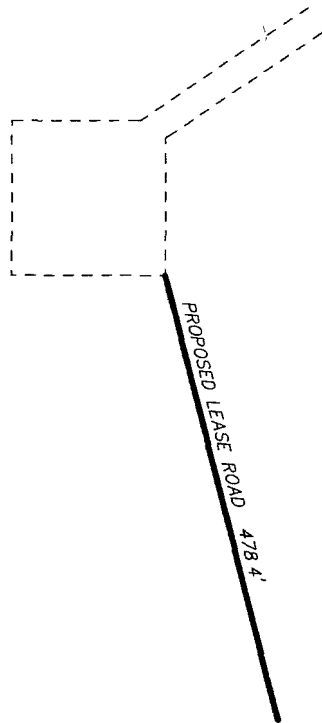

RKI EXPLORATION & PRODUCTION  
PINNACLE STATE #25  
ELEV. - 3066'  
LAT-N 32°20'34.53"  
LONG-W 104°02'48.10"  
(NAD-83)

150' NORTH  
OFF SET  
3067.6'  
□

150' WEST  
OFF SET  
3066.4' □

150' EAST  
OFF SET  
3064.5' □

150' SOUTH  
OFF SET  
3062.4'  
□

200 0 200 400 FEET

SCALE: 1" = 200'

**DIRECTIONS TO LOCATION:**

FROM THE JUNCTION OF HWY 62-180 AND REFINERY ROAD, GO SOUTHERLY ON REFINERY ROAD FOR 10.3 MILES TO LEASE ROAD, ON LEASE ROAD GO NORTHEAST 0.9 MILES, THENCE SOUTHEAST WINDING NORTHEAST 1.2 MILES TO WELL PAD AND PROPOSED LEASE ROAD.

**RKI EXPLORATION & PRODUCTION**

REF: PINNACLE STATE #25 / Well Pad Topo

THE PINNACLE STATE #25 LOCATED 330' FROM  
THE SOUTH LINE AND 800' FROM THE WEST LINE OF  
SECTION 36, TOWNSHIP 22 SOUTH, RANGE 28 EAST,  
N.M.P.M., EDDY COUNTY, NEW MEXICO.

**BASIN SURVEYS** P.O. BOX 1786-HOBBS, NEW MEXICO

W.O. Number. 19603 Drawn By: J. M. SMALL

Date: 05-08-2008 Disk: JMS 19603

Survey Date: 05-07-2008 Sheet 1 of 1 Sheets



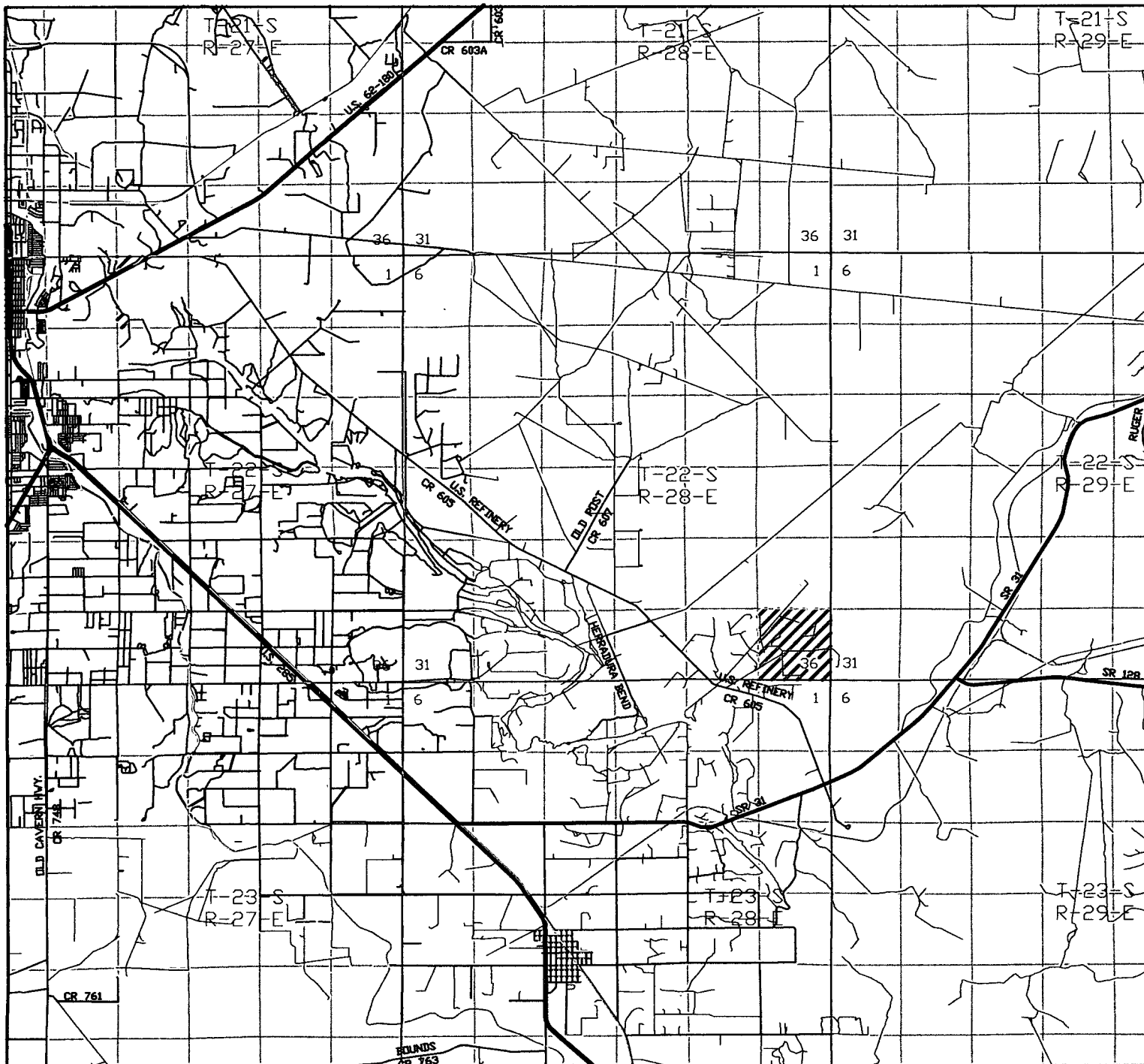

# PINNACLE STATE #26

Located at 330' FSL and 800' FWL  
 Section 36, Township 22 South, Range 28 East,  
 N.M.P.M., Eddy County, New Mexico.



P.O. Box 1786  
 1120 N. West County Rd.  
 Hobbs, New Mexico 88241  
 (505) 393-7316 - Office  
 (505) 392-3074 - Fax  
[basinsurveys.com](http://basinsurveys.com)

W.O. Number: JMS 19603

Survey Date: 05-07-2008

Scale: 1" = 2 MILES

Date: 05-08-2008

RKI  
 EXPLORATION &  
 PRODUCTION

# BLOWOUT PREVENTER SYSTEM

3000 PSI

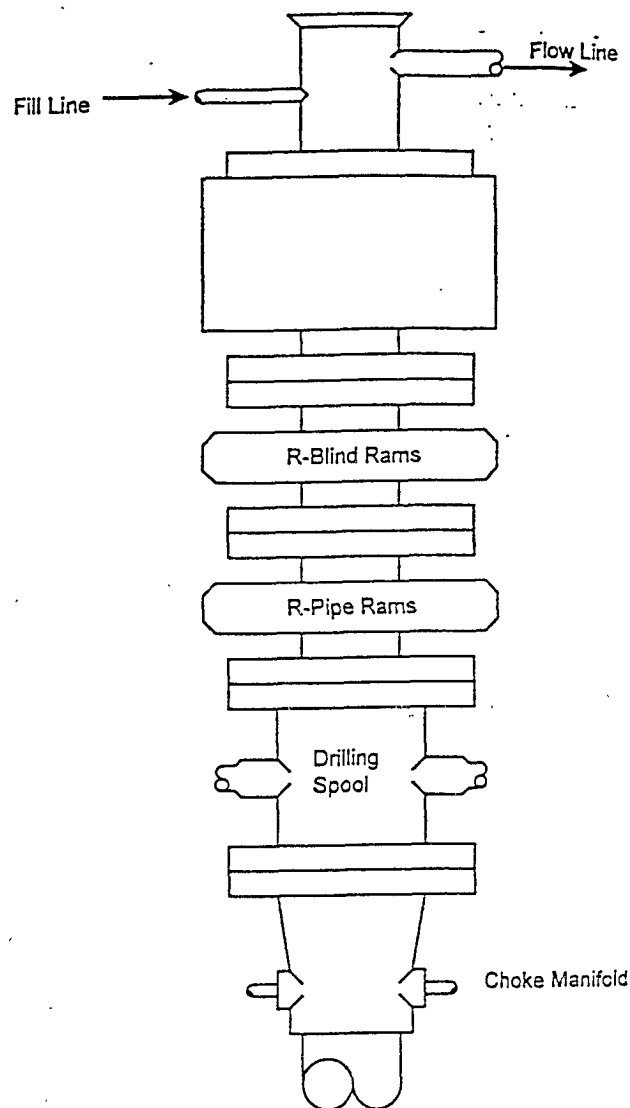

Type 900 SERIES  
3000 PSI WP

## Choke Manifold Assembly for 5M WP System

