

UNITED STATES  
DEPARTMENT OF THE INTERIOR  
BUREAU OF LAND MANAGEMENT



FORM APPROVED  
Budget Bureau No. 1004-0135  
Expires: March 31, 1993

SUNDRY NOTICES AND REPORTS ON WELLS

Do not use this form for proposals to drill or to deepen or reentry for a different reservoir.  
Use "APPLICATION FOR PERMIT --" for such proposals.

SUBMIT IN TRIPLICATE

1. Type of Well: ☐ OIL WELL ☒ GAS WELL ☐ OTHER

2. Name of Operator  
CHEVRON USA INC

3. Address and Telephone No. 15 SMITH ROAD, MIDLAND, TX 79705 915-687-737

4. Location of Well (Footage, Sec., T., R., M., or Survey Description)

Unit Letter K : 1650' Feet From The SOUTH Line and 1725' Feet From The

WEST Line Section 4 Township 22-S Range 23-E

5. Lease Designation and Serial No.  
NM-045273

6. If Indian, Allottee or Tribe Name  
2585

7. If Unit or CA, Agreement Designation

8. Well Name and Number  
BOGLE FLATS  
22

9. API Well No.  
30-015-32667

10. Field and Pool, Exploratory Area  
LOAFER DRAW; MORROW SE

11. County or Parish, State  
EDDY, NM

12. Check Appropriate Box(s) To Indicate Nature of Notice, Report, or Other Data

TYPE OF SUBMISSION	TYPE OF ACTION
<input type="checkbox"/> Notice of Intent	<input type="checkbox"/> Abandonment
<input checked="" type="checkbox"/> Subsequent Report	<input type="checkbox"/> Recompletion
<input type="checkbox"/> Final Abandonment Notice	<input type="checkbox"/> Plugging Back
	<input type="checkbox"/> Casing Repair
	<input type="checkbox"/> Attering Casing
	<input checked="" type="checkbox"/> OTHER: NEW DRILL RIG LAYOUT
	<input type="checkbox"/> Change of Plans
	<input type="checkbox"/> New Construction
	<input type="checkbox"/> Non-Routine Fracturing
	<input type="checkbox"/> Water Shut-Off
	<input type="checkbox"/> Conversion to Injection
	<input type="checkbox"/> Dispose Water

(Note: Report results of multiple completion on Well Completion or Recompletion Report and Log Form.)

13. Describe Proposed or Completed Operations (Clearly state all pertinent details, and give pertinent dates, including estimated date of starting any proposed work. If well is directionally drilled, give subsurface locations and measured and true vertical depths for all markers and zones pertinent to this work.)

ATTACHED, IS A NEW SCHEMATIC OF EXHIBIT "B" FOR THE DRILLING RIG LAYOUT, AS REQUESTED BY BARRY HUNT.

PLEASE REFERENCE PHONE CALL ON 10-14-03 BETWEEN BARRY HUNT (BLM) AND JOE WILLIAMS (CHEVRON)

CHEVRON U.S.A. RECEIVED APPROVAL ON 2-25-03 TO DRILL THE SUBJECT WELL. (APPROVED COPY ATTACHED)  
THE PERMIT WAS SENT IN AS THE BOGLE FLATS UNIT #22 AND WE REQUESTED TO TEST THE CISCO PENN & THE MORROW BEFORE COMPLETING THE SWD. THE MORROW IS NOT PART OF THE UNITIZED INTERVAL, SO WE ARE NOW REFERRING TO IT AS THE BOGLE FLATS #22.

IF THE ZONES ARE COMMERCIAL, THE SUBJECT WELL WOULD BE A PRODUCER INSTEAD OF AN SWD.

PLEASE CHANGE THE NAME ON THE SUBJECT WELL TO BOGLE FLATS #22.

14. I hereby certify that the foregoing is true and correct.

SIGNATURE Denise Leake TITLE Regulatory Specialist DATE 10/16/2003

TYPE OR PRINT NAME Denise Leake

(This space for Federal or State office use)

APPROVED

CONDITIONS OF APPROVAL, IF ANY:

TITLE

DATE

Title 18 U.S.C. Section 1001, makes it a crime for any person knowingly and willfully to make to any department or agency of the United States any false, fictitious or fraudulent statements or representations as to any matter within its jurisdiction.

SECTION 4, TOWNSHIP 22 SOUTH, RANGE 23 EAST, N.M.P.M.,  
EDDY COUNTY, NEW MEXICO.

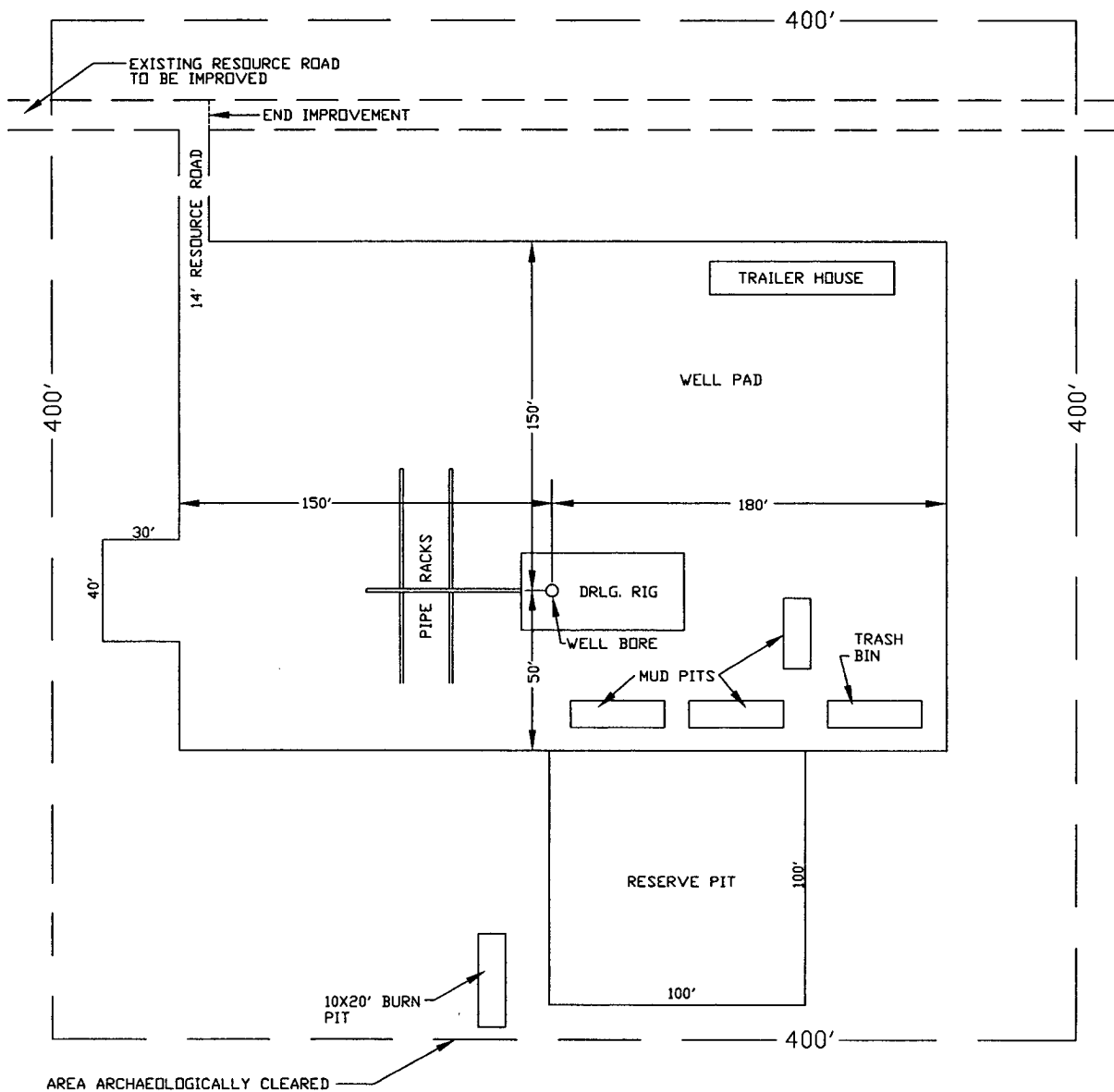

## ChevronTexaco Corporation

EXHIBIT "B"  
DRILLING RIG LAYOUT  
ChevronTexaco Inc.  
BOGLE FLATS #22  
1650' FSL & 1725' FWL SECTION 4  
T22S, R23E, NMPM, EDDY CO., NM.

Survey Date: 4/25/01	Sheet 1 of 1 Sheets
W.O. Number: 03.11.0110	Drawn By: L.A. REV:10/14/03
Date: 2/07/03	DISK: CD#2 03110110 SCALE: NONE