

District I
1625 N. French, Hobbs, NM 88240
District II
811 South First, Artesia, NM 87210
District III
1000 Rio Brazos Rd., Aztec, NM 87410
District IV
1220 S. St. Francis Dr., Santa Fe, NM 87505

OIL CONSERVATION DIVISION
1220 South St. Francis Dr.
Santa Fe, NM 87505

WELL API NO.
30-015-35611

5. Indicate Type Of Lease
STATE ☐ FEE ☒

6. State Oil & Gas Lease No.

WELL COMPLETION OR RECOMPLETION REPORT AND LOG

1a. Type of Well: OIL WELL ☐ GAS WELL ☒ DRY ☐ OTHER _____
b. Type of Completion: NEW WELL ☒ WORK OVER ☐ DEEPEN ☐ PLUG BACK ☐ DIFF. RESVR. ☐ OTHER _____

7. Lease Name or Unit Agreement Name

OCT 09 2008
Seine B 6 Fee
OCD-ARTESIA

2. Name of Operator
EOG Resources Inc.

8. Well No.
1H

3. Address of Operator
P.O. Box 2267 Midland, Texas 79702

9. Pool name or Wildcat
Cottonwood Creek; Wolfcamp, West

4. Well Location
Unit Letter **H** : **2910** Feet From The **South** Line and **255** Feet From The **East** Line
Section **6** Township **16S** Range **25E** NMPM **Eddy** County

10. Date Spudded 8/23/08	11. Date T.D Reached 9/1/08	12. Date Compl. (Ready to Prod.) 9/27/08	13. Elevations (DF & RKB, RT, GR, etc.) 3521' GR	14. Elev. Casinghead
15. Total Depth 8622 M - 4614 V	16. Plug Back T.D.	17. If Multiple Compl. How Many Zones?	18. Intervals Drilled By X	Rotary Tools X
19. Producing Interval(s), of this completion - Top, Bottom, Name Wolfcamp 5200 - 8622				20. Was Directional Survey Made Yes
21. Type Electric and Other Logs Run Perf Depth Control Log				22. Was Well Cored No

23. CASING RECORD (Report all strings set in well)					
CASING SIZE	WEIGHT LB /FT.	DEPTH SET	HOLE SIZE	CEMENTING RECORD	AMOUNT PULLED
8-5/8	32	969	12-1/4	1245 Class C	
5-1/2	17	7455	7-7/8	1400 50/50 POZ C	

24. LINER RECORD					25. TUBING RECORD		
SIZE	TOP	BOTTOM	SACKS CEMENT	SCREEN	SIZE	DEPTH SET	PACKER SET
					2-7/8	5359	

26. Perforation record (interval, size, and number) 7455 - 8222' OH 5200 - 5835', 0.42", 30 hls 6765 - 7385', 0.42", 30 hls 5990 - 6610', 0.42", 30 hls	27. ACID, SHOT, FRACTURE, CEMENT, SQUEEZE, ETC. DEPTH INTERVAL AMOUNT AND KIND MATERIAL USED 5200 - 8222 Frac w/ 285 bbls 15% HCL, 1355 bbl Dilute acid, 1615 bbls 15# gel, 739070 lbs sand, 29043 bbls water
---------------------------------------------------------------------------------------------------------------------------------------------------------------------------------------	----------------------------------------------------------------------------------------------------------------------------------------------------------------------------------------------------------------------------------------------------------

28. **PRODUCTION**

Date First Production 9/27/08	Production Method (Flowing, gas lift, pumping - Size and type pump) Flowing	Well Status (Prod. or Shut-in) Producing					
Date of Test 10/7/08	Hours Tested 24	Choke Size Open	Prod'n For Test Period	Oil - Bbl. 0	Gas - MCF 577	Water - Bbl. 62	Gas - Oil Ratio
Flow Tubing Press. 150	Casing Pressure 400	Calculated 24-Hour Rate	Oil - Bbl.	Gas - MCF	Water - Bbl.	Oil Gravity - API -(Corr.)	

29. Disposition of Gas (Sold, used for fuel, vented, etc.)
Sold

Test Witnessed By

30. List Attachments
C-103, C-104, directional survey

31. I hereby certify that the information shown on both sides of this form is true and complete to the best of my knowledge and belief

Signature **Stan Wagner** Printed Name **Stan Wagner** Title **Regulatory Analyst** Date **10/8/08**

INSTRUCTIONS

This form is to be filed with the appropriate District Office of the Division not later than 20 days after the completion of any newly-drilled or deepened well. It shall be accompanied by one copy of all electrical and radio-activity logs run on the well and a summary of all special tests conducted, including drill stem tests. All depths reported shall be measured depths. In the case of directionally drilled wells, true vertical depths shall also be reported. For multiple completions, Items 25 through 29 shall be reported for each zone. The form is to be filed in quintuplicate except on state land, where six copies are required. See Rule 1105.

INDICATE FORMATION TOPS IN CONFORMANCE WITH GEOGRAPHICAL SECTION OF STATE

Southeastern New Mexico

Northeastern New Mexico

T. Anhy _____	T. Canyon _____	T. Ojo Alamo _____	T. Penn. "B" _____
T. Salt _____	T. Strawn _____	T. Kirtland-Fruitland _____	T. Penn. "C" _____
B. Salt _____	T. Atoka _____	T. Pictured Cliffs _____	T. Penn. "D" _____
T. Yates _____	T. Miss _____	T. Cliff House _____	T. Leadville _____
T. 7 Rivers _____	T. Devonian _____	T. Menefee _____	T. Madison _____
T. Queen _____	T. Silurian _____	T. Point Lookout _____	T. Elbert _____
T. Grayburg _____	T. Montoya _____	T. Mancos _____	T. McCracken _____
T. San Andres _____	T. Simpson _____	T. Gallup _____	T. Ignacio Otzte _____
T. Glorieta 1650'	T. McKee _____	Base Greenhorn _____	T. Granite _____
T. Paddock _____	T. Ellenburger _____	T. Dakota _____	T. _____
T. Blinebry _____	T. Gr. Wash _____	T. Morrison _____	T. _____
T. Tubb 3040'	T. Delaware Sand _____	T. Todilto _____	T. _____
T. Drinkard _____	T. Bone Springs _____	T. Entrada _____	T. _____
T. Abo 3740'	T. _____	T. Wingate _____	T. _____
T. Wolfcamp 4655'	T. _____	T. Chinle _____	T. _____
T. Penn _____	T. _____	T. Permian _____	T. _____
T. Cisco (Bough C) _____	T. _____	T. Penn "A" _____	T. _____

OIL OR GAS SANDS OR ZONES

No. 1, from _____ to _____

No. 2, from _____ to _____

No. 3, from _____ to _____

No. 4, from _____ to _____

IMPORTANT WATER SANDS

Include data on rate of water inflow and elevation to which water rose in hole.

No. 1, from _____ to _____ feet _____

No. 2, from _____ to _____ feet _____

No. 3, from _____ to _____ feet _____

LITHOLOGY RECORD (Attach additional sheet if necessary)

From	To	Thickness in Feet	Lithology

From	To	Thickness in Feet	Lithology

District I
1625 N. French Dr., Hobbs, NM 88240
District II
1301 W. Grand Avenue, Artesia, NM 88210
District III
1000 Rio Brazos Rd., Aztec, NM 87410
District IV
1220 S. St. Francis Dr., Santa Fe, NM 87505

State of New Mexico
Energy, Minerals & Natural Resources Department
OIL CONSERVATION DIVISION
1220 South St. Francis Dr.
Santa Fe, NM 87505

Form C-102
Revised October 12, 2005
Submit to Appropriate District Office
State Lease-4 Copies
Fee Lease-3 Copies

☒ AMENDED REPORT

WELL LOCATION AND ACREAGE DEDICATION PLAT

API Number 30-015-35611	Pool Code 75260	Pool Name Cottonwood Creek; WC West (Gas)
Property Code 35612	Property Name SEINE B 6 FEE	Well Number 1H
OGRID No. 7377	Operator Name EOG RESOURCES, INC.	Elevation 3521'

Surface Location

UL or lot no.	Section	Township	Range	Lot Idn	Feet from the	North/South line	Feet from the	East/West line	County
16	6	16 SOUTH	25 EAST, N.M.P.M.		2910	SOUTH	255	EAST	EDDY

Bottom Hole Location If Different From Surface

UL or lot no.	Section	Township	Range	Lot Idn	Feet from the	North/South line	Feet from the	East/West line	County
13	6	16 SOUTH	25 EAST, N.M.P.M.		3617	SOUTH	955	WEST	EDDY
Dedicated Acres 319.52		Joint or Infill	Consolidation Code	Order No.					

No allowable will be assigned to this completion until all interests have been consolidated or a non-standard unit has been approved by the division.

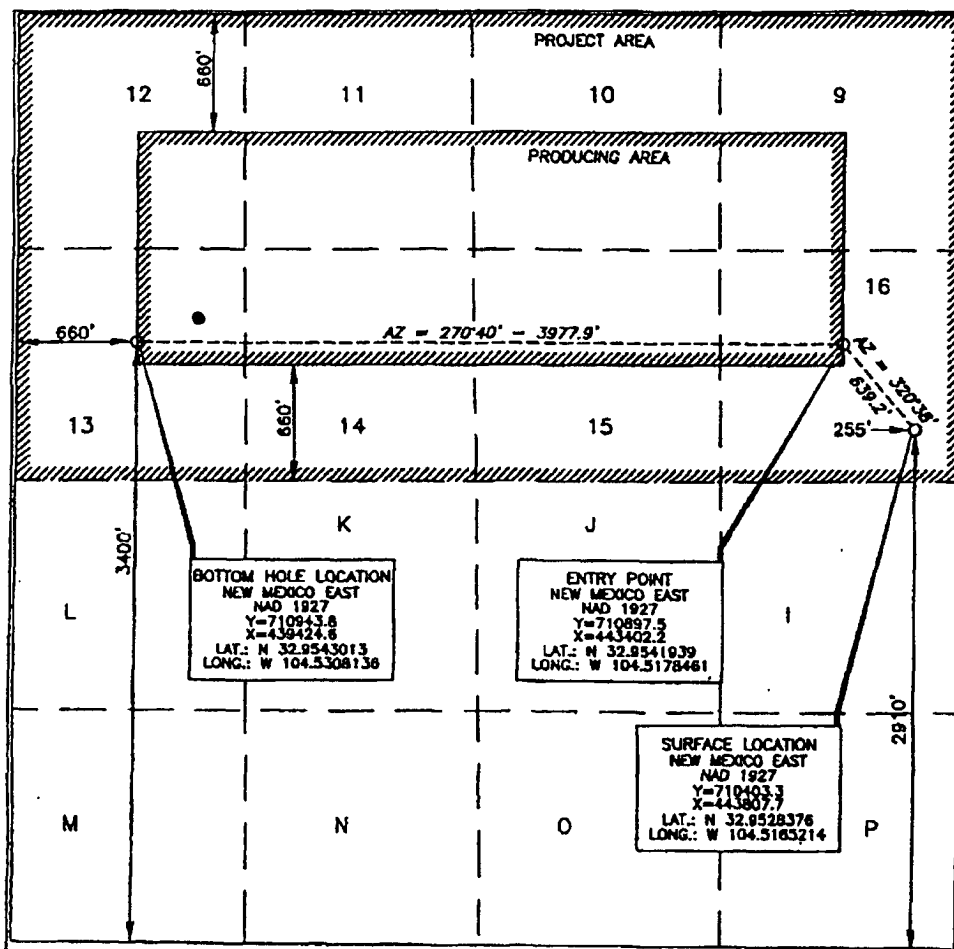

OPERATOR CERTIFICATION

I hereby certify that the information contained herein is true and complete to the best of my knowledge and belief, and that this organization either owns a working interest or unleased mineral interest in the land including the proposed bottom hole location or has a right to drill this well at this location pursuant to a contract with an owner of such a mineral or working interest, or to a voluntary pooling agreement or a compulsory pooling order heretofore entered by the division.

Donny G. Glanton 6/8/06
Signature Date

Donny G. Glanton
Printed Name

SURVEYOR CERTIFICATION

I hereby certify that the well location shown on this plat was plotted from field notes of actual surveys made by me or under my supervision, and that the same are true and correct to the best of my belief.

DATE 26, 2006
Date of Survey 15079
Signature and Seal of Professional Surveyor:
Sergio A. Chaul
Certificate Number 15079

WOF 060330WL-C2 (LV)