

UNITED STATES  
DEPARTMENT OF THE INTERIOR  
BUREAU OF LAND MANAGEMENT

FEB - 3 2009

FORM APPROVED  
OMB NO. 1004-0135  
Expires: July 31, 2010**SUNDRY NOTICES AND REPORTS ON WELLS**  
*Do not use this form for proposals to drill or to re-enter an abandoned well. Use form 3160-3 (APD) for such proposals.***SUBMIT IN TRIPLICATE - Other instructions on reverse side.**

1. Type of Well <input type="checkbox"/> Oil Well <input checked="" type="checkbox"/> Gas Well <input type="checkbox"/> Other		8. Well Name and No. Multiple--See Attached
2. Name of Operator CHESAPEAKE OPERATING, INC. Contact: LINDA GOOD E-Mail: linda.good@chk.com		9. API Well No. Multiple--See Attached
3a. Address OKLAHOMA CITY, OK 73154-0496	3b. Phone No. (include area code) Ph: 405-935-4275	10. Field and Pool, or Exploratory DEVONIAN
4. Location of Well (Footage, Sec., T., R., M., or Survey Description) Multiple--See Attached		11. County or Parish, and State EDDY COUNTY, NM

## 12. CHECK APPROPRIATE BOX(ES) TO INDICATE NATURE OF NOTICE, REPORT, OR OTHER DATA

TYPE OF SUBMISSION	TYPE OF ACTION			
<input type="checkbox"/> Notice of Intent	<input type="checkbox"/> Acidize	<input type="checkbox"/> Deepen	<input type="checkbox"/> Production (Start/Resume)	<input type="checkbox"/> Water Shut-Off
<input checked="" type="checkbox"/> Subsequent Report	<input type="checkbox"/> Alter Casing	<input type="checkbox"/> Fracture Treat	<input type="checkbox"/> Reclamation	<input type="checkbox"/> Well Integrity
<input type="checkbox"/> Final Abandonment Notice	<input type="checkbox"/> Casing Repair	<input type="checkbox"/> New Construction	<input type="checkbox"/> Recomplete	<input checked="" type="checkbox"/> Other
	<input type="checkbox"/> Change Plans	<input type="checkbox"/> Plug and Abandon	<input type="checkbox"/> Temporarily Abandon	Site Facility Diagram/Security Plan
	<input type="checkbox"/> Convert to Injection	<input type="checkbox"/> Plug Back	<input type="checkbox"/> Water Disposal	

13. Describe Proposed or Completed Operation (clearly state all pertinent details, including estimated starting date of any proposed work and approximate duration thereof. If the proposal is to deepen directionally or recompleat horizontally, give subsurface locations and measured and true vertical depths of all pertinent markers and zones. Attach the Bond under which the work will be performed or provide the Bond No. on file with BLM/BIA. Required subsequent reports shall be filed within 30 days following completion of the involved operations. If the operation results in a multiple completion or recompleat in a new interval, a Form 3160-4 shall be filed once testing has been completed. Final Abandonment Notices shall be filed only after all requirements, including reclamation, have been completed, and the operator has determined that the site is ready for final inspection.)

PLEASE FIND THE ATTACHEM UPDATED DIAGRAM FOR GREENWOOD PRE-GRAYBURG UNIT 1.

(CHK PN 890448)

Accepted for Record Purposes.  
Approval Subject to Onsite Inspections.  
Date: 1-31-09

ACCEPTED FOR RECORD

FEB 03 2009

Gerry Guye, Deputy Field Inspector  
NMOCD-District II ARTESIA

14. I hereby certify that the foregoing is true and correct. Electronic Submission #66652 verified by the BLM Well Information System For CHESAPEAKE OPERATING, INC., sent to the Carlsbad Committed to AFMSS for processing by KURT SIMMONS on 01/27/2009 (09KMS0739SE)	
Name (Printed/Typed) LINDA GOOD	Title SR. REGULATORY COMPLIANCE SPEC
Signature (Electronic Submission)	Date 01/26/2009

## THIS SPACE FOR FEDERAL OR STATE OFFICE USE

Approved By <b>ACCEPTED</b>	DUNCAN WHITLOCK Title LEAD PETROLEUM ENGINEERING TECH	Date 01/31/2009
Conditions of approval, if any, are attached. Approval of this notice does not warrant or certify that the applicant holds legal or equitable title to those rights in the subject lease which would entitle the applicant to conduct operations thereon.		Office Carlsbad

Title 18 U.S.C. Section 1001 and Title 43 U.S.C. Section 1212, make it a crime for any person knowingly and willfully to make to any department or agency of the United States any false, fictitious or fraudulent statements or representations as to any matter within its jurisdiction.

\*\* BLM REVISED \*\* BLM REVISED \*\* BLM REVISED \*\* BLM REVISED \*\* BLM REVISED \*\*

**Additional data for EC transaction #66652 that would not fit on the form**

**7. If Unit or CA/Agreement, Name and No., continued**

NMNM70958A  
NMNM70958B

**Wells/Facilities, continued**

<b>Agreement</b>	<b>Lease</b>	<b>Well/Fac Name, Number</b>	<b>API Number</b>	<b>Location</b>
NMNM70958B	NMLC029392B	GREENWOOD PREGB 1	30-015-05614-00-D1	Sec 27 T18S R31E SESE 660FSL 660FEL
NMNM70958A	NMLC029392B	GREENWOOD PREGB 1	30-015-05614-00-D2	Sec 27 T18S R31E SESE 660FSL 660FEL

# CHESAPEAKE OPERATING, INC.

CHK Name & Number: GREENWOOD PRE-GB UT 1  
 API Number: 30-015-05614 890448  
 County: EDDY  
 State: NM  
 Field: UNKNOWN  
 Qtr Qtr Calls: C SESE  
 Sec/Twnshp/Rng: 27-18S-31E  
 Number of Acres: 40

Regulatory Agency: BLM  
 Lease Sign Type: APD WELL  
 CA#: NMMN 709588  
 APD Lease #: NMLC29392B  
 Federal/Indian: FEDERAL  
 Last Violation: UNKNOWN  
 District: PERMIAN NORTH  
 Field Office: HOBBS

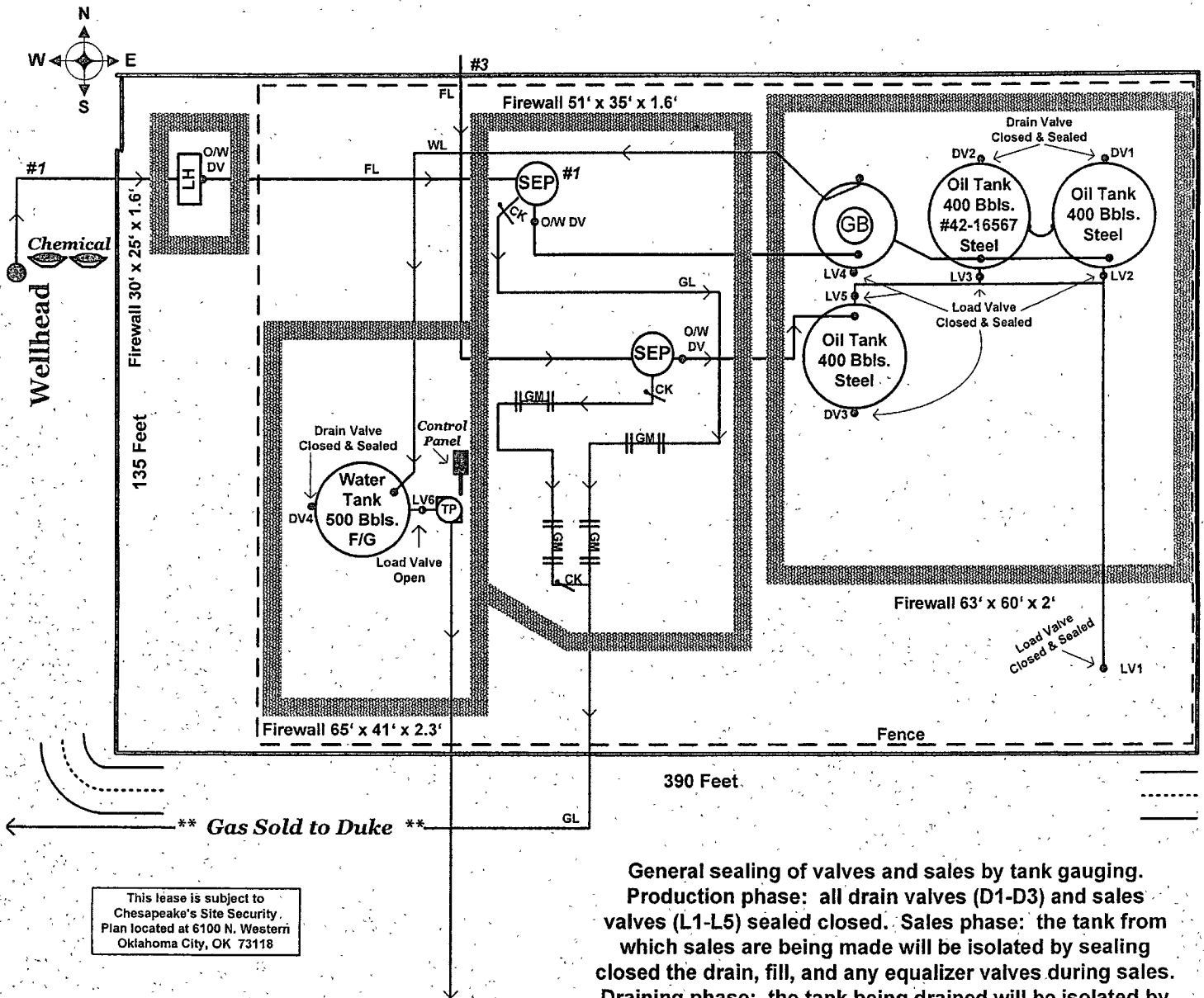

General sealing of valves and sales by tank gauging.  
 Production phase: all drain valves (D1-D3) and sales valves (L1-L5) sealed closed. Sales phase: the tank from which sales are being made will be isolated by sealing closed the drain, fill, and any equalizer valves during sales. Draining phase: the tank being drained will be isolated by sealing closed the sales, fill, equalizer valves and drain valves on the other tanks.

Prepared by: Jackie Reynolds  
 Date: 8-28-2008

Approved by:  
 Date: