

3160-5  
1990)

UNITED STATES  
DEPARTMENT OF THE INTERIOR  
BUREAU OF LAND MANAGEMENT

RECEIVED

FORM APPROVED  
Budget Bureau No. 1004-0135  
Expires: March 31, 1993

*TM*

SUNDRY NOTICES AND REPORTS ON WELLS

SEP 27 12 36 PM '94

Do not use this form for proposals to drill or to deepen or reentry to a different reservoir.

Use "APPLICATION FOR PERMIT—" for such proposals

BUREAU OF LAND MGMT  
WELL RESOURCE

SUBMIT IN TRIPLICATE

AREA

1 Type of Well  
 Oil Well  Gas Well  Other

2 Name of Operator  
 YATES PETROLEUM CORPORATION (505) 748-1471

3 Address and Telephone No.  
 105 South 4th St., Artesia, NM 88210

4 Location of Well (Footage, Sec., T., R., M., or Survey Description)  
 500' FSL & 2080' FWL of Section 29-T7S-R26E (Unit N, SESW)

5. Lease Designation and Serial No.  
 SCR423

6. If Indian, Allottee or Tribe Name  
 Muddy Com #1

7. If Unit or CA, Agreement Designation  
 30-005-61379

8. Well Name and No.  
 Muddy Com #1

9. API Well No.  
 30-005-61379

10. Field and Pool, or Exploratory Area  
 Pecos Slope Abo

11. County or Parish, State  
 Chaves Co., NM

12 CHECK APPROPRIATE BOX(S) TO INDICATE NATURE OF NOTICE, REPORT, OR OTHER DATA

TYPE OF SUBMISSION	TYPE OF ACTION
<input checked="" type="checkbox"/> Notice of Intent	<input type="checkbox"/> Abandonment
<input type="checkbox"/> Subsequent Report	<input type="checkbox"/> Recompletion
<input type="checkbox"/> Final Abandonment Notice	<input type="checkbox"/> Plugging Back
	<input type="checkbox"/> Casing Repair
	<input type="checkbox"/> Altering Casing
	<input checked="" type="checkbox"/> Other <u>Off-lease measurement &amp; sales</u>
	<input type="checkbox"/> Change of Plans
	<input type="checkbox"/> New Construction
	<input type="checkbox"/> Non-Routine Fracturing
	<input type="checkbox"/> Water Shut-Off
	<input type="checkbox"/> Conversion to Injection
	<input type="checkbox"/> Dispose Water

(Note. Report results of multiple completion on Well Completion or Recompletion Report and Log form.)

13 Describe Proposed or Completed Operations (Clearly state all pertinent details, and give pertinent dates, including estimated date of starting any proposed work. If well is directionally drilled, give subsurface locations and measured and true vertical depths for all markers and zones pertinent to this work.)\*

Yates Petroleum Corporation respectfully requests approval for off-lease measurement and sales for the captioned well. Due to economic reasons, the gas purchaser required Yates to lay a pipeline from the Muddy Com #1 to the Sun Federal #2, operated by Pecos River Operating, located in the SESE of Section 29-T7S-R26E, Chaves County, New Mexico (Lease No.: NM-022584).

The Sun Federal #2 sets approximately 1/4 mile northeast of the Muddy Com #2. Transwestern's meterhouse (Meter No. 15661) sets on the edge of the Sun Federal #2 location. These two wells ARE NOT commingled.

Transwestern conducts periodic meter tests on their meters. These will be furnished to the BLM upon request.

14 I hereby certify that the foregoing is true and correct

Signed *[Signature]*

Title Production Clerk

Date Sept. 26, 1994

(This space for Federal or State office use)

Approved by \_\_\_\_\_  
Conditions of approval, if any:

Title \_\_\_\_\_

APPROVED  
 PETER W. CHESTER  
 Peter W. Chester  
 OCT 5 1994  
 BUREAU OF LAND MGMT  
 WELL RESOURCE AREA

Title 18 U.S.C. Section 1001, makes it a crime for any person knowingly and willfully to make to any department or agency of the United States any false, fictitious or fraudulent statements or representations as to any matter within its jurisdiction.

\*See Instruction on Reverse Side

*TM*

RECEIVED

LW  
CG  
PP  
DR  
LB  
OL  
NT

73-7-91

op

Submit 5 Copies  
Appropriate District Office  
DISTRICT I  
P.O. Box 1980, Hobbs, NM 88240

State of New Mexico  
Energy, Minerals and Natural Resources Department

Form C-104  
Revised 1-1-89  
See Instructions  
at Bottom of Page

OCT 24 '89

OIL CONSERVATION DIVISION

DISTRICT II  
P.O. Drawer DD, Artesia, NM 88210

O. C. D.  
ARTESIA OFFICE

P.O. Box 2088  
Santa Fe, New Mexico 87504-2088

DISTRICT III  
1000 Rio Brazos Rd., Aztec, NM 87410

REQUEST FOR ALLOWABLE AND AUTHORIZATION  
TO TRANSPORT OIL AND NATURAL GAS

Operator YATES PETROLEUM CORPORATION	Well API No. 30-005-61379
Address 105 SOUTH 4th STREET, ARTESIA, NM 88210	
Reason(s) for Filing: (Check proper box) <input checked="" type="checkbox"/> Other (Please explain)	
New Well <input type="checkbox"/>	Change in Transporter of: <input type="checkbox"/> Oil <input type="checkbox"/> Dry Gas <input type="checkbox"/>
Recompletion <input type="checkbox"/>	Casinghead Gas <input type="checkbox"/> Condensate <input checked="" type="checkbox"/>
Change in Operator <input checked="" type="checkbox"/>	EFFECTIVE DATE <u>10-21-89</u>
If change of operator give name and address of previous operator Mesa Operating Limited Partnership, PO Box 2009, Amarillo, Texas 79189	

II. DESCRIPTION OF WELL AND LEASE

Lease Name Muddy Com	Well No. 1	Pool Name, Including Formation Pecos Slope Abo	Kind of Lease State, Federal or <u>Fee</u>	Lease No.
Location Unit Letter <u>N</u> : <u>500</u> Feet From The <u>south</u> Line and <u>2080</u> Feet From The <u>west</u> Line Section <u>29</u> Township <u>7S</u> Range <u>26E</u> , NMPM, Chaves County				

III. DESIGNATION OF TRANSPORTER OF OIL AND NATURAL GAS

Name of Authorized Transporter of Oil <input type="checkbox"/> or Condensate <input checked="" type="checkbox"/> Navajo Refining Co.	Address (Give address to which approved copy of this form is to be sent) PO Box 159, Artesia, NM 88210				
Name of Authorized Transporter of Casinghead Gas <input type="checkbox"/> or Dry Gas <input checked="" type="checkbox"/> Transwestern Pipeline Co. (ATT: Aicklen)	Address (Give address to which approved copy of this form is to be sent) PO Box 2521, Houston, TX 77001				
If well produces oil or liquids, give location of tanks.	Unit N	Sec. 29	Twp. 7	Rge. 26	Is gas actually connected? <u>Yes</u> When? <u>8/9/83</u>

If this production is commingled with that from any other lease or pool, give commingling order number:

IV. COMPLETION DATA

Designate Type of Completion - (X)	Oil Well	Gas Well	New Well	Workover	Deepen	Plug Back	Same Res'v	Diff Res'v
Date Spudded	Date Compl. Ready to Prod.		Total Depth			P.H.T.D.		
Elevations (DF, RKH, RT, GR, etc.)	Name of Producing Formation		Top Oil/Gas Pay			Tubing Depth		
Perforations						Depth Casing Shoe		
TUBING, CASING AND CEMENTING RECORD								
HOLE SIZE	CASING & TUBING SIZE		DEPTH SET			SACKS CEMENT		

V. TEST DATA AND REQUEST FOR ALLOWABLE

OIL WELL (Test must be after recovery of total volume of load oil and must be equal to or exceed top allowable for this depth or be for full 24 hours.)

Date First New Oil Run To Tank	Date of Test	Producing Method (Flow, pump, gas lift, etc.)		
Length of Test	Tubing Pressure	Casing Pressure		Choke Size
Actual Prod. During Test	Oil - Bbls.	Water - Bbls.		Gas - MCF

GAS WELL

Actual Prod. Test - MCF/D	Length of Test	Bbls. Condensate/MMCF	Gravity of Condensate
Testing Method (pilot, back pr.)	Tubing Pressure (Shut-in)	Casing Pressure (Shut-in)	Choke Size

VI. OPERATOR CERTIFICATE OF COMPLIANCE

I hereby certify that the rules and regulations of the Oil Conservation Division have been complied with and that the information given above is true and complete to the best of my knowledge and belief.

*Juanita Goodlett*  
Signature  
JUANITA GOODLETT - PRODUCTION SUPVR.  
Printed Name  
8-1-89  
Date  
(505) 748-1471  
Telephone No.

OIL CONSERVATION DIVISION

NOV 17 1989

Date Approved \_\_\_\_\_  
By ORIGINAL SIGNED BY  
MIKE WILLIAMS  
Title SUPERVISOR, DISTRICT II

INSTRUCTIONS: This form is to be filed in compliance with Rule 1104

- 1) Request for allowable for newly drilled or deepened well must be accompanied by tabulation of deviation tests taken in accordance with Rule 111.
- 2) All sections of this form must be filled out for allowable on new and recompleted wells.
- 3) Fill out only Sections I, II, III, and VI for changes of operator, well name or number, transporter, or other such changes.
- 4) Separate Form C-104 must be filed for each pool in multiply completed wells.

sent to partners 2-18-91 cs

RECEIVED BY  
 FEB 12 1986  
 O. C. D.  
 ARTESIA, OFFICE

RECEIVED

MAR 6 1986

STATE OF NEW MEXICO  
 ENERGY AND MINERALS DEPARTMENT

NO. OF COPIES RECEIVED	
DISTRIBUTION	
SANTA FE	
FILE	
U.S.G.S.	
LAND OFFICE	
TRANSPORTER	OIL
	GAS
OPERATOR	<input checked="" type="checkbox"/>
PROBATION OFFICE	

OIL CONSERVATION DIVISION  
 P. O. BOX 2088  
 SANTA FE, NEW MEXICO 87501

REGULATORY SAFETY  
 Form C-104  
 Revised 10-01-78  
 Format 08-01-83  
 Page 1

REQUEST FOR ALLOWABLE  
 AND  
 AUTHORIZATION TO TRANSPORT OIL AND NATURAL GAS

I. Operator Mesa Operating Limited Partnership

Address P.O. Box 2009, Amarillo, Texas 79189

Reason(s) for filing (Check proper box)

<input type="checkbox"/> New Well	Change in Transporter of:	<input type="checkbox"/> Other (Please explain)
<input type="checkbox"/> Recompletion	<input type="checkbox"/> Oil	<input type="checkbox"/> Dry Gas
<input checked="" type="checkbox"/> Change in Ownership	<input type="checkbox"/> Casinghead Gas	<input type="checkbox"/> Condensate

If change of ownership give name and address of previous owner Mesa Petroleum Co., P.O. Box 2009, Amarillo, Texas 79189

II. DESCRIPTION OF WELL AND LEASE

Lease Name <b>MUDDY COM</b>	Well No. <b>1</b>	Pool Name, including Formation <b>PECOS SLOPE ABO</b>	Kind of Lease State, Federal or <u>Fee</u>	Lease No.
Location				
Unit Letter <u>N</u>	<u>500</u> Feet From The <u>SOUTH</u> Line and <u>2080</u> Feet From The <u>WEST</u>			
Line of Section <u>29</u>	Township <u>7S</u>	Range <u>26E</u>	NMPM, <u>CHAVES</u>	County

III. DESIGNATION OF TRANSPORTER OF OIL AND NATURAL GAS

Name of Authorized Transporter of Oil <input type="checkbox"/> or Condensate <input checked="" type="checkbox"/>	Address (Give address to which approved copy of this form is to be sent)					
<u>Permian Corporation</u>	<u>P.O. BOX 1183 / Houston, Texas 77001</u>					
Name of Authorized Transporter of Casinghead Gas <input type="checkbox"/> or Dry Gas <input checked="" type="checkbox"/>	Address (Give address to which approved copy of this form is to be sent)					
<u>Transwestern Pipeline Co.</u>	<u>P.O. BOX 2521 / Houston, Texas 77001</u>					
If well produces oil or liquids, give location of tanks.	Unit	Sec.	Twp.	Rqs.	Is gas actually connected?	When
	<u>N</u>	<u>29</u>	<u>7</u>	<u>26</u>	<u>YES</u>	<u>8-9-83</u>

If this production is commingled with that from any other lease or pool, give commingling order number: \_\_\_\_\_

NOTE: Complete Parts IV and V on reverse side if necessary.

VI. CERTIFICATE OF COMPLIANCE

I hereby certify that the rules and regulations of the Oil Conservation Division have been complied with and that the information given is true and complete to the best of my knowledge and belief.

R. E. Madala  
 (Signature)

REGULATORY AGENT

February 14, 1986  
 (Date)

OIL CONSERVATION DIVISION

APPROVED FEB 28 1986, 19 \_\_\_\_\_

BY Original Signed By  
Les A. Clements  
 TITLE Supervisor District 11

This form is to be filed in compliance with RULE 1104.  
 If this is a request for allowable for a newly drilled or deepened well, this form must be accompanied by a tabulation of the deviation tests taken on the well in accordance with RULE 111.

All sections of this form must be filled out completely for allowable on new and recompleted wells.

Fill out only Sections I, II, III, and VI for changes of owner, well name or number, or transporter or other such change of condition.

Separate Forms C-104 must be filed for each pool in multiply completed wells.

RECEIVED

MAR 07 1986

PRODUCTION RECORDS

XC: NMOCD-(0+4), WF, CR, Reg.

OIL CONSERVATION DIVISION  
P. O. BOX 2088  
SANTA FE, NEW MEXICO 87501

RECEIVED

RECEIVED

MAY - 7 1982

AUG 17 1983

REQUEST FOR ALLOWABLE  
AND  
AUTHORIZATION TO TRANSPORT OIL AND NATURAL GAS

O. C. D.  
ARTESIA OFFICE

MESA -- PBD

NO. OF COPIES DESIRED	
DISTRIBUTION	
SANTA FE FILE	
U.S.G.S.	
LAND OFFICE	
TRANSPORTER OIL GAS	
OPERATOR	
PRODUCTION OFFICE	

Operator  
MESA PETROLEUM CO.

Address  
1000 VAUGHN BUILDING/MIDLAND, TEXAS 79701-4493

Reason(s) for filing (Check proper box)

New Well	<input checked="" type="checkbox"/>	Change in Transporter of:	
Recompletion	<input type="checkbox"/>	Oil	<input type="checkbox"/>
Change in Ownership	<input type="checkbox"/>	Casinghead Gas	<input type="checkbox"/>
		Dry Gas	<input type="checkbox"/>
		Condensate	<input type="checkbox"/>

Other (Please explain) \_\_\_\_\_

Received  
AUG 24 1983  
AUG 23 1983  
Regulatory  
ROW

If change of ownership give name and address of previous owner \_\_\_\_\_

DESCRIPTION OF WELL AND LEASE

Lease Name MUDDY COM	Well No. 1	Pool Name, including Formation PECOS SLOPE ABO	Kind of Lease State, Federal or Free	Lease
Location Unit Letter <u>N</u> ; <u>500</u> Feet From The <u>SOUTH</u> Line and <u>2080</u> Feet From The <u>WEST</u> Line of Section <u>29</u> Township <u>7S</u> Range <u>26E</u> , NMPM, CHAVES Co.				

DESIGNATION OF TRANSPORTER OF OIL AND NATURAL GAS

Name of Authorized Transporter of Oil <input type="checkbox"/> or Condensate <input checked="" type="checkbox"/> KOCH OIL COMPANY <i>Perman Corp.</i>	Address (Give address to which approved copy of this form is to be sent) P.O. BOX <sup>1183</sup> <del>1558</del> , HOUSTON, TX <sup>77001</sup> <del>76024</del>
Name of Authorized Transporter of Casinghead Gas <input type="checkbox"/> or Dry Gas <input checked="" type="checkbox"/> TRANSWESTERN PIPELINE CO (ATTN: AIKLEN)	Address (Give address to which approved copy of this form is to be sent) P.O. BOX 2521, HOUSTON, TX 77001
If well produces oil or liquids, give location of tanks.	Unit Sec. Twp. Rge. Is gas actually connected? When N 29 7S 26E NO Yes - 8-9-83

If this production is commingled with that from any other lease or pool, give commingling order number: \_\_\_\_\_

COMPLETION DATA

Designate Type of Completion - (X)	Oil Well	Gas Well	New Well	Workover	Deepen	Plug Back	Same Res'v.	Diff. I
		X	X					
Date Spudded 3-13-82	Date Compl. Ready to Prod. 4-20-82	Total Depth 4344'	P.B.T.D. 4255'					
Elevations (DF, RKB, RT, CR, etc.) 3562' GR	Name of Producing Formation ABO	Top Oil/Gas Pay 3703' - 3728'	Tubing Depth 3629'					
Perforations 3728' --- 3887'			Depth Casing Shoe 4308'					

TUBING, CASING, AND CEMENTING RECORD

HOLE SIZE	CASING & TUBING SIZE	DEPTH SET	SACKS CEMENT
17 1/2"	13 3/8"	900'	700/300
12 1/4"	8 5/8"	1807'	700/300
6 1/2"	4 1/2"	4308'	650
	2 3/8"	3629'	

TEST DATA AND REQUEST FOR ALLOWABLE OIL WELL (Test must be after recovery of total volume of load oil and must be equal to or exceed top able for this depth or be for full 24 hours)

Date First New Oil Run To Tanks	Date of Test	Producing Method (flow, pump, gas lift, etc.)
Length of Test	Tubing Pressure	Casing Pressure
Actual Prod. During Test	Oil-Bbls.	Water-Bbls.
		Gas-MCF

GAS WELL

Actual Prod. Test-MCF/D CAOF=600	Length of Test 1 hour	Bbls. Condensate/MMCF	Gravity of Condensate
Testing Method (prior, back pr.) BACK PRESSURE	Tubing Pressure (Shot-in) 985	Casing Pressure (Shot-in) 935	Choke Size

CERTIFICATE OF COMPLIANCE  
 ORIG: REM CC: MWF - LAND, D&M, MTS(3) 8-15-83  
 hereby certify that the rules and regulations of the Oil Conservation Division have been complied with and that the information given above is true and complete to the best of my knowledge and belief.  
 XC: NMOCD (6), TLS, CEN RCDS, ACCTG, ROSWELL, MEC, LAND, D&M, LMC, CTY, EEB, REM, K, TW, FILE, MTS (3), (PARTNERS)  
 R.E. Mack  
 (Signature)  
 REGULATORY COORDINATOR  
 (Title)  
 5-5-82  
 (Date)

OIL CONSERVATION DIVISION  
 APPROVED AUG 15 1983, 19\_\_\_\_  
 BY \_\_\_\_\_  
 Original Signed By  
 Leslie A. Clements  
 Supervisor District II  
 TITLE \_\_\_\_\_  
 This form is to be filed in compliance with RULE 1104.  
 If this is a request for allowable for a newly drilled or deep well, this form must be accompanied by a tabulation of the devt tests taken on the well in accordance with RULE 111.  
 All sections of this form must be filled out completely for a well on new and recompleted wells.  
 Fill out only sections I, II, III, and VI for changes of well name or number, or transporter, or other such change of cond

OIL CONSERVATION DIVISION  
P. O. BOX 2088  
SANTA FE, NEW MEXICO 87501

REQUEST FOR ALLOWABLE  
AND  
AUTHORIZATION TO TRANSPORT OIL AND NATURAL GAS

NO. OF OFFICE COPIES	
DISTRIBUTION	
SANTA FE	
FILE	
U.S.D.S.	
LAND OFFICE	
TRANSPORTER	OIL
	GAS
OPERATION	
REGISTRATION OFFICE	

Operator  
Mesa Petroleum Co.

Address  
P.O. Box 2009 / Amarillo, Texas 79189

Reason(s) for filing (Check proper box) Other (Please explain)

New Well <input type="checkbox"/>	Change in Transporter of:	
Recompletion <input type="checkbox"/>	Oil <input type="checkbox"/>	Dry Gas <input type="checkbox"/>
Change in Ownership <input type="checkbox"/>	Casinghead Gas <input type="checkbox"/>	Condensate <input checked="" type="checkbox"/>

If change of ownership give name and address of previous owner \_\_\_\_\_

II. DESCRIPTION OF WELL AND LEASE

Lease Name MUDDY COM	Well No. 1	Pool Name, including Formation Pecos Slope ABO	Kind of Lease <del>State Explorer Fee</del> <input checked="" type="checkbox"/> <b>State Explorer Fee</b>	Lease
Location Unit Letter <u>N</u> ; <u>500</u> Feet From The <u>South</u> Line and <u>2080</u> Feet From The <u>West</u>				
Line of Section <u>29</u> Township <u>7S</u> Range <u>26E</u> , NMPM, Chaves Cour				

III. DESIGNATION OF TRANSPORTER OF OIL AND NATURAL GAS

Name of Authorized Transporter of Oil <input type="checkbox"/> or Condensate <input checked="" type="checkbox"/>	Address (Give address to which approved copy of this form is to be sent)
Permian Corporation	P.O. Box 1183 / Houston, Texas 77001
Name of Authorized Transporter of Casinghead Gas <input type="checkbox"/> or Dry Gas <input checked="" type="checkbox"/>	Address (Give address to which approved copy of this form is to be sent)
Transwestern Pipeline Co. (Attn: Aiklen)	P.O. Box 2521 / Houston, Texas 77001
If well produces oil or liquids, give location of tanks.	Unit Sec. Twp. Rge. is gas actually connected? When
	N 29 7 26 ---

If this production is commingled with that from any other lease or pool, give commingling order number: \_\_\_\_\_

V. COMPLETION DATA

Designate Type of Completion - (X)	Oil Well	Gas Well	New Well	Workover	Deepen	Plug Back	Same Res'v.	Diff. R
Date Spudded	Date Compl. Ready to Prod.	Total Depth			P.B.T.D.			
Elevations (DF, RKB, RT, GR, etc.)	Name of Producing Formation	Top Oil/Gas Pay			Tubing Depth			
Perforations	Depth Casing Shoe							
TUBING, CASING, AND CEMENTING RECORD								
HOLE SIZE	CASING & TUBING SIZE	DEPTH SET			SACKS CEMENT			

VI. TEST DATA AND REQUEST FOR ALLOWABLE (Test must be after recovery of total volume of load oil and must be equal to or exceed top allowable for this depth or be for full 24 hours)

Date First New Oil Run To Tanks	Date of Test	Producing Method (Flow, pump, gas lift, etc.)	
Length of Test	Tubing Pressure	Casing Pressure	Choke Size
Actual Prod. During Test	Oil-Bbls.	Water-Bbls.	Gas-MCF

GAS WELL

Actual Prod. Test-MCF/D	Length of Test	Bbls. Condensate/M/MCF	Gravity of Condensate
Testing Method (prior, back pr.)	Tubing Pressure (Shot-in)	Casing Pressure (Shot-in)	Choke Size

I. CERTIFICATE OF COMPLIANCE

I hereby certify that the rules and regulations of the Oil Conservation Division have been complied with and that the information given above is true and complete to the best of my knowledge and belief.

XC: NMOCD-A (O+5) CEN RCDS, ACCTG, ENG, REM (FILE)

*R. F. Maut*  
(Signature)  
REGULATORY COORDINATOR

(Title)  
1-11-83  
(Date)

OIL CONSERVATION DIVISION

APPROVED \_\_\_\_\_, 19\_\_\_\_

BY \_\_\_\_\_

TITLE \_\_\_\_\_

This form is to be filed in compliance with RULE 1104.  
If this is a request for allowable for a newly drilled or deep well, this form must be accompanied by a tabulation of the device tests taken on the well in accordance with RULE 111.  
All sections of this form must be filled out completely for all wells on new and recompleted wells.  
Fill out only Sections I, II, III, and VI for changes of well name or number, or transporter, or other such change of condition.  
Separate forms C-104 must be filed for each pool in multicompleted wells.

STATE OF NEW MEXICO  
OIL AND MINERALS DEPARTMENT

OIL CONSERVATION DIVISION

P. O. BOX 2088  
SANTA FE, NEW MEXICO 87501

WELL COMPLETION OR RECOMPLETION REPORT AND LOG

NO. OF COPIES RECEIVED	
DISTRIBUTION	
SANTA FE	
FILE	
U.S.O.S.	
LAND OFFICE	
OPERATOR	

5a. Indicate Type of Lease  
State  Fee

5. State Oil & Gas Lease No.

TYPE OF WELL  
OIL WELL  GAS WELL  DRY  OTHER \_\_\_\_\_

TYPE OF COMPLETION  
RTW  WORK OVER  DEEPEN  PLUG BACK  DIFF. RESVR.  OTHER \_\_\_\_\_

7. Unit Agreement Name

8. Farm or Lease Name  
MUDDY COM

Name of Operator  
MESA PETROLEUM CO.

9. Well No.  
1

Address of Operator  
1000 VAUGHN BUILDING/MIDLAND, TX 79701-4493

10. Field and Pool, or Wildcat  
PECOS SLOPE ABO

Location of Well  
LETTER N LOCATED 500 FEET FROM THE SOUTH LINE AND 2080 FEET FROM WEST

12. County  
CHAVES

LINE OF SEC. 29 TWP. 7S RGE. 26E

14. Date Spudded 3-13-82	16. Date T.D. Reached 3-23-82	17. Date Compl. (Ready to Prod.) 4-20-82	18. Elevations (DF, RKB, RT, GR, etc.) 3562' GR	19. Elev. Casinghead 3562'
20. Total Depth 4344'	21. Plug Back T.D. 4255'	22. If Multiple Compl., How Many Many	23. Intervals Drilled By Rotary Tools ALL	24. Cable Tools

25. Producing Interval(s), of this completion - Top, Bottom, Name  
3728' --- 3887', ABO

26. Type Electric and Other Logs Run  
GR-CLL/GR-CNL-FDC

27. Was Well Cored  
NO

CASING RECORD (Report all strings set in well)

CASING SIZE	WEIGHT LB./FT.	DEPTH SET	HOLE SIZE	CEMENTING RECORD	AMOUNT PULLED
13 3/8"	48#	900'	17 1/2"	700 Thixalite/300 "C"	
8 5/8"	24#	1807'	12 1/4"	700 Thixalite/300 "C"	
4 1/2"	10.5#	4308'	6 1/2"	650 "C"	

LINER RECORD

30. TUBING RECORD

SIZE	TOP	BOTTOM	SACKS CEMENT	SCREEN	SIZE	DEPTH SET	PACKER SET
					2 3/8"	3629'	-

28. Perforation Record (Interval, size and number)  
3728', 32', 61', 63', 3878', 80', 81', 84', 86', 87'; total of 20 holes  
3 1/8" csg gun 2 JSPF

32. ACID, SHOT, FRACTURE, CEMENT SQUEEZE, ETC.

DEPTH INTERVAL	AMOUNT AND KIND MATERIAL USED
3728' --- 3887'	A/3250 gal 7 1/2% HCL + 50 BS
3728' --- 3887'	F/49,400 gal XLink gel KCL & CO2 + 110,000# 20/40 sd + 44,000# 10/20 sd

PRODUCTION

29. First Production  
Production Method (Flowing, gas lift, pumping - Size and type pump)  
FLOWING  
Well Status (Prod. or Shut-in)  
SHUT-IN

Date of Test 4-20-82	Hours Tested 1	Choke Size -	Prod'n. For Test Period →	Oil - Bbl. -	Gas - MCF 23	Water - Bbl. -	Gas - Oil Ratio -
Flow Tubing Press. 175	Casing Pressure 275	Calculated 24-Hour Rate →	Oil - Bbl. -	Gas - MCF CAOF=600	Water - Bbl. -	Oil Gravity - API (Corr.) -	

31. Disposition of Gas (Sold, used for fuel, vented, etc.)  
VENTED  
Test Witnessed By  
E. L. BUTTROSS, JR.

33. List of Attachments  
C-122, RECORD OF INCLINATION

I hereby certify that the information shown on both sides of this form is true and complete to the best of my knowledge and belief.

SIGNED R. E. May TITLE REGULATORY COORDINATOR DATE 5-4-82

XC: NMOCD (6), TLS, CEN RCDS, ACCTG, MEC, MAH, D&M, MTS (3), LMC, CTY, ROSWELL, EEB, REM, K, TW, FILE,

INSTRUCTIONS

This form is to be filed with the appropriate District Office of the Division not later than 20 days after the completion of any newly-drilled or deepened well. It shall be accompanied by one copy of all electrical and radio-activity logs run on the well and a summary of all special tests conducted, including drill stem tests. All depths reported shall be measured depths. In the case of directionally drilled wells, true vertical depths shall also be reported. For multiple completions, Items 30 through 34 shall be reported for each zone. The form is to be filed in quadruplicate except on state land, where six copies are required. See Rule 1105.

INDICATE FORMATION TOPS IN CONFORMANCE WITH GEOGRAPHICAL SECTION OF STATE

Southeastern New Mexico

Northwestern New Mexico

T. Anhy _____	T. Canyon _____	T. Ojo Alamo _____	T. Penn. "B" _____
T. Salt _____	T. Strawn _____	T. Kirtland-Fruitland _____	T. Penn. "C" _____
B. Salt _____	T. Atoka _____	T. Pictured Cliffs _____	T. Penn. "D" _____
T. Yates _____	T. Miss _____	T. Cliff House _____	T. Leadville _____
T. 7 Rivers _____	T. Devonian _____	T. Menefee _____	T. Madison _____
T. Queen _____	T. Silurian _____	T. Point Lookout _____	T. Elbert _____
T. Grayburg _____	T. Montoya _____	T. Mancos _____	T. McCracken _____
T. San Andres <u>492'</u>	T. Simpson _____	T. Gallup _____	T. Ignacio Qtzte _____
T. Glorieta <u>1506'</u>	T. McKee _____	Base Greenhorn _____	T. Granite _____
T. Paddock _____	T. Ellenburger _____	T. Dakota _____	T. _____
T. Blinebry _____	T. Gr. Wash _____	T. Morrison _____	T. _____
T. Tubb <u>3006'</u>	T. Granite _____	T. Todilto _____	T. _____
T. Drinkard _____	T. Delaware Sand _____	T. Entrada _____	T. _____
T. Abo <u>3703'</u>	T. Bone Springs _____	T. Wingate _____	T. _____
T. Wolfcamp _____	T. _____	T. Chinle _____	T. _____
T. Penn. _____	T. _____	T. Permian _____	T. _____
T. Cisco (Bough C) _____	T. _____	T. Penn. "A" _____	T. _____

OIL OR GAS SANDS OR ZONES

No. 1, from <u>3720'</u> to <u>3770'</u>	No. 4, from _____ to _____
No. 2, from <u>3870'</u> to <u>3890'</u>	No. 5, from _____ to _____
No. 3, from _____ to _____	No. 6, from _____ to _____

IMPORTANT WATER SANDS

Include data on rate of water inflow and elevation to which water rose in hole.

No. 1, from _____ to _____ feet
No. 2, from _____ to _____ feet
No. 3, from _____ to _____ feet
No. 4, from _____ to _____ feet

FORMATION RECORD (Attach additional sheets if necessary)

From	To	Thickness in Feet	Formation	From	To	Thickness in Feet	Formation
DRILLER'S DEPTH'S							
	395'		REDBED				
	592'		SA/REDBED				
	788'		LM/ANHY				
	900'		LM/CHERT				
	1345'		LM/SH				
	1807'		LM/SH				
	2450'		LM/SH				
	3900'		SA/SH				
	4344'		ABO				

MESA PETROLEUM CO.  
MUDDY COM #1  
500' FSL & 2080' FWL, SEC 29, T7S, R26E  
CHAVES COUNTY, NEW MEXICO

RECORD OF INCLINATION

<u>DEPTH</u>	<u>DEVIATIONS</u>
734'	1/2°
900'	1°
1445'	1°
1807'	1 1/4°
2297'	1 1/2°
2792'	1 3/4°
3290'	1 3/4°
3789'	1 1/2°
4312'	1 1/2°



R. E. MATHIS, REGULATORY COORDINATOR

Subscribed and sworn to before me this 19th day of April, 1982.

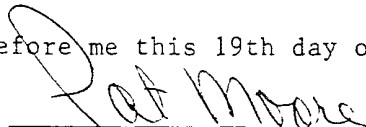
  
Notary Public in and for Midland  
County, Texas.

Commission Expires: JUNE 26, 1985



NEW MEXICO OIL CONSERVATION COMMISSION  
MULTIPOINT AND ONE POINT BACK PRESSURE TEST FOR GAS WELL

Form C-122  
Revised 9-1-65

Type Test <input checked="" type="checkbox"/> Initial <input type="checkbox"/> Annual <input type="checkbox"/> Special				Test Date 4-20-82	
Company Mesa Petroleum Co.			Connection UNCONNECTED		
Pool PECOS SLOPE ABO			Formation ABO		Unit
Completion Date 4-20-82		Total Depth 4344'	Plug Back TD 4255'	Elevation 3562'	Farm or Lease Name MUDDY COM
Csg. Size 4 1/2"	Wt. 10.5#	d	Set At 4308'	Perforations: From 3728' To 3887'	
Tbg. Size 2 3/8"	Wt. 4.7#	d	Set At 3629'	Perforations: From OPEN ENDED To	
Type Well - Single - Bradenhead - G.G. or G.O. Multiple SINGLE				Packer Set At NONE	County CHAVES
Producing Thru TUBING		Reservoir Temp. °F 102 @ 4344'	Mean Annual Temp. °F 60	Baro. Press. - P <sub>c</sub> 13.2	State NEW MEXICO
L	H	G <sub>g</sub> .65	% CO <sub>2</sub> 1	% N <sub>2</sub> 1	% H <sub>2</sub> S
Prover 2" ORIFICE WELL TESTER					

FLOW DATA							TUBING DATA		CASING DATA		Duration of Flow
NO.	Prover Line Size	X	Orifice Size	Press. p.s.i.g.	Diff. h <sub>w</sub>	Temp. °F	Press. p.s.i.g.	Temp. °F	Press. p.s.i.g.	Temp. °F	
SI							985		935		72 HR SI
1.	2" ORIFICE	1	1/4	6.5		70	175	71	275		1 HR
2.	WELL										
3.	TESTER										
4.											
5.											

RATE OF FLOW CALCULATIONS							
NO.	Coefficient (24 Hour)	$\sqrt{h_w P_m}$	Pressure P <sub>m</sub>	Flow Temp. Factor Ft	Gravity Factor F <sub>g</sub>	Super Compress. Factor, F <sub>pv</sub>	Rate of Flow Q, Mcfd
1	587	2" ORIFICE WELL		.9905	.9608		559
2.		TESTER					
3							
4.							
5							

NO.	P <sub>t</sub>	Temp. °R	T <sub>r</sub>	Z	Gas Liquid Hydrocarbon Ratio _____ Mcf/bbl.
1					A.P.I. Gravity of Liquid Hydrocarbons _____ Deg.
2.					Specific Gravity Separator Gas _____ X X X X X X X X X X
3.					Specific Gravity Flowing Fluid _____ X X X X X
4					Critical Pressure _____ P.S.I.A. _____ P.S.I.A.
5.					Critical Temperature _____ R _____ R

P<sub>c</sub> 948    P<sub>c</sub><sup>2</sup> 899

NO.	P <sub>t</sub> <sup>2</sup>	P <sub>w</sub>	P <sub>w</sub> <sup>2</sup>	P <sub>c</sub> <sup>2</sup> - P <sub>w</sub> <sup>2</sup>
1		288	83	816
2				
3				
4				
5				

(1)  $\frac{P_c^2}{P_c^2 - P_w^2} = 1.1017$     (2)  $\left[ \frac{P_c^2}{P_c^2 - P_w^2} \right]^n = 1.1017$

AOF = Q  $\left[ \frac{P_c^2}{P_c^2 - P_w^2} \right]^n = 600$

Absolute Oper. Flow 600 Mcfd @ 15.025    Angle of Slope @ 45°    Slope, n 1

Remarks: UNABLE TO RUN FOUR FLOW RATES DUE TO LOW DELIVERY OF WELL.  
ASSUMED N = 1 AND BASED CALCULATIONS ON ONE POINT TEST.

Approved By Commission:	Conducted By: JAMES CRAIG	Calculated By: E.L.B. 5-4-82	Checked By:
-------------------------	------------------------------	---------------------------------	-------------

MESA PETROLEUM CO.  
 MUDDY COM. NO. 1  
 CHAVES CO., NM  
 4-20-82

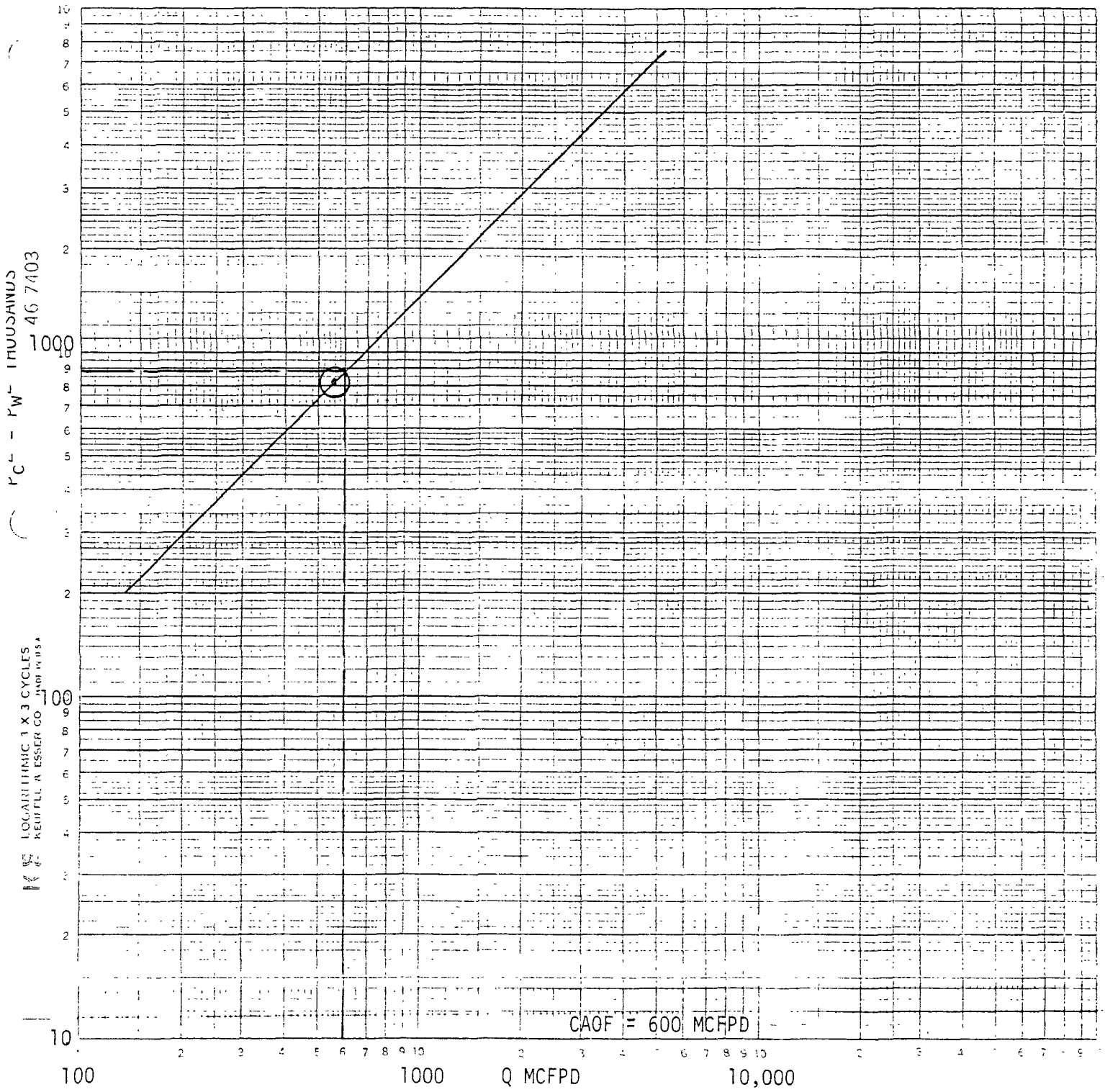

ASSUMED N = 1 AND  $\theta = 45^\circ$

NO. OF COPIES RECEIVED	
DISTRIBUTION	
SANTA FE	
FILE	
U.S.O.S.	
LAND OFFICE	
OPERATOR	

**RECEIVED**  
 JIL CONSERVATION DIVISION  
 P. O. BOX 2088  
 SANTA FE, NEW MEXICO 87501  
**RECEIVED**  
 APR 12 1982  
**O. C. D.**  
 ARTESIA, OFFICE

5a. Indicate Type of Lease  
 State  Fee   
 5. State Oil & Gas Lease No.

**SUNDRY NOTICES AND REPORTS ON WELLS**  
DO NOT USE THIS FORM FOR PROPOSALS TO DRILL OR TO DECEIN OR PLUG BACK TO DIFFERENT RESERVOIR. USE "APPLICATION FOR PERMIT" (FORM C-101) FOR SUCH PROPOSALS.

WELL	9-10
NO.	
REM	11-11
POS	
LINE AND	2080
FEET FROM	

1.  OIL WELL  GAS WELL  OTHER

2. Name of Operator  
**MESA PETROLEUM CO.**

3. Address of Operator  
**1000 VAUGHN BUILDING/MIDLAND, TX 79701-4493**

4. Location of Well  
 UNIT LETTER **N** **500** FEET FROM THE **SOUTH**  
 THE **WEST** LINE, SECTION **29** TOWNSHIP **7S** RANGE **26E** NMPM.  
 LINE AND **2080** FEET FROM **UNDESIGNATED ABO**

7. Unit Agreement Name  
 8. Farm or Lease Name  
**MUDDY COM**

9. Well No.  
**1**

10. Field and Pool, or wildcat  
**UNDESIGNATED ABO**

15. Elevation (Show whether DF, RT, GR, etc.)  
**3562' GR**

12. County  
**CHAVES**

16. Check Appropriate Box To Indicate Nature of Notice, Report or Other Data

NOTICE OF INTENTION TO:		SUBSEQUENT REPORT OF:	
PERFORM REMEDIAL WORK <input type="checkbox"/>	PLUG AND ABANDON <input type="checkbox"/>	REMEDIAL WORK <input type="checkbox"/>	ALTERING CASING <input type="checkbox"/>
TEMPORARILY ABANDON <input type="checkbox"/>	CHANGE PLANS <input type="checkbox"/>	COMMENCE DRILLING OPNS. <input type="checkbox"/>	PLUG AND ABANDONMENT <input type="checkbox"/>
PULL OR ALTER CASING <input type="checkbox"/>	OTHER <input type="checkbox"/>	CASING TEST AND CEMENT JOBS <input checked="" type="checkbox"/>	OTHER <input type="checkbox"/>

17. Describe Proposed or Completed Operations (Clearly state all pertinent details, and give pertinent dates, including estimated date of starting any proposed work) SEE RULE 1103.

Drilled 7 7/8" hole to TD of 4344' of 3-23-82. Stuck drill pipe on bottom. Shot off DP @ 3879' on 3-27-82. Left 14 -- 6 1/2" DC's in hole. Recovered all DC's on 4-3-82. Washed and rea to 4344'. Ran 106 jts 4 1/2", 10.5#, K-55 casing set at 4308'. Cemented with 650 sx "C" + 3/10% HALAD-4 + 2/10% CFR-2 + 2% KCL. PD @ 7 AM 4-5-82. Cement did not circulate. Released rig @ 12 Noon - 4-5-82. WOCU estimated to arrive 4-8-82.

XC: NMOCD (3), TLS, CEN RCDS, ACCTG, MEC, ROSWELL, REM, FILE (PARTNERS )

18. I hereby certify that the information above is true and complete to the best of my knowledge and belief.

SIGNED R. E. Mathis TITLE REGULATORY COORDINATOR DATE 4-6-82

APPROVED BY Mrs. Walker TITLE OIL AND GAS INSPECTOR DATE APR 9 1982

CONDITIONS OF APPROVAL, IF ANY:

Muddy Com #1



STATE OF NEW MEXICO  
ENERGY AND MINERALS DEPARTMENT  
OIL CONSERVATION DIVISION

BRUCE KING  
GOVERNOR  
LARRY KEHOE  
SECRETARY

March 30, 1982

POST OFFICE BOX 2088  
STATE LAND OFFICE BUILDING  
SANTA FE, NEW MEXICO 87501  
(505) 827-2434

RECEIVED

APR 2 1982

MESA-PBD

Mesa Petroleum Co.  
Vaughn Building  
Suite 1000  
Midland, Texas 79701

Attention: R. E. Mathis

Administrative Order NSL-1499

Gentlemen:

Reference is made to your application for a non-standard location for your Muddy Com Well No. 1 to be located 500 feet from the South line and 2080 feet from the West line of Section 29, Township 7 South, Range 26 East, NMPM, Chaves County, New Mexico.

By authority granted me under the provisions of Rule 104 F of the Division Rules and Regulations, the above-described unorthodox location is hereby approved.

Sincerely,

*Joe D. Ramey*  
JOE D. RAMEY,  
Director

JDR/RLS/dr

cc: Oil Conservation Division - Artesia  
Oil & Gas Engineering Committee - Hobbs  
Minerals Management Service - Artesia

MPH	4-5-82
WRM	4-6-82
<del>ELB</del>	
<del>BRH</del>	
REM	4-2-82
RLC	

NO. OF COPIES RECEIVED	
DISTRIBUTION	
SANTA FE	
FILE	
U.S.G.L.	
LAND OFFICE	
OPERATOR	

OIL CONSERVATION DIVISION RECEIVED

P. O. BOX 2088  
SANTA FE, NEW MEXICO 87501

MAR 23 1982

O. C. D.  
ARTESIA, OFFICE

MPH	326
WRM	Form C-103
E&B	Revised 11-1-79
State	3-29-82
S. State	

SUNDRY NOTICES AND REPORTS ON WELLS

DO NOT USE THIS FORM FOR PROPOSALS TO DRILL OR TO DEEPEN OR PLUG A WELL TO A DIFFERENT RESERVOIR.  
USE "APPLICATION FOR PERMIT" (FORM C-101) FOR SUCH PROPOSALS.

<input type="checkbox"/> OIL WELL <input checked="" type="checkbox"/> GAS WELL <input type="checkbox"/> OTHER	Name of Operator <b>MESA PETROLEUM CO</b> Address of Operator <b>1000 VAUGHN BUILDING/MIDLAND, TEXAS 79701-4493</b> Location of well _____ N _____ 500 _____ SOUTH _____ LINE AND _____ 2080 _____ FEET FROM _____ WEST _____ LINE, SECTION _____ 29 _____ TOWNSHIP _____ 7S _____ RANGE _____ 26E _____	7. Well Agreement Name 8. Term of Lease Name <b>Muddy Com</b> 9. Well No. <b>1</b> 10. Field and Pool, or Well Unit <b>Undesignated ABO</b> 11. Elevation (Show whether DF, RT, GR, etc.) <b>3562' GR</b> 12. County <b>Chaves</b>
---	--	--

Check Appropriate Box To Indicate Nature of Notice, Report or Other Data

NOTICE OF INTENTION TO:

SUBSEQUENT REPORT OF:

<input type="checkbox"/> PERFORM REMEDIAL WORK <input type="checkbox"/> TEMPORARILY ABANDON <input type="checkbox"/> FULL OR ALTER CASING <input type="checkbox"/> OTHER _____	<input type="checkbox"/> PLUG AND ABANDON <input type="checkbox"/> CHANGE PLANS <input type="checkbox"/> OTHER _____	<input type="checkbox"/> REMEDIAL WORK <input type="checkbox"/> COMMENCE DRILLING OPS. <input checked="" type="checkbox"/> CASING TEST AND CEMENT JOBS <input type="checkbox"/> OTHER _____	<input type="checkbox"/> ALTERING CASING <input type="checkbox"/> PLUG AND ABANDONMENT <input type="checkbox"/> OTHER _____
---	--	--	---

17. Describe Proposed or Completed Operations (Clearly state all pertinent details, and give pertinent dates, including estimated date of starting any proposed work) SEE RULE 1103.

Drilled 12 1/4" hole to 1807'. Hit brackish water @ 1671'---75 BPH. Ran 41 jts, 8 5/8", 24#, K-55 casing set at 1807'. Cemented with 700 sx Thixalite + 1/4# Flocele + 4% CaCl and tailed in with 300 sx "C" + 2% CaCl. PD at 4:00 a.m. 3-21-82. Circulated 100 sx. Tested BOPs and casing to 600 psi for 30 min.-ok. Reduced hole to 7 7/8" and drilled ahead on 3-22-82. WOC total of 18 hours.

RECEIVED

MAR 25 1982

MESA-PBD

XC: NMOCD(3), TLS, CEN RCDS, ACCTG, ROSWELL, MEC, PARTNERS, FILE, REM

18. I hereby certify that the information above is true and complete to the best of my knowledge and belief.

SIGNED R. E. Stathis TITLE REGULATORY COORDINATOR DATE 3-22-82

APPROVED BY M. H. Walker TITLE OIL AND GAS INSPECTOR DATE MAR 24 1982

CONDITIONS OF APPROVAL, IF ANY:

DATE RECEIVED	
DISTRIBUTION	
DATE	
FILE	
U.I.O.F.	
LAND OFFICE	
OPERATOR	

OIL CONSERVATION DIVISION  
 P. O. BOX 2080  
 SANTA FE, NEW MEXICO 87501

MAR 23 1982

O. C. D.

ARTESIA, OFFICE

MPH	326	Form C-103
WRM		Revised 10-1-75
INDICATE TYPE OF LOSS		
RRR		
DATE	3-20	
TIME	5:30	
NAME	PAT	

SUNDRY NOTICES AND REPORTS ON WELLS

DO NOT USE THIS FORM FOR PROPOSALS TO DRILL OR TO DEEPEN OR PLUG A WELL TO A DIFFERENT RESERVOIR.  
 USE APPLICATION FOR PERMIT - 11 (FORM C-101) FOR SUCH PROPOSALS.

WELL  OIL WELL  GAS WELL  OTHER

Name of Operator  
 MESA PETROLEUM CO /

Address of Operator  
 1000 VAUGHN BUILDING/MIDLAND, TEXAS 79701-4493

Location of Well  
 500 FEET FROM THE SOUTH LINE AND 2080 FEET FROM WEST SECTION 29 TOWNSHIP 7S RANGE 26E

11. Elevation (Show whether DF, RT, GR, etc.)  
 3562' GR

12. County  
 Chaves

8. Name of Lease Block  
 Muddy Com

9. Well No.  
 1

10. Field and Pool, or Wellbore  
 Undesignated ABO

Check Appropriate Box To Indicate Nature of Notice, Report or Other Data

NOTICE OF INTENTION TO:

STOPPED DRILLING WORK

TEMPORARILY ABANDON

WELL OR ALTER CASING

OTHER

PLUG AND ABANDON

CHANGE PLANS

SUBSEQUENT REPORT OF:

REMEDIAL WORK

COMMENCE DRILLING OTHS.

CASING TEST AND CEMENT JOBS

OTHER

ALTERING CASING

PLUG AND ABANDONMENT

Describe Proposed or Completed Operations (Clearly state all pertinent details, and give pertinent dates, including estimated date of starting any proposed work) SEE RULE 1103.

Spudded well with 17 1/2" hole on 3-13-82. Drilled to 500' and set one plug with 200 sx Thixset + 4% CaCl to stop drilling mud from coming up in mouse hole. Set additional 200 sx plug on 3-16-82. Drilled to 900' and ran 22 jts 13 3/8", 54.5#, K-55 casing set at 900'. Cemented with 700 sx Thixalite + 1/4# Flocele + 4% CaCl and tailed in with 300 sx "C" + 2% CaCl. PD at 11:00 p.m. 3-18-82. Circulated 100 sx. Blew hole dry and waited one hour-no fluid. Reduced hole to 12 1/4" and drilled ahead on 3-19-82. WOC total of 19 hours.

RECEIVED

MAR 25 1982

MESA-PBD

XC: NMOC(3), TLS, CEN RCDS, ACCTG, ROSWELL, MEC, PARTNERS, FILE, REM

I hereby certify that the information above is true and complete to the best of my knowledge and belief.

*R. E. Madson*

REGULATORY COORDINATOR

DATE 3-22-82

*Mike Williams*

OIL AND GAS INSPECTOR

DATE MAR 24 1982

OPTIONAL APPROVAL, IF ANY:

NO. OF COPIES RECEIVED	
DISTRIBUTION	
SANTA FE	
FILE	
U.S.G.S.	
LAND OFFICE	
OPERATOR	✓

**RECEIVED**  
 NEW MEXICO OIL CONSERVATION COMMISSION  
**MAR - 8 1982**  
 O. C. D.  
 AMENDED *Location* ARTESIA, OFFICE

30-005-61379  
 Form C-101  
 Revised 1-1-65

Indicate Type of Lease	<input type="checkbox"/>	CC <input checked="" type="checkbox"/>
Oil & Gas Lease No.		
7. Unit Agreement Name		
8. Farm or Lease Name	MUDDY COM	

**APPLICATION FOR PERMIT TO DRILL, DEEPEN, OR PLUG BACK**

1a. Type of Work		19. Proposed Depth		19A. Formation		20. Rotary or C.T.			
b. Type of Well OIL WELL <input type="checkbox"/> GAS WELL <input checked="" type="checkbox"/> OTHER <input type="checkbox"/>		DEEPEN <input type="checkbox"/>		4450'		ABO		ROTARY	
PLUG BACK <input type="checkbox"/>		SINGLE ZONE <input type="checkbox"/>		MULTIPLE ZONE <input type="checkbox"/>		9. Well No.		10. Field and Pool, or Wildcat	
2. Name of Operator		3. Address of Operator		12. County		CHAVES			
MESA PETROLEUM CO.		1000 VAUGHN BUILDING/MIDLAND, TX 79701-4493				1. Muddy Com		7. Unit Agreement Name	
4. Location of Well		UNIT LETTER <u>N</u> LOCATED <u>500</u> FEET FROM THE <u>SOUTH</u> LINE		21. Elevations (Show whether DF, RT, etc.)		21A. Kind & Status Plug. Bond		21B. Drilling Contractor	
AND <u>2080</u> FEET FROM THE <u>WEST</u> LINE OF SEC. <u>29</u> TWP. <u>7S</u> RGE. <u>26E</u> NMPM				3562' GR		BLANKET		TOM BROWN DRILLING	
				22. Approx. Date Work will start		MARCH 12, 1982			

**PROPOSED CASING AND CEMENT PROGRAM**

SIZE OF HOLE	SIZE OF CASING	WEIGHT PER FOOT	SETTING DEPTH	SACKS OF CEMENT	EST. TOP
17 1/2"	13 3/8"	48#	900'	300/200/300	SURFACE
11" or 12 1/4"	8 5/8"	24#	1600'	500/300	ISOLATE WTR, O&G
7 7/8"	4 1/2"	10.5#	4450'	500/500	COVER ALL PAY

Propose to drill 17 1/2" hole to approximately 900', set 13 3/8" surface casing and cement to surface. Will reduce hole to 11" or 12 1/4" and drill to 1600' to set 8 5/8" casing. Will reduce hole to 7 7/8", nipple up RAM type BOP's, and drill to total depth. Drilling medium will be air, foam, or mud as required.

OPERATOR'S GAS SALES ARE DEDICATED.

NOTE: Local Flow Impeded due to the presence of surface ground water.

**MAR 18 1982**

**MESA-PBD**

APPROVAL VALID FOR 180 DAYS  
 PERMIT EXPIRES 9-15-82  
 UNLESS DRILLING UNDERWAY

XC: NMOCD (6), TLS, CEN RCDS, ACCTG, ROSWELL, MEC, LAND, PARTNERS, FILE, REM

IN ABOVE SPACE DESCRIBE PROPOSED PROGRAM; IF PROPOSAL IS TO DEEPEN OR PLUG BACK, GIVE DATA ON PRESENT PRODUCTIVE ZONE AND PROPOSED NEW PRODUCTIVE ZONE. GIVE BLOWOUT PREVENTER PROGRAM, IF ANY.

I hereby certify that the information above is true and complete to the best of my knowledge and belief.

Signed R. E. Mack Title REGULATORY COORDINATOR Date MARCH 4, 1982

(This space for State Use)

APPROVED BY Mike Williams TITLE Oil and Gas Division DATE MAR 16 1982

CONDITIONS OF APPROVAL, IF ANY:

*NSL must be approved prior to Producing*

All distances must be from the outer boundaries of the Section.

Operator Mesa Petroleum Co.		Lease Muddy Com.		Well No. 1
Unit Letter N	Section 29	Township 7 South	Range 26 East	County Chaves
Actual Postage Location of Well: 500 feet from the South line and 2080 feet from the West line				
Ground Level Elev. 3562	Producing Formation ABO	Pool UNDESIGNATED	Dedicated Acreage: SW/4 160 Acres	

1. Outline the acreage dedicated to the subject well by colored pencil or hachure marks on the plat below.
2. If more than one lease is dedicated to the well, outline each and identify the ownership thereof (both as to working interest and royalty).
3. If more than one lease of different ownership is dedicated to the well, have the interests of all owners been consolidated by communitization, unitization, force-pooling, etc?

Yes  No If answer is "yes," type of consolidation COMMUNITIZATION IN PROGRESS

If answer is "no," list the owners and tract descriptions which have actually been consolidated. (Use reverse side of this form if necessary.) \_\_\_\_\_

No allowable will be assigned to the well until all interests have been consolidated (by communitization, unitization, forced-pooling, or otherwise) or until a non-standard unit, eliminating such interests, has been approved by the Division.

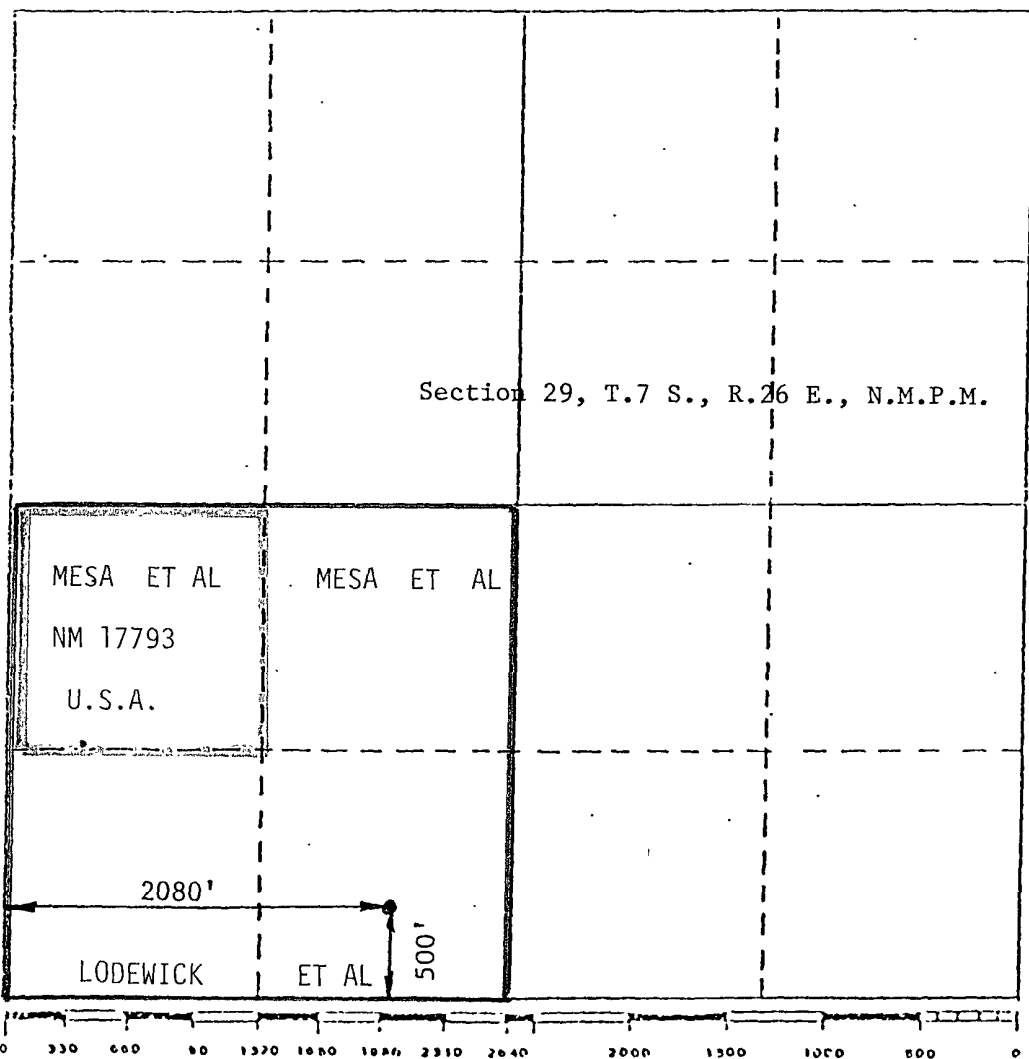

CERTIFICATION

I hereby certify that the information contained herein is true and complete to the best of my knowledge and belief.

*R. E. Mathis*

Name	R. E. MATHIS
Position	REGULATORY COORDINATOR
Company	MESA PETROLEUM CO.
Date	MARCH 4, 1982

I hereby certify that the well location shown on this plat was plotted from field notes of actual surveys made by me or under my supervision, and that the same is true and correct to the best of my knowledge and belief.

Date Survey	March 4, 1982
Registered Professional Engineer and/or Land Surveyor	John D. Jaques, No. 6290
Certificate No.	6290

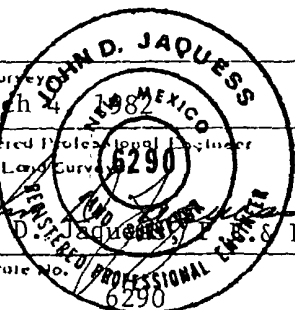





March 4, 1982

Joe D. Ramey, Director  
New Mexico Oil Conservation Division  
P. O. Box 2088  
Santa Fe, New Mexico 87501

Dear Mr. Ramey:

Subject: Mesa Petroleum Co.  
Muddy Com #1  
500' FSL & 2080' FWL  
Sec 29, T7S, R26E  
Chaves County, New Mexico

Application is hereby made for administrative approval of an unorthodox location for subject well due to topography.

Exhibit I is the Form C-102 showing mineral lease holder for the proposed proration unit, Exhibit II is the topographic plat showing the area in question and Exhibit III is a land plat showing offset operators notified by certified mail of this request.

The applied for location was chosen to provide 5' of relief necessary to get the pad above the prevailing ground water level which was found to be at the surface at the orthodox locations and could have posed a threat to the safety of the drilling rig and personnel.

Expeditious handling of this request is appreciated.

Yours truly,

MESA PETROLEUM CO.

A handwritten signature in cursive script, appearing to read 'R. E. Mathis', with a long horizontal line extending to the right.

R. E. Mathis  
Regulatory Coordinator

/pm

**RECEIVED**

**MAR 8 - 1982**

**AMARILLO PRODUCTION**

XC: YATES PETROLEUM, SUN OIL, CORONA, MTS

BXC: NMOCD-A, TLS, CEN RCDS, ACCTG, ROSWELL, MEC, REM, SJ

All distances must be from the outer boundaries of the Section.

Operator Mesa Petroleum Co.		Lease Muddy Com.		Well No. 1
Unit Letter N	Section 29	Township 7 South	Range 26 East	County Chaves
Actual Postage Location of Well:				
500	feet from the	South	line and	2080
			feet from the	West
Ground Level Elev. 3562	Producing Formation ABO	Pool UNDESIGNATED	Dedicated Acreage: SW/4 160 Acres	

1. Outline the acreage dedicated to the subject well by colored pencil or hachure marks on the plat below.
2. If more than one lease is dedicated to the well, outline each and identify the ownership thereof (both as to working interest and royalty).
3. If more than one lease of different ownership is dedicated to the well, have the interests of all owners been consolidated by communitization, unitization, force-pooling, etc?

Yes  No If answer is "yes," type of consolidation COMMUNITIZATION IN PROGRESS

If answer is "no," list the owners and tract descriptions which have actually been consolidated. (Use reverse side of this form if necessary.)

No allowable will be assigned to the well until all interests have been consolidated (by communitization, unitization, forced-pooling, or otherwise) or until a non-standard unit, eliminating such interests, has been approved by the Division.

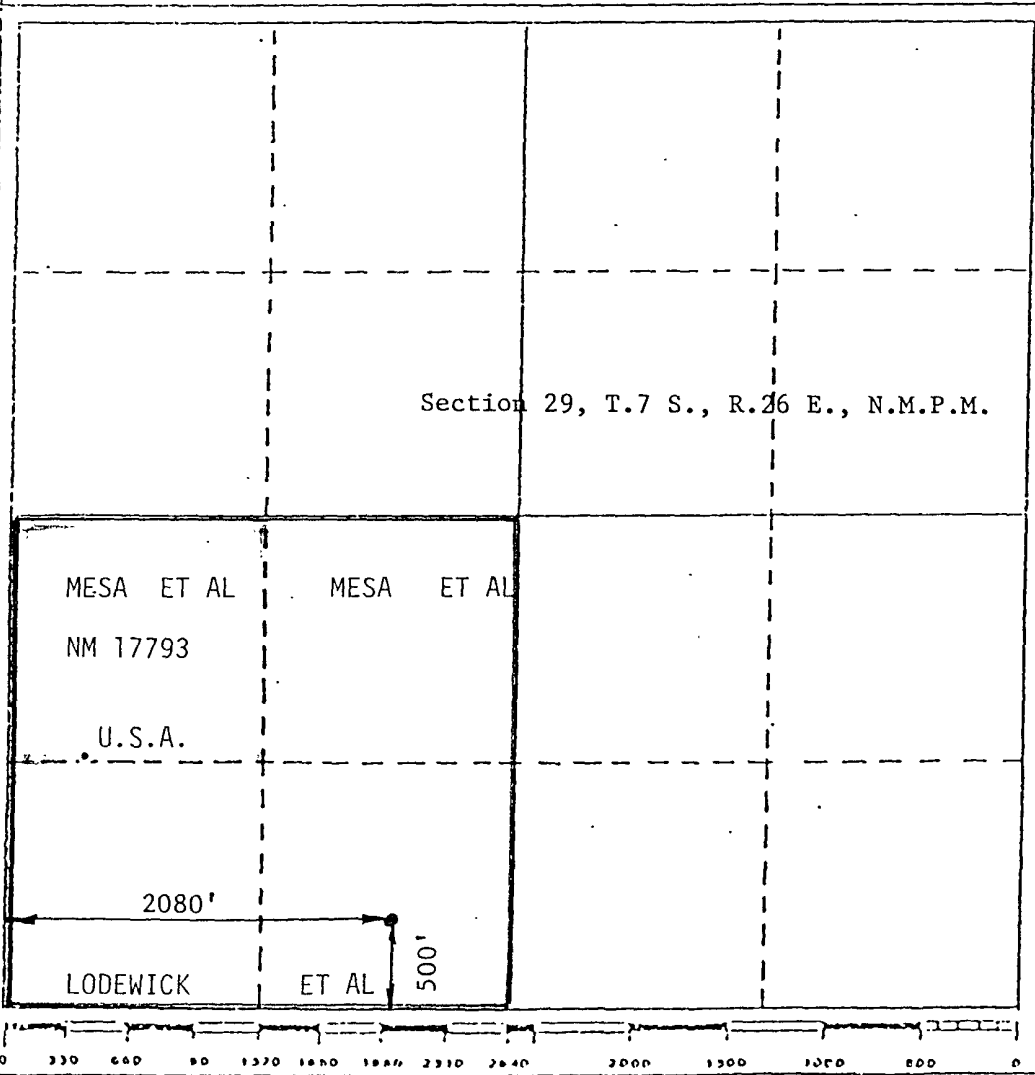

CERTIFICATION

I hereby certify that the information contained herein is true and complete to the best of my knowledge and belief.

*R. E. Mathis*

Name R. E. MATHIS
Position REGULATORY COORDINATOR
Company MESA PETROLEUM CO.
Date MARCH 4, 1982



I hereby certify that the well location shown on this plat was plotted from field notes of actual surveys made by me or under my supervision, and that the same is true and correct to the best of my knowledge and belief.

Date Surveyed  
March 4, 1982

Registered Professional Engineer and/or Land Surveyor  
6290

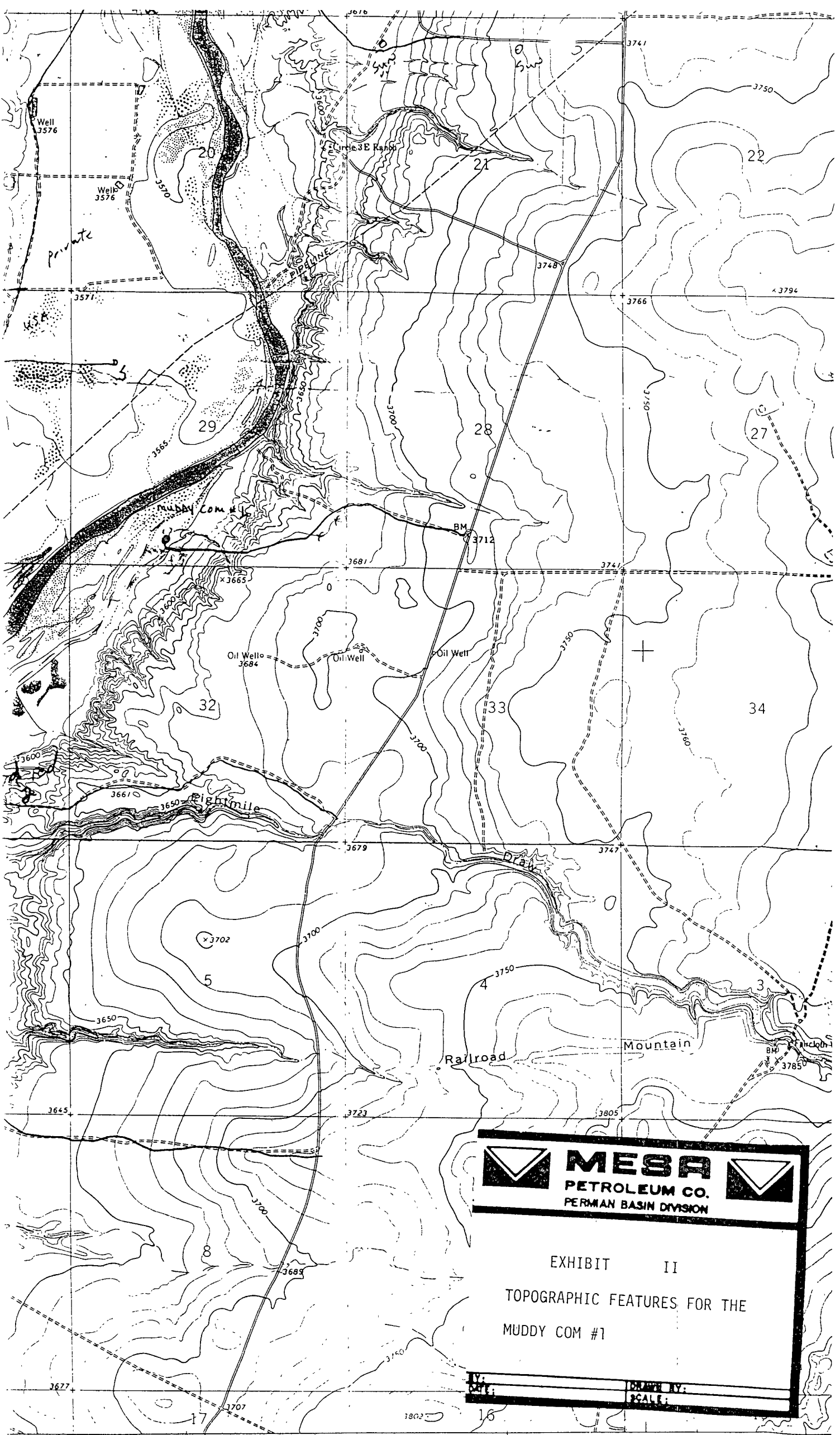
John D. Jaquess  
REGISTERED PROFESSIONAL ENGINEER L.S.  
6290



 <b>MESA</b> 	
<b>PETROLEUM CO.</b> PERMAN BASIN DIVISION	
EXHIBIT II TOPOGRAPHIC FEATURES FOR THE MUDDY COM #1	
BY: _____ DATE: _____	DRAWN BY: _____ SCALE: _____

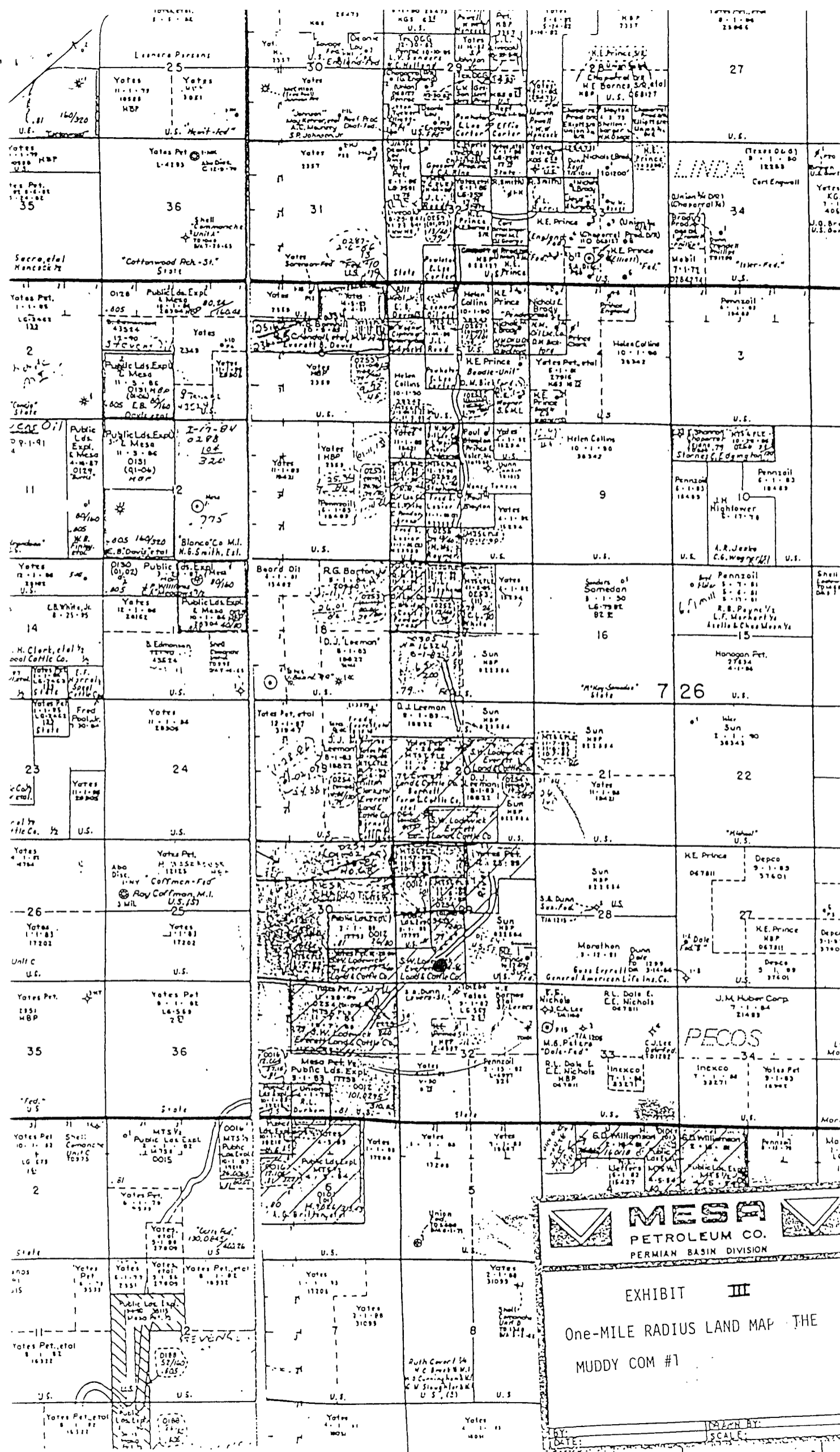

EXHIBIT III  
 One-MILE RADIUS LAND MAP THE  
 MUDDY COM #1

DATE: \_\_\_\_\_  
 SCALE: \_\_\_\_\_

RECEIVED

P. O. BOX 2000  
SANTA FE, NEW MEXICO 87501

JAN 22 1982

O. C. D.

ARTESIA, OFFICE

30-1005-61379  
Form O-101-101  
Revised 10-27-78  
E.D.B.  
5A. Indicate Type of Lease  
Basis  
5. State Oil & Gas Lease No.  
Dist 1 FILE  
1-27-82

NO. OF COPIES RECEIVED	
DISTRIBUTION	
SANTA FE	
FILE	
O.C.D.	
LAND OFFICE	
OPERATOR	

APPLICATION FOR PERMIT TO DRILL, DEEPEN, OR PLUG BACK

1a. Type of Work  
 b. Type of Well DRILL  DEEPEN  PLUG BACK   
 OIL WELL  GAS WELL  OTHER  SINGLE ZONE  MULTIPLE ZONE   
 2. Name of Operator MESA PETROLEUM CO  
 3. Address of Operator 1000 VAUGHN BUILDING/MIDLAND, TEXAS 79701-4493  
 4. Location of Well UNIT LETTER N LOCATED 660 FEET FROM THE South LINE  
 1980 FEET FROM THE West LINE OF SEC. 29 TWP. 7S RCP. 26E M.M.P.M.  
 7. Unit Assignment Name  
 8. Term of Lease Name Muddy Com  
 9. Well No. 1  
 10. Field and Pool, or Wildcat Undesignated ABO  
 17. County Chaves  
 19. Proposed Depth 4450'  
 19a. Formation ABO  
 20. Rotary or C.T. ROTARY  
 21. Deviations (Show whether DF, R, etc.) 3558.9' GR  
 21a. Kind & Status Plug. Bond BLANKET  
 21b. Drilling Contractor Desert Drilling  
 22. Approx. Date Work will start March 1, 1982

PROPOSED CASING AND CEMENT PROGRAM

SIZE OF HOLE	SIZE OF CASING	WEIGHT PER FOOT	SETTING DEPTH	SACKS OF CEMENT	EST. TOP
17 1/2"	13 3/8"	48#	900'	300/200/300	SURFACE
11"	8 5/8"	24#	1600'	500/300	ISOLATE WTR, O&G
7 7/8"	4 1/2"	10.5#	4450'	500/500	COVER ALL PAY

Propose to drill 17 1/2" hole to approximately 900', set 13 3/8" surface casing and cement to surface. Will reduce hole to 11" and drill to 1600' to set 8 5/8" casing. Will reduce hole to 7 7/8", nipple up RAM type BOP's, and drill to total depth. Drilling medium will be air, foam, or mud as required.

Gas Sales are dedicated.

RECEIVED

JAN 27 1982

APPROVAL VALID FOR 180 DAYS  
 PERMIT EXPIRES 7-26-82  
 UNLESS DRILLING UNDERWAY

MESA-PBD

XC: NMOCD(6), TLS, CEN RCDS, ACCTG, ROSWELL, MEC, LAND, PARTNERS, FILE, REM

ABOVE SPACE DESCRIBE PROPOSED PROGRAM; IF PROPOSAL IS TO DEEPEN OR PLUG BACK, GIVE DATA ON PRESENT PRODUCTIVE ZONE AND PROPOSED NEW PAY ZONE. GIVE BLOWOUT PREVENTER PROGRAM, IF ANY.

I hereby certify that the information above is true and complete to the best of my knowledge and belief.

By R. P. Mathis Title REGULATORY COORDINATOR Date 1-21-82

(This space for State Use)

PROVED BY Mike Williams TITLE OIL AND GAS INSPECTOR DATE JAN 26 1982

CONDITIONS OF APPROVAL, IF ANY:

Notify N.M.O.C.C. in sufficient time to witness cementing

the 13 3/8" casing

NEW MEXICO OIL CONSERVATION COMMISSION  
WELL LOCATION AND ACREAGE DEDICATION PLAT

Form C-102  
Supersedes C-128  
Effective 1-1-65

All distances must be from the outer boundaries of the Section

Operator <b>Mesa Petroleum Company</b>			Lease <b>Muddy Con.</b>			Well No. <b>1</b>		
Unit Letter <b>N</b>	Section <b>29</b>	Township <b>7 South</b>	Range <b>26 East</b>	County <b>Chaves</b>				
Actual Footage Location of Well: <b>660</b> feet from the <b>south</b> line and <b>1980</b> feet from the <b>west</b> line								
Ground Level Elev. <b>3558.9'</b>	Producing Formation <b>ABO</b>		Pool <b>UNDESIGNATED</b>			Dedicated Acreage <b>SW/4 160</b> Acres		

- Outline the acreage dedicated to the subject well by colored pencil or hachure marks on the plat below.
- If more than one lease is dedicated to the well, outline each and identify the ownership thereof (both as to working interest and royalty).
- If more than one lease of different ownership is dedicated to the well, have the interests of all owners been consolidated by communitization, unitization, force-pooling, etc?

Yes  No If answer is "yes," type of consolidation Communitization in Progress

If answer is "no," list the owners and tract descriptions which have actually been consolidated (Use reverse side of this form if necessary.) \_\_\_\_\_  
No allowable will be assigned to the well until all interests have been consolidated (by communitization, unitization, forced-pooling, or otherwise) or until a non-standard unit, eliminating such interests, has been approved by the Commission.

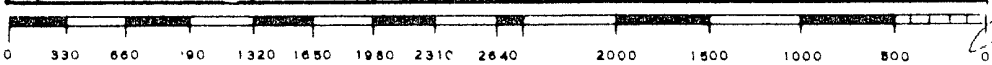
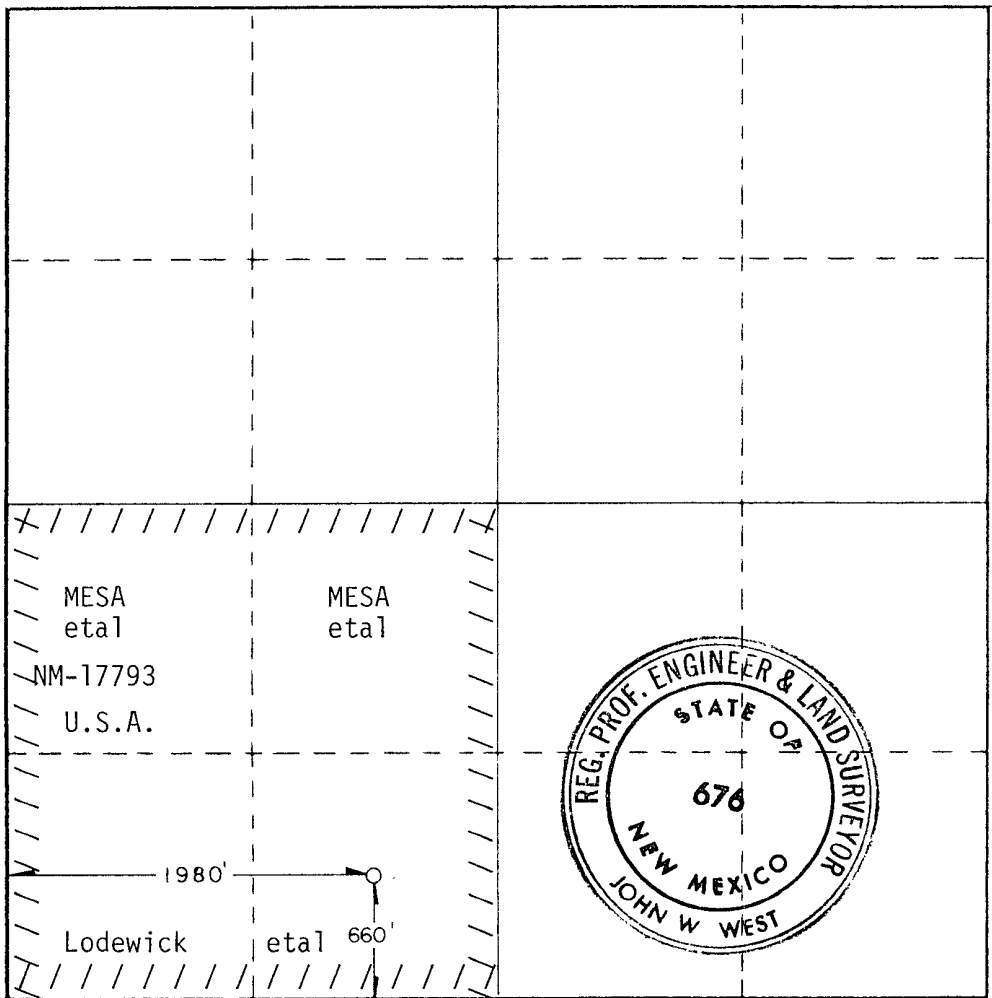

CERTIFICATION	
I hereby certify that the information contained herein is true and complete to the best of my knowledge and belief	
<i>R. E. Mathis</i>	
Name	<b>R. E. MATHIS</b>
Position	<b>REGULATORY COORDINATOR</b>
Company	<b>MESA PETROLEUM CO.</b>
Date	<b>1-21-82</b>
I hereby certify that the well location shown on this plat was plotted from field notes of actual surveys made by me or under my supervision, and that the same is true and correct to the best of my knowledge and belief	
Date Surveyed	<b>1-10-82</b>
Registered Professional Engineer and/or Land Surveyor	
<i>John W. West</i>	
Certificate No.	<b>JOHN W WEST 676</b>
	<b>PATRICK A ROMERO 6863</b>
	<b>Ronald J Eidson 3239</b>