

UNITED STATES
DEPARTMENT OF THE INTERIOR
BUREAU OF LAND MANAGEMENT
CONFIDENTIALOCD-ARTESIA
JAN 27 2009FORM APPROVED
OMB NO. 1004-0137
Expires March 31, 2007

WELL COMPLETION OR RECOMPLETION REPORT AND LOG

| | | | | | | | | | |
|---|---|---|---------------------|------------------------|-------------------------|---------------------------------|-----------------------|-------------------|-------------------|
| 1a. Type of Well <input type="checkbox"/> Oil Well <input checked="" type="checkbox"/> Gas Well <input type="checkbox"/> Dry <input type="checkbox"/> Other | | 5. Lease Serial No. NM-101097 | | | | | | | |
| b. Type of Completion: <input type="checkbox"/> New Well <input type="checkbox"/> Work Over <input type="checkbox"/> Deepen <input type="checkbox"/> Plug Back <input type="checkbox"/> Diff. Resvr Other | | 6. If Indian, Allottee or Tribe Name | | | | | | | |
| 2. Name of Operator Cimarex Energy Co. of Colorado | | 7. Unit or CA Agreement Name and No. | | | | | | | |
| 3. Address 5215 N. O'Connor Blvd ste 1500 Irving Tx. 75039 | | 8. Lease Name and Well No. Tank 29 federal No. 2 | | | | | | | |
| 3a. Phone No. (include area code) 972-401-3111 | | 9. API Well No. 30-015-35690 | | | | | | | |
| 4. Location of Well (Report Location clearly and in accordance with Federal requirements)* At surface 660 FNL & 2480' FEL At top prod. interval reported below 660' FNL & 2480' FEL At total depth 725' FNL & 672' FWL | | 10. Field and Pool, or Exploratory Wolfcamp; Wildcat (GAS) 97489 11. Sec., T., R., M., on Block and Survey or Area 29-25S-26E 12. County or Parish Eddy | | | | | | | |
| 14. Date Spudded 08.07.08 | | 15. Date T D. Reached 09.29.08 | | | | | | | |
| 16. Date Completed <input type="checkbox"/> D & A <input checked="" type="checkbox"/> Ready to Prod. | | 17. Elevations (DF, RKB, RT, GL)* 3440' GR | | | | | | | |
| 18. Total Depth: MD 11325' Pilot hole 10120' TVD 9244' | | 19. Plug Back TD: MD 11232' pilot hole 9108' TVD 9244' | | | | | | | |
| 20. Depth Bridge Plug Set: 9108' | | 21. Type Electric & Other Mechanical Logs Run (Submit copy of each) CBL, DSNR, DLL, GR | | | | | | | |
| 22. Was well cored? <input checked="" type="checkbox"/> No <input type="checkbox"/> Yes (Submit analysis) Was DST run? <input checked="" type="checkbox"/> No <input type="checkbox"/> Yes (Submit report) Directional Survey <input type="checkbox"/> No <input checked="" type="checkbox"/> Yes (Submit copy) | | | | | | | | | |
| 23. Casing and Liner Record (Report all strings set in well) | | | | | | | | | |
| Hole Size | Size/Grade | Wt. (#/ft.) | Top (MD) | Bottom (MD) | Stage Cementer Depth | No. of Sks. & Type of Cement | Slurry Vol. (BBL) | Cement Top* | Amount Pulled |
| 17 1/2" | 13 3/8" H40 STC | 24# | 0' | 260' | | 250 sx Prem plus | | 0' circ | |
| 12 1/4" | 9 5/8" J-55 LTC | 40# | 0' | 2730' | | 1200 sx class C | | 0' circ | |
| 8 3/4" | 7" P-110 LTC | 26# | 0' | 10113' | | 1435 sx class H | | 0' circ | |
| 6 1/8" | 4 1/2" P-110 BTC | 11.6# | 9029' | 9876' | | 400 sx versacem | | 9029' | |
| | 4 1/2" P-110 LTC | 11.6# | 9896' | 11325' | | | | | |
| 24. Tubing Record | | | | | | | | | |
| Size | Depth Set (MD) | Packer Depth (MD) | Size | Depth Set (MD) | Packer Depth (MD) | Size | Depth Set (MD) | Packer Depth (MD) | |
| 2 3/8" | 8978' | 8,966' | AS-1 7" X 2 7/8" | | | | | | |
| 25. Producing Intervals | | | | 26. Perforation Record | | | | | |
| Formation | Top | Bottom | Perforated Interval | Size | No. Holes | Perf. Status | | | |
| A) Wolfcamp | TVD 8468' | TVD 10134' | TMD 10984'-11225' | 0.42 | 96 | open | | | |
| B) Wolfcamp | TVD 8468' | TVD 10134' | TMD 10553'-10836' | 0.42 | 96 | open | | | |
| C) Wolfcamp | TVD 8468' | TVD 10134' | TMD 10092'-10372' | 0.42 | 96 | open | | | |
| D) Wolfcamp | TVD 8468' | TVD 10134' | TMD 9590'-9904' | 0.42 | 96 | open | | | |
| 27. Acid, Fracture, Treatment, Cement Squeeze, etc. | | | | | | | | | |
| Depth Interval | Amount and Type of Material | | | | | | | | |
| 10984'-11225' | Pump 1000 gals 15% HCL. Pumped 438270 gals Slickwater, 18375# of 100 mesh 30/50 White sand. | | | | | | | | |
| 10553'-10872' | Pump 2000 gals 15% HCL. Pumped 426342 gals Slickwater, 61354# of 100 mesh 30/50 White sand. | | | | | | | | |
| 10092'-10372' | Pump 1000 gals 15% HCL. Pumped 471417 gals Slickwater, 12471# of 100 mesh 30/50 White sand. | | | | | | | | |
| 9590'-9904' | Pump 2000 gals 15% HCL. Pumped 543950 gals Slickwater, 89332# of 100 mesh 30/50 White sand. | | | | | | | | |
| 28. Production - Interval A | | | | | | | | | |
| Date First Produced | Test Date | Hours Tested | Test Production | Oil BBL | Gas MCF | Water BBL | Oil Gravity Corr. API | Gas Gravity (BTU) | Production Method |
| 11.09.08 | 11.22.08 | 24 | → | 44 | 758 | 214 | 54.07 | 1.147 | Flowing |
| Choke Size | Tbg Press Flwg | Csg. Press. | 24 Hr. Rate | Oil BBL | Gas MCF | Water BBL | Gas/Oil Ratio | Well Status | |
| open | SI | 300 | → | 44 | 758 | 214 | 17227 | Producing | |
| 28. Production - Interval B | | | | | | | | | |
| Date First Produced | Test Date | Hours Tested | Test Production | Oil BBL | Gas MCF | Water BBL | Oil Gravity Corr. API | Gas Gravity | Production Method |
| | | | → | | | | | | |
| Choke Size | Tbg Press. Flwg | Csg. Press. | 24 Hr. Rate | Oil BBL | Gas MCF | Water BBL | Gas/Oil Ratio | Well Status | |
| SI | | | → | | | | | | |

* (See instructions and spaces for additional data on page 2)

Accepted for record - NMOCD

28b. Production - Interval C

| Date First Produced | Test Date | Hours Tested | Test Production → | Oil BBL | Gas MCF | Water BBL | Oil Gravity Corr. API | Gas Gravity | Production Method |
|---------------------|-------------------------|--------------|----------------------|---------|---------|-----------|--------------------------|-------------|-------------------|
| Choke Size | Tbg Press Flwg SI | Csg Press | 24 Hr. Rate → | Oil BBL | Gas MCF | Water BBL | Gas/Oil Ratio | Well Status | |

28c. Production - Interval D

| Date First Produced | Test Date | Hours Tested | Test Production → | Oil BBL | Gas MCF | Water BBL | Oil Gravity Corr. API | Gas Gravity | Production Method |
|---------------------|-------------------------|--------------|----------------------|---------|---------|-----------|--------------------------|-------------|-------------------|
| Choke Size | Tbg Press Flwg SI | Csg Press | 24 Hr. Rate → | Oil BBL | Gas MCF | Water BBL | Gas/Oil Ratio | Well Status | |

29. Disposition of Gas (*Sold, used for fuel, vented, etc.*)

Sold

30. Summary of Porous Zones (Include Aquifers):

Show all important zones of porosity and contents thereof. Cored intervals and all drill-stem tests, including depth interval tested, cushion used, time tool open, flowing and shut-in pressures and recoveries.

31. Formation (Log) Markers

| Formation | Top | Bottom | Descriptions, Contents, etc. | Name | Top |
|-----------|-----|--------|------------------------------|---------------|-------------|
| | | | | | Meas. Depth |
| | | | | Base Salt | 1,788' |
| | | | | Delaware | 1,861' |
| | | | | Cherry Canyon | 2,776' |
| | | | | Bone Springs | 5,365' |
| | | | | Wolfcamp | 8,468' |
| | | | | Cisco-Canyon | 10,134' |
| | | | | Strawn | 10,421' |
| | | | | Atoka | 10,621' |
| | | | | Morrow | 11,245' |

32. Additional remarks (include plugging procedure):

33. Indicate which items have been attached by placing a check in the appropriate boxes:

☐ Electrical/Mechanical Logs (1 full set req'd)
 ☐ Geologic Report
 ☐ DST Report
 ☒ Directional Survey
☐ Sundry Notice for plugging and cement verification
 ☐ Core Analysis
 ☐ Other:

34. I hereby certify that the foregoing and attached information is complete and correct as determined from all available records (see attached instructions)*

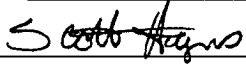
Name (please print) Scott Haynes Title Regulatory Analyst
 Signature  Date January 14, 2009

DISTRICT I
1625 N. French Dr., Hobbs, NM 88240

DISTRICT II
1301 W. Grand Avenue, Artesia, NM 88210

DISTRICT III
1000 Rio Bravos Rd., Aztec, NM 87410

DISTRICT IV
1220 S. St. Francis Dr., Santa Fe, NM 87505

State of New Mexico
Energy, Minerals and Natural Resources Department

Form C-102
Revised October 12, 2005

Submit to Appropriate District Office
State Lease - 4 Copies
Fee Lease - 3 Copies

OIL CONSERVATION DIVISION
1220 South St. Francis Dr.
Santa Fe, New Mexico 87505

☐ AMENDED REPORT

WELL LOCATION AND ACREAGE DEDICATION PLAT

| | | |
|----------------------------|---|-------------------------------|
| API Number 30-015-35690 | Pool Code | Pool Name Wolfcamp Wildcat |
| Property Code | Property Name TANK "29" FEDERAL | Well Number 2 |
| OGRID No. 162683 | Operator Name CIMAREX ENERGY CO. OF COLORADO | Elevation 3440' |

Surface Location

| | | | | | | | | | |
|--------------------|---------------|------------------|---------------|---------|----------------------|---------------------------|-----------------------|------------------------|----------------|
| UL or lot No. B | Section 29 | Township 25 S | Range 26 E | Lot Idn | Feet from the 660 | North/South line NORTH | Feet from the 2480 | East/West line EAST | County EDDY |
|--------------------|---------------|------------------|---------------|---------|----------------------|---------------------------|-----------------------|------------------------|----------------|

Bottom Hole Location If Different From Surface

| | | | | | | | | | |
|--------------------|---------------|------------------|---------------|---------|----------------------|---------------------------|----------------------|------------------------|----------------|
| UL or lot No. D | Section 29 | Township 25 S | Range 26 E | Lot Idn | Feet from the 660 | North/South line NORTH | Feet from the 660 | East/West line WEST | County EDDY |
|--------------------|---------------|------------------|---------------|---------|----------------------|---------------------------|----------------------|------------------------|----------------|

| | | | |
|------------------------|-----------------|--------------------|--------------------------|
| Dedicated Acres 320 | Joint or Infill | Consolidation Code | Order No. NSL Pending |
|------------------------|-----------------|--------------------|--------------------------|

NO ALLOWABLE WILL BE ASSIGNED TO THIS COMPLETION UNTIL ALL INTERESTS HAVE BEEN CONSOLIDATED
OR A NON-STANDARD UNIT HAS BEEN APPROVED BY THE DIVISION

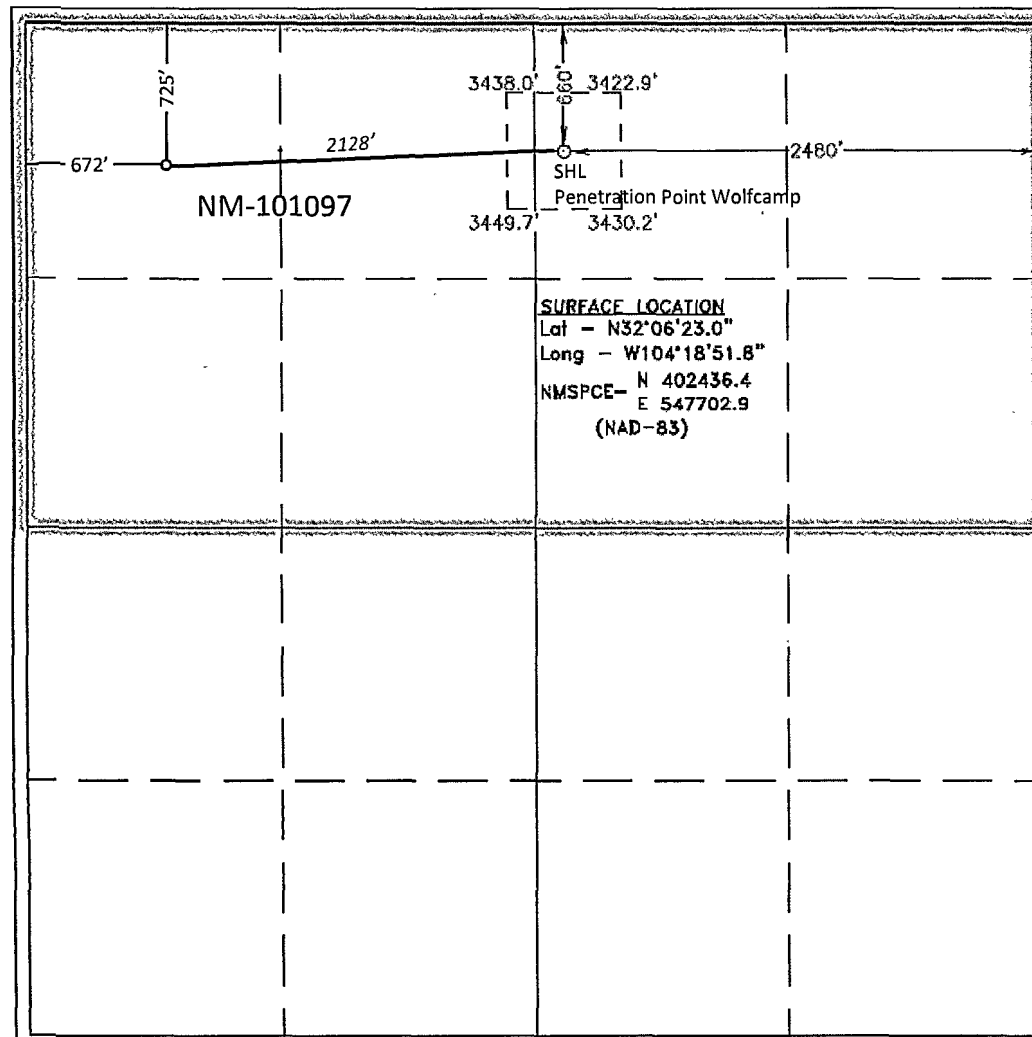

OPERATOR CERTIFICATION

I hereby certify that the information contained herein is true and complete to the best of my knowledge and belief, and that this organization either owns a working interest or unleased mineral interest in the land including the proposed bottom hole location pursuant to a contract with an owner of such a mineral or working interest, or to a voluntary pooling agreement or a compulsory pooling order heretofore entered by the division.

Signature: Scott Haynes Date: 01-14-09

Printed Name: Scott Haynes

SURVEYOR CERTIFICATION

I hereby certify that the well location shown on this plat was plotted from field notes of actual surveys made by me or under my supervision and that the same is true and correct to the best of my belief.

MAY 03 2007

Date Surveyed: MAY 03 2007
Signature: GARY L. JONES
Professional Seal: 7977

Certificate No. Gary L. Jones 7977

BASIN SURVEYS