

UNITED STATES  
DEPARTMENT OF THE INTERIOR  
BUREAU OF LAND MANAGEMENT

## WELL COMPLETION OR RECOMPLETION REPORT AND LOG

FORM APPROVED  
OMB NO. 1004-0137  
Expires: November 30, 2000

1a. Type of Well ☐ Oil Well ☒ Gas Well ☐ Dry Other  
b. Type of Completion ☒ New Well ☐ Work Over ☐ Deepen ☐ Plug Back ☐ Diff. Resvr.,  
Other \_\_\_\_\_

2. Name of Operator  
Concho Exploration Inc.

3. Address  
550 West Texas Avenue, Suite 1300, Midland, TX 79701

3.a Phone No. (Include area code)  
(432)685-4373

4. Location of Well (Report location clearly and in accordance with Federal requirements)\*

At Surface 1861' FNL & 1874' FEL

At top prod. interval reported below 1681' FNL & 1837' FWL

At total depth 1658' FNL & 1670' FWL

RECEIVED

NOV - 7 2003

OCD-ARTESIA

5. Lease Serial No.  
NM-34246

6. If Indian, Allottee or Tribe Name

7. Unit or CA Agreement Name and no.

8. Lease Name and Well No.

Floyd "RI" Fed Com 2

9. API Well No.

30-015-32707

10. Field and Pool, or Exploratory

Happy Valley Morrow Gas

11. Sec., T., R., M., on Block and

Survey or Area Sec. 20, T22S, R26E

12. County or Parish

Eddy

13. State

New Mexico

17. Elevations (DF, RKB, RT, GL)\*

3342'

14. Date Spudded

08/06/2003

15. Date T.D. Reached

09/09/2003

16. Date Completed

☐ D & A ☒ Ready to Prod.

09/26/2003

18. Total Depth: MD 11,830'  
TVD

19. Plug Back T.D.: MD  
TVD

20. Depth Bridge Plug Set: MD  
TVD

21. Type of Electric & Other Mechanical Logs Run (Submit copy of each)

Laterolog Array/Micro-CFL/GR;

Three Detector Litho-Density/CN/GR

22. Was well cored? ☒ No ☐ Yes (Submit analysis)

Was DST run? ☒ No ☐ Yes (Submit analysis)

Directional Survey? ☐ No ☒ Yes (Submit copy)

23. Casing and Liner Record (Report all strings set in well)

Hole Size	Size/Grade	Wt. (#/ft.)	Top (MD)	Bottom (MD)	Stage Cementer Depth	No. of Sk. & Type of Cement	Slurry Vol. (BBL)	Cement Top*	Amount Pulled
17 1/2"	13 3/8"	48#		777'	777'	400 sxC		Surface	
12 1/4"	9 5/8"	40#		2337	2337	815 sxC		Circ	
8 3/4"	5 1/2"	17#		11830	11830	2230 sx Poz H		Circ.	

24. Tubing Record

Size	Depth Set (MD)	Packer Depth (MD)	Size	Depth Set (MD)	Packer Depth (MD)	Size	Depth Set (MD)	Packer Depth (MD)
2 7/8"	11,022	10,987'						

25. Producing Intervals

Formation	Top	Bottom	Perforated Interval	Size	No. Holes	Perf. Status
A) Morrow	11,167	11,181'	11,167 - 11,181'	2 1/8"	56	open
B)						
C)						
D)						

27. Acid, Fracture, Treatment, Cement Squeeze, Etc.

Depth Interval	Amount and Type of Material
11,167 - 11,181'	Acidized w/1500 gals 7 1/2% acid w/20% Methanol, 1000 SCF/bbls N2 w/75 BS & 10,000 N2 pad.

28. Production - Interval A

Date First Produced	Test Date	Hours Tested	Test Production	Oil BBL	Gas MCF	Water BBL	Oil Gravity Corr. API	Gas Gravity	Production Method
10/11/03	10/28/03	24	→	0	400	0			Flowing
Choice Size	Tbg. Press. Flwg.	Csg. Press.	24 Hr. Rate	Oil BBL	Gas MCF	Water BBL	Gas : Oil Ratio	Well Status	
20/64"	SI 100		→	0	400	0		producing	

Production - Interval B

Date First Produced	Test Date	Hours Tested	Test Production	Oil BBL	Gas MCF	Water BBL	Oil Gravity Corr. API	Gas Gravity	Production Method
			→						
Choke Size	Tbg. Press.	Csg. Press.	24 Hr. Rate	Oil	Gas	Water	Gas : Oil	Well Status	
			→						

(See Instructions and spaces for additional data on reverse side)

## 28b. Production - Interval C

Date First Produced	Test Date	Hours Tested	Test Production →	Oil BBL	Gas MCF	Water BBL	Oil Gravity Corr. API	Gas Gravity	Production Method
Choke Size	Tbg. Press. Flwg. SI	Csg. Press.	24 Hr. Rate →	Oil BBL	Gas MCF	Water BBL	Gas : Oil Ratio	Well Status	

## 28c. Production - Interval D

Date First Produced	Test Date	Hours Tested	Test Production →	Oil BBL	Gas MCF	Water BBL	Oil Gravity Corr. API	Gas Gravity	Production Method
Choke Size	Tbg. Press. Flwg. SI	Csg. Press.	24 Hr. Rate →	Oil BBL	Gas MCF	Water BBL	Gas : Oil Ratio	Well Status	

29. Disposition of Gas (Sold, used for fuel, vented, etc.)

## 30. Summary of Porous Zones (Include Aquifers):

Show all important zones or porosity and contents thereof: Cored intervals and all drill-stem tests, including depth interval tested, cushion used, time tool open, flowing and shut-in pressures and recoveries.

## 31. Formation (Log) Markers

Formation	Top	Bottom	Descriptions, Contents, etc.	Name	Top
					Meas. Depth
Lime	0	167		Wolfcamp	8418
Anhy	167	777		Cisco (Bough C)	9090
Dolomite	777	1060		Canyon	9670
Anhydrite	1060	1470		Strawn	9989
Reef	1470	1962		Atoka	10231
Dolo/Reef	1962	2337		Delaware Sand	2342
Dolo	2337	3903		Bone Spring	4735
Sand	3903	5000		Morrow	10456
Lime/Sand	5000	7728			
Bone Spring	7728	8476			
Shale	11754	11830			

32. Additional remarks (include plugging procedure):

## 33. Circle enclosed attachments:

1. Electrical/Mechanical Logs (1 full set req'd.)    2. Geological Report    3. DST Report    4. Directional Survey  
5. Sundry Notice for plugging and cement verification    6. Core Analysis    7. Other

34. I hereby certify that the foregoing and attached information is complete and correct as determined from all available records (see attached instructions)\*

Name (please print) Brenda CoffmanTitle Regulatory Analyst

Signature

Date 11/04/2003

Title 18 U.S.C. Section 101 and Title 43 U.S.C. Section 1212, make it a crime for any person knowingly and willfully to make to any department or agency of the United States and false, fictitious or fraudulent statements or representations as to any matter within its jurisdiction.

DISTRICT II  
P.O. Drawer DD, Artesia, NM 88211-0719

DISTRICT III  
1000 Rio Brazos Rd., Aztec, NM 87410

DISTRICT IV  
P.O. BOX 2088, SANTA FE, N.M. 87504-2088

OIL CONSERVATION DIVISION

P.O. Box 2088

Santa Fe, New Mexico 87504-2088

☐ AMENDED REPORT

WELL LOCATION AND ACREAGE DEDICATION PLAT

API Number <b>30-015-32707</b>	Pool Code <b>78060</b>	Pool Name <b>HAPPY VALLEY-MORROW GAS</b>
Property Code <b>22150</b>	Property Name <b>FLOYD "RI" FEDERAL COM</b>	Well Number <b>2</b>
OGRID No. <b>193407</b>	Operator Name <b>RICKS EXPLORATION</b>	Elevation <b>3342'</b>

Surface Location

UL or lot No.	Section	Township	Range	Lot Idn	Feet from the	North/South line	Feet from the	East/West line	County
<b>G</b>	<b>20</b>	<b>22-S</b>	<b>26-E</b>		<b>1861'</b>	<b>NORTH</b>	<b>1874'</b>	<b>EAST</b>	<b>EDDY</b>

Bottom Hole Location If Different From Surface

UL or lot No.	Section	Township	Range	Lot Idn	Feet from the	North/South line	Feet from the	East/West line	County
<b>F</b>	<b>20</b>	<b>22-S</b>	<b>26-E</b>		<b>1650</b>	<b>NORTH</b>	<b>1650</b>	<b>WEST</b>	<b>EDDY</b>

Dedicated Acres	Joint or Infill	Consolidation Code	Order No.
<b>320</b>			

NO ALLOWABLE WILL BE ASSIGNED TO THIS COMPLETION UNTIL ALL INTERESTS HAVE BEEN CONSOLIDATED  
OR A NON-STANDARD UNIT HAS BEEN APPROVED BY THE DIVISION

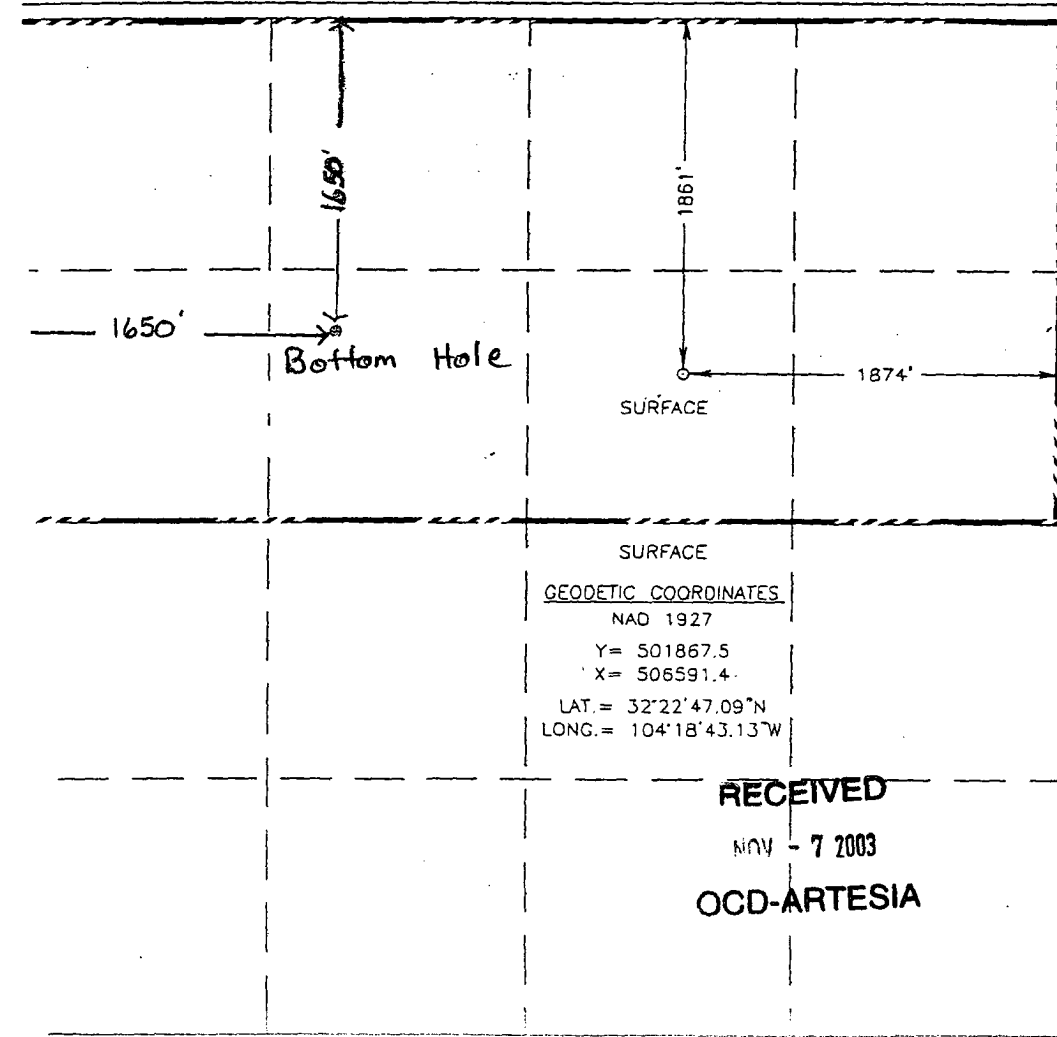

<b>OPERATOR CERTIFICATION</b>	
I hereby certify the the information contained herein is true and complete to the best of my knowledge and belief.	
<i>Brenda Coffman</i> Signature	
<b>Brenda Coffman</b> Printed Name	
<b>Regulatory Analyst</b> Title	
<b>11-4-03</b> Date	
<b>SURVEYOR CERTIFICATION</b>	
I hereby certify that the well location shown on this plat was plotted from field notes of actual surveys made by me or under my supervision and that the same is true and correct to the best of my belief.	
<b>NOVEMBER 12, 2002</b>	
Date Surveyed	AWB
<i>Ronald J. Eidson</i> Signature & Seal of Professional Surveyor	
<b>02 11 0868</b>	
Certificate No.	<b>RONALD J. EIDSON 3239</b> <b>GARY EIDSON 12641</b>

OPERATOR: CONCHO EXPLORATION INC.  
WELL/LEASE: FLOYD FED. 2  
COUNTY: EDDY

144-0019

STATE OF NEW MEXICO  
DEVIATION REPORT

---

171	1
288	1 1/4
587	1
777	1 1/4
901	1/2
1,218	3/4
1,535	3/4
1,852	1/2
2,168	1
2,337	1 1/2
2,553	1 1/4
2,805	1 1/4
3,060	1
3,311	1 1/4
3,727	1 1/2
3,983	1 1/2
4,240	1 1/2
4,498	1 1/2
4,755	1 1/2

RECEIVED  
NOV - 7 2003  
OCD-ARTESIA

By: Steve Moore

STATE OF TEXAS

COUNTY OF MIDLAND

The foregoing instrument was acknowledged before me on this 23rd day of September, 2003, by Steve Moore on behalf of Patterson-UTI Drilling Company LP, LLLP.

Joni D. Hodges  
Notary Public for Midland County, Texas

My Commission Expires: 4/08/2007

