

District I
1625 N. French Dr., Hobbs, NM 88240
District II
1301 W. Grand Avenue, Artesia, NM 88210
District III
1000 Rio Brazos Road, Aztec, NM 87410
District IV
1220 S. St. Francis Dr., Santa Fe, NM 87505

State of New Mexico
Energy Minerals and Natural Resources

Oil Conservation Division
1220 South St. Francis Dr.
Santa Fe, NM 87505

Form C-144
June 1, 2004

For drilling and production facilities, submit to appropriate NMOCD District Office.
For downstream facilities, submit to Santa Fe Office.

Pit or Below-Grade Tank Registration or Closure

Is pit or below-grade tank covered by a "general plan"? Yes ☐ No ☒

Type of action: Registration of a pit or below-grade tank ☐ Closure of a pit or below-grade tank ☒

Operator: Nadel and Gussman Permian LLC Telephone: 505-746-1428 e-mail address: lledbetter@naguss.com			
Address: 2408 Freeman, Artesia NM, 88210			
Facility or well name: Quick Draw Fed #1 API #: 30-005-63716 U/L or Qtr/Qtr D Sec 23 T 7S R 26E			
County: Chaves County Latitude N33° 41' 50.9" Longitude W104° 16' 26.1" NAD: 1927- <input type="checkbox"/> 1983- <input type="checkbox"/>			
Surface Owner: Federal <input checked="" type="checkbox"/> State <input type="checkbox"/> Private <input type="checkbox"/> Indian <input type="checkbox"/>			
Pit		Below-grade tank	
Type: Drilling <input checked="" type="checkbox"/> Production <input type="checkbox"/> Disposal <input type="checkbox"/> Workover <input type="checkbox"/> Emergency <input type="checkbox"/> Lined <input checked="" type="checkbox"/> Unlined <input type="checkbox"/> Liner type: Synthetic <input checked="" type="checkbox"/> Thickness 12 mil Clay <input type="checkbox"/> Pit Volume _____ bbl		Volume: _____ bbl Type of fluid: _____ Construction material: _____ Double-walled, with leak detection? Yes <input type="checkbox"/> If not, explain why not. _____	
Depth to ground water (vertical distance from bottom of pit to seasonal high water elevation of ground water).		Less than 50 feet (20 points) <input type="checkbox"/> 50 feet or more, but less than 100 feet (10 points) <input checked="" type="checkbox"/> 100 feet or more (0 points) <input type="checkbox"/>	
Wellhead protection area: (Less than 200 feet from a private domestic water source, or less than 1000 feet from all other water sources.)		Yes (20 points) <input type="checkbox"/> No (0 points) <input checked="" type="checkbox"/>	
Distance to surface water: (horizontal distance to all wetlands, playas, irrigation canals, ditches, and perennial and ephemeral watercourses.)		Less than 200 feet (20 points) <input type="checkbox"/> 200 feet or more, but less than 1000 feet (10 points) <input type="checkbox"/> 1000 feet or more (0 points) <input checked="" type="checkbox"/>	
		Ranking Score (Total Points)	10 points

If this is a pit closure: (1) Attach a diagram of the facility showing the pit's relationship to other equipment and tanks. (2) Indicate disposal location: (check the onsite box if you are burying in place) onsite ☒ offsite ☐ If offsite, name of facility _____. (3) Attach a general description of remedial action taken including remediation start date and end date. (4) Groundwater encountered: No ☒ Yes ☐ If yes, show depth below ground surface _____ ft. and attach sample results. (5) Attach soil sample results and a diagram of sample locations and excavations.

Additional Comments: **Nadel and Gussman proposes the construction of an onsite pit for deep burial (see diagram). All drilling material will be blended with soil-like material to stabilize for burial. Material will be encapsulated with a 12 ml liner and capped by a 20 ml liner. 3' of soil-like material will cover cap to grade. Site will be reseeded and returned to as near original condition as possible.**

I hereby certify that the information above is true and complete to the best of my knowledge and belief. I further certify that the above-described pit or below-grade tank has been / will be constructed or closed according to NMOCD guidelines ☒, a general permit ☐, or an (attached) alternative OCD-approved plan ☐.

Date: **8-26-05**

Printed Name / Title **Kee Ledbetter / Field Superintendent** Signature **Kee Ledbetter**

Your certification and NMOCD approval of this application / closure does not relieve the operator of liability should the contents of the pit or tank contaminate ground water or otherwise endanger public health or the environment. Nor does it relieve the operator of its responsibility for compliance with any other federal, state, or local laws and / or regulations.

Approval: **Mike Bratcher / Asst. II**

Signature **Mike Bratcher**

AUG 26 2005

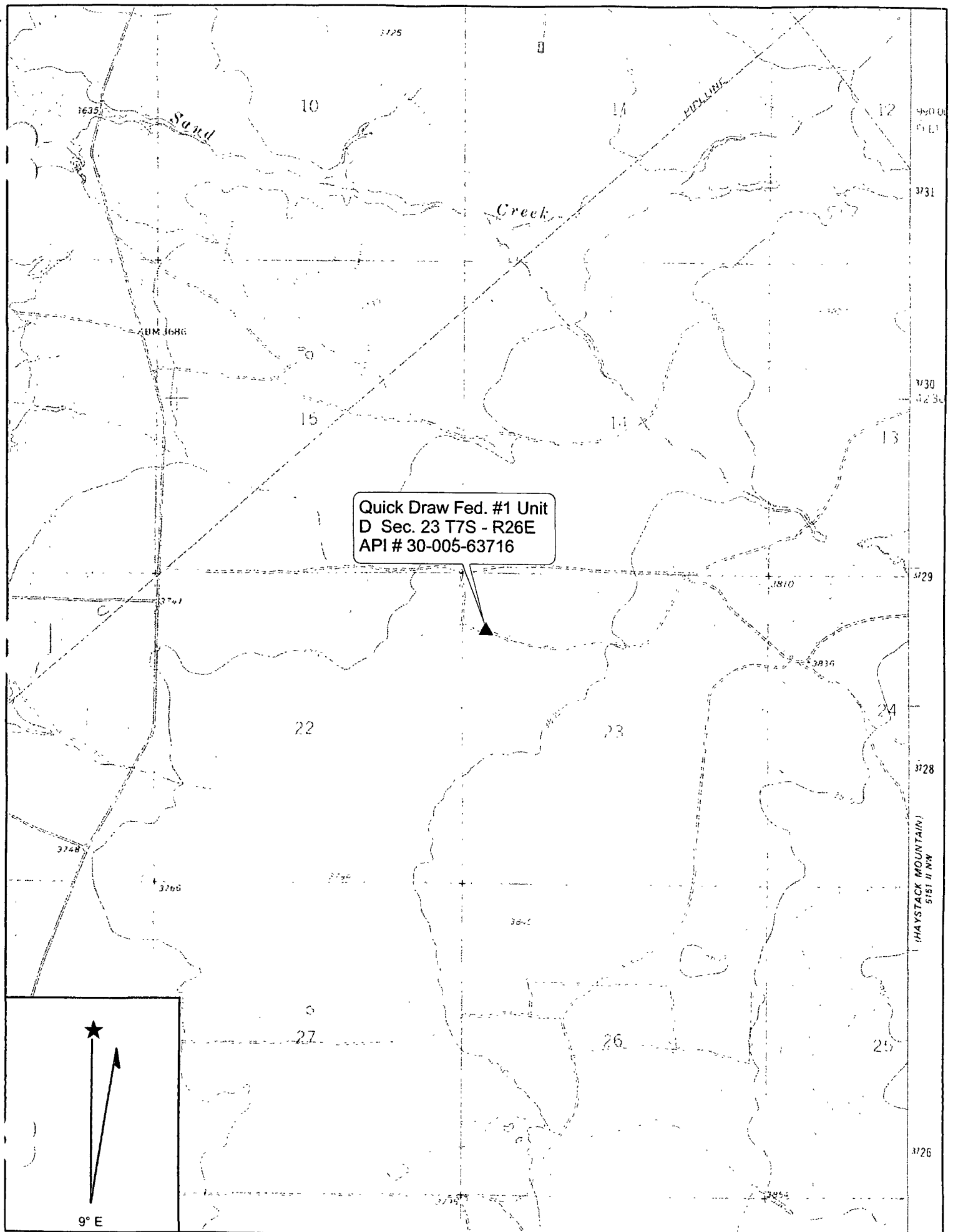

Quick Draw Fed. #1 Unit
D Sec. 23 T7S - R26E
API # 30-005-63716

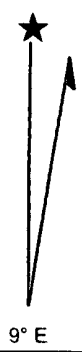

Quick Draw Fed. #1 Unit
D Sec. 23 T7S - R26E
API # 30-005-63716

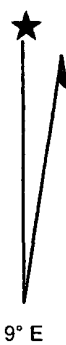

9° E

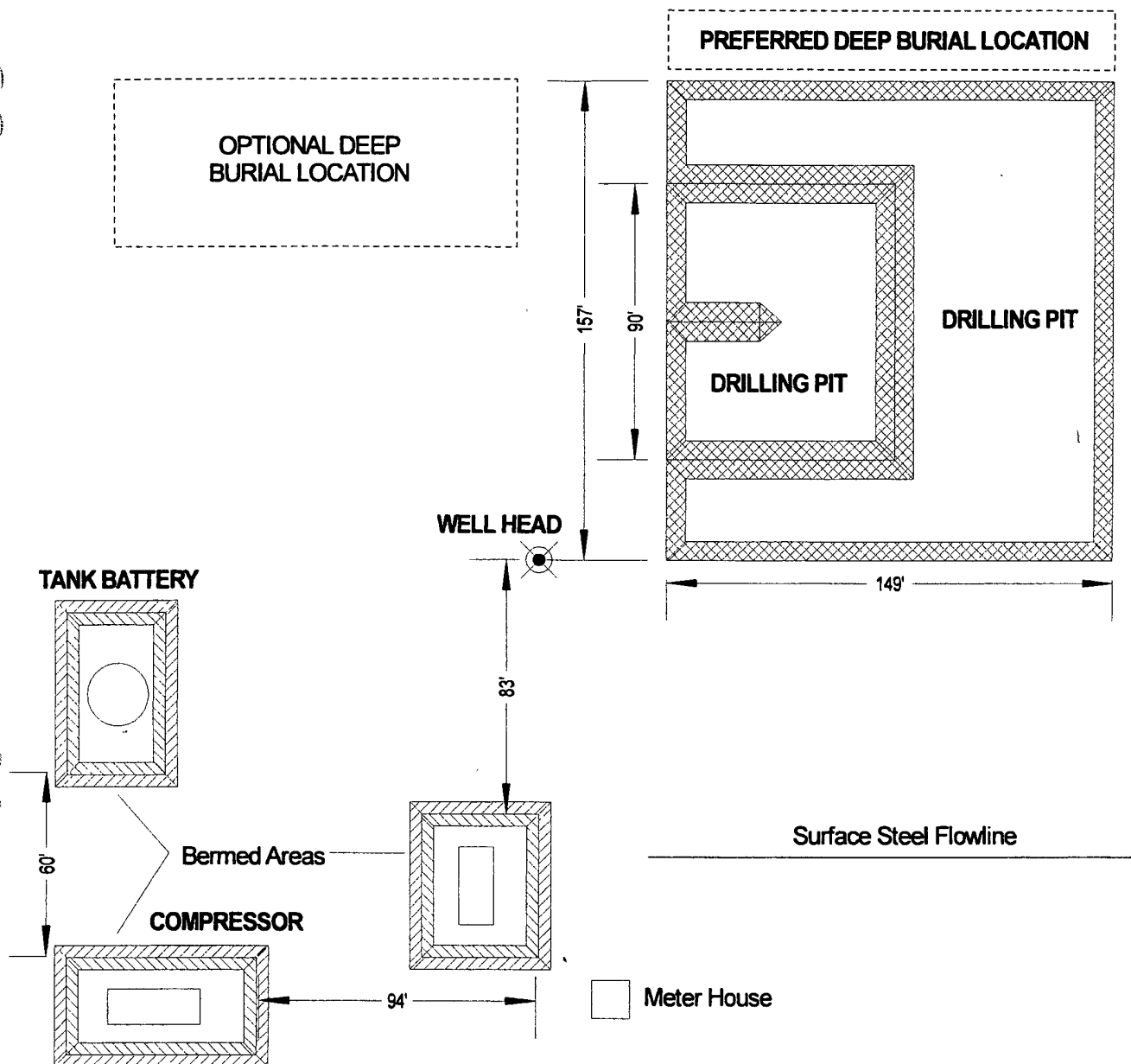

Property: Quick Draw Federal #1
 UL-D; Section 23; T7S; R26E
 Chavez County, NM
 API No.: 30-005-63716
 BLM No.: NM27634
 N 33° 41' 50.9"
 W 104° 16' 26.1"
 Elevation: 3763-ft amsl

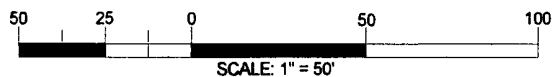
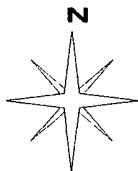

Project: RR-05-002
 Drilling Pit Closure
 Location:
 Quick Draw Federal #1
 Chavez County, New Mexico
 Date: 08-25-05

NADEL and GUSSMAN
 PERMIAN, LLC

 2408 Freeman
 Artesia, NM 88210
 (505) 746-1428

P.O. Box 1816

Ocotillo
 ENVIRONMENTAL

 Hobbs, NM 88240

**New Mexico Office of the State Engineer
Well Reports and Downloads**

Township: 07S Range: 26E Sections: 11,12,13,22,23,24,25,26,27

NAD27 X: Y: Zone: Search Radius:

County: Basin: Number: Suffix:

Owner Name: (First) (Last) ☐ Non-Domestic ☐ Domestic ☒ All

Well / Surface Data Report

Avg Depth to Water Report

Water Column Report

Clear Form

WATERS Menu

Help

WELL / SURFACE DATA REPORT 08/18/2005

DB File Nbr	(acre ft per annum)	Use	Diversion	Owner	Well Number	Source	Tws	Rng	Sec	q	q	q	X Y are
													Zone
RA 03127 (1)	PRO	0	STEVENS OPERATING CORP	RA 03127 (1)			07S	26E	11	0	0	0	
RA 09312	STK	3	WHITE JOHN	RA 09312	Shallow	07S	26E	24	2	2			
RA 09322	STK	3	WHITE JOHN	RA 09322	Shallow	07S	26E	24	1	2	2		
RA 09357	STK	3	JOHN WHITE	RA 09357			07S	26E	24	2			

Record Count: 4

New Mexico Office of the State Engineer
Well Reports and Downloads

Township: 07S Range: 26E Sections: 11,12,13,22,23,24,25,26,27

NAD27 X: Y: Zone: Search Radius:

County: Basin: Number: Suffix:

Owner Name: (First) (Last) ☐ Non-Domestic ☐ Domestic ☒ All

Well / Surface Data Report

Avg Depth to Water Report

Water Column Report

Clear Form

WATERS Menu

Help

AVERAGE DEPTH OF WATER REPORT 08/18/2005

Bsn	Tws	Rng	Sec	Zone	X	Y	Wells	(Depth Water in Feet)		
								Min	Max	Avg
RA	07S	26E	24				1	59	59	59

Record Count: 1

Findings. Five previously recorded sites are within one mile of the proposed well location. The age and cultural affiliation of all of the sites are unknown. None of the sites are in the vicinity of the project.

b. Description of Undertaking: Nadel and Gussman Permian propose to construct a well pad and access road. The access road follows an existing eroded two track road that connects with the existing Hanagan Fed. #2 well location.

c. Environmental Setting: The proposed well location is on a west-sloping plain in an area of low coppice dunes. An area of larger dunes are to the northwest. The area is eroded by sheet wash. Soils are classified as Holomex series. Observed soils are loose tan aeolian sands in the dunes with red-brown sands intermixed with sparse caliche fragments elsewhere. Vegetation includes mesquite, sand sage, yucca, prickly pear, cholla, snakeweed, and mixed grasses.

d. Field Methods: A series of transects were walked no more than 50' apart. The access road was examined by walking a single linear transect on either side of the road.

e. Artifacts Collected: None

17. Cultural Resource Findings: No cultural resources were discovered within the areas examined.

a. Location and Identification of Each Resource:

b. Evaluation of Significance of Each Resource:

18. Management Summary: It is recommended that construction of the proposed well location and access road proceed without any additional cultural resource investigations.

19. I certify the information provided is correct and accurate to my knowledge and meets all applicable BLM standards.

Responsible Archaeologist: *Don E. E. E.*

Date: *Jan. 3, 2004*

New Mexico Office of the State Engineer
Well Reports and Downloads

Township: 07S Range: 26E Sections: 11,12,13,22,23,24,25,26,27

NAD27 X: Y: Zone: Search Radius:

County: Basin: Number: Suffix:

Owner Name: (First) (Last) ☐ Non-Domestic ☐ Domestic ☒ All

Well / Surface Data Report

Avg Depth to Water Report

Water Column Report

Clear Form

WATERS Menu

Help

WATER COLUMN REPORT 08/18/2005

(quarters are 1=NW 2=NE 3=SW 4=SE)

(quarters are biggest to smallest)

Well Number	Tw	Rng	Sec	q	q	q	Zone	X	Y	Depth Well	Depth Water	Water (in Column
RA 09322	07S	26E	24	1	2	2				129	59	70
RA 09357	07S	26E	24	2						200		
RA 09312	07S	26E	24	2	2					200		

Record Count: 3

Exhibit #9

TITLE PAGE/ABSTRACT/NEGATIVE SITE REPORT

1. BLM Report No.	2. Reviewer's Initials/Date..... Accepted () Rejected ()	3. NMCRIS Number 90627
4. Type of Report:)	Negative (X)	Positive ()
5. Title of Report: A Cultural Resource Survey of the Quick Draw Fed. Com. #1 Well Location, Chaves County, New Mexico Author: Don Clifton		6. Fieldwork Date(s) 29Oct2004 7. Report Date: 03Nov2004
8. Consultant Name& Address: Direct Charge: Don Clifton Field Personnel Names: Don Clifton Address: P. O. Box 30, Pep, N.M. 88126 Phone: (505) 675-2360		9. Cultural Resource Permit No.: #83-2920-02-0 10. Consultant Report No.: 541
11. Client Name: Nadel and Gussman Permian Responsible Individual: Josh Fernau Address: 601 N. Marienfeld Suite 508, Midland, Tx 79701 Phone: 432-682-4325		
13. Land Status	BLM	State
a. Area Surveyed		Private
b. Area of Effect		Other
		Total
		12.4
		6.4
		12.4 acres
		6.4 acres
14. Linear	Length: 1,800'	Width: 100'
15. Location: a. State: New Mexico b. County: Chaves c. BLM Office: Roswell d. Nearest City or Town: Roswell e. Legal Description: T 7S R 26E Sec.23 NW¼ NW¼ f. Well Pad Footages: 990'fwl/660'fwl g. USGS 7.5' Map:Eightmile Draw, N.M. 1962, rev. 1982 33104 F3		
16. Project Data: a. Records Search: Date of BLM File Review: 26Oct2004 Name of Reviewer: Pat Flanary Date of ARMS Data Review: 25Oct2004 Name of Reviewer: Don Clifton		

NADEL AND GUSSMAN PERMIAN, L.L.C.

601 N. Marienfeld, Suite #508

Midland, Texas 79701

(432) 682-4429

Fax (432) 682-4325

Mr. Mike Bratcher
Oil Conservation Division
1301 West Grand Avenue
Artesia, NM 88210

Re: Quick Draw #1 C-144 closure
API 30-005-63716

January 14, 2010

Dear Mr. Bratcher,

Today when I opened the Quick Draw Fed #1 on line file I discovered that the attached approved closure plan was not in the online file. The pit on this location was closed as approved in 2005.

Yours truly,



Kem E. McCready

Operations Engineer

Nadel and Gussman Permian

432-682-4429 office

432-425-6347 cell