

N.M. Oil Cons. DIV-Dist. 2
1301 W. Grand Avenue
Artesia, NM 88210

Form 3160-3
(August 1999)

UNITED STATES
DEPARTMENT OF THE INTERIOR
BUREAU OF LAND MANAGEMENT

RECEIVED

0
OMB No. 1004-0136
Expires November 30, 2000

FEB 10 2004

OCD-ARTE

APPLICATION FOR PERMIT TO DRILL OR REENTER

1a. Type of Work: <input checked="" type="checkbox"/> DRILL <input type="checkbox"/> REENTER		5. Lease Serial No. LC049945-C
b. Type of Well: <input type="checkbox"/> Oil Well <input checked="" type="checkbox"/> Gas Well <input type="checkbox"/> Other <input type="checkbox"/> Single Zone <input type="checkbox"/> Multiple Zone		6. If Indian, Allottee or Tribe Name
2. Name of Operator Yates Drilling Company		7. If Unit or CA Agreement, Name and No.
3A. Address 105 South Fourth Street Artesia, New Mexico 88210		8. Lease Name and Well No. Parrot Federal Com. #1
3b. Phone No. (include area code) (505) 748-1471		9. API Well No. 30-015-33233
4. Location of Well (Report location clearly and in accordance with any State requirements. *) At surface 1200' FNL and 1310' FEL At proposed prod. Zone Same		10. Field and Pool, or Exploratory Wildcat Chester
14. Distance in miles and direction from nearest town or post office* Approximately 14 miles southeast of Artesia, New Mexico.		11. Sec., T., R., M., or Blk. and Survey or Area Section 29, T19S-R27E
15. Distance from proposed* location to nearest property or lease line, ft. (Also to nearest drig. unit line, if any) 1200'	16. No. of Acres in lease 40	17. Spacing Unit dedicated to this well E/2
18. Distance from proposed location* to nearest well, drilling, completed, applied for, on this lease, ft. 5500'	19. Proposed Depth 10600'	20. BLM/BIA Bond No. on file 586000
21. Elevations (Show whether DF, KDB, RT, GL, etc.) 3408' GL	22. Approximate date work will start* ASAP	23. Estimated duration 45 days

24. Attachments

ROSWELL CONTROLLED WATER BASIN

The following, completed in accordance with the requirements of Onshore Oil and Gas Order No. 1, shall be attached to this form:

- | | |
|---|---|
| 1. Well plat certified by a registered surveyor. | 4. Bond to cover the operations unless covered by an existing bond on file (see Item 20 above). |
| 2. A Drilling Plan. | 5. Operator certification. |
| 3. A Surface Use Plan (if the location is on National Forest System Lands, the SUPO shall be filed with the appropriate Forest Service Office). | 6. Such other site specific information and/or plans as may be required by the authorized office. |

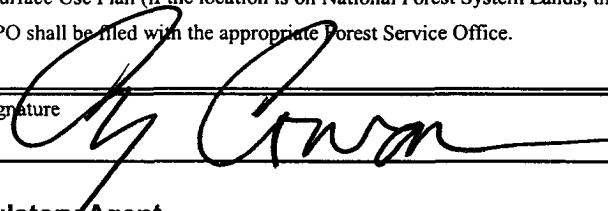
25. Signature 	Name (Printed/Typed) Cy Cowan	Date 11/13/03
Title: Regulatory Agent		
Approved by (Signature) /s/ Joe G. Lara	Name (Printed/Typed) /s/ Joe G. Lara	Date 5 FEB 2004
Title FIELD MANAGER	Office CARLSBAD FIELD OFFICE	

Application approval does not warrant or certify that the applicant holds legal or equitable title to those rights in the subject lease which would entitle the applicant to conduct operations thereon.

APPROVAL FOR 1 YEAR

Conditions of approval, if any, are attached.

Title 18 U.S.C. Section 1001 and Title 43 U.S.C. Section 1212, make it a crime for any person knowingly and willfully to make to any department or agency of the United States any false, fictitious or fraudulent statements or representations as to any matter within its jurisdiction.

*(Instructions on reverse)

APPROVAL SUBJECT TO
GENERAL REQUIREMENTS
AND SPECIAL STIPULATIONS
ATTACHED

DISTRICT I
1625 N. French Dr., Hobbs, NM 88240
DISTRICT II
811 South First, Artesia, NM 88210
DISTRICT III
1600 Edo Braces Rd., Aztec, NM 87410
DISTRICT IV
2940 South Pacheco, Santa Fe, NM 87505

State of New Mexico
Energy, Minerals and Natural Resources Department

Form C-182
Revised March 17, 1999
Instruction on back
Submit to Appropriate District Office
State Lease - 4 Copies
Fee Lease - 3 Copies

OIL CONSERVATION DIVISION
P.O. Box 2088
Santa Fe, New Mexico 87504-2088

☐ AMENDED REPORT

WELL LOCATION AND ACREAGE DEDICATION PLAT

API Number	Pool Code	Pool Name Chester
Property Code	Property Name Parrot Federal Com.	Well Number 1
OCRD No. 025513	Operator Name YATES DRILLING COMPANY	Elevation

Surface Location

UL or lot No.	Section	Township	Range	Lot Idn	Feet from the	North/South line	Feet from the	East/West line	County
A	29	19S	27E		1200'	North	1310'	East	Eddy

Bottom Hole Location If Different From Surface

UL or lot No.	Section	Township	Range	Lot Idn	Feet from the	North/South line	Feet from the	East/West line	County
Dedicated Acres 320	Joint or Infill	Consolidation Code	Order No.						

NO ALLOWABLE WILL BE ASSIGNED TO THIS COMPLETION UNTIL ALL INTERESTS HAVE BEEN CONSOLIDATED
OR A NON-STANDARD UNIT HAS BEEN APPROVED BY THE DIVISION

OPERATOR CERTIFICATION

I hereby certify the the information contained herein is true and complete to the best of my knowledge and belief.

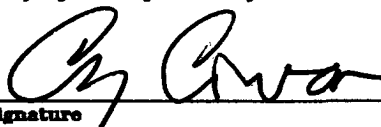
Signature
Cy Cowan
Printed Name
Regulatory Agent
Title
November 13, 2003
Date

SURVEYOR CERTIFICATION

I hereby certify that the well location shown on this plat was plotted from field notes of actual surveys made by me or under my supervision, and that the same is true and correct to the best of my belief.

November 11, 2003
Date Surveyed
Signature of Professional Surveyor

Certificate No. Hershel L. Jones RLS 3640
GENERAL SURVEYING COMPANY

YATES DRILLING COMPANY
Parrot Federal Com. #1
1200' FNL and 1310' FEL
Section 29, T19S-R27E
Eddy County, New Mexico

1. The estimated tops of geologic markers are as follows:

Queen	852'	Atoka	9563'
Grayburg	1159'	Morrow	9893'
San Andres	1798'	Morrow Clastics	10043'
Bone Spring Lime	2691'	Lower Morrow	10175'
1 st Bone Spring Lime	5389'	Barnett	10251'
3 rd Bone Springs Lime	7337'	Chester	10529'
Wolfcamp	7792'	TD	10600'
Cisco Canyon	8191'		
Strawn	8856'		

2. The estimated depths at which anticipated water, oil or gas formations are expected to be encountered:

Water: 200' - 300'
Oil or Gas: All potential zones

3. Pressure Control Equipment: BOPE will be installed on the 9 5/8" casing and rated for 5000 BOP systems will be consistent with API RP 53. Pressure tests will be conducted before drilling out from under all casing strings which are set and cemented in place. Blowout Preventor controls will be installed prior to drilling the surface plug and will remain in use until the well is completed or abandoned. Preventors will be inspected and operated at least daily to ensure good mechanical working order, and this inspection recorded on the daily drilling report. See Exhibit B.

Auxiliary Equipment:

A. Auxiliary Equipment: Kelly cock, pit level indicators, flow sensor equipment and a sub with full opening valve to fit the drill pipe and collars will be available on the rig floor in the open position at all times for use when kelly is not in use.

4. THE PROPOSED CASING AND CEMENTING PROGRAM:

A. Casing Program: (All New)

<u>Hole Size</u>	<u>Casing Size</u>	<u>Wt./Ft</u>	<u>Grade</u>	<u>Thread</u>	<u>Interval</u>	<u>Length</u>
17 1/2"	13 3/8"	48#	H-40	ST&C	0-400'	400'
12 1/4"	9 5/8"	36#	J-55	ST&C	0-2800'	2800'
8 3/4"	5 1/2"	17#	L-80	LT&C	0-900'	900'
8 3/4"	5 1/2"	17#	J-55	LT&C	900'-2000'	1100'
8 3/4"	5 1/2"	15.5#	J-55	LT&C	2000'-6200'	4200'
8 3/4"	5 1/2"	17#	J-55	LT&C	6200'-8000'	1800'
8 3/4"	5 1/2"	17#	L-80	LT&C	8000'-9400'	1400'
8 3/4"	5 1/2"	17#	HCP-110	LT&C	9400'-10600'	1200'

A deep string of 7" casing will be set if problems are encountered.

Minimum Casing Design Factors: Collapse 1.125, Burst 1.0, Tensile Strength 1.8

B. CEMENTING PROGRAM:

WITNESS

Surface casing: 500 sx Class 'C' + 2% CaCl₂(YLD 1.32 WT 14.8).

WITNESS

WITNESS

Intermediate casing: Lead with 700 sx Lite (YLD 2.0 WT 12.5) Tail in w/200 sx Class C + 2% CaCl₂ (YLD 1.32 WT 14.8).

WITNESS

Production Casing: TOC 7300', Lead w/750 sx Super 'C' (YLD 1.63 WT 13.0)

5. Mud Program and Auxiliary Equipment:

<u>Interval</u>	<u>Type</u>	<u>Weight</u>	<u>Viscosity</u>	<u>Fluid Loss</u>
Spud to 400'	FW Gel/Paper	8.4-8.8	32-40	N/C
400'-2800'	Fresh Water	8.4	28	N/C
2800'-9650'	Cut Brine	8.6-9.6	28	N/C
9650'-10600'	S Gel/KCL/Starch/Driscapac	9.6-10.0	32-38	<12cc

Sufficient mud material(s) to maintain mud properties, control lost circulation and contain a blow out will be available at the well site during drilling operations. Mud will be checked hourly by rig personnel.

6. EVALUATION PROGRAM:

Samples: 10' out from under intermediate casing to TD.

Logging: Platform Express/HALS/NGT.

Coring: None anticipated.

DST's: As Warranted.

7. Abnormal Conditions, Bottom hole pressure and potential hazards:

Anticipated BHP:

From: 0	TO 400'	Anticipated Max. BHP: 175	PSI
From: 400'	TO 2800'	Anticipated Max. BHP: 1225	PSI
From: 2800'	TO 10600'	Anticipated Max. BHP: 5600	PSI

Abnormal Pressures Anticipated: None

Lost Circulation Zones Anticipated: None

H₂S Zones Anticipated: None

Maximum Bottom Hole Temperature: 189° F

8. ANTICIPATED STARTING DATE:

Plans are to drill this well as soon as possible after receiving approval. It should take approximately 30 days to drill the well with completion taking another 15 days.

MULTI-POINT SURFACE USE AND OPERATIONS PLAN

**Yates Drilling Company
Parrot Federal Com. #1
1200' FNL and 1310' FEL
Section 29, T19S-R27E
Eddy County, New Mexico**

This plan is submitted with Form 3160-3, Application for Permit to Drill, covering the above described well. The purpose of this plan is to describe the location of the proposed well, the proposed construction activities and operations plan, the magnitude of the surface disturbance involved and the procedures to be followed in rehabilitating the surface after completion of the operations, so that a complete appraisal can be made of the environmental effect associated with the operations.

1. EXISTING ROADS:

Exhibit A is a portion of the BLM map showing the well and roads in the vicinity of the proposed location. The proposed wellsite is located approximately 14 miles southeast of Artesia, New Mexico and the access route to the location is indicated in red and green on Exhibit A.

DIRECTIONS:

Go south of Artesia on Highway 285 for approx. 24.5 miles to intersection of Capitan Reef Road and Hwy 285. Turn left on Capitan Reef Road and go approx. 5.8 miles to the intersection of Lake Road and Capitan Reef Road. Turn left on Lake Road (CR-34) and go approx. 0.2 of a mile. Turn right here on Netherland Road (CR-236) and go approx. 4.1 miles. At this point a two track road well go to the northeast. Follow this two track for approximately .8 of a mile to the southeast corner of the well location.

2. PLANNED ACCESS ROAD:

- A. There will be no new access road. However existing two track road will be upgraded for approx. .8 of a mile from the county road to the southeast corner of the proposed well location.
- B. The new road will be 14 feet in width (driving surface) and will be adequately drained to control runoff and soil erosion.
- C. The new road will be bladed with drainage on one side. Traffic turnouts will not be built.
- D. The route of the road is visible.
- E. Existing roads will be maintained in the same or better condition.

3. LOCATION OF EXISTING WELL

- A. There is drilling activity within a one-mile radius of the wellsite.
- B. Exhibit D shows existing wells within a one-mile radius of the proposed wellsite.

4. LOCATION OF EXISTING AND/OR PROPOSED FACILITIES

- A. There are no production facilities on this lease at the present time.
- B. In the event that the well is productive, the necessary production facilities will be installed on the drilling pad. If the well is productive oil, a gas or diesel self-contained unit will be used to provide the necessary power. No power will be required if the well is productive of gas.

5. LOCATION AND TYPE OF WATER SUPPLY:

- A. It is planned to drill the proposed well with a fresh water system. The water will be obtained from commercial sources and will be hauled to the location by truck over the existing and proposed roads shown in Exhibit A.

6. SOURCE OF CONSTRUCTION MATERIALS:

The dirt contractor will acquire any materials from the closest source at the time of construction of the well pad.

7. METHODS OF HANDLING WASTE DISPOSAL:

- A. Drill cuttings will be disposed of in the reserve pits.
- B. Drilling fluids will be allowed to evaporate in the reserve pits until the pits are dry.
- C. Water produced during operations will be collected in tanks until hauled to an approved disposal system, or separate disposal application will be submitted.
- D. Oil produced during operations will be stored in tanks until sold.
- E. Current laws and regulations pertaining to the disposal of human waste will be complied with.
- F. All trash, junk, and other waste materials will be contained in trash cages or bins to prevent scattering and will be removed and deposited in an approved sanitary landfill. Burial on site is not approved.

8. ANCILLARY FACILITIES: None

9. WELLSITE LAYOUT:

- A. Exhibit C shows the relative location and dimensions of the well pad, the reserve pits, the location of the drilling equipment, rig orientation and access road approach.
- B. The reserve pits will be plastic lined.
- C. A 400' x 400' area has been staked and flagged.

10. PLANS FOR RESTORATION

- A. After finishing drilling and/or completion operations, all equipment and other material not needed for further operations will be removed. The location will be cleaned of all trash and junk to leave the wellsite in as aesthetically pleasing a condition as possible.
- B. Unguarded pits, if any, containing fluids will be fenced until they have dried and been leveled.
- C. If the proposed well is non-productive, all rehabilitation and/or vegetation requirements of the Bureau of Land Management will be complied with and will be accomplished as expeditiously as possible. All pits will be filled level within 90 days after abandonment.

11. SURFACE OWNERSHIP: Bureau of Reclamation Albuquerque, New Mexico.

12. OTHER INFORMATION:

- A. Topography: Refer to the existing archaeological report for a description of the topography, flora, fauna, soil characteristics, dwellings, historical and cultural sites.
- B. The primary surface use is for grazing.

13. OPERATOR'S REPRESENTATIVE

A. Through A.P.D. Approval:

Cy Cowan, Regulatory Agent
Yates Petroleum Corporation
105 South Fourth Street
Artesia, New Mexico 88210
Phone (505) 748-1471

B. Through Drilling Operations,
Completions and Production:

Pinson McWhorter, Operations Manager
Yates Petroleum Corporation
105 South Fourth Street
Artesia, New Mexico 88210
Phone (505) 748-1471

14. CERTIFICATION:

I hereby certify that I, or persons under my direct supervision, have inspected the proposed drill site and access route, that I am familiar with the conditions which presently exist; that the statements made in this plan are to the best of my knowledge, true and correct; and, that the work associated with the operations proposed herein will be performed by Yates Petroleum Corporation and its contractors and subcontractors in conformity with this plan and the terms and conditions under which it is approved. This statement is subject to the provisions of 18 U.S.C. 1001 for the filing of a false statement.

11/13/2003

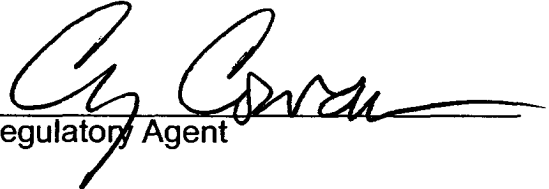
Regulatory Agent

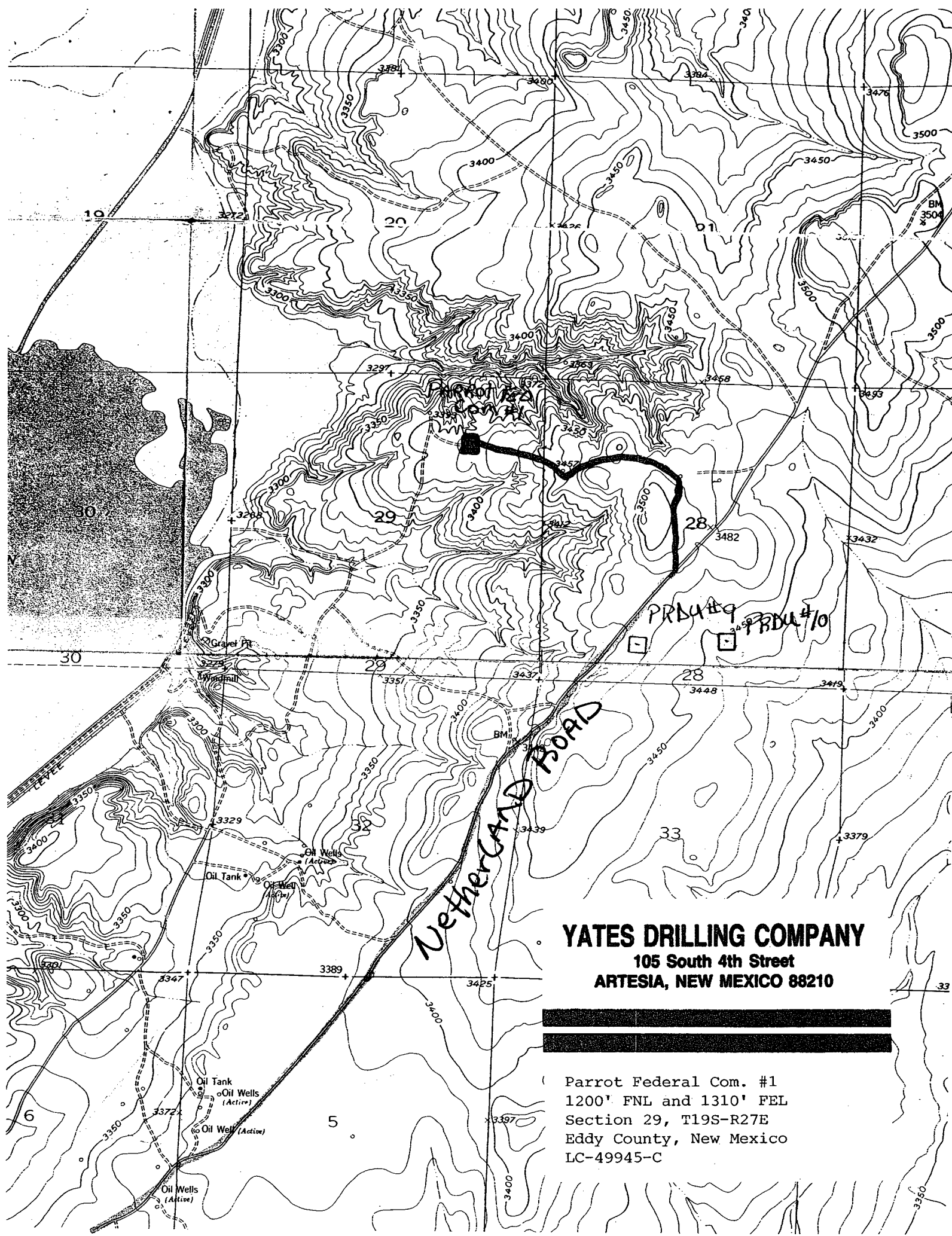

YATES DRILLING COMPANY
105 South 4th Street
ARTESIA, NEW MEXICO 88210

Parrot Federal Com. #1
1200' FNL and 1310' FEL
Section 29, T19S-R27E
Eddy County, New Mexico
LC-49945-C

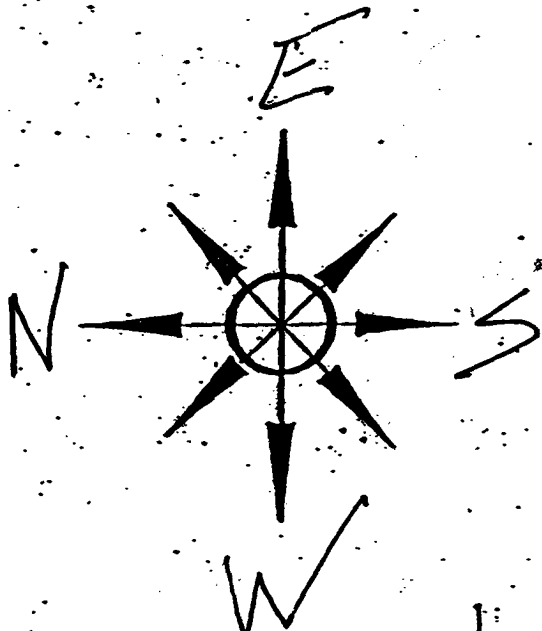

YATES DRILLING COMPANY

Location Layout for Permian Basin
Up to 12,000'

Parrot Federal Com. #1
1200' FNL and 1310' FEL
Section 29, T19S-R27E
Eddy County, New Mexico
LC-49945-C

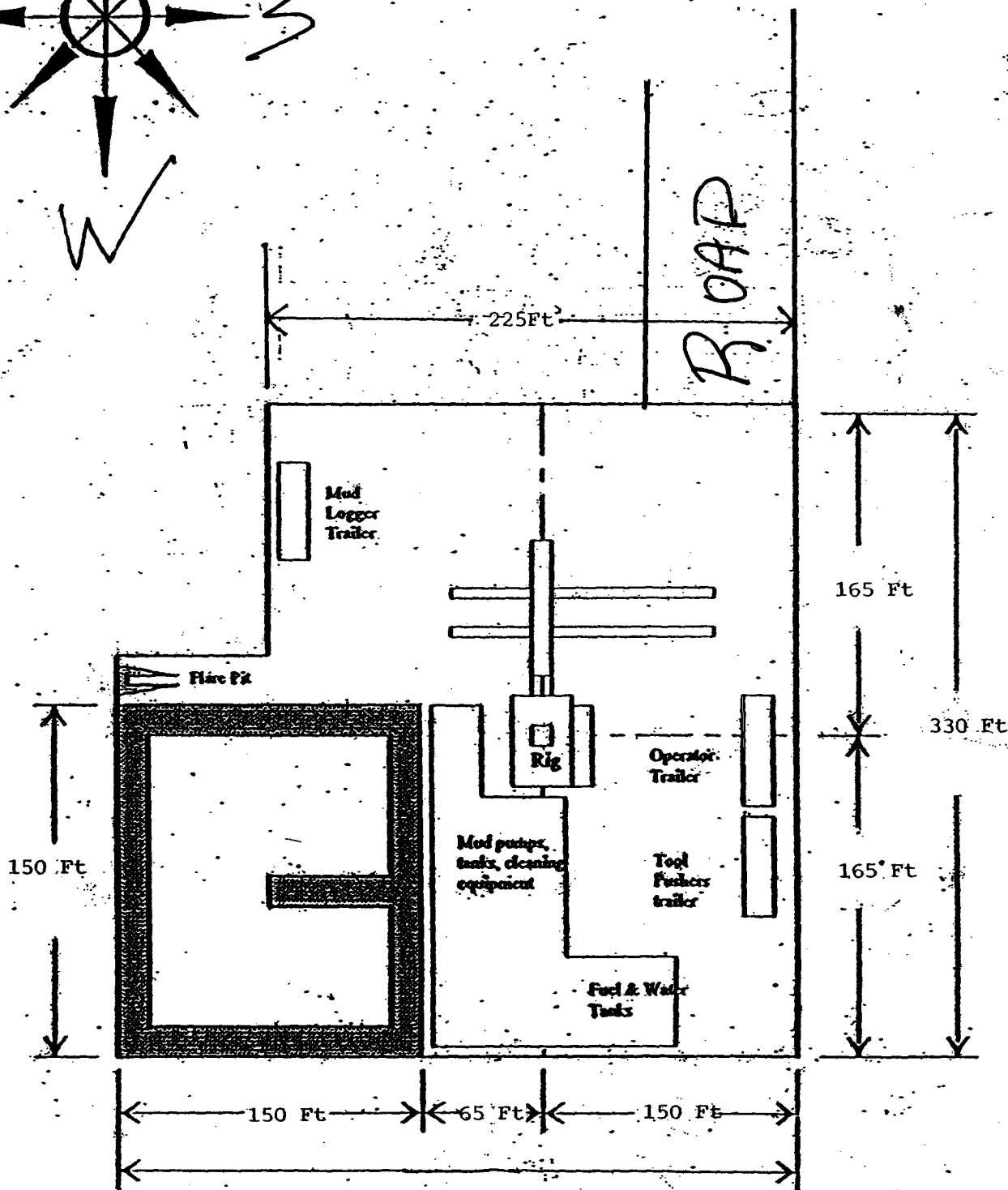

Distance from Well
Head to Reserve Pit
will vary between rigs

The above dimension
should be a maximum

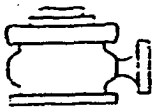

YATES DRILLING COMPANY

BOP-4

Typical 5,000 psi Pressure System Schematic Annular with Double Ram Preventer Stack

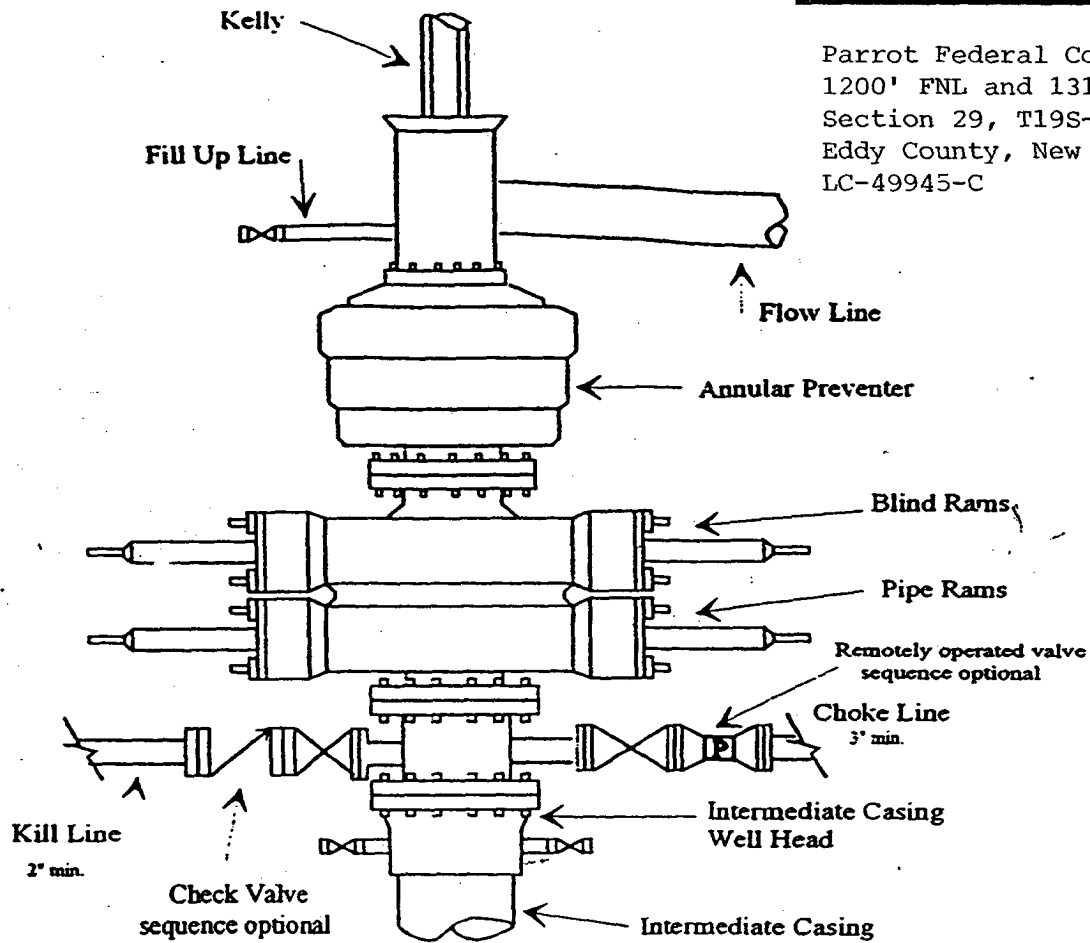

Typical 5,000 psi choke manifold assembly with at least these minimum features

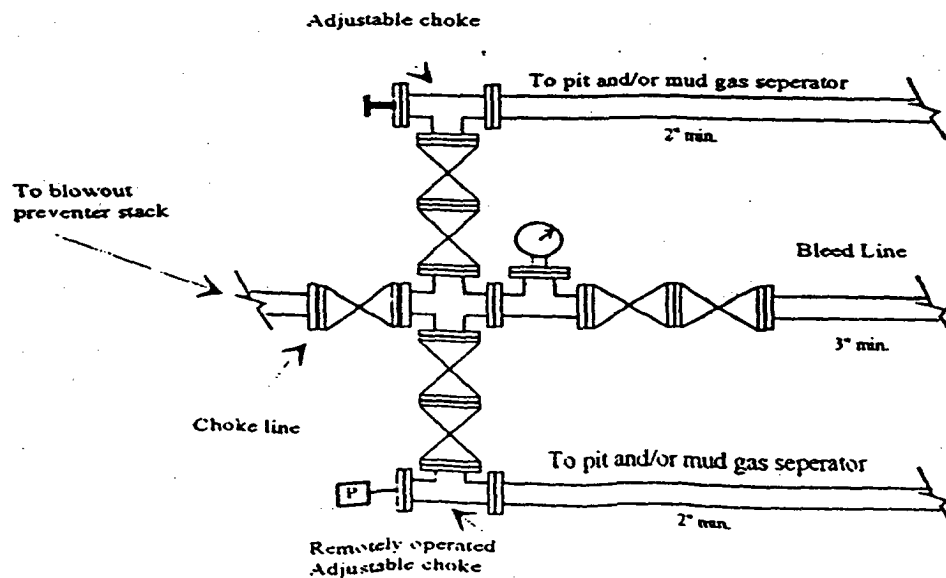

T
19
ST
20
S

YATES DRILLING COMPANY

105 South 4th Street
ARTESIA, NEW MEXICO 88210

Parrot Federal Com. #1
1200' FNL and 1310' FEL
Section 29, T19S-R27E
Eddy County, New Mexico
LC-49945-C

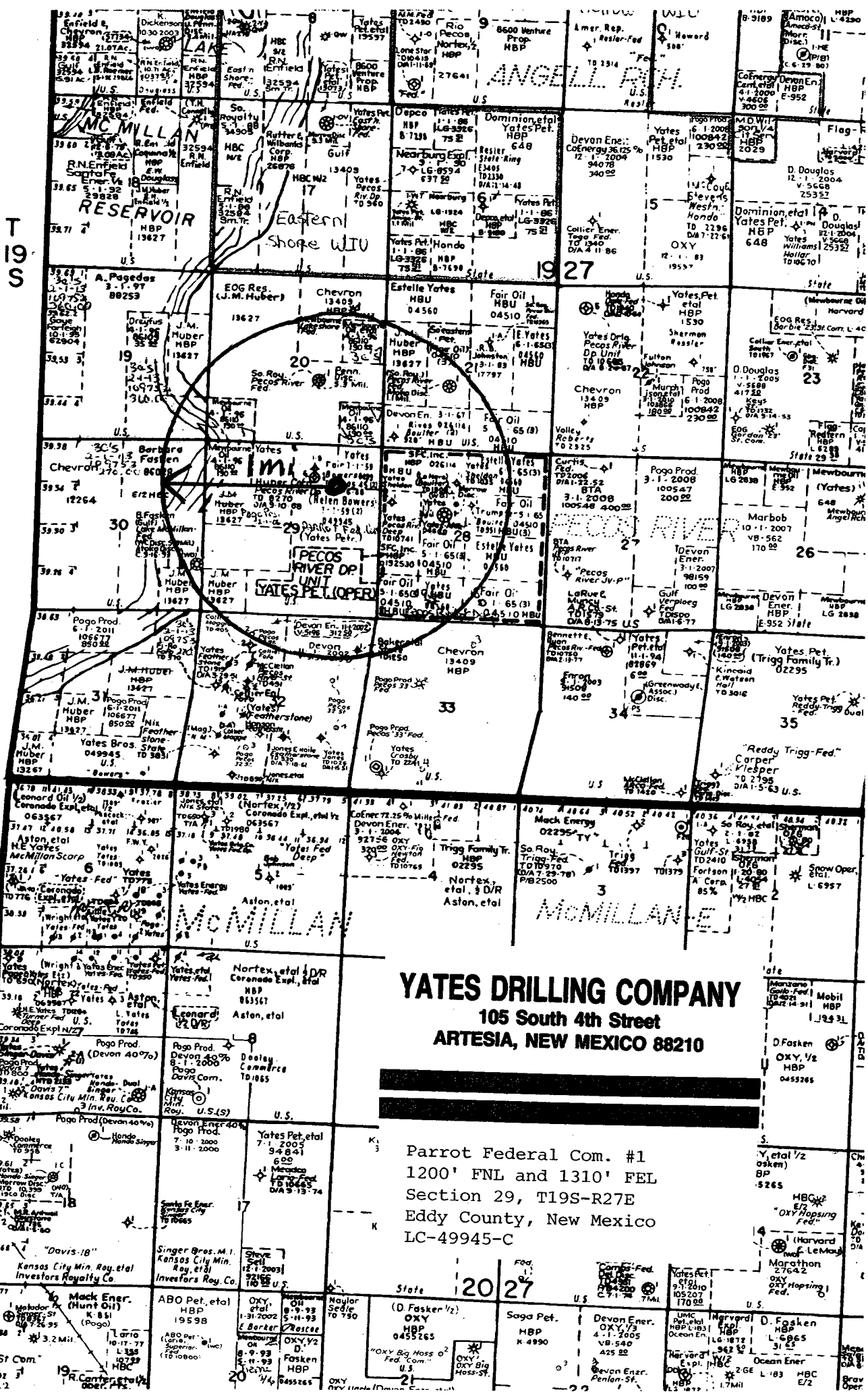

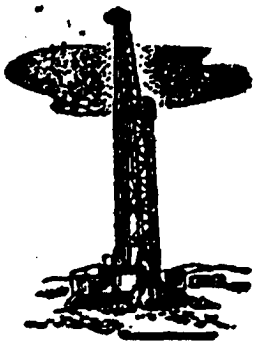

YATES DRILLING COMPANY

105 SOUTH FOURTH STREET - (505) 748-1471

FAX (505) 746-2268

ARTESIA, NEW MEXICO 88210

PEYTON YATES
PRESIDENT

S. P. YATES
VICE PRESIDENT

RANDY G. PATTERSON
SECRETARY

DENNIS G. KINSEY
TREASURER

STATEMENT ACCEPTING RESPONSIBILITY FOR OPERATIONS

The undersigned accepts all applicable terms, conditions, stipulations, and restrictions concerning operations conducted on the leased land or portion thereof, as described below:

Lease Number: LC-49945-C

Bond Coverage: Individually Bonded

Legal Description of Land:
NE/NE/4
Section 29, T19S-R27E

BLM Bond File Number: NM 0344

Formations(s) (if applicable): N/A

Date: November 18, 2003

YATES DRILLING COMPANY

Cy Cowan, Regulatory Agent