

DISTRICT I
1625 N. French Dr., Hobbs, NM 88240

DISTRICT II
1301 W. Grand Avenue, Artesia, NM 88210

DISTRICT III
1000 Rio Drazos Rd., Aztec, NM 87410

DISTRICT IV
1220 S. St. Francis Dr., Santa Fe, NM 87505

State of New Mexico
Energy, Minerals and Natural Resources Department

Form C-102
Revised October 15, 2009

Submit one copy to appropriate
District Office

OIL CONSERVATION DIVISION
1220 South St. Francis Dr.
Santa Fe, New Mexico 87505

WELL LOCATION AND ACREAGE DEDICATION PLAT

AMENDED REPORT

API Number 30-015-38139	Pool Code 60660	Pool Name Turkey Track; Bone Spring
Property Code	Property Name PARKWAY "12" STATE COM	Well Number 3H
OGRID No. 162683	Operator Name CIMAREX ENERGY CO. OF COLORADO	Elevation 3403'

Surface Location

UL or lot No.	Section	Township	Range	Lot Idn	Feet from the	North/South line	Feet from the	East/West line	County
B	12	19 S	29 E		330	NORTH	1840	EAST	EDDY

Bottom Hole Location If Different From Surface

UL or lot No.	Section	Township	Range	Lot Idn	Feet from the	North/South line	Feet from the	East/West line	County
O	12	19 S	29 E		330	SOUTH	1980	EAST	EDDY

Dedicated Acres 160	Joint or Infill	Consolidation Code P	Order No.
------------------------	-----------------	-------------------------	-----------

NO ALLOWABLE WILL BE ASSIGNED TO THIS COMPLETION UNTIL ALL INTERESTS HAVE BEEN CONSOLIDATED OR A NON-STANDARD UNIT HAS BEEN APPROVED BY THE DIVISION

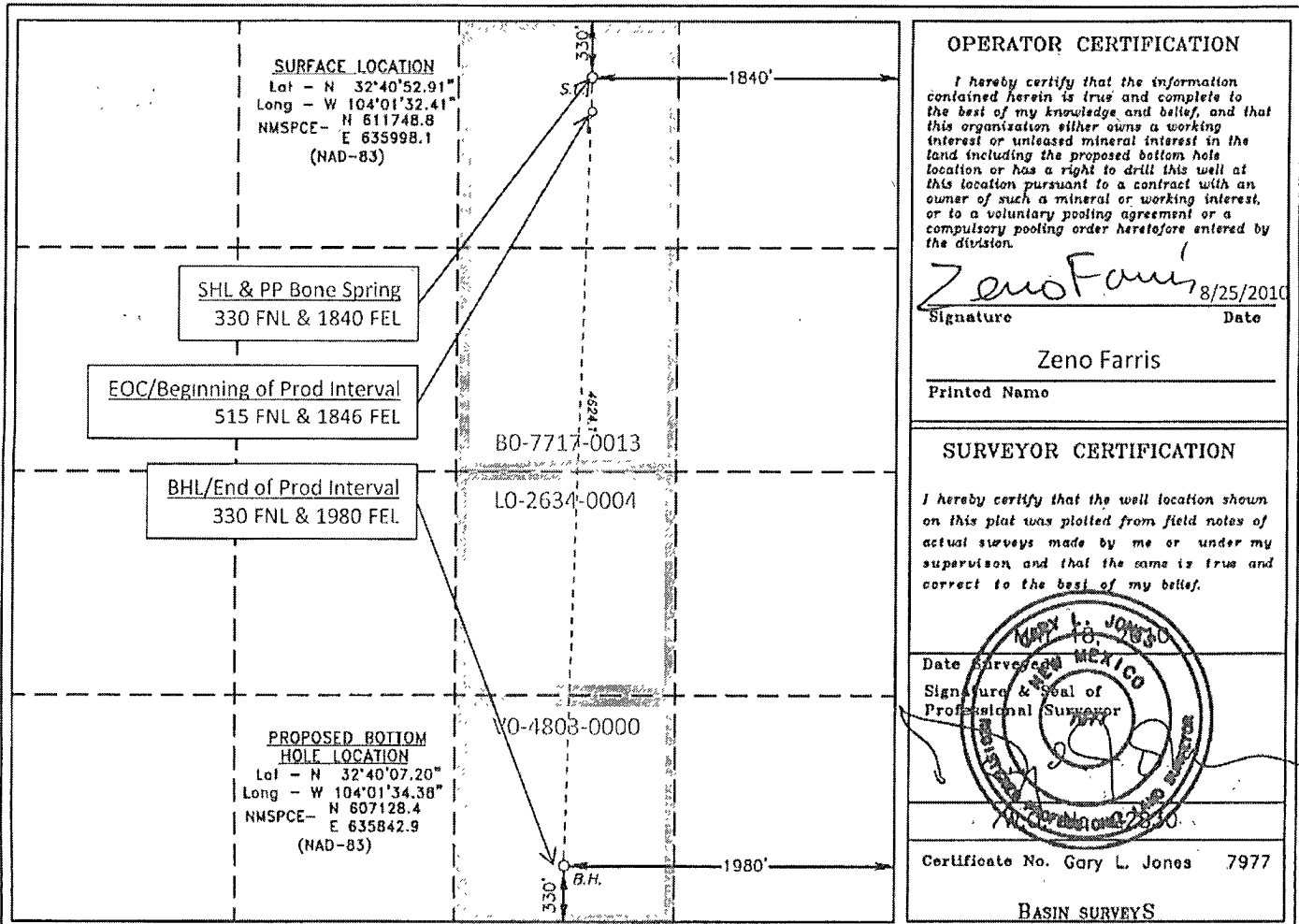

Mud, Casing, Cementing, and BOP Attachment
Parkway 12 State Com No. 1
 Cimarex Energy Co. of Colorado
 Unit B, Section 12
 T19S-R29E, Eddy County, NM

In response to questions asked under Section II B of Bulletin NTL-6, the following information is provided for your consideration:

Location: SHL 330 FNL & 1840 FEL
 BHL 330 FSL & 1980 FEL

Elevation above sea level: 3403' GR

Proposed drilling depth: MD 12364' TVD 7950'

Proposed Mud Circulating System:

Depth	Mud Wt	Visc	Fluid Loss	Type Mud
0' to 250'	8.4 - 8.6	28	NC	FW
0' to 2500'	10.0	30-32	NC	Brine water
0' to 12364'	8.4 - 9.5	30-32	NC	FW, brine

Sufficient mud materials will be kept on location at all times in order to combat lost circulation or unexpected kicks. In order to run DSTs, open hole logs, and casing, the viscosity and water loss may have to be adjusted in order to meet these needs.

Proposed drilling Plan

Drill 8¾" hole to KOP @ 7630' and drill through curve to TD @ 12364.' Run 5½" 17# P-110 LTC from 0-12364.' Cement to 2300.'

Mud, Casing, Cementing, and BOP Attachment
Parkway 12 State Com No. 1
 Cimarex Energy Co. of Colorado
 Unit O, Section 15
 T19S-R29E, Eddy County, NM

Casing & Cementing Plan:

String	Hole Size	Depth		Casing OD		Weight	Collar	Grade
<i>Surface</i>	17½"	0'	to 250'	New	13¾"	48#	STC	H-40
<i>Intermediate</i>	12¼"	0'	to 2500'	New	9⅝"	40#	LTC	J/K-55
<i>Production</i>	8¾"	0'	to 12364'	New	5½"	17#	LTC	P-110

Cementing Plan:

Surface 310 sx Premium Plus + 2% CaCl₂ (wt 14.8, yld 1.35)
TOC Surface

Intermediate Lead: 150 sx Econocem + 3% Salt + 2% CaCl₂ + 3 lbm/sk Gilsonite (wt 11.7, yld 2.06)
Tail: 550 sks Premium Plus + 1% CaCl₂ (wt 14.8, yld 1.34)
TOC Surface

Production Lead: 500 sx EconoCem + 5# Gilsonite (wt 11.9, yld 2.48)
Tail: 1730 sx Halcem (wt 15.6, yld 1.19)
TOC 2300'

Fresh water zones will be protected by setting 13¾" casing at 250' and cementing to surface. Hydrocarbon zones will be protected by setting 9⅝" casing at 2500' and cementing to surface, and by setting 5½" casing at 12364' and cementing to 2300'.

<u>Collapse Factor</u>	<u>Burst Factor</u>	<u>Tension Factor</u>
1.125	1.125	1.6

Pressure control Equipment:

Exhibit "E". A 13¾" 5000 PSI working pressure BOP tested to 3000 psi consisting of one set of blind rams and one set of pipe rams and a 5000# annular type preventer. A choke manifold and 120 gallon accumulator with floor and remote operating stations and auxiliary power system. Rotating head as needed. A kelly cock will be installed and maintained in operable condition and a drill string safety valve in the open position will be available on the rig floor.

BOP unit will be hydraulically operated. BOP will be nipped up and operated at least once a day while drilling and the blind rams will be operated when out of hole during trips. No abnormal pressure or temperature is expected while drilling. From the base of the 13¾" casing through the running of production casing, the well will be equipped with a 5000 psi BOP system tested to 3000 psi.

BOPS will be tested by an independent service company to 250 psi low and 3000 psi high. Hydril will be tested to 250 psi low and 1500 psi high.