

Submit 3 Copies To Appropriate District
Office
District I
1625 N. French Dr. Hobbs, NM 88240
District II
1301 W. Grand Ave., Artesia, NM 88210
District III
1000 Rio Brazos Rd., Aztec, NM 87410
District IV
1220 S. St. Francis Dr., Santa Fe, NM
87505

State of New Mexico
Energy, Minerals and Natural Resources
RECEIVED
AUG 04 2010
CONSERVATION DIVISION
1220 South St. Francis Dr
Santa Fe, NM 87505
HOBBS

Form C-103
June 19, 2008

WELL API NO. 30-015-21201
5. Indicate Type of Lease STATE <input checked="" type="checkbox"/> FEE <input type="checkbox"/>
6. State Oil & Gas Lease No.
7. Lease Name or Unit Agreement Name State BQ
8. Well Number 1
9. OGRID Number 6137
10. Pool name or Wildcat Avalon; Wolfcamp, Southwest (97068)

SUNDY NOTICES AND REPORTS ON WELLS
(DO NOT USE THIS FORM FOR PROPOSALS TO DRILL OR TO DEEPEN OR PLUG BACK TO A DIFFERENT RESERVOIR. USE "APPLICATION FOR PERMIT" (FORM C-101) FOR SUCH PROPOSALS.)

1. Type of Well: Oil Well ☒ Gas Well ☐ Other ☐

2. Name of Operator
Devon Energy Production Co., LP

3. Address of Operator
20 North Broadway, OKC OK 73102-8260

4. Well Location
Unit Letter F 1980 feet from the north line and 1980 feet from the West line
Section 9 Township 21S Range 26E NMPM Eddy County, NM

11. Elevation (Show whether DR, RKB, RT, GR, etc.)
3239' GL

12 Check Appropriate Box to Indicate Nature of Notice, Report or Other Data

NOTICE OF INTENTION TO:		SUBSEQUENT REPORT OF:	
PERFORM REMEDIAL WORK <input type="checkbox"/>	PLUG AND ABANDON <input type="checkbox"/>	REMEDIAL WORK <input type="checkbox"/>	ALTERING CASING <input type="checkbox"/>
TEMPORARILY ABANDON <input type="checkbox"/>	CHANGE PLANS <input type="checkbox"/>	COMMENCE DRILLING OPNS. <input type="checkbox"/>	P AND A <input type="checkbox"/>
PULL OR ALTER CASING <input type="checkbox"/>	MULTIPLE COMPL <input type="checkbox"/>	CASING/CEMENT JOB <input type="checkbox"/>	
DOWNHOLE COMMINGLE <input type="checkbox"/>			
OTHER: CHANGE CLASSIFICATION FROM GAS TO OIL <input checked="" type="checkbox"/>		OTHER <input type="checkbox"/>	

13. Describe proposed or completed operations. (Clearly state all pertinent details, and give pertinent dates, including estimated date of starting any proposed work). SEE RULE 1103. For Multiple Completions: Attach wellbore diagram of proposed completion or recompletion.

Devon respectfully submits a revised C-102 to change the classification of this well from gas to oil; the proration unit has been revised from a 320 to a 40 acre unit. See attached C-102.

*Also change Property name
From State BQ Com To: State BQ*

Spud Date:

Rig Release Date:

OPER. OGRID NO. 6137
New PROPERTY NO. 38270
POOL CODE 97068
EFF. DATE 6/14/10
API NO. 30-015-21201

I hereby certify that the information above is true and complete to the best of my knowledge and belief

SIGNATURE [Signature] TITLE Sr. Staff Engineering Technician DATE 08/04/2010

Type or print name Stephanie A. Ysasaga E-mail address Stephanie.Ysasaga@dvn.com PHONE 405-552-7802
For State Use Only

APPROVED BY: [Signature] TITLE Dist. Engineer DATE 11/03/2010
Conditions of Approval (if any):

NE EXICO OIL CONSERVATION COMMISSIO
WELL LOCATION AND ACREAGE DEDICATION PLAT

All distances must be from the outer boundaries of the Section.

30-015-21201

Deron Energy Production Co. LP		Lease State BC		Section 1	
Section	9	Township	21S	Range	26E
County		Eddy			
1980		North		1980	
3239'		Wolfcamp		Avalon	
Pool Code		Q7DB8			
Acres		40			

- Outline the acreage dedicated to the subject well by colored pencil or hatchure marks on the plat below.
- If more than one lease is dedicated to the well, outline each and identify the ownership thereof (both as to working interest and royalty).
- If more than one lease of different ownership is dedicated to the well, have the interests of all owners been consolidated by communitization, unitization, force-pooling, etc?

RECEIVED

MAY 1 1974

☒ Yes ☐ No If answer is "yes," type of consolidation Communitization

O.C.E.
ARTESIA, OFFICE

If answer is "no," list the owners and tract descriptions which have actually been consolidated. (Use reverse side of this form if necessary.)

No allowable will be assigned to the well until all interests have been consolidated (by communitization, unitization, forced-pooling, or otherwise) or until a non-standard unit, eliminating such interests, has been approved by the Commis-

SION

R 26 E

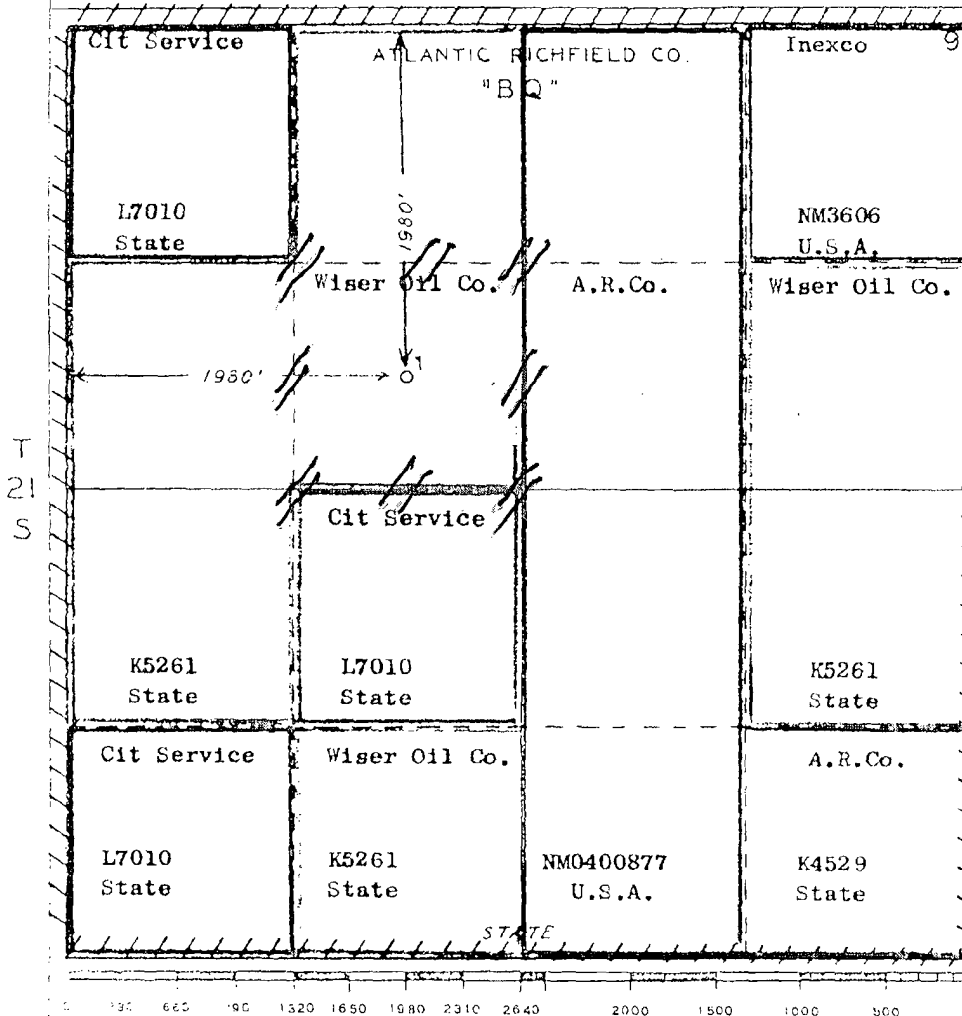

CERTIFICATION

I hereby certify that the information contained herein is true and complete to the best of my knowledge and belief.

By Shirley A. Sasaga
Staff Eng. Tech
Deron Energy Prod Co. LP
 Date 08/04/2010

I hereby certify that the well location shown on this plat was plotted from field notes of actual surveys made by me or under my supervision, and that the same is true and correct to the best of my knowledge and belief.

Date Surveyed APRIL 30, 1974

Registered Professional Land Surveyor

Certificate No. 648