

COG Operating LLC

30-015-38448

## Hydrogen Sulfide Drilling Operation Plan

### I. HYDROGEN SULFIDE TRAINING

All personnel, whether regularly assigned, contracted, or employed on an unscheduled basis, will receive training from a qualified instructor in the following areas prior to commencing drilling operations on this well:

1. The hazards and characteristics of hydrogen sulfide (H<sub>2</sub>S)
2. The proper use and maintenance of personal protective equipment and life support systems.
3. The proper use of H<sub>2</sub>S detectors, alarms, warning systems, briefing areas, evacuation procedures, and prevailing winds.
4. The proper techniques for first aid and rescue procedures.

In addition, supervisory personnel will be trained in the following areas:

1. The effects of H<sub>2</sub>S on metal components. If high tensile tubular are to be used, personnel will be trained in their special maintenance requirements.
2. Corrective action and shut-in procedures when drilling or reworking a well and blowout prevention and well control procedures.
3. The contents and requirements of the H<sub>2</sub>S Drilling Operations Plan and Public Protection Plan.

There will be an initial training session just prior to encountering a known or probable H<sub>2</sub>S zone (within 3 days or 500 feet) and weekly H<sub>2</sub>S and well control drills for all personnel in each crew. The initial training session shall include a review of the site specific H<sub>2</sub>S Drilling Operations Plan and the Public Protection Plan. **The concentrations of H<sub>2</sub>S of wells in this area from surface to TD are low enough that a contingency plan is not required.**

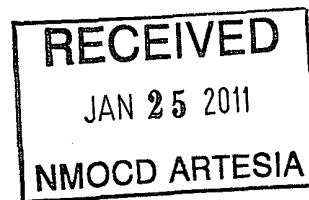

## II. H2S SAFETY EQUIPMENT AND SYSTEMS

Note: All H2S safety equipment and systems will be installed, tested, and operational when drilling reaches a depth of 500 feet above, or three days prior to penetrating the first zone containing or reasonable expected to contain H2S.

### 1. Well Control Equipment:

- A. Flare line.
- B. Choke manifold.
- C. Blind rams and pipe rams to accommodate all pipe sizes with properly sized closing unit.
- D. Auxiliary equipment may include if applicable: annular preventer & rotating head.

### 2. Protective equipment for essential personnel:

- A. Mark II Survive air 30-minute units located in the doghouse and at briefing areas, as indicated on well site diagram.

### 3. H2S detection and monitoring equipment:

- A. 1 portable H2S monitors positioned on location for best coverage and response. These units have warning lights and audible sirens when H2S levels of 20 PPM are reached.

### 4. Visual warning systems:

- A. Wind direction indicators as shown on well site diagram (Exhibit #8).
- B. Caution/Danger signs (Exhibit #7) shall be posted on roads providing direct access to location. Signs will be painted a high visibility yellow with black lettering of sufficient size to be readable at a reasonable distance from the immediate location. Bilingual signs will be used, when appropriate. See example attached.

### 5. Mud program:

- A. The mud program has been designed to minimize the volume of H2S circulated to surface. Proper mud weight, safe drilling practices, and the use of H2S scavengers will minimize hazards when penetrating H2S bearing zones.

**6. Metallurgy:**

- A. All drill strings, casings, tubing, wellhead, blowout preventer, drilling spool, kill lines, choke manifold and lines, and valves shall be suitable for H<sub>2</sub>S service.
- B. All elastomers used for packing and seals shall be H<sub>2</sub>S trim.

**7. Communication:**

- A. Radio communications in company vehicles including cellular telephone and 2-way radio.
- B. Land line (telephone) communication at Office.

**8. Well testing:**

- A. Drill stem testing will be performed with a minimum number of personnel in the immediate vicinity, which are necessary to safely and adequately conduct the test. The drill stem testing will be conducted during daylight hours and formation fluids will not be flowed to the surface. All drill-stem-testing operations conducted in an H<sub>2</sub>S environment will use the closed chamber method of testing.
- B. There will be no drill stem testing.

**EXHIBIT #7**

**WARNING**  
**YOU ARE ENTERING AN H<sub>2</sub>S**  
**AUTHORIZED PERSONNEL ONLY**

- 1. BEARDS OR CONTACT LENSES NOT ALLOWED
- 2. HARD HATS REQUIRED
- 3. SMOKING IN DESIGNATED AREAS ONLY
- 4. BE WIND CONSCIOUS AT ALL TIMES
- 5. CHECK WITH COG OPERATING FOREMAN AT

**COG OPERATING LLC**  
**1-432-683-7443**  
**1-575-746-2010**

**EDDY COUNTY EMERGENCY NUMBERS**

ARTESIA FIRE DEPT. 575-746-5050  
ARTESIA POLICE DEPT. 575-746-5000  
EDDY CO. SHERIFF DEPT. 575-746-9888

**LEA COUNTY EMERGENCY NUMBERS**

HOBBS FIRE DEPT. 575-397-9308  
HOBBS POLICE DEPT. 575-397-9285  
LEA CO. SHERIFF DEPT. 575-396-1196

# DRILLING LOCATION H<sub>2</sub>S SAFETY EQUIPMENT Exhibit # 8

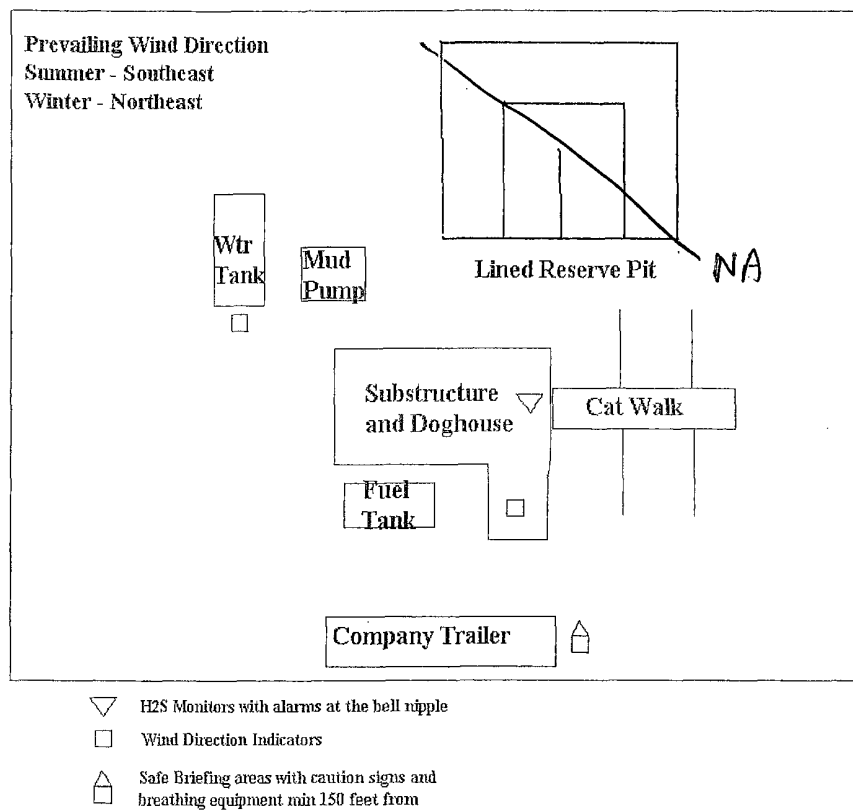

COG Operating LLC

# EXHIBIT 8

Drilling Location - H2S Safety Equipment Diagram

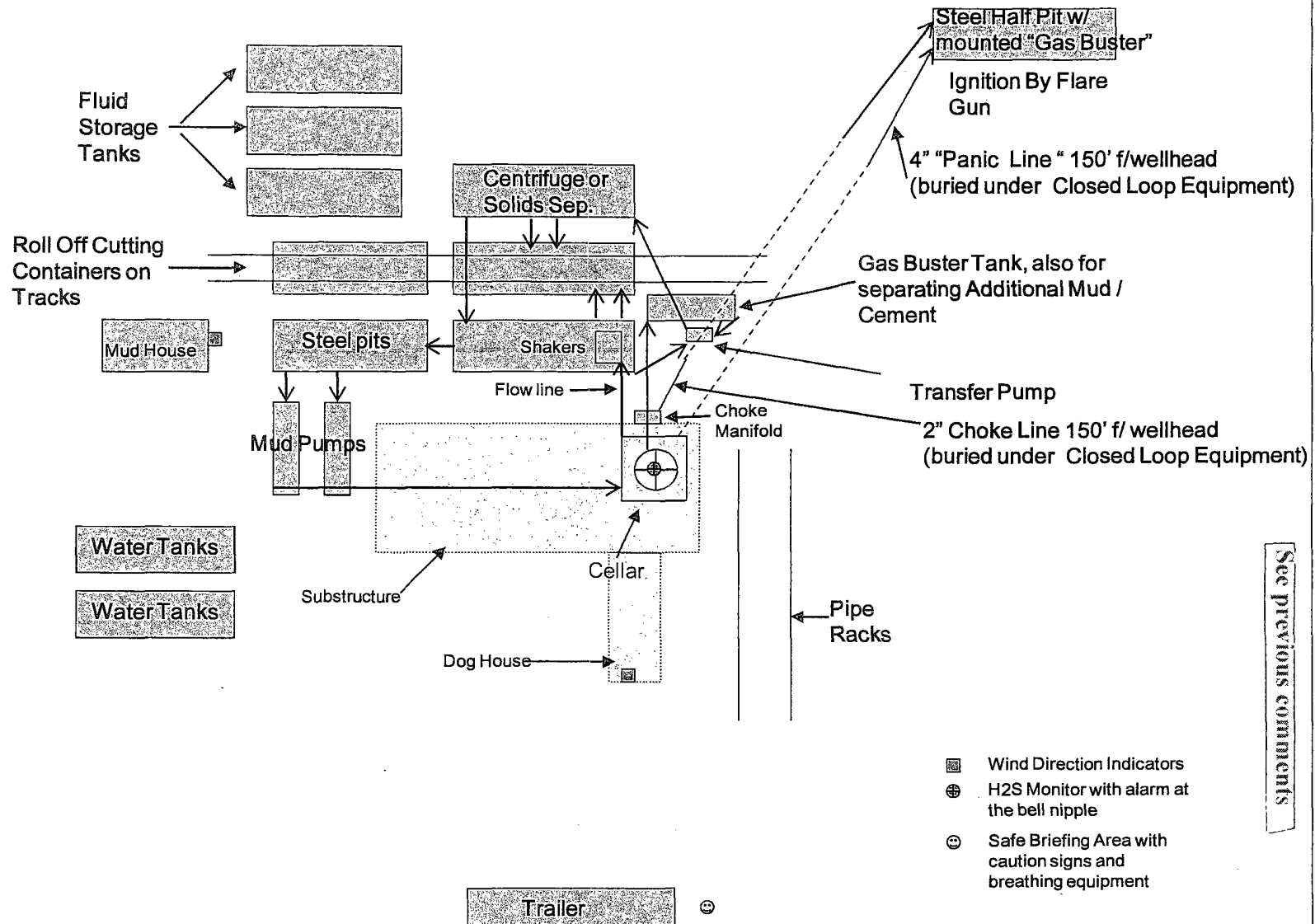

## **SURFACE USE AND OPERATING PLAN**

### **1. Existing & Proposed Access Roads**

- A. The well site survey and elevation plat for the proposed well is shown in Exhibit #1. It was staked by John West Engineering, Hobbs, NM.
- B. All roads to the location are shown in the topographic map Exhibit #2. The existing lease roads are illustrated and are adequate for travel during drilling and production operations. Upgrading existing roads prior to drilling the well will be done where necessary.
- C. **Directions to Location:** From the intersection US Highway 82 and Co. Rd. 224 (Ripple Road), Go Southwest on US Highway 82 apprx 1.2 miles. Turn Right and go Northwest apprx 1.0 mile. Turn Right and go North apprx 0.8 mile. Turn Right and go East apprx 0.3 mile to the Skelly Unit #824 well pad. This location stake is apprx 150 feet South of existing well. See Vicinity Map, Exhibit #3.
- D. Routine grading and maintenance of existing roads will be conducted as necessary to maintain their condition as long as any operations continue on this lease. Roads will be maintained according to specifications in section 2A of this Surface Use and Operating Plan.

### **2. Proposed Access Road:**

Exhibit #4 shows that 0' of new access road will be required for this location. If any road is required it will be constructed as follows:

- A. The maximum width of the running surface will be 14'. The road will be crowned, ditched and constructed of 6" rolled and compacted caliche. Ditches will be at 3:1 slope and 4 feet wide. Water will be diverted where necessary to avoid ponding, prevent erosion, maintain good drainage, and to be consistent with local drainage patterns.
- B. The average grade will be less than 1%.
- C. No turnouts are planned.
- D. No culverts, cattleguard, gates, low water crossings or fence cuts are necessary.

- E. Surfacing material will consist of native caliche. Caliche will be obtained from the actual well site if available. If not available onsite, caliche will be hauled from the nearest BLM caliche pit.

### **3. Location of Existing Well:**

Exhibit #5 shows all existing wells within a one-mile radius of this well.

As shown on this plat there are numerous wells producing from the San Andres and Yeso formations.

### **4. Location of Existing and/or Proposed Facilities:**

- A. COG Operating LLC does operate a production facility on this lease.
- B. If the well is productive, contemplated facilities will be as follows:
  - 1) Production will be sent to the Skelly 942 Federal tank battery located well location @ 1210 FNL & 2195 FEL, Section 22, T17S, R31E, UL B. The facility location is shown in Exhibit #5.
  - 2) The tank battery and facilities including all flow lines and piping will be installed according to API specifications.
  - 3) Any additional caliche will be obtained from the actual well site. If caliche does not exist or is not plentiful from the well site, the caliche will be hauled from a BLM approved caliche pit. Any additional construction materials will be purchased from contractors.
  - 4) Proposed flow lines, will follow an archaeologically approved route to the Skelly 942 Federal tank battery located well location @ 1210 FNL & 2195 FEL, Section 22, T17S, R31E, UL B. The flowline will be SDR 7 3" poly line laid on the surface and will be approximately 1.5 miles in length with max pressure 100 psi. Flowlines will be no more than 11' from the paralleling road. The facility location is shown in Exhibit #5.
  - 5) It will be necessary to run electric power if this well is productive. Power will be provided by CVE and they will submit a separate plan and ROW for service to the well location.
  - 6) If the well is productive, rehabilitation plans will include the following:
    - a) The original topsoil from the well site will be returned to the location, and the site will be re-contoured as close as possible to the original site.

## **5. Location and Type of Water Supply:**

The well will be drilled with combination brine and fresh water mud system as outlined in the drilling program. The water will be obtained from commercial water stations in the area and hauled to location by transport truck over the existing and proposed access roads shown in Exhibit #2. If a commercial fresh water source is nearby, fast line may be laid along existing road ROW's and fresh water pumped to the well. No water well will be drilled on the location.

## **6. Source of Construction Materials and Location "Turn-Over" Procedure:**

Obtaining caliche:      The primary way of obtaining caliche to build locations and roads will be by "turning over" the location. This means, caliche will be obtained from the actual well sight. A caliche permit will be obtained from BLM prior to pushing up any caliche. 2400 cu. Yards is max amount of caliche needed for pad and roads. Amount will vary for each pad. The procedure below has been approved by BLM personnel:

- A. The top 6 inches of topsoil is pushed off and stockpiled along the side of the location.**
- B. An approximate 120' X 120' area is used within the proposed well site to remove caliche.**
- C. Subsoil is removed and piled along side the 120' by 120' area within the pad site.**
- D. When caliche is found, material will be stock piled within the pad site to build the location and road.**
- E. Then subsoil is pushed back in the hole and caliche is spread accordingly across entire location and road.**
- F. Once well is drilled, the stock piled top soil will be used for interim reclamation and spread along areas where caliche is picked up and the location size is reduced. Neither caliche or subsoil will be stock piled outside of the well pad. Topsoil will be stockpiled along the edge of the pad as depicted in attached plat.**

In the event that no caliche is found onsite, caliche will be hauled in from a BLM approved caliche pit.

## **7. Methods of Handling Water Disposal:**

- A. The well will be drilled utilizing a closed loop mud system. Drill cuttings will be held in roll-off style mud boxes and taken to an NMOCD approved disposal site.**
- B. Drilling fluids will be contained in steel mud pits.**



- C. Water produced from the well during completion will be held temporarily in steel tanks and then taken to an NMOCD approved commercial disposal facility.
- D. Garbage and trash produced during drilling or completion operations will be collected in a trash bin and hauled to an approved landfill. No toxic waste or hazardous chemicals will be produced by this operation.
- E. After the rig is moved out and the well is either completed or abandoned, all waste materials will be cleaned up within 30 days. In the event of a dry hole only a dry hole marker will remain.

**8. Ancillary Facilities:**

No airstrip, campsite or other facilities will be built as a result of the operation on this well.

**9. Well Site Layout:**

- A. The drill pad layout, with elevations staked by John West Engineering, is shown in Exhibit #4. Dimensions of the pad and pits are shown on Exhibit #6. V door direction is West. Topsoil, if available, will be stockpiled per BLM specifications. Because the pad is almost level no major cuts will be required.
- B. Exhibit #6 also shows the proposed orientation of closed loop system and access road. No permanent living facilities are planned, but a temporary foreman/toolpusher's trailer will be on location during the drilling operations.

**10. Plans for Restoration of the Surface:**

- A. Interim Reclamation will take place after the well has been completed. The pad will be downsized by reclaiming the areas not needed for production operations. The portions of the pad that are not needed for production operations will be recontoured to its original state as much as possible. The caliche that is removed will be reused to either build another pad site or for road repairs within the lease. The stockpiled topsoil will then be spread out reclaimed area and reseeded with a BLM approved seed mixture. In the event that the well must be worked over or maintained, it may be necessary to drive, park, and/or operate machinery on reclaimed land. This area will be repaired or reclaimed after work is complete. Pad will be approx. 200'X250' when reclaimed.
- B.

- C. Final Reclamation: Upon plugging and abandoning the well, All caliche for well pad and lease road will be removed and surface will be recountoured to reflect its surroundings as much as possible. Caliche will be recycled for road repair or reused for another well pad within the lease. If any topsoil remains, it will be spread out and the area will be re-seeded with a BLM approved mixture and revegetated as per BLM orders.

**11. Surface Ownership:**

- A. The surface is owned by the U.S. Government and is administered by the Bureau of Land Management. The surface is multiple uses with the primary uses of the region for grazing of livestock and the production of oil and gas.
- B. The surface tenant for this site is Charles Martin, P.O. Box 706, Artesia NM 88211.
- C. The proposed road routes and surface location will be restored as directed by the BLM

**12. Other Information:**

- A. The area around the well site is grassland and the topsoil is sandy. The vegetation is moderately sparse with native prairie grasses, some mesquite and shinnery oak. No wildlife was observed but it is likely that mule deer, rabbits, coyotes and rodents traverse the area.
- B. There is no permanent or live water in the immediate area.
- C. There are no dwellings within 2 miles of this location.
- D. If needed, a Cultural Resources Examination is being prepared by Southern New Mexico Archaeological Services, Inc. P.O. Box 1, Bent New Mexico, 88314, phone # 505-671-4797 and the results will be forwarded to your office in the near future. Otherwise, **COG will be participating in the Permian Basin MOA Program.**

*Surface Use Plan*

*COG Operating, LLC*

*Skelly Unit 833*

*SHL: 900 FNL & 1851 FEL, UL B*

*BHL: 990' FNL & 1650' FEL, UL B*

*Section 15, T-17-S, R-31-E*

*Eddy County, New Mexico*

**13. Bond Coverage:**

Bond Coverage is Nationwide Bond # 000215

**14. Lessee's and Operator's Representative:**

The COG Operating LLC representative responsible for assuring compliance with the surface use plan is as follows:

John Coffman,

Erick Nelson.

Drilling Superintendent

Division Operations Manager

COG Operating LLC

COG Operating LLC

550 W. Texas, Suite 1300

550 W. Texas, Suite 1300

Midland, TX 79701

Midland, TX 79701

Phone (432) 683-7443 (office)

Phone (505) 746-2210 (office)

(432) 631-9762 (cell)

(432) 238-7591 (cell)

Surface Use Plan  
COG Operating, LLC  
Skelly Unit 833

SHL: 900 FNL & 1851 FEL, UL B      BHL: 990' FNL & 1650' FEL, UL B  
Section 15, T-17-S, R-31-E  
Eddy County, New Mexico

I hereby certify that I, or persons under my direct supervision, have inspected the drill site and access road proposed herein; that I am familiar with the conditions that presently exist; that I have full knowledge of State and Federal laws applicable to this operation; that the statements made in this APD package are, to the best of my knowledge, true and correct; and that the work associated with the operations proposed herein will be performed in conformity with this APD package and the terms and conditions under which it is approved. I also certify that I, or COG Operating, LLC, am responsible for the operations conducted under this application. These statements are subject to the provisions of 18 U.S.C. 1001 for the filing of false statements. Executed this 27<sup>th</sup> day of August, 2010.

Signed: \_\_\_\_\_

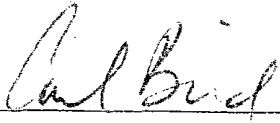

Printed Name: Carl Bird

Position: Drilling Engineer

Address: 550 W. Texas, Suite 1300, Midland, Texas 79701

Telephone: (432) 683-7443

Field Representative (if not above signatory): Same

E-mail: cbird@conchoresources.com

# SECTION 15, TOWNSHIP 17 SOUTH, RANGE 31 EAST, N.M.P.M.

EDDY COUNTY

NEW MEXICO

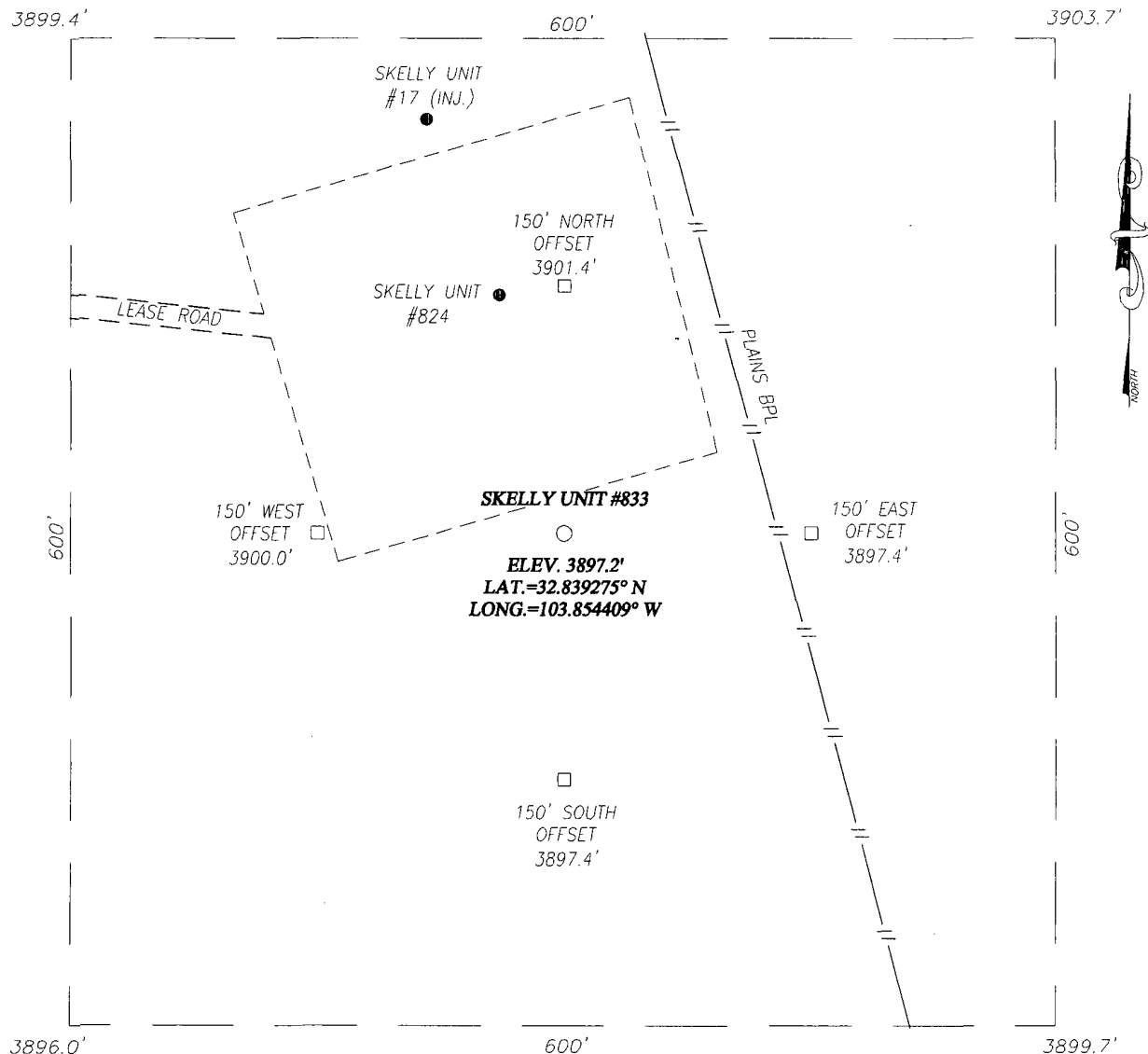

## DIRECTIONS TO LOCATION

FROM THE INTERSECTION OF U.S. HWY. #82 AND CO. RD. #224 (RIPPLE RD.), GO SOUTHWEST ON U.S. HWY. #82 APPROX. 1.2 MILES. TURN RIGHT AND GO NORTHWEST APPROX. 1.0 MILE. TURN RIGHT AND GO NORTH APPROX. 0.8 MILES. TURN RIGHT AND GO EAST APPROX. 0.3 MILES TO THE SKELLY UNIT #824 WELL PAD. THE LOCATION STAKE IS APPROX. 150 FEET SOUTH OF EXISTING WELL.

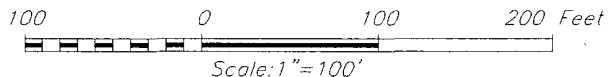

## COG OPERATING, LLC

SKELLY UNIT #833 WELL  
LOCATED 900 FEET FROM THE NORTH LINE  
AND 1851 FEET FROM THE EAST LINE OF SECTION 15,  
TOWNSHIP 17 SOUTH, RANGE 31 EAST, N.M.P.M.,  
EDDY COUNTY, NEW MEXICO

Survey Date: 8/12/10	Sheet 1 of 1 Sheets
W.O. Number: 10.11.1027	Dr By: LA
Date: 8/19/10	10111027
	Scale: 1"=100'

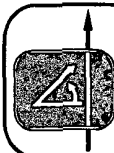

PROVIDING SURVEYING SERVICES  
SINCE 1946  
**JOHN WEST SURVEYING COMPANY**  
412 N. DAL PASO  
HOBBS, N.M. 88240  
(575) 393-3117

# VICINITY MAP

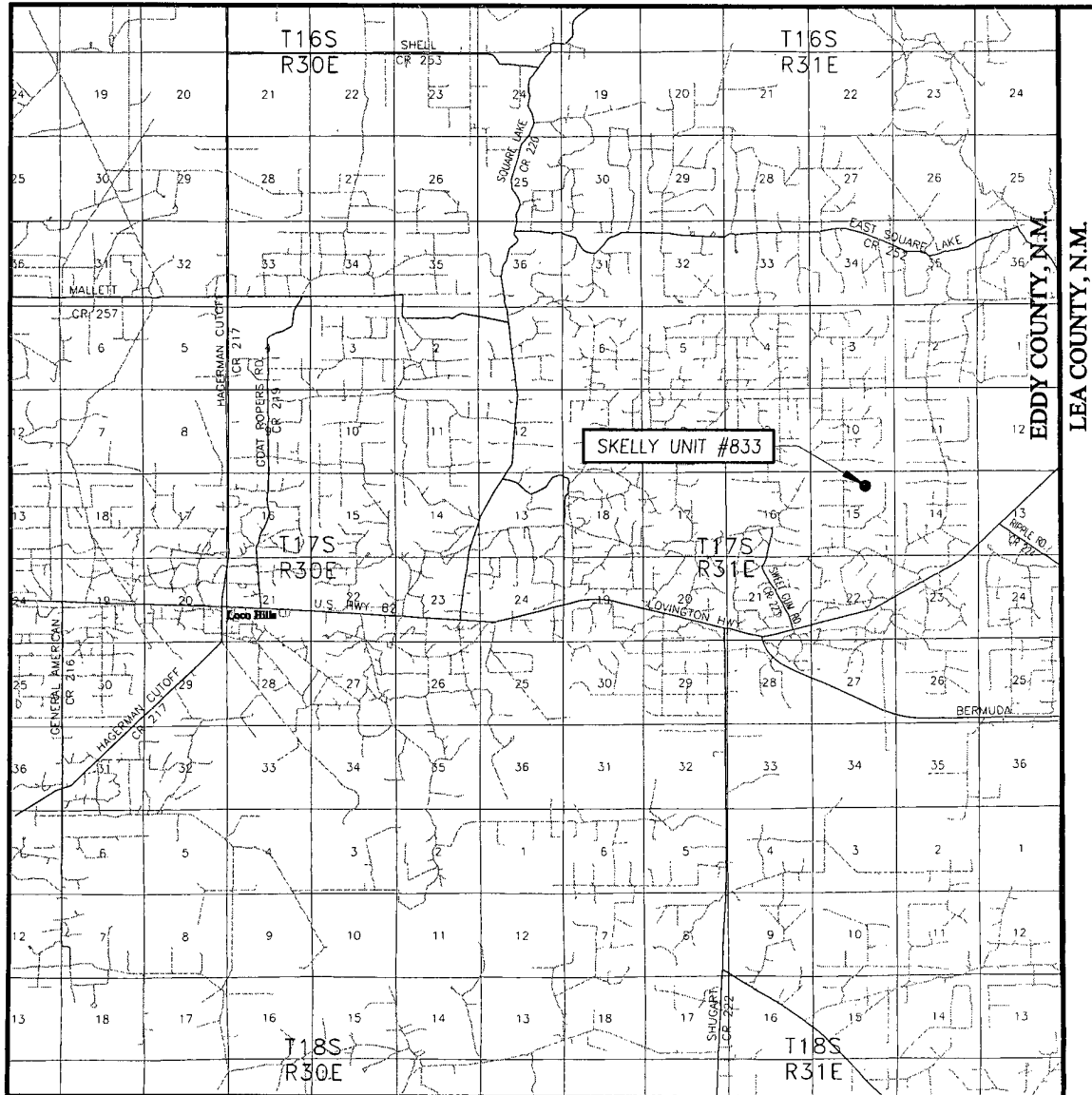

SCALE: 1" = 2 MILES

SEC. 15 TWP. 17-S RGE. 31-E  
 SURVEY N.M.P.M.  
 COUNTY EDDY STATE NEW MEXICO  
 DESCRIPTION 900' FNL & 1851' FEL  
 ELEVATION 3897'  
 COG  
 OPERATOR OPERATING, LLC  
 LEASE SKELLY UNIT



PROVIDING SURVEYING SERVICES  
 SINCE 1946  
**JOHN WEST SURVEYING COMPANY**  
 412 N. DAL PASO  
 HOBBS, N.M. 88240  
 (575) 393-3117

# LOCATION VERIFICATION MAP

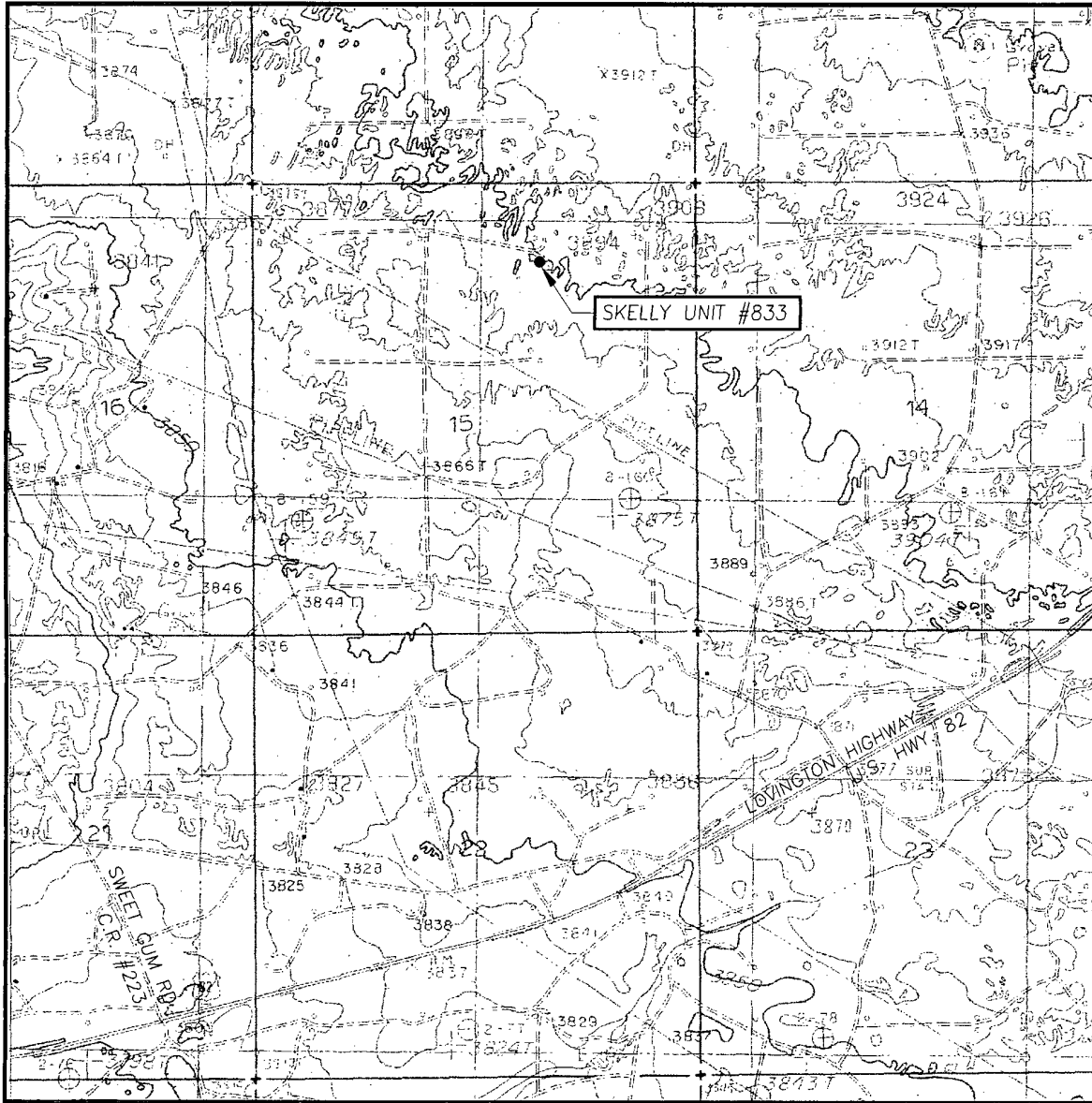

SCALE: 1" = 2000'

CONTOUR INTERVAL:  
MALJAMAR, N.M. - 10'

SEC. 15 TWP. 17-S RGE. 31-E

SURVEY \_\_\_\_\_ N.M.P.M. \_\_\_\_\_

COUNTY EDDY STATE NEW MEXICO

DESCRIPTION 900' FNL & 1851' FEL

ELEVATION 3897'

OPERATOR COG OPERATING, INC.

LEASE SKELLY UNIT

U.S.G.S. TOPOGRAPHIC MAP  
MALJAMAR, N.M.

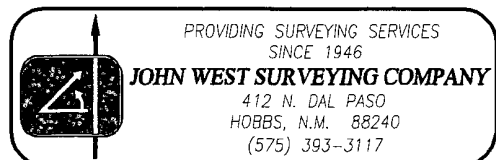

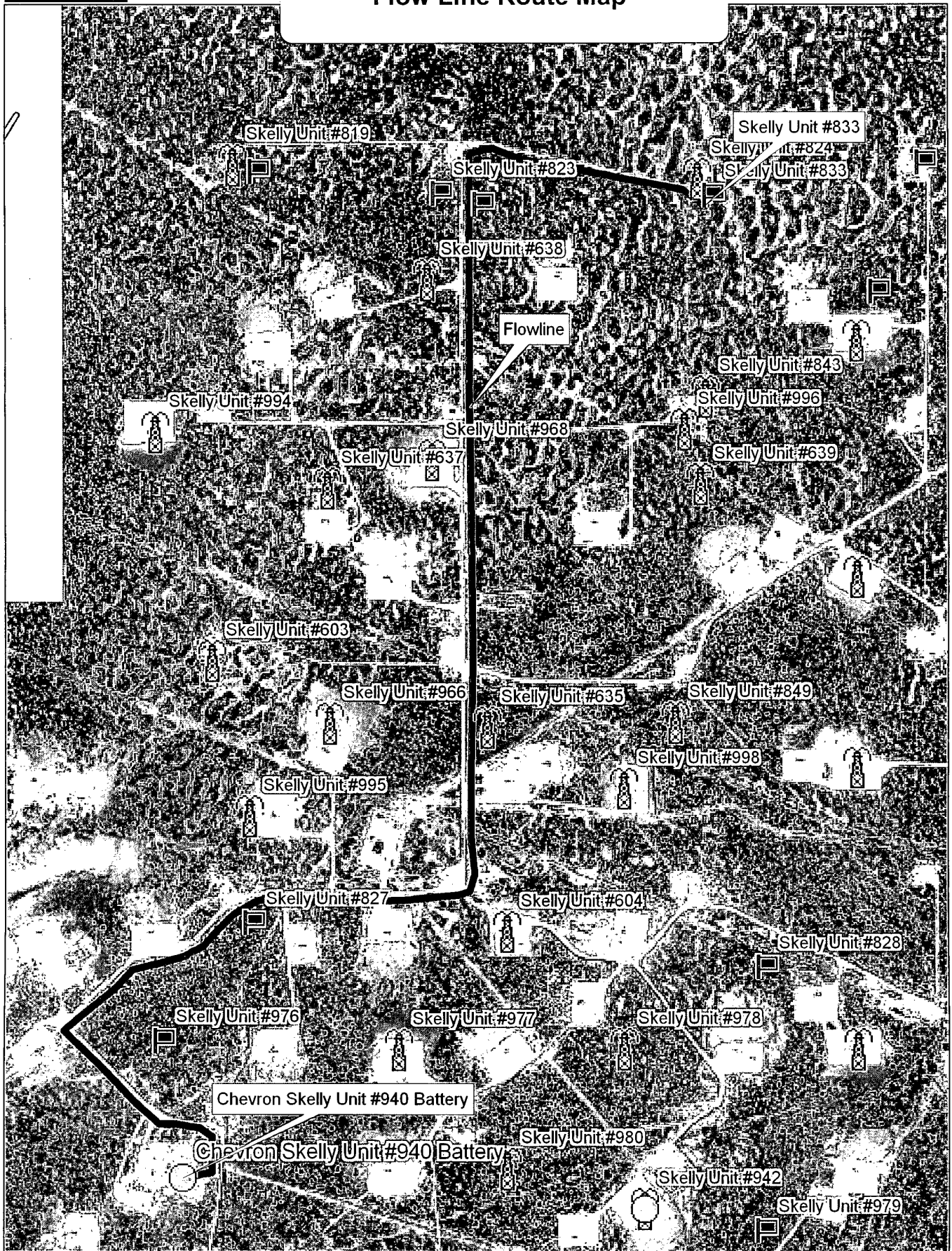

Data use subject to license.

© DeLorme. XMap® 7.

www.delorme.com

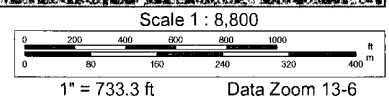



Replaced 12/3/10 TEN

DELOORME

# Flow Line Route Map

XMap® 7

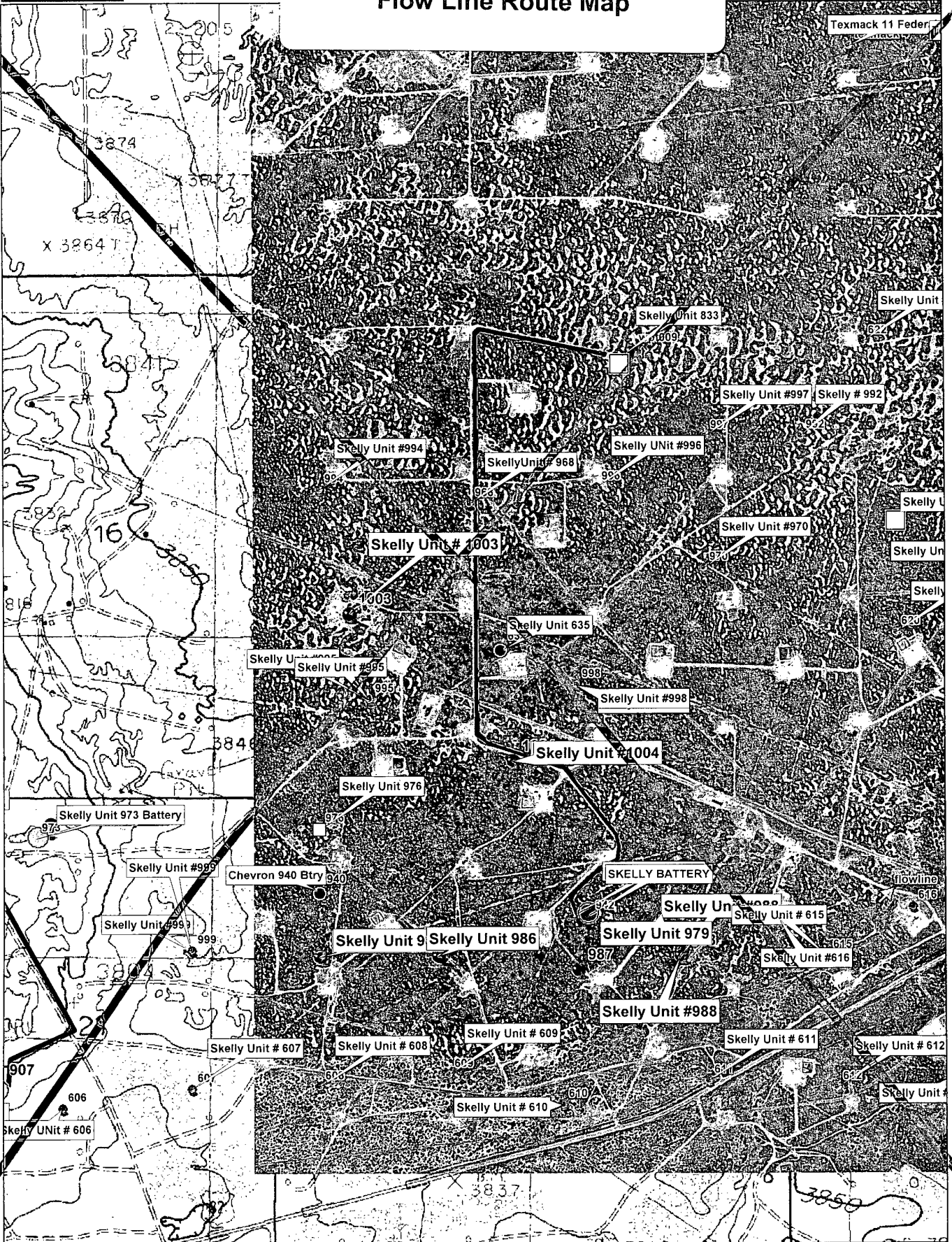

Data use subject to license.

© DeLorme. XMap® 7.

www.delorme.com

TN  
MN (7.9"E)

Scale 1 : 16,000  
0 400 800 1200 1600 2000  
0 140 280 420 560 700  
1" = 1,333.3 ft Data Zoom 13-6

## Wells in 1 Mile Radius to Skelly Unit 833

API#	Operator	County	Legal	Lease	Well#	Date Issued	Permitted Depth	Permit TVD	Images	Doc	Total Depth	Well Type	Well Status	Target Formation
30-015-37982	COG OPERATING LLC	EDDY	S:15, T:17S, R:31E	SKELLY UNIT	823	7/2/2010	7,100		No	link	7,100	PO	Active	
30-015-37983	COG OPERATING LLC	EDDY	S:15, T:17S, R:31E	SKELLY UNIT	829	7/2/2010	7,000		No	link	7,000	PO	Active	
30-015-37985	COG OPERATING LLC	EDDY	S:15, T:17S, R:31E	SKELLY UNIT	843	7/1/2010	3,885		No	link	3,885	PO	Active	
30-015-37979	COG OPERATING LLC	EDDY	S:14, T:17S, R:31E	SKELLY UNIT	654	6/29/2010	96,900		No	link	96,900	PO	Active	
30-015-37980	COG OPERATING LLC	EDDY	S:14, T:17S, R:31E	SKELLY UNIT	658	6/29/2010	6,800		No	link	6,800	PO	Active	
30-015-37984	COG OPERATING LLC	EDDY	S:15, T:17S, R:31E	SKELLY UNIT	832	6/29/2010	7,000		No	link	7,000	PO	Active	
30-015-37868	COG OPERATING LLC	EDDY	S:16, T:17S, R:31E	CHOCTAW STATE	005	6/4/2010	6,700		Yes	link	6,700	PO	Active	YESO FORMATION
30-015-37909	COG OPERATING LLC	EDDY	S:15, T:17S, R:31E	SKELLY UNIT	836	6/1/2010	6,750		Yes	link	6,750	PO	Active Permit	
30-015-37886	COG OPERATING LLC	EDDY	S:15, T:17S, R:31E	SKELLY UNIT	820	5/20/2010	7,100		Yes	link	7,100	PO	Active Permit	
30-015-37823	COG OPERATING LLC	EDDY	S:11, T:17S, R:31E	TEX MACK 11 FEDERAL	39	5/13/2010	7,000		Yes	link	7,000	PO	Active Permit	
30-015-37637	COG OPERATING LLC	EDDY	S:16, T:17S, R:31E	CHOCTAW STATE	004	3/10/2010	6,700		Yes	link	6,700	PO	Active Permit	YESO FORMATION
30-015-37624	COG OPERATING LLC	EDDY	S:16, T:17S, R:31E	WILLOW STATE	012	3/2/2010	6,700		Yes	link	6,700	PO	Active Permit	YESO FORMATION
30-015-37668	COG OPERATING LLC	EDDY	S:15, T:17S, R:31E	SKELLY UNIT	824	2/25/2010	7,036	7,000	Yes	link	7,036	PO	Active Permit	
30-015-37667	COG OPERATING LLC	EDDY	S:11, T:17S, R:31E	TEX-MACK 11 FEDERAL	35	2/24/2010	7,000		Yes	link	7,000	PO	Active Permit	
30-015-37517	COG OPERATING LLC	EDDY	S:15, T:17S, R:31E	SKELLY UNIT	849	1/6/2010	6,917	6,900	Yes	link	6,917	PO	Active Permit	
30-015-37474	COG OPERATING LLC	EDDY	S:14, T:17S, R:31E	SKELLY UNIT	678	12/18/2009	6,900		Yes	link	6,900	PO	Active Permit	
30-015-37475	COG OPERATING LLC	EDDY	S:15, T:17S, R:31E	SKELLY UNIT	819	12/18/2009	6,900		Yes	link	6,930	O	Active Permit	
30-015-37477	COG OPERATING LLC	EDDY	S:14, T:17S, R:31E	SKELLY UNIT	682	12/18/2009	6,900		Yes	link	6,900	PO	Active Permit	
30-015-37176	COG OPERATING LLC	EDDY	S:16, T:17S, R:31E	WILLOW STATE	14	7/24/2009	6,800		Yes	link	6,800	PO	Active Permit	YESO FORMATION
	COG OPERATING													

30-015-37084	LLC	EDDY	S:15, T:17S, R:31E	SKELLY UNIT	638	5/19/2009	6,722	6,700	Yes	link	6,740	O	Active Permit	
30-015-37089	COG OPERATING LLC	EDDY	S:15, T:17S, R:31E	SKELLY UNIT	637	5/19/2009	6,722	6,700	Yes	link	6,735	O	Active Permit	
30-015-37083	COG OPERATING LLC	EDDY	S:15, T:17S, R:31E	SKELLY UNIT	639	5/19/2009	6,711	6,700	Yes	link	6,720	O	Active Permit	
30-015-37085	COG OPERATING LLC	EDDY	S:15, T:17S, R:31E	SKELLY UNIT	640	5/19/2009	6,800		Yes	link	6,795	O	Active Permit	
30-015-37090	COG OPERATING LLC	EDDY	S:15, T:17S, R:31E	SKELLY UNIT	636	5/19/2009	6,811	6,800	Yes	link	6,826	O	Active Permit	
30-015-37657	COG OPERATING LLC	EDDY	S:15, T:17S, R:31E	SKELLY UNIT	635	3/6/2009	6,708	6,700	Yes	link	6,708	PO	Active Permit	
30-015-36966	COG OPERATING LLC	EDDY	S:14, T:17S, R:31E	SKELLY UNIT	633	2/25/2009	6,800		Yes	link	6,798	O	Active Permit	
30-015-36965	COG OPERATING LLC	EDDY	S:14, T:17S, R:31E	SKELLY UNIT	634	2/25/2009	6,800		Yes	link	6,820	O	Active Permit	
30-015-36974	COG OPERATING LLC	EDDY	S:15, T:17S, R:31E	SKELLY UNIT	632	2/25/2009	6,800		Yes	link	6,825	O	Active Permit	
30-015-36848	COG OPERATING LLC	EDDY	S:11, T:17S, R:31E	TEX MACK 11 FEDERAL	6	12/12/2008	6,600		Yes	link	6,852	O	Active Permit	
30-015-36850	COG OPERATING LLC	EDDY	S:11, T:17S, R:31E	TEX MACK 11 FEDERAL	8	12/12/2008	6,650		Yes	link	6,655	O	Active Permit	
30-015-36831	COG OPERATING LLC	EDDY	S:14, T:17S, R:31E	SKELLY UNIT	622	12/5/2008	6,640	6,600	Yes	link	6,650	O	Active Permit	
30-015-36833	COG OPERATING LLC	EDDY	S:14, T:17S, R:31E	SKELLY UNIT	623	12/5/2008	6,642	6,600	Yes	link	6,857	O	Active Permit	
30-015-36836	COG OPERATING LLC AGENT or COG OPERATING LLC	EDDY	S:11, T:17S, R:31E	TEX MACK 11 FEDERAL	4	12/5/2008	6,600		Yes	link	6,822	O	Active Permit	
30-015-36779	COG OPERATING LLC	EDDY	S:14, T:17S, R:31E	SKELLY UNIT	620	11/21/2008	6,500		Yes	link	6,570	O	Active Permit	
30-015-36728	COG OPERATING LLC	EDDY	S:15, T:17S, R:31E	SKELLY UNIT	603	10/14/2008	6,500		Yes	link	6,753	O	Active Permit	
30-015-36729	COG OPERATING LLC	EDDY	S:15, T:17S, R:31E	SKELLY UNIT	996	10/9/2008	6,700		Yes	link	6,767	O	Active Permit	
30-015-36588	COG OPERATING L L C or COG OPERATING LLC	EDDY	S:15, T:17S, R:31E	SKELLY UNIT	994	8/27/2008	6,528	6,500	Yes	link	6,690	O	Active Permit	
30-015-36514	COG OPERATING LLC AGENT or COG OPERATING LLC	EDDY	S:23, T:17S, R:31E	SKELLY UNIT	983	8/4/2008	6,500		Yes	link	6,700	O	Active Permit	
	COG													

30-015-36517	OPERATING LLC AGENT or COG OPERATING LLC	EDDY	S:14, T:17S, R:31E	SKELLY UNIT	984	8/4/2008	6,500	Yes	link	6,720	O	Active Permit	
30-015-36516	COG OPERATING LLC AGENT or COG OPERATING LLC	EDDY	S:22, T:17S, R:31E	SKELLY UNIT	981	8/4/2008	6,500	Yes	link	6,505	O	Active Permit	
30-015-36472	COG OPERATING LLC	EDDY	S:14, T:17S, R:31E	SKELLY UNIT	993	7/31/2008	6,700	Yes	link	6,790	O	Active Permit	
30-015-36473	COG OPERATING LLC	EDDY	S:15, T:17S, R:31E	SKELLY UNIT	995	7/31/2008	6,450	Yes	link	6,450	PO	Active Permit	
30-015-36598	COG OPERATING LLC	EDDY	S:14, T:17S, R:31E	SKELLY UNIT	992	7/31/2008	6,700	Yes	link	6,696	O	Active Permit	
30-015-36681	COG OPERATING LLC	EDDY	S:15, T:17S, R:31E	SKELLY UNIT	998	7/31/2008	6,600	Yes	link	6,593	O	Active Permit	
30-015-36474	COG OPERATING LLC	EDDY	S:15, T:17S, R:31E	SKELLY UNIT	997	7/22/2008	6,700	Yes	link	6,495	O	Active Permit	
30-015-36423	FOREST OIL CORPORATION	EDDY	S:16, T:17S, R:31E	STATE B	13	7/18/2008	4,100	Yes	link	4,100	PI	Active Permit	GRAYBURG
30-015-36445	COG OPERATING LLC	EDDY	S:15, T:17S, R:31E	SKELLY UNIT	604	7/18/2008	6,450	Yes	link	6,512	O	Active Permit	
30-015-36256	FOREST OIL CORPORATION	EDDY	S:16, T:17S, R:31E	FOC B STATE	012	4/7/2008	4,100	Yes	link	4,030	O	Active Permit	GRAYBURG
30-015-36254	FOREST OIL CORPORATION	EDDY	S:16, T:17S, R:31E	FOC B STATE	10	4/7/2008	4,100	Yes	link	4,075	O	Active Permit	GRAYBURG
30-015-36061	CHEVRON USA, INC. or CHEVRON USA INC	EDDY	S:22, T:17S, R:31E	SKELLY UNIT	977	1/17/2008	6,500	Yes	link	6,510	O	Active Permit	
30-015-36062	CHEVRON USA, INC. or CHEVRON USA INC	EDDY	S:22, T:17S, R:31E	SKELLY UNIT	978	1/17/2008	6,500	Yes	link	6,500	PO	Active Permit	
30-015-35876	COG OPERATING LLC	EDDY	S:16, T:17S, R:31E	CHOCOTAW STATE	002	10/22/2007	6,600	Yes	link	6,610	O	Active Permit	YESO FORMATION
30-015-35877	COG OPERATING LLC	EDDY	S:16, T:17S, R:31E	CHOCOTAW STATE	003	10/22/2007	6,600	Yes	link	6,625	O	Active Permit	YESO FORMATION
30-015-35867	CHEVRON USA, INC. or CHEVRON USA INC	EDDY	S:14, T:17S, R:31E	SKELLY UNIT	969	10/11/2007	6,500	Yes	link	6,517	O	Active Permit	
30-015-35969	CHEVRON USA, INC. or CHEVRON USA INC	EDDY	S:15, T:17S, R:31E	SKELLY UNIT	966	10/11/2007	6,500	Yes	link	6,615	O	Active Permit	
30-015-35816	CHEVRON USA, INC.	EDDY	S:15, T:17S, R:31E	SKELLY UNIT	968	9/18/2007	6,500	Yes	link	6,566	O	Active Permit	
30-015-35817	CHEVRON USA, INC. or COG OPERATING LLC	EDDY	S:15, T:17S, R:31E	SKELLY UNIT	970	9/18/2007	6,500	Yes	link	6,521	O	Active Permit	
	CHEVRON USA,												

30-015-35871	INC. or CHEVRON USA INC	EDDY	S:15, T:17S, R:31E	SKELLY UNIT	967	9/18/2007	6,500	Yes	link	6,508	O	Active Permit	
30-015-35947	CHEVRON USA, INC. or CHEVRON USA INC	EDDY	S:14, T:17S, R:31E	SKELLY UNIT	971	9/18/2007	6,600	Yes	link	6,580	O	Active Permit	
30-015-34647	CHEVRON USA, INC.	EDDY	S:15, T:17S, R:31E	SKELLY UNIT	965	2/22/2006	3,849	No	link	5,370	O	Active Permit	
30-015-34686	CHEVRON U S A INC	EDDY	S:15, T:17S, R:31E	SKELLY UNIT	964	2/22/2006	5,500	No	link	5,410	PO	Active Permit	FREN PADDOCK
30-015-34646	CHEVRON USA, INC.	EDDY	S:15, T:17S, R:31E	SKELLY UNIT	963	2/21/2006	5,500	No	link	5,500	PO	Active Permit	
30-015-34324	CHEVRON USA, INC.	EDDY	S:14, T:17S, R:31E	SKELLY UNIT	961	9/2/2005	5,500	No	link	5,495	O	Active Permit	
30-015-34325	CHEVRON USA, INC.	EDDY	S:23, T:17S, R:31E	SKELLY UNIT	962	9/2/2005	5,500	No	link	5,470	PO	Active Permit	
30-015-34326	CHEVRON USA, INC.	EDDY	S:14, T:17S, R:31E	SKELLY UNIT	960	9/2/2005	5,500	No	link	5,480	O	Active Permit	
30-015-34327	CHEVRON USA, INC.	EDDY	S:15, T:17S, R:31E	SKELLY UNIT	959	9/2/2005	5,500	No	link	5,480	O	Active Permit	
30-015-34318	CHEVRON USA, INC.	EDDY	S:15, T:17S, R:31E	SKELLY UNIT	958	8/30/2005	5,500	No	link	5,480	O	Active Permit	
30-015-34143	MACK ENERGY CORPORATION or MACK ENERGY CORP	EDDY	S:15, T:17S, R:31E	WILLOW STATE	007	6/3/2005	6,400	No	link	5,325	PO	Active Permit	PADDOCK
30-015-34126	MARBOB ENERGY CORP	EDDY	S:9, T:17S, R:31E	CROW FEDERAL	001	5/17/2005	12,300	No	link	12,140	G	Active Permit	
30-015-32965	CHEVRON USA, INC. or CHEVRON U S A INC	EDDY	S:22, T:17S, R:31E	SKELLY UNIT	946	11/30/2004		No	link	5,430	O	Active	FREN PADDOCK 26770
30-015-32966	CHEVRON USA, INC. or CHEVRON U S A INC	EDDY	S:22, T:17S, R:31E	SKELLY UNIT	947	11/30/2004		No	link	5,430	O	Active	FREN PADDOCK 26770
30-015-32968	CHEVRON USA, INC. or CHEVRON U S A INC	EDDY	S:15, T:17S, R:31E	SKELLY UNIT	949	11/30/2004		No	link	5,350	O	Active	FREN PADDOCK
30-015-32967	CHEVRON USA, INC. or CHEVRON U S A INC	EDDY	S:15, T:17S, R:31E	SKELLY UNIT	948	11/30/2004		No	link	5,350	O	Active	FREN PADDOCK 26770
30-015-32316	MARBOB ENERGY CORP	EDDY	S:10, T:17S, R:31E	OXY BUTTER PECAN FEDERAL	001	6/30/2004		No	link	12,200	G	Active	FREN MORROW
30-015-33089	MARBOB ENERGY CORPORATION or MARBOB ENERGY CORP	EDDY	S:16, T:17S, R:31E	OXY SPUMONI STATE	001	4/8/2004	9,850	Yes	link	12,200	G	Active	PENN
30-015-33089	MARBOB ENERGY CORP	EDDY	S:16, T:17S, R:31E	OXY SPUMONI STATE	001	3/31/2004		No	link	12,200	G	Active	FREN CISCO CANYON
30-015-33089	OXY USA WTP LIMITED PARTNERSHIP	EDDY	S:16, T:17S, R:31E	OXY SPUMONI STATE	001	11/1/2003	12,000	No	link	12,200	G	Active	MORROW
30-015-32963	CHEVRON USA, INC. or CHEVRON USA INC	EDDY	S:22, T:17S, R:31E	SKELLY UNIT	944	8/21/2003	5,500	No	link	5,450	O	Active	FREN PADDOCK
	CHEVRON USA, INC. or												

30-015-32964	CHEVRON USA INC	EDDY	S:22, T:17S, R:31E	SKELLY UNIT	945	8/21/2003	5,500	No	link	5,483	O	Active	FREN PADDOCK
30-015-32965	CHEVRON USA, INC. or CHEVRON USA INC	EDDY	S:22, T:17S, R:31E	SKELLY UNIT	946	8/21/2003	5,500	No	link	5,430	O	Active	FREN PADDOCK
30-015-32966	CHEVRON USA, INC. or CHEVRON USA INC	EDDY	S:22, T:17S, R:31E	SKELLY UNIT	947	8/21/2003	5,500	No	link	5,430	O	Active	FREN PADDOCK
30-015-32967	CHEVRON USA, INC. or CHEVRON USA INC	EDDY	S:15, T:17S, R:31E	SKELLY UNIT	948	8/21/2003	5,500	No	link	5,350	O	Active	FREN PADDOCK
30-015-32968	CHEVRON USA, INC. or CHEVRON USA INC	EDDY	S:15, T:17S, R:31E	SKELLY UNIT	949	8/21/2003	5,500	No	link	5,350	O	Active	FREN PADDOCK
30-015-32963	CHEVRON USA, INC. or CHEVRON U S A INC	EDDY	S:22, T:17S, R:31E	SKELLY UNIT	944	7/31/2003		No	link	5,450	O	Active	FREN PADDOCK
30-015-32964	CHEVRON USA, INC. or CHEVRON U S A INC	EDDY	S:22, T:17S, R:31E	SKELLY UNIT	945	7/31/2003		No	link	5,483	O	Active	FREN PADDOCK
30-015-32844	MACK ENERGY CORPORATION or MACK ENERGY CORP	EDDY	S:16, T:17S, R:31E	WILLOW STATE	4	6/15/2003	6,400	No	link	5,405	O	Active	Paddock
30-015-32844	MACK ENERGY CORP	EDDY	S:16, T:17S, R:31E	WILLOW STATE	004	5/31/2003		No	link	5,405	O	Active	Paddock
30-015-32598	CHEVRON USA, INC. or CHEVRON USA INC	EDDY	S:21, T:17S, R:31E	SKELLY UNIT	939	1/16/2003	5,500	No	link	5,360	O	Active	FREN PADDOCK
30-015-05173	WISER OIL CO (THE)	EDDY	S:16, T:17S, R:31E	STATE B	004	1/1/2003	0	No	link	3,782	O	Shut-in	
30-015-05172	WISER OIL CO (THE)	EDDY	S:16, T:17S, R:31E	STATE B	003	1/1/2003	0	No	link	0	O	Shut-in	
30-015-32598	CHEVRON USA, INC. or CHEVRON U S A INC	EDDY	S:21, T:17S, R:31E	SKELLY UNIT	939	12/31/2002		No	link	5,360	O	Active	FREN PADDOCK
30-015-05119	MERIT ENERGY CO or MERIT ENERGY COMPANY, LLC	EDDY	S:9, T:17S, R:31E	H E WEST B	017	7/1/2002		No	link	3,980	G	Active	
30-015-05122	MERIT ENERGY CO or MERIT ENERGY COMPANY, LLC	EDDY	S:10, T:17S, R:31E	H E WEST B	013	7/1/2002		No	link	3,900	I	Injection Well	
30-015-05123	MERIT ENERGY CO or MERIT ENERGY COMPANY, LLC	EDDY	S:10, T:17S, R:31E	H E WEST B	014	7/1/2002		No	link	3,950	I	Injection Well	
30-015-05124	MERIT ENERGY CO	EDDY	S:10, T:17S, R:31E	H E WEST B	015	7/1/2002		No	link	3,952	I	Plugged	
30-015-05126	MERIT ENERGY CO or MERIT ENERGY COMPANY, LLC	EDDY	S:10, T:17S, R:31E	H E WEST B	020	7/1/2002		No	link	3,971	I	Injection Well	
	MERIT ENERGY CO or MERIT												

30-015-05127	ENERGY COMPANY, LLC	EDDY	S:10, T:17S, R:31E	H E WEST B	021	7/1/2002			No	link	3,802	I	Injection Well	
30-015-25921	MERIT ENERGY CO or MERIT ENERGY COMPANY, LLC	EDDY	S:10, T:17S, R:31E	H E WEST B	031	7/1/2002			No	link	4,218	O	Pumping	
30-015-25954	MERIT ENERGY CO or MERIT ENERGY COMPANY, LLC	EDDY	S:10, T:17S, R:31E	H E WEST B	032	7/1/2002			No	link	3,954	I	Injection Well	
30-015-25989	MERIT ENERGY CO or MERIT ENERGY COMPANY, LLC	EDDY	S:10, T:17S, R:31E	H E WEST B	034	7/1/2002			No	link	3,885	O	Pumping	
30-015-25995	MERIT ENERGY CO or MERIT ENERGY COMPANY, LLC	EDDY	S:9, T:17S, R:31E	H E WEST B	036	7/1/2002			No	link	3,883	G	Active	
30-015-26001	MERIT ENERGY CO or MERIT ENERGY COMPANY, LLC	EDDY	S:10, T:17S, R:31E	H E WEST B	038	7/1/2002			No	link	3,960	I	Injection Well	
30-015-26033	MERIT ENERGY CO or MERIT ENERGY COMPANY, LLC	EDDY	S:10, T:17S, R:31E	H E WEST B	041	7/1/2002			No	link	4,008	O	Pumping	
30-015-26044	MERIT ENERGY CO or MERIT ENERGY COMPANY, LLC	EDDY	S:10, T:17S, R:31E	H E WEST B	042	7/1/2002			No	link	4,004	O	Pumping	
30-015-26572	MERIT ENERGY CO or MERIT ENERGY COMPANY, LLC	EDDY	S:10, T:17S, R:31E	H E WEST B	048	7/1/2002			No	link	4,370	I	Injection Well	QUEEN
30-015-27110	MERIT ENERGY CO or MERIT ENERGY COMPANY, LLC	EDDY	S:10, T:17S, R:31E	H E WEST B	051	7/1/2002			No	link	4,372	O	Pumping	
30-015-27149	MERIT ENERGY CO or MERIT ENERGY COMPANY, LLC	EDDY	S:10, T:17S, R:31E	H E WEST B	052	7/1/2002			No	link	4,330	O	Pumping	
30-015-27311	MERIT ENERGY CO or MERIT ENERGY COMPANY, LLC	EDDY	S:10, T:17S, R:31E	H E WEST B	058	7/1/2002			No	link	4,480	O	Pumping	SAN ANDRES
30-015-27318	MERIT ENERGY CO or MERIT ENERGY COMPANY, LLC	EDDY	S:10, T:17S, R:31E	H E WEST B	059	7/1/2002			No	link	4,370	O	Pumping	GRAYBURG
30-015-27354	MERIT ENERGY CO or MERIT ENERGY COMPANY, LLC	EDDY	S:10, T:17S, R:31E	H E WEST B	067	7/1/2002			No	link	4,395	O	Pumping	GRAYBURG
30-015-27401	MERIT ENERGY CO or MERIT ENERGY COMPANY, LLC	EDDY	S:10, T:17S, R:31E	H E WEST B	061	7/1/2002			No	link	4,350	O	Pumping	GRAYBURG
30-015-27561	MERIT ENERGY CO or MERIT ENERGY COMPANY, LLC	EDDY	S:10, T:17S, R:31E	H E WEST B	060	7/1/2002			No	link	4,335	O	Pumping	SAN ANDRES
	MERIT ENERGY CO or MERIT ENERGY													

30-015-27785	COMPANY, LLC	EDDY	S:10, T:17S, R:31E	H E WEST B	066	7/1/2002	0	No	link	4,190	O	Pumping	GB-JACKSON POOL
30-015-28131	MERIT ENERGY CO or MERIT ENERGY COMPANY, LLC	EDDY	S:9, T:17S, R:31E	H E WEST B	072	7/1/2002		No	link	4,160	O	Shut-in	GRAYBURG
30-015-28535	MERIT ENERGY CO or MERIT ENERGY COMPANY, LLC	EDDY	S:10, T:17S, R:31E	H E WEST B	069	7/1/2002		No	link	4,040	O	Pumping	SAN ANDRES
30-015-28573	MERIT ENERGY CO or MERIT ENERGY COMPANY, LLC	EDDY	S:9, T:17S, R:31E	H E WEST B	071	7/1/2002		No	link	3,960	O	Pumping	SAN ANDRES
30-015-28574	MERIT ENERGY CO or MERIT ENERGY COMPANY, LLC	EDDY	S:10, T:17S, R:31E	H E WEST B	070	7/1/2002		No	link	4,010	O	Pumping	SAN ANDRES
30-015-28575	MERIT ENERGY CO or MERIT ENERGY COMPANY, LLC	EDDY	S:10, T:17S, R:31E	H E WEST B	068	7/1/2002		No	link	4,055	O	Pumping	SAN ANDRES
30-015-32316	MARBOB ENERGY CORP	EDDY	S:10, T:17S, R:31E	OXY BUTTER PECAN FEDERAL	001	5/29/2002	12,400	No	link	12,200	G	Active	MORROW
30-015-29322	CHEVRON USA, INC. or CHEVRON U S A INC	EDDY	S:15, T:17S, R:31E	SKELLY UNIT	902	5/1/2002		No	link	12,300	G	Active	MORROW
30-015-29720	CHEVRON USA, INC. or CHEVRON U S A INC	EDDY	S:11, T:17S, R:31E	TEXMACK 11 FEDERAL	001	5/1/2002		No	link		G	Flowing	MORROW
30-015-05131	WESTBROOK OIL CORP	EDDY	S:11, T:17S, R:31E	LEA C	003	3/1/2002		No	link	3,953	O	Temporarily Abandoned	
30-015-20627	WESTBROOK OIL CORP	EDDY	S:11, T:17S, R:31E	LEA C	007	3/1/2002		No	link	3,970	I	Temporarily Abandoned	
30-015-20641	WESTBROOK OIL CORP	EDDY	S:11, T:17S, R:31E	LEA C	008	3/1/2002		No	link	3,920	O	Temporarily Abandoned	
30-015-20648	WESTBROOK OIL CORP	EDDY	S:11, T:17S, R:31E	LEA C	009	3/1/2002		No	link		I	Temporarily Abandoned	
30-015-20678	WESTBROOK OIL CORP	EDDY	S:11, T:17S, R:31E	LEA C	010	3/1/2002		No	link	3,954	O	Active	
30-015-20679	WESTBROOK OIL CORP	EDDY	S:11, T:17S, R:31E	LEA C	011	3/1/2002		No	link	3,930	I	Temporarily Abandoned	
30-015-20697	WESTBROOK OIL CORP	EDDY	S:11, T:17S, R:31E	LEA C	012	3/1/2002		No	link	3,995	O	Pumping	
30-015-29568	MACK ENERGY CORP	EDDY	S:16, T:17S, R:31E	WILLOW STATE	004	9/5/2001		No	link		O	Active	PADDOCK
30-015-31322	MARBOB ENERGY CORP	EDDY	S:10, T:17S, R:31E	OXY POTEET STRAWBERRY FEDERAL	001	5/1/2001		No	link	12,200	O	Pumping	FREN MORROW
30-015-30725	MARBOB ENERGY CORP	EDDY	S:16, T:17S, R:31E	FORAN STATE	002	8/18/1999		No	link	5,530	O	Pumping	PADDOCK
30-015-29086	DEVON ENERGY PRODUCTION COMPANY, LP	EDDY	S:10, T:17S, R:31E	H E WEST B	093	1/13/1999		No	link		X	Cancelled	SAN ANDRES
30-015-29836	BURNS OPERATING	EDDY	S:10, T:17S, R:31E	ARCO 10 FEDERAL	002	1/12/1999		No	link		X	Cancelled	DEVONIAN
30-015-30312	TEXACO EXPLORATION & PRODUCTION INC	EDDY	S:11, T:17S, R:31E	TEXMACK 11 FEDERAL	002	6/15/1998		No	link	12,350	G	Active	WOLFCAMP



30-015-29370	BURNS OPERATING	EDDY	S:10, T:17S, R:31E	ARCO 10 FEDERAL	001	5/27/1998		No	link		X	Cancelled	DEVONIAN
30-015-29201	WISER OIL CO (THE)	EDDY	S:14, T:17S, R:31E	SKELLY UNIT	184	4/7/1998		No	link		PO	Unknown	SAN ANDRES
30-015-29205	WISER OIL CO (THE)	EDDY	S:15, T:17S, R:31E	SKELLY UNIT	183	4/7/1998		No	link		PO	Unknown	SAN ANDRES
30-015-05152	WISER OIL CO (THE)	EDDY	S:15, T:17S, R:31E	SKELLY UNIT	001	10/16/1997	0	No	link	3,692	G	Active	
30-015-22261	WISER OIL CO (THE)	EDDY	S:15, T:17S, R:31E	SKELLY UNIT	127	10/16/1997	0	No	link	2,503	I	Injection Well	
30-015-29762	WISER OIL CO (THE)	EDDY	S:22, T:17S, R:31E	SKELLY UNIT	213	7/29/1997		No	link	3,950	O	Pumping	SAN ANDRES
30-015-05148	WISER OIL CO (THE)	EDDY	S:14, T:17S, R:31E	SKELLY UNIT	103	7/22/1997	0	No	link	0	I	Injection Well	
30-015-20406	WISER OIL CO (THE)	EDDY	S:15, T:17S, R:31E	SKELLY UNIT	108	7/22/1997	0	No	link	3,804	I	Injection Well	
30-015-05153	WISER OIL CO (THE)	EDDY	S:15, T:17S, R:31E	SKELLY UNIT	017	6/18/1997	0	No	link	0	I	Injection Well	
30-015-20366	WISER OIL CO (THE)	EDDY	S:15, T:17S, R:31E	SKELLY UNIT	106	6/10/1997	0	No	link	3,651	I	Injection Well	
30-015-05146	WISER OIL CO (THE)	EDDY	S:14, T:17S, R:31E	SKELLY UNIT	104	6/6/1997	0	No	link	3,831	I	Injection Well	
30-015-05140	WISER OIL CO (THE)	EDDY	S:14, T:17S, R:31E	SKELLY UNIT	033	6/2/1997	0	No	link	3,840	I	Injection Well	
30-015-05154	WISER OIL CO (THE)	EDDY	S:15, T:17S, R:31E	SKELLY UNIT	018	6/2/1997	0	No	link	0	G	Active	
30-015-24011	MACK ENERGY CORP	EDDY	S:16, T:17S, R:31E	CHOCTAW STATE	001	6/1/1997	0	No	link	3,600	O	Active	
30-015-05161	WISER OIL CO (THE)	EDDY	S:15, T:17S, R:31E	SKELLY UNIT	020	5/20/1997	0	No	link	0	G	Active	
30-015-20468	WISER OIL CO (THE)	EDDY	S:15, T:17S, R:31E	SKELLY UNIT	109	5/14/1997	0	No	link	3,920	I	Injection Well	
30-015-29606	MACK ENERGY CORP	EDDY	S:16, T:17S, R:31E	WILLOW STATE	003	5/14/1997		No	link	5,507	O	Pumping	PADDOCK
30-015-05156	WISER OIL CO (THE)	EDDY	S:15, T:17S, R:31E	SKELLY UNIT	028	4/29/1997	0	No	link	0	I	Injection Well	
30-015-05145	WISER OIL CO (THE)	EDDY	S:14, T:17S, R:31E	SKELLY UNIT	023	4/24/1997	0	No	link	3,860	I	Pumping	
30-015-05159	WISER OIL CO (THE)	EDDY	S:15, T:17S, R:31E	SKELLY UNIT	027	4/24/1997	0	No	link	0	I	Pumping	
30-015-05160	WISER OIL CO (THE)	EDDY	S:15, T:17S, R:31E	SKELLY UNIT	025	4/24/1997	0	No	link	0	G	Active	
30-015-05343	WISER OIL CO (THE)	EDDY	S:22, T:17S, R:31E	SKELLY UNIT	041	4/24/1997	0	No	link	3,818	I	Injection Well	
30-015-29540	WISER OIL CO (THE)	EDDY	S:14, T:17S, R:31E	SKELLY UNIT	214	4/24/1997		No	link	3,950	O	Active	SAN ANDRES
30-015-29541	WISER OIL CO (THE)	EDDY	S:14, T:17S, R:31E	SKELLY UNIT	215	4/24/1997		No	link	4,000	O	Pumping	SAN ANDRES
30-015-05320	WISER OIL CO (THE)	EDDY	S:21, T:17S, R:31E	SKELLY UNIT	059	4/17/1997	0	No	link	3,654	I	Injection Well	
30-015-10500	WISER OIL CO (THE)	EDDY	S:22, T:17S, R:31E	SKELLY UNIT	043	4/11/1997	0	No	link	0	G	Active	
30-015-29495	MACK ENERGY CORP	EDDY	S:16, T:17S, R:31E	WILLOW STATE	005	4/10/1997		No	link	8,700	O	Pumping	WOLFCAMP
30-015-05361	WISER OIL CO (THE)	EDDY	S:23, T:17S, R:31E	SKELLY UNIT	039	3/28/1997	0	No	link	3,841	G	Active	
30-015-05151	WISER OIL CO (THE)	EDDY	S:15, T:17S, R:31E	SKELLY UNIT	029	3/19/1997	0	No	link	3,717	G	Active	
30-015-26098	MARBOB ENERGY CORP	EDDY	S:16, T:17S, R:31E	FORAN STATE	001	2/1/1997		No	link	3,832	O	Pumping	SAN ANDRES
	WISER OIL CO												

30-015-29312	(THE)	EDDY	S:15, T:17S, R:31E	SKELLY UNIT	191	12/20/1996		No	link	3,900	O	Pumping	GRAYBURG JACKSON
30-015-29313	WISER OIL CO (THE)	EDDY	S:15, T:17S, R:31E	SKELLY UNIT	192	12/20/1996		No	link	3,950	O	Pumping	GRAYBURG JACKSON
30-015-29223	WISER OIL CO (THE)	EDDY	S:14, T:17S, R:31E	SKELLY UNIT	216	10/11/1996		No	link	4,100	O	Pumping	SAN ANDRES
30-015-29216	WISER OIL CO (THE)	EDDY	S:14, T:17S, R:31E	SKELLY UNIT	193	10/9/1996		No	link	4,100	O	Pumping	SAN ANDRES
30-015-29217	WISER OIL CO (THE)	EDDY	S:14, T:17S, R:31E	SKELLY UNIT	194	10/9/1996		No	link	4,100	O	Pumping	SAN ANDRES
30-015-29219	WISER OIL CO (THE)	EDDY	S:14, T:17S, R:31E	SKELLY UNIT	203	10/9/1996		No	link	4,100	O	Pumping	SAN ANDRES
30-015-29203	WISER OIL CO (THE)	EDDY	S:15, T:17S, R:31E	SKELLY UNIT	180	10/4/1996		No	link	3,950	O	Active	SAN ANDRES
30-015-29204	WISER OIL CO (THE)	EDDY	S:15, T:17S, R:31E	SKELLY UNIT	182	10/4/1996		No	link	3,950	O	Pumping	SAN ANDRES
30-015-29206	WISER OIL CO (THE)	EDDY	S:15, T:17S, R:31E	SKELLY UNIT	189	10/4/1996		No	link	3,925	O	Pumping	SAN ANDRES
30-015-29207	WISER OIL CO (THE)	EDDY	S:15, T:17S, R:31E	SKELLY UNIT	190	10/4/1996		No	link	3,900	O	Pumping	SAN ANDRES
30-015-29092	WISER OIL CO (THE)	EDDY	S:15, T:17S, R:31E	SKELLY UNIT	211	8/7/1996	4,800	No	link	4,000	O	Pumping	SAN ANDRES
30-015-29092	WISER OIL CO (THE)	EDDY	S:15, T:17S, R:31E	SKELLY UNIT	211	7/31/1996		No	link	4,000	O	Pumping	SAN ANDRES
30-015-29062	WISER OIL CO (THE)	EDDY	S:14, T:17S, R:31E	SKELLY UNIT	202	7/25/1996		No	link	4,050	O	Pumping	SAN ANDRES
30-015-29031	WISER OIL CO (THE)	EDDY	S:22, T:17S, R:31E	SKELLY UNIT	212	7/2/1996		No	link	4,060	O	Pumping	SAN ANDRES
30-015-29013	WISER OIL CO (THE)	EDDY	S:15, T:17S, R:31E	SKELLY UNIT	198	6/21/1996		No	link	4,000	O	Pumping	SAN ANDRES
30-015-28998	WISER OIL CO (THE)	EDDY	S:15, T:17S, R:31E	SKELLY UNIT	200	6/5/1996		No	link	4,000	O	Pumping	GRAYBURG JACKSON
30-015-28972	WISER OIL CO (THE)	EDDY	S:15, T:17S, R:31E	SKELLY UNIT	199	5/9/1996		No	link	4,000	O	Pumping	GRAYBURG JACKSON
30-015-28965	WISER OIL CO (THE)	EDDY	S:15, T:17S, R:31E	SKELLY UNIT	181	5/2/1996		No	link	3,950	O	Shut-in	GRAYBURG JACKSON
30-015-28947	WISER OIL CO (THE)	EDDY	S:14, T:17S, R:31E	SKELLY UNIT	201	4/24/1996		No	link	4,050	O	Pumping	SAN ANDRES
30-015-05143	WISER OIL CO (THE)	EDDY	S:14, T:17S, R:31E	SKELLY UNIT	034	9/1/1995	0	No	link	0	G	Flowing	
30-015-05144	WISER OIL CO (THE)	EDDY	S:14, T:17S, R:31E	SKELLY UNIT	024	9/1/1995	0	No	link	0	I	Injection Well	
30-015-05149	WISER OIL CO (THE)	EDDY	S:14, T:17S, R:31E	SKELLY UNIT	105	9/1/1995	0	No	link	0	I	Injection Well	
30-015-05150	WISER OIL CO (THE)	EDDY	S:15, T:17S, R:31E	SKELLY UNIT	031	9/1/1995	0	No	link	3,800	O	Shut-in	
30-015-05155	WISER OIL CO (THE)	EDDY	S:15, T:17S, R:31E	SKELLY UNIT	019	9/1/1995	0	No	link	0	I	Injection Well	
30-015-05157	WISER OIL CO (THE)	EDDY	S:15, T:17S, R:31E	SKELLY UNIT	026	9/1/1995	0	No	link	0	G	Active	
30-015-05158	WISER OIL CO (THE)	EDDY	S:15, T:17S, R:31E	SKELLY UNIT	021	9/1/1995	0	No	link	0	G	Flowing	
30-015-05162	WISER OIL CO (THE)	EDDY	S:15, T:17S, R:31E	SKELLY UNIT	032	9/1/1995	0	No	link	0	I	Injection Well	
30-015-05347	WISER OIL CO (THE)	EDDY	S:22, T:17S, R:31E	SKELLY UNIT	003	9/1/1995	0	No	link	12,384	O	Active	
30-015-05356	WISER OIL CO (THE)	EDDY	S:22, T:17S, R:31E	SKELLY UNIT	042	9/1/1995		No	link	2,165	I	Injection Well	
30-015-05360	WISER OIL CO (THE)	EDDY	S:23, T:17S, R:31E	SKELLY UNIT	040	9/1/1995	0	No	link	3,827	G	Flowing	
30-015-10774	WISER OIL CO (THE)	EDDY	S:15, T:17S, R:31E	SKELLY UNIT	030	9/1/1995	0	No	link	3,906	G	Active	PLUGGED & ABANDON

30-015-22254	WISER OIL CO (THE)	EDDY	S:14, T:17S, R:31E	SKELLY UNIT	120	9/1/1995	0	No	link	2,600	O	Pumping	
30-015-22260	WISER OIL CO (THE)	EDDY	S:15, T:17S, R:31E	SKELLY UNIT	126	9/1/1995	0	No	link	2,530	O	Active	
30-015-22262	WISER OIL CO (THE)	EDDY	S:22, T:17S, R:31E	SKELLY UNIT	128	9/1/1995	0	No	link	2,550	O	Active	
30-015-22263	WISER OIL CO (THE)	EDDY	S:21, T:17S, R:31E	SKELLY UNIT	129	9/1/1995	0	No	link	0	O	Active	
30-015-22483	WISER OIL CO (THE)	EDDY	S:15, T:17S, R:31E	SKELLY UNIT	150	9/1/1995	0	No	link	2,630	O	Pumping	
30-015-22520	WISER OIL CO (THE)	EDDY	S:23, T:17S, R:31E	SKELLY UNIT	146	9/1/1995	0	No	link	2,646	O	Pumping	
30-015-22537	STEVENS OPERATING CORPORATION or HANAGAN PETROLEUM CORP	EDDY	S:14, T:17S, R:31E	PRE-ONGARD WELL	156	1/1/1970		No	link		PO	Active Permit	GETTY OIL CO /SKELLY UT
30-015-26208	STEVENS OPERATING CORPORATION or HANAGAN PETROLEUM CORP	EDDY	S:10, T:17S, R:31E	PRE-ONGARD WELL	048	1/1/1970		No	link		PO	Active Permit	HONDO OIL & GAS CO /H E WEST B

[PDF](#) [Save](#)  
[Map](#) [Image](#)

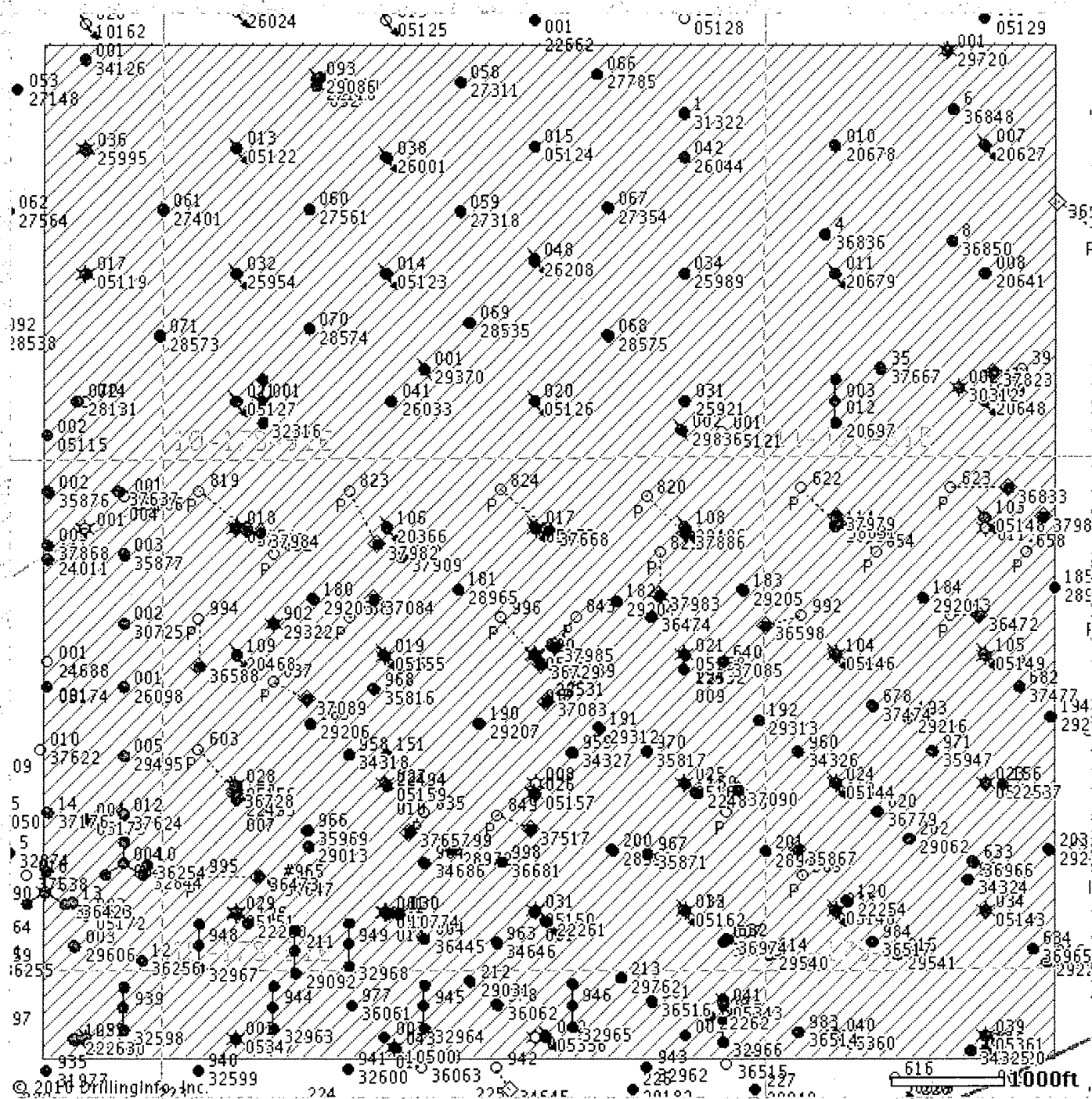

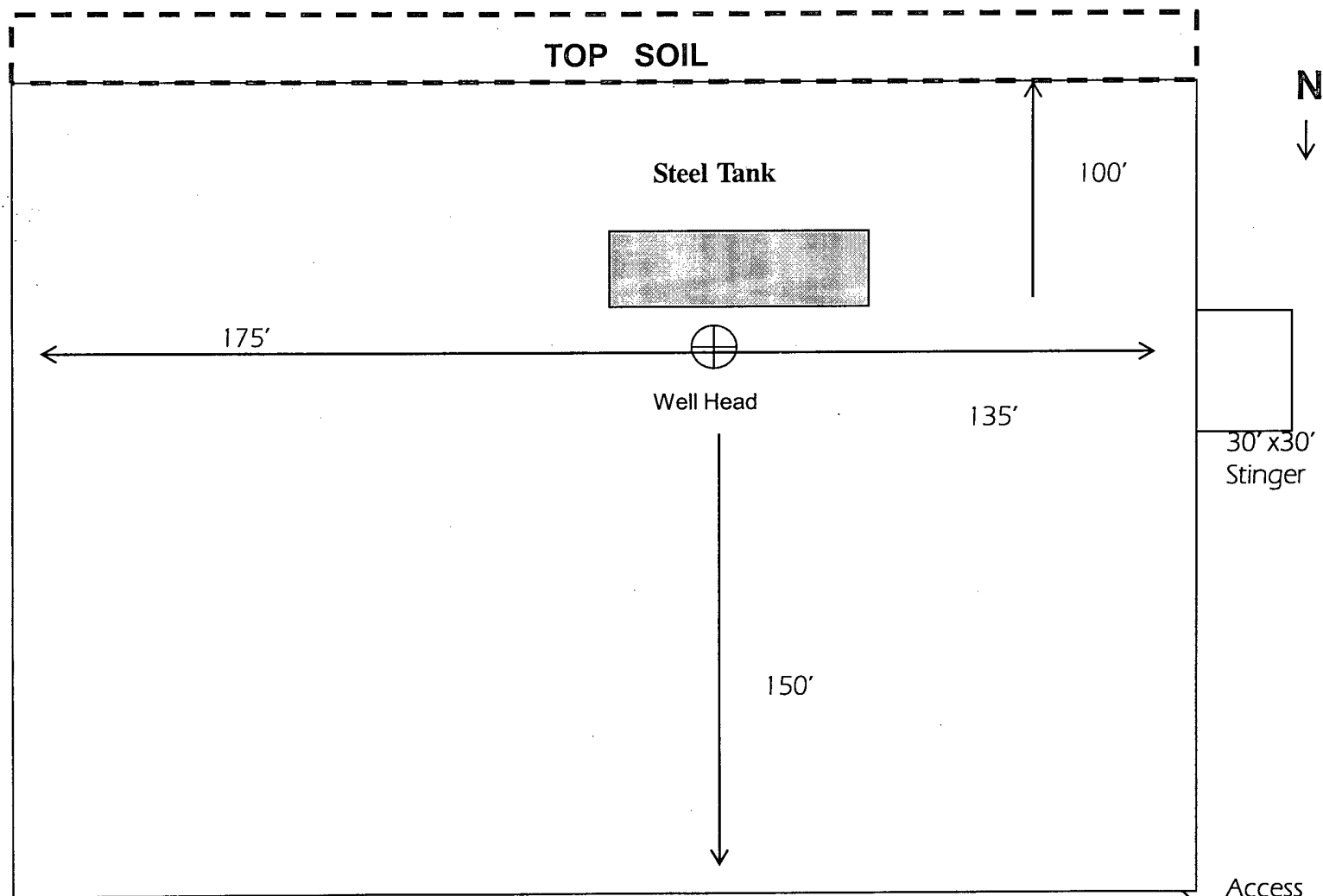

Not To Scale

COG OPERATING LLC  
Rig Layout-Closed Loop  
System Skelly Unit 833

