

Submit 3 Copies To Appropriate District
Office
District I
1625 N. French Dr., Hobbs, NM 88240
District II
1301 W. Grand Ave., Artesia, NM 88210
District III
1000 Rio Brazos Rd., Aztec, NM 87410
District IV
1220 S. St. Francis Dr., Santa Fe, NM
87505

State of New Mexico
Energy, Minerals and Natural Resources

Form C-103
May 27, 2004

OIL CONSERVATION DIVISION
1220 South St. Francis Dr.
Santa Fe, NM 87505

WELL API NO.
30-015-30944
Indicate Type of Lease
STATE ☒ FEE ☐
State Oil & Gas Lease No.

SUNDRY NOTICES AND REPORTS ON WELLS
(DO NOT USE THIS FORM FOR PROPOSALS TO DRILL OR TO DEEPEN OR PLUG BACK TO A
DIFFERENT RESERVOIR. USE "APPLICATION FOR PERMIT" (FORM C-101) FOR SUCH
PROPOSALS.)

1. Type of Well: Oil Well ☒ Gas Well ☐ Other

2. Name of Operator
COG Operating LLC

3. Address of Operator
550 W. Texas Ave., Suite 100 Midland, TX 79701

Well Location

Unit Letter I : 2310 feet from the South line and 990 feet from the East line
Section 19 Township 17S Range 29E NMPM County Eddy

11. Elevation (Show whether DR, RKB, RT, GR, etc.)
3683 GR

Pit or Below-grade Tank Application ☐ or Closure ☐

Pit type _____ Depth to Groundwater _____ Distance from nearest fresh water well _____ Distance from nearest surface water _____

Pit Liner Thickness: 0 mil Below-Grade Tank: Volume _____ bbls; Construction Material _____

12. Check Appropriate Box to Indicate Nature of Notice, Report or Other Data

NOTICE OF INTENTION TO:

PERFORM REMEDIAL WORK ☐ PLUG AND ABANDON ☐
TEMPORARILY ABANDON ☐ CHANGE PLANS ☐
PULL OR ALTER CASING ☐ MULTIPLE COMPL ☐
DOWNHOLE COMMINGLE ☐

OTHER:

Deepen ☒

SUBSEQUENT REPORT OF:

REMEDIAL WORK ☐ ALTERING CASING ☐
COMMENCE DRILLING OPNS. ☐ P AND A ☐
CASING/CEMENT JOB ☐

OTHER:

13. Describe proposed or completed operations. (Clearly state all pertinent details, and give pertinent dates, including estimated date of starting any proposed work). SEE RULE 1103. For Multiple Completions: Attach wellbore diagram of proposed completion or recompletion.

See Attached procedure

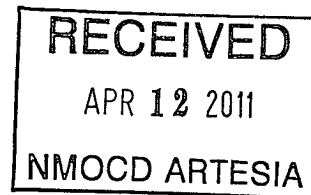

SIGNATURE Netha Aaron TITLE Regulatory Analyst DATE 4/11/11

Type or print name Netha Aaron E-mail address: oaaron@conchoresources.com PHONE: 432-818-2319

For State Use Only

APPROVED BY: David May TITLE Field Supervisor DATE 4-19-11

Conditions of Approval (if any):

COG Operating, LLC
State S 19 #14
API# 30-015-30944
I-19-17S-29E
2310 FSL & 990 FEL
Eddy Co, NM

Deepening Procedure

1. MIRU rig.
2. Sqz upper Yeso w/ +/- 400 sx of Class C neat. Drill out squeeze.
3. PU 4-3/4" bit and drill 4-3/4" hole from 4405' to 5500'.
4. POOH w/ bit and drillstring.
5. RIH w/ logs and log from TD to 3600'.
6. RIH w/ 4", 11.3# casing. See section 11 for general centralizer program.
7. Cement casing from TD to 4205' w/ 120 sxs Class C cmt. Drop plug and open DV tool. Circ cmt off DV tool. Drop plug to close DV tool.
8. PU workstring and RIH and drill out DV tool. POOH and LD workstring.
9. RDMO rig.

Completion Procedure

1. MIRU rig.
2. RIH/ w/ perforating guns and perforate Yeso from 5100 – 5300 w/ 1 spf, 28 holes.
3. Acidize w/ 2500 gals of 15% HCl. Frac zone w/ 179,800 # of sand. Set plug at 5050'.
4. RIH w/ perforating guns and perforate Yeso from 4800' – 5000'.
5. Acidize w/ 2500 gals of 15% HCl. Frac zone w/ 179,800 # of sand. Set plug at 4750'.
6. RIH w/ perforating guns and perforate Yeso from 4500' – 4700'.
7. Acidize w/ 2500 gals of 15% HCl. Frac zone w/ 179,800 # of sand.
8. RIH and drill out plug at 4750' and 5050'.
9. RIH and cut or back off 4" casing at 4205'. POOH w/ 4" casing. Leave 4" liner from 4205' to 5500' (TD).
10. RIH w/ tbg and locate end of tbg at 4155'.
11. RIH w/ rods and pump.
12. RDMO rig.

Centralizer Diagram

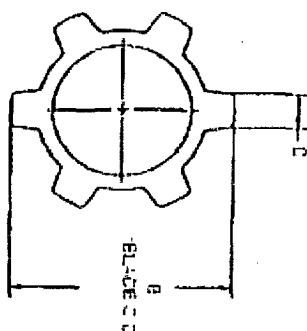
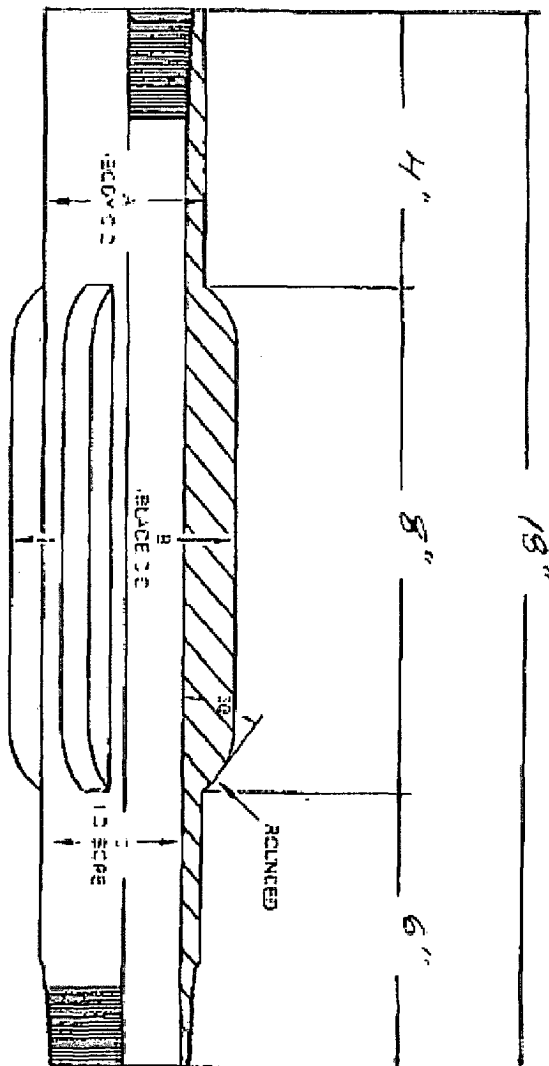

1/8"
 6.80
 21.0

1000
 1000
 1000

SIZE	A	B	C	D	E	F	G	DRIFT
4" 1/4 3/4 11/64	4.050	4.750	3.347	3/4"				3-303"

 RAY OIL TOOL CO.	
STAND OFF 5	
CENTRALIZED INTERCASING	
CLIENT	Concho Res
WELL NAME & NO.	
CASING	4" 11/4 11/64
MATERIAL	4 3/4 x 3/4 x 18" 4105

FIGURE 107

42