

# N. M. Oil Cons. Division

811 S. 1ST ST.

ARTESIA, NM 88401-2004

0157

Form 3160-5  
(June 1990)

## UNITED STATES DEPARTMENT OF THE INTERIOR BUREAU OF LAND MANAGEMENT

FORM APPROVED  
Budget Bureau No. 1004-0135  
Expires: March 31, 1993

### SUNDRY NOTICES AND REPORTS ON WELLS

Do not use this form for proposals to drill or to deepen or reentry to a different reservoir.  
Use "APPLICATION FOR PERMIT-" for such proposals

SUBMIT IN TRIPLICATE

1. Type of Well  
☒ Oil Well ☐ Gas Well ☐ Other

2. Name of Operator  
Burns Operating Co.

3. Address and Telephone No.  
P.O. Box 97525 Wichita Falls, TX 76300

4. Location of Well (Footage, Sec., T., R., M., or Survey Description)  
1792' FNL & 727' FWL  
Sec. 17-T17S-R31E

5. Lease Designation and Serial No.  
NMLC-054908

6. If Indian, Allottee or Tribe Name

7. If Unit or CA, Agreement Designation

8. Well Name and No.  
Fair "17" Fed. #1

9. API Well No.  
30-015-23969

10. Field and Pool, or Exploratory Area  
Wildcat-Devonian

11. County or Parish, State  
Eddy County, New Mexico

### 12. CHECK APPROPRIATE BOX(es) TO INDICATE NATURE OF NOTICE, REPORT, OR OTHER DATA

TYPE OF SUBMISSION	TYPE OF ACTION
<input type="checkbox"/> Notice of Intent	<input checked="" type="checkbox"/> Abandonment
<input type="checkbox"/> Subsequent Report	<input type="checkbox"/> Recompletion
<input checked="" type="checkbox"/> Final Abandonment Notice	<input type="checkbox"/> Plugging Back
	<input type="checkbox"/> Casing Repair
	<input type="checkbox"/> Altering Casing
	<input type="checkbox"/> Other
	<input type="checkbox"/> Change of Plans
	<input type="checkbox"/> New Construction
	<input type="checkbox"/> Non-Routine Fracturing
	<input type="checkbox"/> Water Shut-Off
	<input type="checkbox"/> Conversion to Injection
	<input type="checkbox"/> Dispose Water

(Note: Report results of multiple completion on Well Completion or Recompletion Report and Log form.)

13. Describe Proposed or Completed Operations (Clearly state all pertinent details, and give pertinent dates, including estimated date of starting any proposed work. If well is directionally drilled, give subsurface locations and measured and true vertical depths for all markers and zones pertinent to this work.)

Drill 7 7/8" hole to total depth of 12,321. Reach TD at 1930 hrs on 7/11/96. Run Electric logs and plug and abandon well as follows:

Plug #1	12321-12,121'	200' Plug	60 sx. Class "H" Neat	Bottom plug
Plug #2	11400-11,300'	100' Plug	30 sx. Class "H" Neat	Top of Chester
Plug #3	10950-10,850'	"	"	Top of Morrow
Plug #4	9500-9400'	"	"	Top of Penn. Canyon
Plug #5	8100-8000'	"	"	Top of Wolfcamp
Plug #6	7000-6900'	"	"	Top of Abo
Plug #7	4800-4600'	200' Plug	60 sx. Class "H" Neat	Across 8 5/8" Shoe—Tagged at 4615'
Plug #8	2500-2400'	100' Plug	30 sx. Class "H" Neat	Top of Salt
Plug #9	650-550'	"	"	Across 13 3/8" Shoe
Plug #10	60' to Surface.	60' Plug	15 sx. Class "H" Neat	Surface Plug.

Plugging procedure approval given verbally by BLM—Steve Cathey and Confirmed by BLM—Joe Lara.  
Rig down and move out ZiaDril Rig #2. Install regulation dry hole marker.  
Final plug set at 1045 hrs. 7/12/96.

Fill in cellar and rehabilitate location. Fill in reserve pits. Re-seed with appropriate seed mixture. Final Report of Abandonment.

14. I hereby certify that the foregoing is true and correct

Signed [Signature] Title Agent Date 07/25/96

(This space for Federal or State office use)

Approved by [Signature] Title SGD LARRY COOPER Date AUG 18

Conditions of approval, if any:

Title 18 U.S.C. Section 1001, makes it a crime for any person knowingly and willfully to make to any department or agency of the United States any false, fictitious or fraudulent statements or representations as to any matter within its jurisdiction.

\*See Instruction on Reverse Side



**NEW MEXICO ENERGY, MINERALS  
& NATURAL RESOURCES DEPARTMENT**

OIL CONSERVATION DIVISION  
DISTRICT II ARTESIA  
811 S. FIRST ST. ARTESIA, NM 88210  
(505) 748-1283  
FAX (505) 748-8720

**Jennifer A. Salisbury**  
CABINET SECRETARY

February 25, 2000

Burns Operating Corporation  
P.O. Box 97525  
Wichita Falls, TX 76309

**RE:    *Arco '10' Federal Well #1 located 990 feet from the South line and 2310 feet from the West line  
(Unit N) of Section 10, Township 17 South, Range 31 East, NMPM, Eddy County, New Mexico.***

***Fair '17' Federal #1 located 1792 feet from the North line and 727 feet from the West line  
(Unit E) of Section 17, Township 17 South, Range 31 East, NMPM, Eddy County, New Mexico***

Dear Sirs/ Madams:

In reference to the above, the Oil Conservation Division has not received a complete set of electric logs, completion reports and well survey deviation reports after telephone requests last year. This information is needed in order to update our files.

Please submit the information requested so as possible in order to comply with OCD rules and regulations.

Yours truly,

Bryan G. Arrant  
District II Geologist

Form C 102  
Revised February 10, 1984  
Submit to Appropriate District Office  
State Lease - 4 Copies  
Fee Lease - 3 Copies

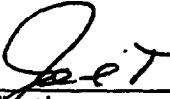
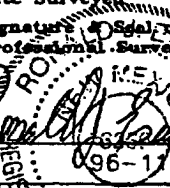
<h2 style="text-align: center;">OPERATOR CERTIFICATION</h2> <p style="text-align: center;"><i>I hereby certify the the information contained herein is true and complete to the best of my knowledge and belief.</i></p> <div style="text-align: center;">  </div> <hr/> <p>Signature</p> <hr/> <p>Joe T. Janica</p> <hr/> <p>Printed Name</p> <hr/> <p>Agent</p> <hr/> <p>Title</p> <hr/> <p>04/10/96</p> <hr/> <p>Date</p>	
<h2 style="text-align: center;">SURVEYOR CERTIFICATION</h2> <p style="text-align: center;"><i>I hereby certify that the well location shown on this plat was plotted from field notes of actual surveys made by me or under my supervision, and that the same is true and correct to the best of my belief.</i></p> <p style="text-align: center;">APRIL 3, 1996</p> <hr/> <p>Date Surveyed <span style="float: right;">DMCC</span></p> <hr/> <p>Signature of Seal of Professional Surveyor</p> <div style="text-align: center;">  </div> <hr/> <p>Certificate No. JOHN W. ROBERTSON 676 RONALD J. EIDSON 3239 RONALD J. EIDSON 12641</p>	

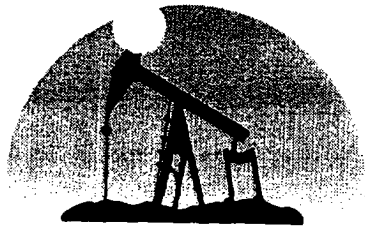

---

**marbob**  
energy corporation

---

STATEMENT ACCEPTING RESPONSIBILITY FOR OPERATIONS

The undersigned accepts all applicable terms, conditions, stipulations, and restrictions concerning operations conducted on the leased land or portion thereof, as described below:

LEASE NO.: NMLC-054908

LEGAL DESCRIPTION OF LAND: Section 17-T17S-R31E  
EDDY COUNTY, NEW MEXICO

FORMATION (S) (if applicable): Wildcat Morrow

BOND COVERAGE: Statewide

BLM BOND FILE NO.: 585716

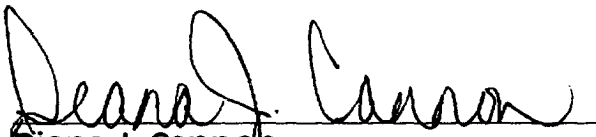
  
Diana J. Cannon  
Production Analyst

Date: 4/1/02

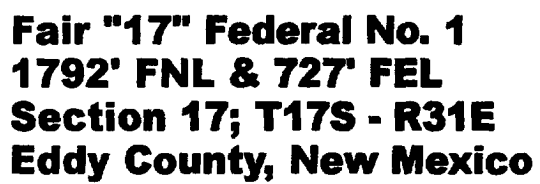

# Exhibit Four

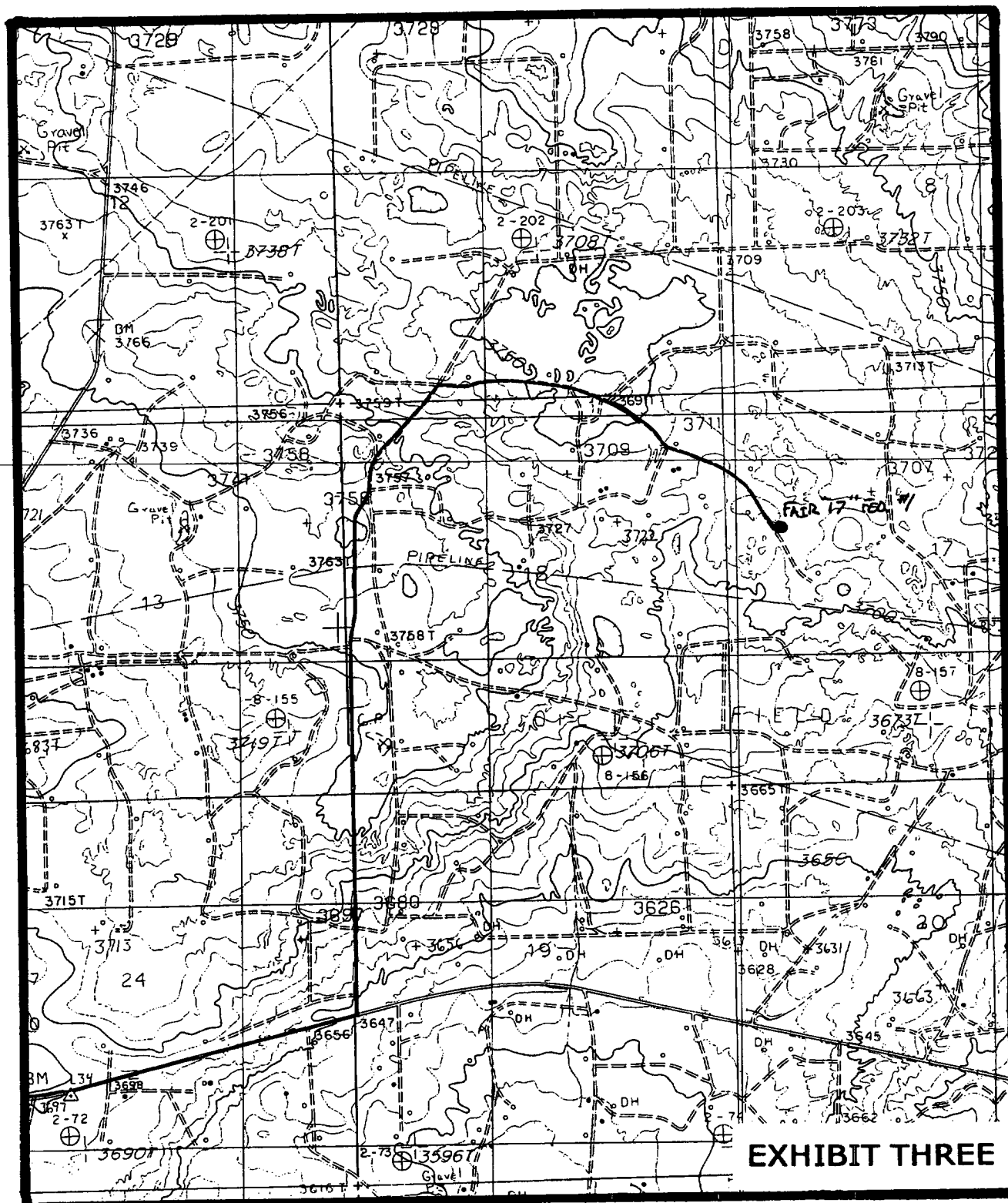

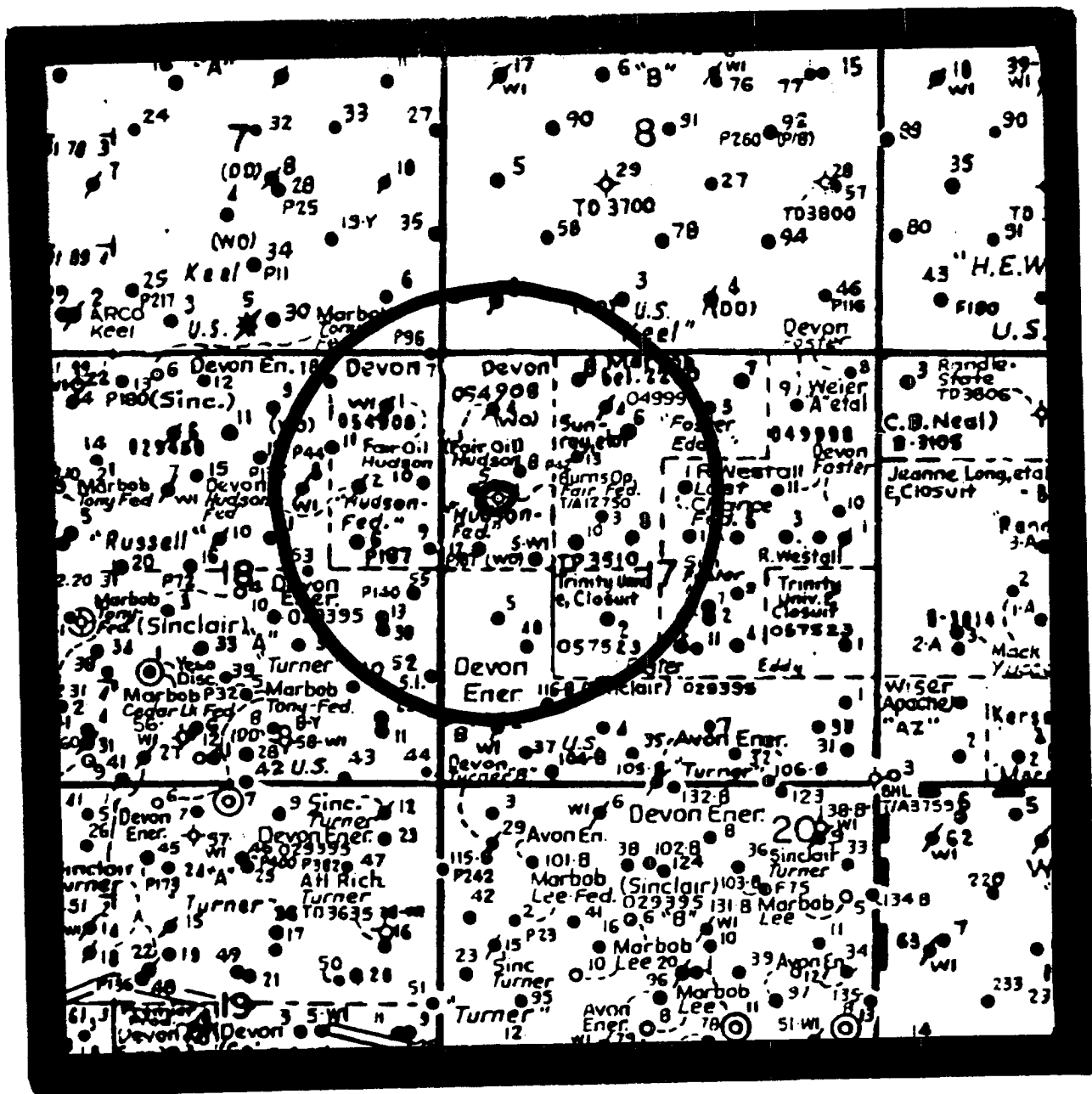

These requirements supercede those issued in your existing, approved APD's for the shallow wells located in T. 17 S., Rgs. 29, 30 and 31 E., NMPM. If you have any question regarding this matter please call John S. Simitz at (505) 627-0288 or Armando A. Lopez at (505) 627-0248.

Sincerely,

A handwritten signature in cursive script, reading "Larry D. Bray".

Larry D. Bray  
Acting Assistant Field Office Manager,  
Lands and Minerals

---

SEP 09 1999



## United States Department of the Interior

### BUREAU OF LAND MANAGEMENT

Roswell Field Office  
2909 West Second St.  
Roswell, New Mexico 88201  
[www.nm.blm.gov](http://www.nm.blm.gov)



IN REPLY REFER TO:  
NMNM-88525X  
3180 (06200)

Marbob Energy Corporation  
Attention: Johnny Gray  
P. O. Box 227  
Artesia, NM 88210

SEP 07 1999

Gentlemen:

With regard to our telephone conversation of September 2, 1999, a review of our records has found discrepancies in the casing requirements section of the conditions of approval for your APD's. As per our meeting on July 7, 1999, our office had agreed with your recommended casing procedures for shallow wells of 6000 ft. or less in T. 17 S., Rgs. 29, 30 and 31 E., NMPM. In order to correct the discrepancies, this letter states the language to be used for the conditions of approval casing requirements for all your existing APD's

Conditions of Approval-Drilling amended as follows:

II. Casing requirements in T. 17 S., Rgs. 29, 30 and 31 E. for shallow wells less than 6,000 ft.

1. 8-5/8 inch surface casing should be set at approximately \_\_\_\_ ft. in the Rustler Anhydrite or in the case the salt occurs at a shallower depth above the top of the salt. The surface casing shoe shall be set in the anhydrite to ensure adequate sealing. The operator is required to use an excess of 100% cement volume to fill annulus. If cement does not circulate to surface the operator may then use ready mix cement to fill the remaining annulus.

2. The minimum required fill of cement behind the 5½ inch production casing is to place the top of the cement 200 ft. above the top of the uppermost hydrocarbon bearing interval or to the base of the salt.