

30-005-60007

NEW MEXICO OIL CONSERVATION COMMISSION

Form C-101
Revised 1-1-65

NO. OF COPIES RECEIVED	7
DISTRIBUTION	
SANTA FE	1
FILE	1
U.S.G.S.	2
LAND OFFICE	1
OPERATOR	2

5A. Indicate Type of Lease
STATE FEE

5. State Oil & Gas Lease No.
OG 701 676-1

APPLICATION FOR PERMIT TO DRILL, DEEPEN, OR PLUG BACK

1a. Type of Work
b. Type of Well DRILL DEEPEN PLUG BACK
OIL WELL GAS WELL OTHER SINGLE ZONE MULTIPLE ZONE

2. Name of Operator
Dr. Sam G. Dunn

3. Address of Operator
P.O. Box 192 Artesia, New Mexico 88210

4. Location of Well
UNIT LETTER **N** LOCATED **330** FEET FROM THE **South** LINE
AND **2310** FEET FROM THE **West** LINE OF SEC. **9** TWP. **11** RGE. **27E** NMPM

7. Unit Agreement Name

8. Farm or Lease Name
Huber & State

9. Well No.
31

10. Field and Pool, or Wildcat
UNDES. COYOTE QUEEN

12. County
Chaves

19. Proposed Depth **1000** 19A. Formation **Penrose** 20. Rotary or C.T. **Rotary**

21. Elevations (Show whether DF, RT, etc.) **3672** 21A. Kind & Status Plug. Bond **Blank** 21B. Drilling Contractor **Self** 22. Approx. Date Work will start **2-22-1967**

PROPOSED CASING AND CEMENT PROGRAM

SIZE OF HOLE	SIZE OF CASING	WEIGHT PER FOOT	SETTING DEPTH	SACKS OF CEMENT	EST. TOP
11"	8 5/8"	28#	175	100	
6 3/4"	4 1/2"	9.5#	972'-1000'	Cir.	

APPROVAL VALID
FOR 90 DAYS UNLESS
DRILLING COMMENCED.

EXPIRES 5-15-67

FEB 8 1967

IN ABOVE SPACE DESCRIBE PROPOSED PROGRAM: IF PROPOSAL IS TO DEEPEN OR PLUG BACK, GIVE DATA ON PRESENT PRODUCTIVE ZONE AND PROPOSED NEW PRODUCTIVE ZONE, GIVE BLOWOUT PREVENTER PROGRAM, IF ANY.

I hereby certify that the information above is true and complete to the best of my knowledge and belief.

Signed Shelma Hail Title Agent Date 2-7-1967

(This space for State Use)

APPROVED BY W. A. Greenwalt TITLE INSPECTOR DATE FEB 14 1967

CONDITIONS OF APPROVAL, IF ANY:

NEW MEXICO OIL CONSERVATION COMMISSION
WELL LOCATION AND ACREAGE DEDICATION PLAT

Form C-102
Supersedes C-128
Effective 1-1-65

All distances must be from the outer boundaries of the Section.

Operator DR. SAM G. DUNN		Lease HUBER STATE		Well No. 1
Tract Letter N	Section 9	Township 11 SOUTH	Range 27 EAST	County CHAVES
Actual Footage Location of Well: 330 feet from the SOUTH line and 2310 feet from the WEST line				
Ground Level Elev.	Producing Formation Penrose	Pool UNDES. COYOTE QUEEN	Dedicated Acreage: 4 40 Acres	

- Outline the acreage dedicated to the subject well by colored pencil or hachure marks on the plat below.
- If more than one lease is dedicated to the well, outline each and identify the ownership thereof (both as to working interest and royalty).
- If more than one lease of different ownership is dedicated to the well, have the interests of all owners been consolidated by communitization, unitization, force-pooling, etc?

RECEIVED

FEB 8 1967

**O. C. C.
ARTS & OFFICE**

Yes No If answer is "yes," type of consolidation _____
If answer is "no," list the owners and tract descriptions which have actually been consolidated (reverse side of this form if necessary.) _____
No allowable will be assigned to the well until all interests have been consolidated (by communitization, unitization, forced-pooling, or otherwise) or until a non-standard unit, eliminating such interests, has been approved by the Commission.

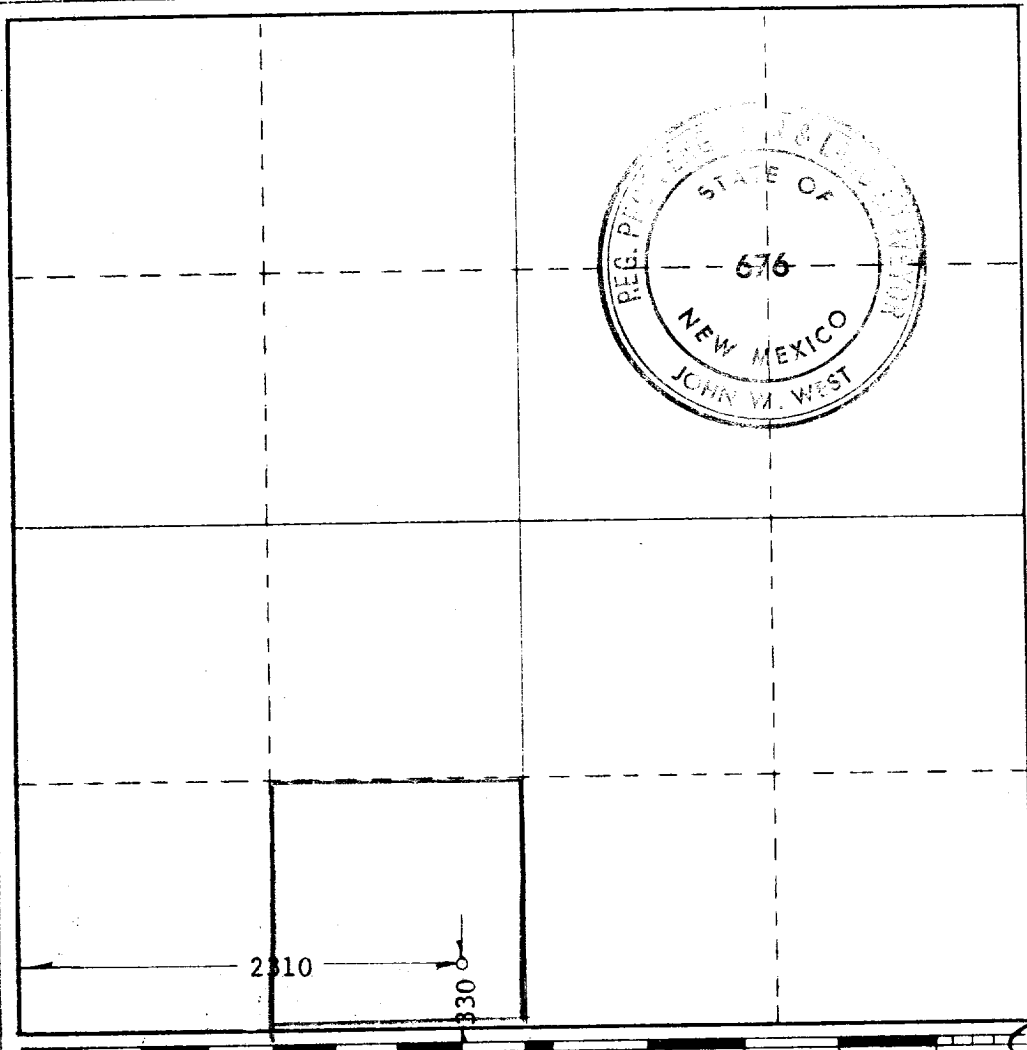

CERTIFICATION

I hereby certify that the information contained herein is true and complete to the best of my knowledge and belief.

Name
Lu R McYadon
Position
SUPERINTENDANT

Company
DR. SAM G. DUNN

Date
2-6-67

I hereby certify that the well location shown on this plat was plotted from field notes of actual surveys made by me or under my supervision, and that the same is true and correct to the best of my knowledge and belief.

Date Surveyed
12-29-66

Registered Professional Engineer and/or Land Surveyor
John W West
Certificate No. **676**

